

# Your Ultimate Source for OEM Repair Manuals

FactoryManuals.net is a great resource for anyone who wants to save money on repairs by doing their own work. The manuals provide detailed instructions and diagrams that make it easy to understand how to fix a vehicle.

## 2024 Volvo V60 Cross Country Service and Repair Manual

[Go to manual page](#)

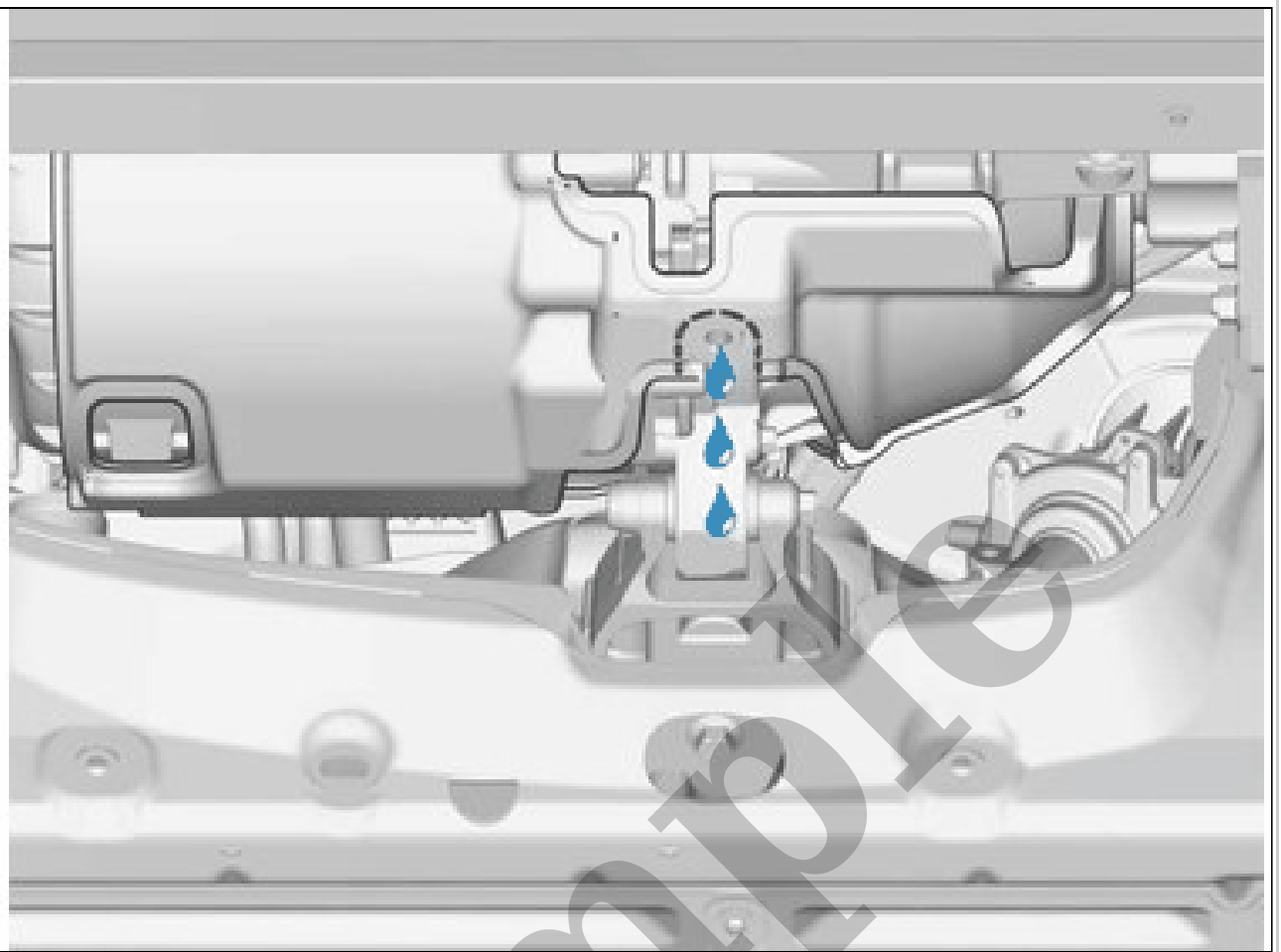

Courtesy of VOLVO CARS CORPORATION

**CAUTION:** *The fluid must be allowed to escape until a continuous flow changes into single drops.*

## INSTALLATION

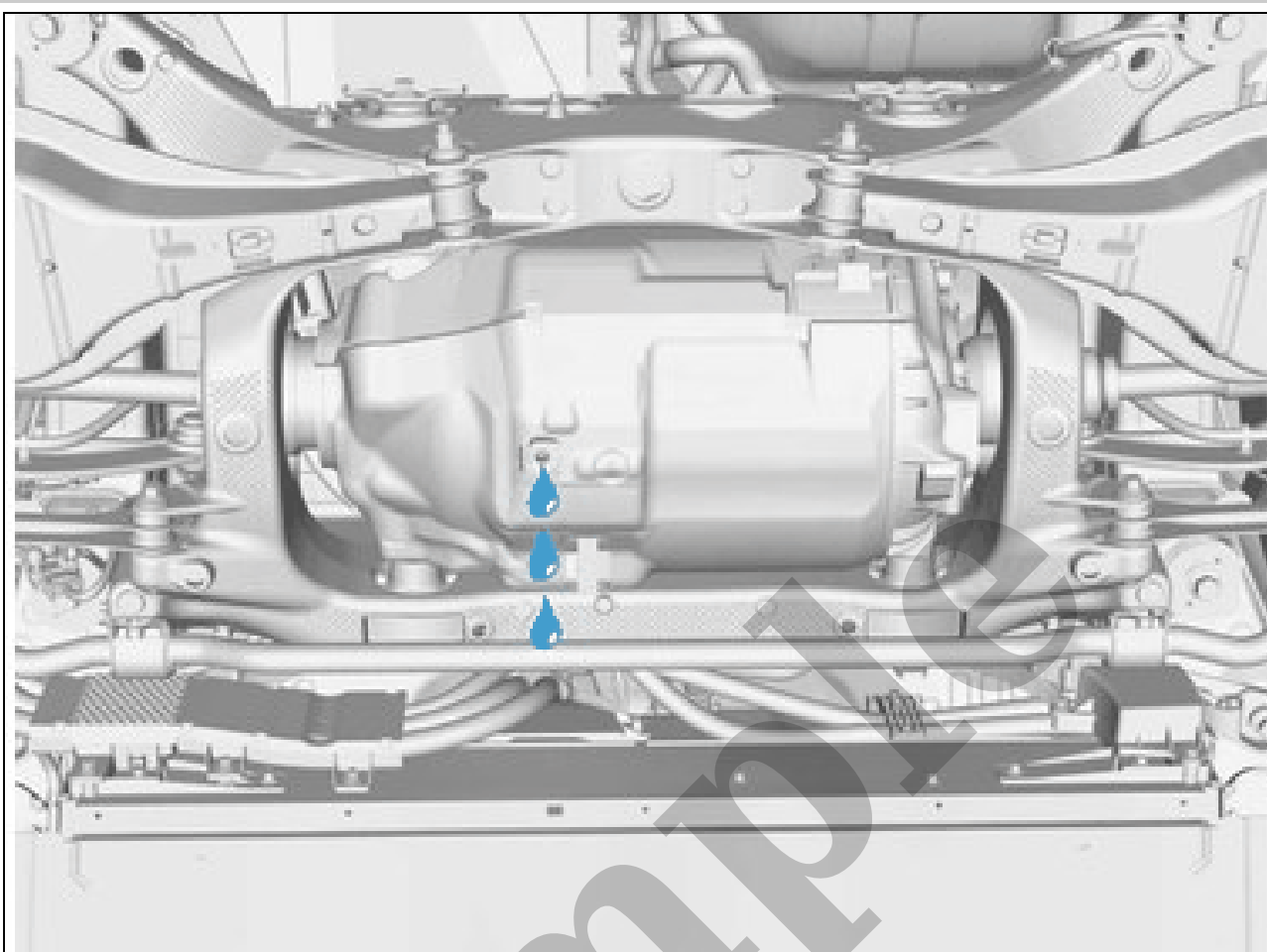

Courtesy of VOLVO CARS CORPORATION

**CAUTION:** *The fluid must be allowed to escape until a continuous flow changes into single drops.*

## INSTALLATION

## ACTIVE ON-DEMAND COUPLING OIL PUMP > ACTIVE ON-DEMAND COUPLING OIL PUMP [2018-2022, TG-81SC AWD] > REMOVAL

**NOTE:** Removal steps in this procedure may contain installation details.

Follow instructions for lifting points body frame. Refer to: JACKING POINTS BODY

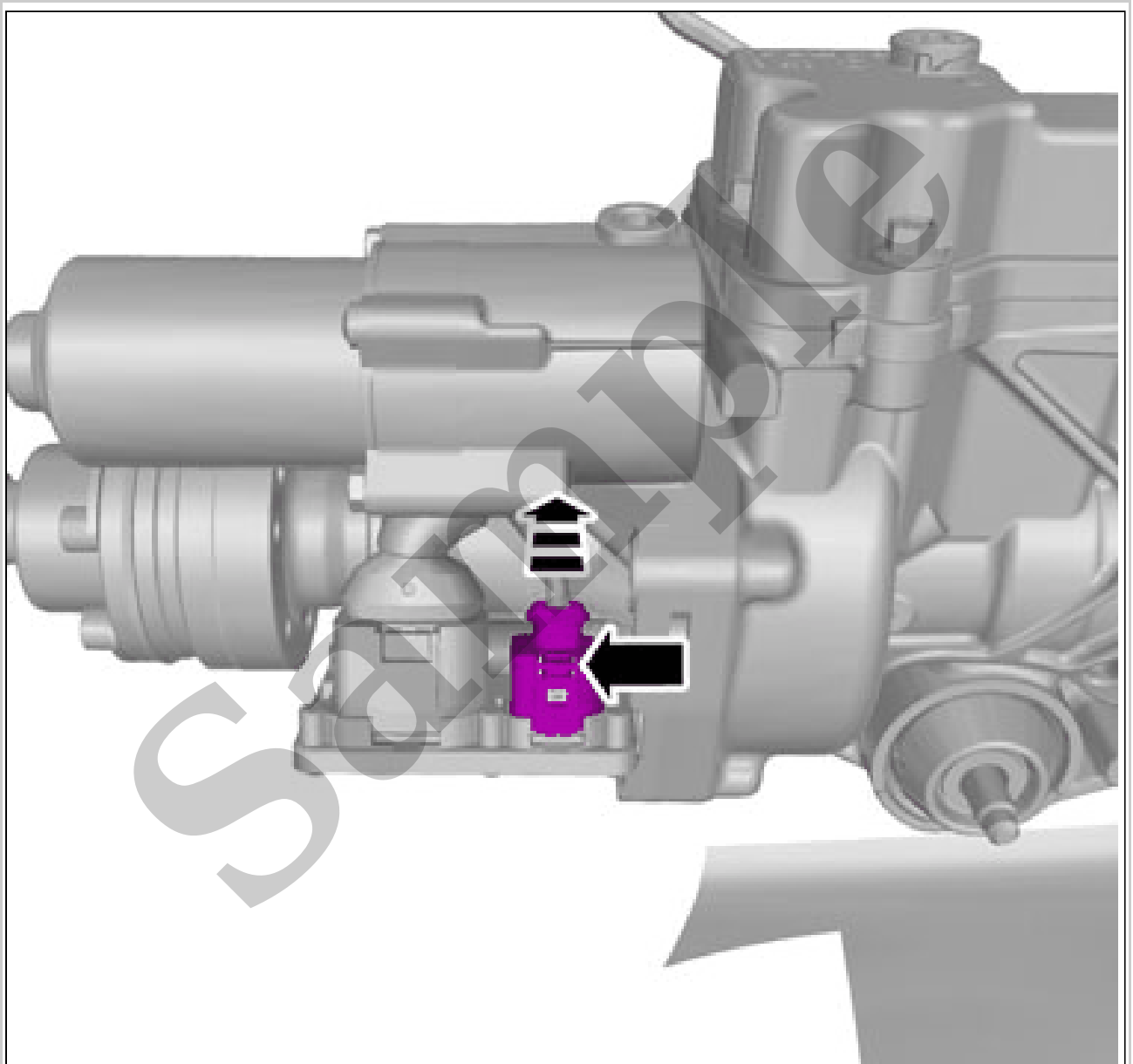

Courtesy of VOLVO CARS CORPORATION

Disconnect the connector.

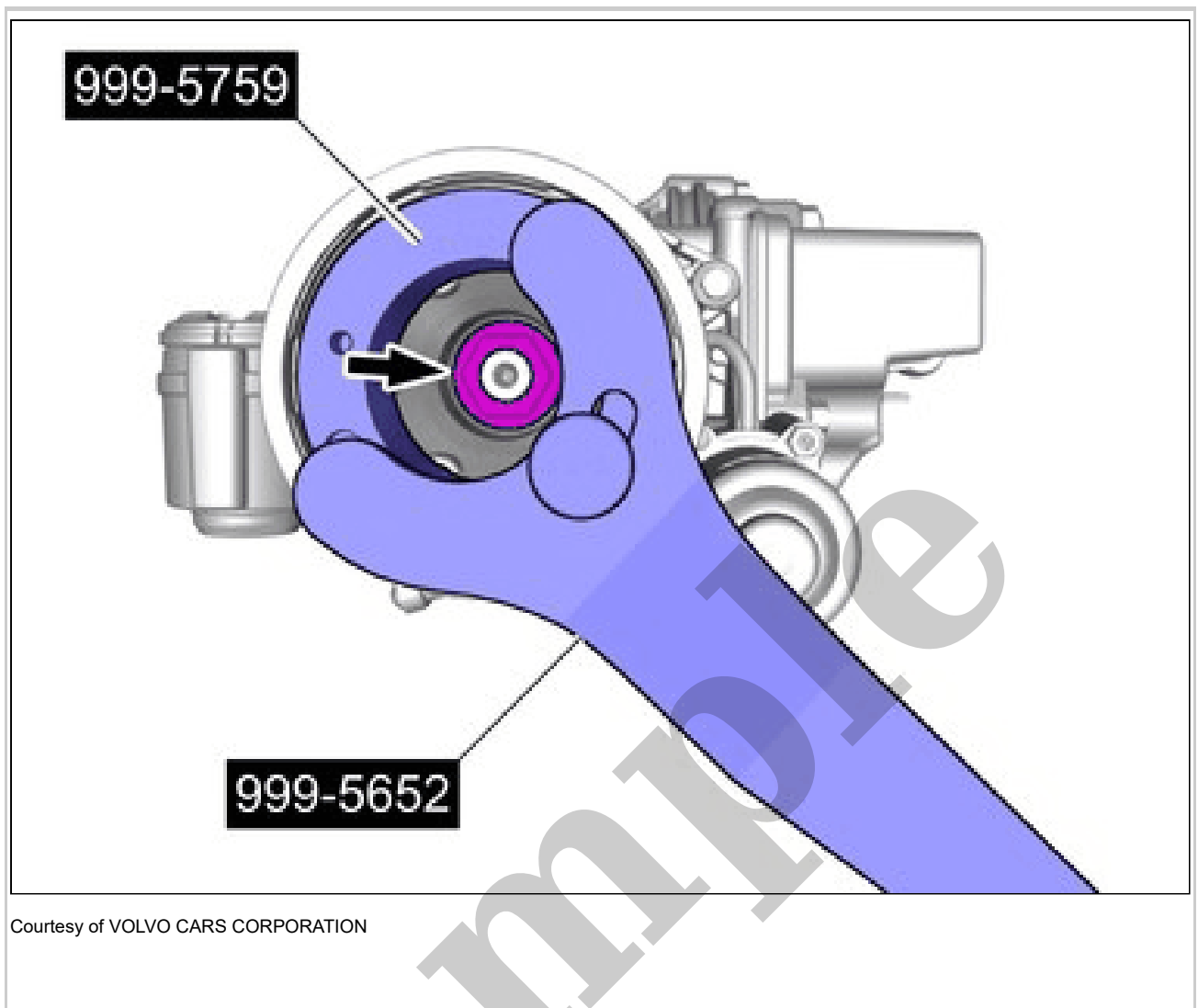

Remove the nut.

Special Tool: 999 5759 Adapter flange All-wheel drive Special Tool: 999 5652 Counterh.

**Torque:** Pinion nut for clutch AOC, 150Nm

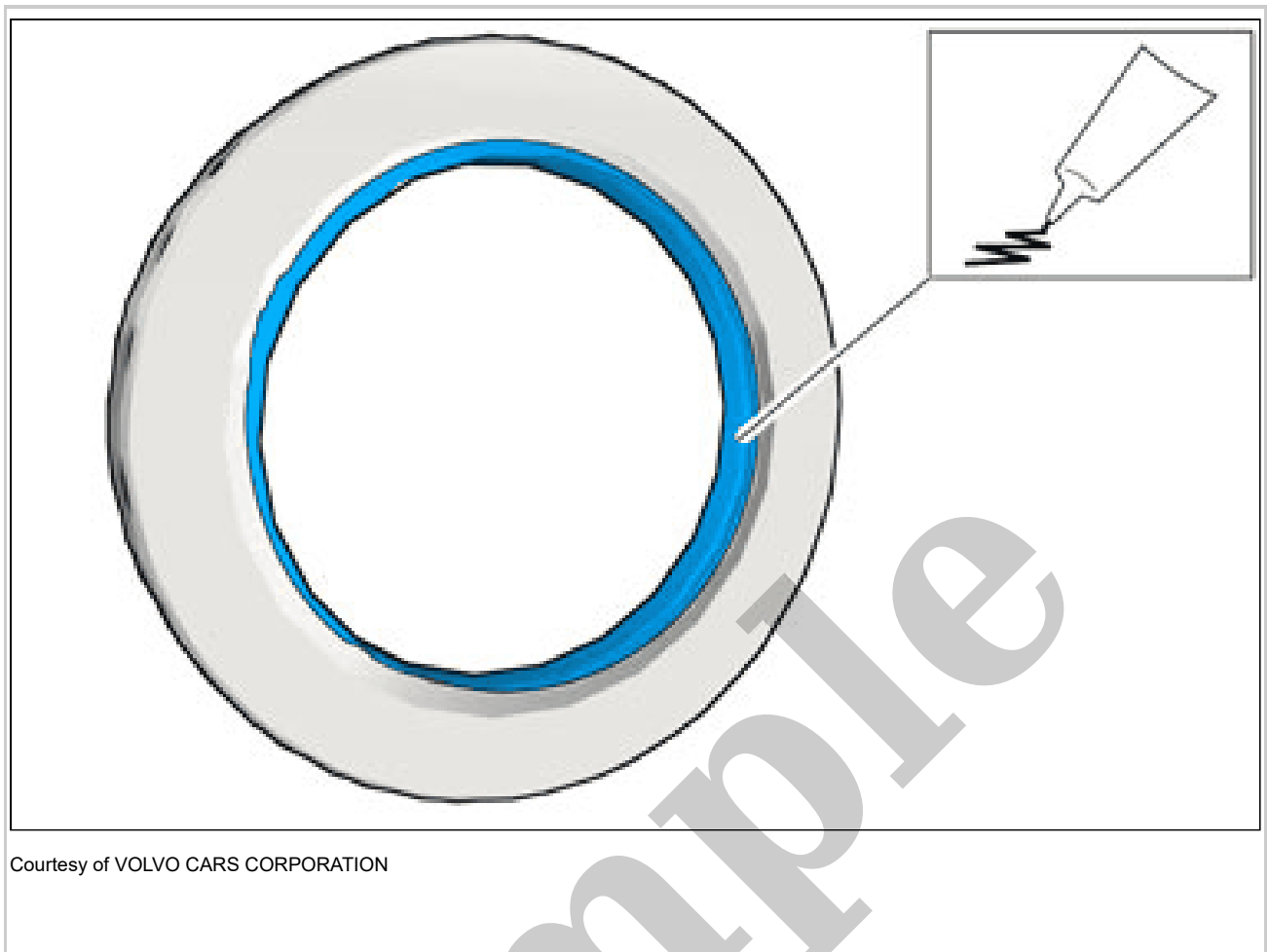

Courtesy of VOLVO CARS CORPORATION

**Use:** Wheel bearing grease, 1161689

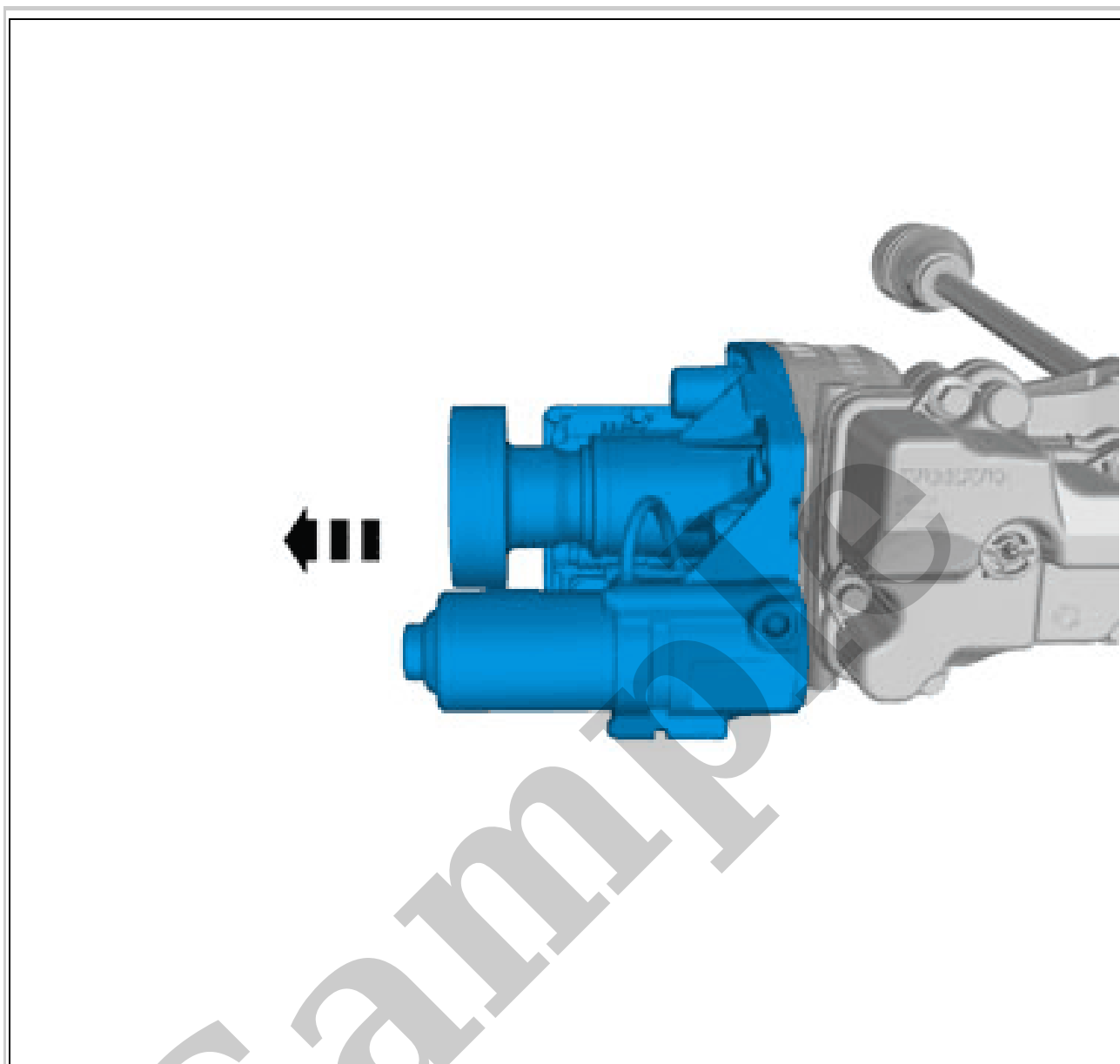

Courtesy of VOLVO CARS CORPORATION

**WARNING:** *Be prepared to collect escaping fluid.*

Remove the part carefully

**CLUTCH FOUR-WHEEL DRIVE > CLUTCH FOUR-WHEEL DRIVE [2018-2022, TG-81SC AWD] > INSTALLATION**

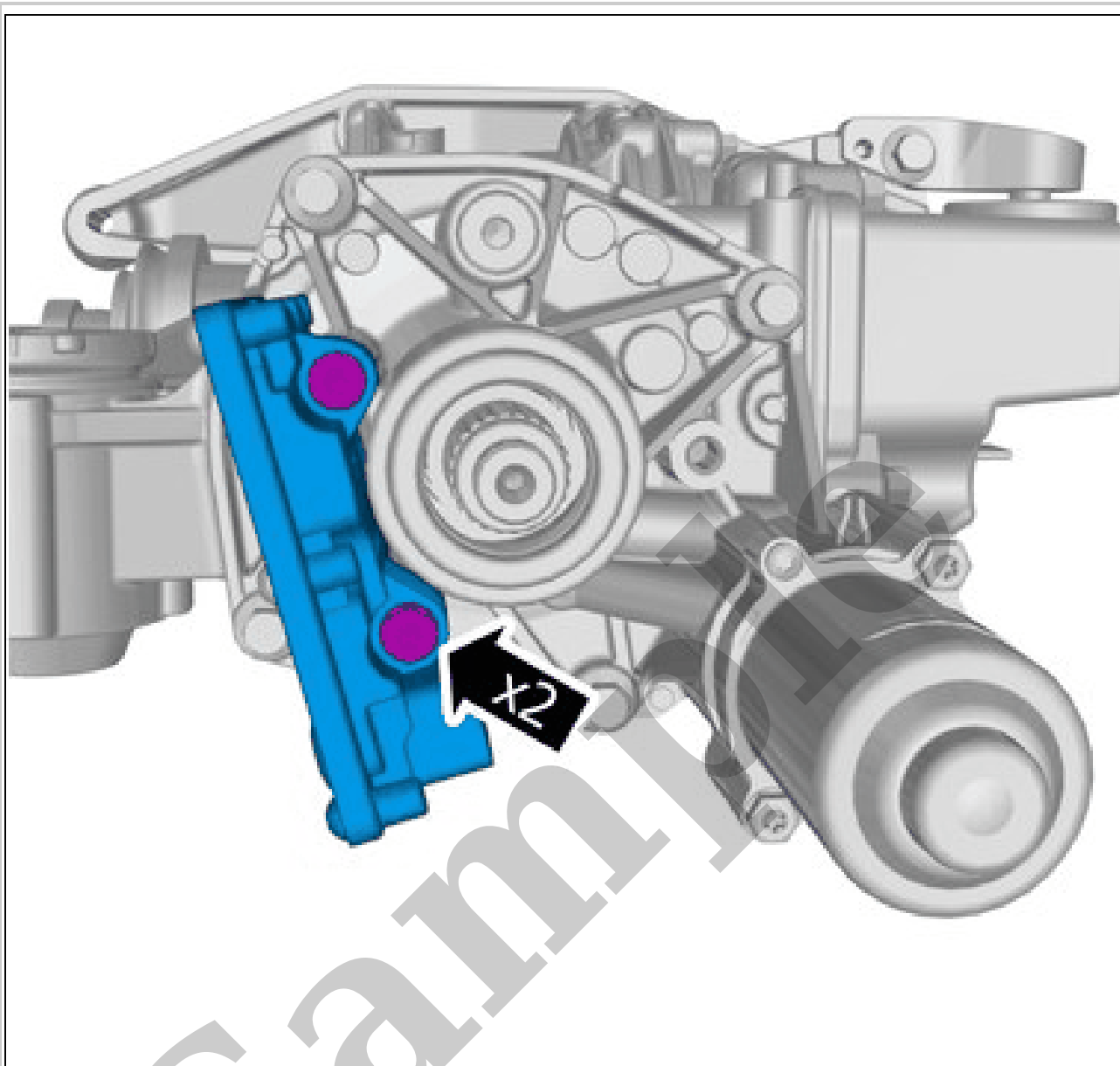

Courtesy of VOLVO CARS CORPORATION

Remove the screws.

**Torque:** M6, 10Nm

Remove the marked part.

## **DIFFERENTIAL ELECTRONIC MODULE > DIFFERENTIAL ELECTRONIC MODULE (DEM) [2018-2022, TG-81SC AWD] > INSTALLATION**

To install, reverse the removal procedure.

Order and download the appropriate software according to: VIDA/Software/Hardware Changes

Calibrate according to: Diagnostics / Components / Control modules / Differential Electronic Module (DEM) / Diagnostic sequences / Calibration of Differential Electronic Module (DEM)



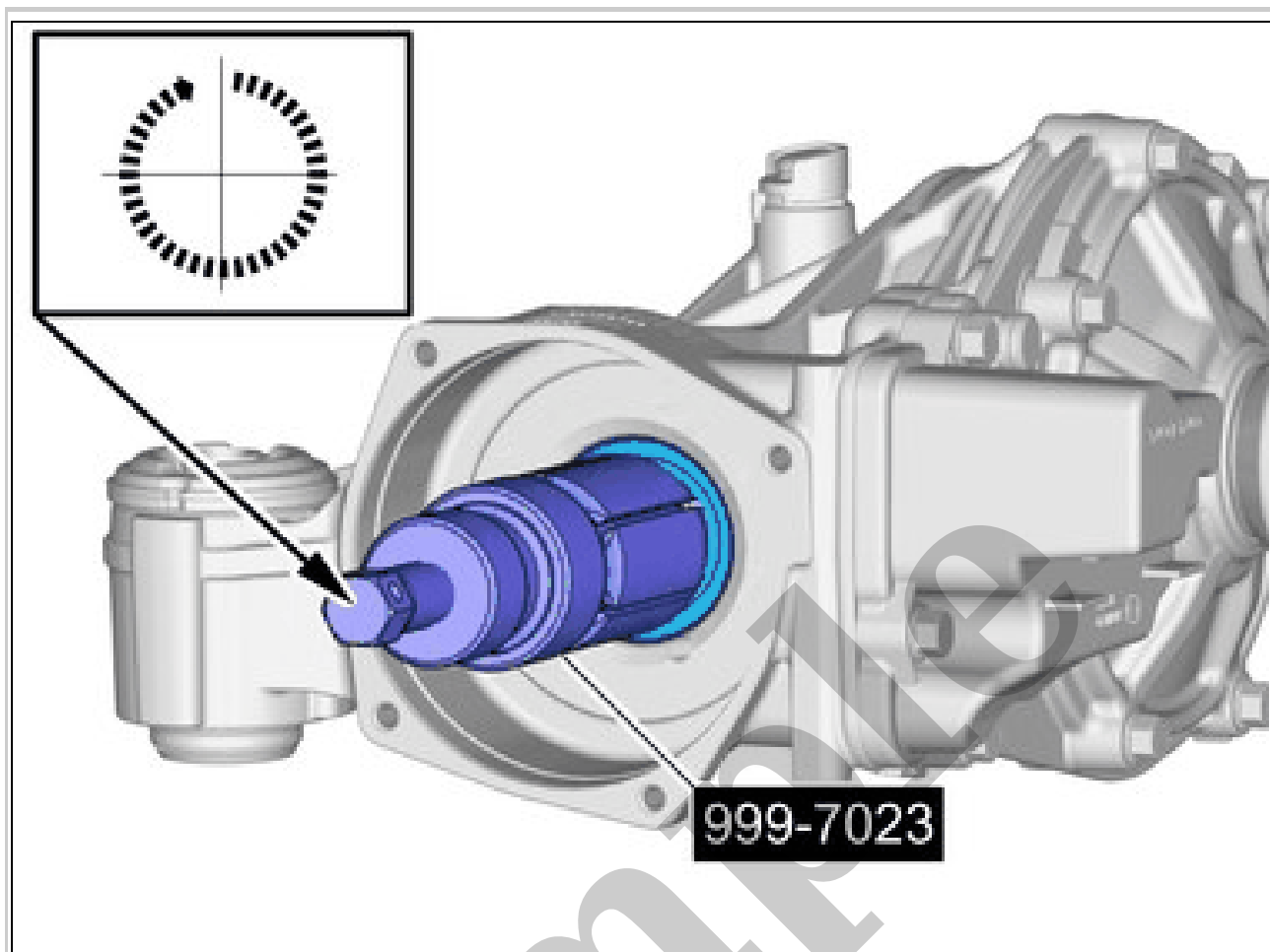

Courtesy of VOLVO CARS CORPORATION

**WARNING:** *Be prepared to collect escaping fluid.*

Remove the marked part.

Special Tool: 999 7023 Extractor pinion seal Haldex coupling

**DIFFERENTIAL INPUT SHAFT SEAL > DIFFERENTIAL INPUT SHAFT SEAL [2018-2022, TG-81SC AWD] > INSTALLATION**

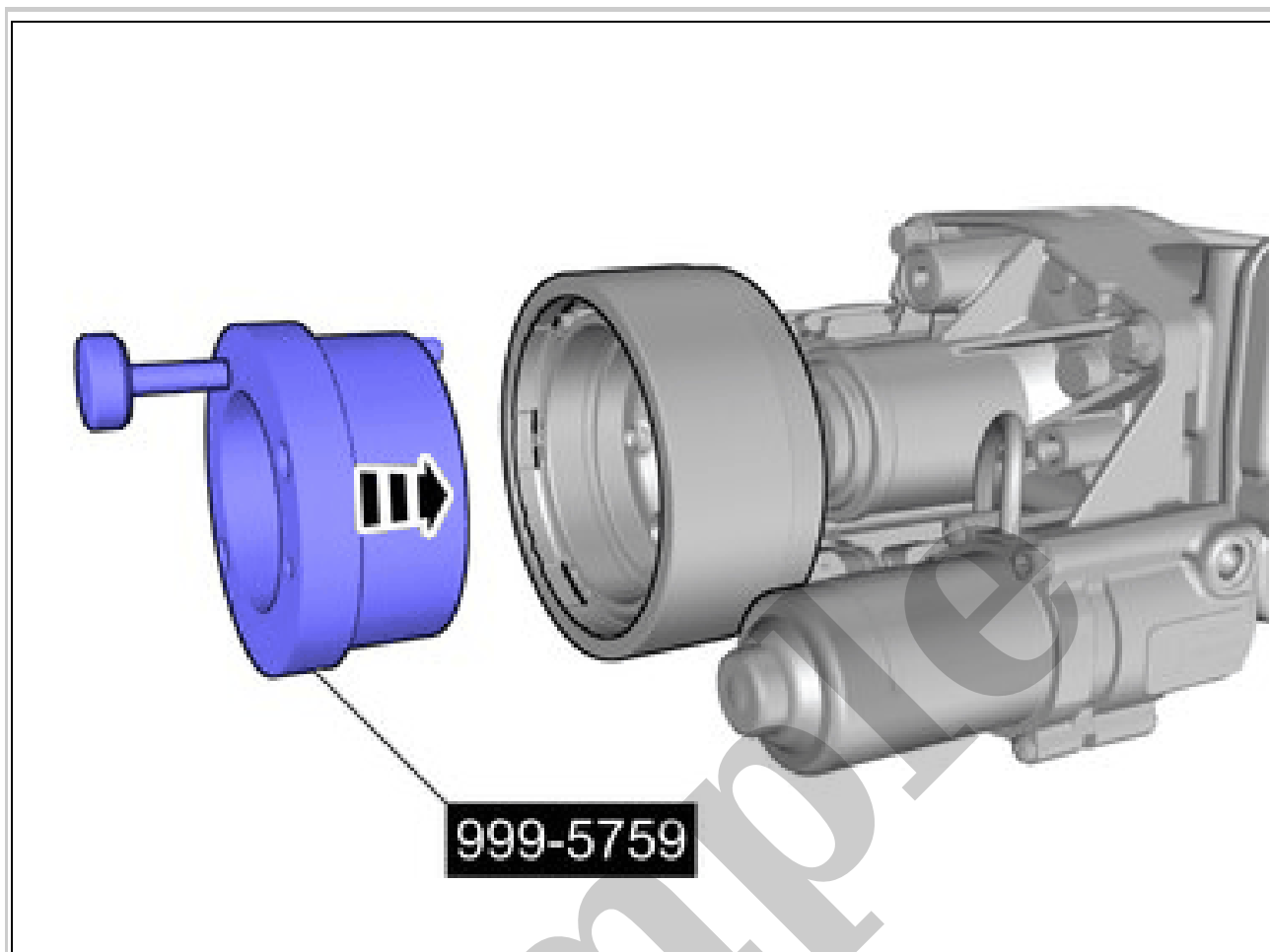

Courtesy of VOLVO CARS CORPORATION

Special Tool: 999 5759 Adapter flange All-wheel drive