

Your Ultimate Source for OEM Repair Manuals

FactoryManuals.net is a great resource for anyone who wants to save money on repairs by doing their own work. The manuals provide detailed instructions and diagrams that make it easy to understand how to fix a vehicle.

2024 Ford Transit-150 Service and Repair Manual

[Go to manual page](#)

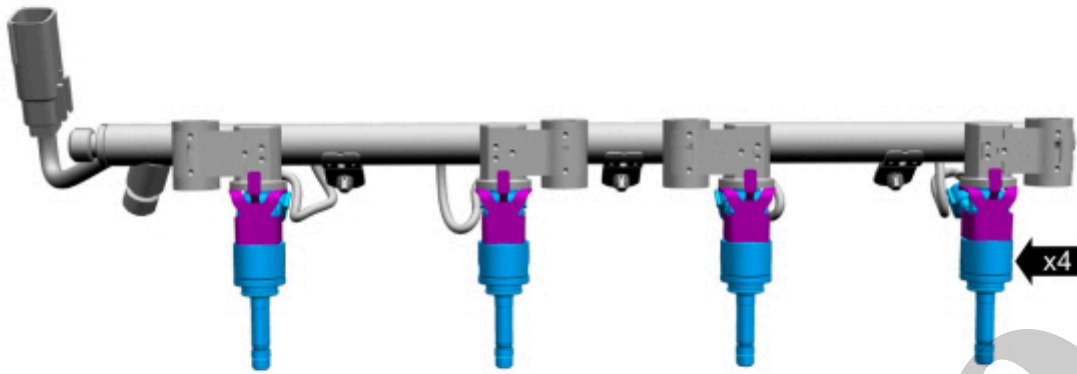

E330037

[Click here to learn about symbols, color coding, and icons used in this manual.](#)

17. Remove and discard the fuel injector clips.

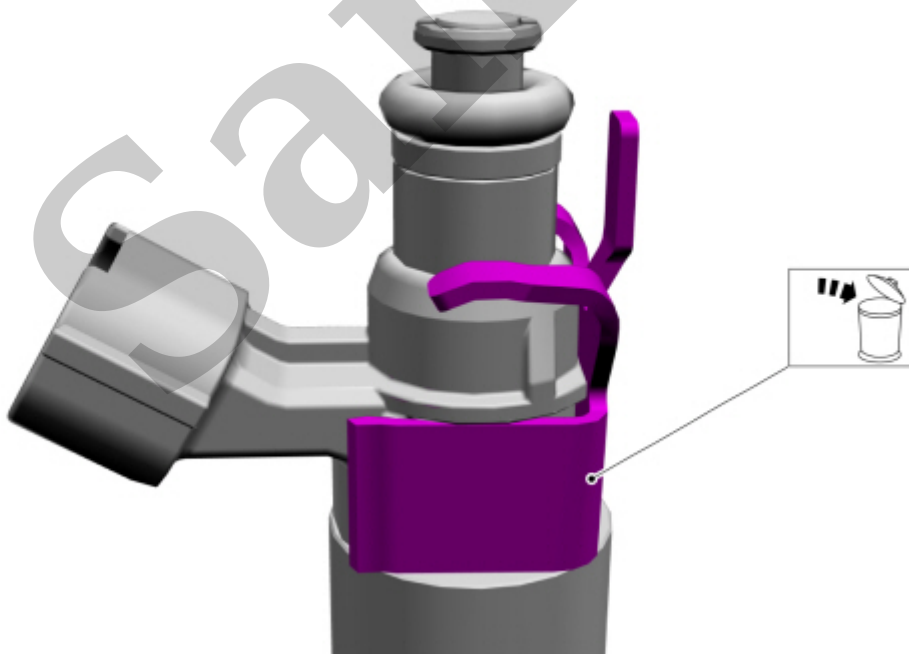

E257415

[Click here to learn about symbols, color coding, and icons used in this manual.](#)

18. **NOTICE**

1. **NOTICE**

Make sure to thoroughly clean any residual fuel or foreign material from the cylinder head, block and the general surrounding area of the fuel rails and injectors.

2. Using the special tool, clean the cylinder head fuel injector bores.

Use Special Service Tool : 310-205 Fuel Injector Brush

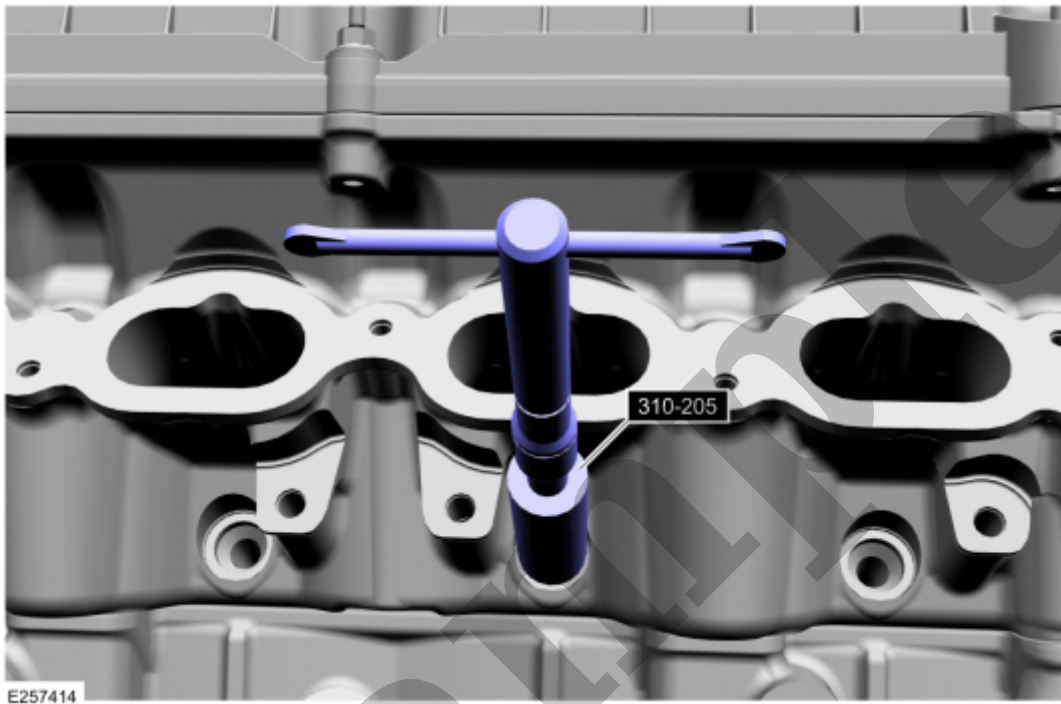

[Click here to learn about symbols, color coding, and icons used in this manual.](#)

20. 1. Remove and discard the fuel injector O-ring seals.

2. **NOTE**

Note the correct orientation of the fuel injector support rings for correct installation of the new fuel injector support rings.

Remove and discard the fuel injector support rings.

3. Inspect the inlet stopper, if it is damaged or comes off then discard the inlet stopper. The inlet stopper is not needed for proper function. Ensure that any debris from the inlet stopper are removed. If the inlet stopper is intact and undamaged do not remove the inlet stopper from the fuel injector.

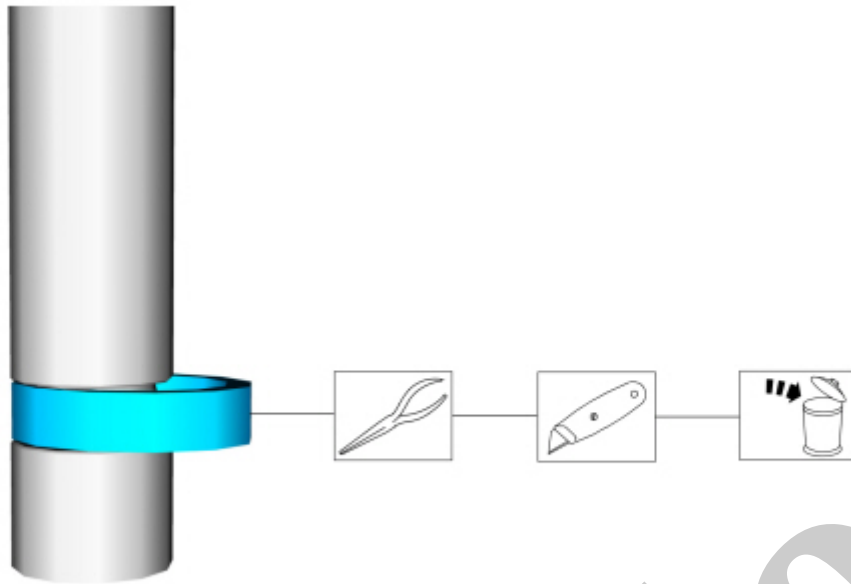

E168006

[Click here to learn about symbols, color coding, and icons used in this manual.](#)

Installation

1. NOTICE

Do not lubricate the new lower Teflon® fuel injector seals.

1. Install the Teflon® Seal Guide onto the fuel injector tip.

Use Special Service Tool : 310-207 Installer, Fuel Injector Seal Assembly

2. NOTICE

Once the Teflon® seal is installed on the Teflon® Seal Guide, it should immediately be installed onto the fuel injector to avoid excessive expansion of the Teflon® seal.

NOTE

Make sure that new lower fuel injector Teflon® seals are installed.

Install the new Teflon® seals onto the Teflon® Seal Guide, using the Pusher Tool, slide the Teflon® seals along the Teflon® Seal Guide.

2. Massage and warm the Teflon® seal with your fingers before the Teflon® seal sizer tool is installed. This will aid in installing the Teflon® seal sizer tool.
3. Position the Teflon® seal sizer tool with the larger opening towards the Teflon® seal. Push while turning the Teflon® seal sizer tool 180 degrees.

Use Special Service Tool : 303-1567 Sizer, Teflon Seal

4. Once the Teflon® seal sizer tool is installed, check and make sure the Teflon® seal is in the sizing portion of the Teflon® seal sizer tool.
5. After one minute, turn the Teflon® seal sizer tool back 180 degrees and remove.

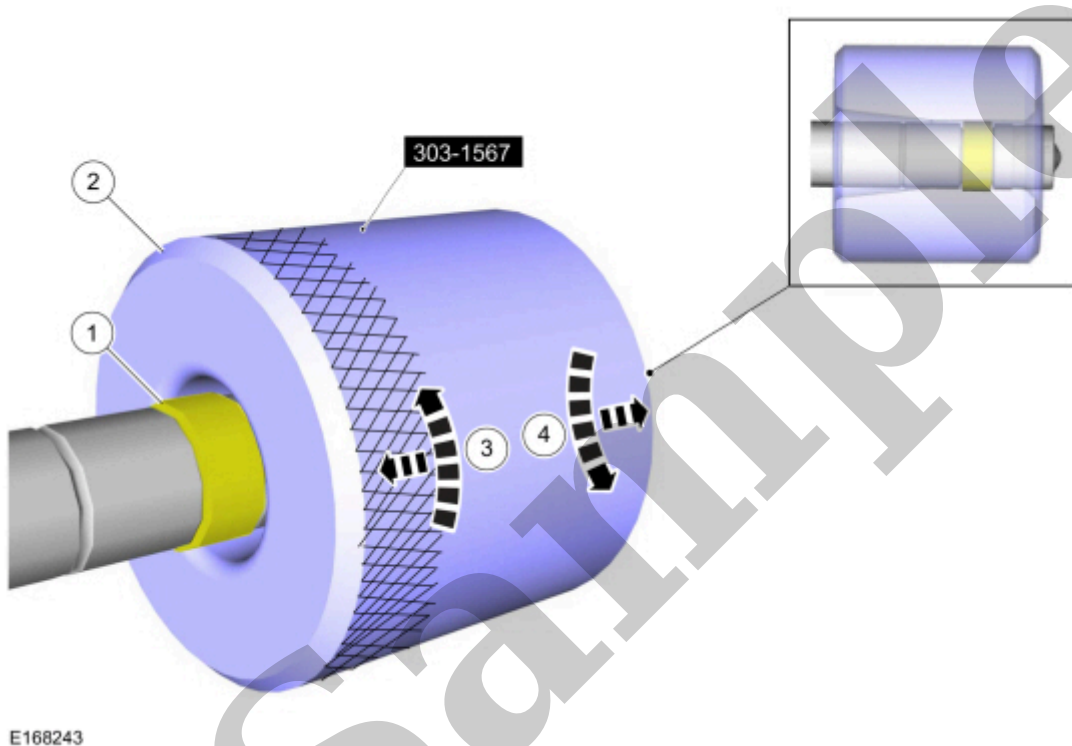

[Click here to learn about symbols, color coding, and icons used in this manual.](#)

3. NOTICE

Take care to prevent foreign substances from adhering to the O-ring or the seal surface.

NOTICE

Take care to prevent foreign substances from entering the fuel injector inlet.

[Click here to learn about symbols, color coding, and icons used in this manual.](#)

4. Install the new fuel injector clips.

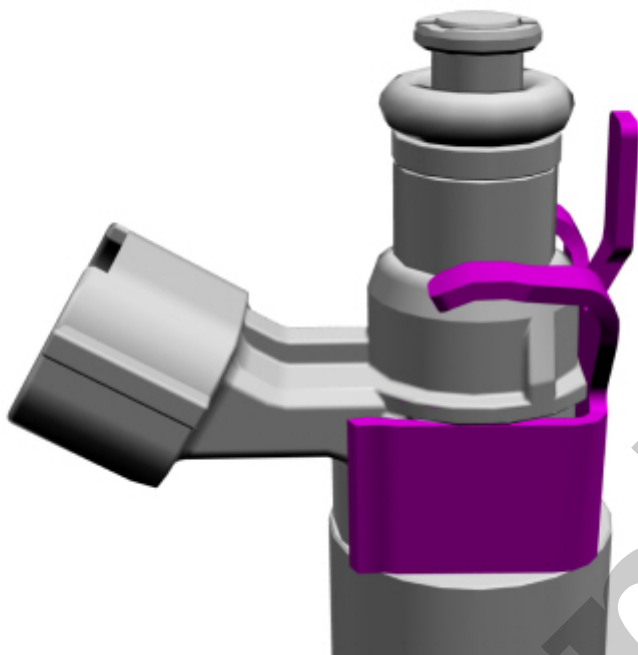

E257412

[Click here to learn about symbols, color coding, and icons used in this manual.](#)

5. NOTICE

Do not re-use a fuel injector if it is dropped. Any damage to the fuel injector may cause drivability concerns or catastrophic failure of the engine.

NOTE

The anti-rotation finger of the fuel injector clip must slip into the groove of the fuel rail cup.

Install the fuel injectors to the fuel rail, then connect the fuel injector electrical connectors.

7. 1. **NOTE**

Do not lubricate the new lower Teflon® fuel injector seals.

Install the fuel rail, push down on the fuel rail above the injectors.

2. Hand start all of the fuel rail bolts, finger tighten the fuel rail bolts so they are uniformly in light contact with fuel rail bosses.
3. Tighten the fuel rail bolts approximately 90 degrees, in the sequence shown. Repeat to evenly draw down the fuel rail, until the fuel rail bosses are in contact with the cylinder head.

Torque :

Stage 1: Tighten the fuel rail bolts in the sequence shown to : 89 lb.in (10 Nm)

Stage 2: Tighten the fuel rail bolts in the sequence shown to : 21 lb.ft (28 Nm)

Stage 3: Tighten the fuel rail bolts in the sequence shown an additional : 25°

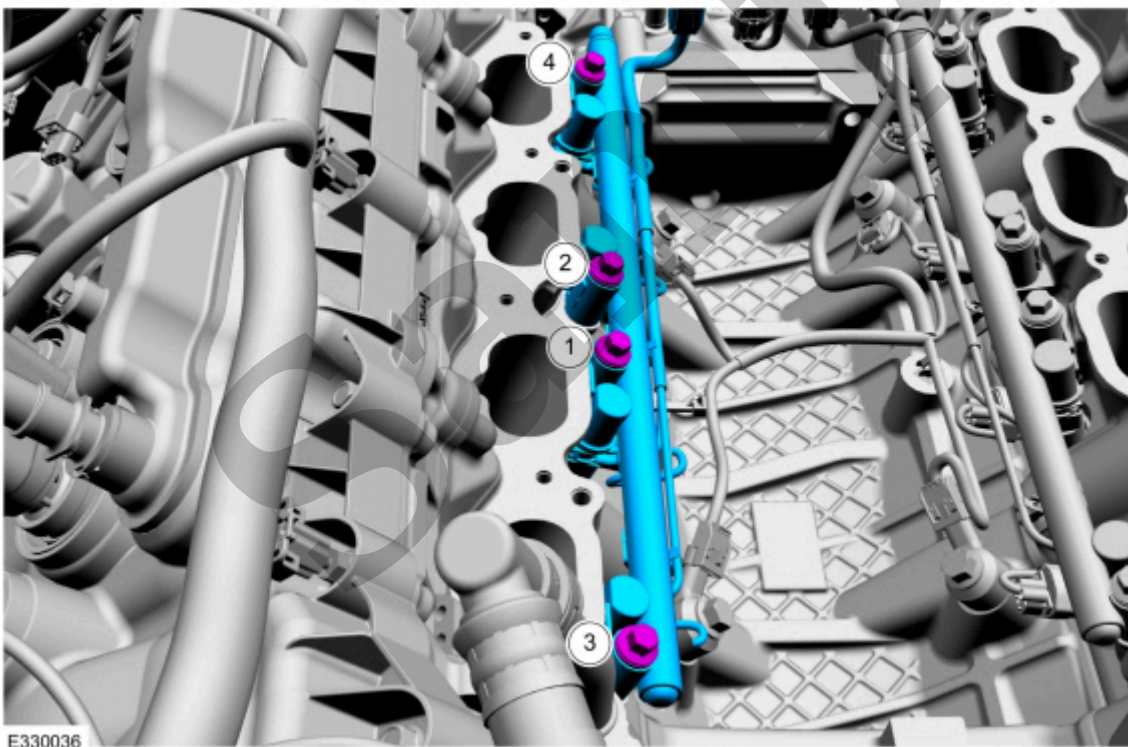

[Click here to learn about symbols, color coding, and icons used in this manual.](#)

8. **NOTE**

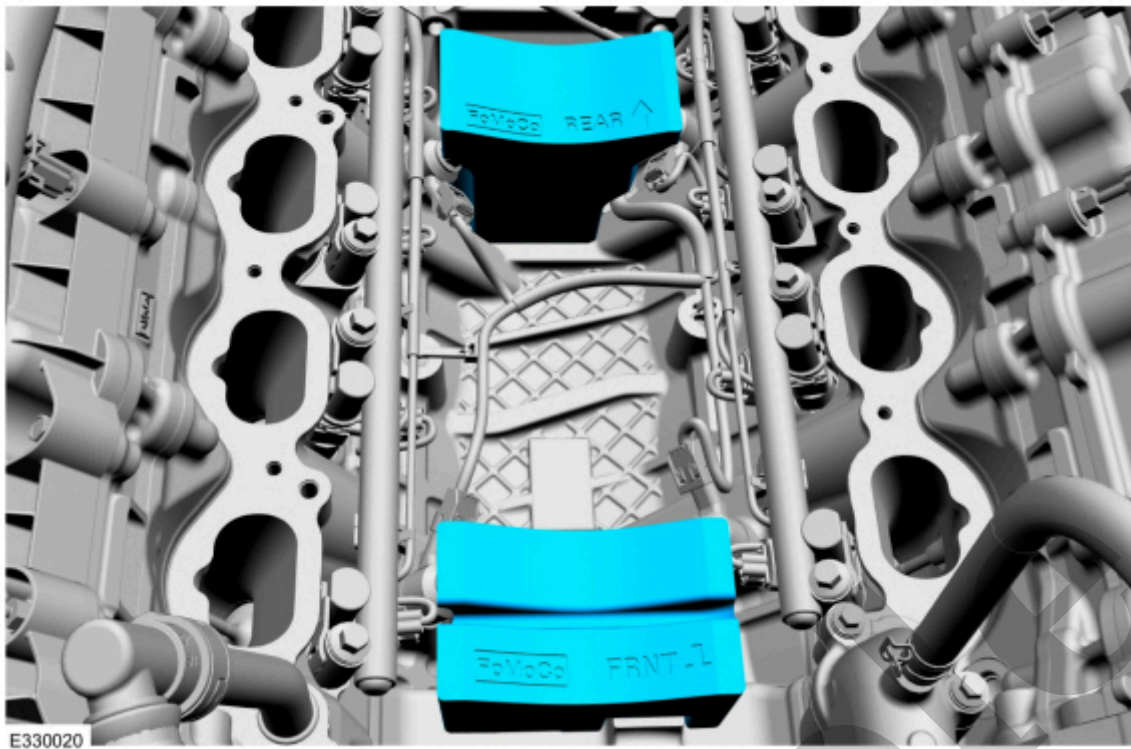

[Click here to learn about symbols, color coding, and icons used in this manual.](#)

10. NOTICE

In stage 7, if the torque required to tighten any flare nut on the new high-pressure fuel tube reaches or exceeds 37 lb.ft (50 Nm), then that high pressure fuel tube must be discarded and replaced with another new high-pressure fuel tube.

NOTICE

Do not use oil on the threads.

NOTE

Make sure that a new high-pressure fuel tube is installed.

1. Calculate the correct torque wrench setting for the following torque using the Torque Wrench Adapter Formulas.
2. Install the high-pressure fuel tube and retainers, tighten the high-pressure fuel tube flare nuts and retainers finger tight.

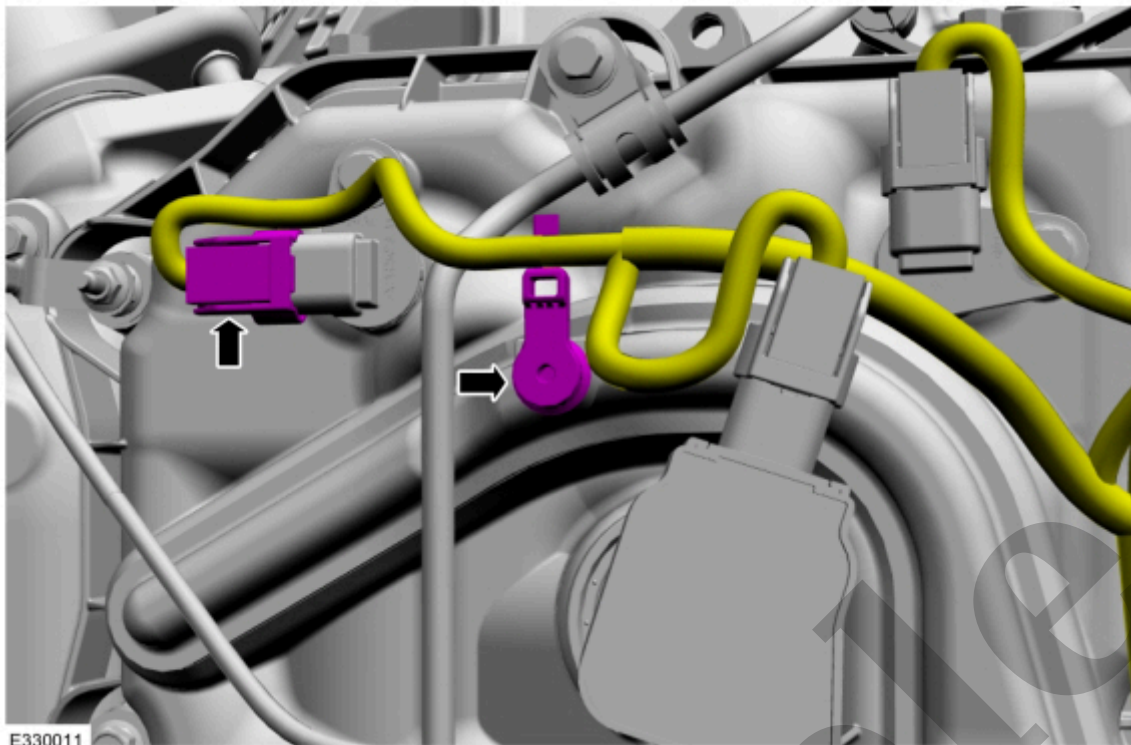

[Click here to learn about symbols, color coding, and icons used in this manual.](#)

12. Install the high-pressure fuel line shield, then install and tighten the high-pressure fuel line shield retainers.

Torque : 89 lb.in (10 Nm)

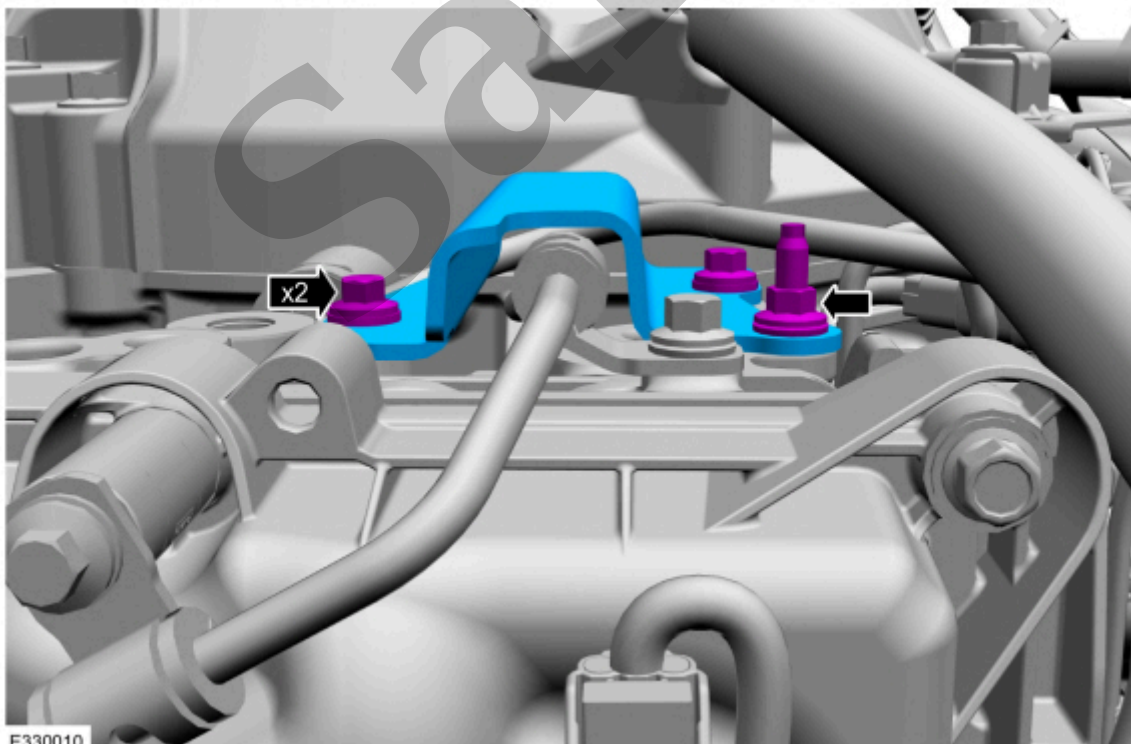

[Click here to learn about symbols, color coding, and icons used in this manual.](#)

15. **NOTE**

When removing or installing the fuel injection pump noise insulator, spreading the openings will reduce the risk of damage.

Install the fuel injection pump noise insulator, then engage the retainer.

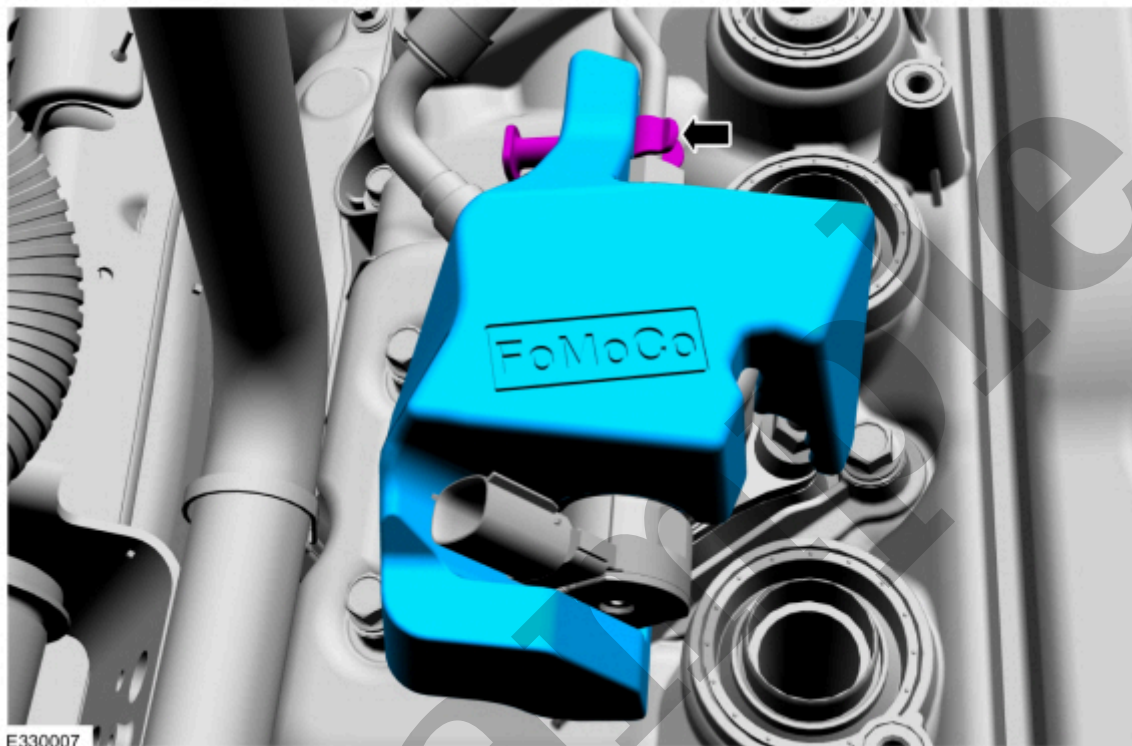

[Click here to learn about symbols, color coding, and icons used in this manual.](#)

16. Connect the high-pressure fuel pump electrical connector.