

Your Ultimate Source for OEM Repair Manuals

FactoryManuals.net is a great resource for anyone who wants to save money on repairs by doing their own work. The manuals provide detailed instructions and diagrams that make it easy to understand how to fix a vehicle.

2022 Toyota RAV4 Service and Repair Manual

[Go to manual page](#)

Last Modified: 07-26-2024

6.11:8.1.0

Doc ID: RM100000001JCIV

Model Year Start: 2020

Model: Supra

Prod Date Range: [03/2019 -]

Title: SUPPLEMENTAL RESTRAINT SYSTEMS: KNEE AIRBAG ASSEMBLY (for Driver Side): COMPONENTS; 2020 - 2025 MY Supra [03/2019 -]

COMPONENTS

ILLUSTRATION

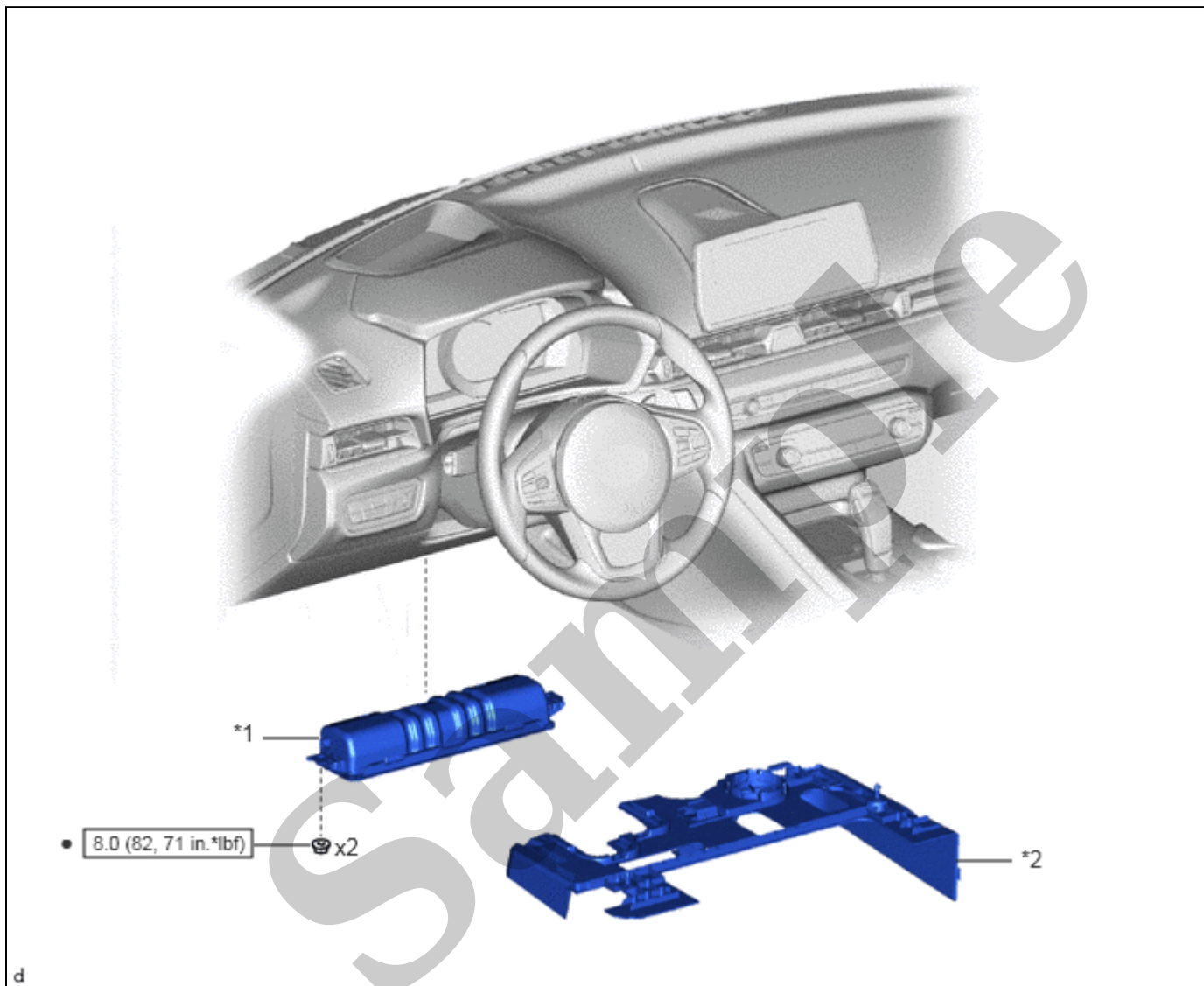

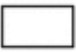
*1	LOWER NO. 2 INSTRUMENT PANEL AIRBAG ASSEMBLY	*2	NO. 1 INSTRUMENT PANEL UNDER COVER SUB-ASSEMBLY
	N*m (kgf*cm, ft.*lbf): Specified torque	•	Non-reusable part



- Clock settings, radio settings, audio system memory, DTCs and other data will be cleared when the cable is disconnected from the negative (-) battery terminal. Write down any necessary data before disconnecting the cable.

PROCEDURE

1. DISCONNECT CABLE FROM NEGATIVE BATTERY TERMINAL

Click here [INFO](#)

CAUTION:

- Wait at least 60 seconds after disconnecting the cable from the negative (-) battery terminal to disable the SRS system.
- If the airbag deploys for any reason, it may cause a serious accident.

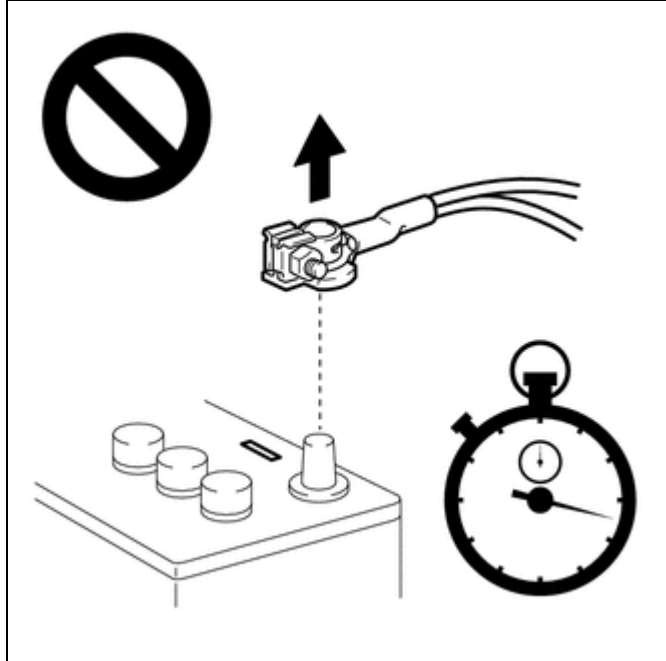

2. REMOVE NO. 1 INSTRUMENT PANEL UNDER COVER SUB-ASSEMBLY

Click here [INFO](#)

3. REMOVE LOWER NO. 2 INSTRUMENT PANEL AIRBAG ASSEMBLY

CAUTION:

- Airbag unit.

Danger! Life-threatening injuries!

- Before performing any work on the airbag, always disconnect the battery earth lead from the battery.
- Airbag unit may only be set down with the cushion (airbag itself) facing upwards.
- For additional information see:

Click here [INFO](#)

(a) Check that the START-STOP button (engine switch) off.

HINT:

Pressing and holding the AUDIO button changes the power source mode to IG OFF.

Last Modified: 07-26-2024	6.11:8.1.0	Doc ID: RM100000001R9LF
Model Year Start: 2021	Model: Supra	Prod Date Range: [07/2020 -]
Title: SUPPLEMENTAL RESTRAINT SYSTEMS: KNEE AIRBAG ASSEMBLY (for Driver Side): REMOVAL; 2021 - 2025 MY Supra [07/2020 -]		

REMOVAL

CAUTION / NOTICE / HINT

CAUTION:

- Airbag unit.

Danger! Life-threatening injuries!



- Before performing any work on the airbag, always disconnect the battery earth lead from the battery.
- Airbag unit may only be set down with the cushion (airbag itself) facing upwards.

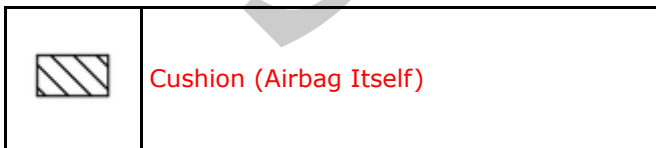

- All work on pyrotechnic parts may be carried out by technically experienced and appropriately trained personnel only.
- Replace any damaged part or ones that have been dropped.
- For additional information see:

Click here [INFO](#)

- Wait at least 60 seconds after disconnecting the cable from the negative (-) battery terminal to disable the SRS system.
- If the airbag deploys for any reason, it may cause a serious accident.

NOTICE:

- Before performing work on electronic components, disconnect the cable from the negative (-) battery terminal to prevent damage to the electrical system or components.
- When disconnecting the cable, turn the START-STOP button (engine switch) and headlight switch off and loosen the cable nut completely. Perform these operations without twisting or prying on the cable. Then disconnect the cable.

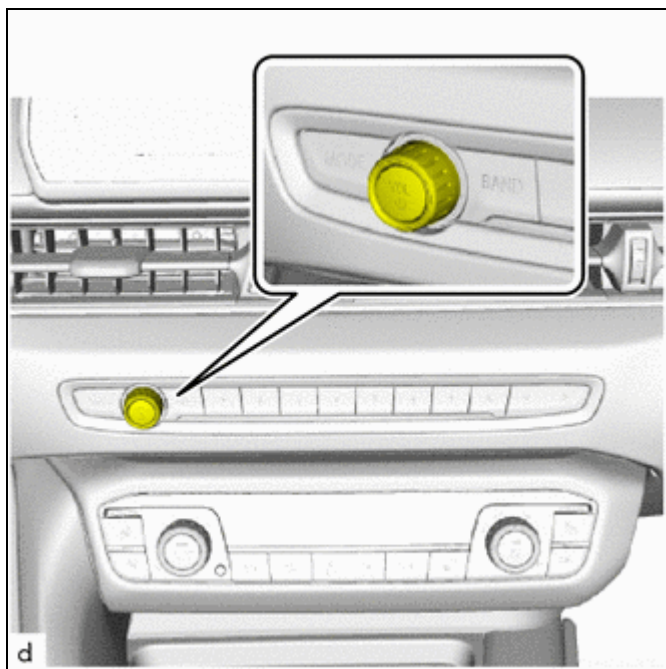

(b) Check that the cable is disconnected from the negative (-) battery terminal.

CAUTION:

- Wait at least 60 seconds after disconnecting the cable from the negative (-) battery terminal to disable the SRS system.
- If the airbag deploys for any reason, it may cause a serious accident.

(c) Unlock the plug connection (1) and disconnect.

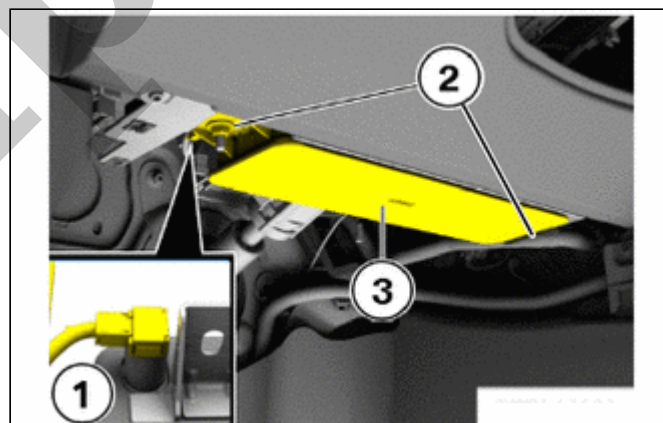

(d) Loosen the nuts (2) and remove the lower No. 2 instrument panel airbag assembly (3).

