

Your Ultimate Source for OEM Repair Manuals

FactoryManuals.net is a great resource for anyone who wants to save money on repairs by doing their own work. The manuals provide detailed instructions and diagrams that make it easy to understand how to fix a vehicle.

2021 Toyota Prius Service Manual

[Go to manual page](#)

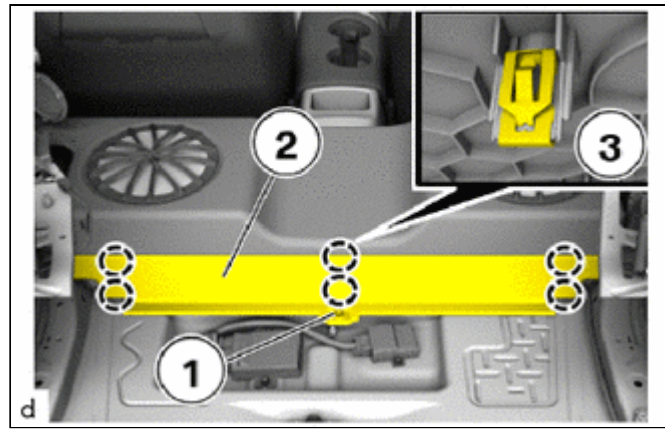

(b) Detach the clips (3) to remove the luggage compartment trim rear cover (2).

21. REMOVE FRONT DOOR SCUFF PLATE LH

Click here [INFO](#)

22. REMOVE FRONT DOOR SCUFF PLATE RH

HINT:

Use the same procedure as for the LH side.

23. REMOVE QUARTER TRIM LOWER PANEL LH

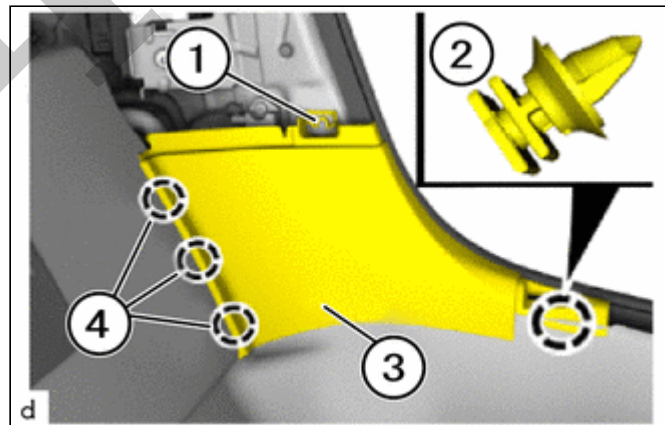

(a) Loosen nut (1).

(b) Using a clip remover, detach the clip (2).

(c) Remove the quarter trim lower panel LH (3) from the guides (4) to the top.

24. REMOVE QUARTER TRIM LOWER PANEL RH

HINT:

Use the same procedure as for the LH side.

25. REMOVE REAR NO. 3 SPEAKER ASSEMBLY (for 12 Speakers)

Click here [INFO](#)

26. REMOVE REAR NO. 2 SPEAKER ASSEMBLY (for 10 Speakers)

HINT:

Use the same procedure as for the No. 3 speaker.

27. REMOVE CHILD RESTRAINT SEAT COVER

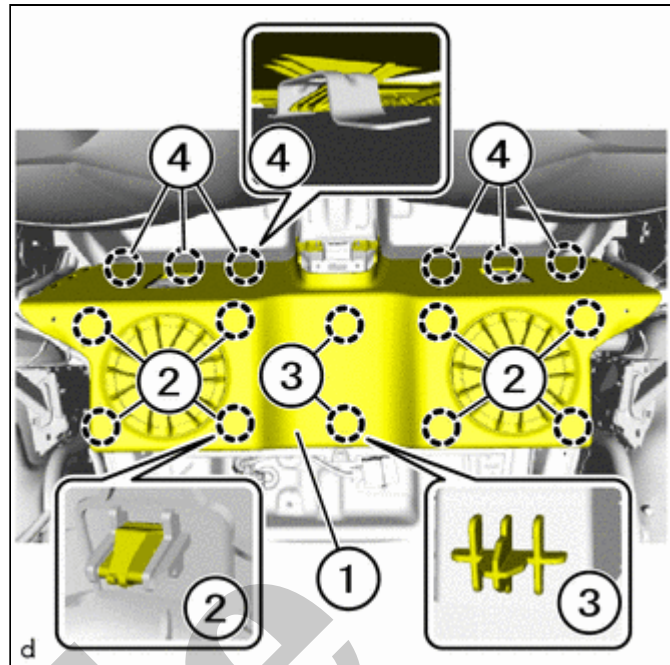

29. REMOVE REAR SPEAKER ASSEMBLY

HINT:

- Use the same procedure for the RH side and LH side.
- The following procedure is for the LH side.

(a) Unlock plug connection (1) and disconnect.

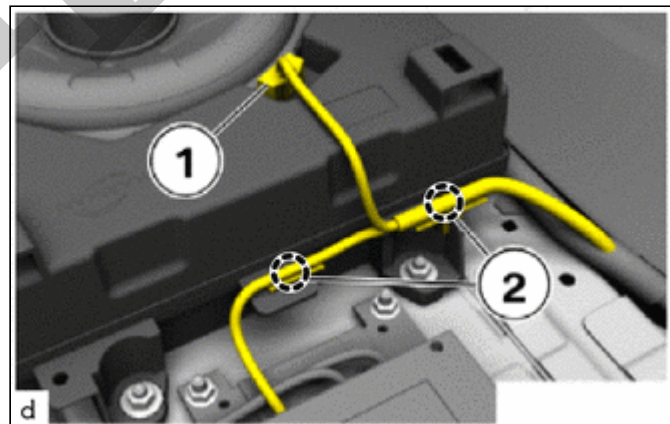

(b) Detach the clamps (2).

(c) Loosen nuts (1).

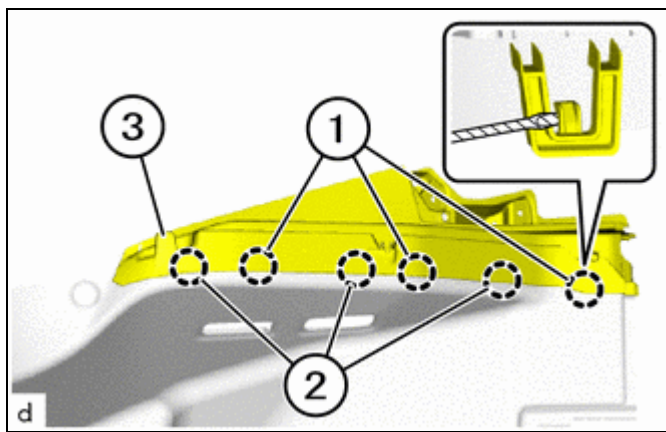

(b) Detach the guides (2) to remove the deck side trim cover LH (3) from the deck trim side board LH.

33. REMOVE DECK SIDE TRIM COVER RH

HINT:

- Perform this procedure only when replacement of the deck side trim cover RH is necessary.
- Use the same procedure as for the LH side.

34. REMOVE ROOM PARTITION BAND ASSEMBLY (w/ Courtesy Light)

HINT:

Perform this procedure only when replacement of the room partition band assembly is necessary.

(a) Using a molding remover A, detach the claws (1) and guides (2) to remove the room partition band assembly (3) .

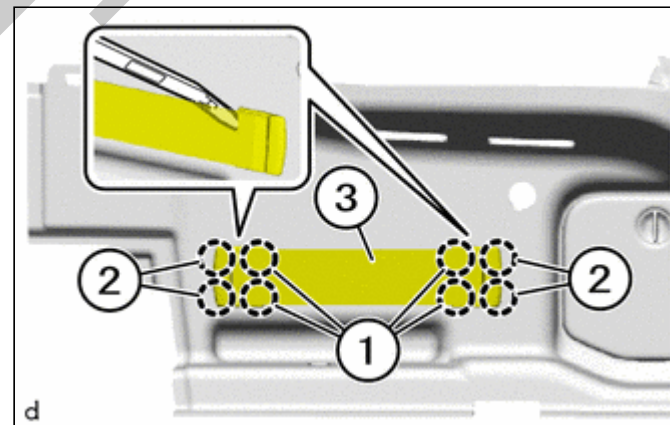

35. REMOVE ROOM PARTITION NET ASSEMBLY (w/ Courtesy Light)

HINT:

Perform this procedure only when replacement of the room partition net assembly is necessary.

(a) Using a clip remover, detach the clip (1).

37. REMOVE PIVOT MOUNTING SUPPORT LH

HINT:

Perform this procedure only when replacement of the pivot mounting support LH is necessary.

(a) Remove the bolts (1) and pivot mounting support LH (2).

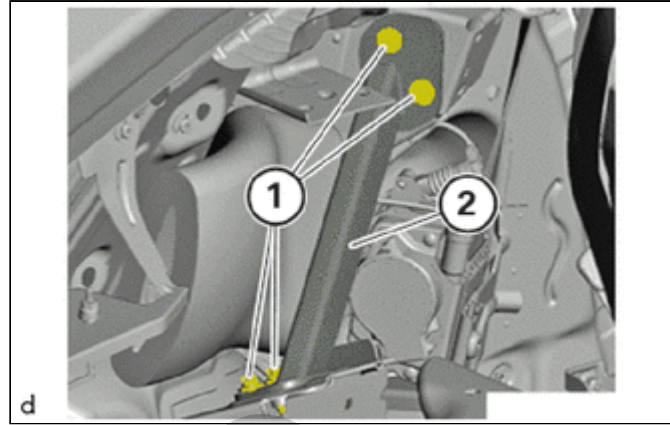

38. REMOVE PIVOT MOUNTING SUPPORT RH

HINT:

- Perform this procedure only when replacement of the pivot mounting support RH is necessary.
- Use the same procedure as for the LH side.

