

# Your Ultimate Source for OEM Repair Manuals

FactoryManuals.net is a great resource for anyone who wants to save money on repairs by doing their own work. The manuals provide detailed instructions and diagrams that make it easy to understand how to fix a vehicle.

## 2018 MAZDA MX-5 / Miata RF OEM Service and Repair Workshop Manual

[Go to manual page](#)

PREPARE VEHICLE AS FOLLOWS

- APPLY PARKING BRAKE (PARKING BRAKE SWITCH: ON)
- SWITCH IGNITION ON (ENGINE OFF).
- SWITCH LIGHT SWITCH TO OFF POSITION.
- SWITCH HAZARD WARNING SWITCH TO OFF.

WAIT FOR 2 s OR MORE.

DEPRESS BRAKE PEDAL.

**NOTE**

• CONTINUE DEPRESSING BRAKE PEDAL UNTIL WORK IS COMPLETED.

WITHIN 2 s

WITHIN 5 s, PERFORM FOLLOWING LIGHT SWITCH OPERATION 5 TIMES REPEATEDLY, AND THEN SWITCH IT TO OFF POSITION.

OFF → TNS\* → OFF → TNS\* → OFF → TNS\* → OFF → TNS\* → OFF → TNS\* → OFF

1 TIME      2 TIMES      3 TIMES      4 TIMES      5 TIMES

WITHIN 2 s

WITHIN 5 s, PERFORM FOLLOWING HAZARD WARNING SWITCH OPERATION 5 TIMES REPEATEDLY, AND THEN SWITCH IT TO OFF.

OFF → ON → OFF → ON → OFF → ON → OFF → ON → OFF → ON → OFF

1 TIME      2 TIMES      3 TIMES      4 TIMES      5 TIMES

WITHIN 2 s

WITHIN 5 s, PERFORM FOLLOWING LIGHT SWITCH OPERATION 5 TIMES REPEATEDLY, AND THEN SWITCH IT TO OFF POSITION.

OFF → TNS\* → OFF → TNS\* → OFF → TNS\* → OFF → TNS\* → OFF → TNS\* → OFF

1 TIME      2 TIMES      3 TIMES      4 TIMES      5 TIMES

WAIT FOR 5 s OR MORE.

SWITCH IGNITION ON (ENGINE ON).

DRIVE THE VEHICLE AT 3 km/h {2 mph} OR MORE TO VERIFY THAT THE DRL SETTING WAS CHANGED.

DID DRL SWITCH FROM OFF TO ON, OR FROM ON TO OFF?

No

Yes

COMPLETED

\* : TNS (PARKING LIGHTS)

ac5uuw00005408

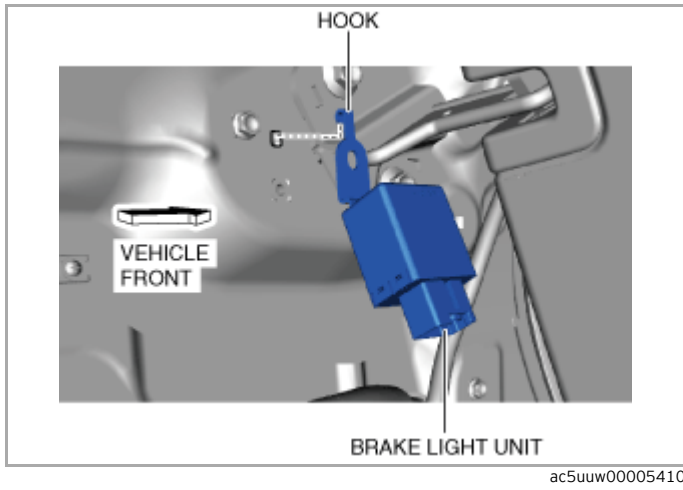

6. Install in the reverse order of removal.

LIGHTING SYSTEMS LOCATION INDEX

SM2899512

id09180080010

Exterior

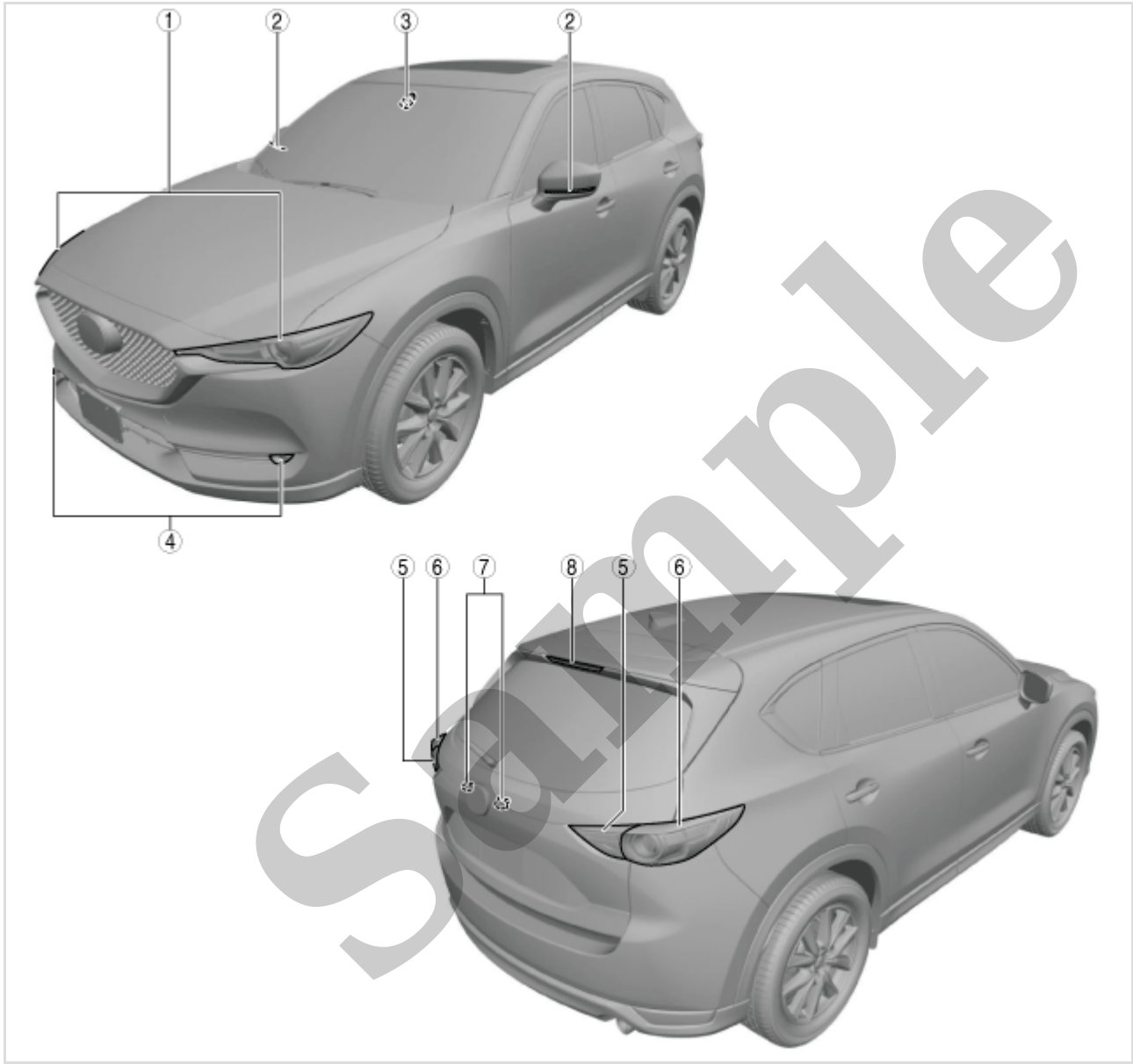

ac5uuw00005411

1	Front combination light (See FRONT COMBINATION LIGHT REMOVAL/INSTALLATION.) (See FRONT COMBINATION LIGHT DISASSEMBLY/ASSEMBLY.) (See HEADLIGHT BULB REMOVAL/INSTALLATION.) (See HEADLIGHT AIMING.) (See HEADLIGHT LEVELING ACTUATOR INSPECTION.) (See DRL (DAYTIME RUNNING LIGHT) BULB REMOVAL/INSTALLATION.) (See PARKING LIGHT BULB REMOVAL/INSTALLATION.) (See FRONT SIDE MARKER LIGHT BULB REMOVAL/INSTALLATION.) (See FRONT TURN LIGHT BULB REMOVAL/INSTALLATION.) (See LIGHTING SYSTEM PERSONALIZATION FEATURES SETTING PROCEDURE.)
---	---



# HEADLIGHT AIMING

SM2899513

id09180080040

## Note

- When the vehicle attitude angle changes with the ignition switched off and the ignition is switched ON under this condition, the optical axis may be temporarily deviated. The optical axis deviation is corrected by driving the vehicle approx. 2 km {1 mile} to 9 km {6 mile}.
- If the following servicing is done, perform the headlight aiming adjustment.
  - Front combination light replacement
  - Suspension replacement and removal/installation, servicing requiring vehicle height to be changed
- If servicing was done which changes the vehicle height, perform the headlight auto leveling system initialization first to record the vehicle height under the unloaded condition to the auto leveling control module/AFS control module, then perform headlight aiming. (See **HEADLIGHT AUTO LEVELING SYSTEM INITIALIZATION**.)

1. Empty the vehicle except for the spare tire, jack and vehicle tools.

2. Adjust the tire pressure to the specification. (See **WHEEL AND TIRE SPECIFICATION**.)

3. Move the vehicle to level ground.

4. Verify the headlight auto leveling system operation.

- Sit on the rear seat to verify that the leveling operates.
  - If it operates, go to the next step.
  - If it does not operate, refer to the "THE HEADLIGHT AUTO LEVELING SYSTEM DOES NOT OPERATE IN RESPONSE TO VEHICLE POSTURE". (See **THE HEADLIGHT AUTO LEVELING SYSTEM DOES NOT OPERATE IN RESPONSE TO VEHICLE POSTURE [HEADLIGHT AUTO LEVELING SYSTEM]**.)

5. Make an adjustment-use screen as shown in the figure using double-weight, white paper.

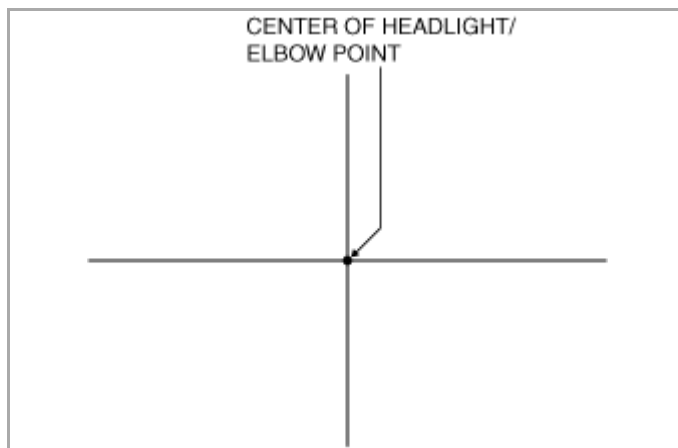

ac5uuw00005413

# HEADLIGHT BULB REMOVAL/INSTALLATION

SM2899514

id09180080050

## Note

- Because the headlight is an LED type, it is integrated with the front combination light.
- When replacing the headlight, replace the front combination light. (See **FRONT COMBINATION LIGHT REMOVAL/INSTALLATION.**)

Sample

# CARGO COMPARTMENT LIGHT REMOVAL/INSTALLATION

SM2899518

id09180080170

1. Disconnect the negative battery terminal. (See [NEGATIVE BATTERY TERMINAL DISCONNECTION/CONNECTION.](#))

## Caution

- When inserting the remover tool in the gap between the cargo compartment light and the liftgate lower trim, the remover tool could interfere with the liftgate lower trim and scratch or damage it. When removing the cargo compartment light from the liftgate lower trim, apply protective tape to the liftgate lower trim.

2. To prevent scratches or damage, affix protective tape to the position shown in the figure.

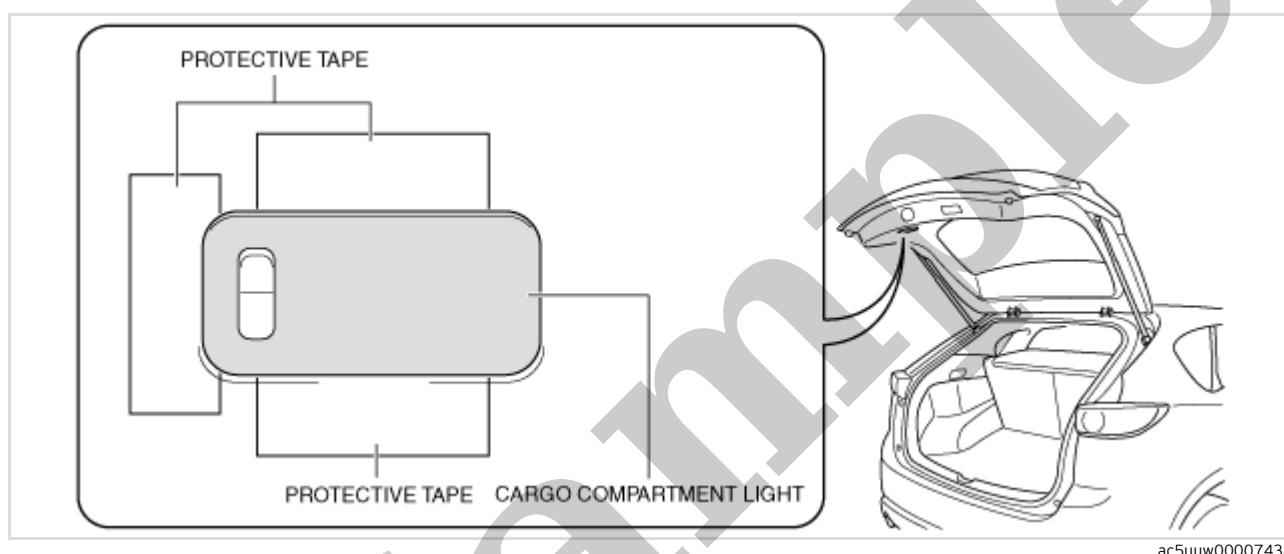

3. While pressing tabs A of the cargo compartment light using the remover tool, pull out the cargo compartment light in the direction of arrows (1) to detach tabs A of the cargo compartment light from the liftgate lower trim.

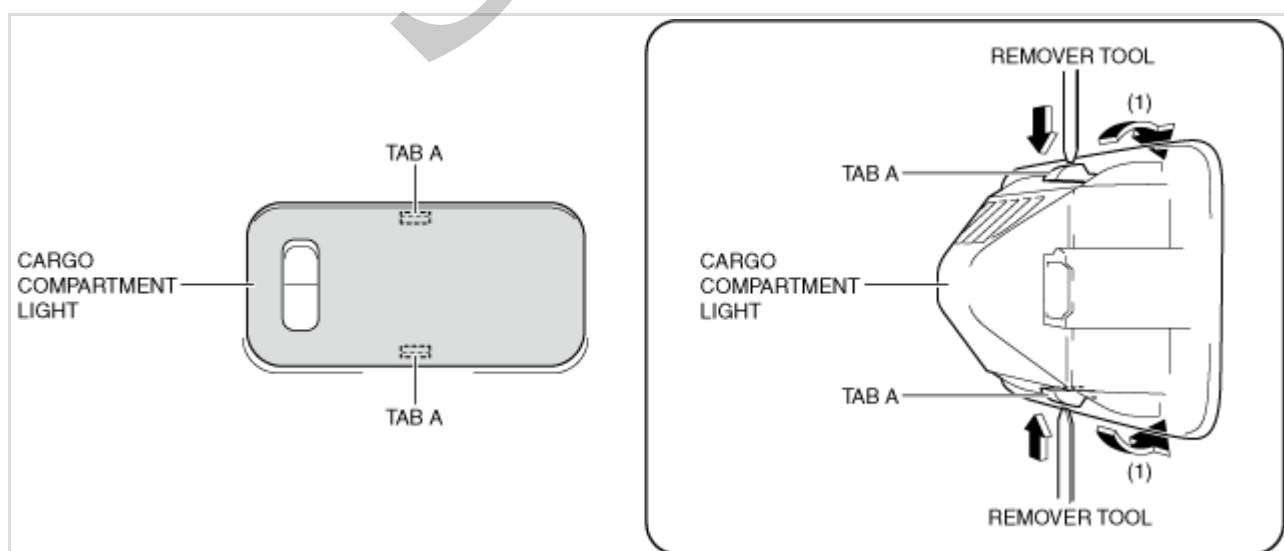

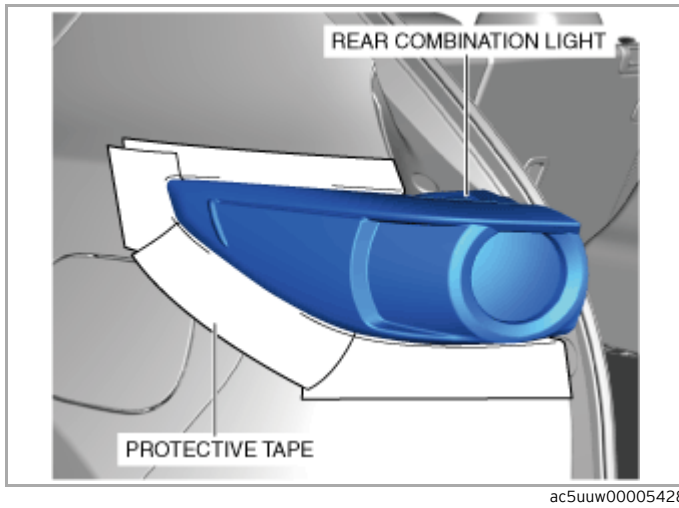

7. Pull the rear combination light in the direction of arrow (1) shown in the figure and pull out the rear combination light from the body.

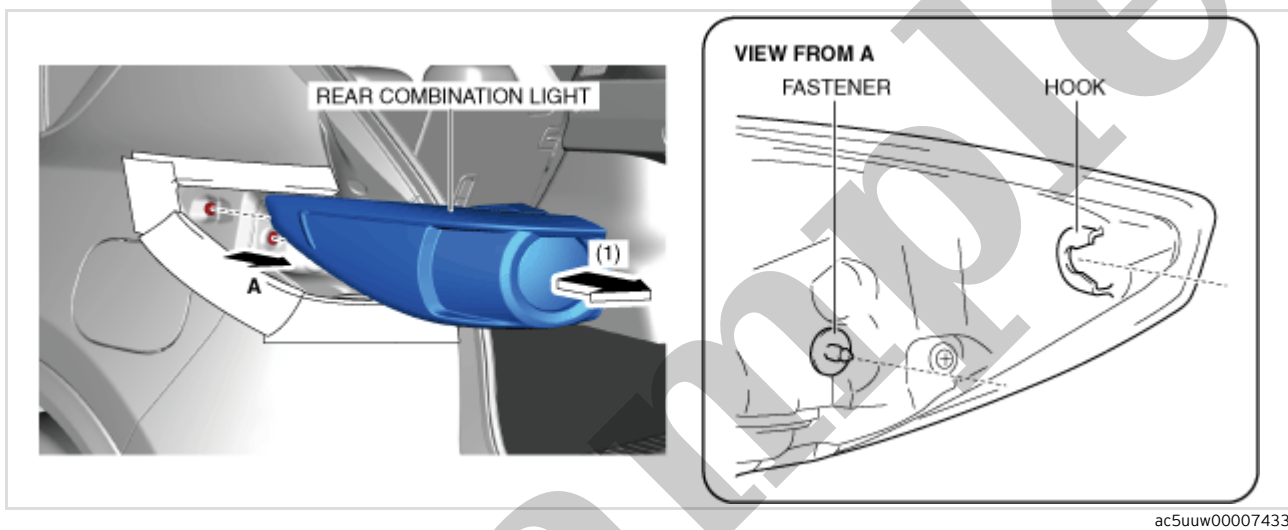

8. Remove the clip from the rear combination light.



9. Turn the socket counterclockwise and remove it in the direction of arrow (1) shown in the figure.

10. Turn the socket counterclockwise and remove it in the direction of arrow (1) shown in the figure. (Bulb type)

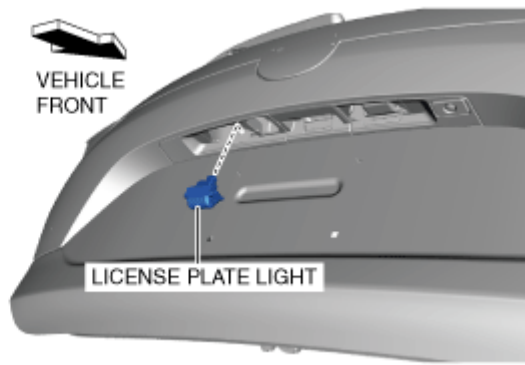
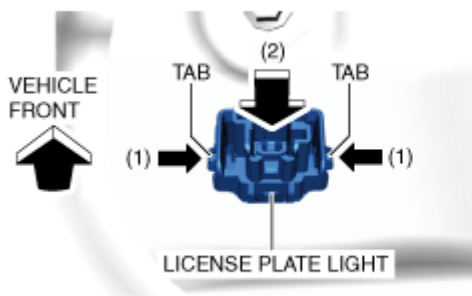

ac5uuw00005436

5.Remove the license plate light.

6.Install in the reverse order of removal.

# FRONT FOG LIGHT REMOVAL/INSTALLATION

SM2899522

id09180080210

1. Disconnect the negative battery terminal. (See [NEGATIVE BATTERY TERMINAL DISCONNECTION/CONNECTION.](#))
2. Partially peel back the front under cover No.1. (See [FRONT UNDER COVER No.1 REMOVAL/INSTALLATION.](#))
3. Partially peel back the front mudguard. (See [MUDGUARD REMOVAL/INSTALLATION.](#))
4. Disconnect the connectors.

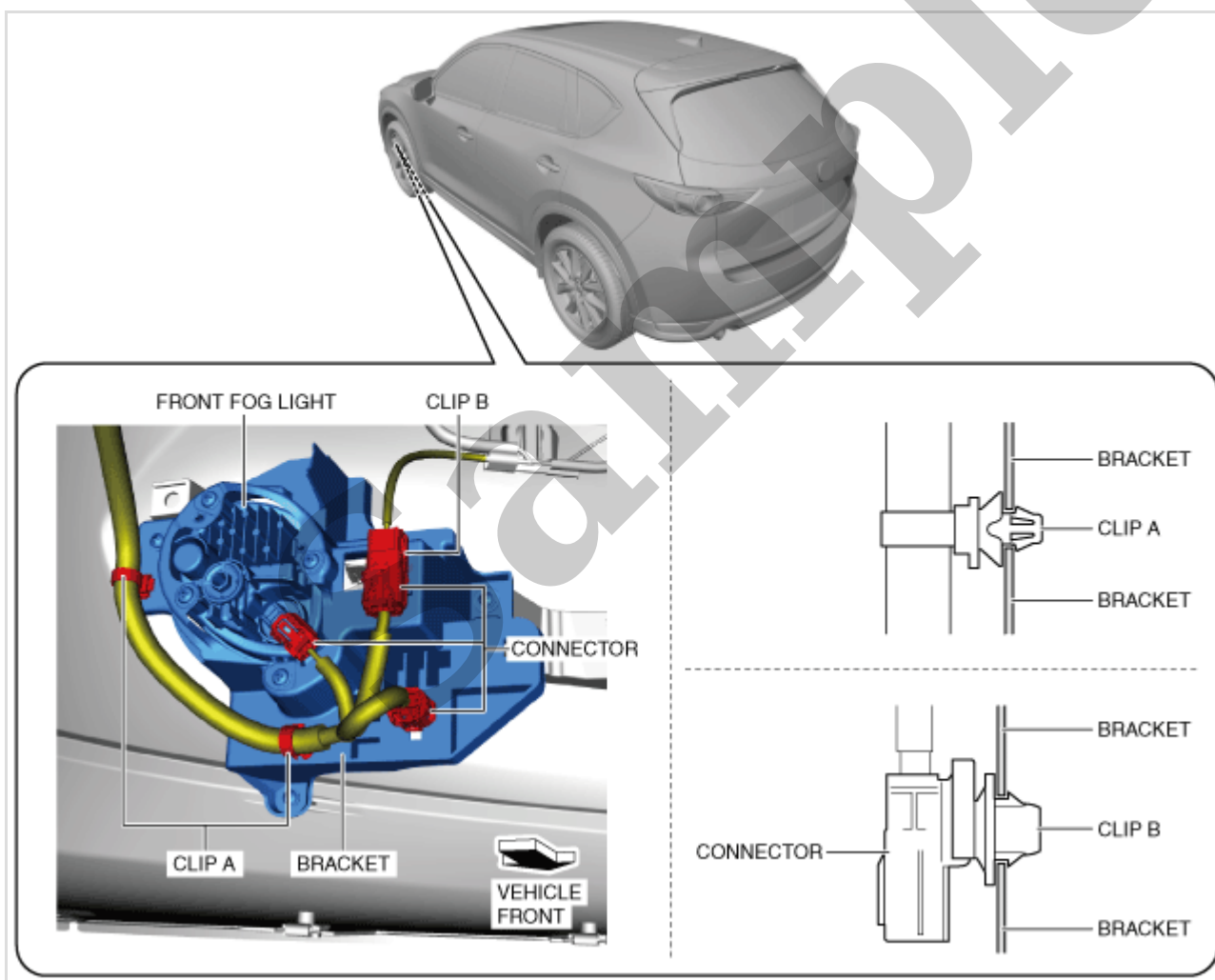

ac5uuw00007439

5. Remove the clips.
6. Remove the screws.