

Your Ultimate Source for OEM Repair Manuals

FactoryManuals.net is a great resource for anyone who wants to save money on repairs by doing their own work. The manuals provide detailed instructions and diagrams that make it easy to understand how to fix a vehicle.

2018 Mazda 6 Service and Repair Manual

[Go to manual page](#)

7. Partially peel back the dashboard lower insulator and insert a tape-wrapped flathead screwdriver into the position shown in the figure.

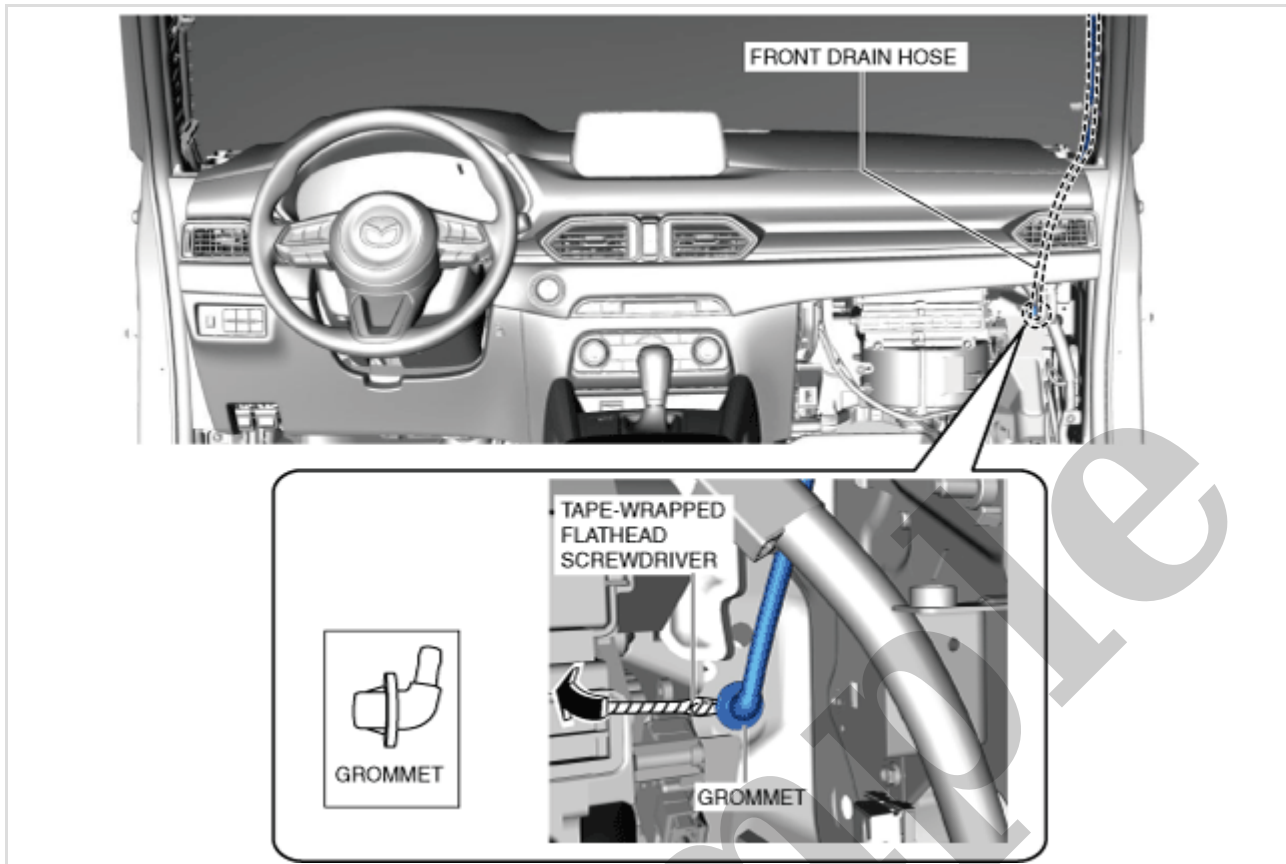

8. Move the tape-wrapped flathead screwdriver in the direction of the arrow shown in the figure and remove the grommet.

9. Pull the front drain hose from the A-pillar side and pull it out in the direction of the arrow shown in the figure.

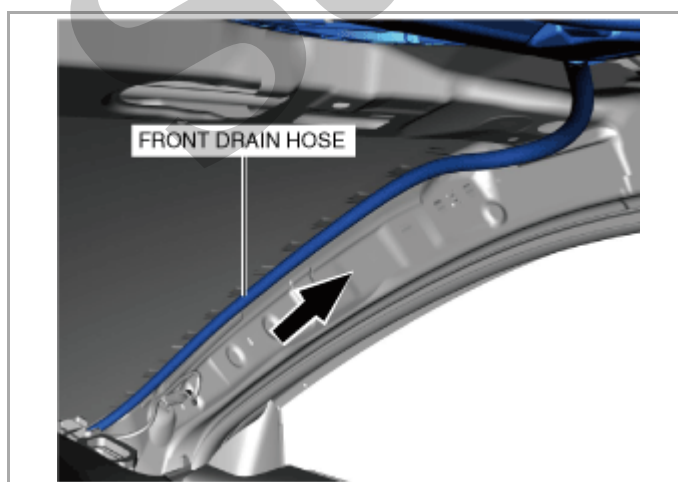

10. Install in the reverse order of removal.

SUNROOF LOCATION INDEX

SM2899411

id09150080010

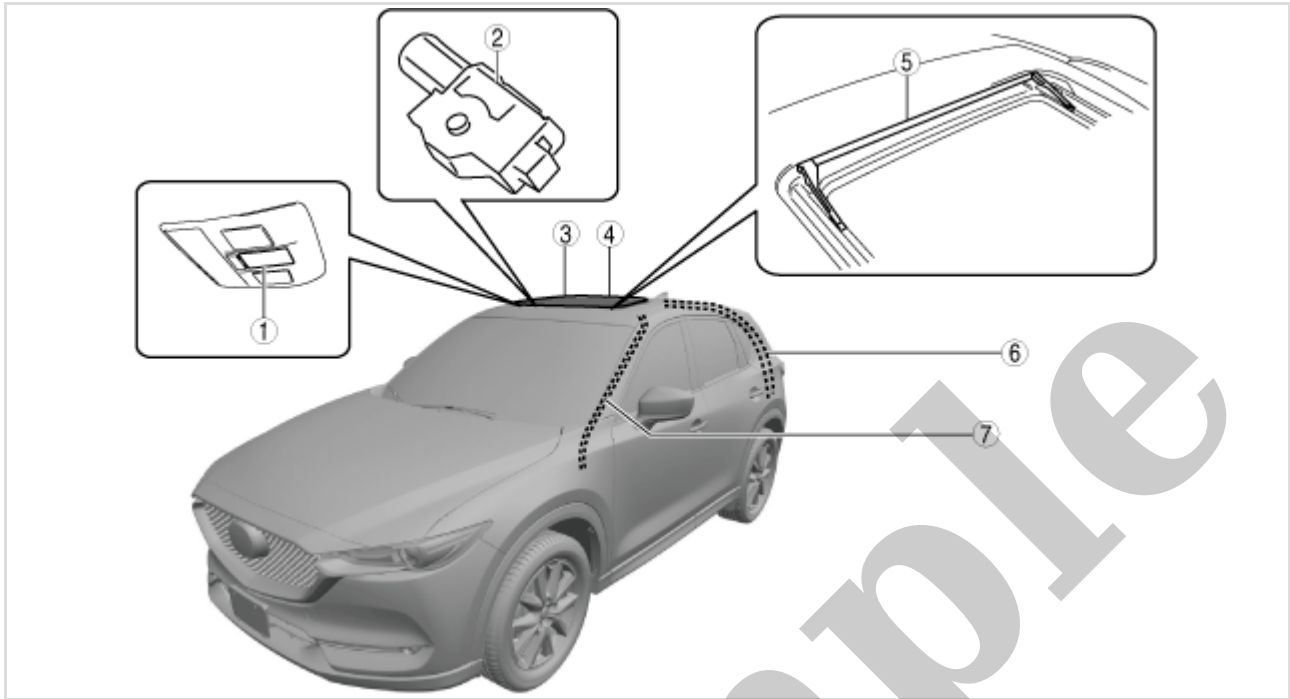

ac5uuw00006582

1	Sunroof switch (See SUNROOF SWITCH REMOVAL/INSTALLATION.) (See SUNROOF SWITCH INSPECTION.) (See SUNROOF SYSTEM INITIALIZATION PROCEDURE.)
2	Sunroof motor (See SUNROOF MOTOR REMOVAL/INSTALLATION.) (See SUNROOF MOTOR INSPECTION.)
3	Glass panel (See GLASS PANEL REMOVAL/INSTALLATION.) (See GLASS PANEL ADJUSTMENT.)
4	Sunroof unit (See SUNROOF UNIT REMOVAL/INSTALLATION.) (See SUNROOF UNIT DISASSEMBLY/ASSEMBLY.)
5	Deflector (See DEFLECTOR REMOVAL/INSTALLATION.)
6	Rear drain hose (See REAR DRAIN HOSE REMOVAL/INSTALLATION.)
7	Front drain hose (See FRONT DRAIN HOSE REMOVAL/INSTALLATION.)

LH

RH

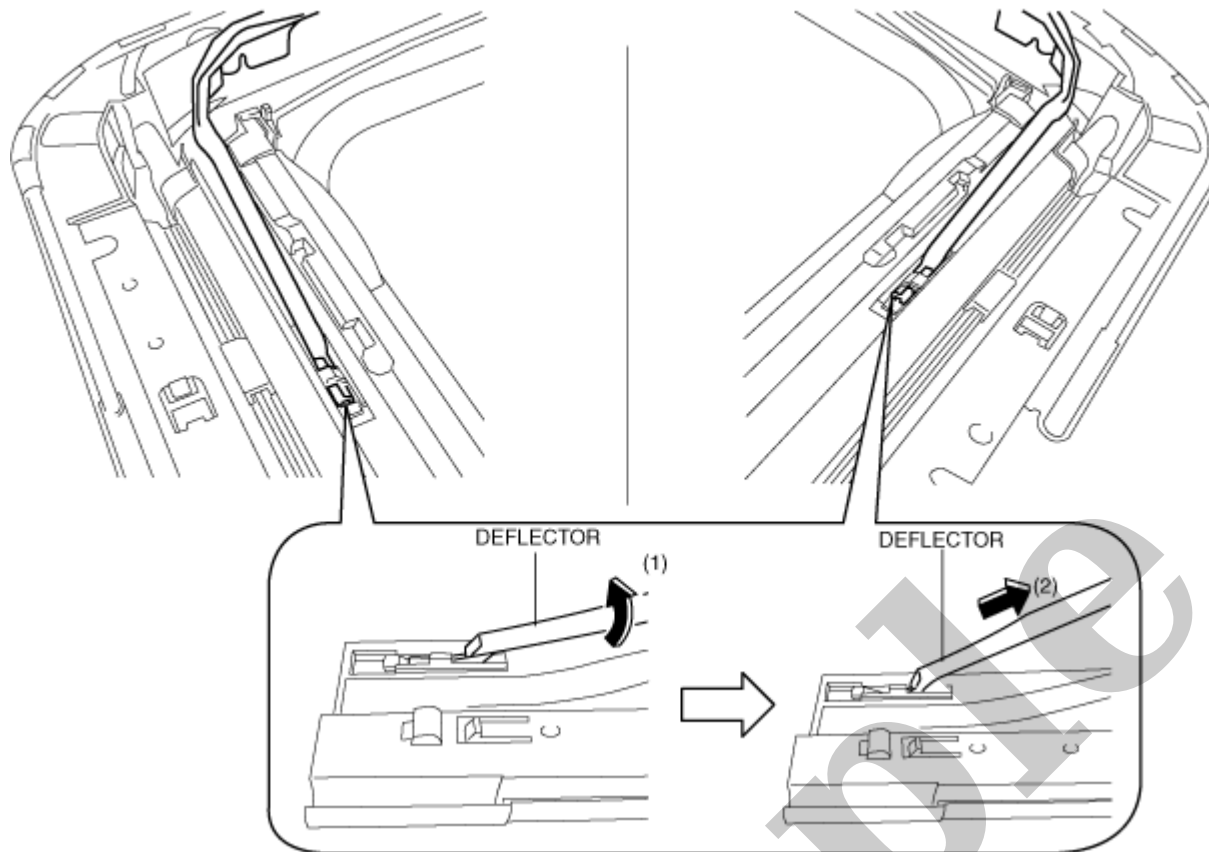

ac5uuw00010062

4. Install in the reverse order of removal.

SUNROOF UNIT DISASSEMBLY/ASSEMBLY

SM2899418

id09150080080

1.Disassemble in the order indicated in the table.

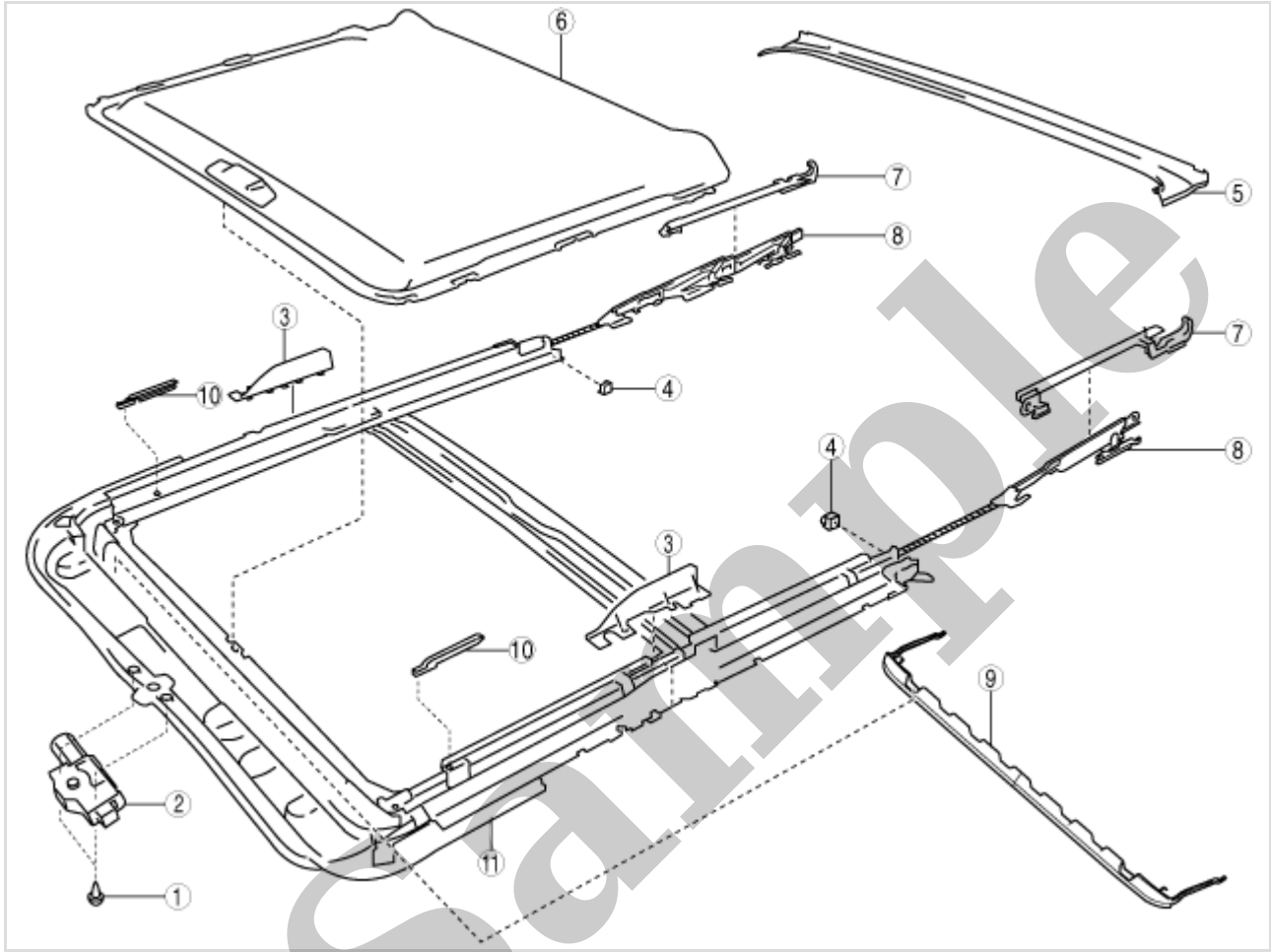

ac5uuw00009417

1	Screw
2	Sunroof motor
3	Screen
4	Rear stopper
5	Drip rail
6	Sunshade (See Sunshade Disassembly Note.)
7	Front guide (See Front Guide Disassembly Note.)
8	Decoration link
9	Deflector
10	Set plate
11	Sunroof frame

2.Assemble in the reverse order of disassembly.

1. Install the weatherstrip to the glass panel with the joint part of the weatherstrip assembled to the vehicle rear side.

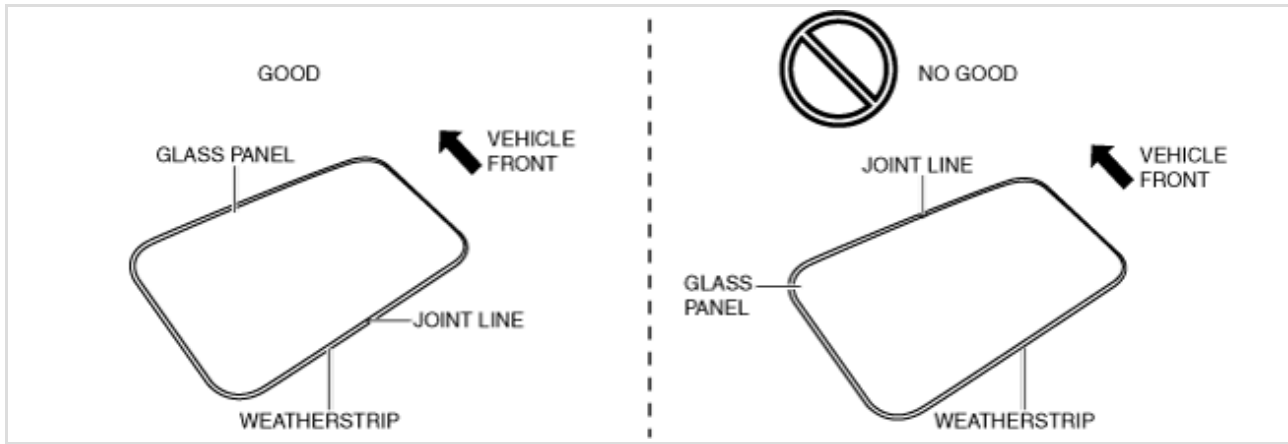

ac5uuw00010064

Sample

Terminal	Signal	Connected to	Test condition	Voltage (V)	Inspection item
H	—	—	—	—	—
I	GND	GND	Under any condition	1.0 or less	• Body ground
J	Power supply	SUNROOF 10A fuse	Under any condition	B+	• SUNROOF 10A fuse

Sample

3. Insert a tape-wrapped flathead screwdriver in the position shown in the figure, move it in the direction of the arrow to remove the clip.

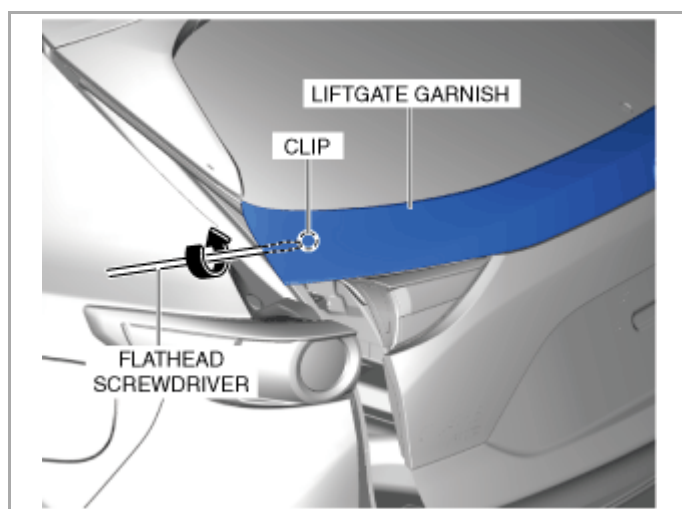

ac5uuw00009421

4. Put on gloves.

5. Insert the hand in the position shown in the figure.

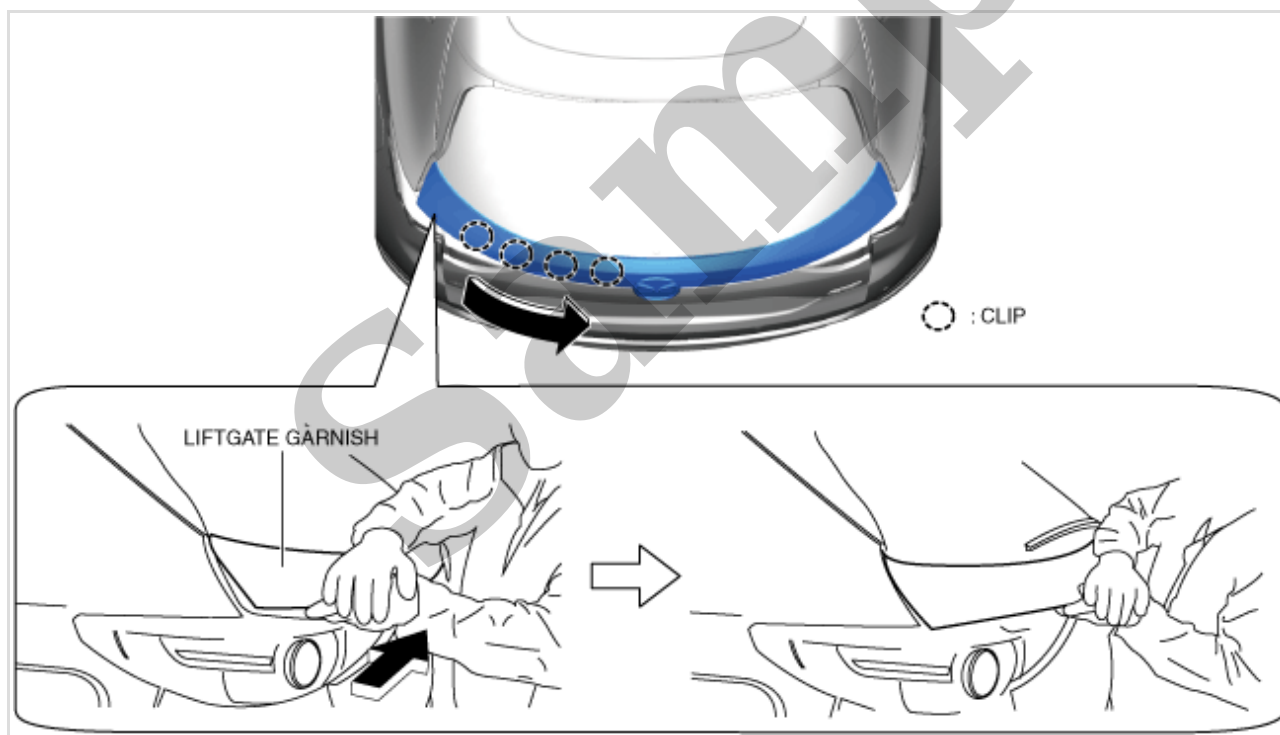

ac5uuw00009422

6. Slide the hand in the direction of the arrow shown in the figure and remove the clips.

7. Perform the same procedure from Steps 1 to 6 for the opposite side of the vehicle.

8. Move the liftgate garnish in the direction of the arrows shown in the figure and remove the tab and clip.

REAR DOOR GARNISH REMOVAL/INSTALLATION

SM2899423

id09160044570

Warning

•Using a utility knife with bare hands can cause injury. Always wear gloves when using a utility knife.

Front

Removal

Replace parts

Rear door garnish	Double-sided adhesive tape
Number of parts: 1	Number of parts: 3
Used place: Rear door garnish	Used place: Rear door garnish

- 1.Remove the rear beltline molding. (See [REAR BELTLINE MOLDING REMOVAL/INSTALLATION.](#))
- 2.Remove the clip.

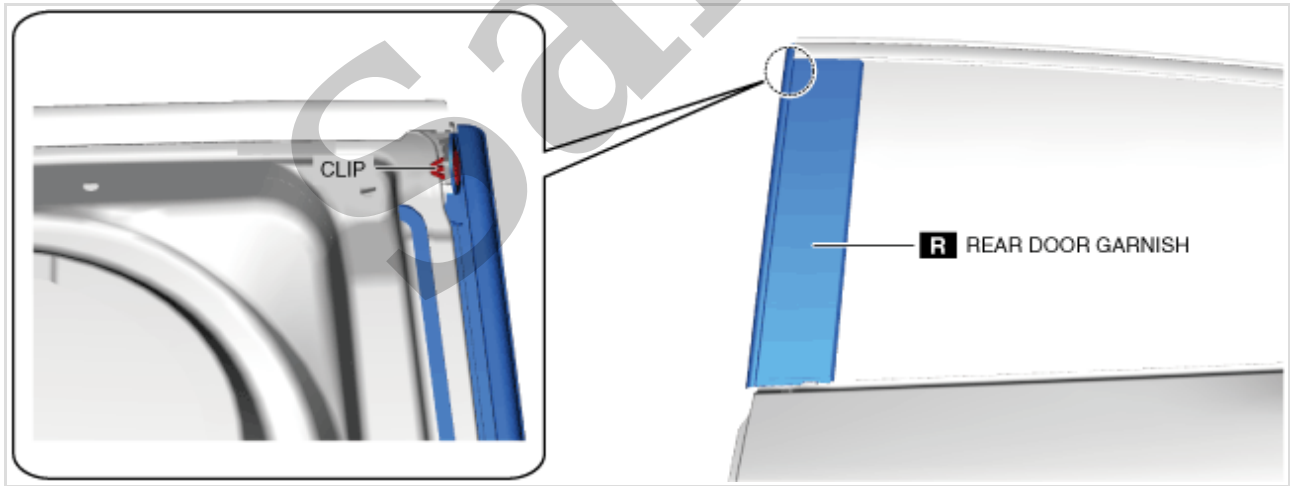

ac5uuw00007234

- 3.Peel off double-sided adhesive tape using a utility knife.

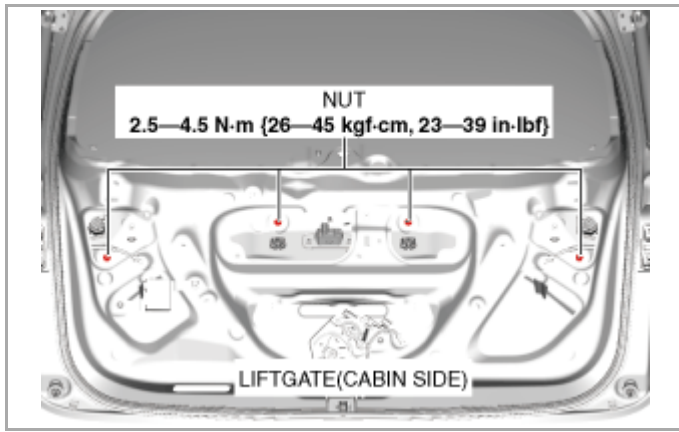

5.Remove the cap.

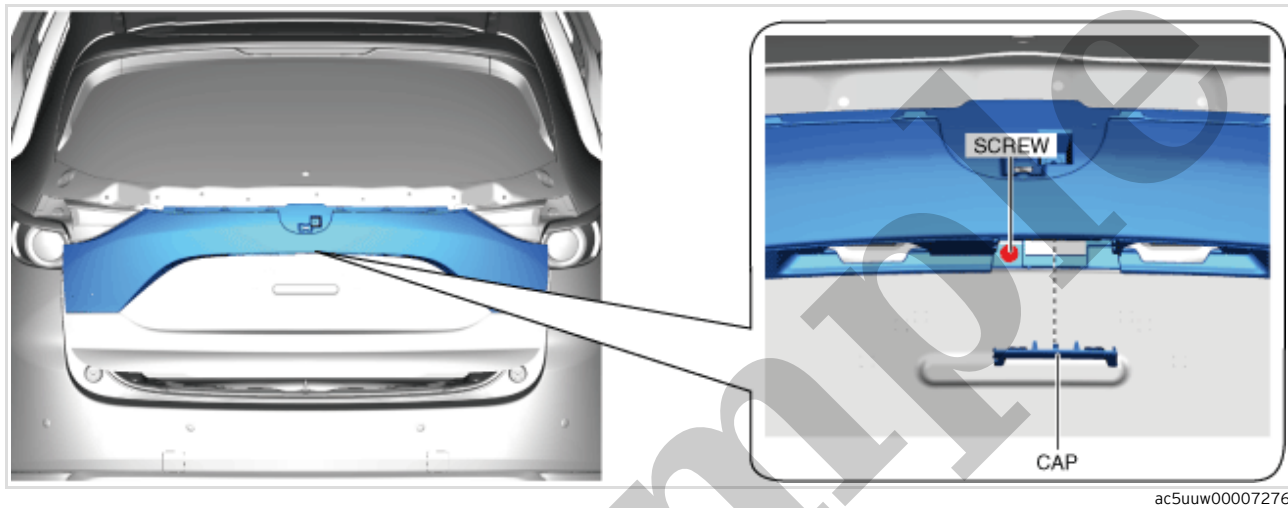

6.Remove the screws.

7.Pull the rear finisher and detach the clips.

