

Your Ultimate Source for OEM Repair Manuals

FactoryManuals.net is a great resource for anyone who wants to save money on repairs by doing their own work. The manuals provide detailed instructions and diagrams that make it easy to understand how to fix a vehicle.

2017 JEEP Grand Cherokee SRT OEM Service and Repair Workshop Manual

[Go to manual page](#)

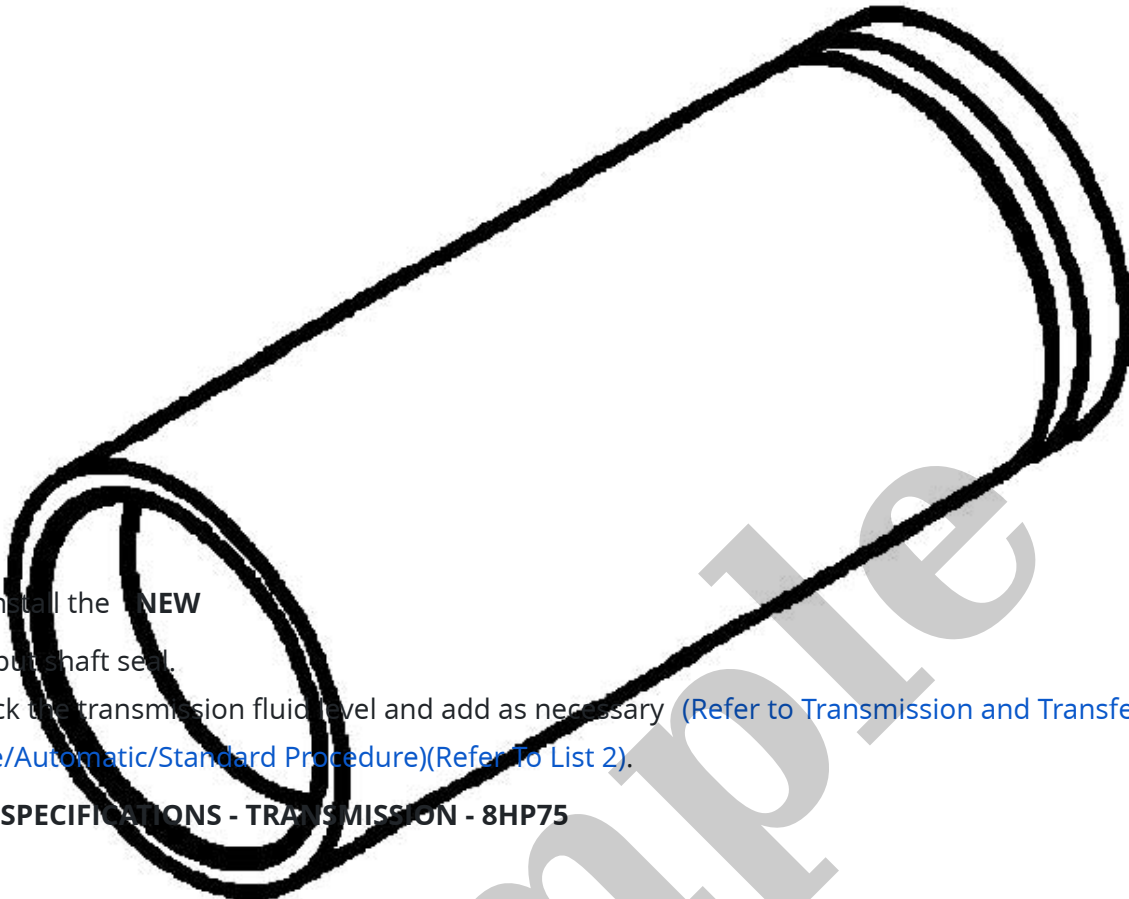

to install the **NEW**
output shaft seal.

- Check the transmission fluid level and add as necessary ([Refer to Transmission and Transfer Case/Automatic/Standard Procedure](#))(Refer To List 2).

TORQUE SPECIFICATIONS - TRANSMISSION - 8HP75

DESCRIPTION	SPECIFICATION	COMMENT
Bellhousing Bolt	53 N·m (39 Ft. Lbs.)	—
Bellhousing to Engine Oil Pan Bolts	45 N·m (33 Ft. Lbs.)	—
Flexplate to Crankshaft Bolts	95 N·m (70 Ft. Lbs.)	Do not reuse these fasteners. If removed, a NEW fastener must be installed and tightened to specifications.
Hydraulic Impulse Solenoid (HIS) Bolts	8 N·m (71 In. Lbs.)	—
Manual Park Release Cable Bracket to Transmission Bolts	20 N·m (15 Ft. Lbs.)	—
Manual Park Release Lever Shaft Nut	20 N·m (15 Ft. Lbs.)	—

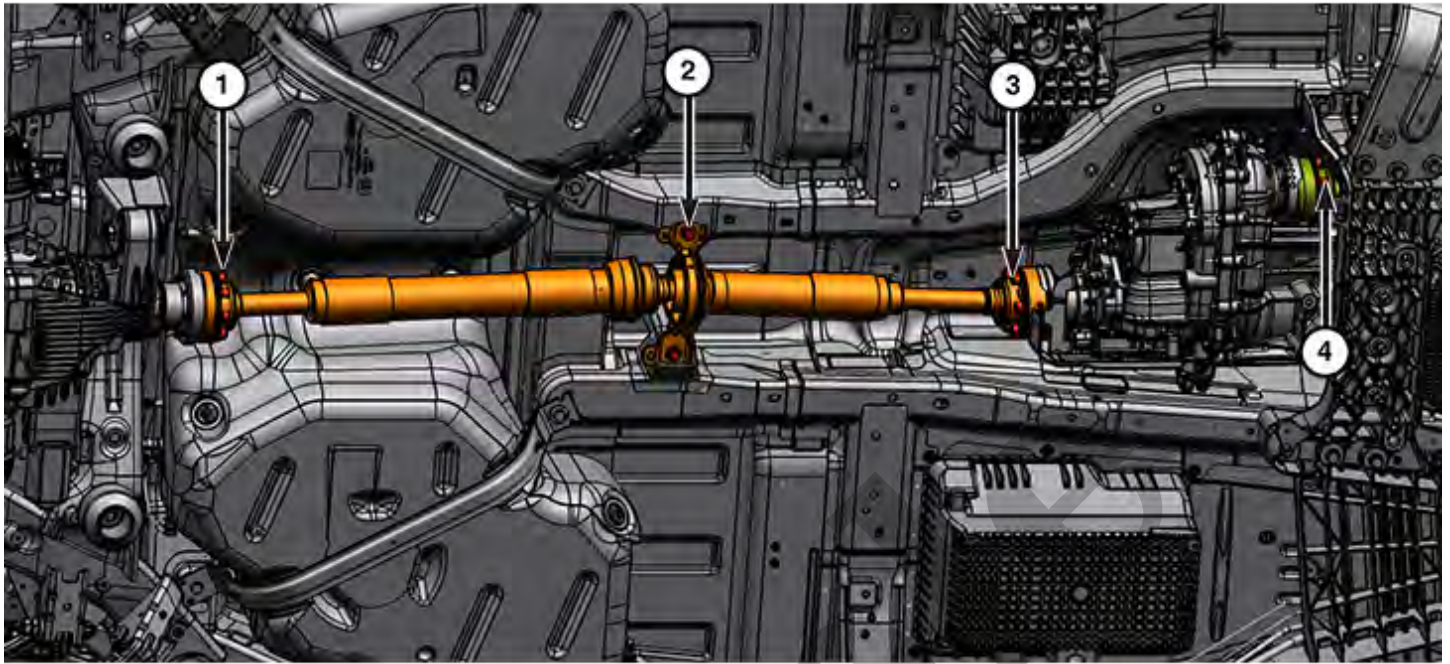

0305191835

CALLOUT	DESCRIPTION	SPECIFICATION	COMMENTS
1	Rear Driveshaft to Rear Pinion Flange Bolts	56 N·m (41 Ft. Lbs.)	If removed, NEW bolts must be installed and tightened to specifications
2	Rear Driveshaft Center Support Bearing Bolts	55 N·m (41 Ft. Lbs.)	If removed, NEW bolts must be installed and tightened to specifications
3	Rear Driveshaft to Transfer Case Flange Bolts	56 N·m (41 Ft. Lbs.)	If removed, NEW bolts must be installed and tightened to specifications
4	Front Driveshaft to Transfer Case Flange Bolts	56 N·m (41 Ft. Lbs.)	If removed, NEW bolts must be installed and tightened to specifications

Refer To List:

List 1

- [21 - Transmission and Transfer Case / Transfer Case, MPT3015C \(One Speed\) / Removal and Installation](#)
- [21 - Transmission and Transfer Case / Transfer Case, MPT3028C / Removal and Installation](#)

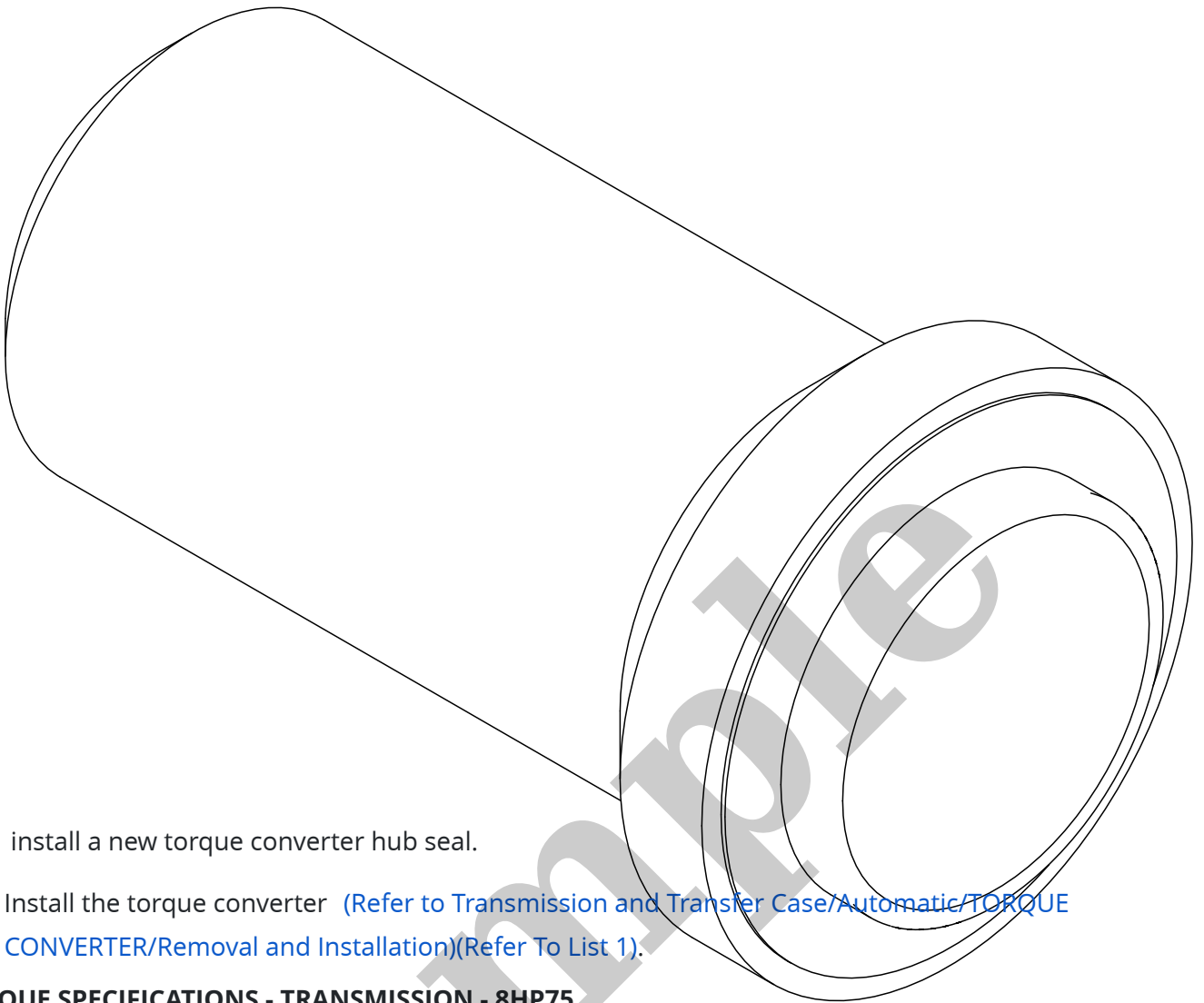

install a new torque converter hub seal.

3. Install the torque converter [\(Refer to Transmission and Transfer Case/Automatic/TORQUE CONVERTER/Removal and Installation\)\(Refer To List 1\).](#)

TORQUE SPECIFICATIONS - TRANSMISSION - 8HP75

DESCRIPTION	SPECIFICATION	COMMENT
Bellhousing Bolt	53 N·m (39 Ft. Lbs.)	—
Bellhousing to Engine Oil Pan Bolts	45 N·m (33 Ft. Lbs.)	—
Flexplate to Crankshaft Bolts	95 N·m (70 Ft. Lbs.)	Do not reuse these fasteners. If removed, a NEW fastener must be installed and tightened to specifications.
Hydraulic Impulse Solenoid (HIS) Bolts	8 N·m (71 In. Lbs.)	—
Manual Park Release Cable Bracket to	20 N·m (15 Ft. Lbs.)	—

YOUR CURRENT VEHICLE

Transmission Shifter

TRANSMISSION SHIFTER

REMOVAL

The shifter is serviced with the Electronic Shift Module (ESM) for removal and installation information ([Refer to Electrical/8E - Electronic Control Modules/MODULE, Electronic Shift/Removal and Installation](#)).

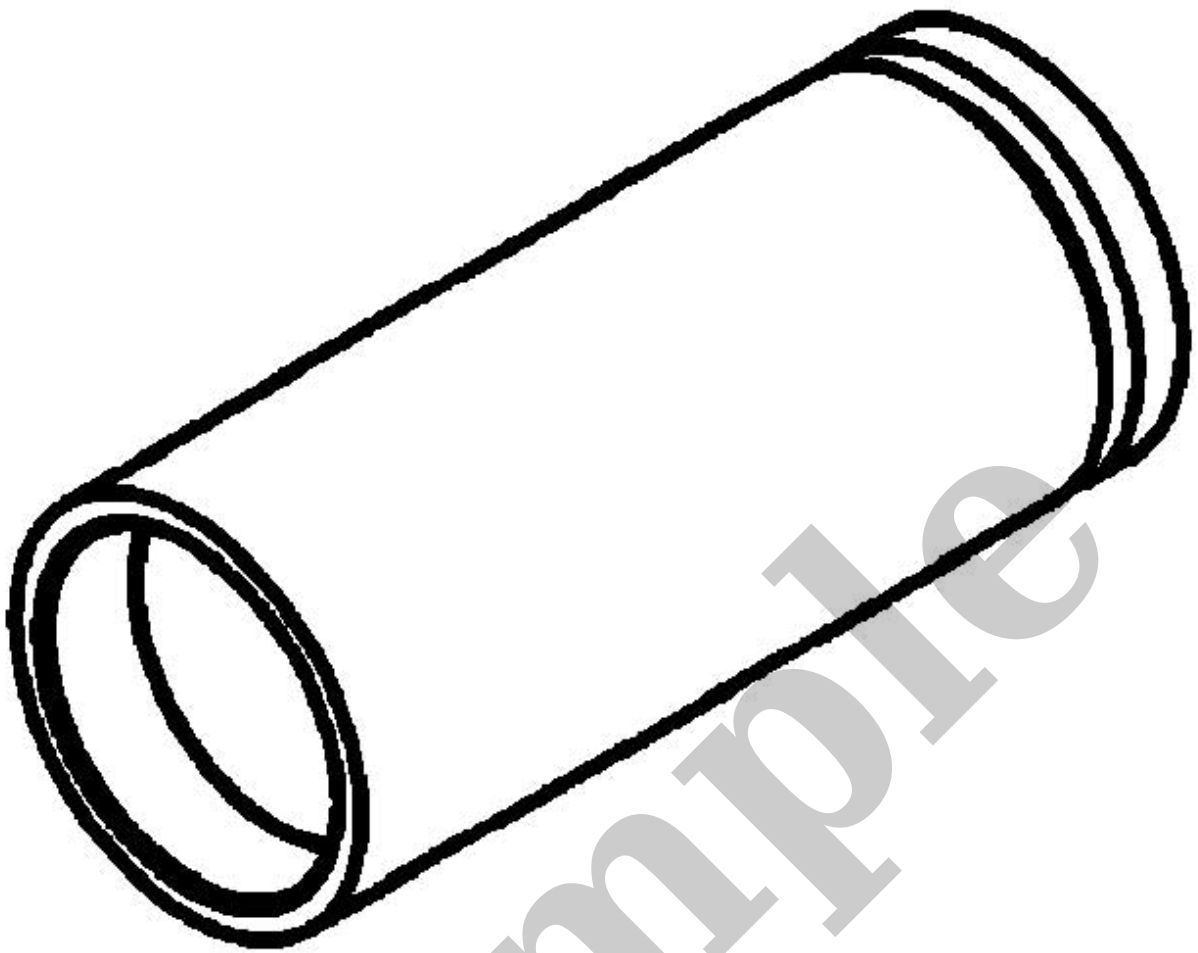

Pressing Tool

Installer, Seal

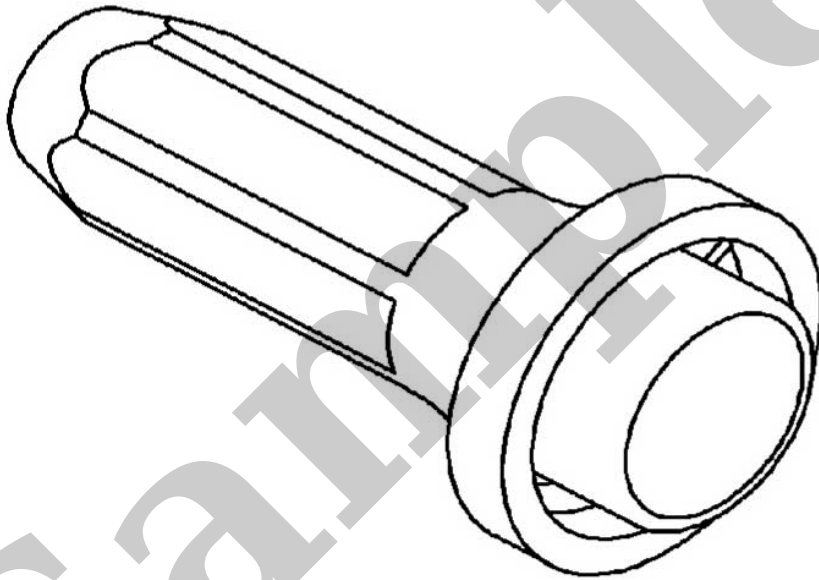
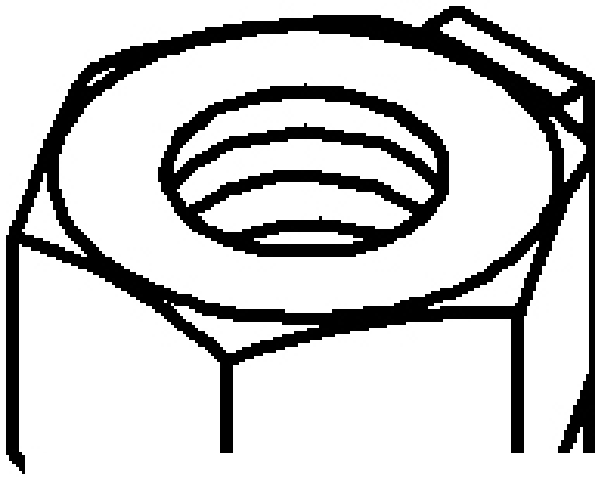

Installer, Output Needle Bearing/Rear Oil Dam

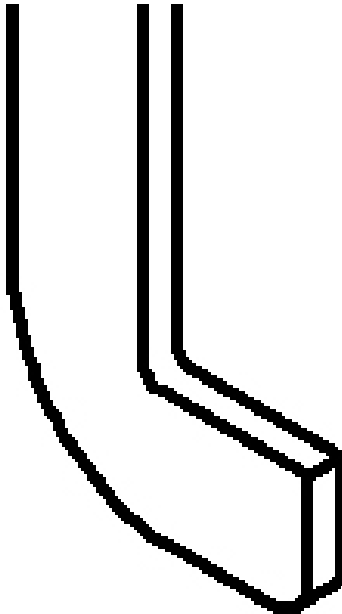

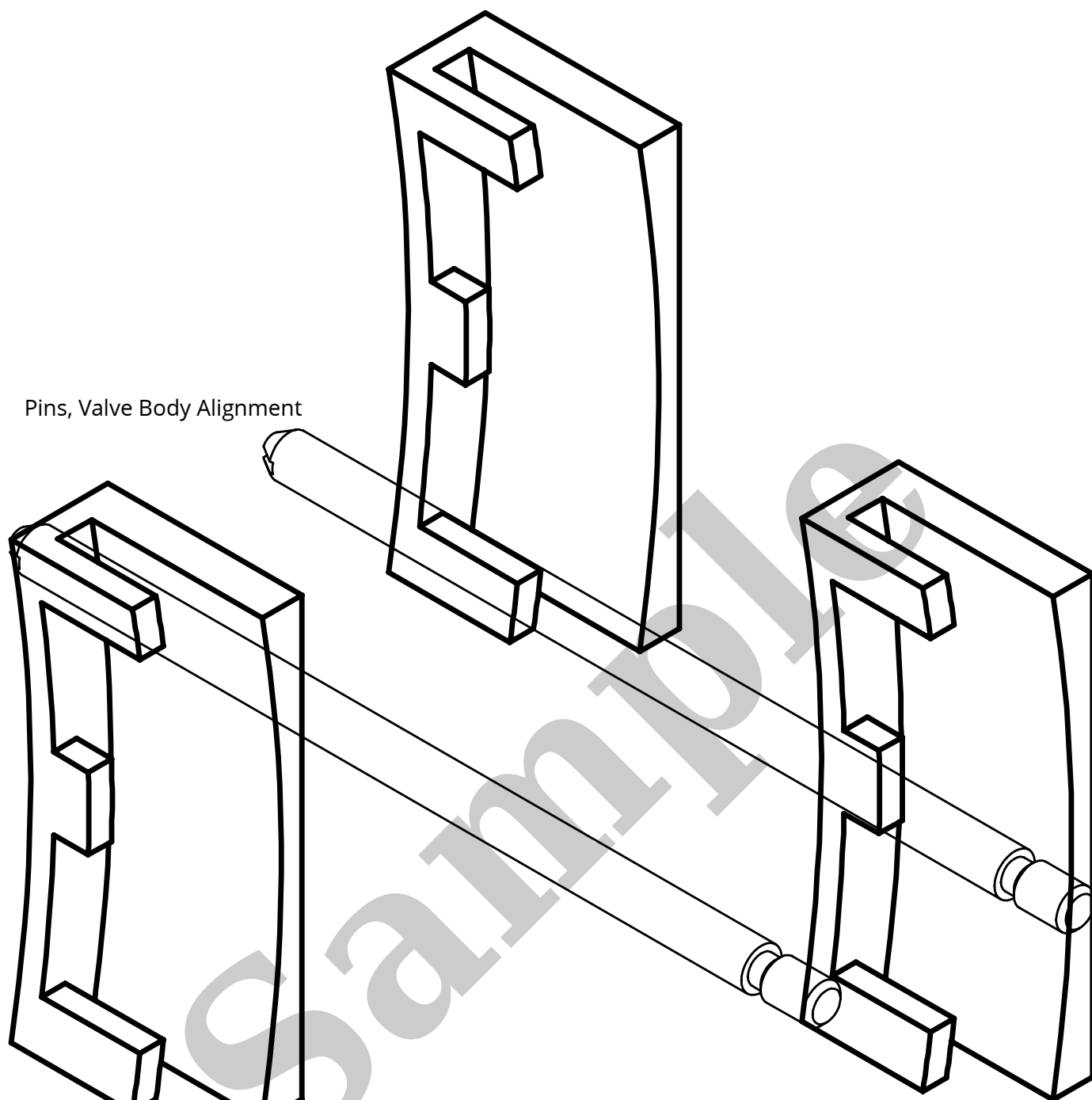

Pins, Valve Body Alignment

Installer, Oil Pump Housing Needle Bearing

Slide Hammer, Universal

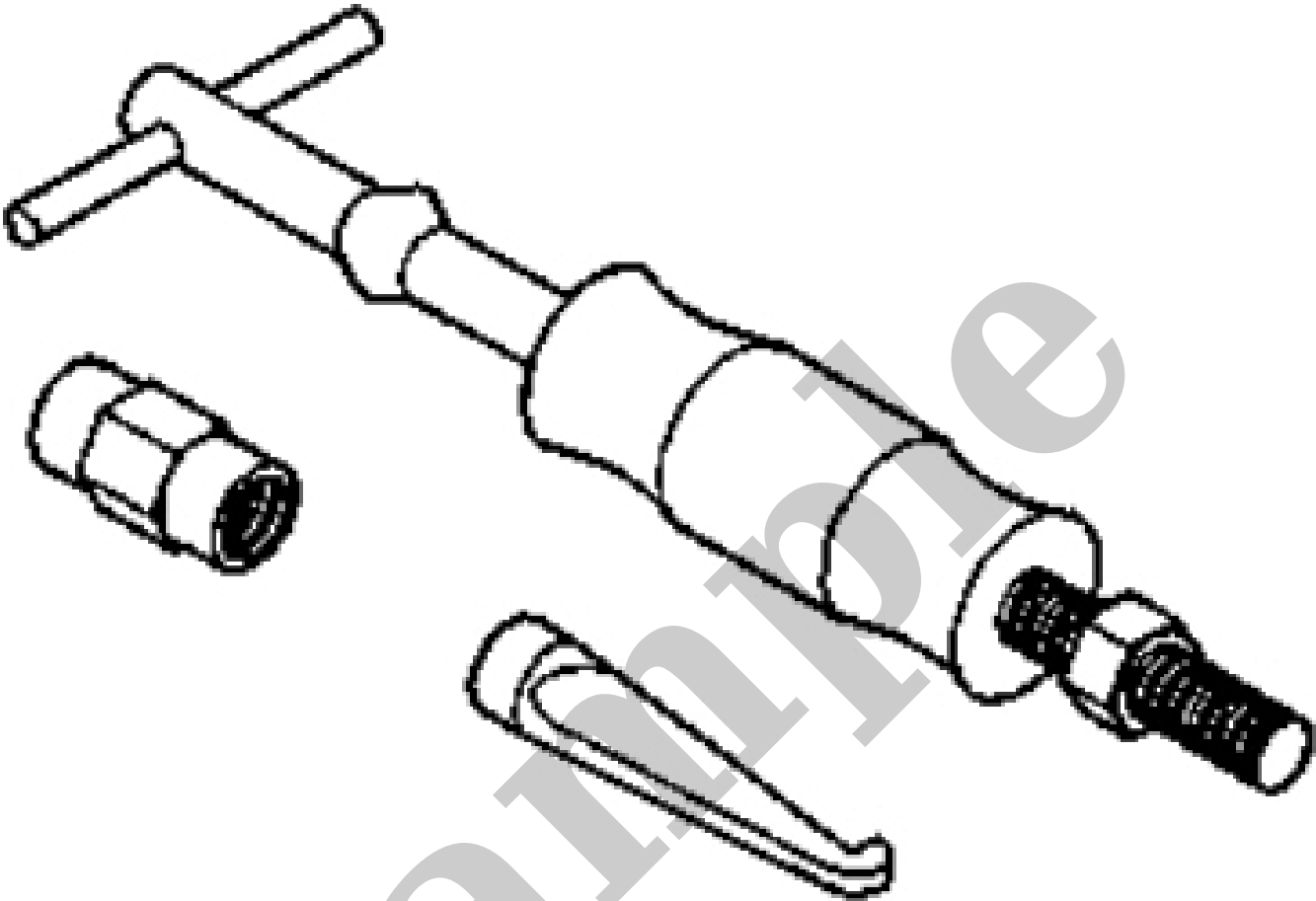

Holder, Flange

Check Transmission Oil Level

CHECK TRANSMISSION OIL LEVEL

To properly check and fill the transmission, perform the following procedure:

WARNING

There is a risk of accident from vehicle moving when the engine is running. Secure vehicle to prevent it from moving. There is a risk of injury from contusions and burns if you insert your hands into the engine when it is running. Do not touch hot or rotating parts. Wear properly fitted work clothes.

CAUTION

A unique transmission fluid has been developed for this transmission. This fluid is NOT compatible with ATF+4 or any other current FCA US LLC transmission fluid. For specifics about this unique fluid see FLUIDS, LUBRICANTS AND GENUINE PARTS.

NOTE

ZF transmissions are filled from the factory with UV leak detection dye. Do NOT add leak detection dye to the transmission. Adding oil dye can cause shift quality issues and is not recommended.

1. Raise and support the vehicle **on a level hoist** ([Refer to Vehicle Quick Reference/Hoisting - Standard Procedure](#)).
2. Start the engine. The engine must continue to run for the entire test.
3. Using a scan tool or the vehicle information center, verify that the transmission fluid temperature is between 30°C (86°F) and 50°C (122°F).
4. Disable Electronic Stability Control (ESC).