

Your Ultimate Source for OEM Repair Manuals

FactoryManuals.net is a great resource for anyone who wants to save money on repairs by doing their own work. The manuals provide detailed instructions and diagrams that make it easy to understand how to fix a vehicle.

2017 Chevrolet Spark Service and Repair Manual

[Go to manual page](#)

Perform the [Diagnostic Repair Verification](#) after completing the repair.

[Control Module References](#) for Control Module replacement, programming and setup

Sample



YOUR CURRENT VEHICLE

B218R Side Object Sensor Module - Right: Scan Tool Information

B218R Side Object Sensor Module - Right: Scan Tool Information

Side Object Detection Scan Tool Parameters

Parameter	System State	Expected Value	Definition
Operating Conditions: Ignition ON			
Manufacturer's Traceability Number	–	Varies	The scan tool displays the Manufacturer's Traceability Number
Manufacturer Enable Counter	–	Varies	The scan tool displays the Manufacturer Enable Counter
Module Diagnostic Address	–	Varies	The scan tool displays the Software Module 1 Identifier
Software Module 1 Identifier	–	Varies	The scan tool displays the Software Module 1 Identifier
Software Module 2 Identifier	–	Varies	The scan tool displays the Software Module 2 Identifier
End Model Part Number	–	Varies	The scan tool displays the End Model Part Number
Base Model Part Number	–	Varies	The scan tool displays the Base Model Part Number
Software Module 1 Identifier Alpha Code	–	Varies	The scan tool displays the Software Module 1 Identifier Alpha Code

Parameter	Expected Value	Definition
Counter		security code.
Software Part Number	Varies, 8 Digit Number	The scan tool displays the software part number in the SDM.
Vehicle Identification Number	Varies, 17 Digit Number	The VIN number of the vehicle programmed into the SDM.
VIN Programmed	Yes/No	The scan tool displays Yes if the VIN has been programmed into the SDM.
VIN Programming Counter	Random Value	The SDM uses this counter while programming the VIN.

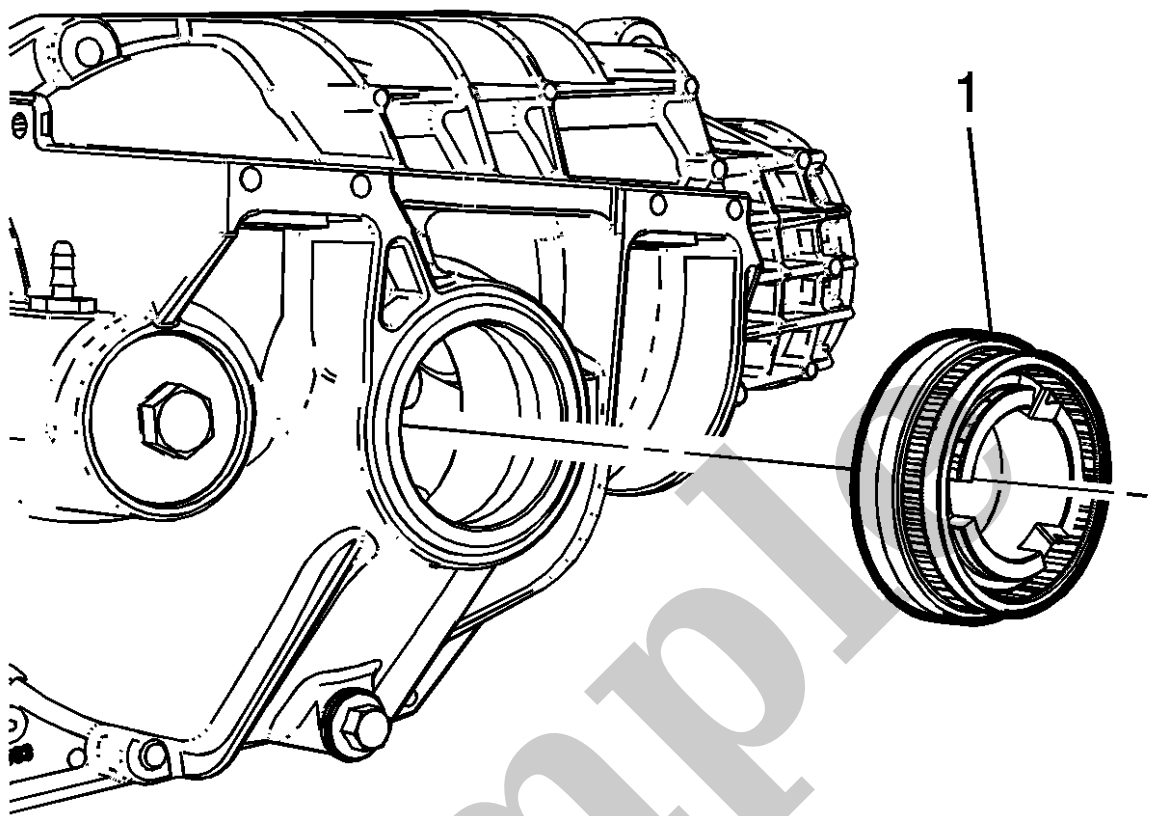

26.

NOTE

Note

Ensure that the differential adjuster nut is fully seated in the adjuster nut sleeve.

Position the differential adjuster nut (2) and the lock ring (1) in the differential case halves.

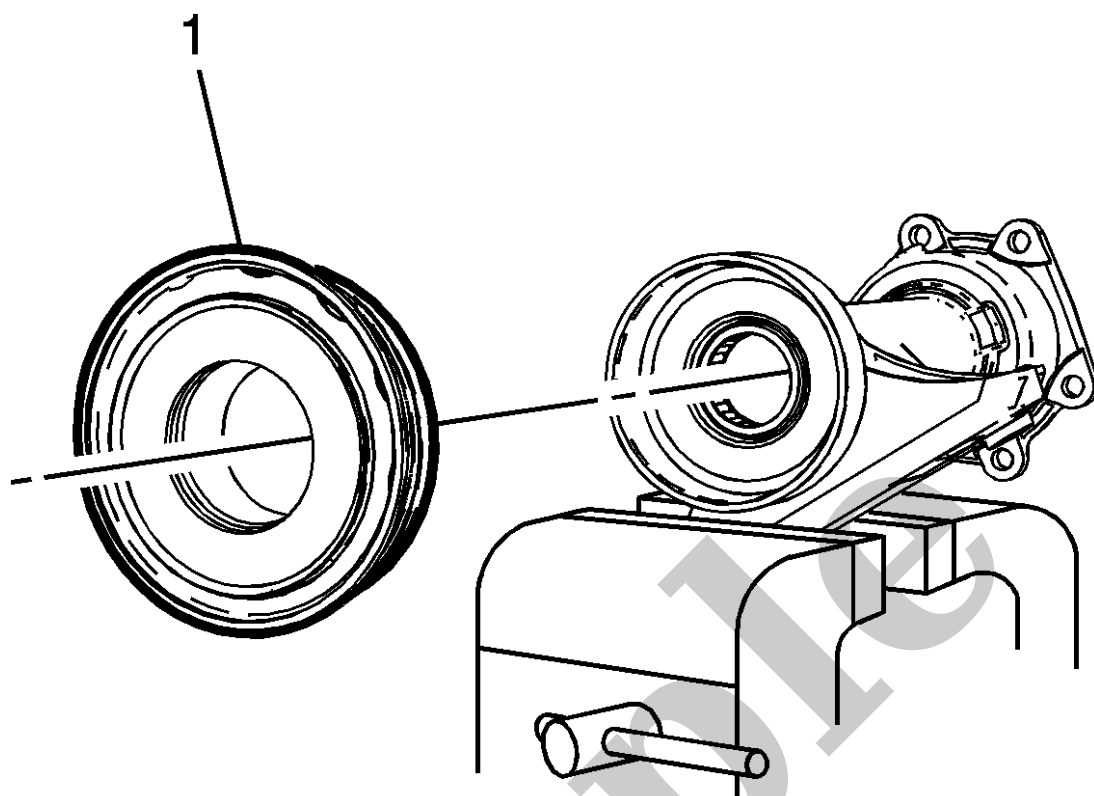

1.

Position the NEW front drive axle inner seal (1) so that it is even in the front drive axle inner shaft housing.



YOUR CURRENT VEHICLE

Locking Differential Assemble

Locking Differential Assemble

NOTE

Note

The left and right side gear backlash and thrust block thickness measurements must be completed before the components of the locking differential can be assembled.

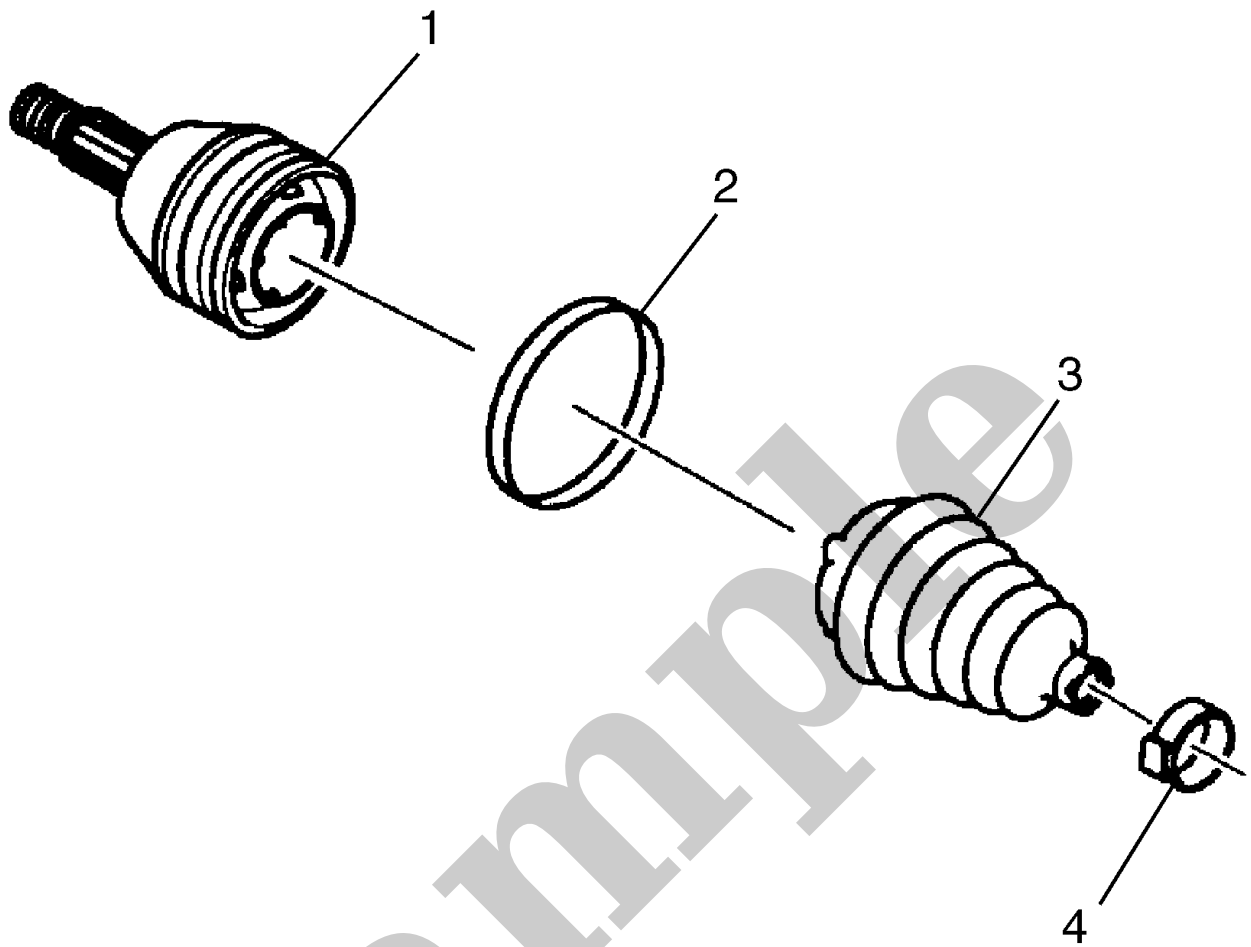

2.

NOTE

Note

Use caution when using the hand grinder by the CV joint outer race (1).

Use a hand grinder to cut through the swage ring (2).

3. Use side cutters to cut off the small boot clamp (4).

Note

Some circuits supply audio signals to more than one speaker. It may be necessary to disconnect all speakers on the affected audio circuit when performing circuit tests.

Ignition OFF, disconnect the harness connector at the appropriate P19 Speaker. Ignition ON, infotainment system ON, mute OFF.

2. Test for 5–7 V between each audio signal circuit terminal 1 and terminal 2 and ground.

- **If less than 5 V**

- 1. Ignition OFF, disconnect the X1 and X2 harness connectors at the T3 Audio Amplifier.

- 2. Test for infinite resistance between the signal circuit and ground.

- If less than infinite resistance, repair the short to ground on the circuit.
 - If infinite resistance

- 3. Test for less than 2 Ω in the signal circuit end to end.

- If 2 Ω or greater, repair the open/high resistance in the circuit.
 - If less than 2 Ω , replace the T3 Audio Amplifier.

- **If greater than 7 V**

- 1. Ignition OFF, disconnect the X1 and X2 harness connectors at the T3 Audio Amplifier. Ignition ON.

- 2. Test for less than 1 V between the signal circuit and ground.

- If 1 V or greater, repair the short to voltage on the circuit.
 - If less than 1 V, replace the T3 Audio Amplifier.

- **If 5–7 V**

3. Test or replace the P19 Speaker.

Repair Instructions

Perform the [Diagnostic Repair Verification](#) after completing the repair.

- [Speaker Replacement Reference](#)
- [Control Module References](#) for audio amplifier replacement, programming, and setup.