

Your Ultimate Source for OEM Repair Manuals

FactoryManuals.net is a great resource for anyone who wants to save money on repairs by doing their own work. The manuals provide detailed instructions and diagrams that make it easy to understand how to fix a vehicle.

Volvo V60 2016 Manual - Complete Service & Repair

[Go to manual page](#)

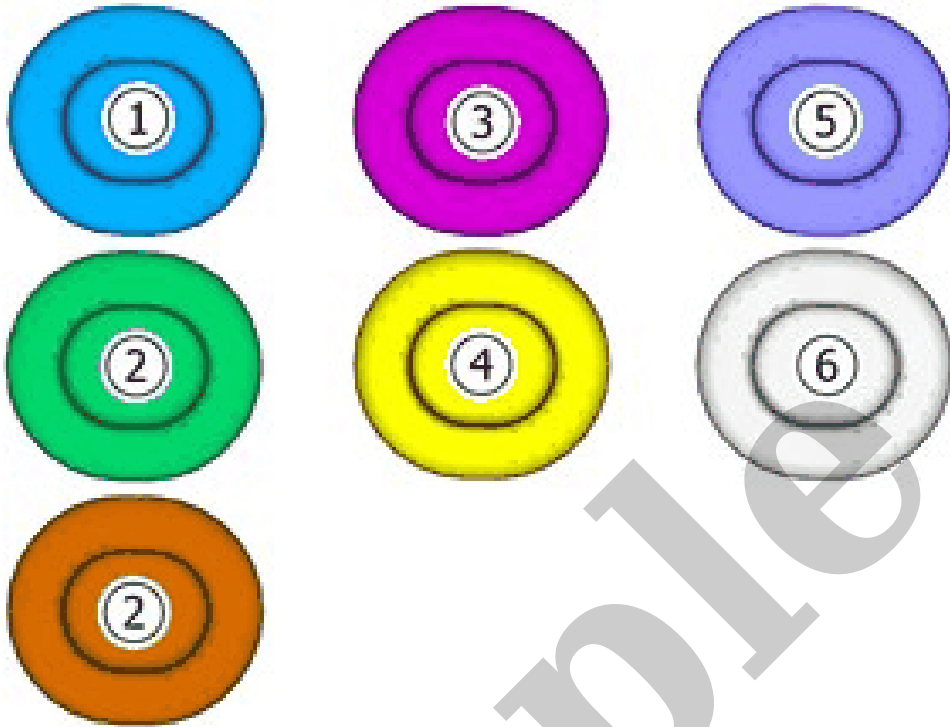

Courtesy of VOLVO CARS CORPORATION

NOTE: *This color chart displays (in color print and electronic version) the importance of the different colors used in the images of the method steps.*

1. Used for focused component, the component with which you will do something.
2. Used as extra colors when you need to show or differentiate additional parts.
3. Used for attachments that are to be removed/installed. May be screws, clips, connectors, etc.
4. Used when the component is not fully removed from the vehicle but only hung to the side.
5. Used for standard tools and special tools.
6. Used as background color for vehicle components.

REMOVAL

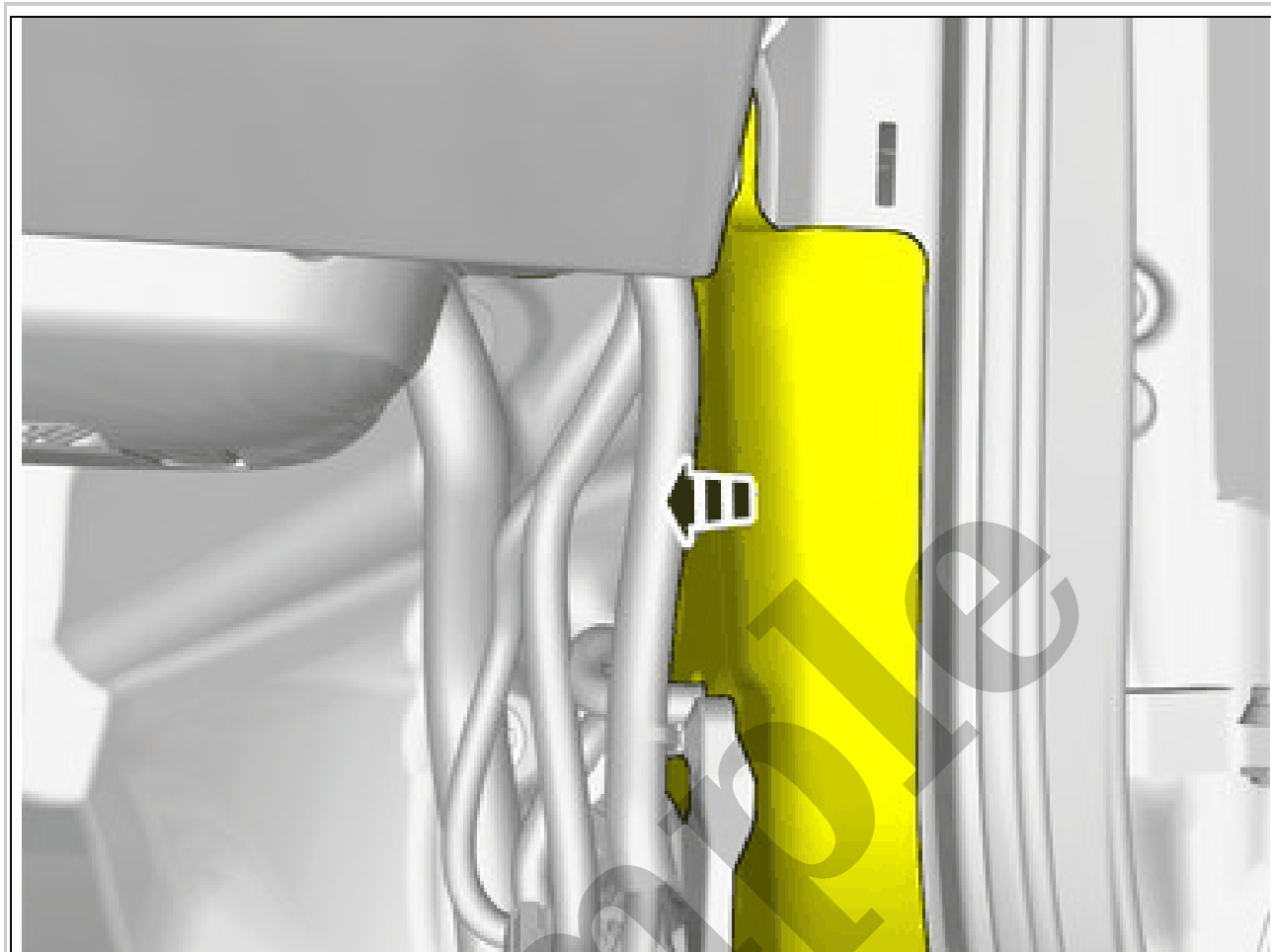

Courtesy of VOLVO CARS CORPORATION

Fold the insulation aside.

ACCESSORY INSTALLATION

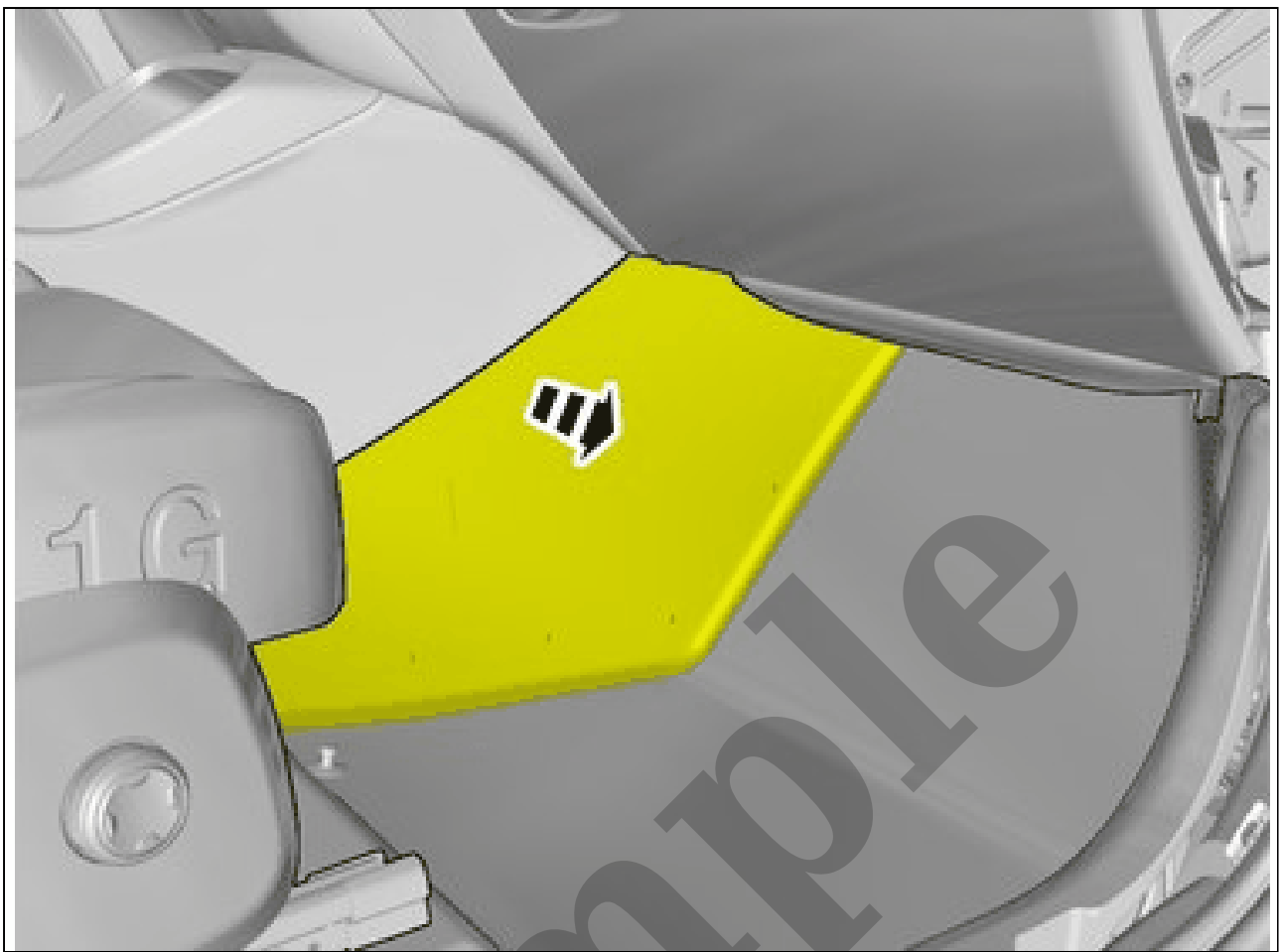

Courtesy of VOLVO CARS CORPORATION

Fold the carpet aside.



Courtesy of VOLVO CARS CORPORATION

Component overview

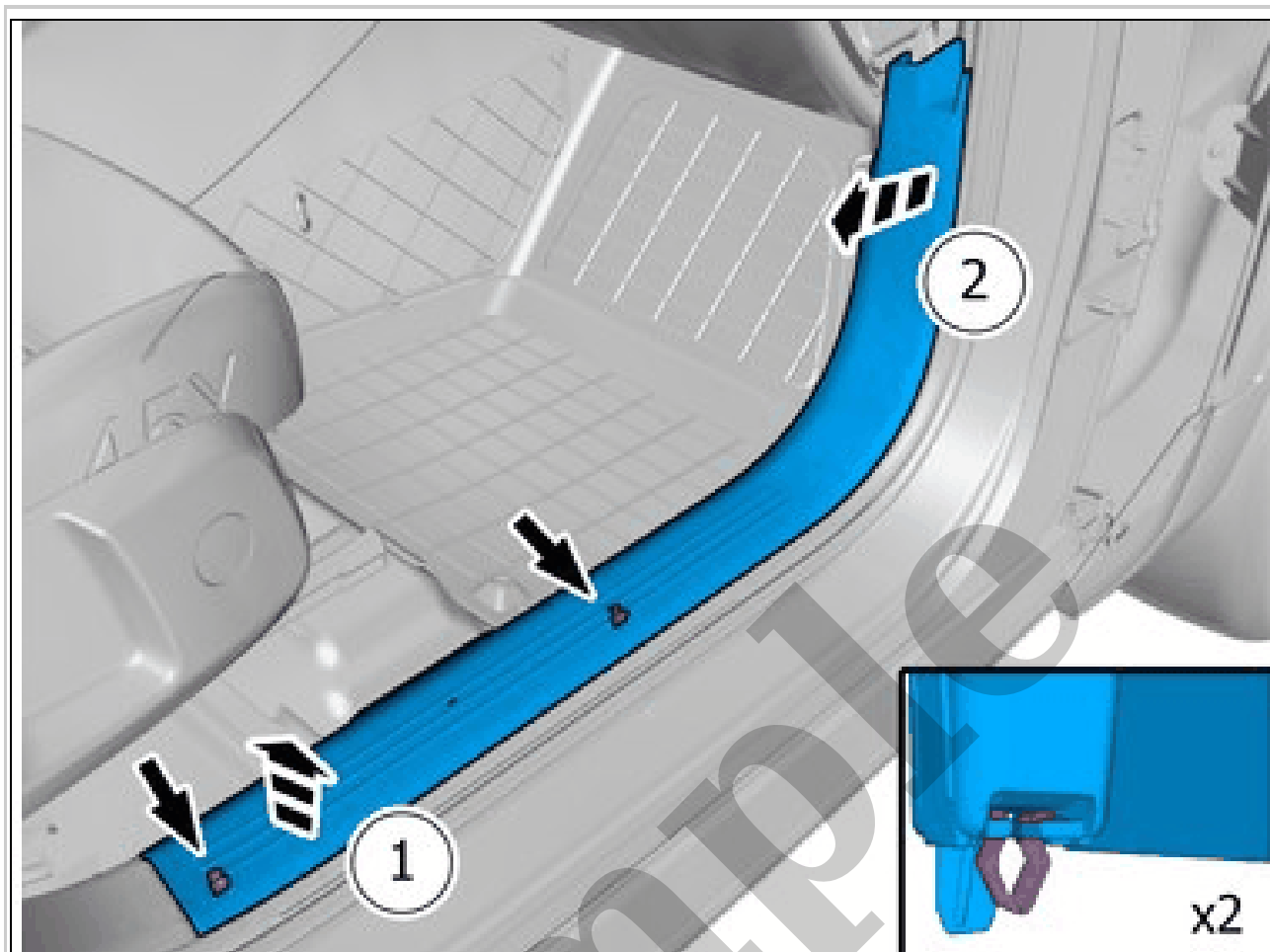

Courtesy of VOLVO CARS CORPORATION

Remove the panel.

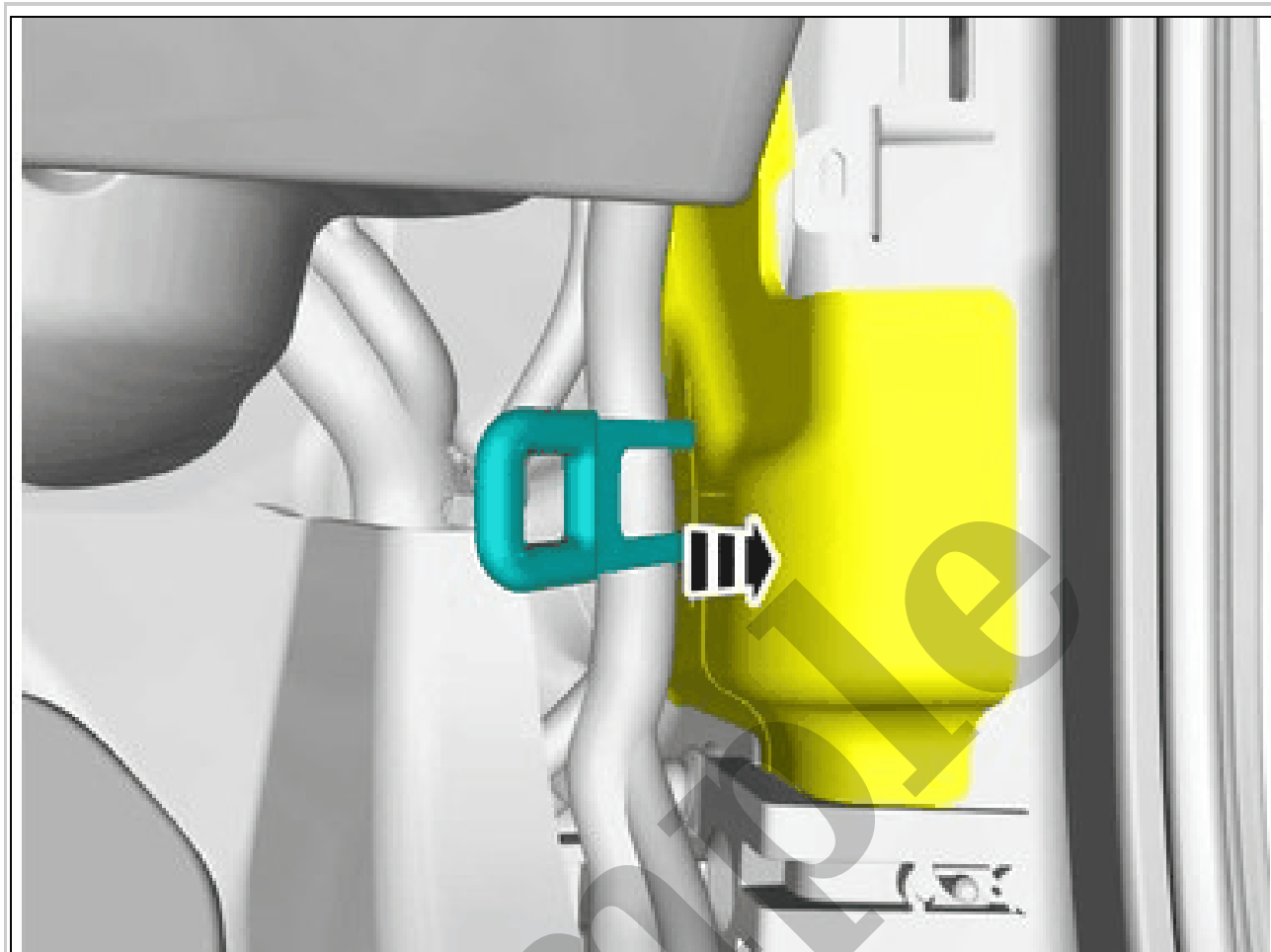

Courtesy of VOLVO CARS CORPORATION

Refit the insulation.

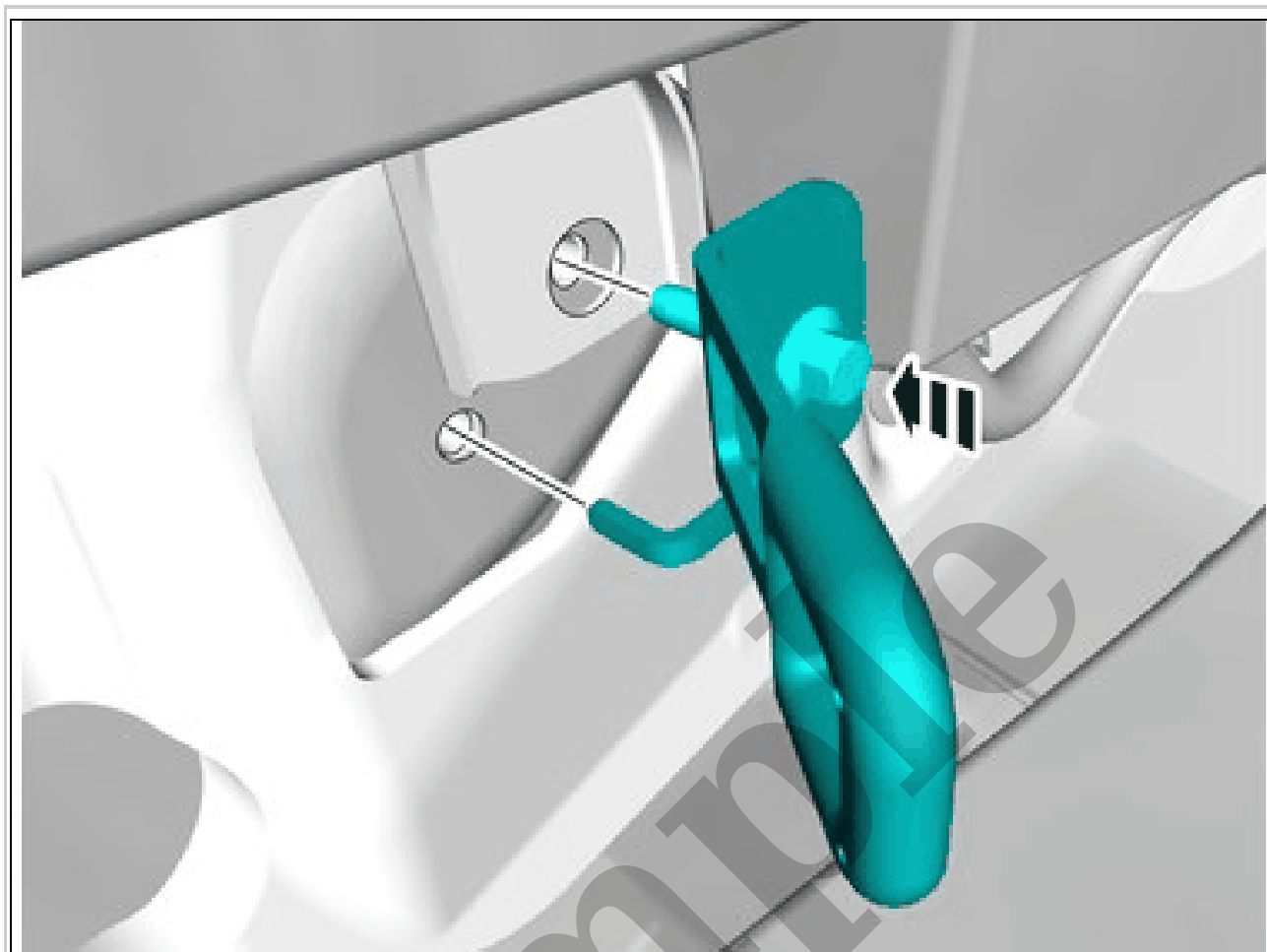

Courtesy of VOLVO CARS CORPORATION

Install component that comes with the accessory kit.



Courtesy of VOLVO CARS CORPORATION

Remove the screw.

Torque: Panel A-pillar, 4.5Nm

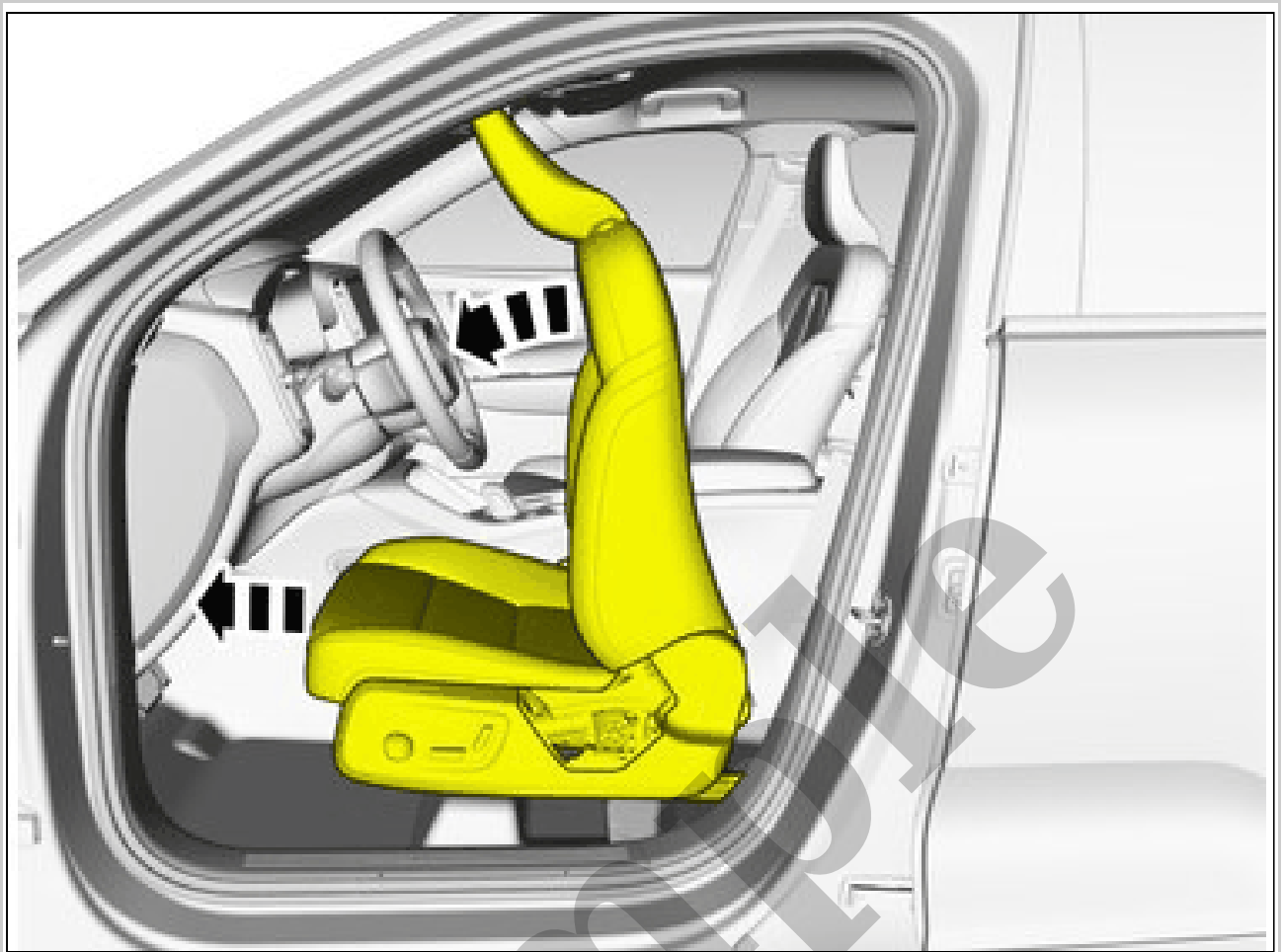

Courtesy of VOLVO CARS CORPORATION

Sample