

Your Ultimate Source for OEM Repair Manuals

FactoryManuals.net is a great resource for anyone who wants to save money on repairs by doing their own work. The manuals provide detailed instructions and diagrams that make it easy to understand how to fix a vehicle.

2016 Toyota Prius v Prius Service Manual

[Go to manual page](#)

(h) Disconnect the diagnosis system from the vehicle.

(i) Disconnect the battery charger from the vehicle.

Sample



Last Modified: 07-26-2024	6.11:8.1.0	Doc ID: RM100000001JDID
Model Year Start: 2020	Model: Supra	Prod Date Range: [03/2019 -]
Title: CRUISE CONTROL: MILLIMETER WAVE RADAR SENSOR: REMOVAL; 2020 - 2025 MY Supra [03/2019 -]		

REMOVAL

PROCEDURE

1. REMOVE FRONT BUMPER ASSEMBLY

Click here [INFO](#) [INFO](#)

2. REMOVE LOWER RADIATOR GRILLE RH

Click here [INFO](#) [INFO](#)

3. REMOVE LOWER SIDE RADIATOR GRILLE RH

Click here [INFO](#) [INFO](#)

4. REMOVE MILLIMETER WAVE RADAR SENSOR ASSEMBLY

(a) Unscrew T25 screws (1) and remove the millimeter wave radar sensor assembly (2).

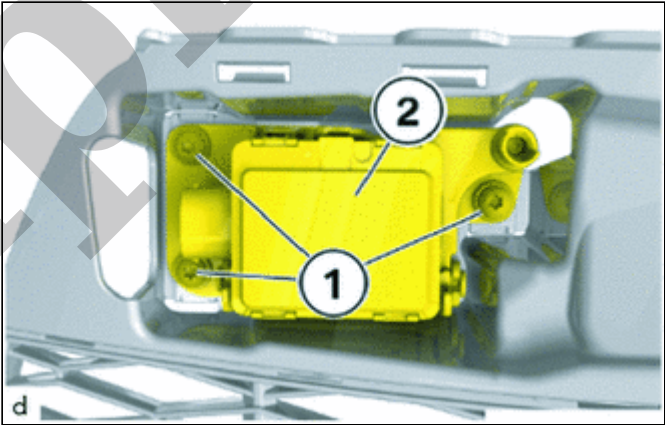

(f) Carry out vehicle test.

Vehicle management / Troubleshooting / Fault memory / Calculate test plan

(g) Delete the fault memory.

Vehicle management / Troubleshooting / Fault memory / Delete fault memory

(h) Disconnect the diagnosis system from the vehicle.

(i) Disconnect the battery charger from the vehicle.

6. ADJUST MILLIMETER WAVE RADAR SENSOR ASSEMBLY

- Before starting adjustment:

Click here

INFO

- Adjustment:

Click here

INFO

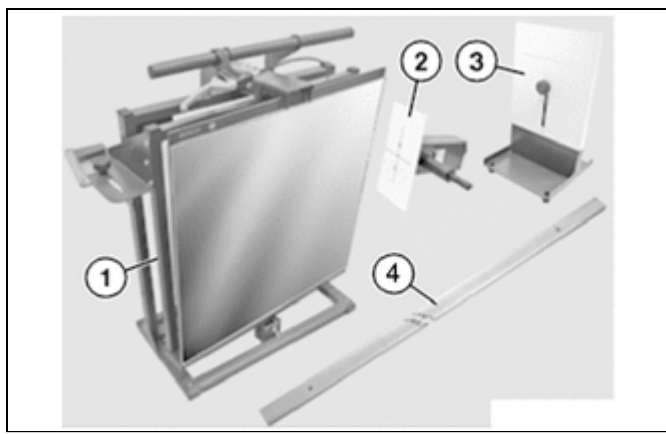

*1	Setting Device
*2	Wheel Laser
*3	Slotted Cover
*4	Rail

(1) Setting Device:

HINT:

Installing the rail enables the setting device to be set up at a right angle to the vehicle.

- Purpose:
 - a. Confirming the horizontal and vertical alignment of the vehicle.
 - b. Adjusting the millimeter wave radar sensor assembly.
- How to install to rail:
 - a. Pull the clamp release locking lever to open the clamp.
 - b. With the clamp open, place the setting device on the rail.
 - c. Release the locking lever to secure the setting device to the rail.
- Usage Method:
 - a. Setting device main unit angle adjustment:
 - i. Use the knurled screw for vertical alignment of the setting device to adjust the setting device main unit so that it is level with the floor.

HINT:

- Use the spirit level to confirm the angle of the main unit.
- Adjust the unit so that the bubble is in the center of the spirit level.

- b. Mirror angle adjustment:
 - i. Use the knurled screw for vertical mirror adjustment to

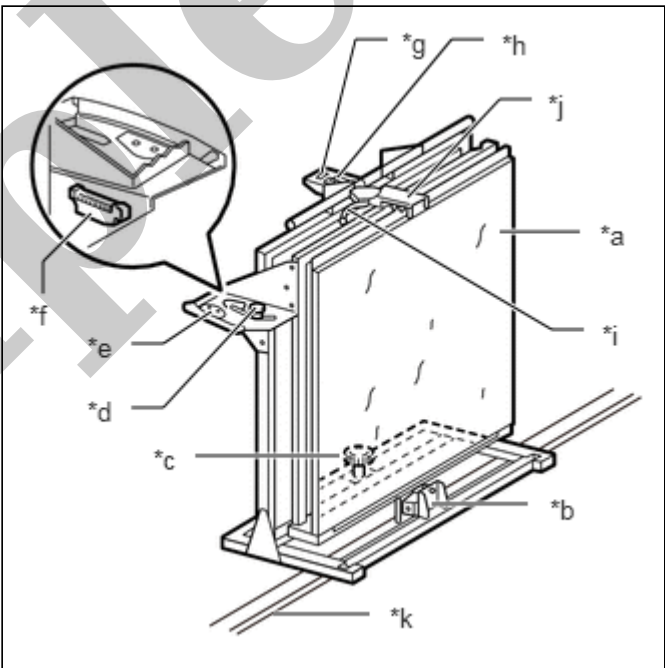

*a	Mirror
*b	Clamp
*c	Knurled Screw for Vertical Adjustment of Setting Device
*d	Setscrew for Horizontal Mirror Alignment
*e	Mirror Horizontal Alignment Scale
*f	Spirit Level
*g	Knurled Screw for Vertical Mirror Adjustment
*h	Mirror Vertical Alignment Scale
*i	Clamp Release Locking Lever
*j	Tilting Mechanism
*k	Rail