

Your Ultimate Source for OEM Repair Manuals

FactoryManuals.net is a great resource for anyone who wants to save money on repairs by doing their own work. The manuals provide detailed instructions and diagrams that make it easy to understand how to fix a vehicle.

2016 Jeep Patriot Service and Repair Manual

[Go to manual page](#)

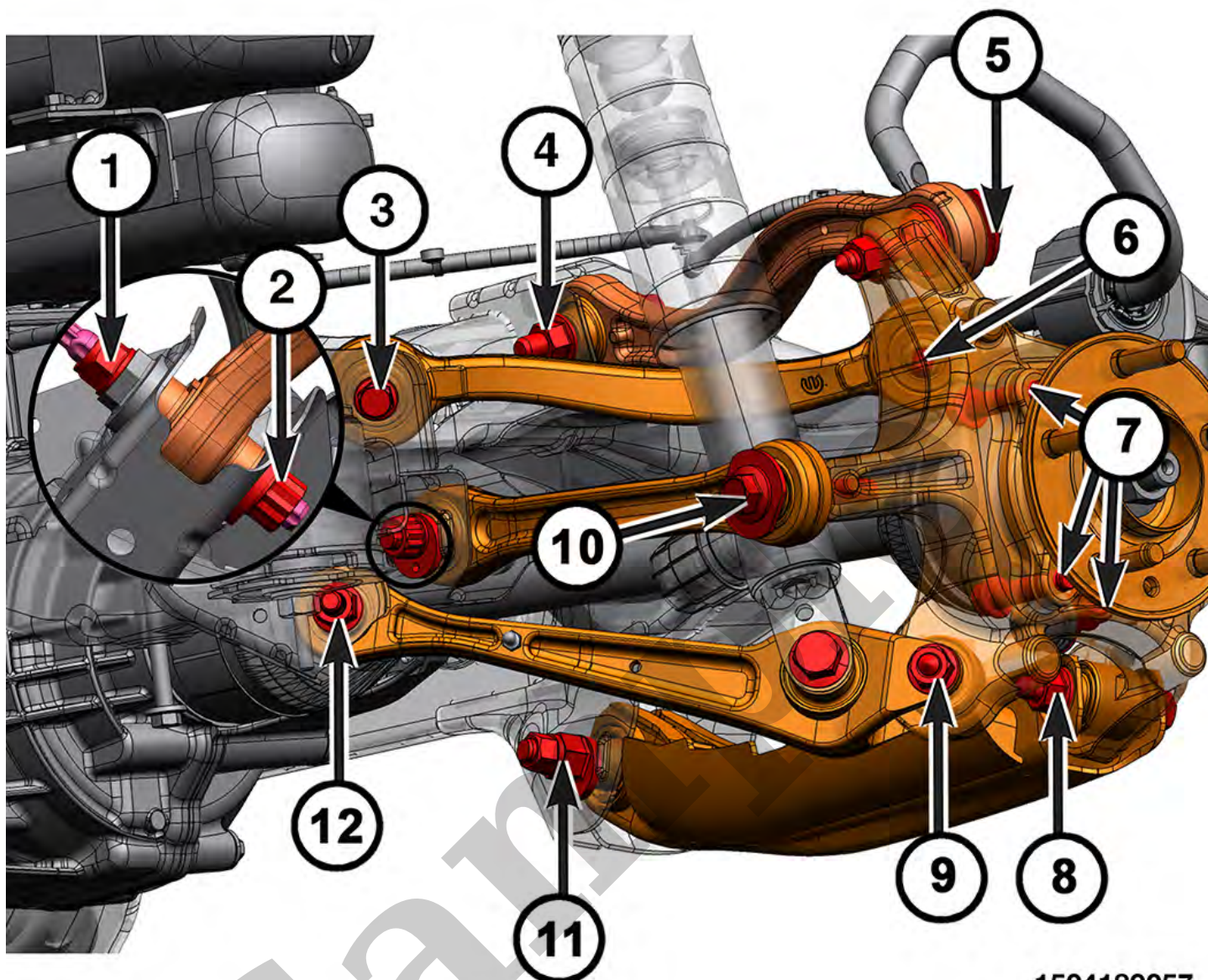

1504189057

| CALLOUT | DESCRIPTION | SPECIFICATION | COMMENT |
|---------|-------------------------|------------------------------|--|
| 1 | Toe Link Inner Nut | 120 N·m (89 Ft. Lbs.) | Fastener must be torqued with the vehicle at normal ride height. Do not reuse these fasteners. If removed, a new fastener must be installed and tightened to specifications. |
| 2 | Toe Link Stud | 35 N·m (26 Ft. Lbs.) | Do not reuse these fasteners. If removed, a new fastener must be installed and tightened to specifications. |
| 3 | Tension Link Inner Bolt | 100 N·m (74 Ft. Lbs.) | Fastener must be torqued with the vehicle at normal ride height. |

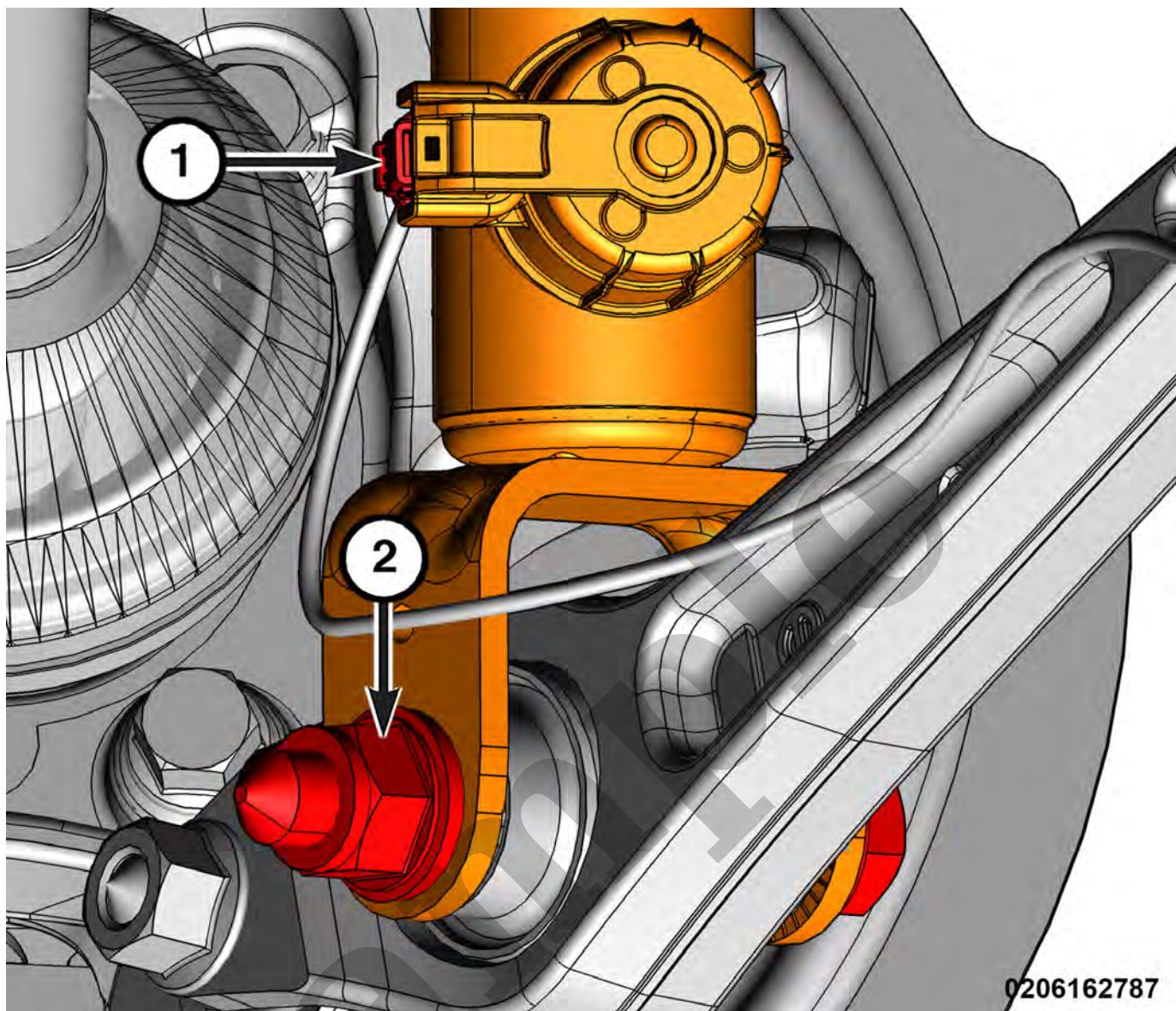

1 - Wire Harness Connector

2 - Shock Absorber Lower Nut

6. If equipped, disconnect the shock absorber wire harness connector.
7. Remove and **DISCARD** the shock absorber lower nut and remove the shock absorber lower bolt.

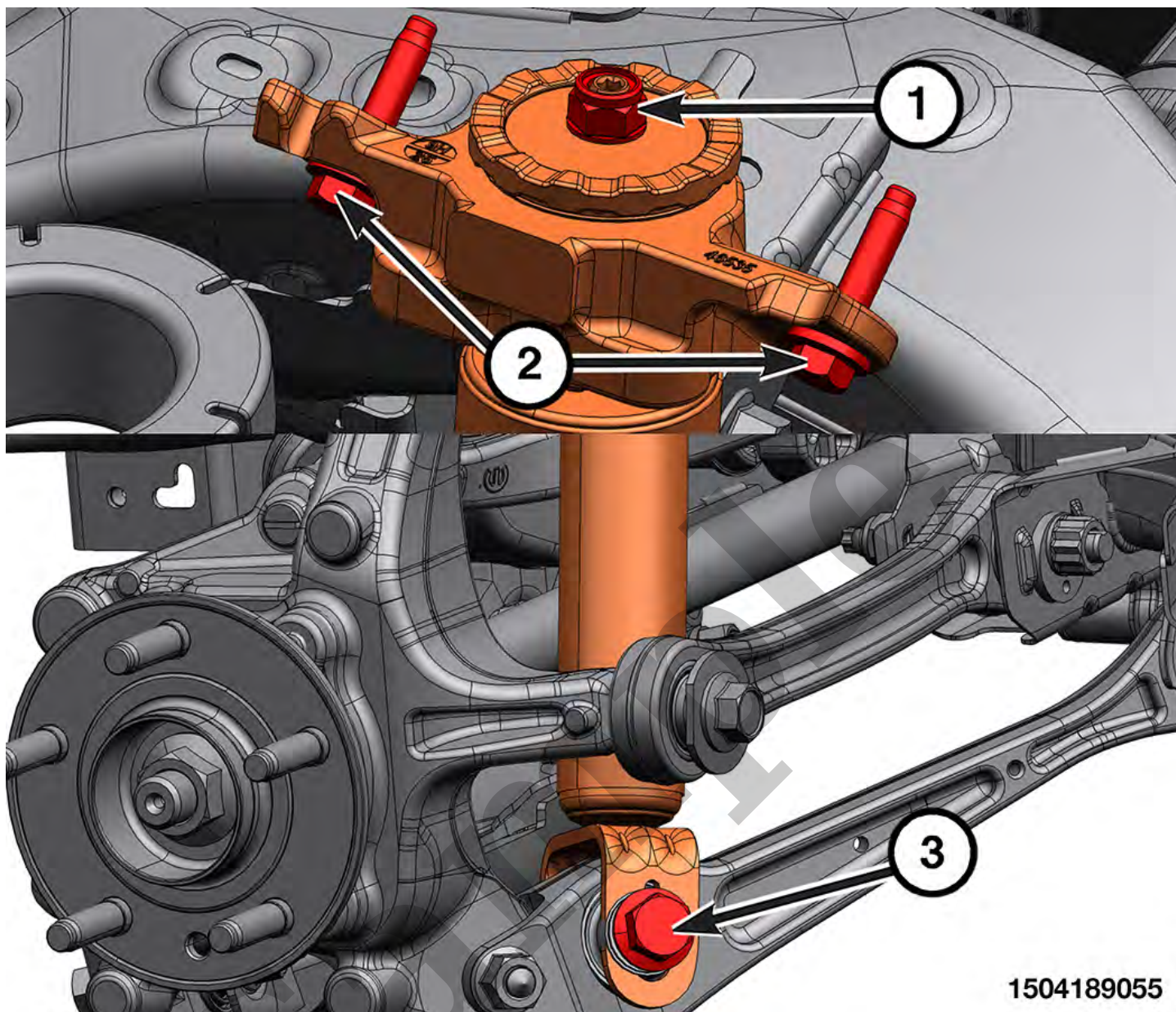

1504189055

| CALLOUT | DESCRIPTION | SPECIFICATION | COMMENT |
|---------|-----------------------------------|---|---|
| 1 | Shock Absorber Upper Nut | 70 N·m (52 Ft. Lbs.) | Do not reuse these fasteners. If removed, a new fastener must be installed and tightened to specifications. |
| 2 | Shock Absorber Upper Bracket Bolt | 70 N·m (52 Ft. Lbs.) | — |
| 3 | Shock Absorber Lower Nut | 50 + 178° N·m (37 + 178° Ft. Lbs.) | Fastener must be torqued with the vehicle at normal ride height. |

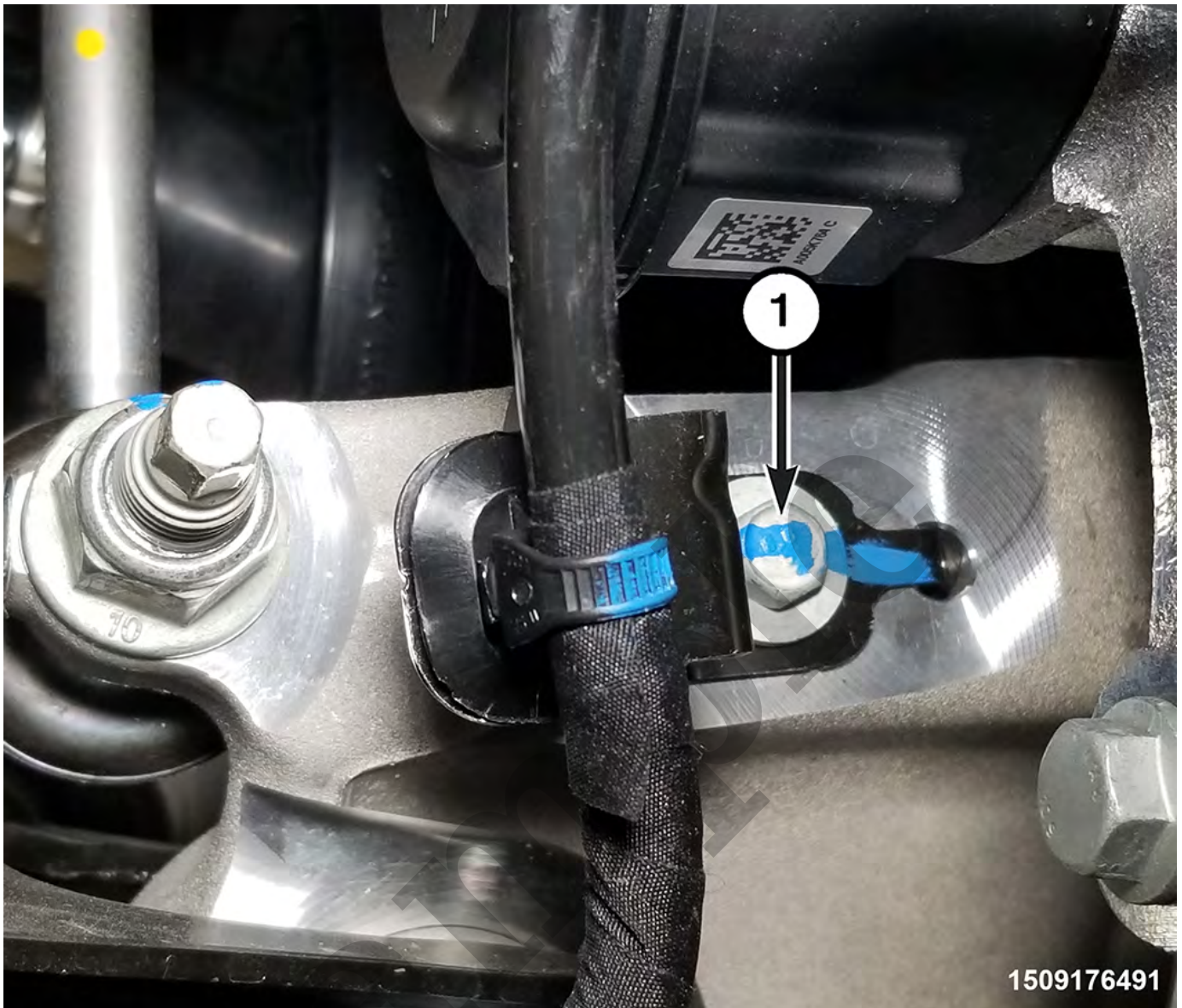

1 - Electric Parking Brake (EPB) Actuator Harness Bracket Bolt

4. Remove the Electric Parking Brake (EPB) actuator harness bracket bolt.
5. Remove the rear brake caliper from the brake caliper adapter and position it aside ([Refer to Brakes, Base/Hydraulic/Mechanical/CALIPER, Disc Brake, Rear/Removal and Installation](#))(Refer To List 1).

NOTE

Do **NOT** disconnect the brake caliper hydraulic fluid hose for service of the rear air spring.

NOTE

In any instance where a bolt is through a rubber bushing, the bolt must be torqued with the vehicle at normal ride height.

1. Support the spring link with a suitable jack.

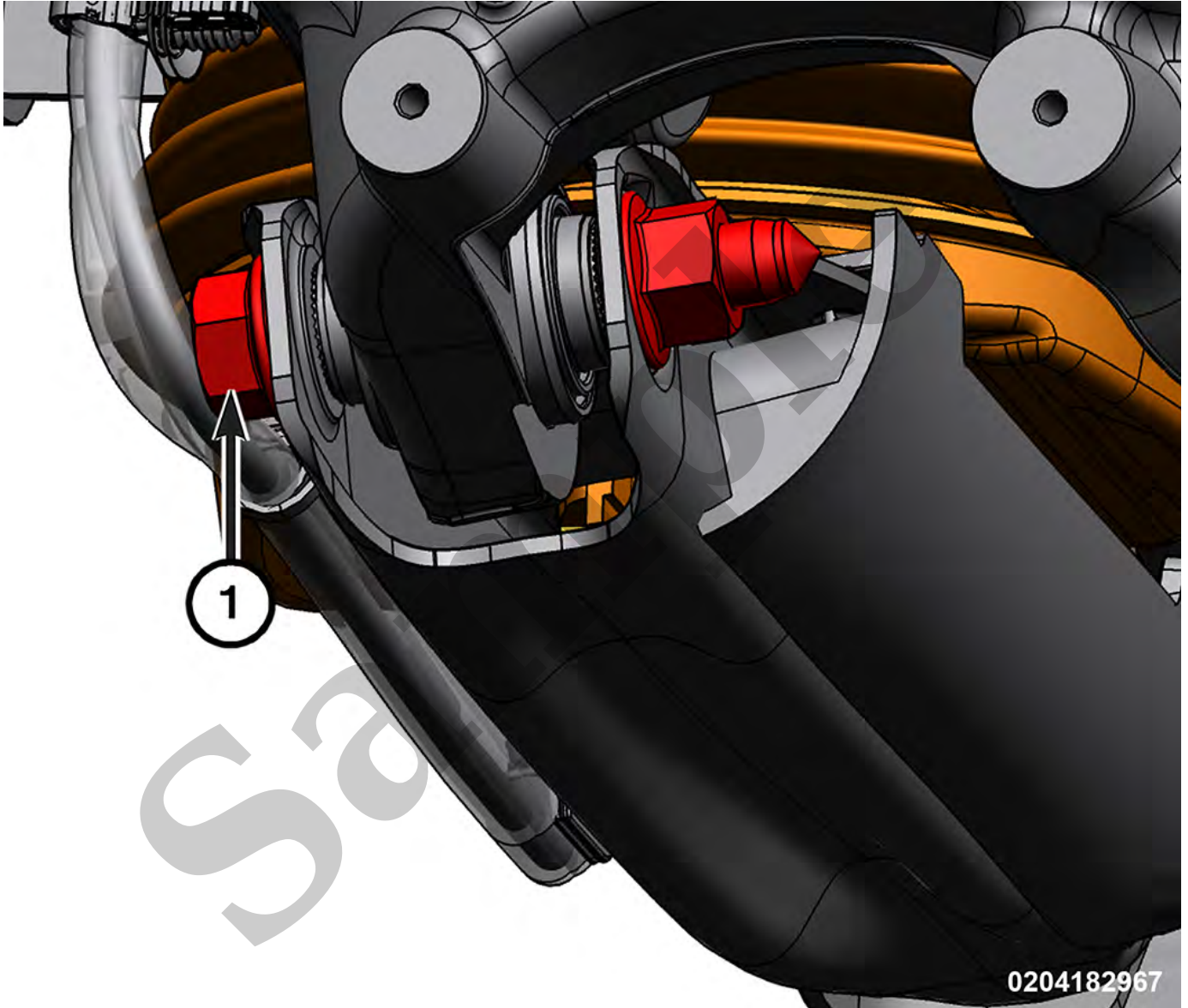

1 - Spring Link Outer Bolt and Nut

2. Position the air spring to the body and to the spring link.
3. Raise the jack to align the spring link to the knuckle, align the bolt holes and install the spring link outer bolt and a **NEW** spring link outer nut, but **do not tighten at this time.**

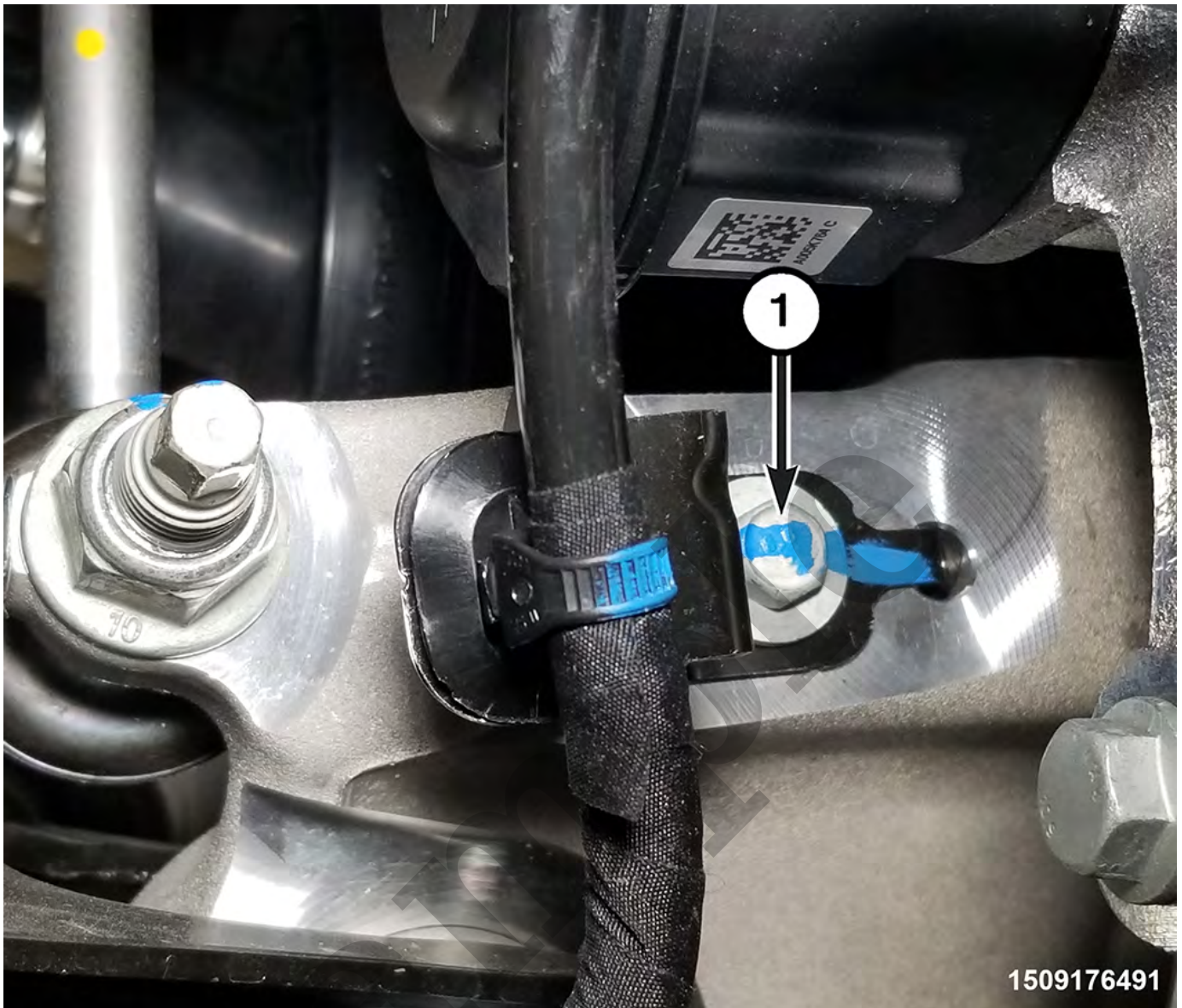

1 - Electric Parking Brake (EPB) Actuator Harness Bracket Bolt

9. Position the EPB actuator harness bracket to the knuckle, then install the Electric Parking Brake (EPB) actuator harness bracket bolt and tighten securely.
10. With a diagnostic scan tool, under the ASCM, perform the following:
 - Perform The Short Fill (until there is 2.5 - 3.0 Bar)
 - Fill Spring From Reservoir
 - Enable Level Control

NOTE

| | | | |
|----|-----------------------------|-------------------------------|--|
| 2 | Toe Link Stud | 35 N·m (26 Ft. Lbs.) | Do not reuse these fasteners. If removed, a new fastener must be installed and tightened to specifications. |
| 3 | Tension Link Inner Bolt | 100 N·m (74 Ft. Lbs.) | Fastener must be torqued with the vehicle at normal ride height. |
| 4 | Camber Link Inner Bolt | 185 N·m (136 Ft. Lbs.) | Fastener must be torqued with the vehicle at normal ride height. |
| 5 | Camber Link Outer Bolt | 200 N·m (148 Ft. Lbs.) | Fastener must be torqued with the vehicle at normal ride height. |
| 6 | Tension Link Outer Bolt | 145 N·m (107 Ft. Lbs.) | Fastener must be torqued with the vehicle at normal ride height. |
| 7 | Hub and Bearing Bolts | 160 N·m (118 Ft. Lbs.) | — |
| 8 | Spring Link Outer Bolt | 185 N·m (136 Ft. Lbs.) | Fastener must be torqued with the vehicle at normal ride height. |
| 9 | Compression Link Outer Bolt | 190 N·m (140 Ft. Lbs.) | Fastener must be torqued with the vehicle at normal ride height. |
| 10 | Toe Link Outer Bolt | 200 N·m (148 Ft. Lbs.) | Fastener must be torqued with the vehicle at normal ride height. Do not reuse these fasteners. If removed, a new fastener must be installed and tightened to specifications. |
| 11 | Spring Link Inner Nut | 190 N·m (140 Ft. Lbs.) | Fastener must be torqued with the vehicle at normal ride height. |
| 12 | Compression Link Inner Bolt | 170 N·m (125 Ft. Lbs.) | Fastener must be torqued with the vehicle at normal ride height. |

Refer To List:

List 1

- [05 - Brakes / Hydraulic/Mechanical / CALIPER, Disc Brake, Front / Removal and Installation](#)

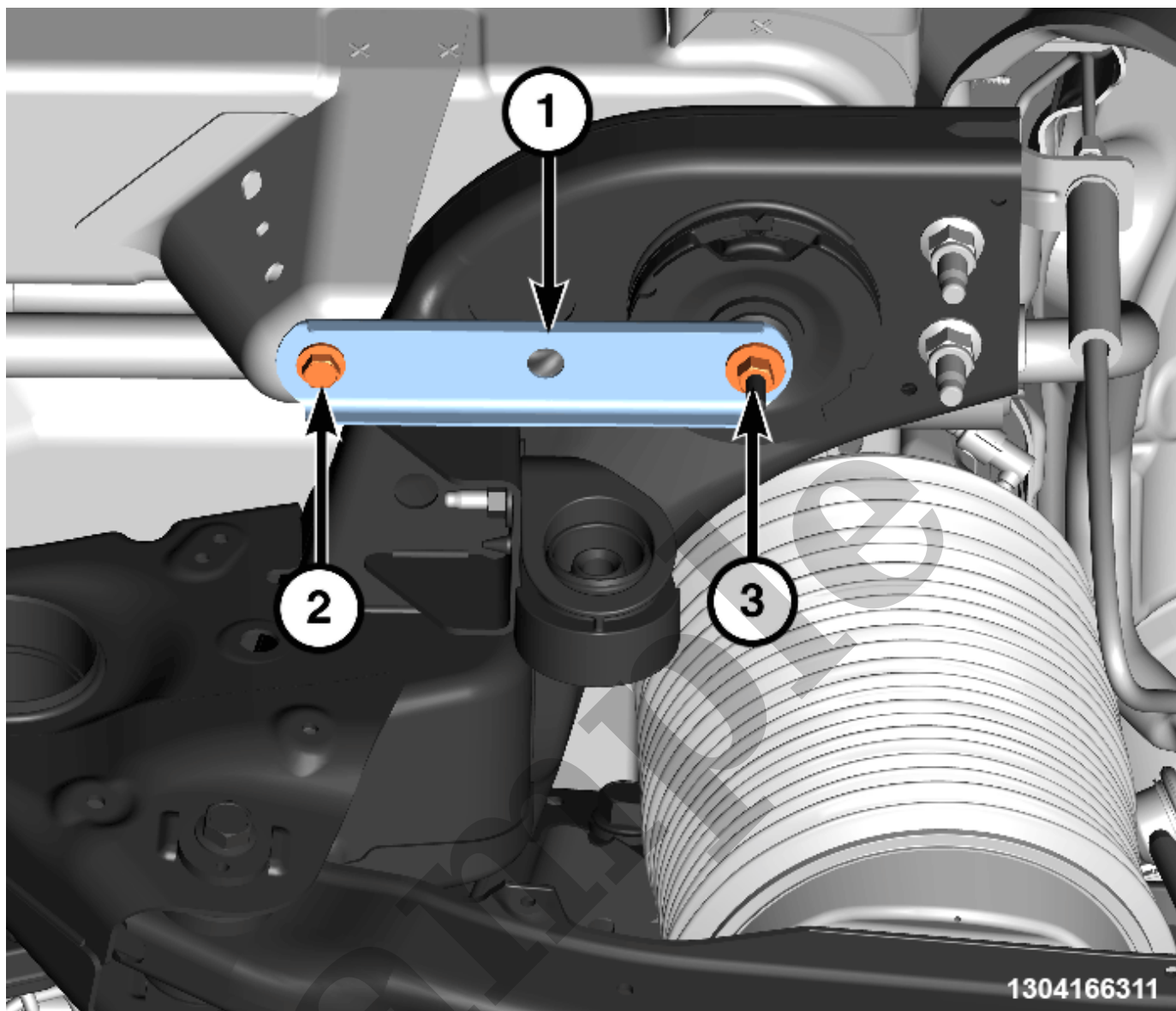

| |
|---|
| 1 - Rear Crossmember - Rear Support Bracket |
| 2 - Bolt |
| 3 - Nut |

9. Remove the bolt and nut, and remove the rear crossmember rear support bracket.

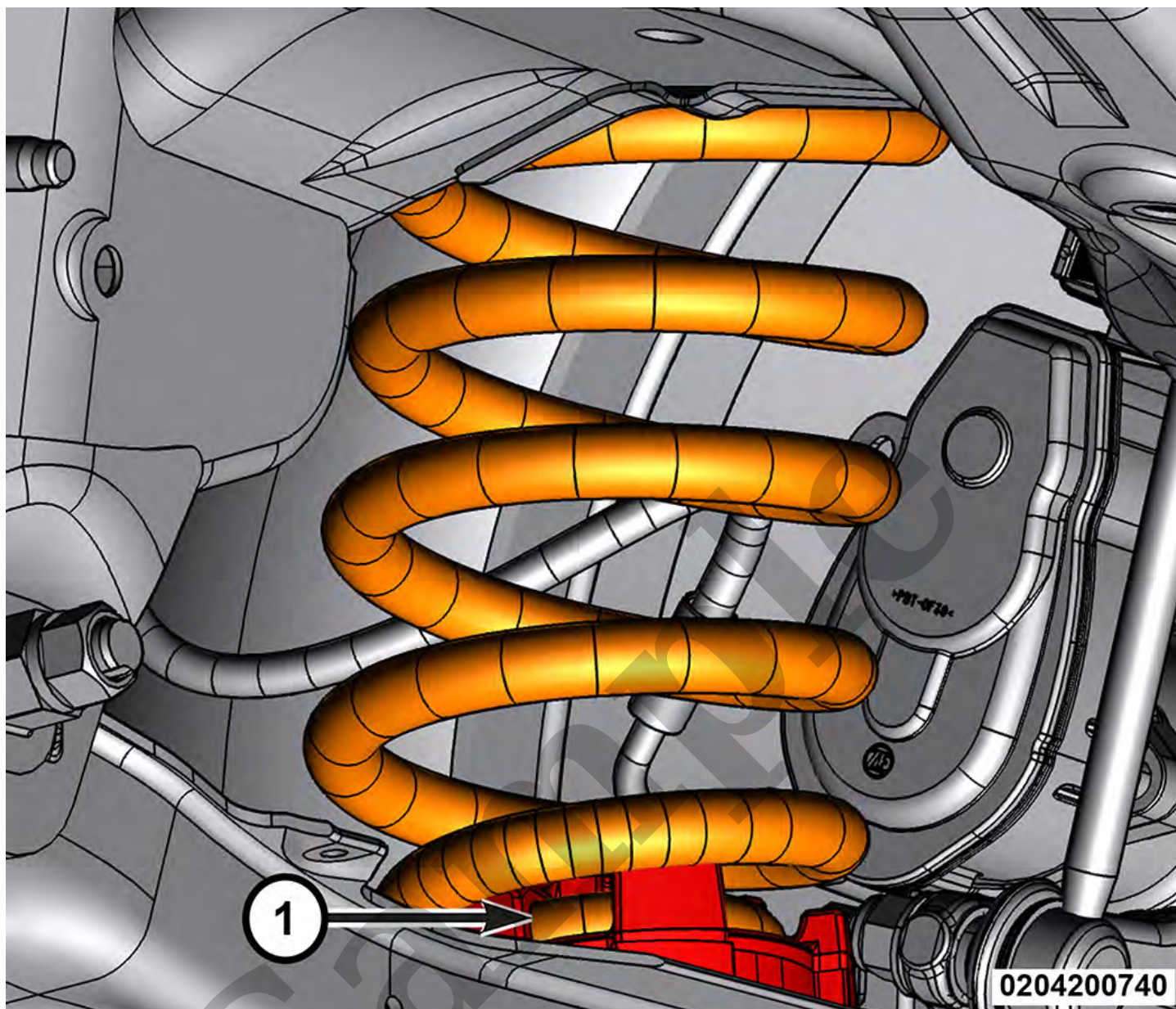

1 - Lower Isolator Spring Stop

- The top of the coil spring must be seated flat against the upper isolator and the lower spring end must be as tight as possible against the lower isolator spring stop. The gap between the lower spring end and the lower isolator spring stop must not exceed 10mm (0.39 Inch).
- Use the marks to secure the rear suspension crossmember in the same position.
- Perform the wheel alignment standard procedure ([Refer to Front Suspension/Wheel Alignment/Toe Set/Standard Procedure](#)).

TORQUE SPECIFICATIONS - REAR SUSPENSION