

Your Ultimate Source for OEM Repair Manuals

FactoryManuals.net is a great resource for anyone who wants to save money on repairs by doing their own work. The manuals provide detailed instructions and diagrams that make it easy to understand how to fix a vehicle.

2015 NISSAN Navara / Frontier King Cab OEM Service and Repair Workshop Manual

[Go to manual page](#)

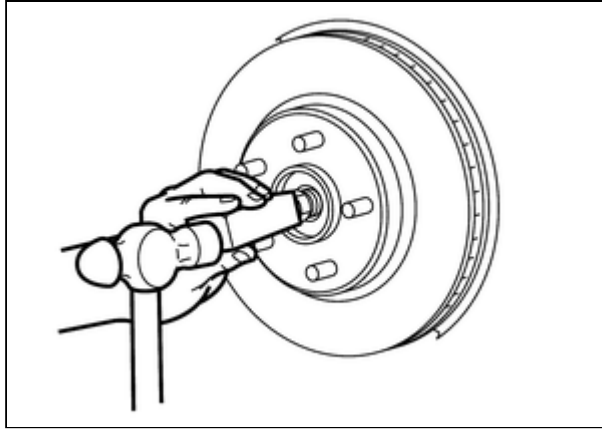

RPR-002005799-04-PDIF0320ZZ



NOTE:

Use suitable puller, if wheel hub and bearing assembly and drive shaft cannot be separated even after performing the above procedure.

7 Remove wheel hub and bearing assembly.

CAUTION:

Remove parking brake assembly only when necessary.

8 Remove back plate.

9 Remove hub cap.

10 Remove the rear drive shaft from transaxle assembly.

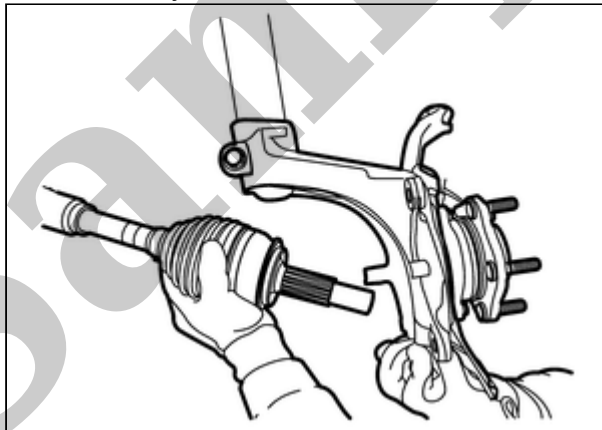

RPR-002005799-05-000312426

CAUTION:

- Never place drive shaft joint at an extreme angle.
- Be careful not to overextend slide joint.

11 Remove the rear drive shaft from the rear final drive.

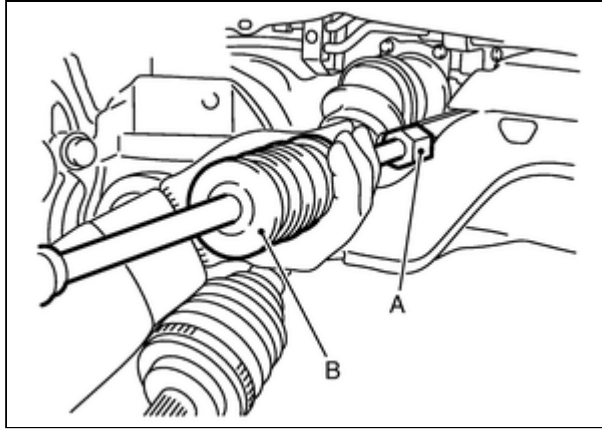

RPR-002005799-02-PDIF0004ZZ

- Use the drive shaft attachment (A) (SST: KV40107500) and a sliding hammer (B) while inserting tip of the drive shaft attachment between housing and final drive assembly.

CAUTION:

- Never place drive shaft joint at an extreme angle when removing drive shaft. Also be careful not to overextend slide joint.
- Confirm that the circular clip is attached to the drive shaft.

12 Perform inspection after removal. Refer to [Inspection](#).

INSTALLATION

Note the following, and install in the reverse order of removal.

CAUTION:

Always replace side oil seal with new one when installing drive shaft. Refer to [Removal & Installation](#).

RH SIDE

- Install New O-ring to link shaft.

CAUTION:

- Apply grease (MOLYKOTE BR2 plus corresponding) to all length and around (A) of the spline.

Amount paste

0.5– 1.2 g (0.04 – 0.10 oz)

- Insert drive shaft and slide the slide joint of drive shaft like a hammering to securely install it.

CAUTION:

- Upon set insertion, O-ring must not be damaged.

WARNING:

Check the circle is properly engaged. Improper engagement can cause housing assembly to remove from the reducer while vehicle is running, leading to damage to drive shaft, loss of driving force, accidents, and serious injury.

CAUTION:

- To check that circlip is properly engaged, make sure that the drive shaft does not come off even when housing ① of the drive shaft is held and pulled toward the axle (→).

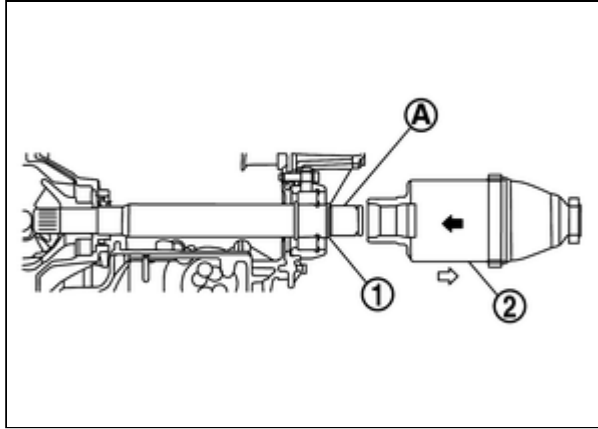

RPR-002005799-08-000406394

LH SIDE

When inserting drive shaft, attach a protector (special tool: KV38107900) (A) to oil seal to prevent damage to the side oil seal of the reducer. Then, insert drive shaft and slide the slide joint of drive shaft like a hammering to securely install it.

WARNING:

Check that circlip is properly engaged. Improper engagement can cause housing assembly to remove from the reducer while vehicle is running, leading to damage to drive shaft, loss of driving force, accidents, and serious injury.

CAUTION:

- To check that circlip is properly engaged, make sure that the drive shaft does not come off even when housing ① of the drive shaft is held and pulled toward the axle (→).

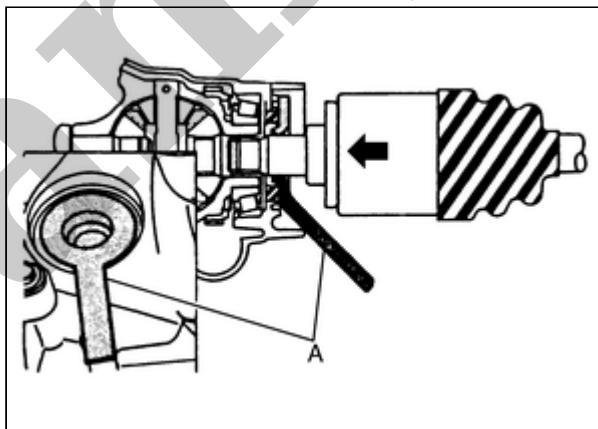

RPR-002005799-10-PDIF0023ZZ

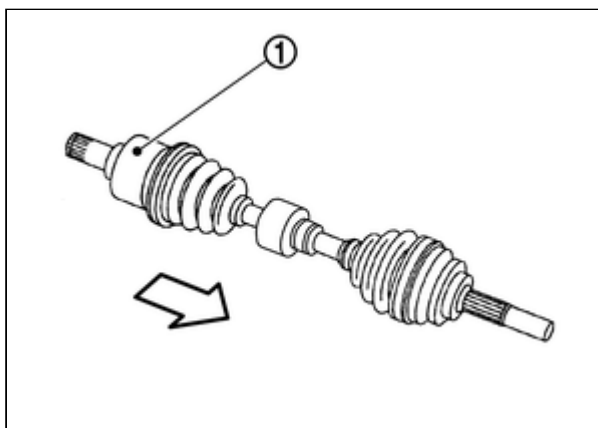

RPR-002005799-18-SDIB0898ZZ

- Align the matching marks (A) made during removal when reusing the disc rotor.

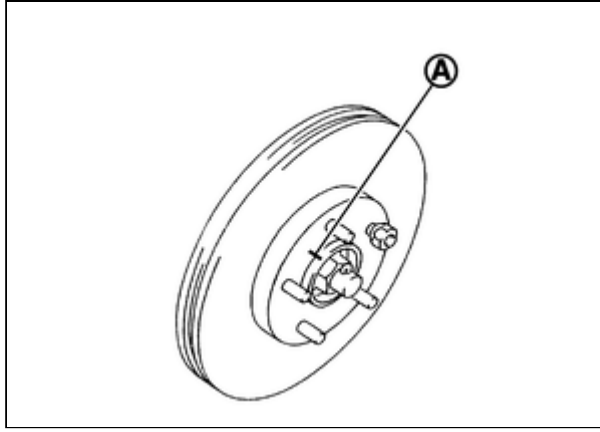

RPR-002005799-09-PDIG0066ZZ

- Perform final tightening of bolts and nuts at suspension arm (rubber bushing), under unladen conditions with tires on level ground.
- Tighten the wheel hub lock nut to the specified torque. Refer to [Exploded View](#).
- Perform inspection after installation. Refer to [Inspection](#).

Sample

DISASSEMBLY

Final Drive Side

1 Fix shaft with a vise.

CAUTION:

Protect shaft using aluminum or copper plates when fixing with a vise.

2 Remove boot bands, and then remove boot from housing.

3 Remove stopper ring.

4 Put matching marks on housing and shaft.

CAUTION:

Use paint or an equivalent for matching marks. Never scratch the surface.

5 Put matching marks **(A)** on the spider assembly and shaft.

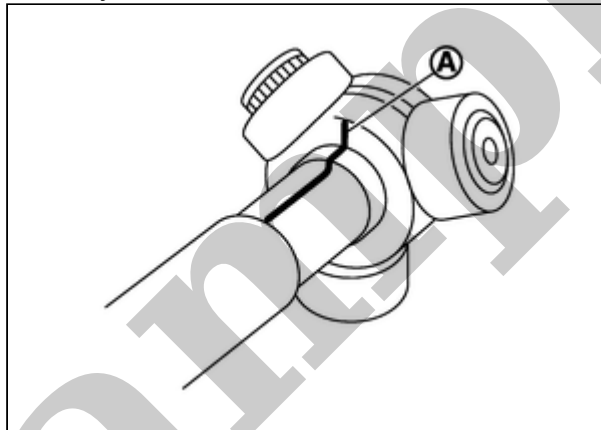

RPR-002005800-01-PDIF0006ZZ

CAUTION:

Use paint or an equivalent for matching marks. Never scratch the surface.

6 Remove snap ring **(1)**, and then remove spider assembly from shaft.

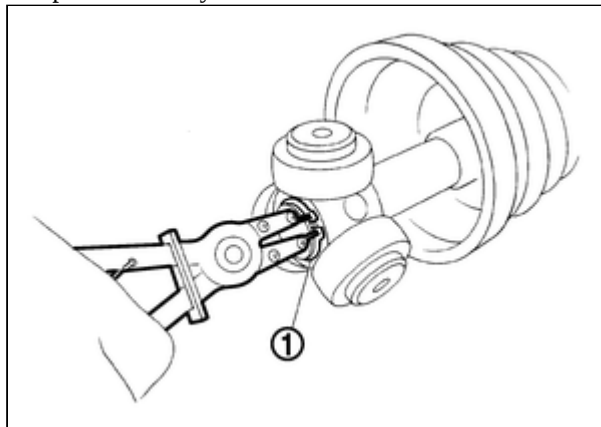

RPR-002005800-02-PDIF0014ZZ

7 Remove boot from shaft.

8 Remove circular clip housing. (For LH drive shaft)

9 Remove dust shield to housing. (For LH drive shaft)

10 Remove old grease on housing with paper towels.

11 Perform inspection after disassembly. Refer to [Inspection](#).

Wheel Side

1 Fix shaft with a vise.

CAUTION:

Protect shaft using aluminum or copper plates when fixing with a vise.

2 Remove boot bands. Then remove boot from joint sub-assembly.

3 Screw drive shaft puller (A) (commercial service tool) into joint sub-assembly screw part to a length 30 mm (1.18 in) or more. Support drive shaft with one hand and pull out joint sub-assembly from shaft.

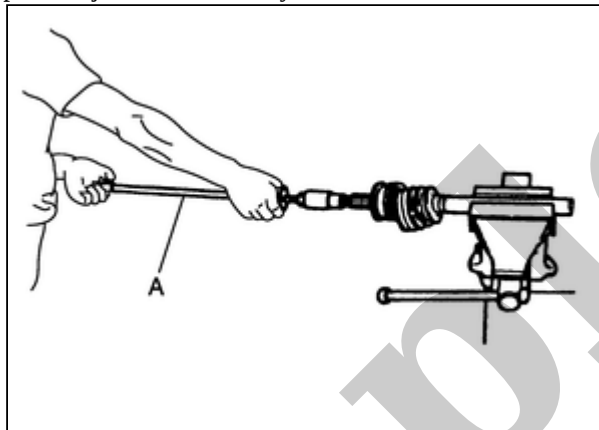

RPR-002005800-10-PDIG0151ZZ

CAUTION:

- If joint sub-assembly cannot be removed after five or more unsuccessful attempts, replace drive shaft assembly.
- Align drive shaft puller and drive shaft and remove them by pulling firmly and uniformly.

4 Remove circular clip from shaft.

CAUTION:

Never reuse circular clip.

5 Remove boot from shaft.

6 Remove old grease on joint sub-assembly with paper towels.

7 Perform inspection after disassembly. Refer to [Inspection](#).

ASSEMBLY

Final drive Side

1 Wrap serration on shaft with tape (A) to protect boot from damage. Install new boot and boot band to shaft.

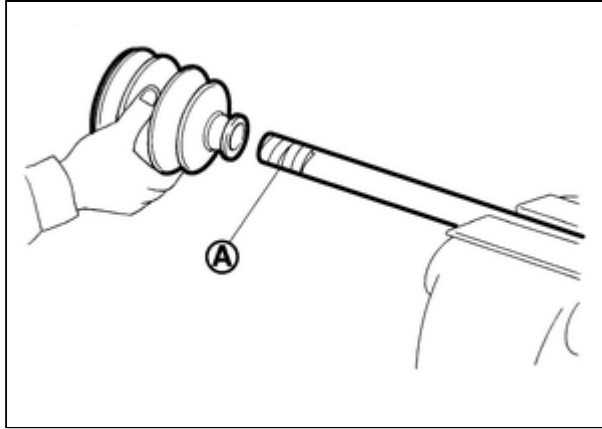

RPR-002005800-05-PDIF0009ZZ

CAUTION:

Never reuse boot and boot band.

2 Remove the tape wrapped around the serrated on shaft.

3 To install the spider assembly ①, align it with the matching marks ① on the shaft ② during the removal, and direct the serration mounting surface ③ to the shaft.

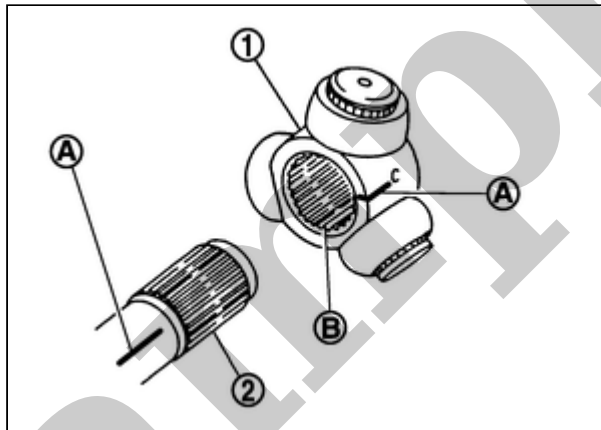

RPR-002005800-06-PDIF0017ZZ

4 Secure spider assembly onto shaft with snap ring ①.

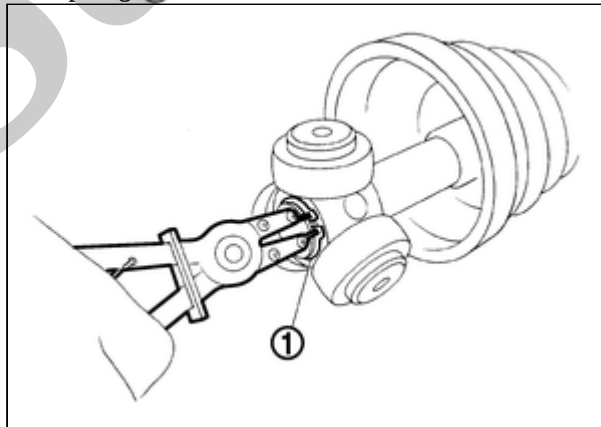

RPR-002005800-07-PDIF0014ZZ

CAUTION:

Never reuse snap ring.

5 Assemble the housing onto spider assembly, and apply the balance of the specified amount grease.

[Standard](#)

[Grease amount](#)

: Refer to [Service Data](#).

6 Install stopper ring.

CAUTION:

Never reuse stopper ring.

7 Align matching marks painted when housing were removed.

8 Install boot securely into grooves (indicated by "*" marks) shown in the figure.

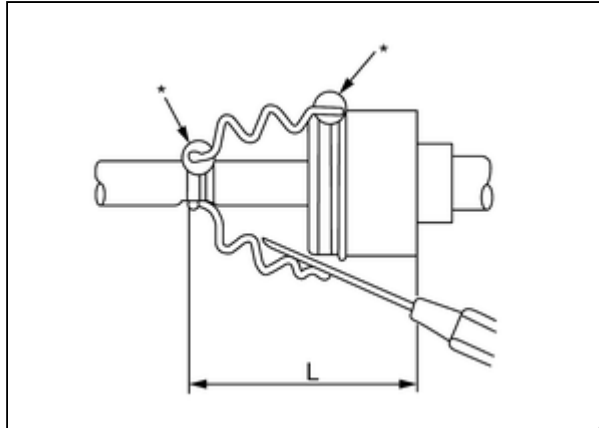

RPR-002005800-08-000406396

CAUTION:

If there is grease on boot mounting surfaces (indicated by "*" marks) of shaft or housing, boot may be removed. Remove all grease from the surfaces.

9 To prevent from deformation of the boot, adjust the boot installation length to the value shown below (L) by inserting the suitable tool into the inside of boot from the large diameter side of boot and discharging inside air.

Standard

L : Refer to [Service Data](#).

CAUTION:

- If the boot installation length exceeds the standard, it may cause breakage in boot.
- Be careful not to touch the inside of the boot with the tip of tool.

10 Install new boot bands securely.

CAUTION:

Never reuse boot band.

- For low profile type band

1. Set boot band to the drive shaft boot groove and temporarily fix pawl (A) of boot band to (B) of boot band.

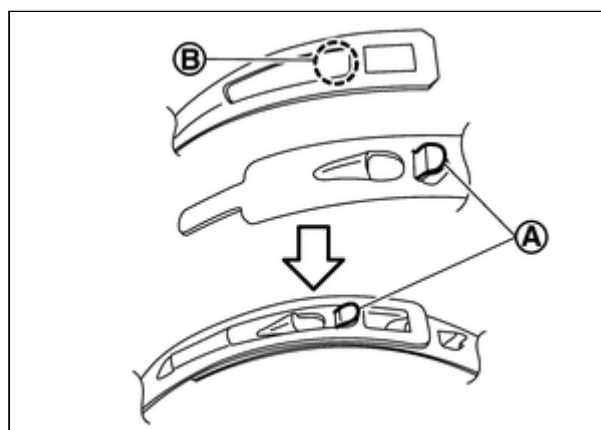

RPR-002005800-03-SDIA6965ZZ

2. Tighten boot band protrusions (B) with boot band crimping tool (SST: KV40107310) (A) in the direction shown by arrows (←).

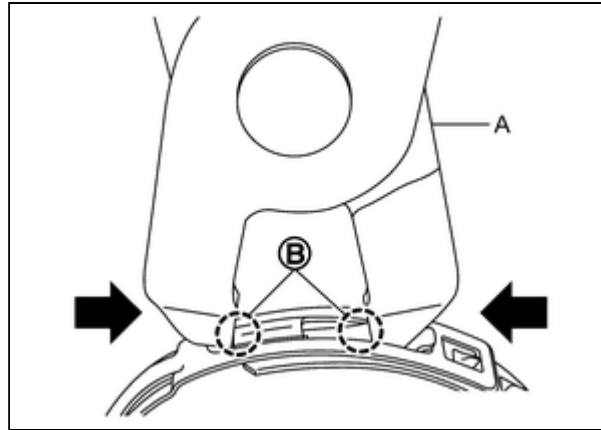

RPR-002005800-09-SDIA6966ZZ

CAUTION:

Securely install boot band (A) to boot band pawl (B).

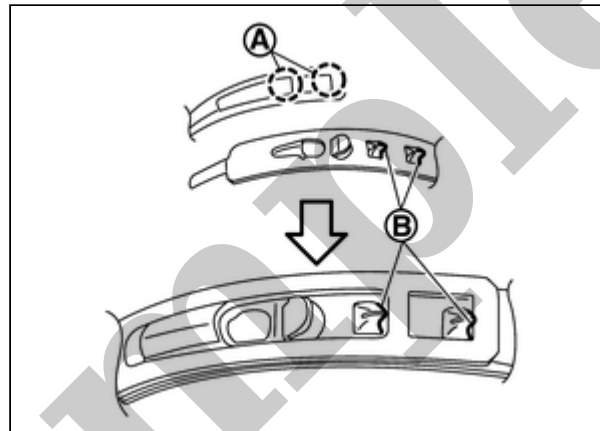

RPR-002005800-14-SDIA6968ZZ

• **For omega type band**

1. Secure the boot bands using the boot band crimping tool (A) (SST: KV40107300).

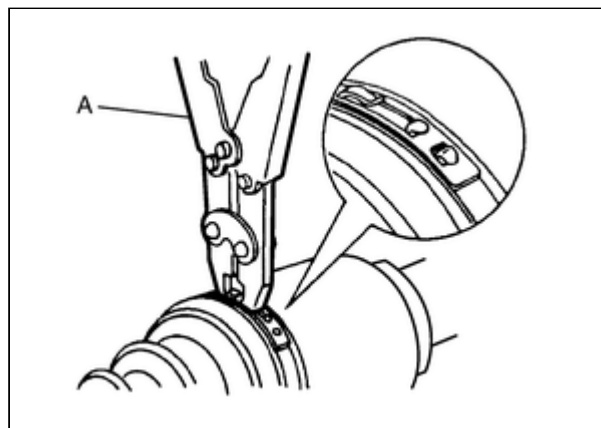

RPR-002005800-15-PDIF0012ZZ

CAUTION:

- Never reuse boot band.
- Boot band claw (A) must be behind the drive direction (←) after assembling.