

Your Ultimate Source for OEM Repair Manuals

FactoryManuals.net is a great resource for anyone who wants to save money on repairs by doing their own work. The manuals provide detailed instructions and diagrams that make it easy to understand how to fix a vehicle.

2015 NISSAN Maxima OEM Service and Repair Workshop Manual

[Go to manual page](#)

Tool name	Description

Sample

Lubricant or/and Sealant

RDE-002037812

Item	Use
Lithium-based grease including molybdenum disulphide	Application to the inside of rear final drive unit input shaft (insertion part of rear traction motor shaft splines)

Sample

SEC. 380

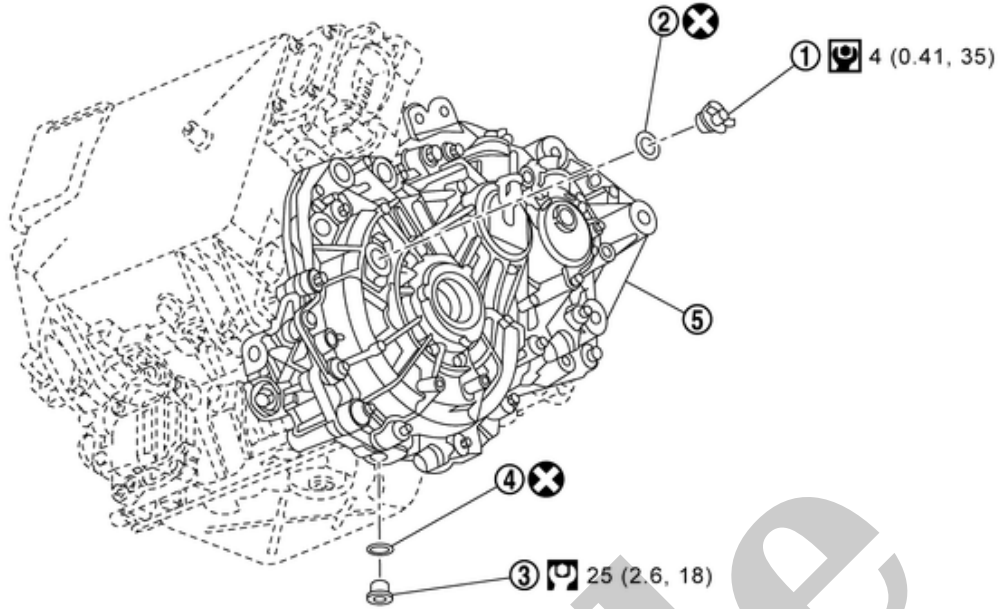

RDE-002020625-01-000416125

①	Filler plug	②	Gasket	③	Drain plug
④	Gasket	⑤	Rear final drive assembly		
: N·m (kg-m, in-lb)					
: N·m (kg-m, ft-lb)					
: Always replace after every disassembly.					



NOTE:

The tightening torque of filler plug ① is a reference.

OIL LEAKAGE

- Remove rear diffuser during working. Refer to [Removal & Installation](#).

Check final drive assembly surrounding area (oil seal, drain plug, and filler plug etc.) for oil leakage.

OIL LEVEL

- Remove rear diffuser during working. Refer to [Removal & Installation](#).

1 Check oil level from filler plug mounting hole as shown in the figure, after removing filler plug ① and gasket from final drive assembly.

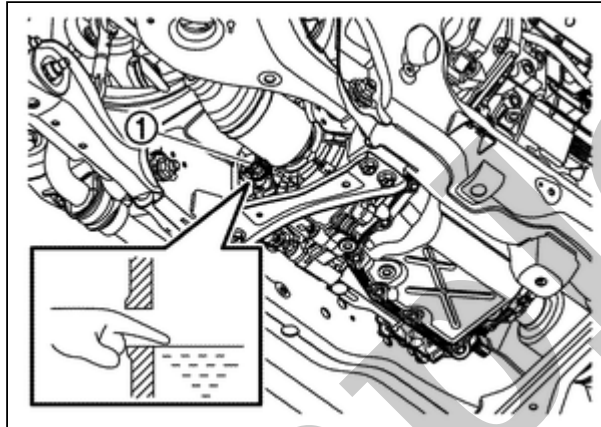

RPR-002037809-01-000416120

CAUTION:

Power switch OFF while checking fluid level.

- Oil level should be level with bottom of filler plug mounting hole. Add gear oil if necessary.

2 Set a gasket on filler plug and install it on final drive assembly.

CAUTION:

Never reuse gasket.

3 Tighten filler plug to the specified torque. Refer to [Exploded View](#).

Draining

RPR-002037806

- Remove rear diffuser during working. Refer to [Removal & Installation](#).

1 Power switch OFF.

2 Remove drain plug ① and gasket, using a socket (commercial service tool) and then drain gear oil.

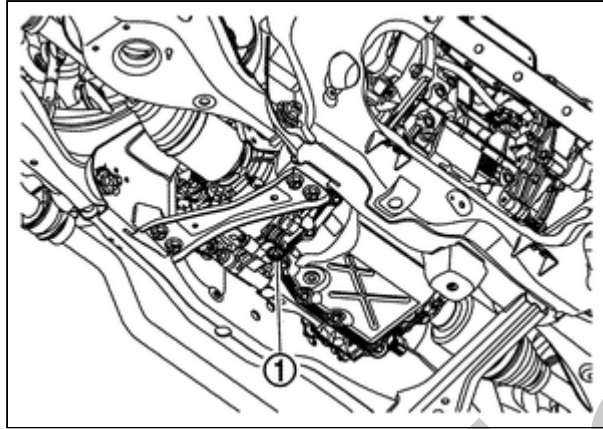

RPR-002037806-01-000416121



NOTE:

Removing filler plug can drain oil efficiently.

3 Set a gasket on drain plug and install it to final drive assembly, using a socket (commercial service tool).

CAUTION:

Never reuse gasket.

4 Tighten drain plug to the specified torque. Refer to [Exploded View](#).

- Remove rear diffuser during working. Refer to [Removal & Installation](#).

1 Fill with new gear oil until oil level reaches the specified level **A** near filler plug mounting hole, after removing filler plug **1** and gasket from final drive assembly.

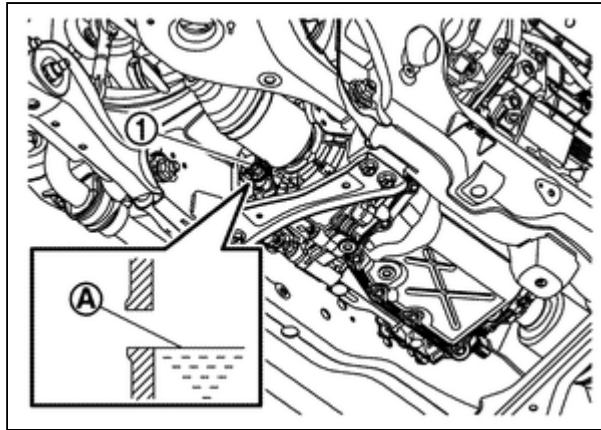

RPR-002037815-01-000416122

[Recommended oil and capacity](#)

: Refer to [MAINTENANCE : Recommended Fluid and Lubricants](#).

2 Leave the vehicle for 3 minutes, and check the oil level again. Refer to [Inspection](#).

3 Set a gasket on filler plug, and install it to final drive assembly.

CAUTION:

Never reuse gasket.

4 Tighten filler plug to the specified torque. Refer to [Exploded View](#).

REAR FINAL DRIVE ASSEMBLY : Exploded View

RDE-002037818

SEC. 380

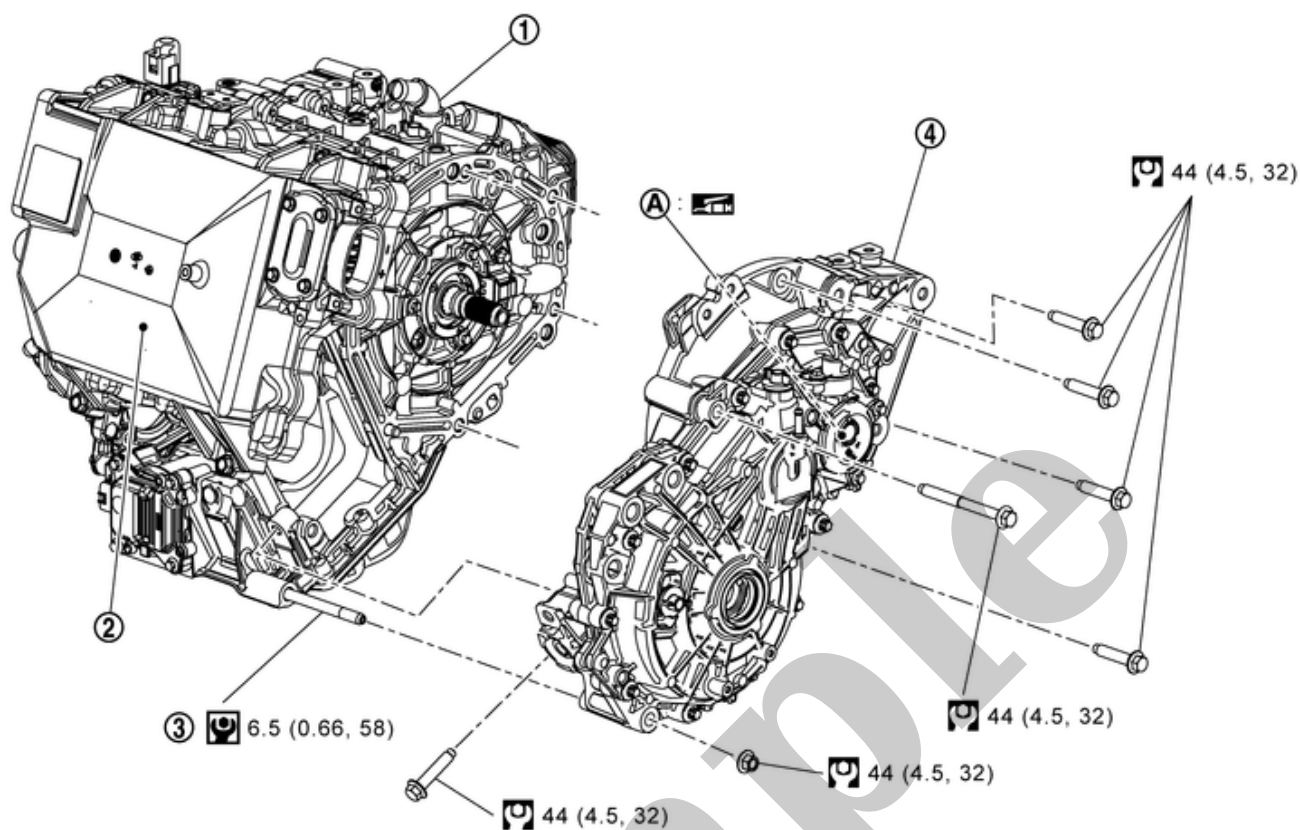

RDE-002019822-01-000416119

①	Rear traction motor	②	Inverter (rear)	③	Stud bolt
④	Rear final drive assembly				
A	Inside of input shaft (insertion part of rear traction motor shaft splines)				
	N·m (kg-m, in-lb)				
	N·m (kg-m, ft-lb)				
	Apply lithium-based grease including molybdenum disulphide.				

REMOVAL

- 1 Drain the gear oil. Refer to [Draining](#).
- 2 Remove rear suspension member assembly together with rear final drive assembly and rear traction motor with inverter (rear) from vehicle. Refer to [REAR SUSPENSION MEMBER : Removal & Installation](#).
- 3 Remove rear final drive assembly, rear traction motor and inverter (rear) as a set from rear suspension member assembly. Refer to [Removal and Installation](#).
- 4 Remove rear final drive air breather hose. Refer to [REAR FINAL DRIVE AIR BREATHER : Removal & Installation](#).
- 5 Remove rear motor mounting insulator assembly (front side) ① and rear motor mounting insulator assembly (left side) ②. Refer to [Removal and Installation](#).

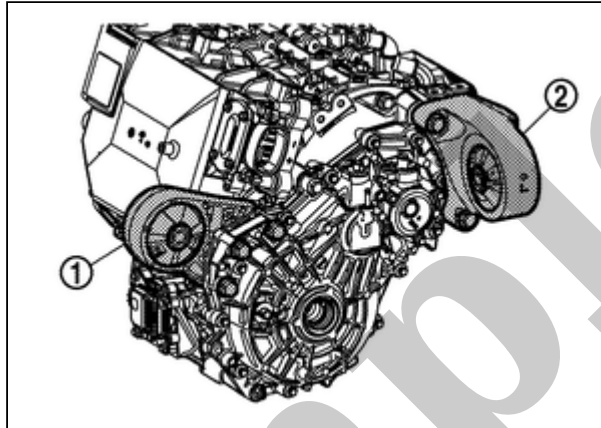

RPR-002037810-01-000422677

- 6 Remove the bolts (A) and a nut (B) that fasten rear final drive assembly ① and rear traction motor.

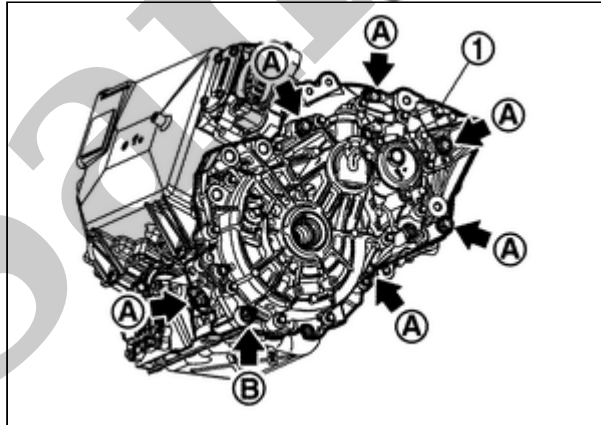

RPR-002037810-03-000422678

- 7 Remove rear final drive assembly ① from rear traction motor.

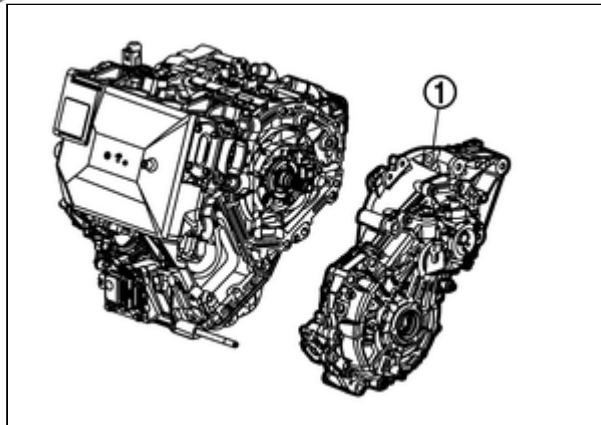

RPR-002037810-05-000422679

INSTALLATION

Note the following, and install in the reverse order of removal.

- For each tightening torque, refer to [REAR FINAL DRIVE ASSEMBLY : Exploded View](#).
- Check fitting of dowel pins (A) on rear traction motor side of rear final drive installation surface, and remove any moisture, oil, or foreign material from matching surface on rear traction motor and rear final drive.

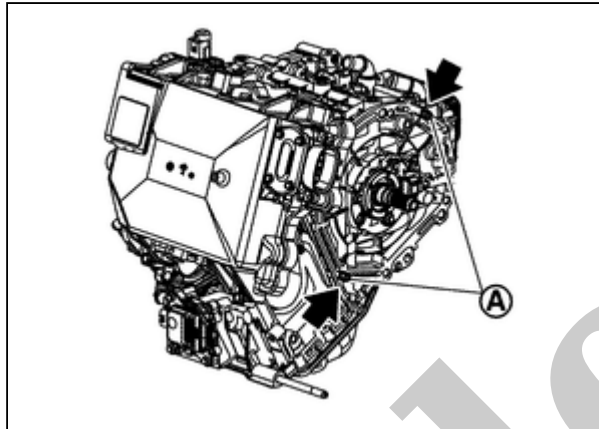

RPR-002037810-04-000422680

- Before installing rear final drive assembly to rear traction motor, apply recommended grease to the inside of rear final drive input shaft (insertion part of rear traction motor shaft splines), as per the following procedure.
 - For applying grease, refer to [REAR FINAL DRIVE ASSEMBLY : Exploded View](#).
- 1. Clean rear traction motor shaft splines and inside of rear final drive input shaft to remove old grease and powder arisen from abrasion.
- 2. Inject the specified amount of recommended grease into the rear final drive input shaft back side (greasing part: (A)).

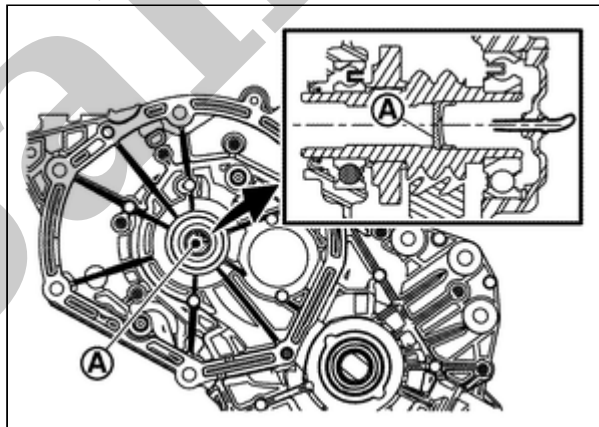

RPR-002037810-02-000425514

Specified grease amount

: 3.5 ±0.5 g (0.12 ±0.018 oz)

CAUTION:

Be sure not to exceed specified amount of grease. Excessive grease may overflow during installing and break the O-ring.

- When removing rear final drive assembly from rear traction motor, replace O-ring of rear traction motor shaft. Refer to [Exploded View](#).
- When installing rear final drive assembly (1) to rear traction motor (2), align markings (A) on rear final drive input shaft and rear traction motor shaft.