

Your Ultimate Source for OEM Repair Manuals

FactoryManuals.net is a great resource for anyone who wants to save money on repairs by doing their own work. The manuals provide detailed instructions and diagrams that make it easy to understand how to fix a vehicle.

2015 NISSAN 370Z Coupe OEM Service and Repair Workshop Manual

[Go to manual page](#)



Touching high voltage components without using the appropriate protective equipment will cause electrocution.



4. Remove the DC/DC converter inlet hose ①.

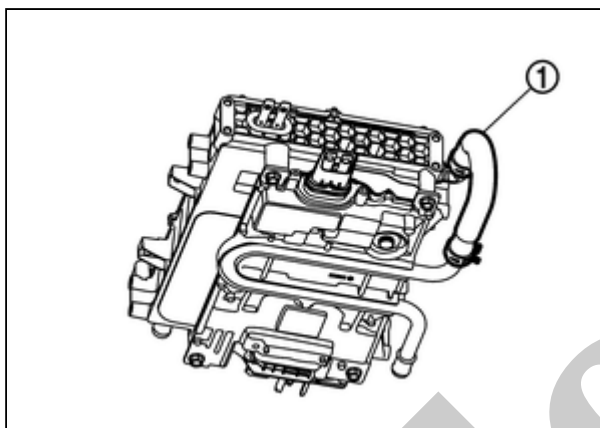

RPR-001980215-01-000346784

DANGER:



Touching high voltage components without using the appropriate protective equipment will cause electrocution.



CAUTION:

Touching high voltage components without using the appropriate protective equipment will cause electrocution.

5. Remove the DC/DC converter mounting bolts (A), and remove the DC/DC converter ② from the on-board charger ①.
Refer to [DC/DC CONVERTER : Disassembly & Assembly](#).

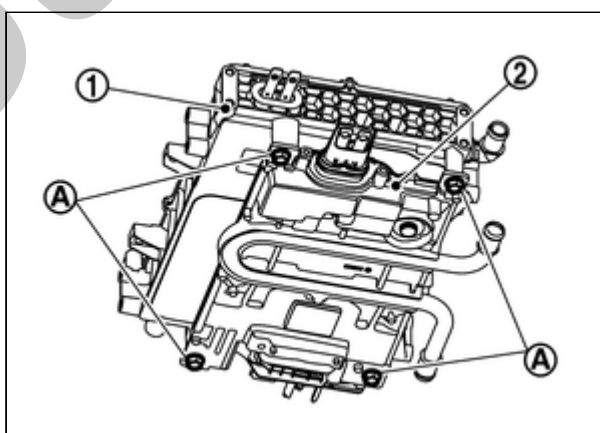

RPR-001980215-02-000346785

DANGER:



Touching high voltage components without using the appropriate protective equipment will cause electrocution.



INSTALLATION

Install in the reverse order of removal.

Sample

EXPLODED VIEW

SEC. 290•291

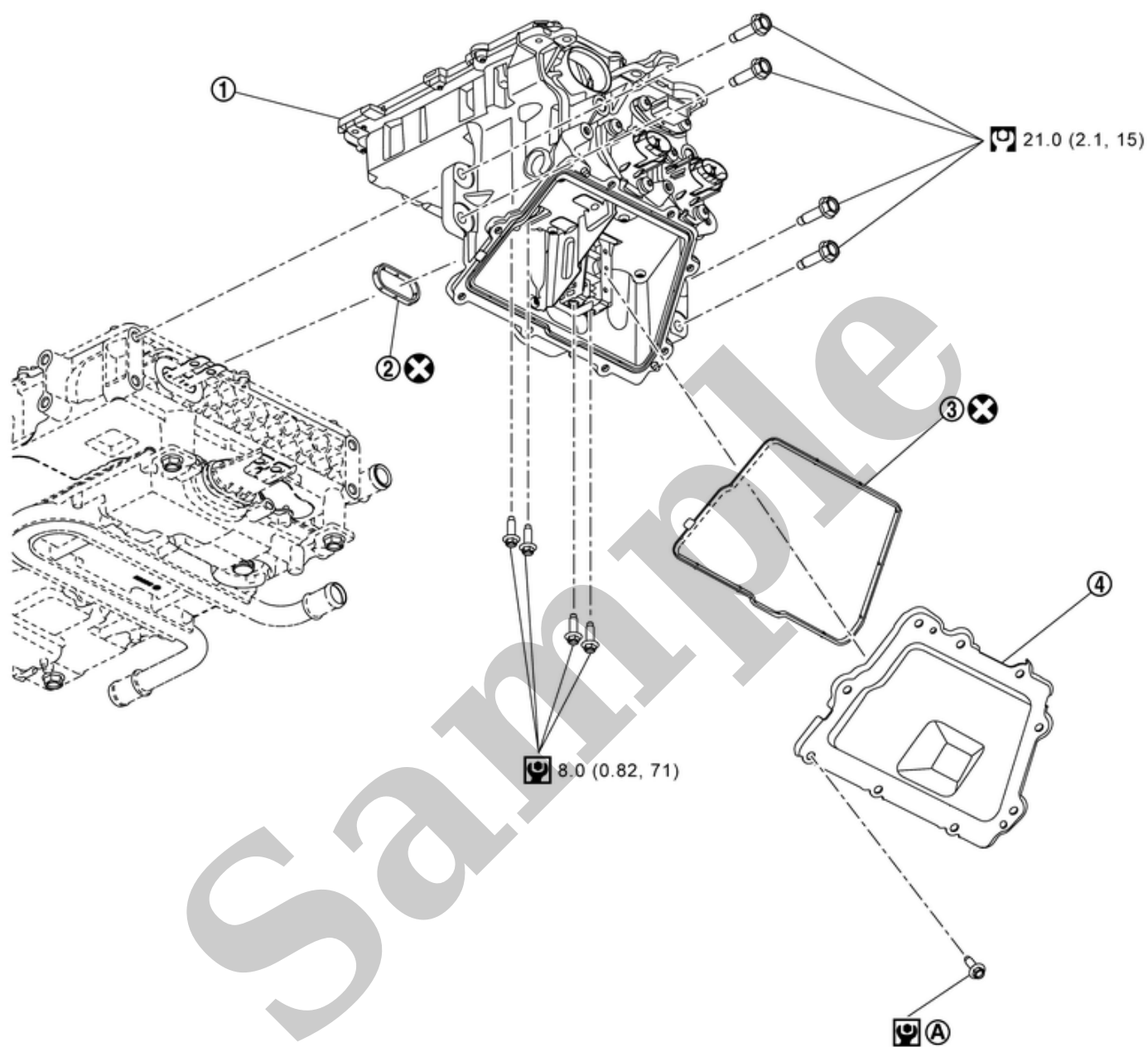

RDE-001980214-01-000372713

①	High voltage junction box	②	Gasket	③	Gasket
④	High voltage junction box cover				
Ⓐ	Perform tightening by following the installation instructions. Refer to HIGH VOLTAGE JUNCTION BOX : Disassembly & Assembly .				
⊗	: Always replace after every disassembly.				
Ⓒ	: N·m (kg-m, ft-lb)				
Ⓓ	: N·m (kg-m, in-lb)				

DANGER:

Since hybrid vehicles and electric vehicles contain a high voltage battery, there is the risk of electric shock, electric leakage, or similar accidents if the high voltage component and vehicle are handled incorrectly. Be sure to follow the correct work procedures when performing inspection and maintenance.

WARNING:

- Be sure to remove the service plug in order to disconnect the high voltage circuits before performing inspection or maintenance of high voltage system harnesses and parts.
- The removed service plug must always be carried in a pocket of the responsible worker or placed in the tool box during the procedure to prevent the plug from being connected by mistake.
- Be sure to wear insulating protective equipment consisting of glove, shoes, face shield and glasses before beginning work on the high voltage system.
- Never allow workers other than the responsible person to touch the vehicle containing high voltage parts. To keep others from touching the high voltage parts, these parts must be covered with an insulating sheet except when using them.
- Refer to [HIGH VOLTAGE PRECAUTIONS : Precautions](#).

CAUTION:

Never bring the vehicle into the READY status with the service plug removed unless otherwise instructed in the Service Manual. A malfunction may occur if this is not observed.

REMOVAL

WARNING:

Disconnect high voltage. Refer to [HOW TO DISCONNECT HIGH VOLTAGE : Precautions](#).

1. Check voltage in high voltage circuit. (Check that condenser are discharged.)

DANGER:

Touching high voltage components without using the appropriate protective equipment will cause electrocution.



2. Remove the high voltage power delivery assembly. Refer to [HIGH VOLTAGE POWER DELIVERY ASSEMBLY : Removal & Installation](#).

DANGER:

Touching high voltage components without using the appropriate protective equipment will cause electrocution.



3. Follow the procedure below and remove the high voltage junction box cover.

1. Loosen the high voltage junction box cover mounting bolts in the order of 9 → 1 in the figure.

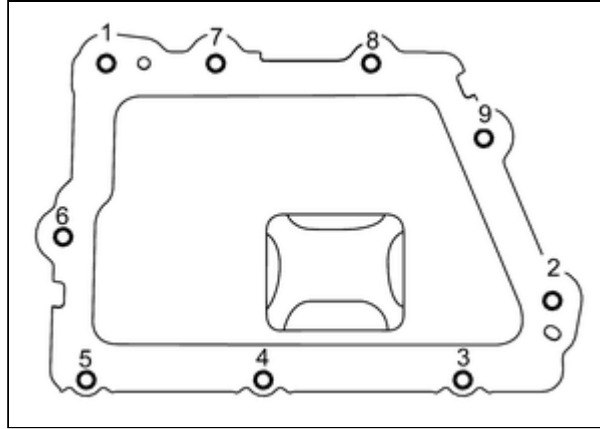

RPR-001980213-01-000369927

2. Remove the high voltage junction box cover ①.

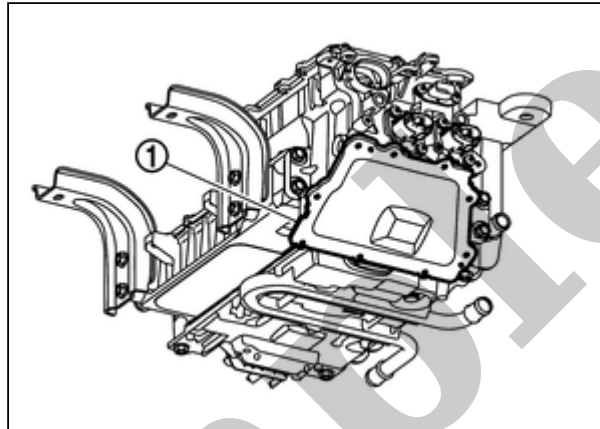

RPR-001980213-02-000346780

4. Remove the DC/DC converter mounting bolts (A) and on-board charger mounting bolts (B).

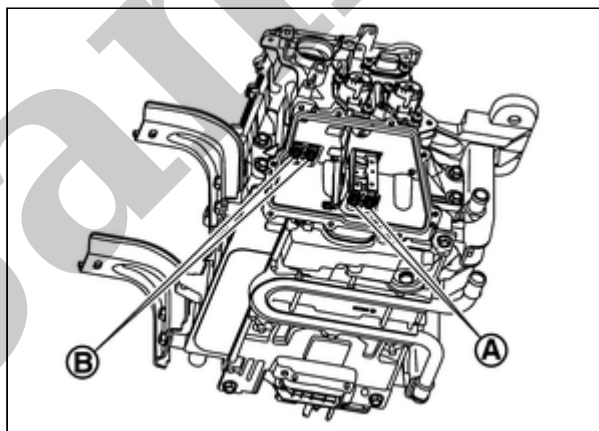

RPR-001980213-03-000346782

DANGER:



Touching high voltage components without using the appropriate protective equipment will cause electrocution.



5. Remove the high voltage junction box mounting bolts (A) , and remove the high voltage junction box ①.

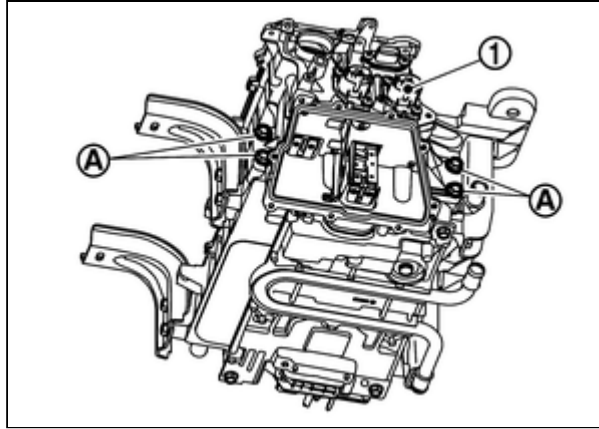

RPR-001980213-04-000346783

DANGER:



Touching high voltage components without using the appropriate protective equipment will cause electrocution.



INSTALLATION

Note the followings, and install in the reverse order of removal.

1. Follow the procedure below and install the high voltage junction box cover.
 1. Temporary tighten the high voltage junction box cover mounting bolts in the order of 1 → 9 in the figure.

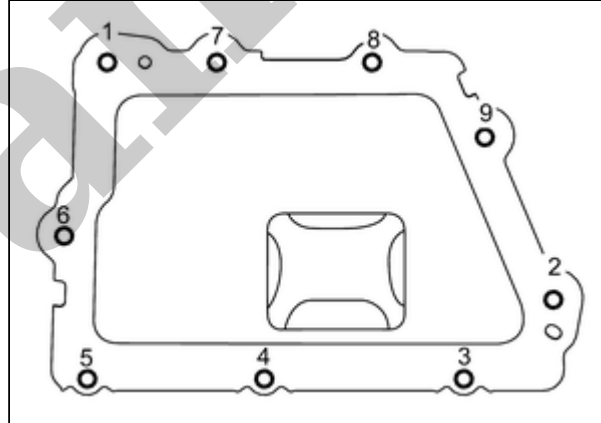

RPR-001980213-05-000369927

2. Tighten to the specified torque in the order of 1 → 9 in the figure.

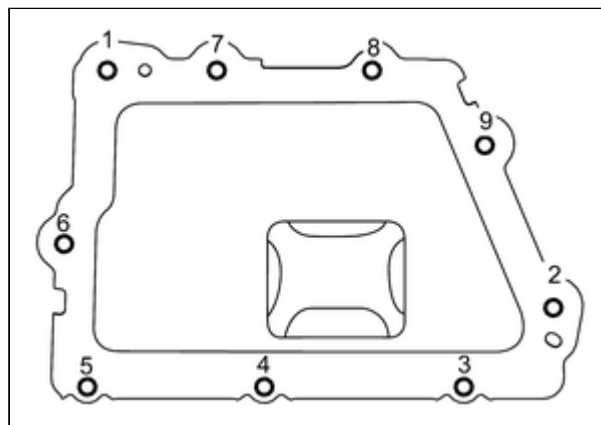

RPR-001980213-06-000369927

High voltage junction box cover mounting bolts 	:8.0 N·m(0.82 kg-m, 71 ft-lb)
--	-------------------------------

Sample

SEC. 253

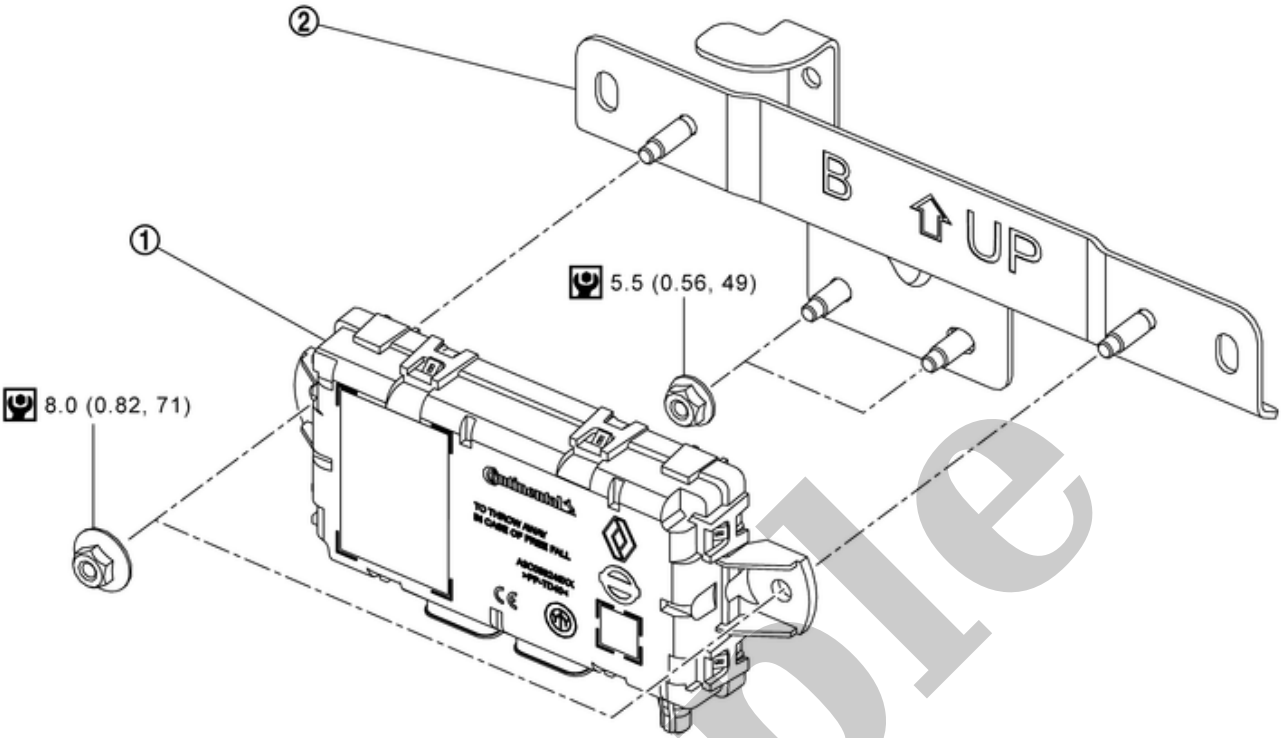

RDE-001920509-01-000377114

①	CPLC	②	CPLC bracket		
	: N·m (kg-m, in-lb)				

CAUTION:

- Discard any CPLC that has been dropped from a height and use a new one.
- When the CPLC was replaced, make sure to perform the tasks listed in "ADDITIONAL SERVICE WHEN REPLACING CPLC". Refer to [Work Procedure](#).

1 Remove instrument lower cover center ①.

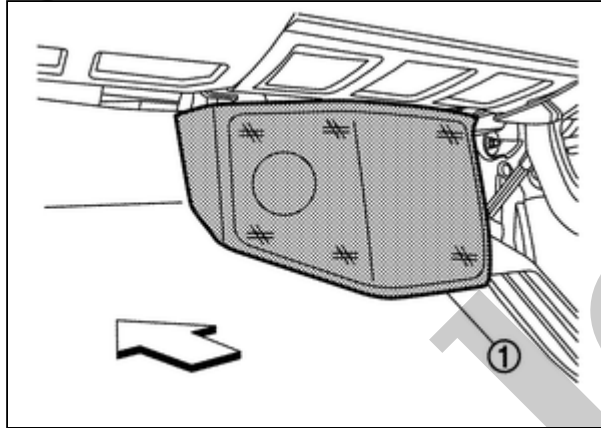

RPR-001932078-01-000346811

2 Remove RH front kicking plate. Refer to [Removal & Installation](#).

3 Remove RH dash side finisher. Refer to [Removal & Installation](#).

4 Turn up the front right side of the floor carpet.

5 Remove front floor spacer RH. Refer to [Exploded View](#).

6 Remove the CPLC installing nut ① and remove the CPLC harness connector ②.

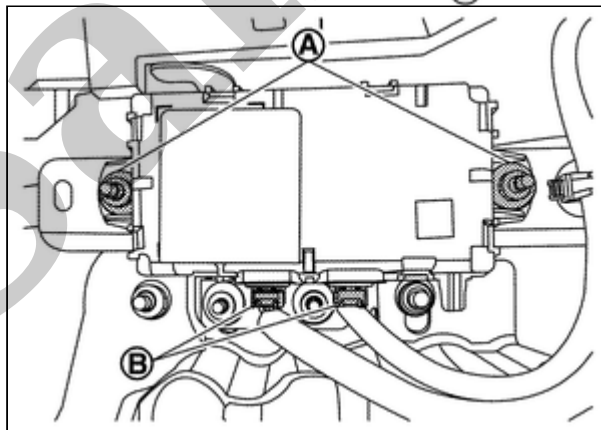

RPR-001932078-02-000377115

7 Remove the CPLC bracket installing nut. (If necessary)