

# Your Ultimate Source for OEM Repair Manuals

FactoryManuals.net is a great resource for anyone who wants to save money on repairs by doing their own work. The manuals provide detailed instructions and diagrams that make it easy to understand how to fix a vehicle.

## 2015 CHEVROLET Suburban OEM Service and Repair Workshop Manual

[Go to manual page](#)

YOUR CURRENT VEHICLE

# Inside Rearview Mirror Replacement

Inside Rearview Mirror Replacement (With UE1)

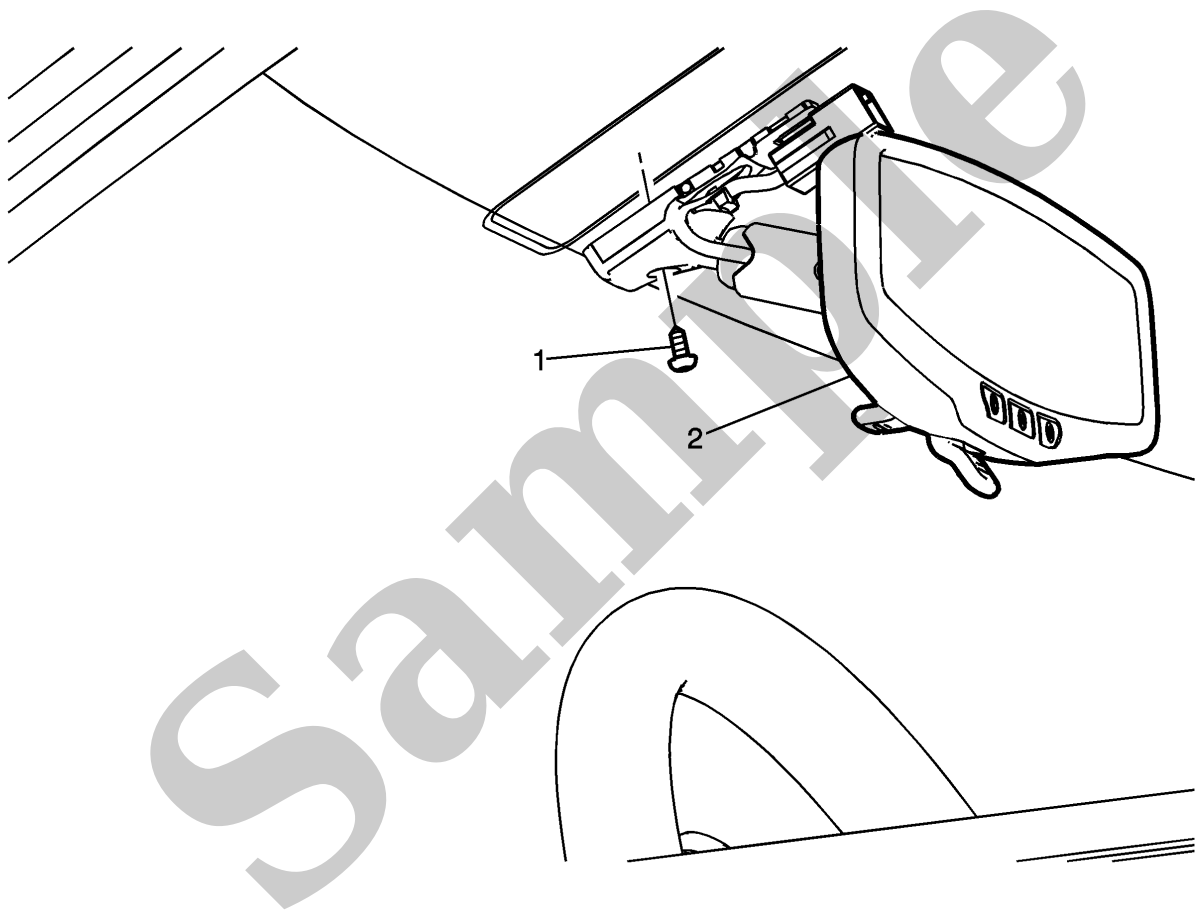

## Inside Rearview Mirror Replacement

Callout	Component Name
WARNING	
Warning	



6. Connect a 3 A fused jumper wire between the test points:Signal circuit terminal 1&Ground circuit terminal 2

7. Verify the scan tool parameter:Trunk Lid/Liftgate Window Exterior Unlatch Switch=Active

- **If not the specified state**

- 1. Ignition/Vehicle » Off & Remove » Jumper wire(s)

- 2. Disconnect the electrical connector:K9 Body Control Module

- 3. Ignition » On / Vehicle » In Service Mode

- 4. Test for less than 1 V between the test points:Signal circuit terminal 1@Component harness&Ground

- If 1 V or greater » Repair the short to voltage on the circuit.

- If less than 1 V

- 5. Ignition/Vehicle » Off

- 6. Test for less than 2  $\Omega$  between the test points:Signal circuit terminal 1@Component harness&Terminal 14 X7@Control module harness

- If 2  $\Omega$  or greater » Repair the open/high resistance in the circuit.

- If less than 2  $\Omega$  » Replace the component:K9 Body Control Module

- **If the specified state**

8. Test or replace the component:S46B Liftgate Unlatch Switch

## Component Testing

1. Ignition/Vehicle » Off

2. Disconnect the electrical connector:S46B Liftgate Unlatch Switch

3. Test for infinite resistance between the test points:Signal terminal 1&Ground terminal 2—The switch is in the open position.

- **If less than infinite resistance**

- Replace the component:S46B Liftgate Unlatch Switch

- **If infinite resistance**

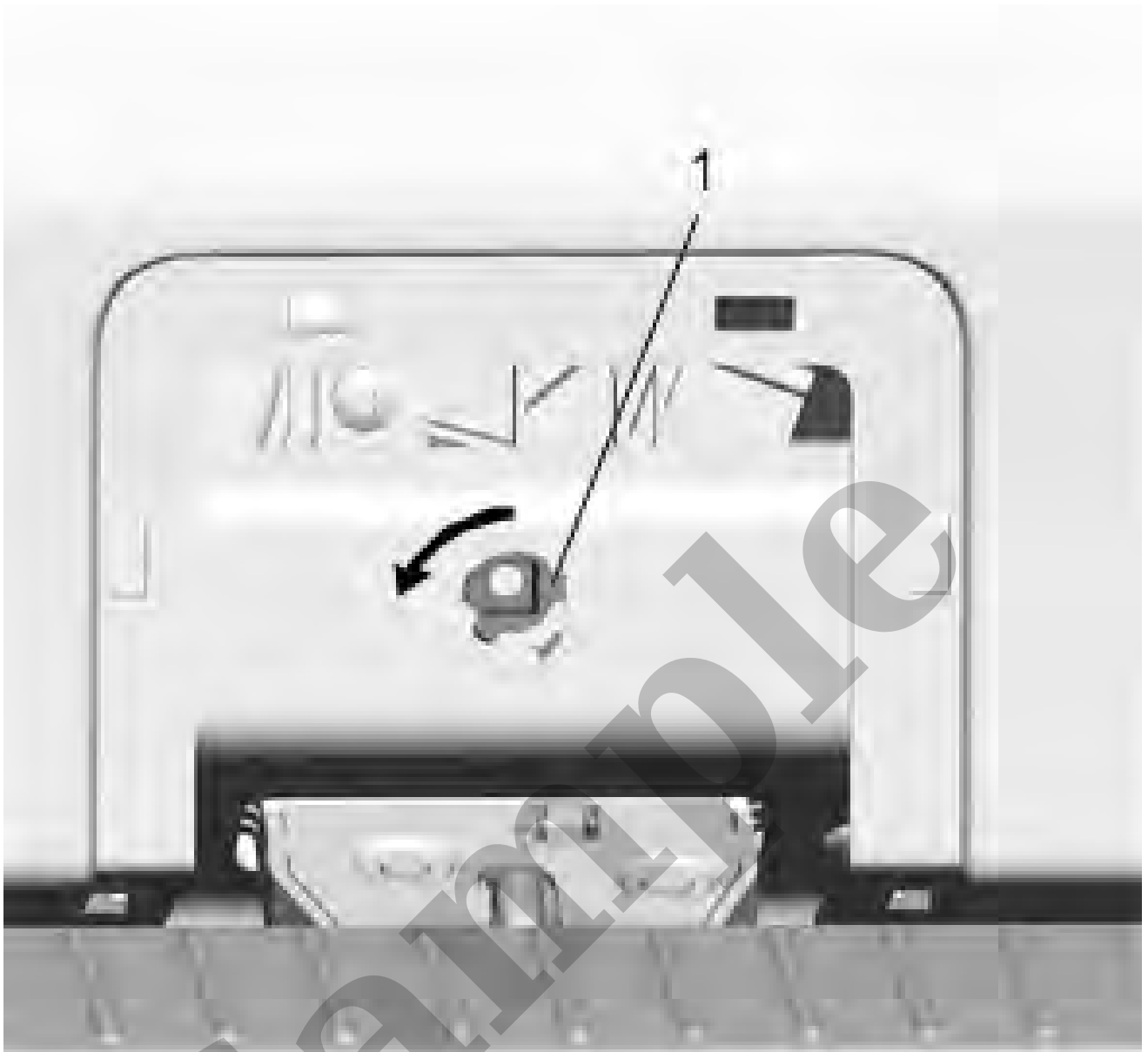

3.

#### NOTE

##### Note

Gate may not open this point, continue to next step.

#### NOTE

##### Note

Rotation to release latch should be approximately 30 degrees. Excessive rotation can cause damage to the latch.

YOUR CURRENT VEHICLE

# Windshield Washer Solvent Container Replacement

Windshield Washer Solvent Container Replacement (Cadillac)

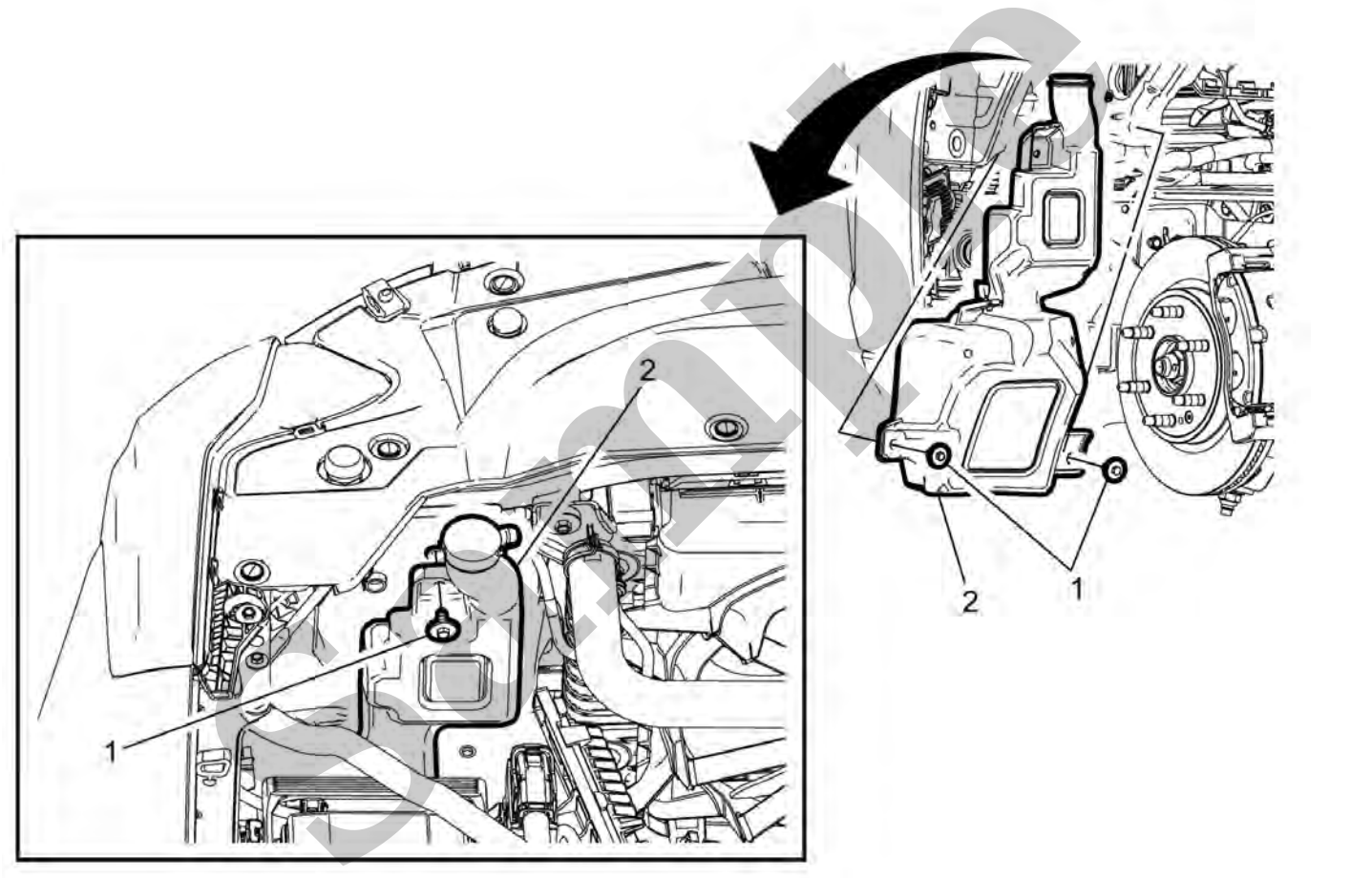

## Windshield Washer Solvent Container Replacement

Callout	Component Name
<p><b>Preliminary Procedure</b></p> <p>1. Remove the front wheelhouse liner-left side. Refer to <a href="#">Front Wheelhouse Liner Replacement - Left Side</a>.</p> <p>2. Remove the auxiliary battery tray. Refer to <a href="#">Auxiliary Battery Tray Replacement</a>.</p>	



## Circuit/System Verification

### NOTE

#### Note

Since most occurrences of this DTC are caused by excessive ABS or traction control usage, review with the customer the conditions under which the DTC set.

1. Ignition ON.
2. Verify that DTC C0186, C0187, C0196, C0287, or C0710 is not set.
  - **If any of the DTCs are set**  
Refer to [Diagnostic Trouble Code \(DTC\) List - Vehicle](#).
  - **If none of the DTCs are set**
3. Ignition OFF, allow the hydraulic brake pressure modulator to cool down to ambient temperature.
4. Ignition ON.
5. Verify that DTC C0274 54, C0275 54, or C0280 54 are not set while driving the vehicle within normal braking conditions.
  - **If any of the DTCs are set**  
Replace the K17 Electronic Brake Control Module with Brake Pressure Modulator.
  - **If none of the DTCs are set**
6. All OK.

## Repair Instructions

Perform the [Diagnostic Repair Verification](#) after completing the repair.

- [Brake Pressure Modulator Valve Replacement](#)
- [Control Module References](#) for electronic brake control module replacement, programming and setup

# Vehicle Dynamics Sensor Replacement

## Vehicle Dynamics Sensor Replacement (Cadillac without DCK)

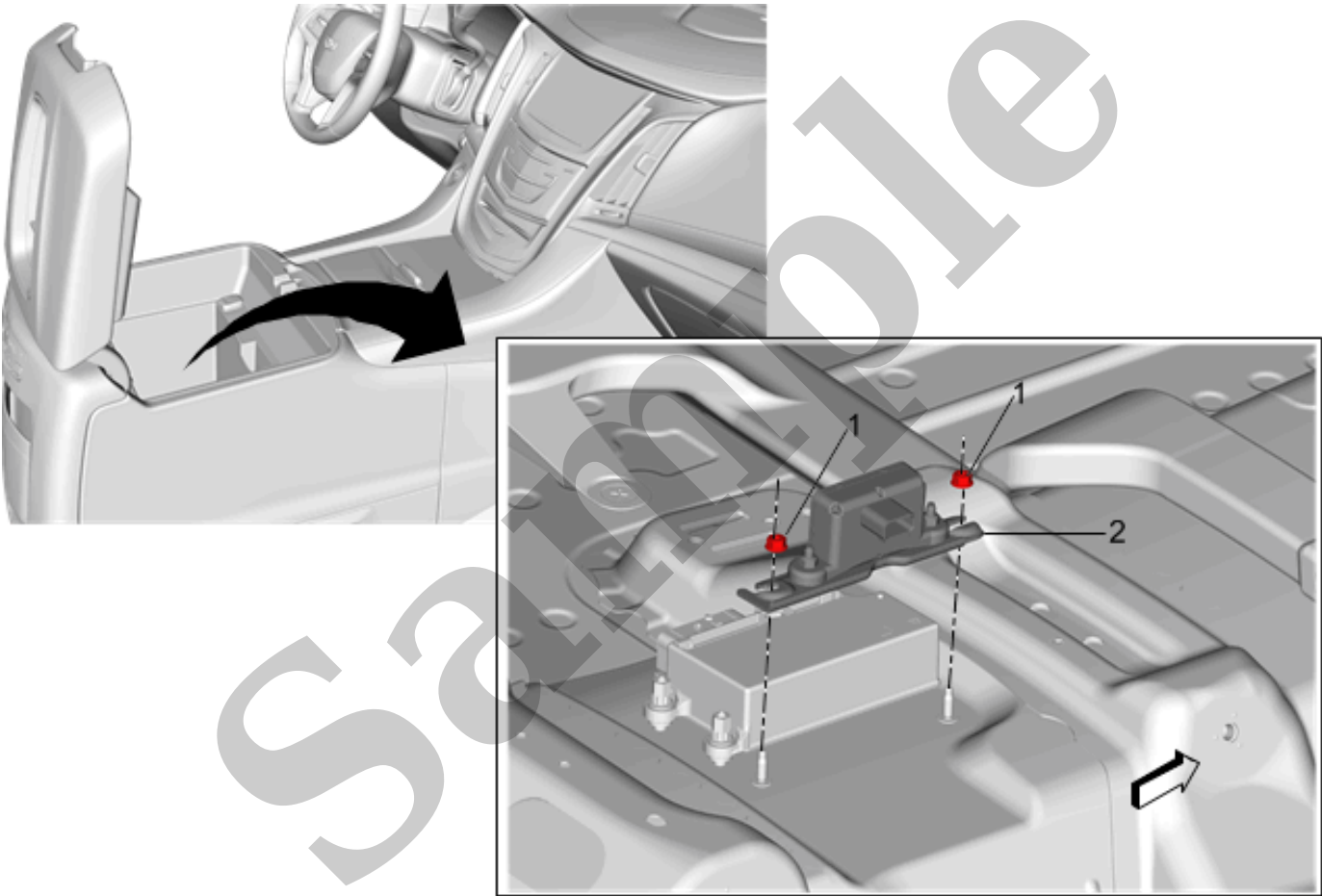

### Vehicle Dynamics Sensor Replacement

Callout	Component Name
<b>Preliminary Procedures</b> <ol style="list-style-type: none"> <li>1. Turn the ignition OFF.</li> <li>2. Remove the front floor console front compartment. Refer to <a href="#">Front Floor Console Front Compartment Replacement</a>.</li> </ol>	



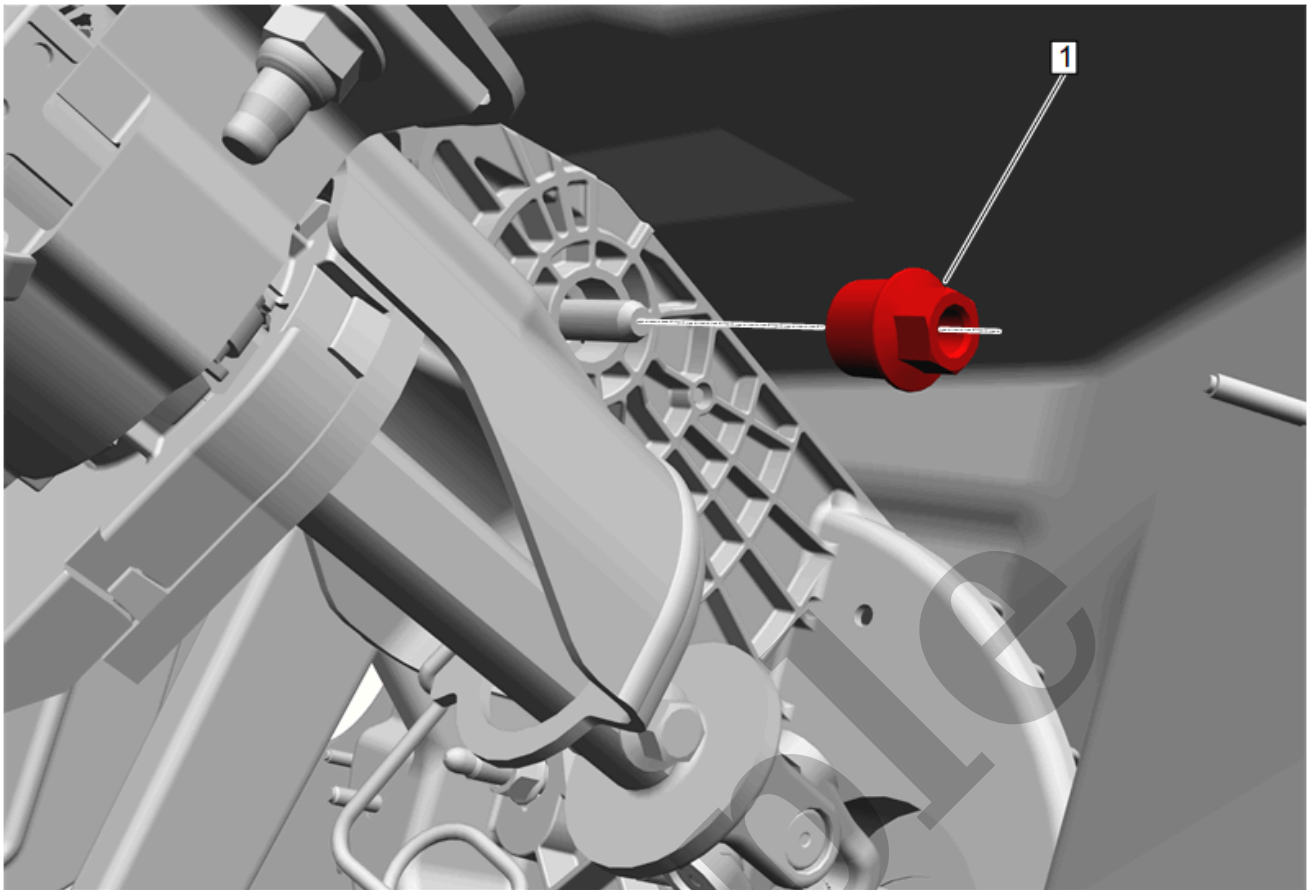

6.

#### CAUTION

##### Caution

Refer to [Fastener Caution](#).

While holding the brake pedal pivot bolt stationary, install the brake pedal pivot nut (1) and tighten to **26 N·m (19 lb ft)**.

7. Apply a thin coat of high temperature lubricant to the brake pedal pivot pin. [Adhesives, Fluids, Lubricants, and Sealers](#)
8. Connect the power brake booster pushrod.



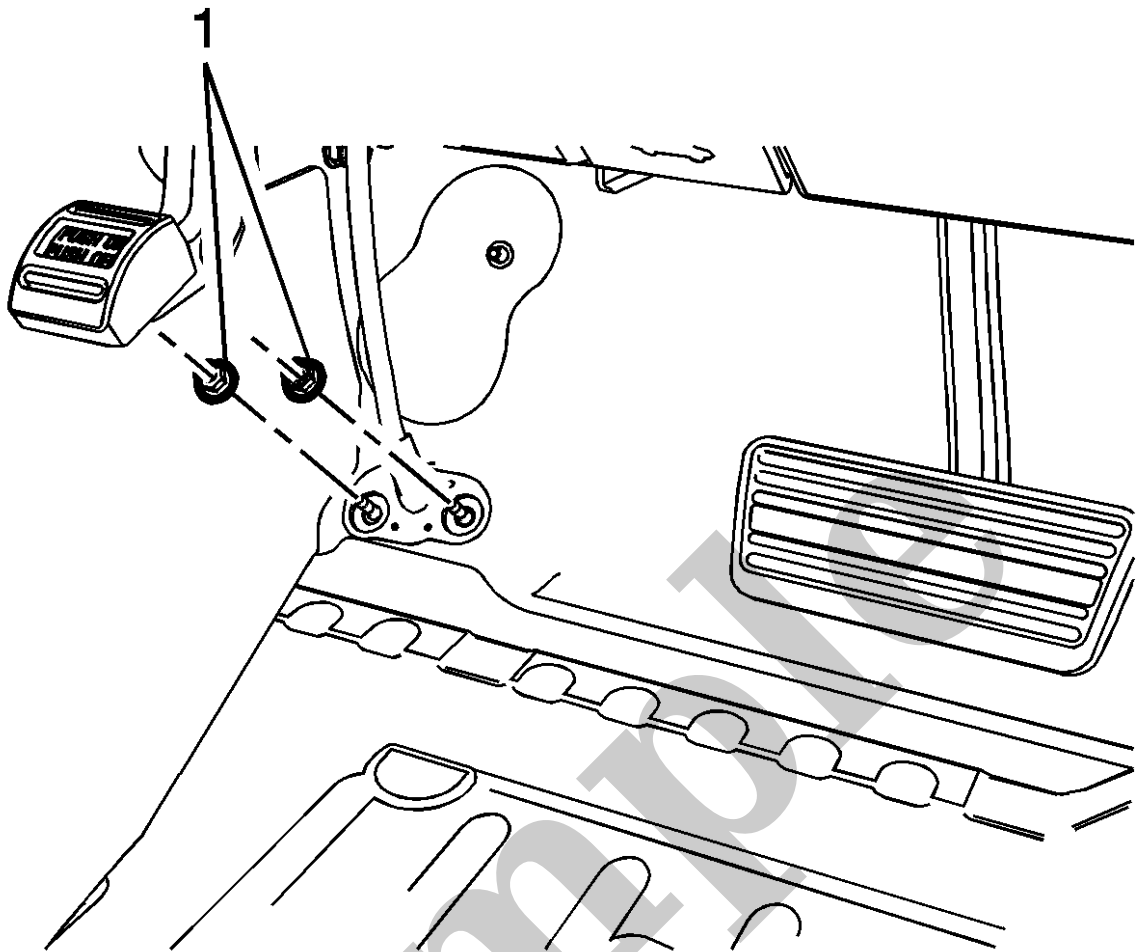

1.

#### NOTE

##### Note

Ensure the front parking brake cable pass through grommet is properly seated in the front floor panel.

Insert the front brake cable through the hole in the front floor panel and seat the pass-through grommet.

2. **CAUTION**

##### Caution

Refer to [Fastener Caution](#).