

# Your Ultimate Source for OEM Repair Manuals

FactoryManuals.net is a great resource for anyone who wants to save money on repairs by doing their own work. The manuals provide detailed instructions and diagrams that make it easy to understand how to fix a vehicle.

## 2014 VOLVO S60 Polestar OEM Service and Repair Workshop Manual

[Go to manual page](#)

**NOTE:** Removal steps in this procedure may contain installation details.

**Remove the following items:**

- side door front. Refer to: FRONT DOOR
- Side door rear. Refer to: SIDE DOOR REAR

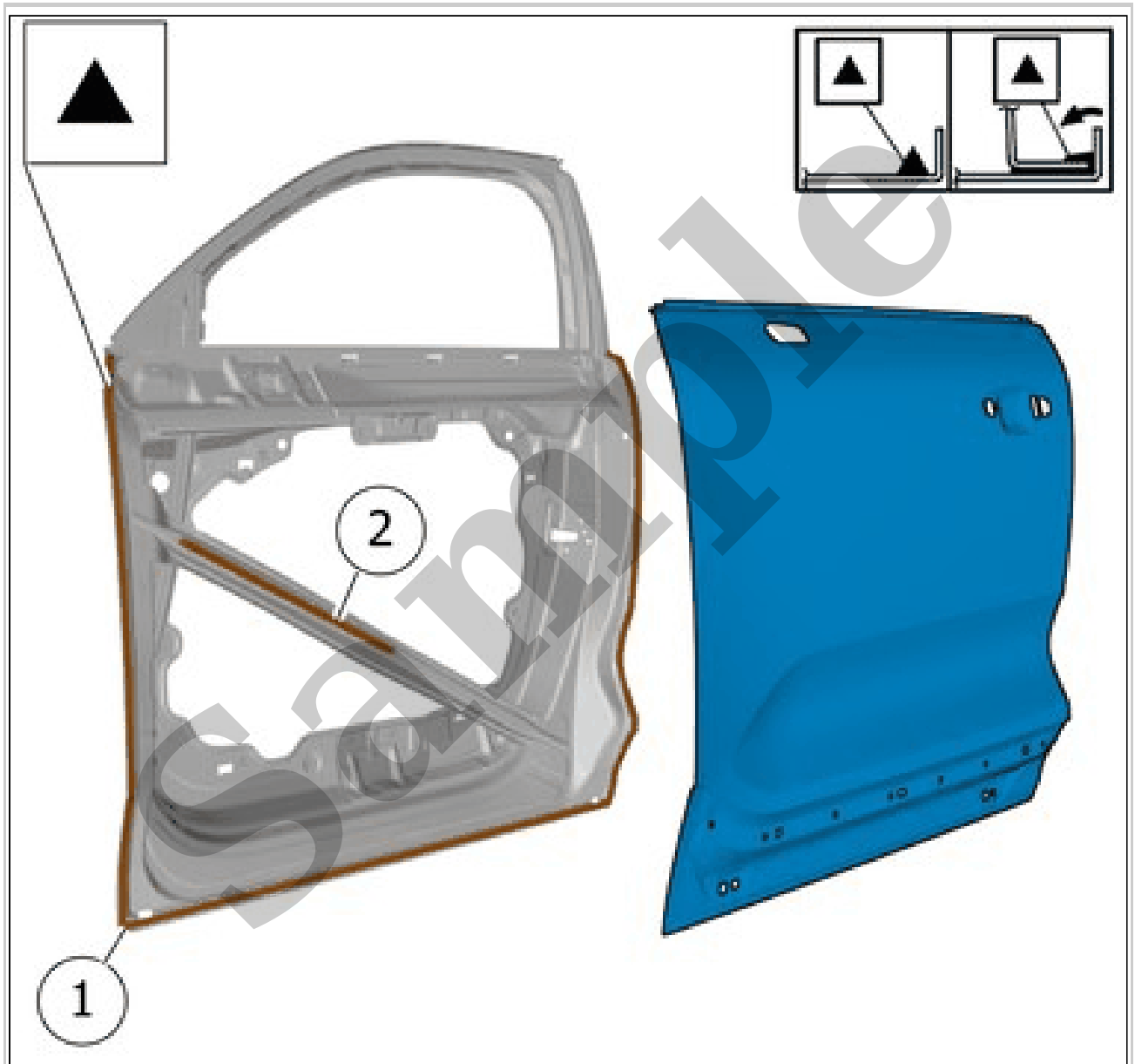

Courtesy of VOLVO CARS CORPORATION

1. **Use:** Bodywork adhesive, 30764637

2. **Use:** Sealing compound, 1161767

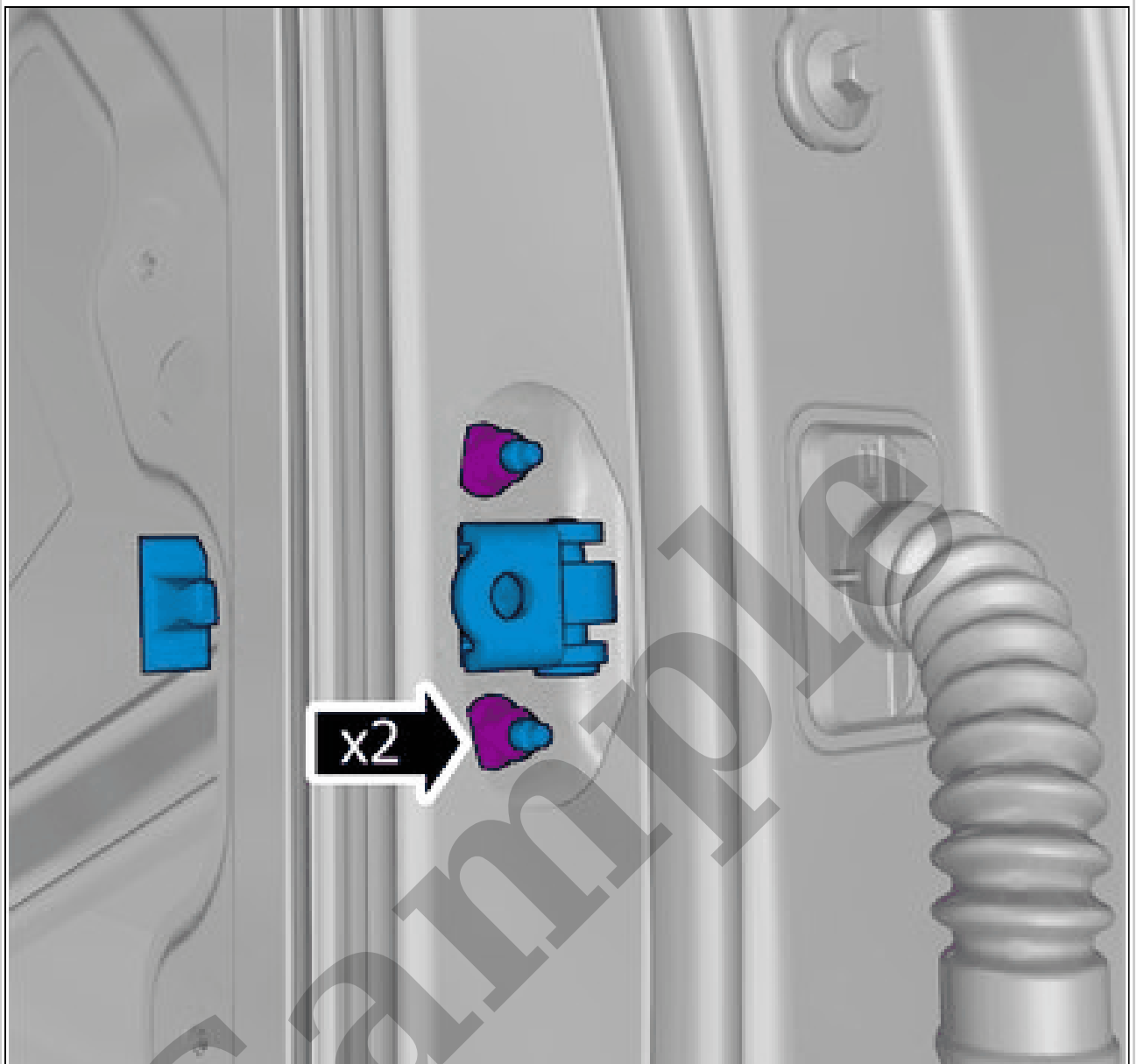

Courtesy of VOLVO CARS CORPORATION

Remove the nuts.  
Remove the marked part.

**Torque:** M6, 10Nm

## **DOOR STOP FRONT SIDE DOOR > DOOR STOP FRONT SIDE DOOR [2018-2022] > INSTALLATION**

To install, reverse the removal procedure.

## **FRONT DOOR > FRONT DOOR [2018-2022] > REMOVAL**

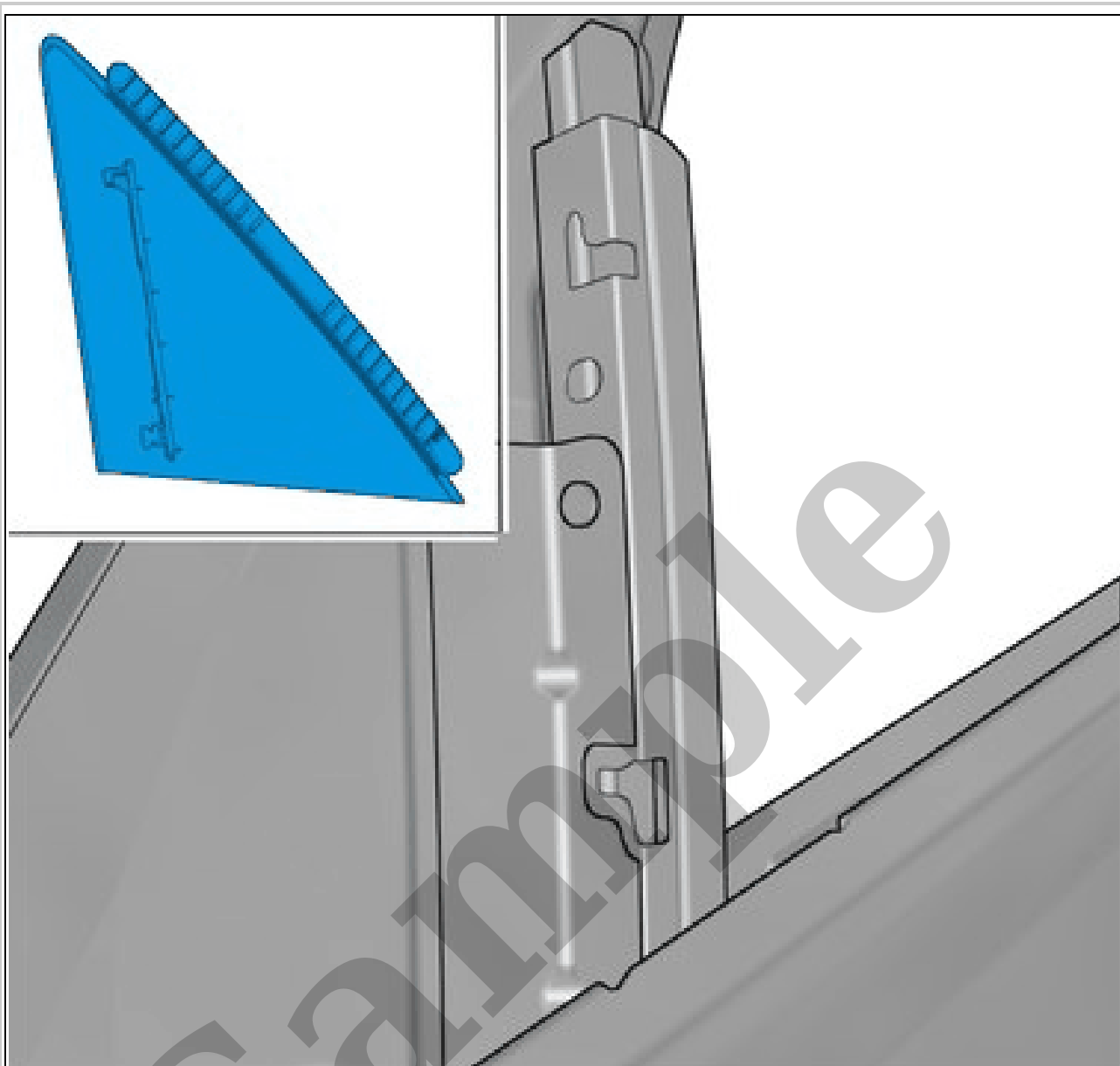

Courtesy of VOLVO CARS CORPORATION

**NOTE:** The graphic shows the back of the component before removal.

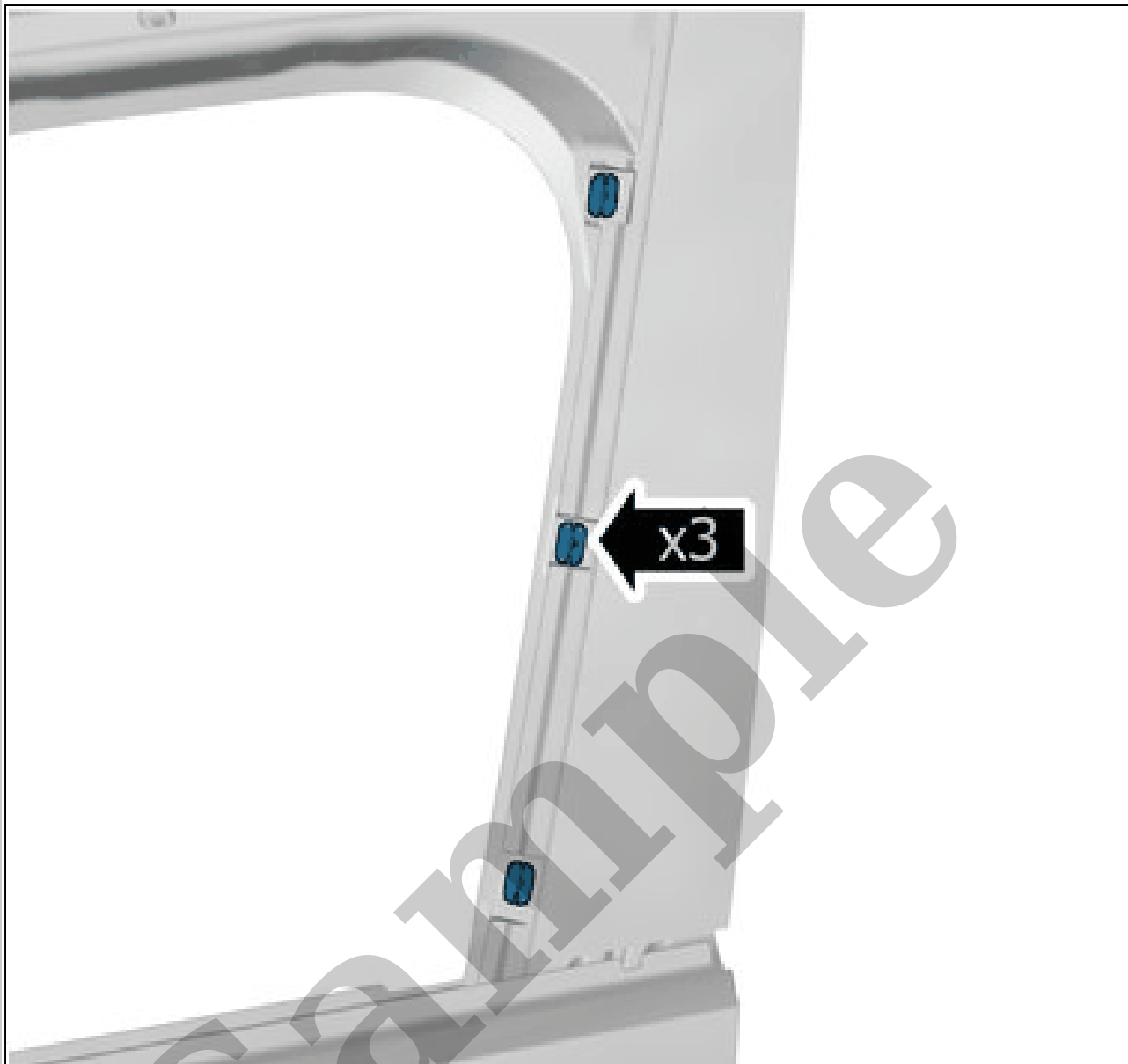

Courtesy of VOLVO CARS CORPORATION

Remove the marked part.

**Use:** Interior trim remover

**NOTE:** Removal steps in this procedure may contain installation details.

**Remove the following items:**

- Lift mechanism, rear door. Refer to: LIFT MECHANISM, REAR DOOR
- Window, rear door. Refer to: WINDOW, REAR DOOR
- lower trim strip, rear door. Refer to: LOWER TRIM STRIP, REAR DOOR
- Doorstop, door rear. Refer to: DOORSTOP, DOOR REAR
- side window, fixed, rear door. Refer to: REAR DOOR FIXED WINDOW GLASS

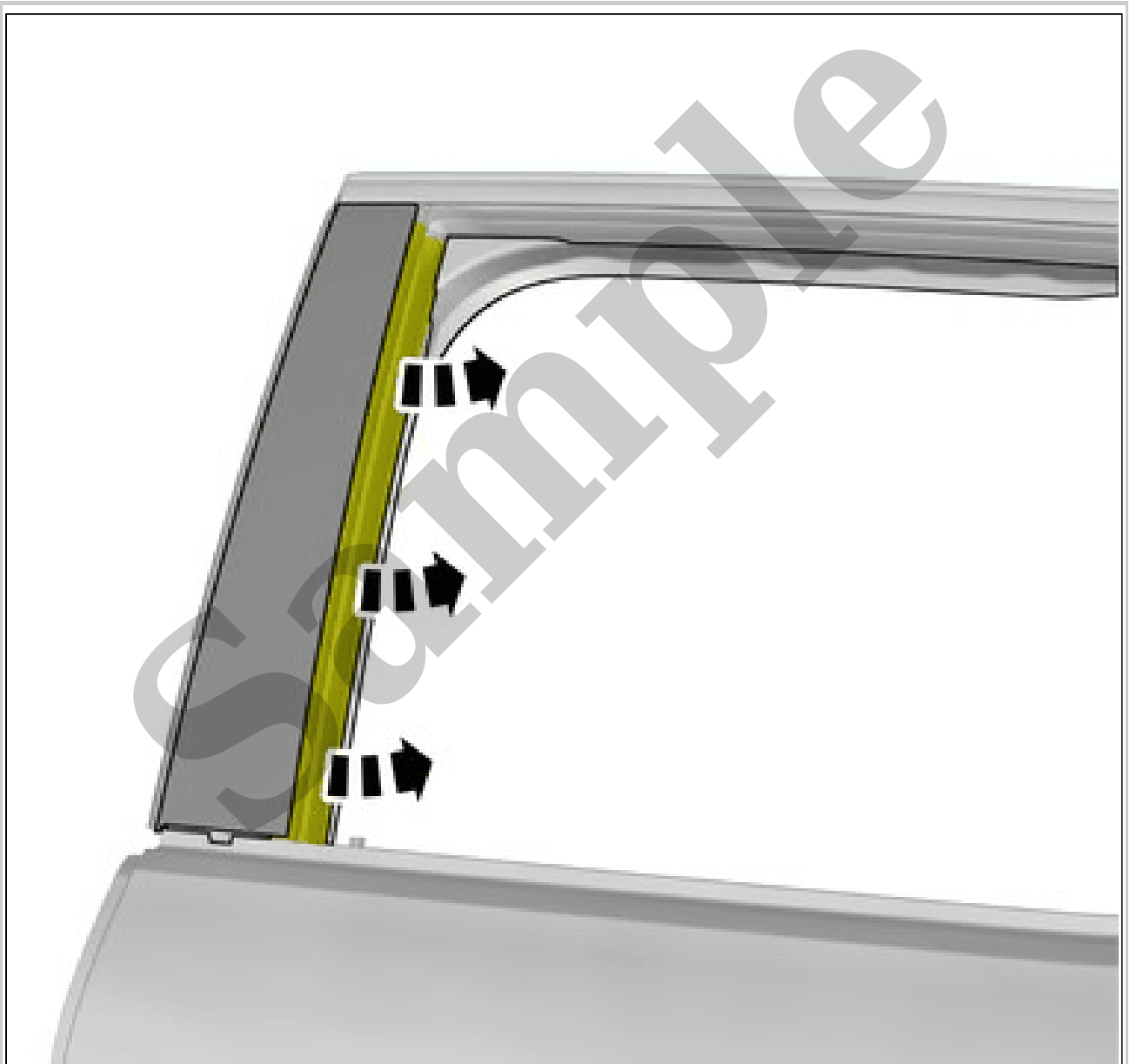

Courtesy of VOLVO CARS CORPORATION

Fold marked part aside.



Courtesy of VOLVO CARS CORPORATION

Remove the screws.

Remove the marked part.

**Torque:** M8, 24Nm

## **SIDE DOOR REAR > SIDE DOOR REAR [2018-2022] > INSTALLATION**

See information about components with double-sided adhesive tape. Refer to: COMPONENTS WITH DOUBLE-SIDED TAPE

See information about paint. Refer to: PAINT

See information about corrosion protection. Refer to: RUSTPROOFING

See information about door and lids. Refer to: DOORS AND LIDS

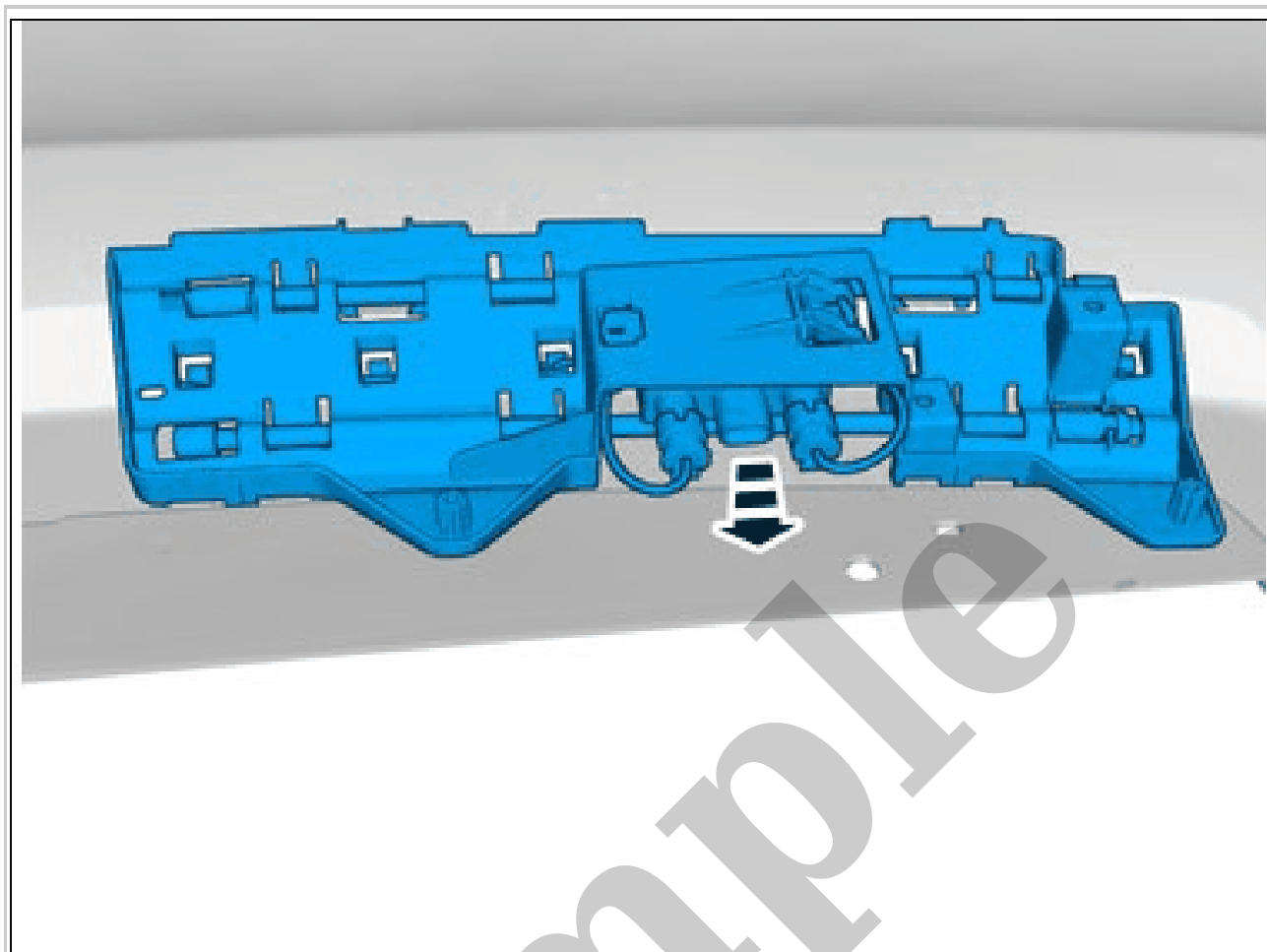

Courtesy of VOLVO CARS CORPORATION

Remove the marked part.

#### **FOOT MOVEMENT DETECTION MODULE > FOOT MOVEMENT DETECTION MODULE (FMDM) [2018-2022, B4204T18 | 2019-2022, B4204T47] > INSTALLATION**

To install, reverse the removal procedure.

#### **FOOT MOVEMENT DETECTION MODULE > FOOT MOVEMENT DETECTION MODULE (FMDM) [2021-2022, E400V6] > REMOVAL**

Perform battery disconnecting and connecting. Refer to: BATTERY DISCONNECTING AND CONNECTING





Courtesy of VOLVO CARS CORPORATION

Remove the nuts.

**Torque:** M8, 24Nm

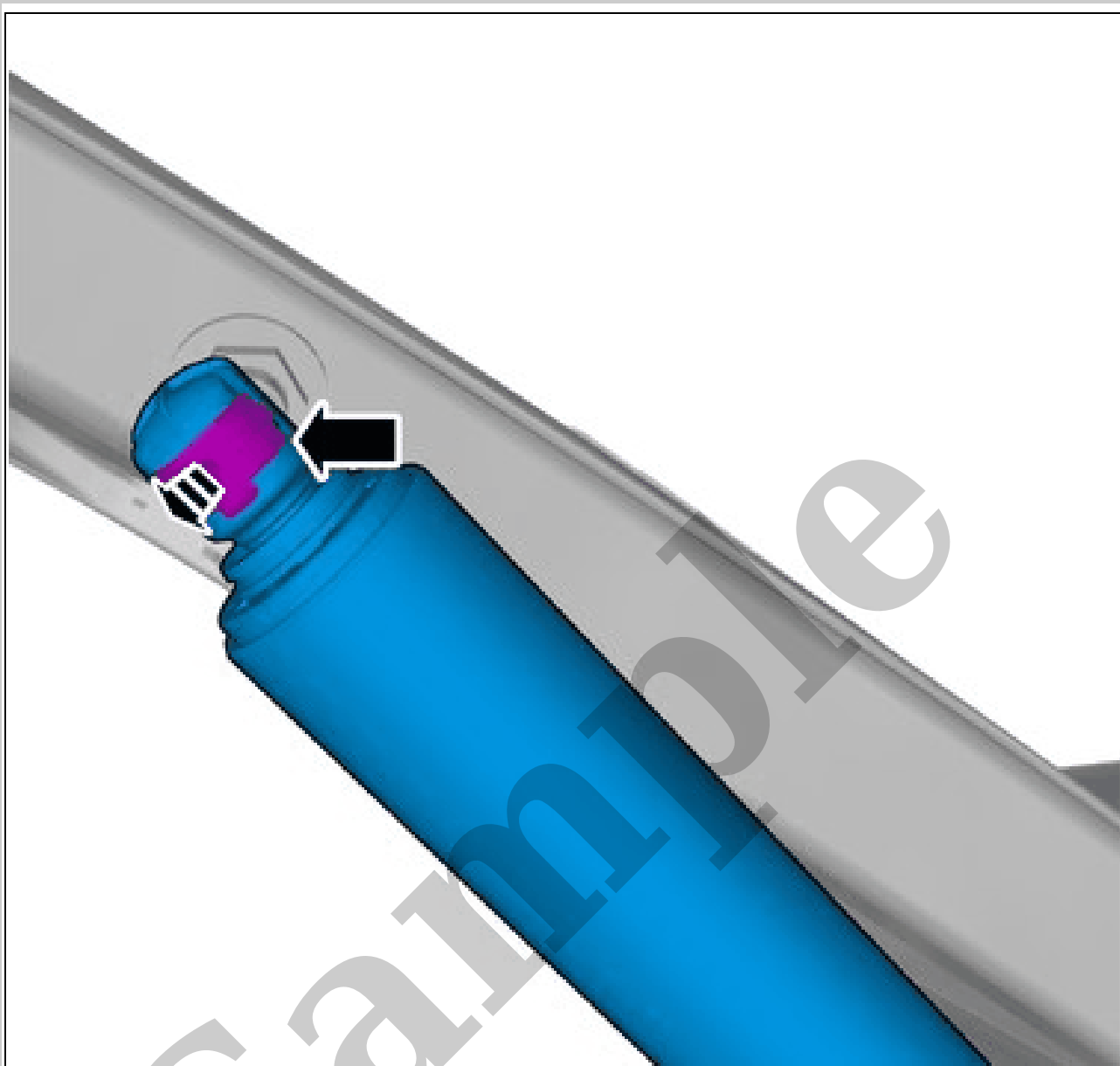

Courtesy of VOLVO CARS CORPORATION

Loosen the clip.  
Remove the marked part.

### **MOTOR, POWER OPERATED TAILGATE > MOTOR, POWER OPERATED TAILGATE [2018-2022] > INSTALLATION**

To install, reverse the removal procedure.

### **POWER OPERATED TAILGATE MODULE > POWER OPERATED TAILGATE MODULE (POT) [2018-2022] > REMOVAL**