

# Your Ultimate Source for OEM Repair Manuals

FactoryManuals.net is a great resource for anyone who wants to save money on repairs by doing their own work. The manuals provide detailed instructions and diagrams that make it easy to understand how to fix a vehicle.

## 2013 Volvo S60 Repair Manual & Workshop Service Guide

[Go to manual page](#)

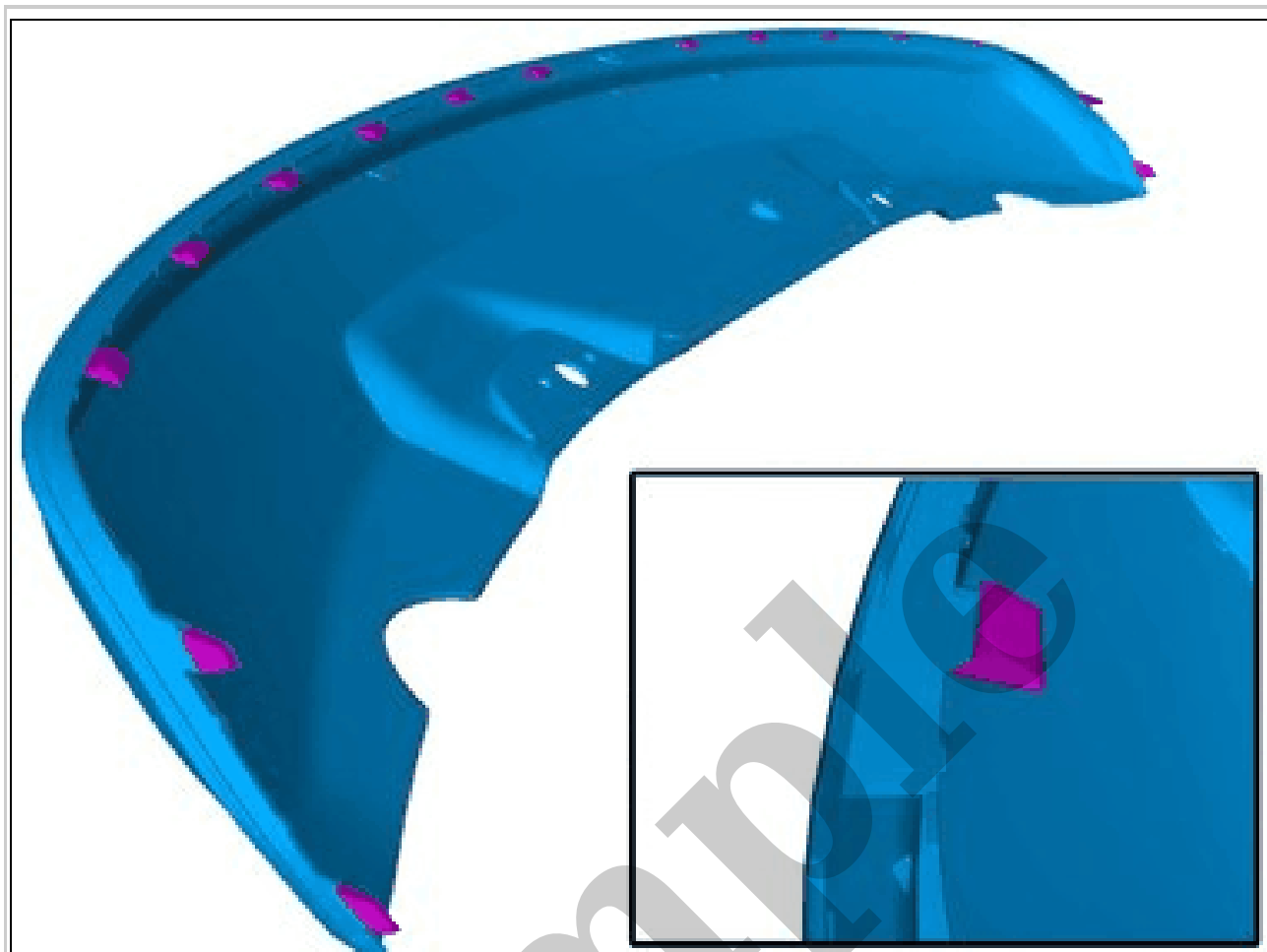

Courtesy of VOLVO CARS CORPORATION

**NOTE:** *The graphic shows the back of the component before removal.*

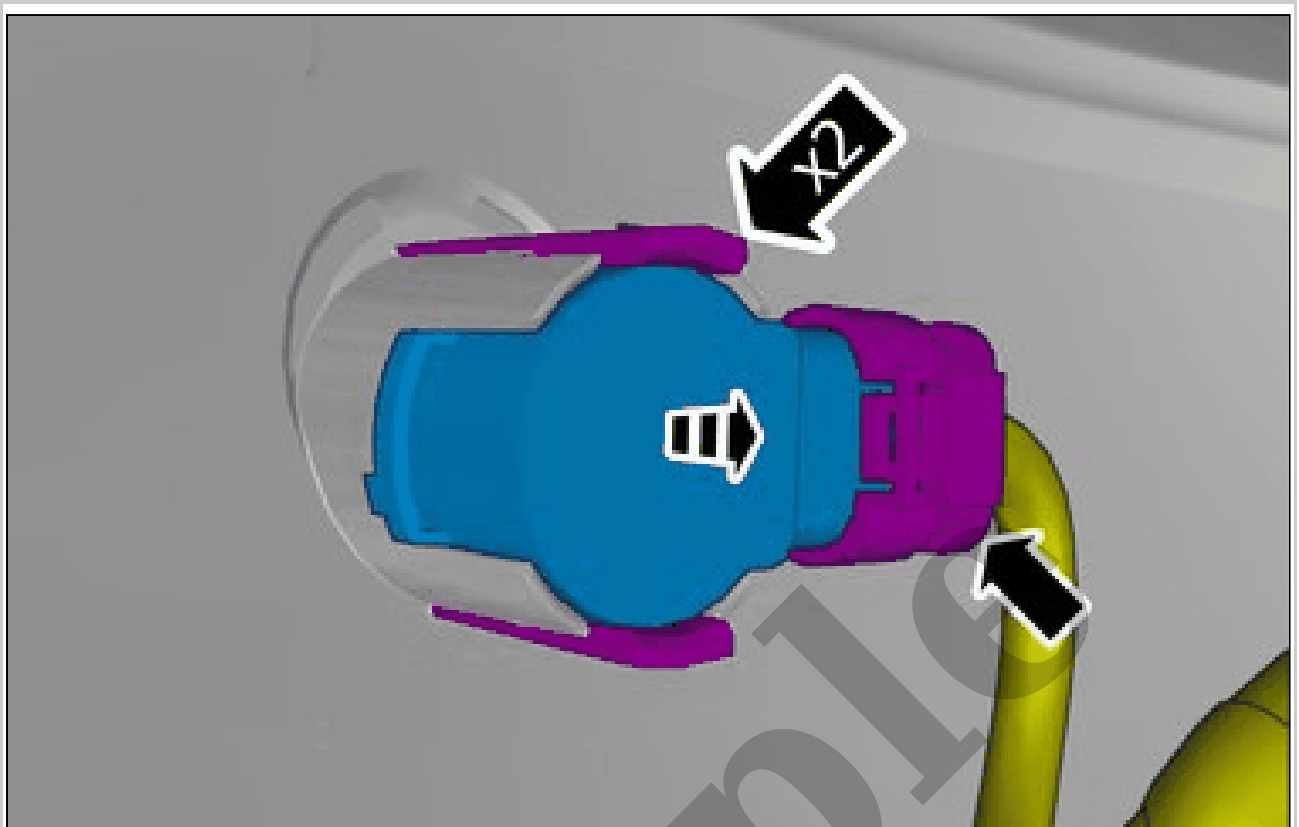

Courtesy of VOLVO CARS CORPORATION

Disconnect the connector.  
Release the catches.  
Remove the marked part.

#### **INSTALLATION**

**NOTE:** *The following steps are only necessary when installing a new component.*

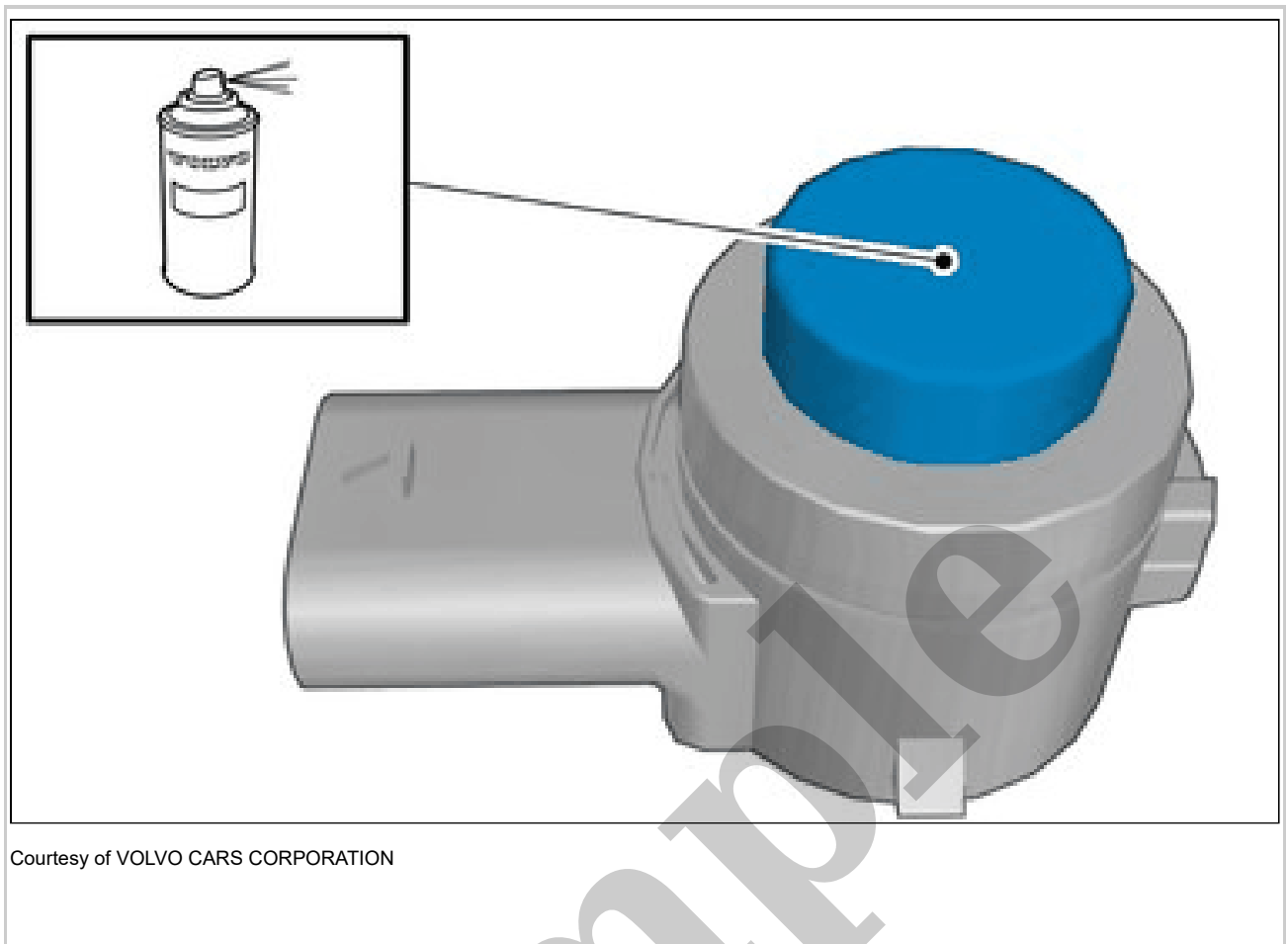

Courtesy of VOLVO CARS CORPORATION

**CAUTION:** *Protect connector surfaces against paint spray.*

**NOTE:** *Paint the sensors the same color code as the vehicle.*

**Use:** Volvo Original Touch-up paint,  
Use base coat only.

**Use:** Varnish 2-component, 31335447  
Also see the instructions on the container.

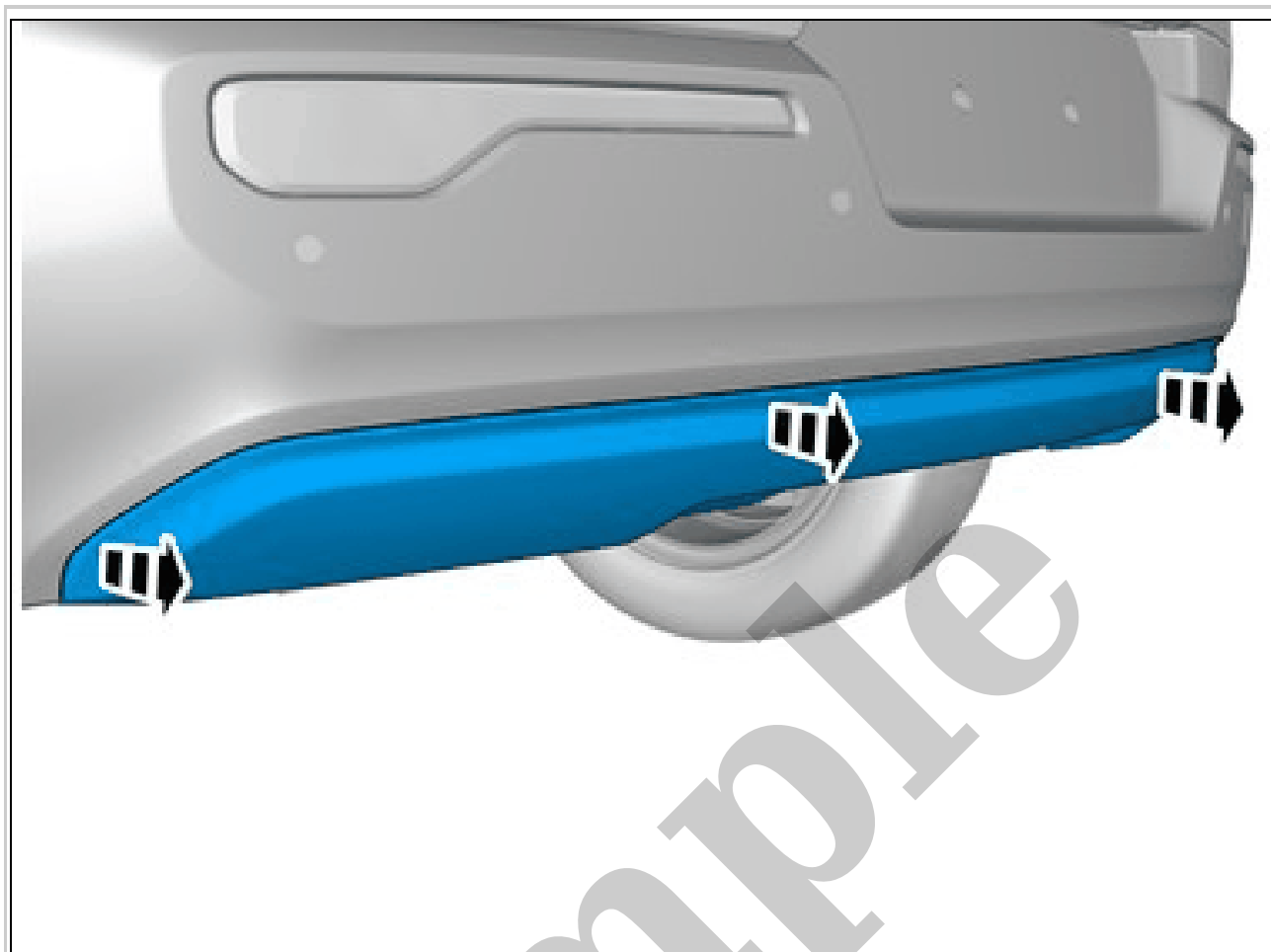

Courtesy of VOLVO CARS CORPORATION

Use hands only.  
Remove the marked part.

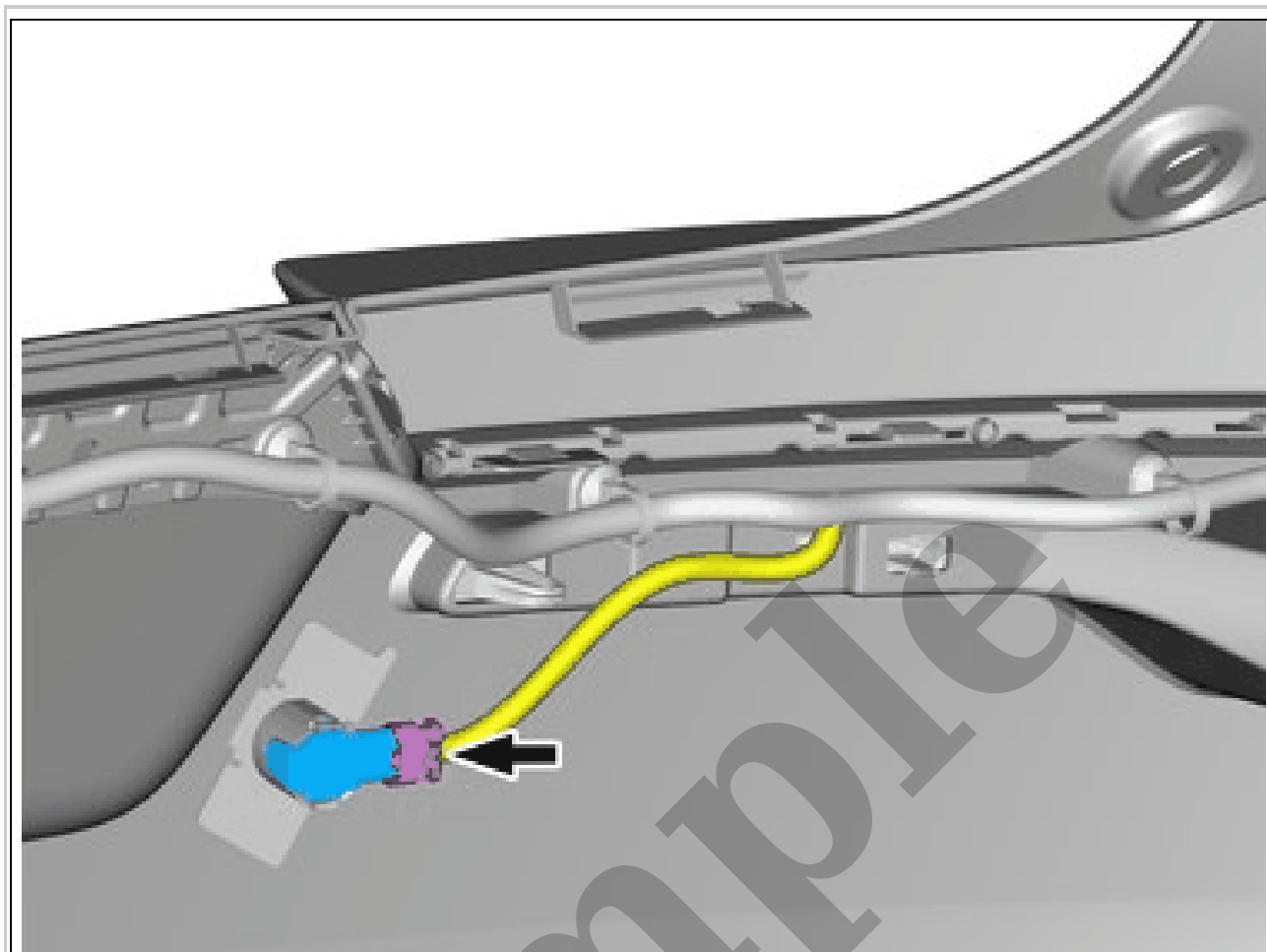

Courtesy of VOLVO CARS CORPORATION

Disconnect the connector.

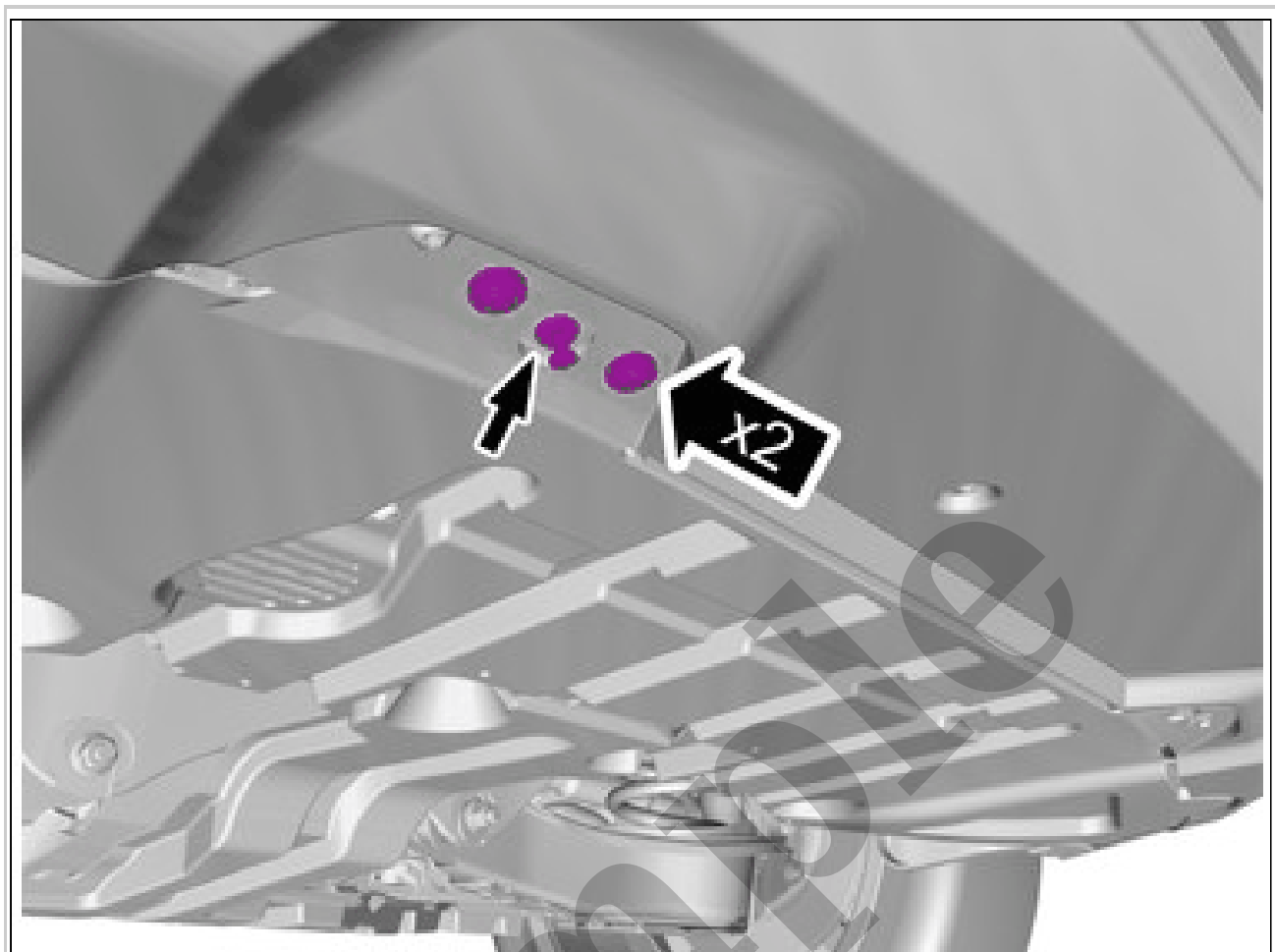

Courtesy of VOLVO CARS CORPORATION

Remove the clip.  
Remove the screws.  
Repeat on the other side.

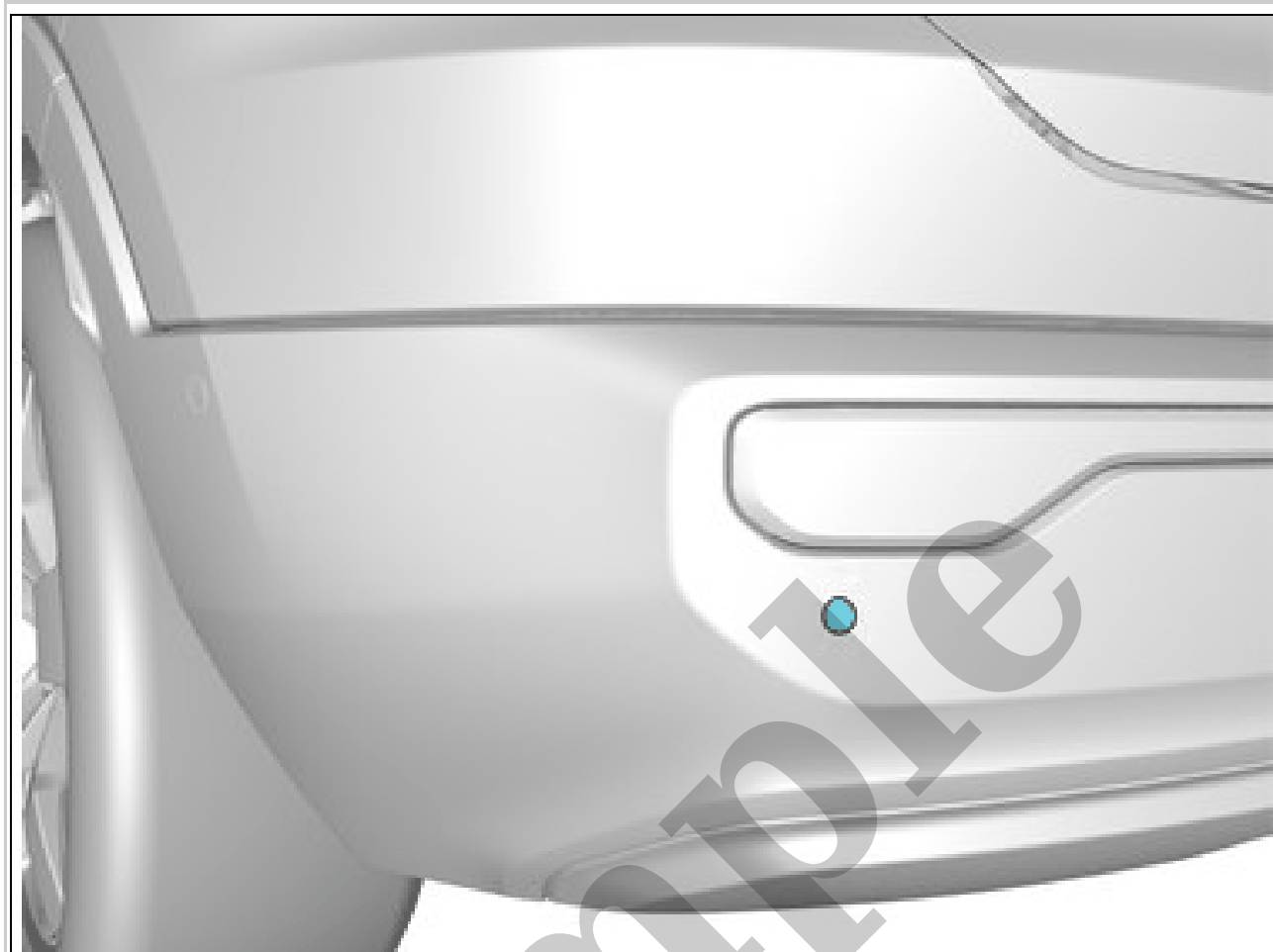

Courtesy of VOLVO CARS CORPORATION

**NOTE:** *Orientation view*



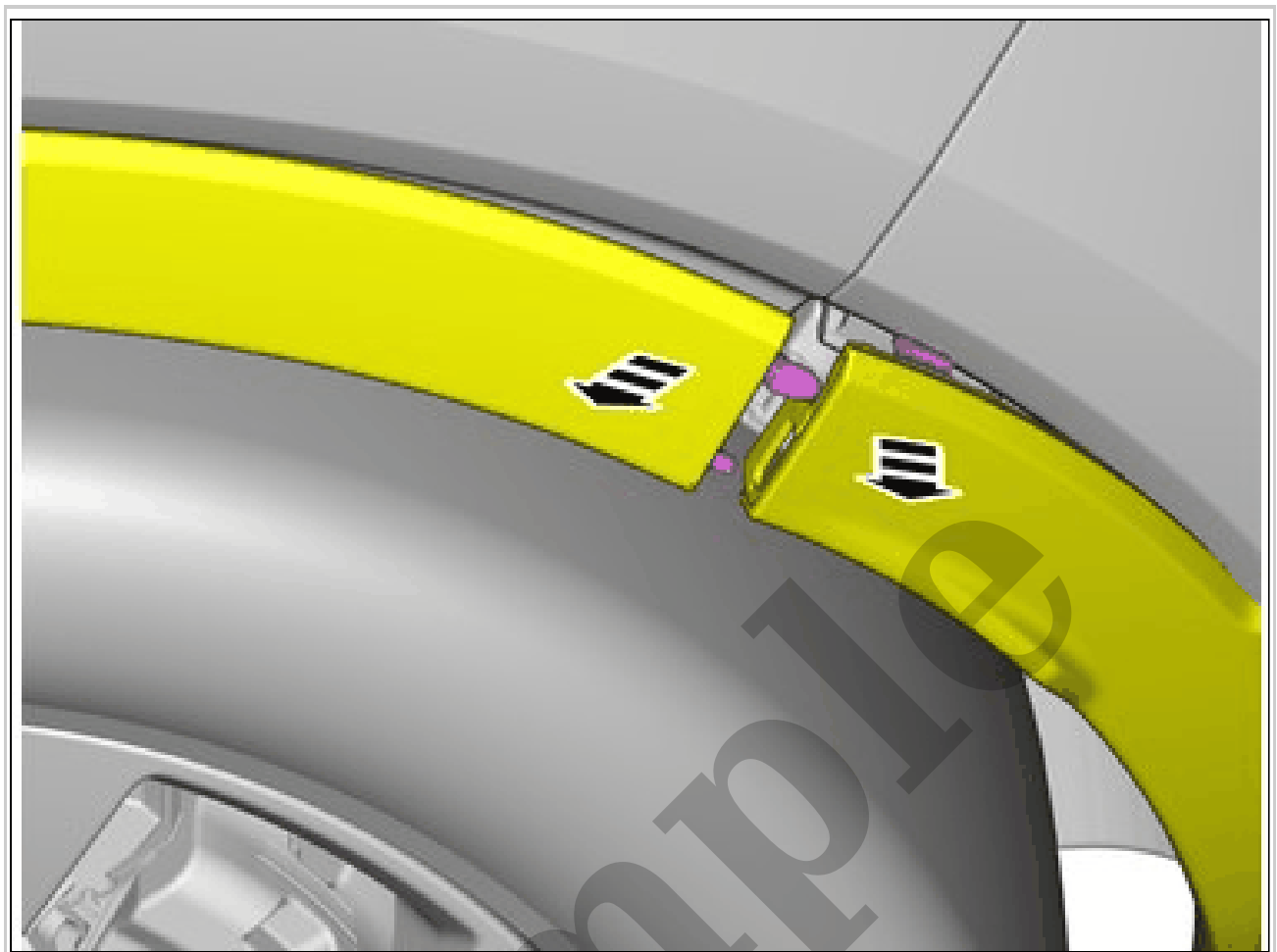

Courtesy of VOLVO CARS CORPORATION

Loosen the marked details.  
Use hands only.

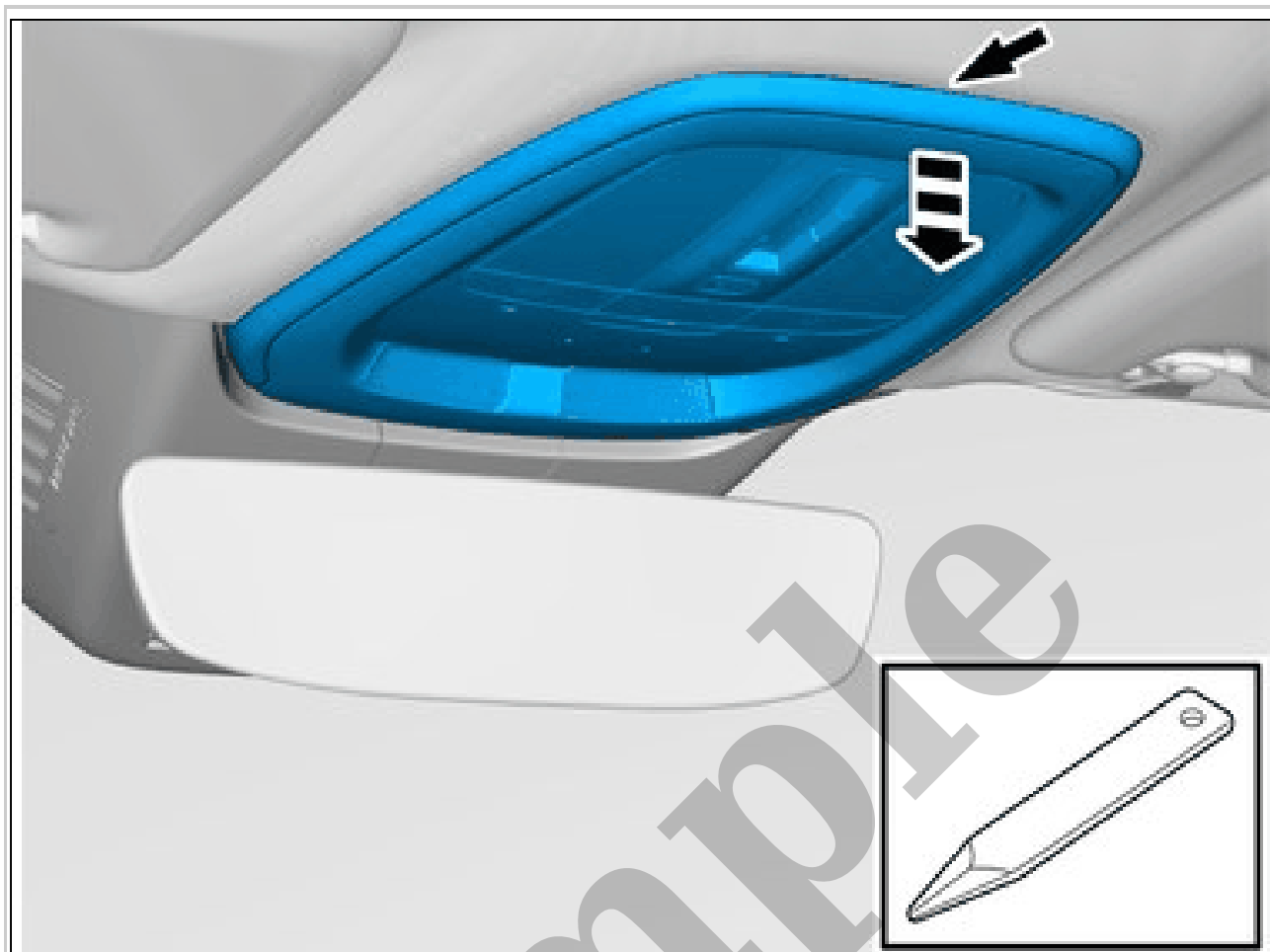

Courtesy of VOLVO CARS CORPORATION

**NOTE:** *The number of connectors may vary depending on the vehicle's equipment level.*

Remove the marked part.  
Disconnect the connector.  
**Use:** Interior trim remover