

Your Ultimate Source for OEM Repair Manuals

FactoryManuals.net is a great resource for anyone who wants to save money on repairs by doing their own work. The manuals provide detailed instructions and diagrams that make it easy to understand how to fix a vehicle.

2013 Volvo C70 Service and Repair Manual

[Go to manual page](#)

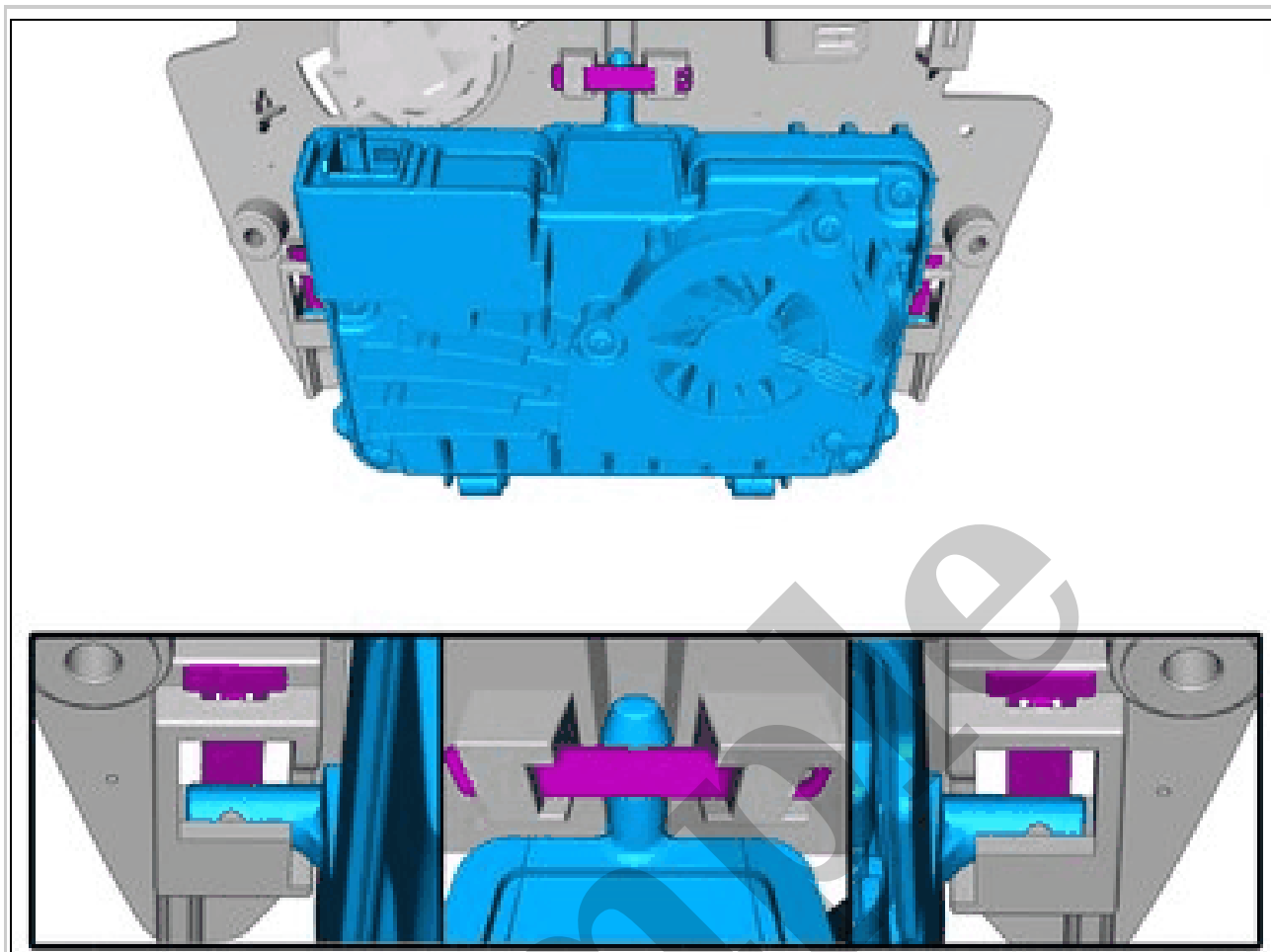

Courtesy of VOLVO CARS CORPORATION

CAUTION: *Do not touch the camera lens.*

CAUTION: *Make sure the component is fitted as illustrated.*

Ensure that all clips engage.

Check that the component has locked in its position.

To install, reverse the removal procedure.

Calibrate FLC2 according to: Diagnostics / Components / Control modules / Forward looking camera (FLC2) / Diagnostic sequences / Calibration of forward looking camera (FLC2)

FORWARD LOOKING CAMERA > FORWARD LOOKING CAMERA (FLC) [2021-2022, E400V6] > REMOVAL

Perform battery disconnecting and connecting. Refer to: BATTERY DISCONNECTING AND CONNECTING

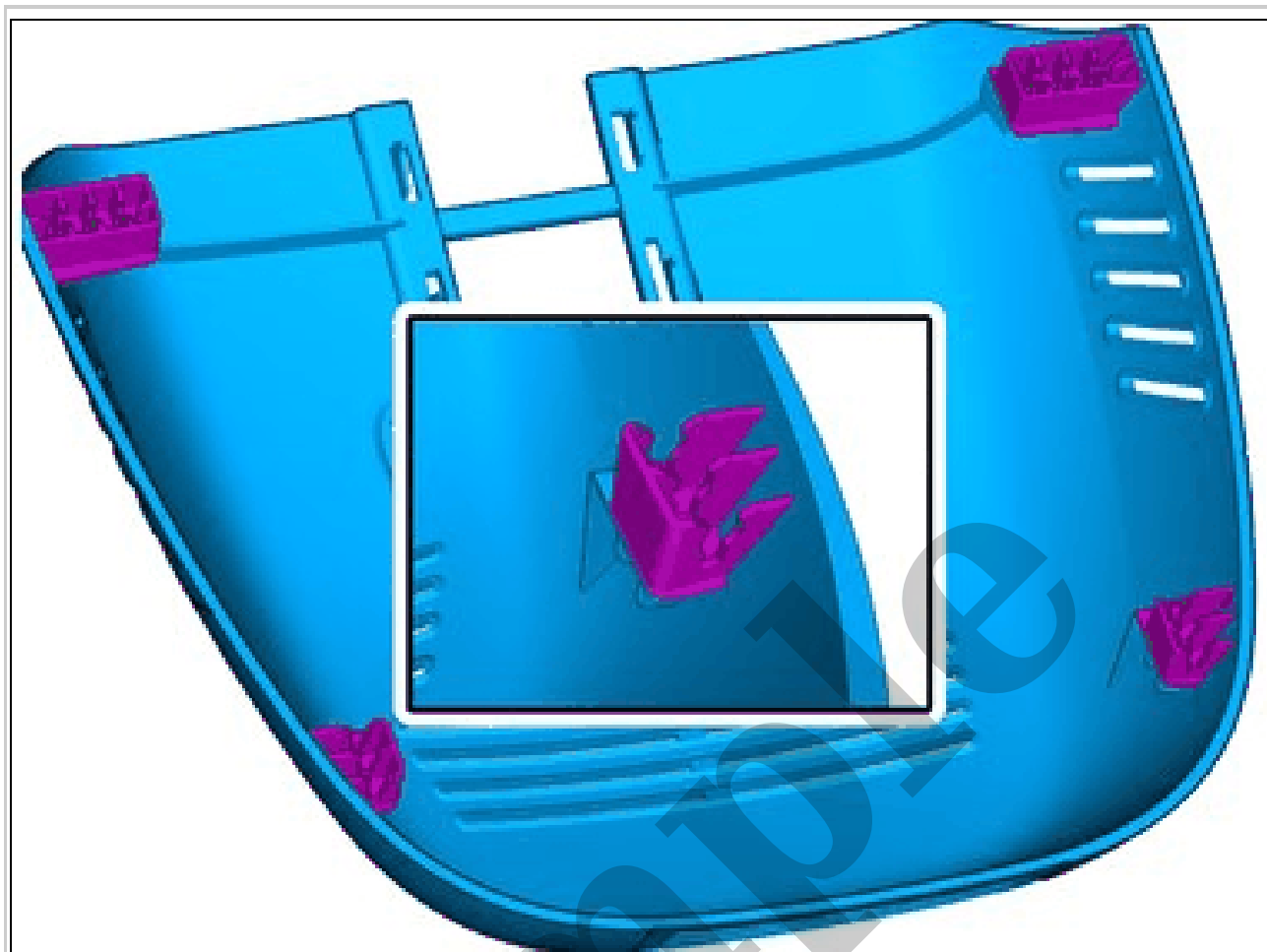

Courtesy of VOLVO CARS CORPORATION

NOTE: The graphic shows the back of the component before removal.

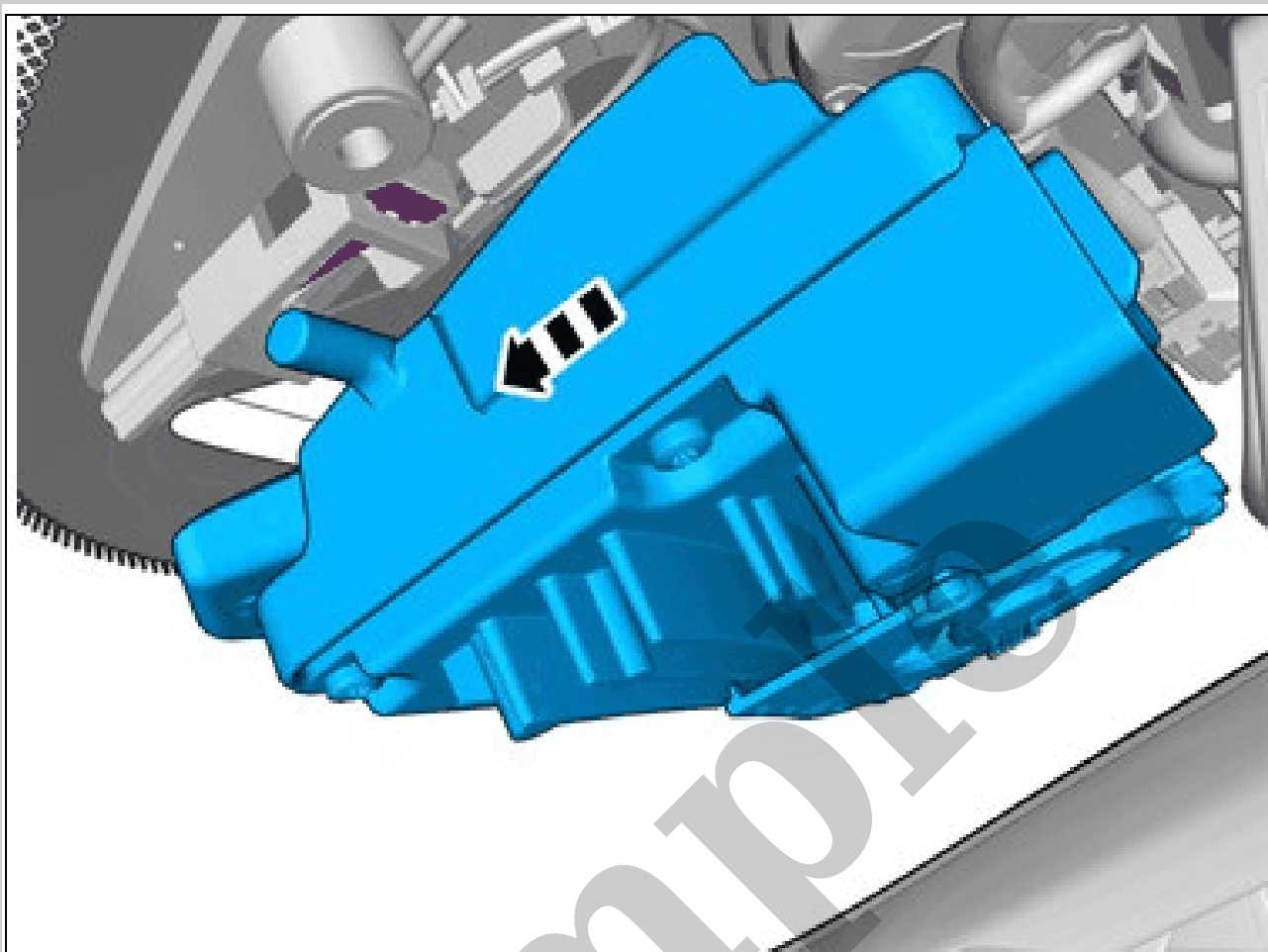

Courtesy of VOLVO CARS CORPORATION

CAUTION: *Do not touch the camera lens.*

NOTE: *Clips might come off when removing component.*

Remove the marked part.

FORWARD LOOKING CAMERA > FORWARD LOOKING CAMERA (FLC) [2021-2022, E400V6] > INSTALLATION

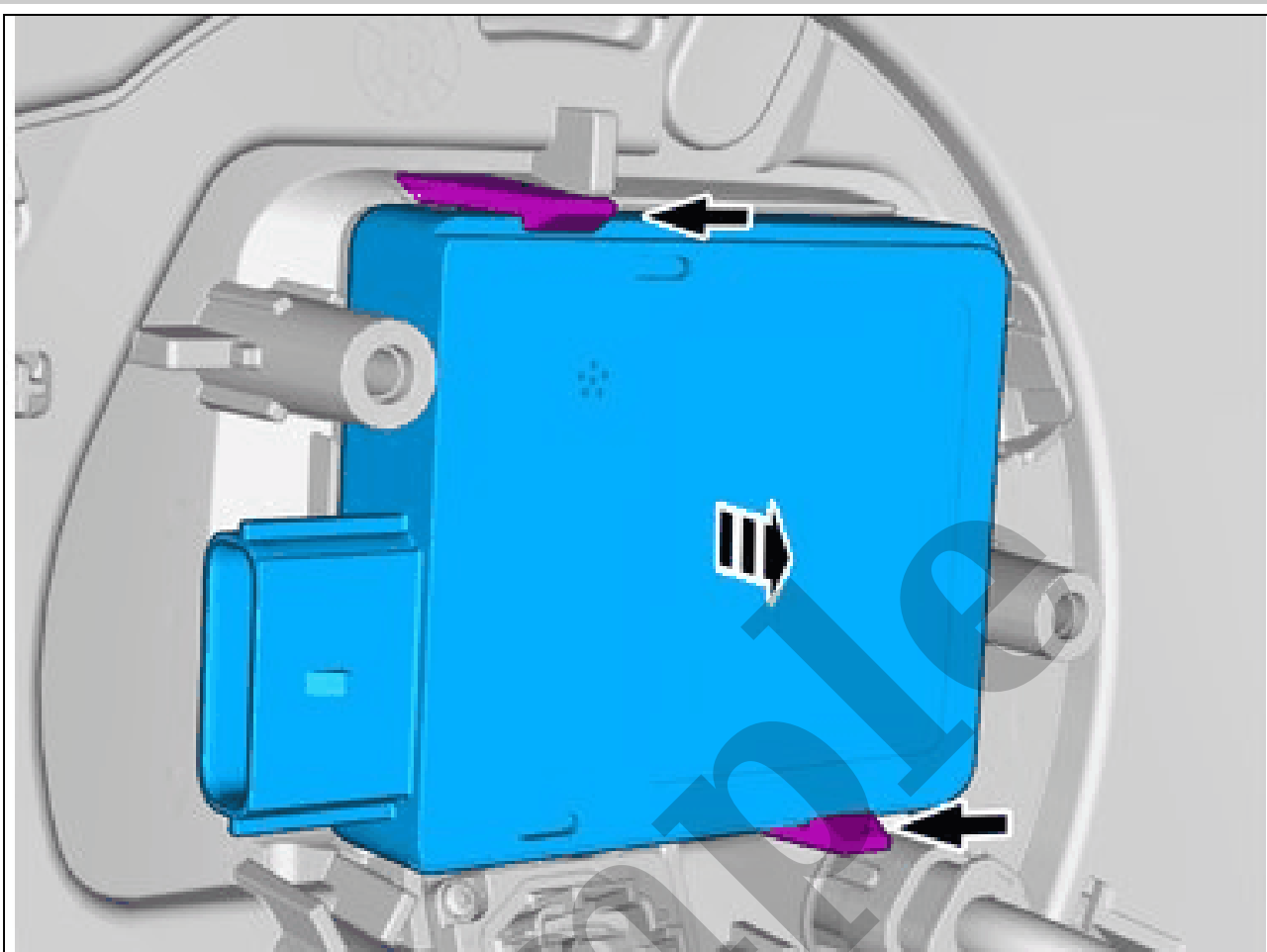

Courtesy of VOLVO CARS CORPORATION

Release the catches.
Remove the marked part.

FORWARD LOOKING RADAR > FORWARD LOOKING RADAR (FLR) [2021-2022, E400V6] > INSTALLATION

To install, reverse the removal procedure.

NOTE: *The following steps are only necessary when installing a new component.*

Order and download the appropriate software according to: VIDA/Software/Hardware Changes
Calibrate FLR according to: Diagnostics / Components / Control modules / Forward Looking Radar (FLR) / Diagnostic sequences / Calibration of Forward Looking Radar (FLR)

INTERIOR MOTION SENSOR > INTERIOR MOTION SENSOR (IMS) [2018-2022] > REMOVAL

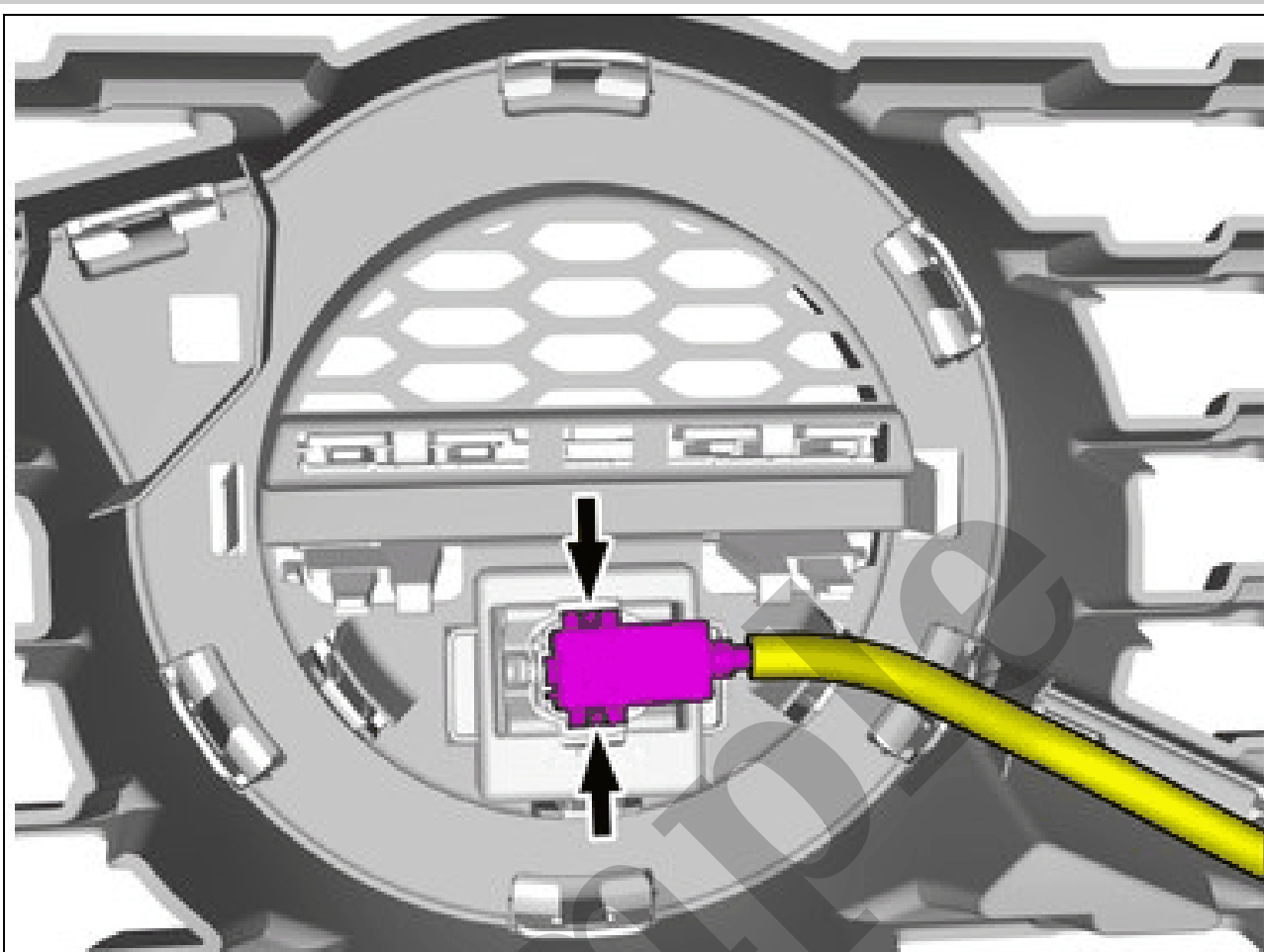

Courtesy of VOLVO CARS CORPORATION

Depress the locking device.
Fold marked part aside.

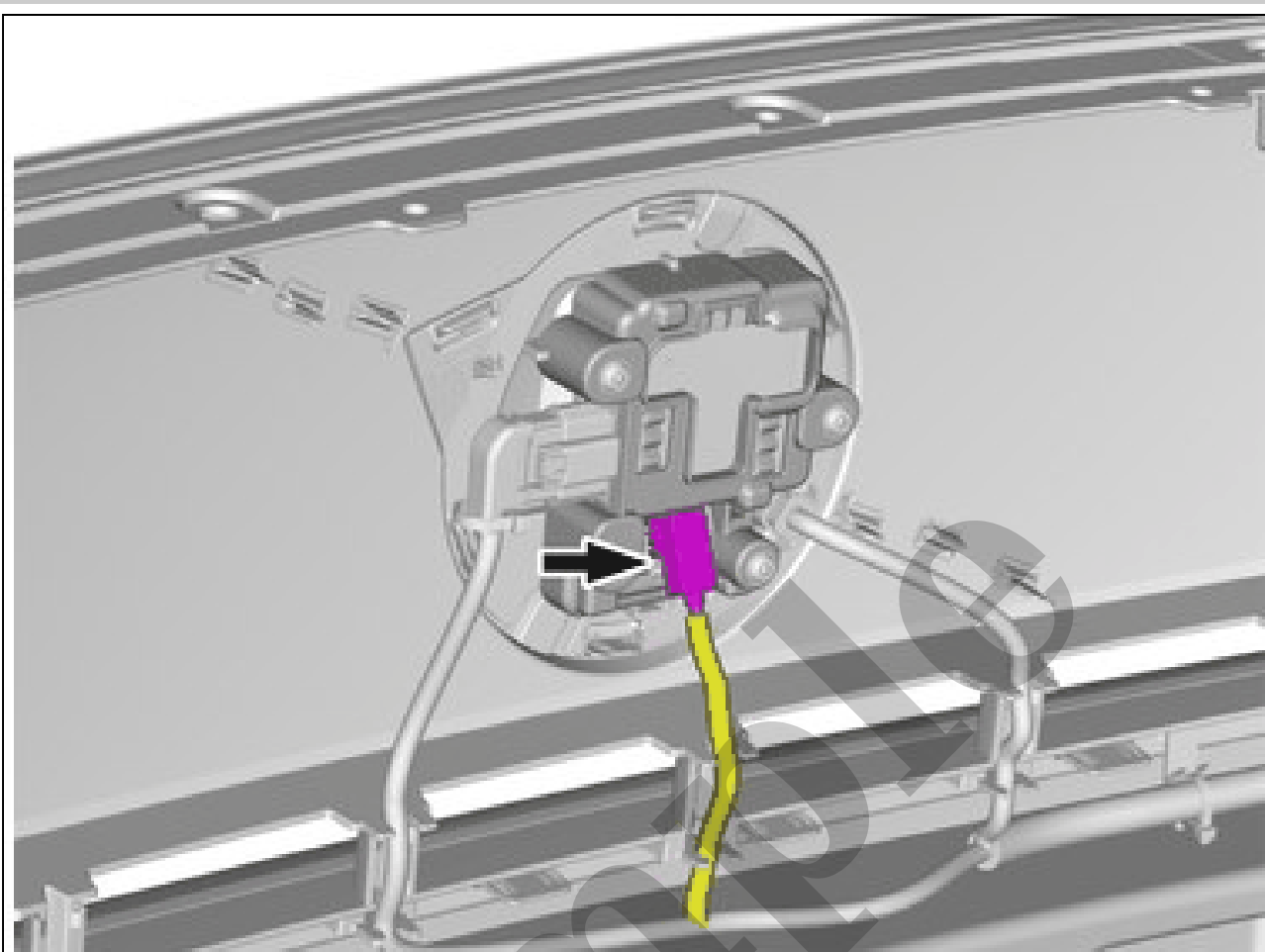

Courtesy of VOLVO CARS CORPORATION

Release the connector's catch.
Disconnect the connector.

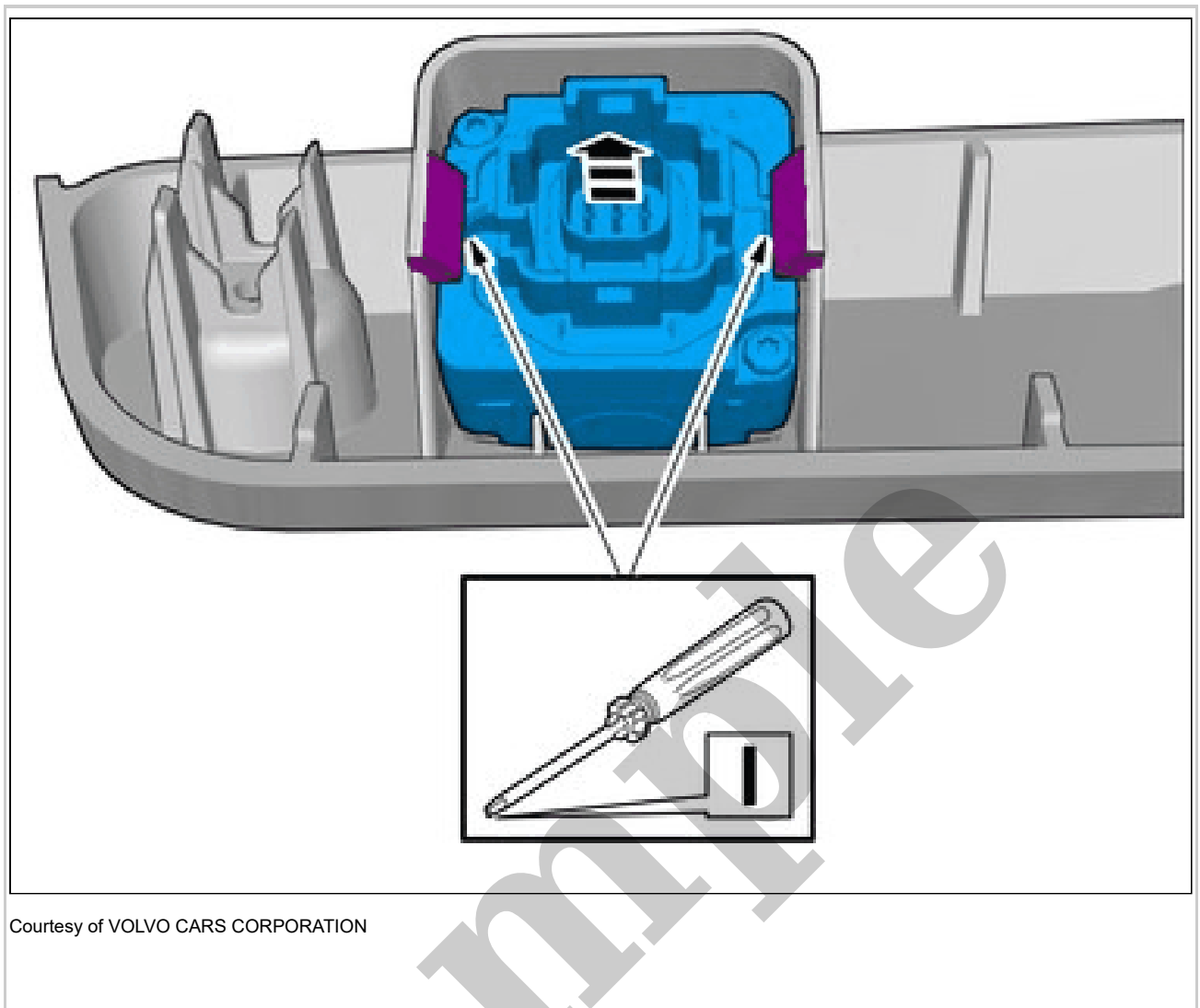

Release the catches.
Remove the marked part.

PARKING ASSISTANCE CAMERA, REAR > PARKING ASSISTANCE CAMERA, REAR [2018-2022] > INSTALLATION

To install, reverse the removal procedure.

NOTE: This step is only necessary when installing a new component.

Order and download the appropriate software according to: VIDA/Software/Hardware Changes

VEHICLES WITH WIDE ANGLE VISION MODULE (WAM)

Calibrate WAM according to: Diagnostics / Components / Control modules /Wide Angle Vision Module (WAM) / Diagnostic sequences / Calibrating parking assistance cameras

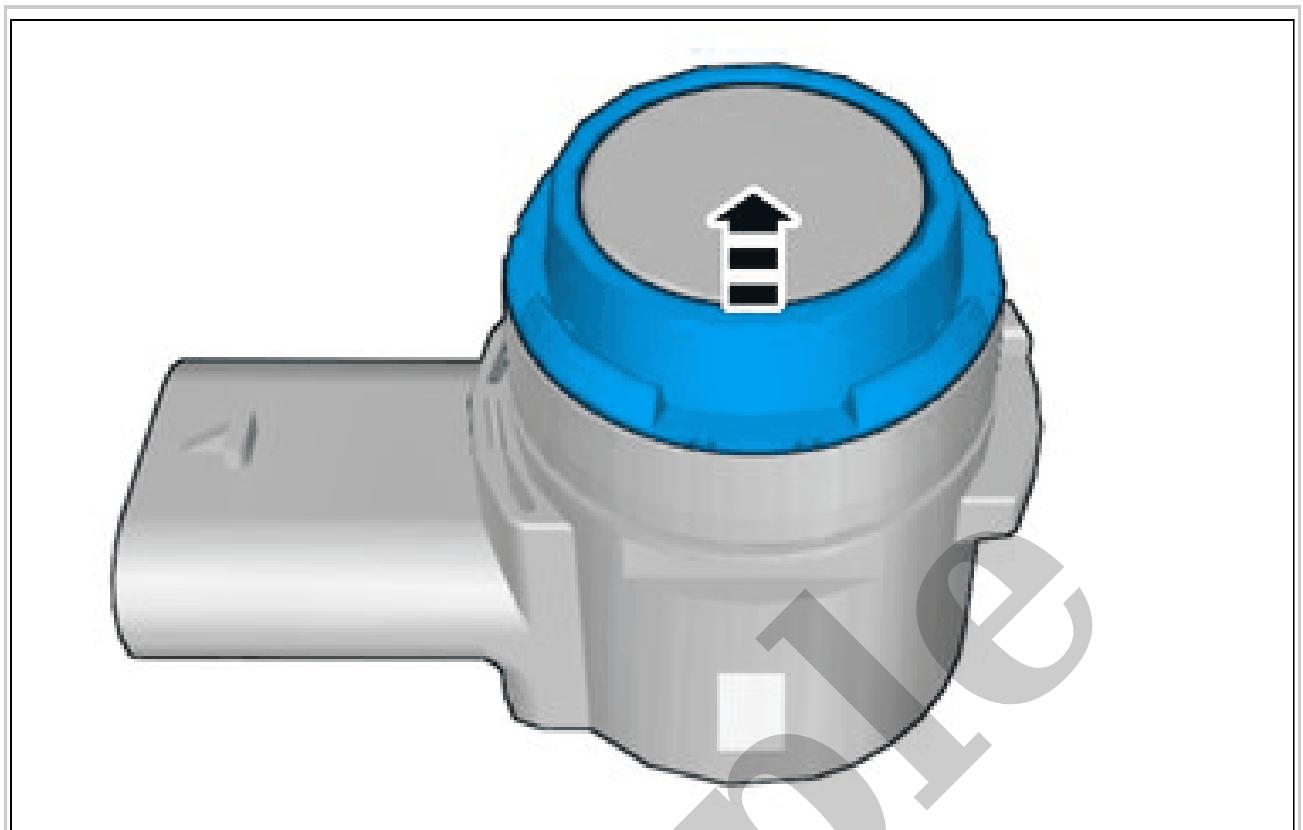

Courtesy of VOLVO CARS CORPORATION

Remove the marked part.

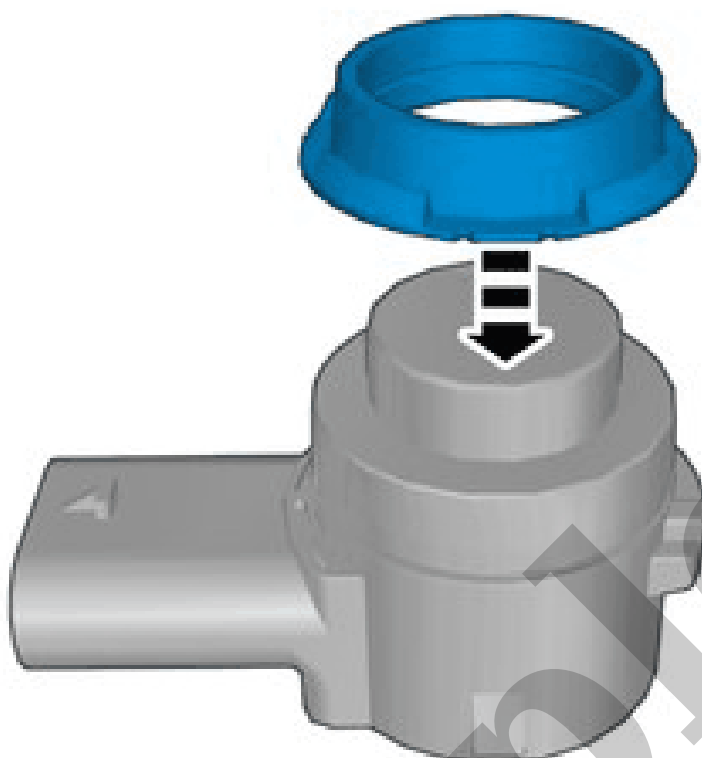

Courtesy of VOLVO CARS CORPORATION

CAUTION: *First the paint must dry after painting.*

To install, reverse the removal procedure.

PARKING ASSISTANCE SENSOR, FRONT, INNER > PARKING ASSISTANCE SENSOR, FRONT, INNER [2018-2022] > REMOVAL