

Your Ultimate Source for OEM Repair Manuals

FactoryManuals.net is a great resource for anyone who wants to save money on repairs by doing their own work. The manuals provide detailed instructions and diagrams that make it easy to understand how to fix a vehicle.

2013 Toyota Sienna Service Manual

[Go to manual page](#)

Last Modified: 07-26-2024	6.11:8.1.0	Doc ID: RM100000001R4WW
Model Year Start: 2021	Model: Supra	Prod Date Range: [07/2020 -]
Title: B48 (LUBRICATION): OIL AND OIL FILTER: REPLACEMENT; 2021 - 2025 MY Supra [07/2020 -]		

[REPLACEMENT](#)

[CAUTION / NOTICE / HINT](#)

Click here [INFO](#)

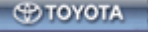

Sample

Last Modified: 07-26-2024	6.11:8.1.0	Doc ID: RM100000001R4WY
Model Year Start: 2021	Model: Supra	Prod Date Range: [07/2020 -]
Title: B48 (LUBRICATION): OIL PRESSURE SENSOR: REMOVAL; 2021 - 2025 MY Supra [07/2020 -]		

REMOVAL

CAUTION / NOTICE / HINT

CAUTION:

- Hot fluids.

Risk of scalding!

- Conduct all work in the vehicle wearing appropriate personal protective equipment only.

- Hot surfaces.

Risk of burning!

- Perform all work only on components that have cooled down.

- Collect and dispose of emerging fluids. Observe country-specific waste disposal regulations.

PROCEDURE

1. REMOVE OIL FILTER BRACKET

Click here [INFO](#)

2. REMOVE OIL PRESSURE SENSOR

CAUTION:

Collect and dispose of emerging fluids. Observe country-specific waste disposal regulations.

NOTICE:

- Electrostatic discharge.

Damage to or destruction of electrical components.

- Only touch the housings of electrical components. Do not touch pins or multi-pin connectors directly.
- For additional information see:

Click here [INFO](#)

(a) Unlock plug connection (1) and disconnect.

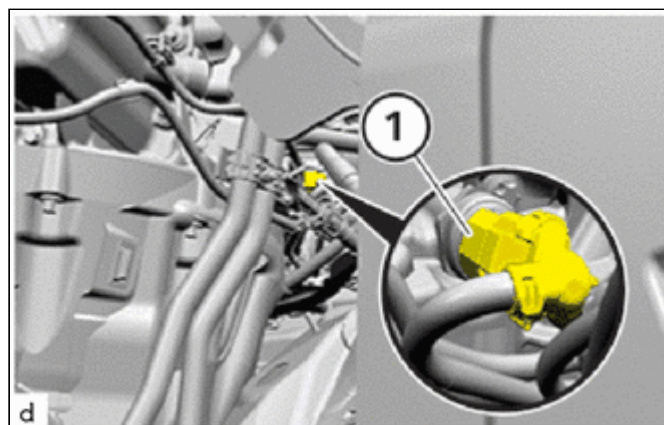

(b) Using a 24 mm deep socket wrench, detach and remove the oil pressure sensor (1).

Last Modified: 07-26-2024	6.11:8.1.0	Doc ID: RM100000001R4WZ
Model Year Start: 2021	Model: Supra	Prod Date Range: [07/2020 -]
Title: B48 (LUBRICATION): OIL PRESSURE SENSOR: INSTALLATION; 2021 - 2025 MY Supra [07/2020 -]		

INSTALLATION

PROCEDURE

1. INSTALL OIL PRESSURE SENSOR

- (a) Guide in and install the oil pressure sensor.
- (b) Using a 24 mm deep socket wrench, tighten the oil pressure sensor.

Torque:

15 N·m {153 kgf·cm, 11 ft·lbf}

- (c) Connect and lock the connector.

HINT:

The connector must engage audibly.

2. INSTALL OIL FILTER BRACKET

Click here [INFO](#)

3. INSPECT FOR ENGINE OIL LEAK

Click here [INFO](#)

4. CHECK ENGINE OIL LEVEL

Click here [INFO](#)



Sample

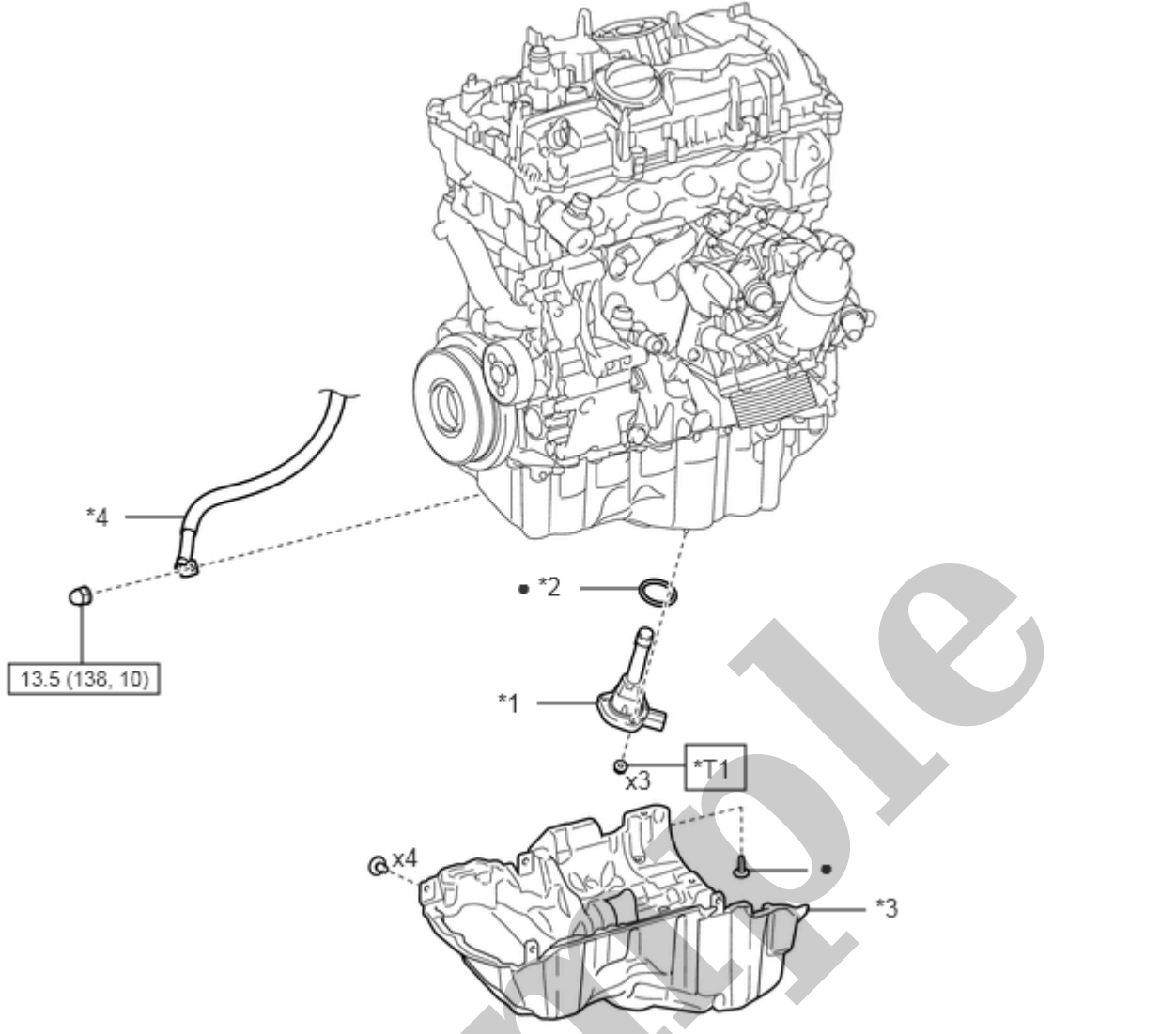

P

*1	ENGINE OIL LEVEL SENSOR	*2	ENGINE OIL LEVEL SENSOR GASKET
*3	OIL PAN COVER	*4	POSITIVE BATTERY CABLE
	N*m (kgf*cm, ft.*lbf): Specified torque	•	Non-reusable part
*T1	1st: 2.0 (20, 18 in.*lbf) 2nd: 8.0 (82, 71 in.*lbf)	-	-

