

Your Ultimate Source for OEM Repair Manuals

FactoryManuals.net is a great resource for anyone who wants to save money on repairs by doing their own work. The manuals provide detailed instructions and diagrams that make it easy to understand how to fix a vehicle.

2013 Ford E-150 Service and Repair Manual

[Go to manual page](#)

[Click here to learn about symbols, color coding, and icons used in this manual.](#)

20. Position the RH (right-hand) timing chain tensioner with the end of the tensioner correctly engaged to the tensioner arm and install the fasteners.

Torque : 89 lb.in (10 Nm)

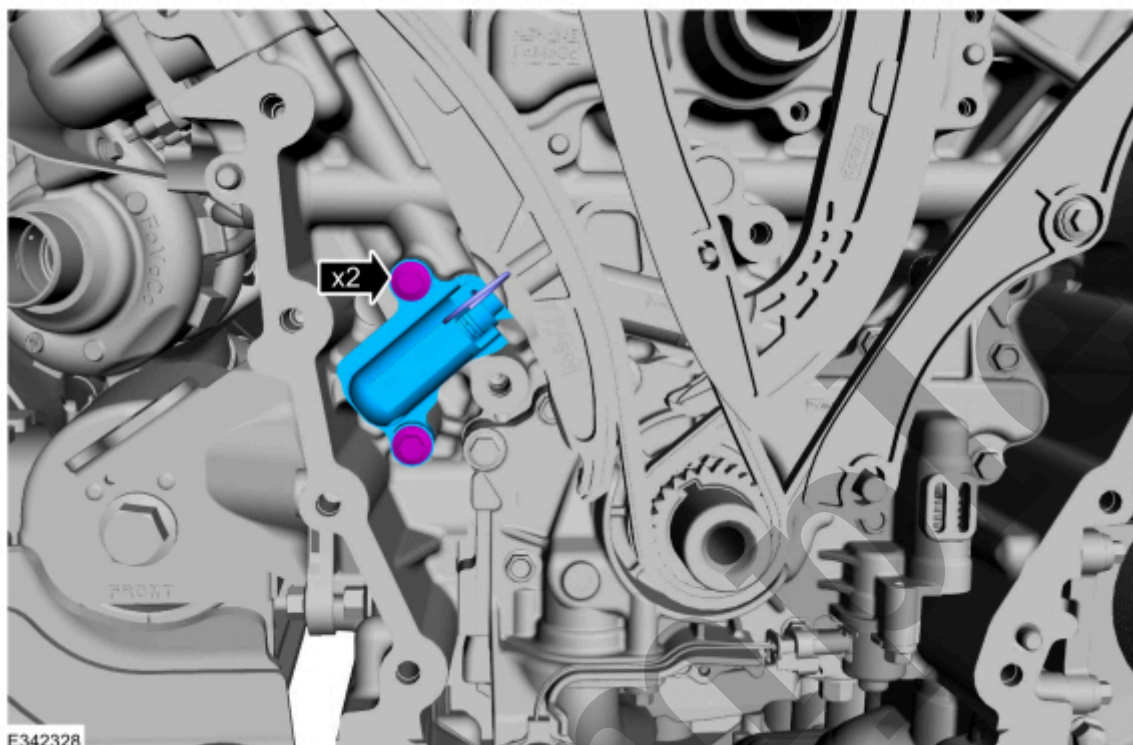

[Click here to learn about symbols, color coding, and icons used in this manual.](#)

21. Remove the tensioner pin.

23. Install the engine front cover.

Refer to: [Engine Front Cover](#)(303-01C Engine - 3.5L EcoBoost (BM), Removal and Installation).

Copyright © Ford Motor Company

Sample

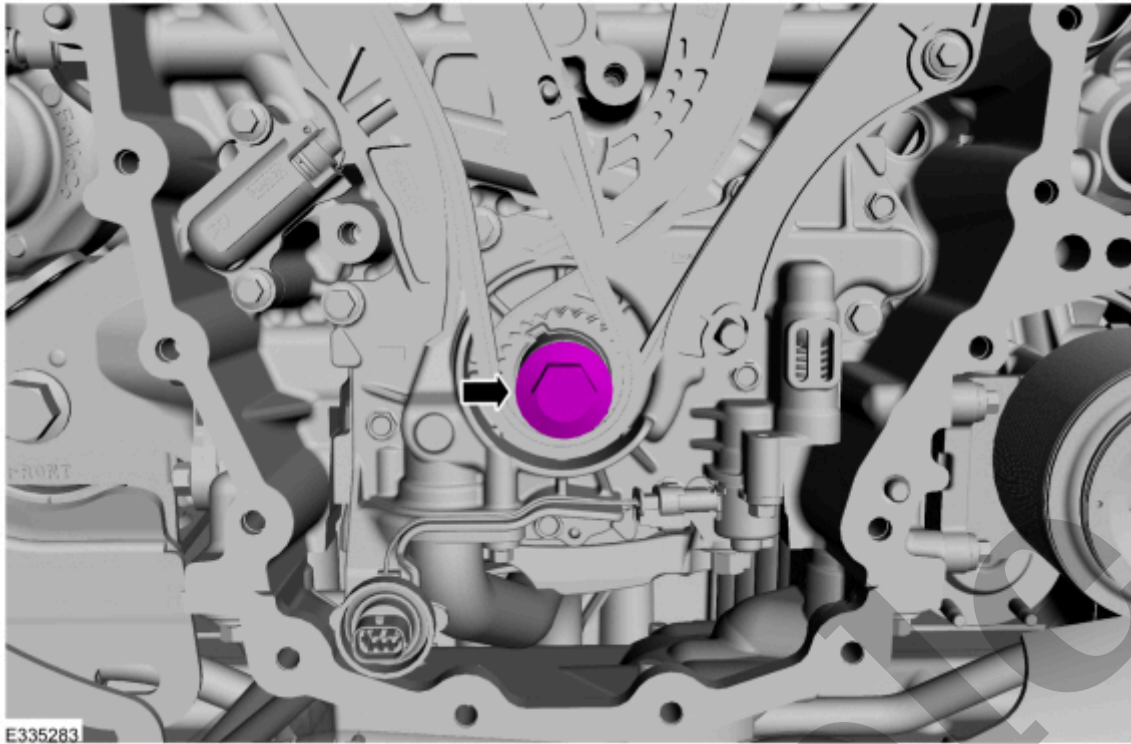

[Click here to learn about symbols, color coding, and icons used in this manual.](#)

3. 1. Rotate the crankshaft clockwise.
2. Position the crankshaft sprocket keyway at the 11 o'clock position.

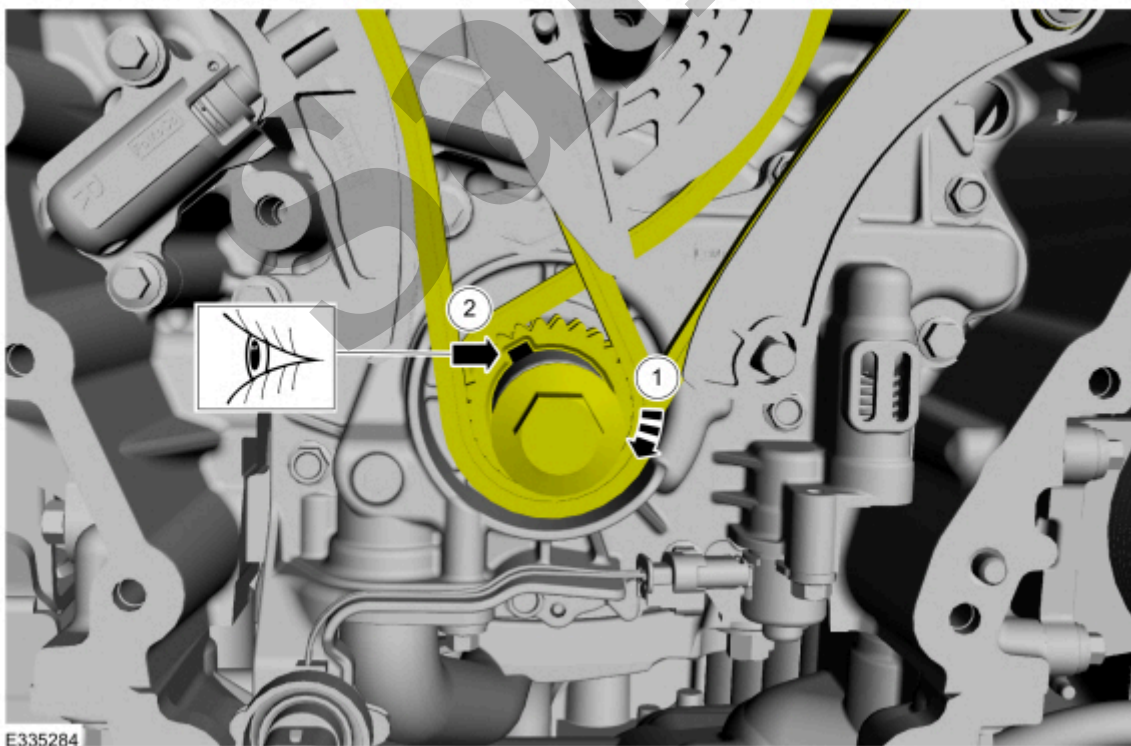

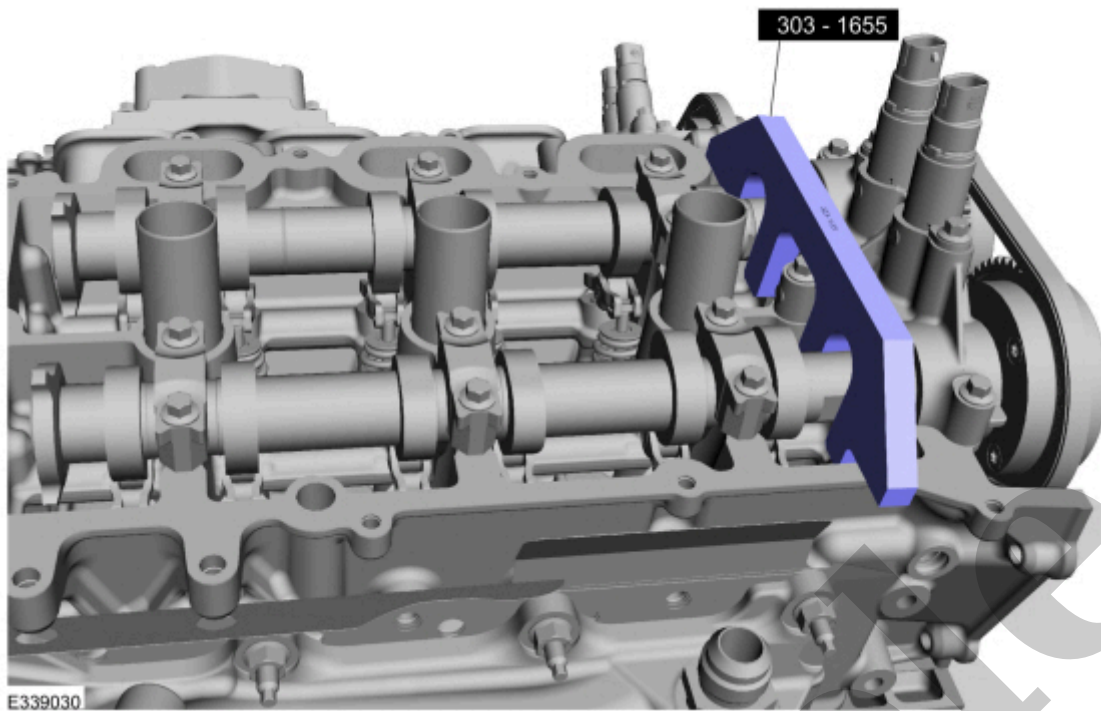

[Click here to learn about symbols, color coding, and icons used in this manual.](#)

6. Remove the bolts and the RH (right-hand) timing chain guide.

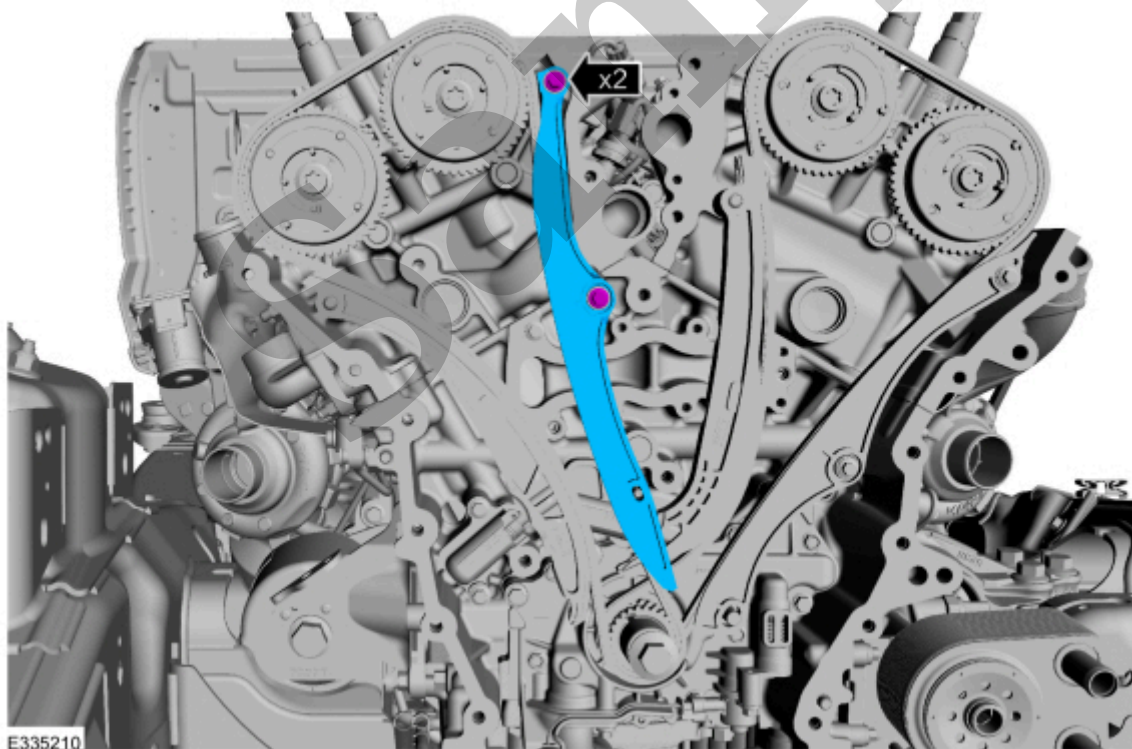

[Click here to learn about symbols, color coding, and icons used in this manual.](#)

7. Remove the bolts and the RH (right-hand) timing chain tensioner.

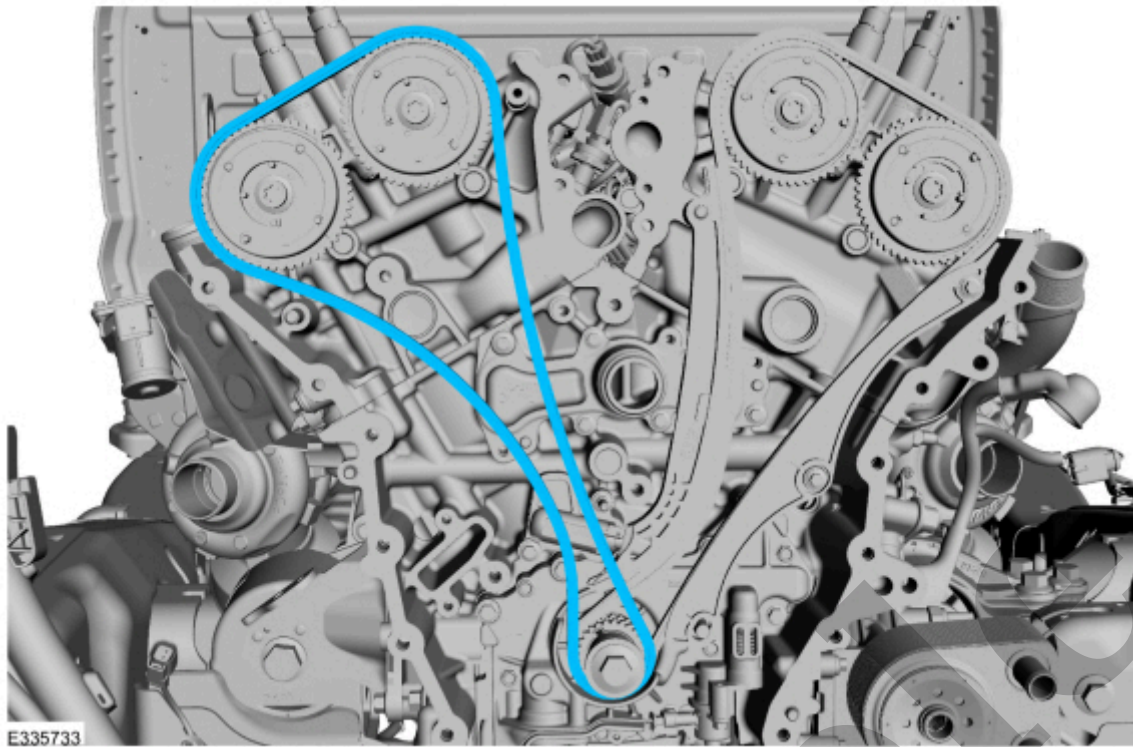

[Click here to learn about symbols, color coding, and icons used in this manual.](#)

LH timing chain

10. NOTE

The Camshaft Holding Tool will hold the camshafts in the TDC (top dead center) position.

Remove Special Service Tool : 303-1655 Tool, Camshaft Holding

12. **NOTE**

The Camshaft Holding Tool will hold the camshafts in the TDC (top dead center) position.

Install Special Service Tool : 303-1655 Tool, Camshaft Holding

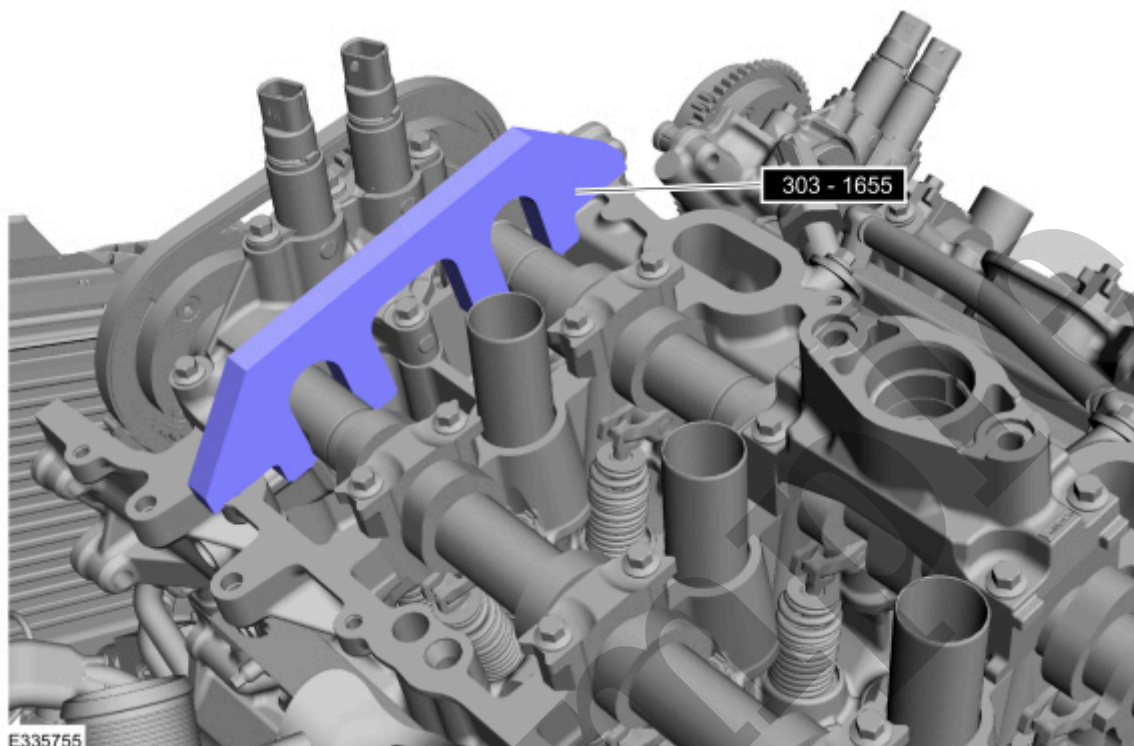

[Click here to learn about symbols, color coding, and icons used in this manual.](#)

13. Remove the bolts and the LH (left-hand) timing chain guide.

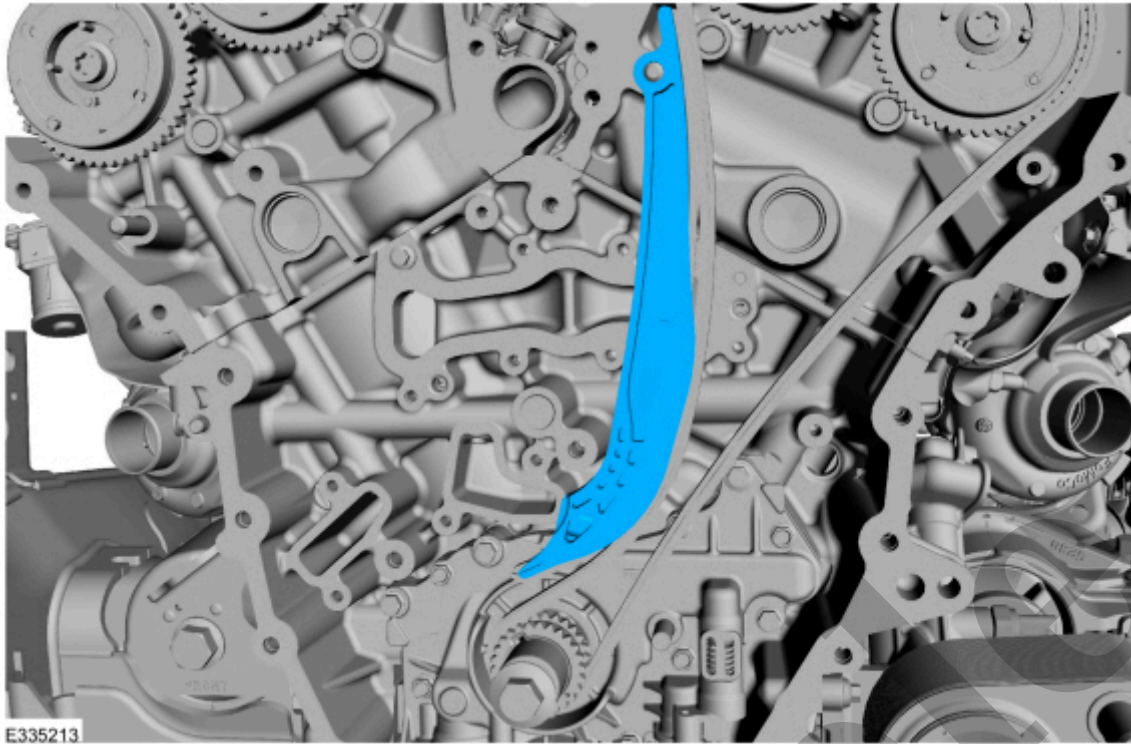

[Click here to learn about symbols, color coding, and icons used in this manual.](#)

16. Remove the LH (left-hand) timing chain.

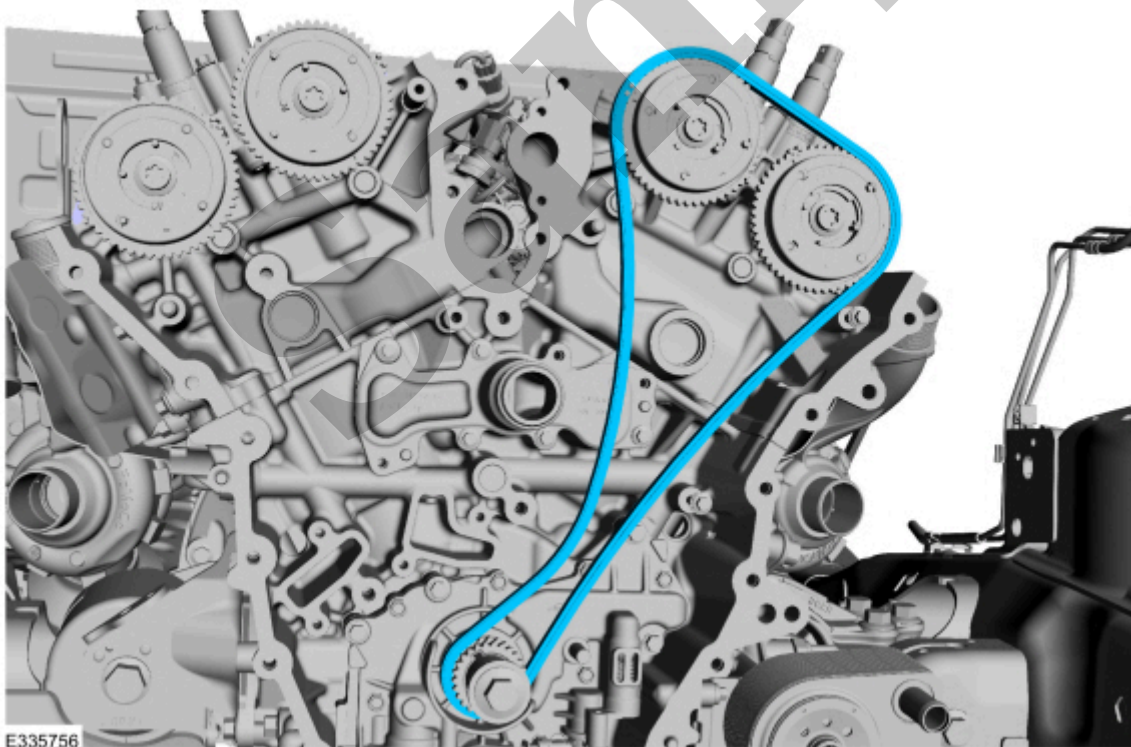

[Click here to learn about symbols, color coding, and icons used in this manual.](#)

17. Remove the crankshaft pulley bolt.

LH timing chain

1. Install the timing chain sprocket.

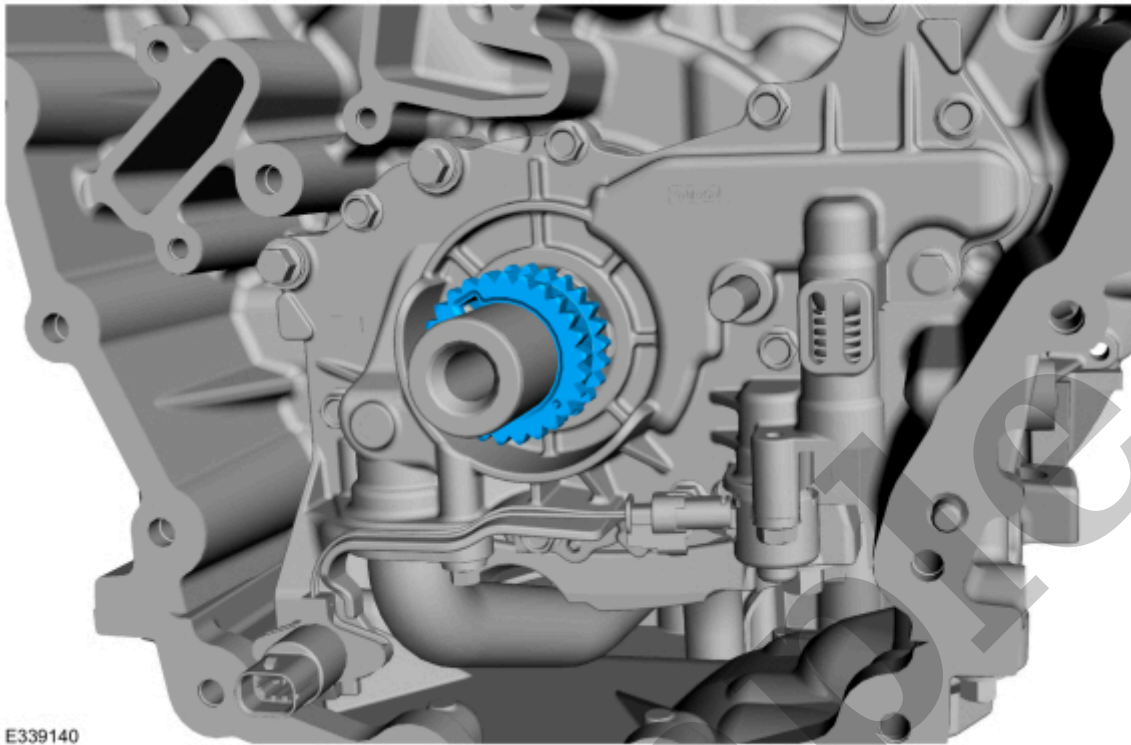

[Click here to learn about symbols, color coding, and icons used in this manual.](#)

2. **NOTE**

The crankshaft sprocket is reversible with a timing mark on each face. For installation of each timing chain, utilize the timing mark on the front face of the crankshaft sprocket for chain alignment.

1. Install the LH (left-hand) timing chain with the single colored links aligned with the timing marks on the VCT (variable camshaft timing) units.
2. Install the double colored links so they straddle the timing mark on the crankshaft sprocket.

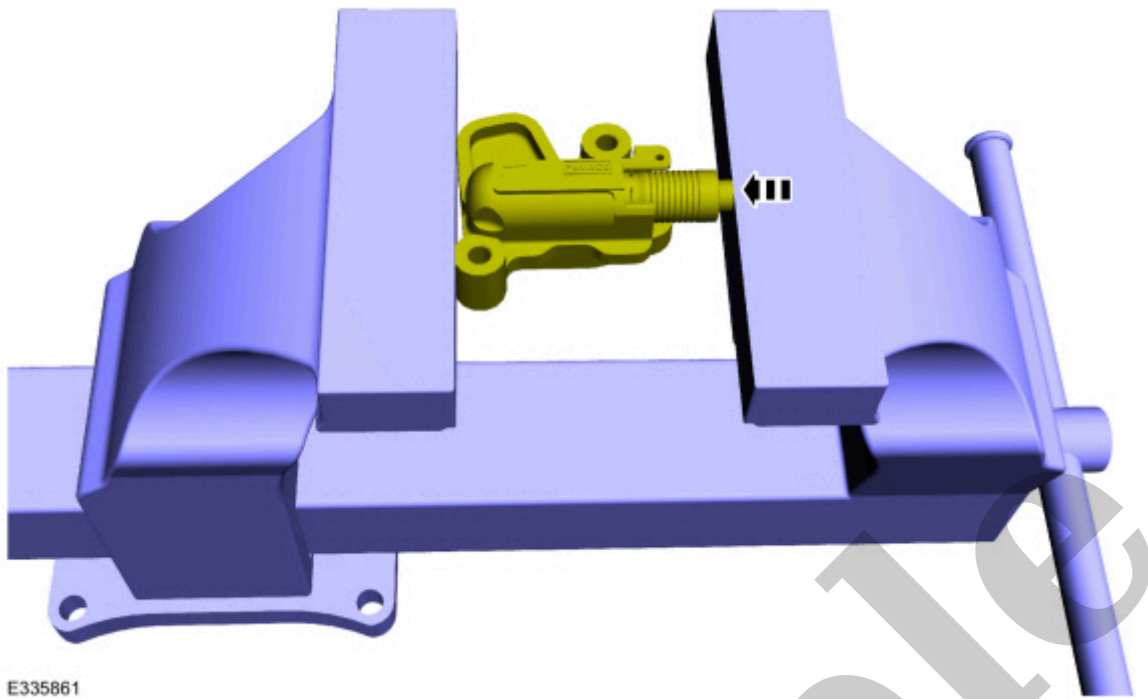

E335861

[Click here to learn about symbols, color coding, and icons used in this manual.](#)

5. **NOTE**

Use of a commercially available tools with a curved radius in the range of 10mm - 15mm is suggested for use in resetting the ratchet clip. Examples are a 8mm closed end wrench, 12x12mm piece of bar stock, T40 to T50 Torx screwdriver or 3/8 wobble style socket extender.

Using a commercially available wrench, push down on the ratchet clip so the ratchet clip pushes outward.