

Your Ultimate Source for OEM Repair Manuals

FactoryManuals.net is a great resource for anyone who wants to save money on repairs by doing their own work. The manuals provide detailed instructions and diagrams that make it easy to understand how to fix a vehicle.

2011 MAZDA BT-50 OEM Service and Repair Workshop Manual

[Go to manual page](#)

REAR DIFFERENTIAL LOCATION INDEX

SM2898022

id03140080030

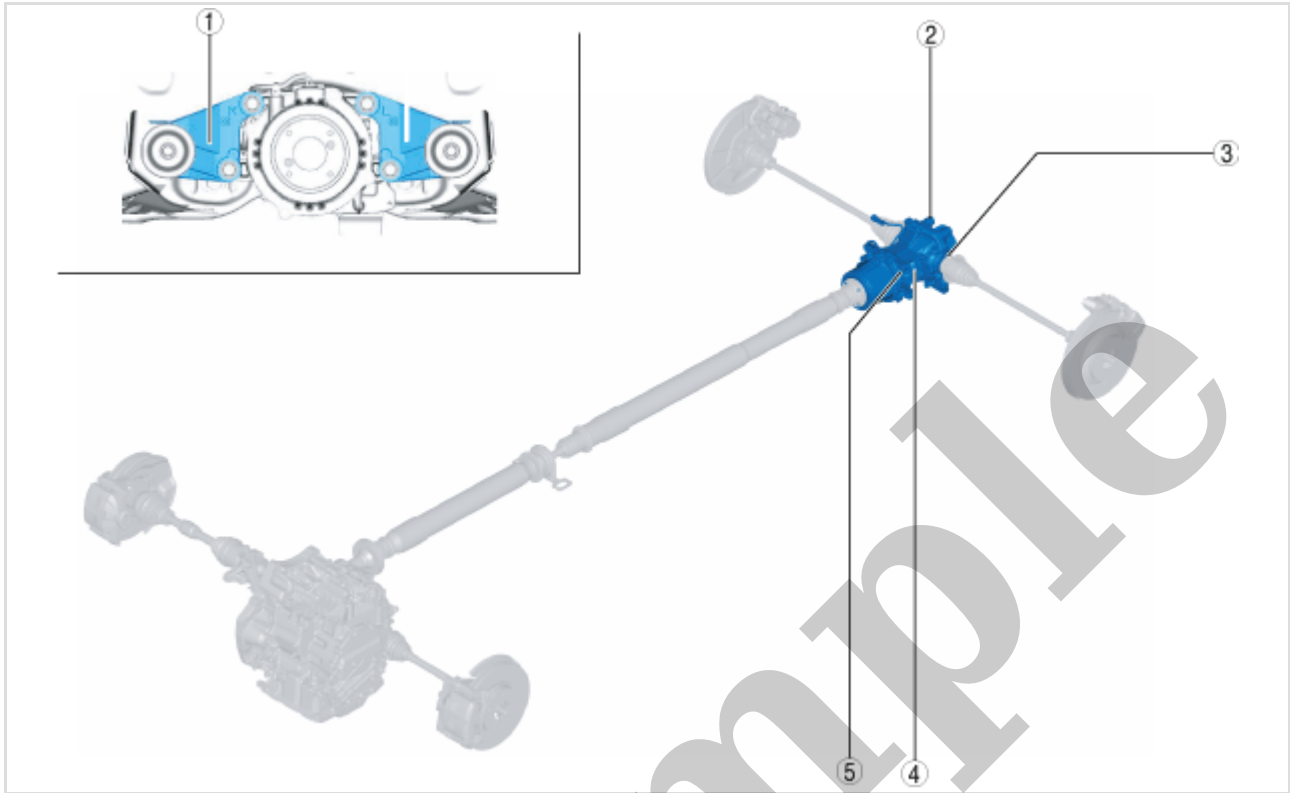

ac5jjw00010904

1	Rear differential mount rubber (See REAR DIFFERENTIAL MOUNT RUBBER REMOVAL/INSTALLATION.)
2	Differential oil (See DIFFERENTIAL OIL INSPECTION.) (See DIFFERENTIAL OIL REPLACEMENT.)
3	Oil seal (side gear) (See OIL SEAL (SIDE GEAR) REPLACEMENT.)
4	Rear differential (See REAR DIFFERENTIAL REMOVAL/INSTALLATION.) (See REAR DIFFERENTIAL DISASSEMBLY.) (See REAR DIFFERENTIAL ASSEMBLY.)
5	Oil seal (coupling component) (See OIL SEAL (COUPLING COMPONENT) REPLACEMENT.)

Sample

REAR DIFFERENTIAL MOUNT RUBBER REMOVAL/INSTALLATION

SM2898025

id03140080300

1.Remove the fuel tank. (See [FUEL TANK REMOVAL/INSTALLATION \[SKYACTIV-G 2.5 \(WITH CYLINDER DEACTIVATION\)\]](#).) (See [FUEL TANK REMOVAL/INSTALLATION \[SKYACTIV-G 2.5 \(WITHOUT CYLINDER DEACTIVATION\)\]](#).) (See [FUEL TANK REMOVAL/INSTALLATION \[SKYACTIV-G 2.5T\]](#).) (See [FUEL TANK REMOVAL/INSTALLATION \[SKYACTIV-D 2.2\]](#).)

2.Support the rear differential component using a jack.

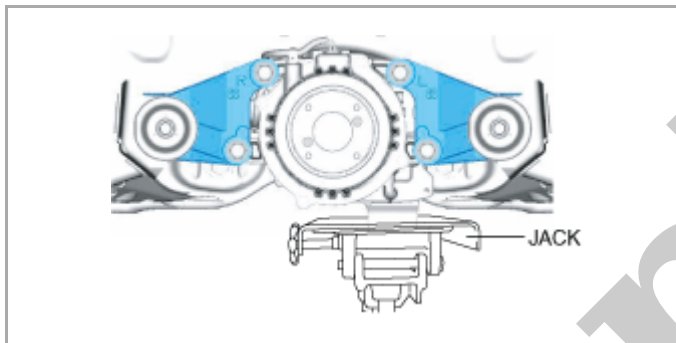

3.Place alignment marks on the rear crossmember and rear differential mount rubber as shown in the figure.

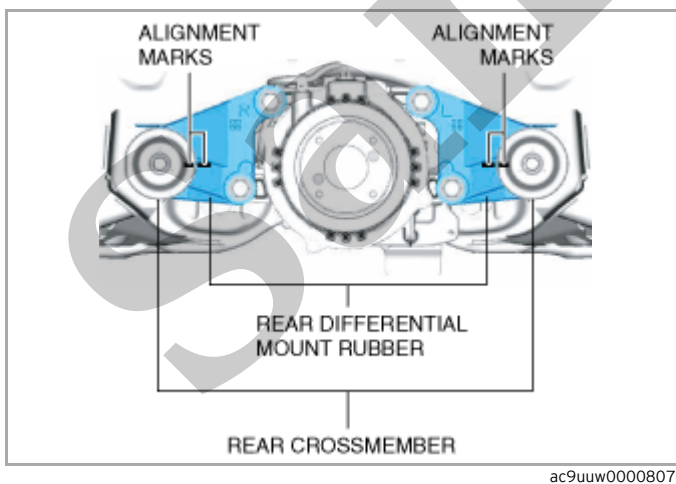

4.Remove the rear differential mount rubber.

PROPELLER SHAFT LOCATION INDEX

SM2898026

id03150014920

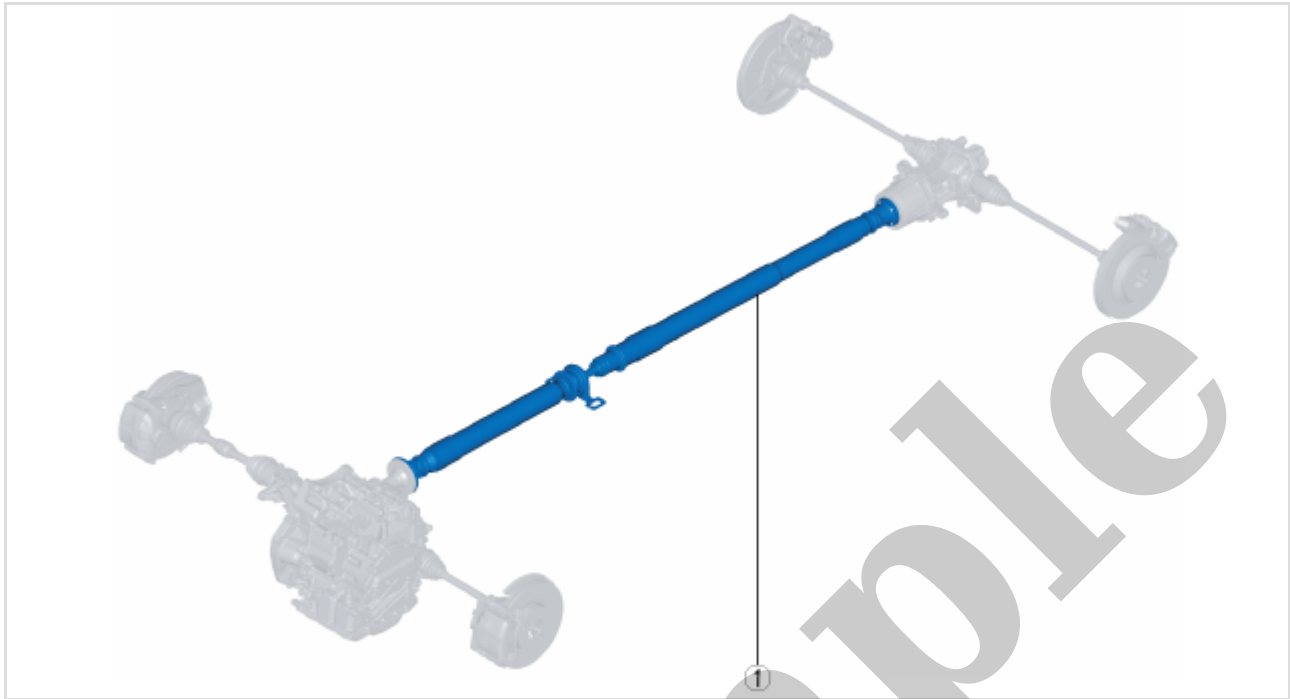

ac5uuw00003814

1	Propeller shaft (See PROPELLER SHAFT REMOVAL/INSTALLATION.) (See PROPELLER SHAFT INSPECTION.) (See PROPELLER SHAFT ON-VEHICLE INSPECTION.)
---	---

(6) Disconnect the bracket from the TWC.

(7) Disconnect the TWC from the main silencer. (See [EXHAUST SYSTEM REMOVAL/INSTALLATION \[SKYACTIV-G 2.5 \(WITH CYLINDER DEACTIVATION\)\]](#).)

(8) Suspend the TWC using a cable as shown in the figure.

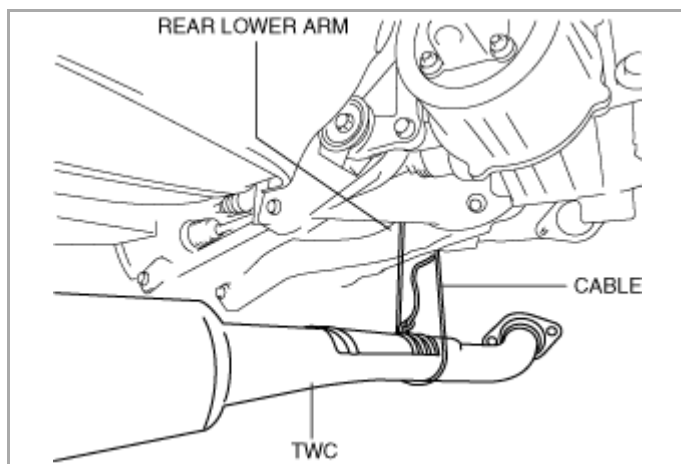

ac5wzw00011231

7. For SKYACTIV-G 2.5T vehicles, perform the following procedure.

(1) Remove the nut.

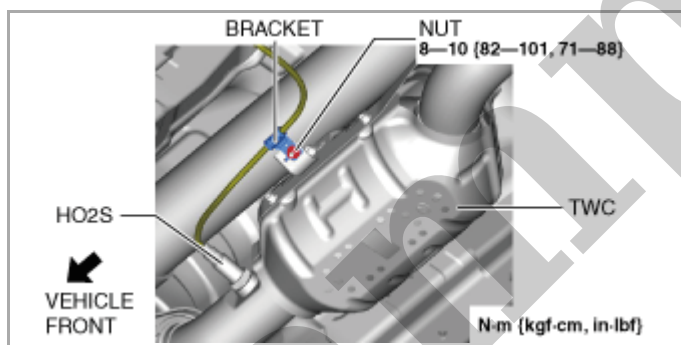

ac5uuw00010762

(2) Disconnect the bracket from the TWC.

(3) Remove the TWC from the mount rubber.

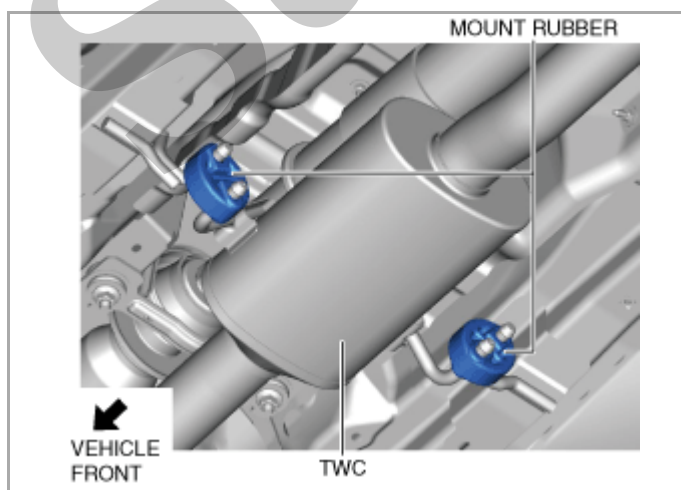

ac5uuw00010763

(4) Disconnect the TWC from the main silencer. (See [EXHAUST SYSTEM REMOVAL/INSTALLATION \[SKYACTIV-G 2.5T\]](#).)

(5) Suspend the TWC using a cable as shown in the figure.

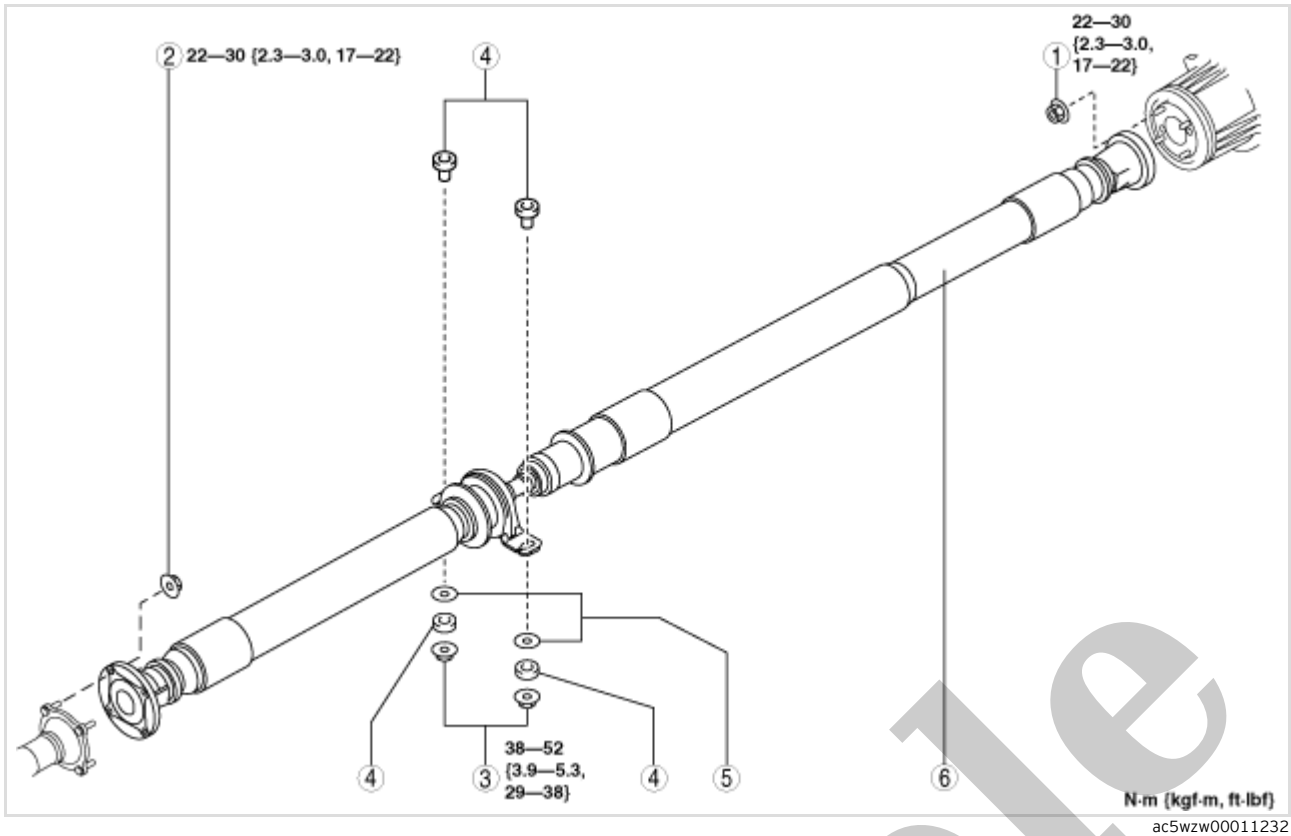

1	Nut (rear) (See Propeller Shaft Removal Note.) (See Propeller Shaft Installation Note.)
2	Nut (front) (See Propeller Shaft Removal Note.) (See Propeller Shaft Installation Note.)
3	Nut (center bearing support) (See Propeller Shaft Removal Note.) (See Propeller Shaft Installation Note.)
4	Bush, spacer
5	Washer
6	Propeller shaft (See Propeller Shaft Removal Note.) (See Propeller Shaft Installation Note.)

Propeller Shaft Removal Note

Caution

- Do not mark with a punch to prevent imbalance.

1. Before removing the nut, place alignment marks on the companion flange (front) and constant velocity joint, and on the coupling component (rear) and yoke.

PROPELLER SHAFT INSPECTION

SM2898028

id03150014940

1. Measure the propeller shaft center runout using the dial gauge.

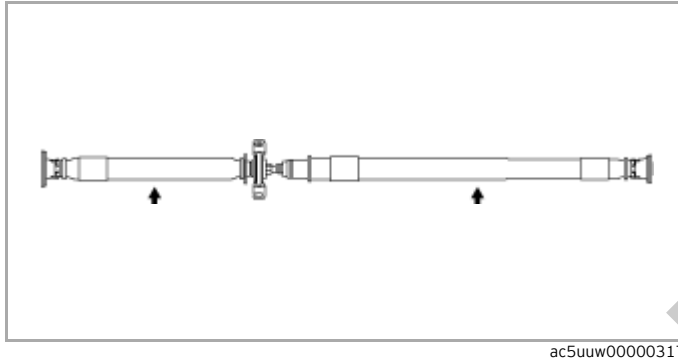

ac5uuw00000317

Propeller shaft maximum runout

0.8 mm {0.031 in}

- If it exceeds the maximum specification, replace the propeller shaft as a single component. (See **PROPELLER SHAFT REMOVAL/INSTALLATION.**)

2. Inspect the play and rotation of the joint by turning the universal joint in the directions shown by the arrows.

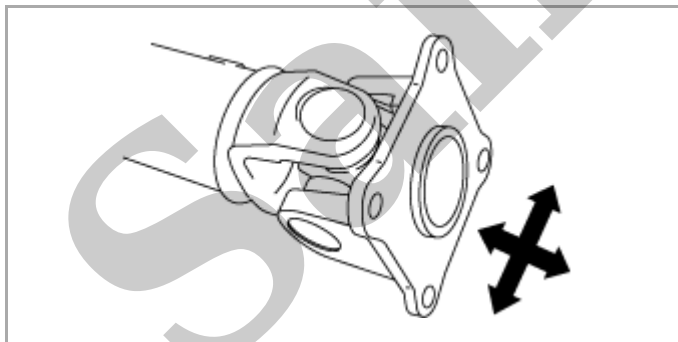

acxuuw00003098

Propeller shaft rotation torque

0.3–1.4 N·m {3.1–14.0 kgf·cm, 2.7–12.0 in·lbf}

- If it is not within the specification, replace the propeller shaft. (See **PROPELLER SHAFT REMOVAL/INSTALLATION.**)

TRANSFER LOCATION INDEX [FW6AX-EL, GW6AX-EL]

SM2898030

id0316g680010

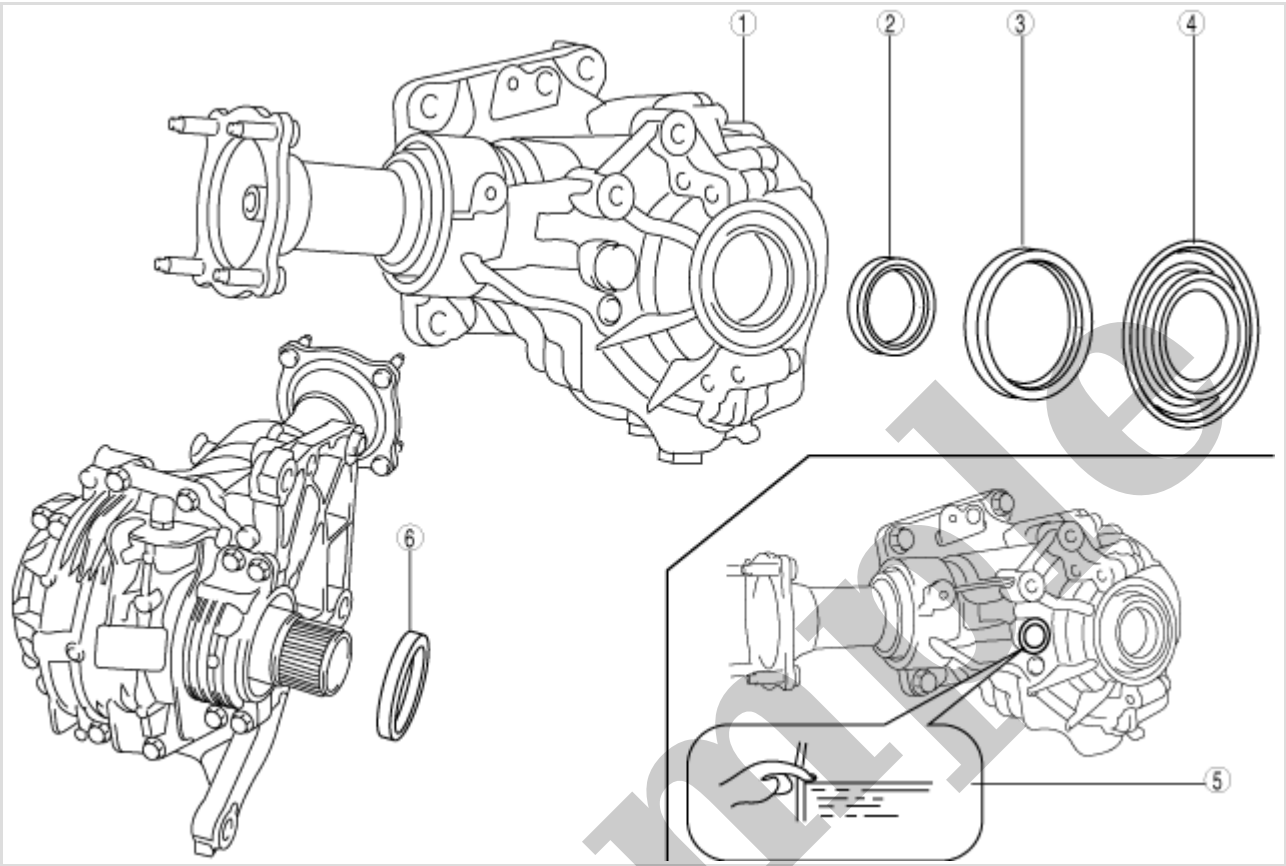

ac5uuw00011829

1	Transfer (See TRANSFER REMOVAL/INSTALLATION [FW6AX-EL].) (See TRANSFER REMOVAL/INSTALLATION [GW6AX-EL (SKYACTIV-G 2.5T)].) (See TRANSFER REMOVAL/INSTALLATION [GW6AX-EL (SKYACTIV-D 2.2)].)
2	Transfer oil seal (RH) No.3 (See TRANSFER OIL SEAL REPLACEMENT [FW6AX-EL, GW6AX-EL].)
3	Transfer oil seal (RH) No.2 (See TRANSFER OIL SEAL REPLACEMENT [FW6AX-EL, GW6AX-EL].)
4	Transfer oil seal (RH) No.1 (See TRANSFER OIL SEAL REPLACEMENT [FW6AX-EL, GW6AX-EL].)
5	Transfer oil (See TRANSFER OIL INSPECTION [FW6AX-EL, GW6AX-EL].) (See TRANSFER OIL REPLACEMENT [FW6AX-EL, GW6AX-EL].)
6	Transfer oil seal (LH) (See TRANSFER OIL SEAL REPLACEMENT [FW6AX-EL, GW6AX-EL].)

TRANSFER OIL REPLACEMENT [FW6AX-EL, GW6AX-EL]

SM2898032

id0316g680030

Replacement Part

Washer	Washer
Quantity: 1	Quantity: 1
Location of use: Drain plug	Location of use: Oil level plug

Oil and Chemical Type

Transfer oil
Type: MAZDA LONG LIFE HYPOID GEAR OIL SG1

- 1.Remove the front under cover No.2. (See FRONT UNDER COVER No.2 REMOVAL/INSTALLATION.)
- 2.Remove the drain plug with the washer.

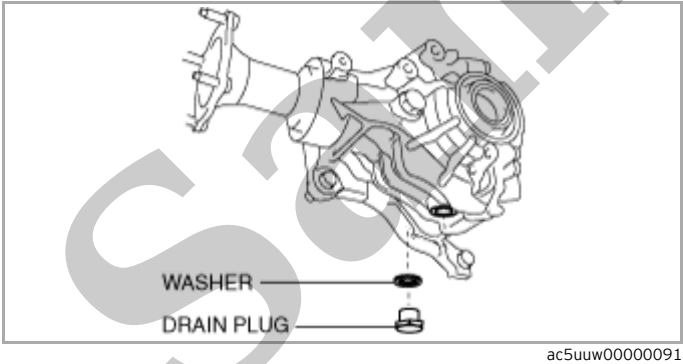

- 3.Drain the oil into a suitable container.
- 4.Tighten the drain plug with a new washer.