

Your Ultimate Source for OEM Repair Manuals

FactoryManuals.net is a great resource for anyone who wants to save money on repairs by doing their own work. The manuals provide detailed instructions and diagrams that make it easy to understand how to fix a vehicle.

2010 JEEP Grand Cherokee OEM Service and Repair Workshop Manual

[Go to manual page](#)

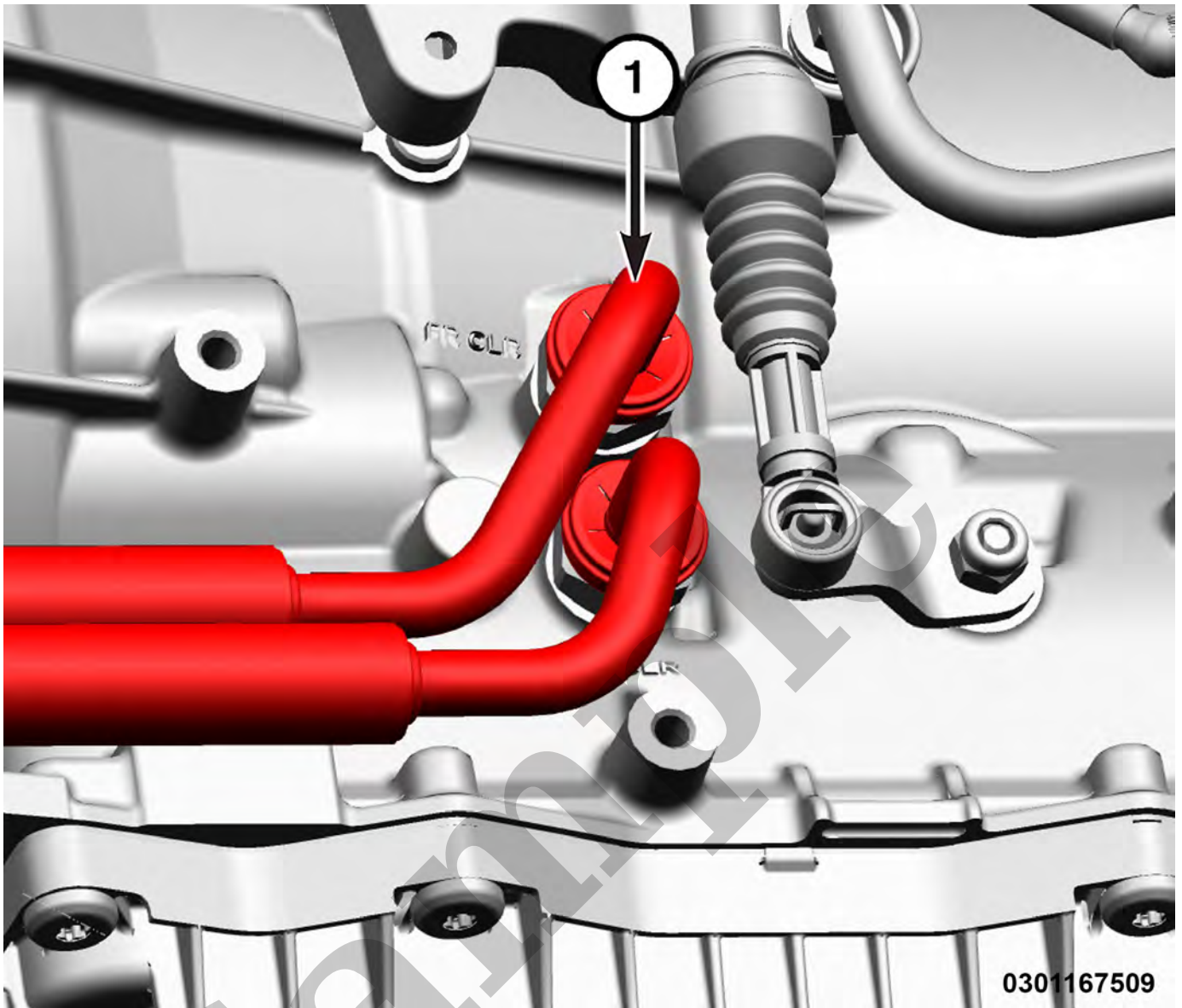

1 - Transmission Oil Cooler Lines

10. Position a drain pan under the transmission lines.

11. Using the

Disconnect Tool

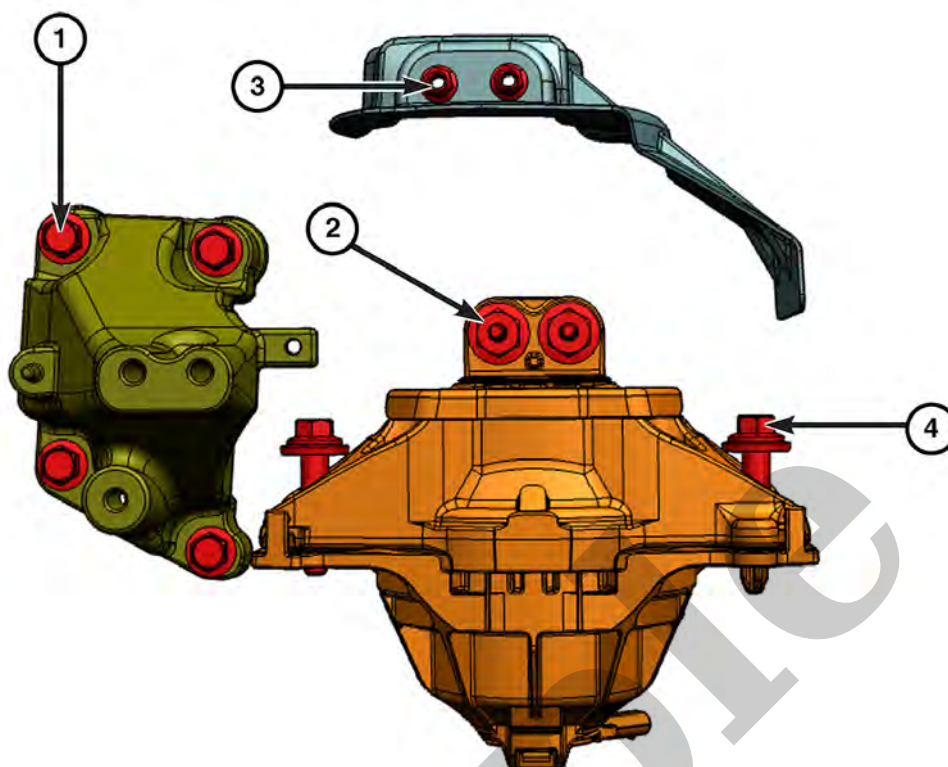

0912190522

| CALLOUT | DESCRIPTION | SPECIFICATION | COMMENTS |
|---------|---|-----------------------------|----------|
| 1 | Left Engine Mount Bracket to Engine Block Bolts | 63 N·m (46 Ft. Lbs.) | – |
| 2 | Left Engine Mount Isolator to Bracket Bolts | 63 N·m (46 Ft. Lbs.) | – |
| 3 | Left Engine Mount Heat Shield Nuts | 11 N·m (8 Ft. Lbs.) | – |
| 4 | Left Engine Mount Isolator to Frame Bolt | 63 N·m (46 Ft. Lbs.) | – |

Refer To List:

List 1

- [09 - Engine, 2.0L / Standard Procedure](#)
- [09 - Engine, 3.6L / Standard Procedure](#)
- [09 - Engine, 5.7L / Standard Procedure](#)

List 2

- [13 - Frame and Bumpers / Under Body Protection / PLATE, Skid / Removal and Installation](#)

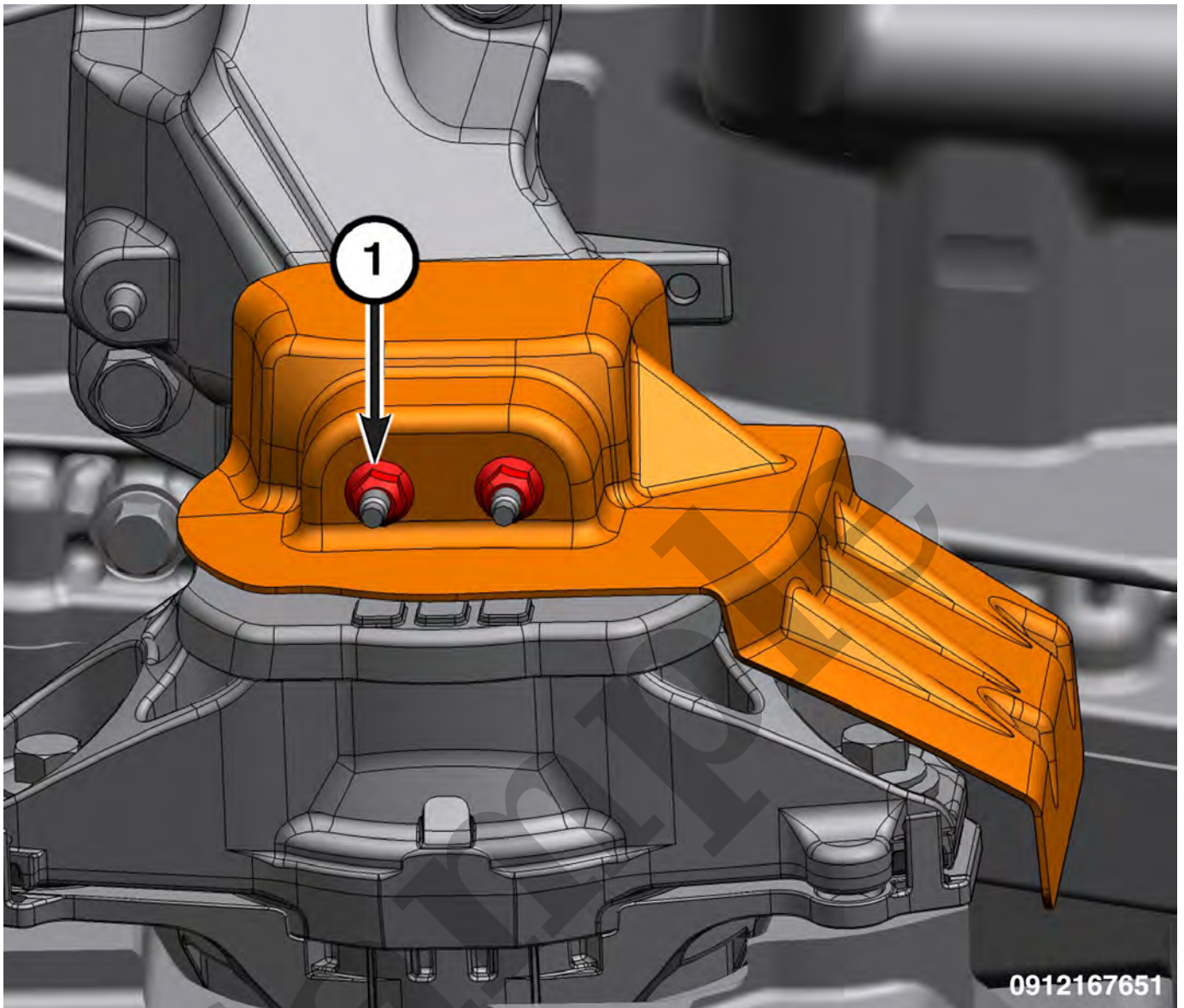

1 - Left Engine Mount Heat Shield Nuts

NOTE

The left engine mount fasteners are accessed from the front under the A/C compressor.

3. Remove the left engine mount heat shield nuts and the left engine mount heat shield.

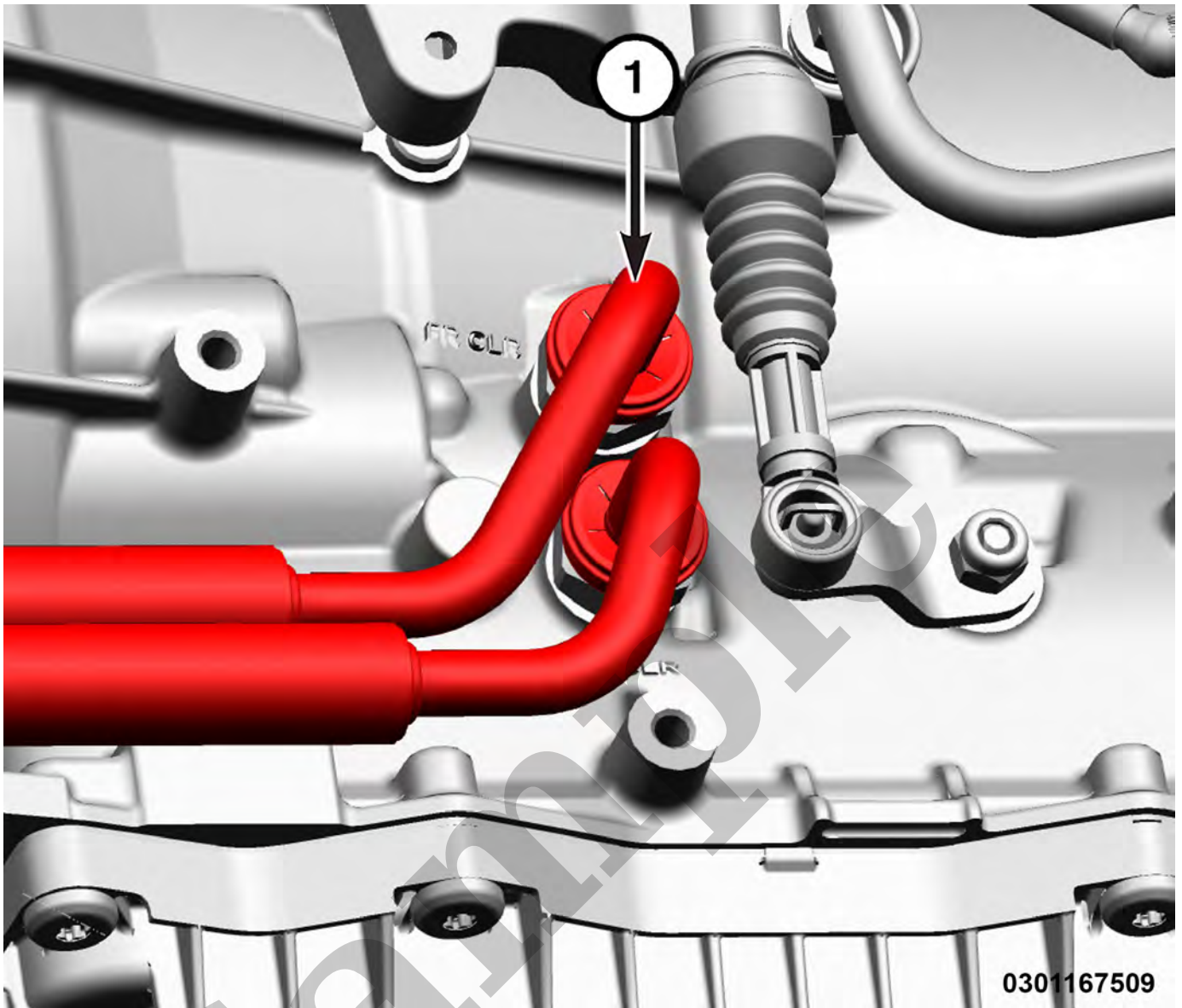

1 - Transmission Oil Cooler Lines

13. Position a drain pan under the trans lines.

14. Using the

Disconnect Tool

RIGHT ENGINE MOUNT

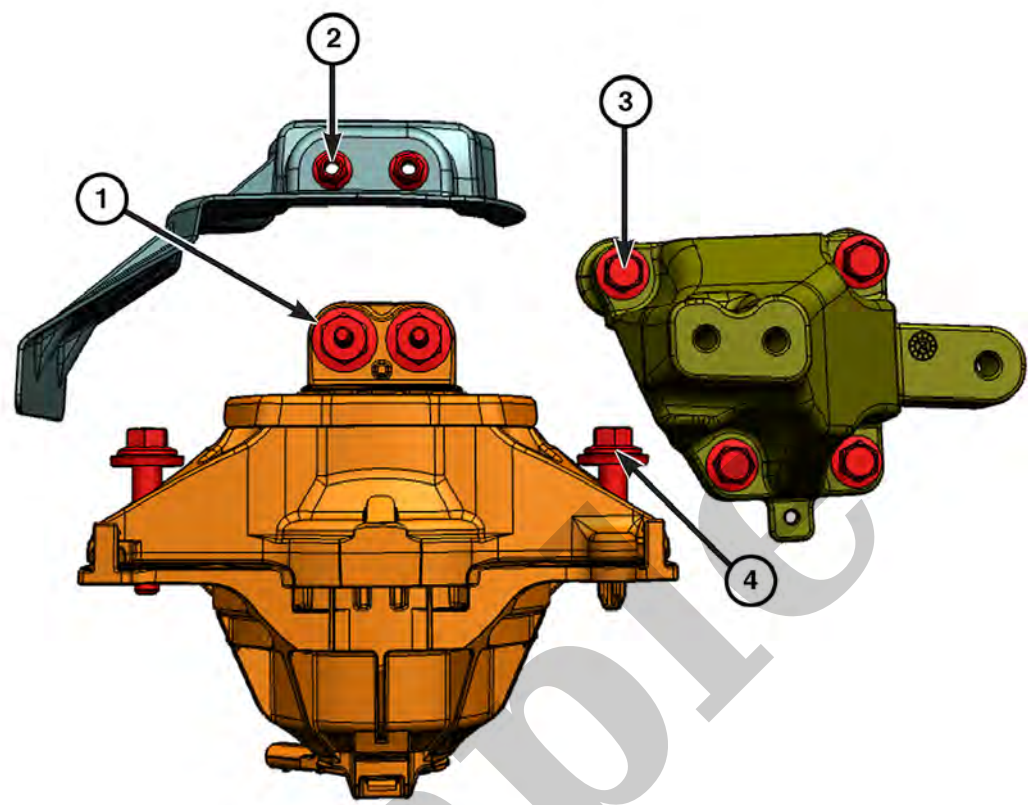

0912190521

| CALLOUT | DESCRIPTION | SPECIFICATION | COMMENTS |
|---------|---|----------------------|----------|
| 1 | Engine Mount Isolator to Engine Mount Bracket Bolts | 63 N·m (46 Ft. Lbs.) | – |
| 2 | Engine Mount Heat Shield Bolts | 11 N·m (8 Ft. Lbs.) | – |
| 3 | Engine Mount Bracket to Engine Block Bolts | 63 N·m (46 Ft. Lbs.) | – |
| 4 | Engine Mount Isolator to Frame Bolts | 63 N·m (46 Ft. Lbs.) | – |

LEFT ENGINE MOUNT

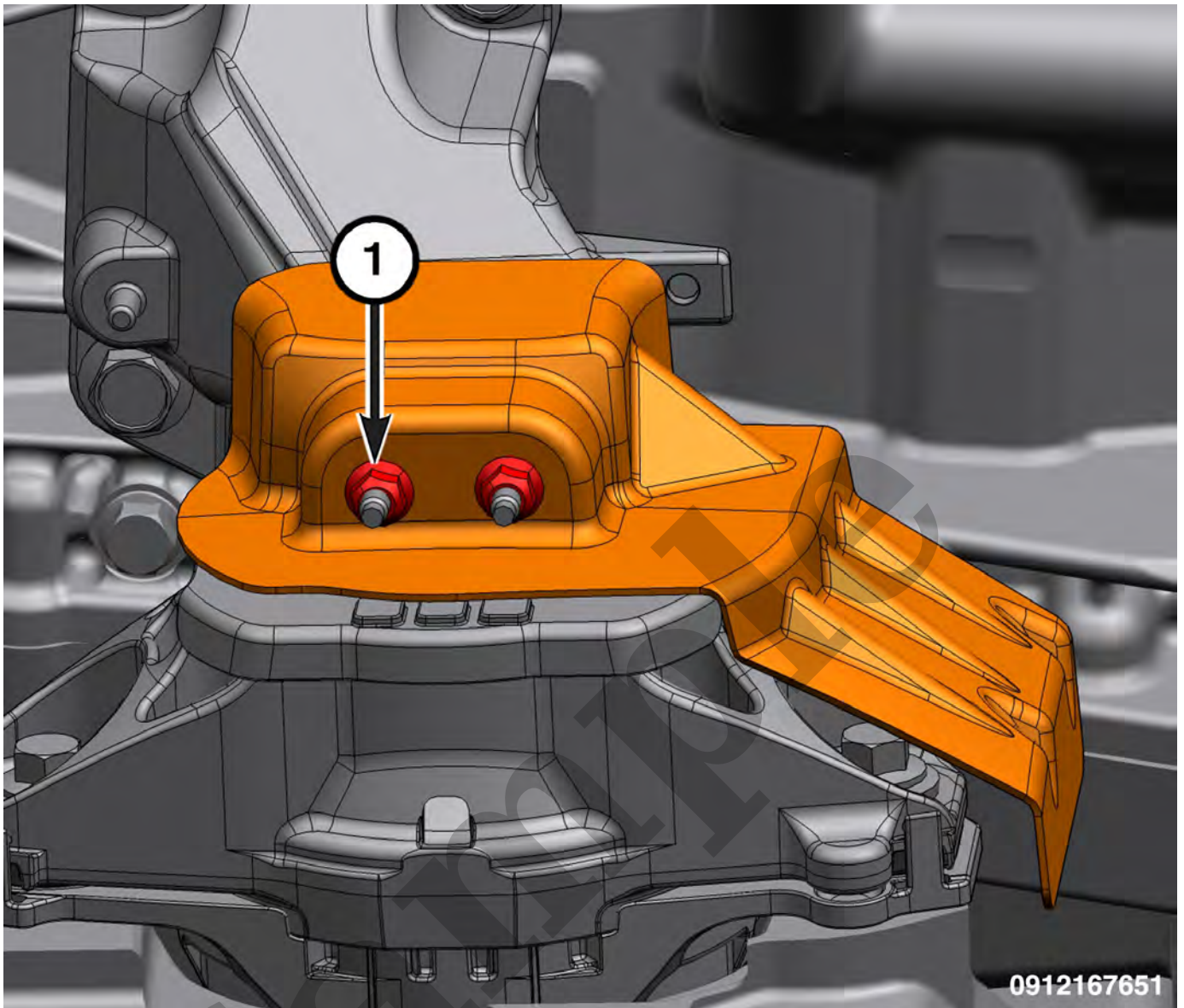

1 - Left Engine Mount Heat Shield Nuts

4. Remove the left engine mount heat shield nuts and the left engine mount heat shield.

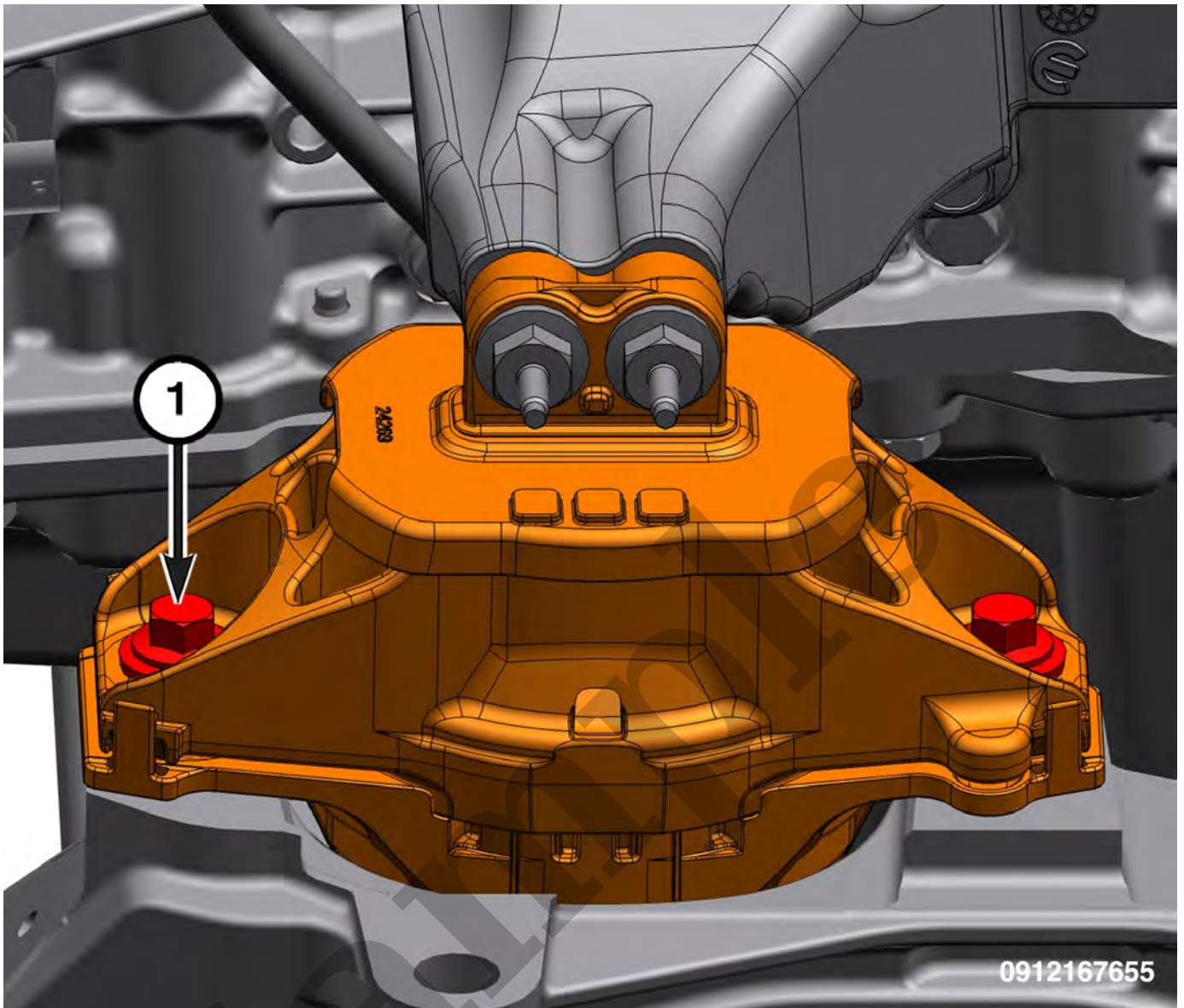

1 - Engine Mount Bolts

9. Remove the right engine mount bolts.

10. Raise the engine.

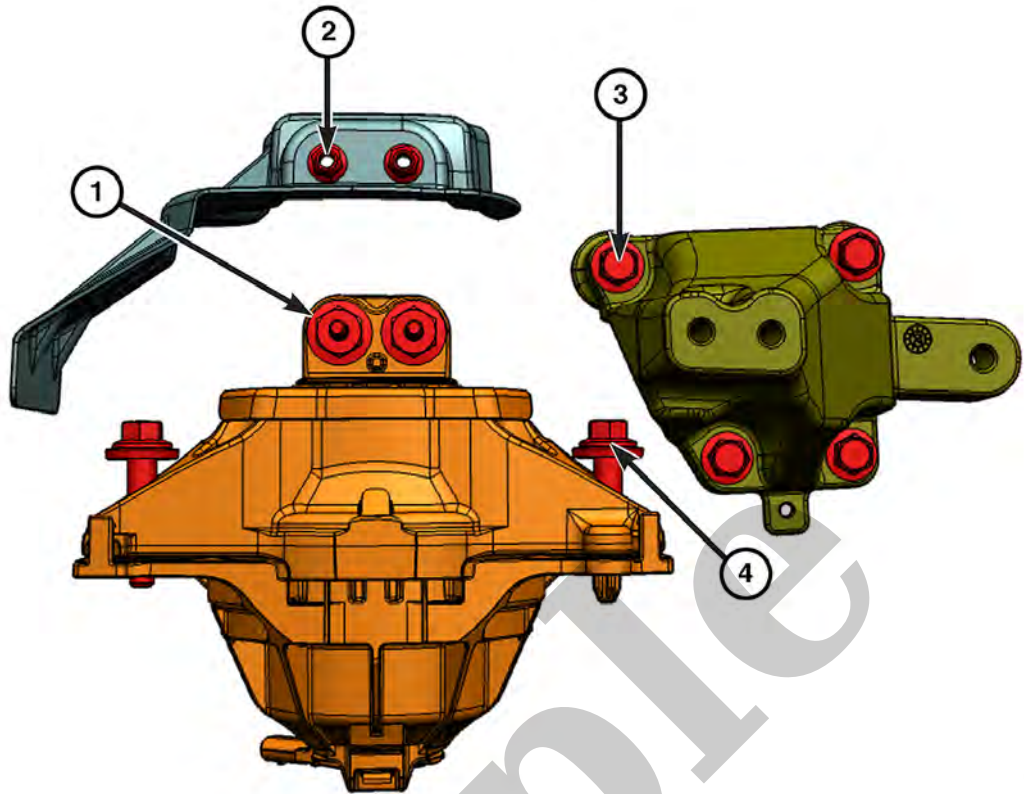

0912190521

| CALLOUT | DESCRIPTION | SPECIFICATION | COMMENTS |
|---------|---|-----------------------------|----------|
| 1 | Engine Mount Isolator to Engine Mount Bracket Bolts | 63 N·m (46 Ft. Lbs.) | – |
| 2 | Engine Mount Heat Shield Bolts | 11 N·m (8 Ft. Lbs.) | – |
| 3 | Engine Mount Bracket to Engine Block Bolts | 63 N·m (46 Ft. Lbs.) | – |
| 4 | Engine Mount Isolator to Frame Bolts | 63 N·m (46 Ft. Lbs.) | – |

LEFT ENGINE MOUNT

Kit, WL Engine Support

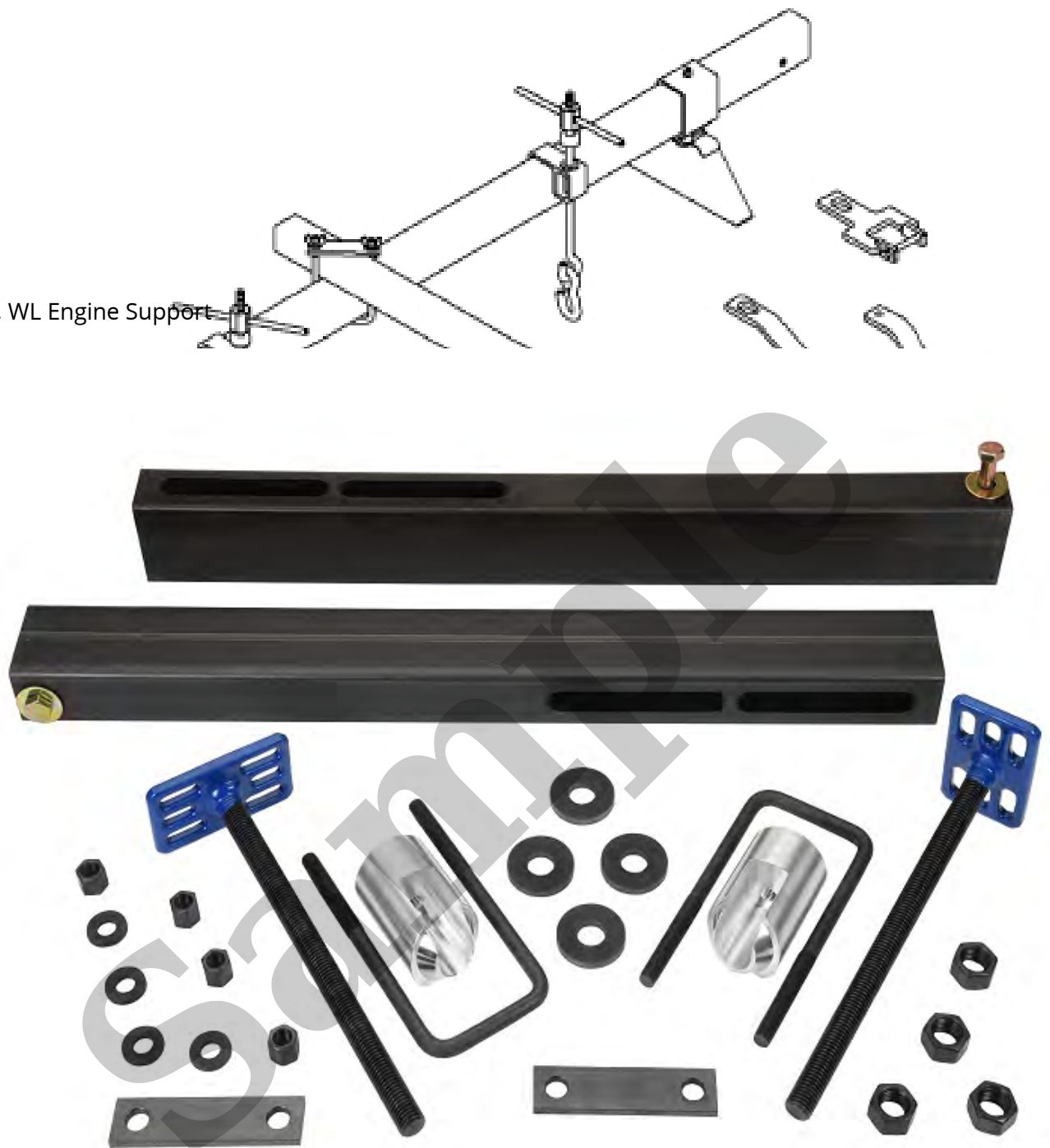

(Refer to Engine/Standard Procedure)(Refer To List 2)

4. Remove the generator ([Refer to Electrical/Charging/GENERATOR/Removal and Installation](#)).