

Your Ultimate Source for OEM Repair Manuals

FactoryManuals.net is a great resource for anyone who wants to save money on repairs by doing their own work. The manuals provide detailed instructions and diagrams that make it easy to understand how to fix a vehicle.

2009 NISSAN Skyline Sedan OEM Service and Repair Workshop Manual

[Go to manual page](#)

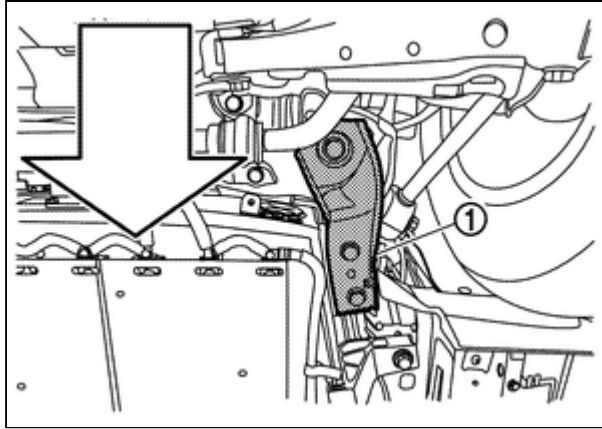

RPR-001999661-73-000346886



: Vehicle front

WARNING:



To prevent electric shock, wear insulated protective gear.



CAUTION:

If replacement of mounting nuts (A) of Li-ion battery side is required, replace according to the following procedure.

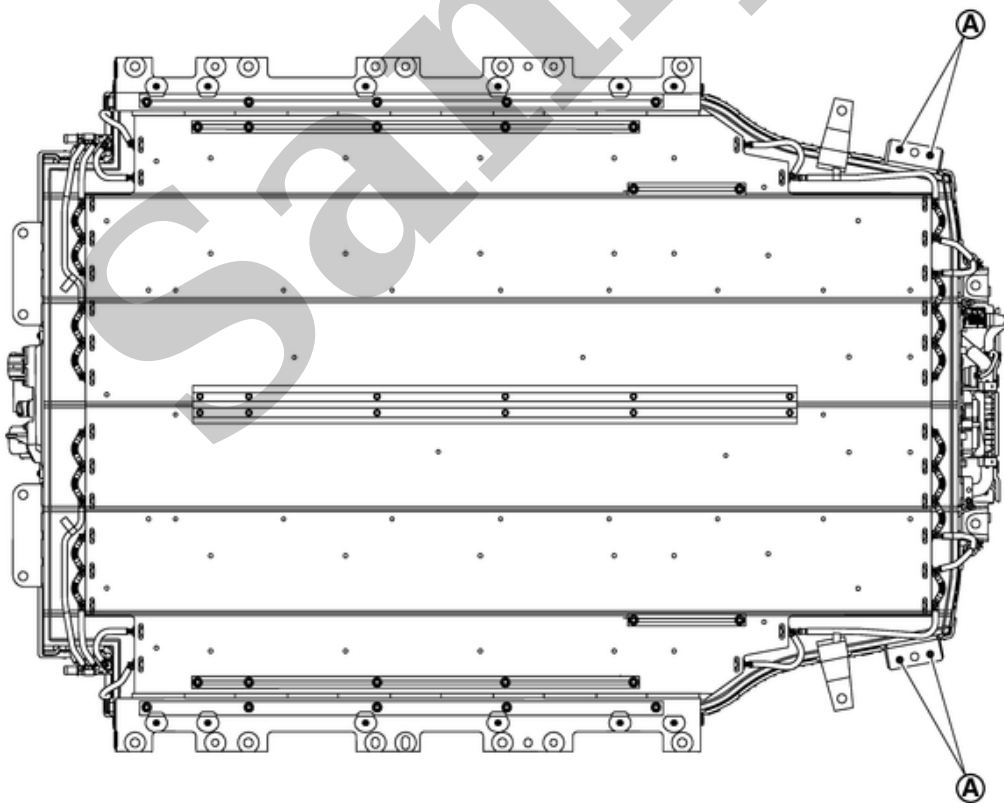

RPR-001999661-74-000346896

1. Cut metal plate (A) next to the nut using nippers (B).

WARNING:



To prevent electric shock, wear insulated protective gear.



- Do not use tools that generate sparks or fire, such as power tools.

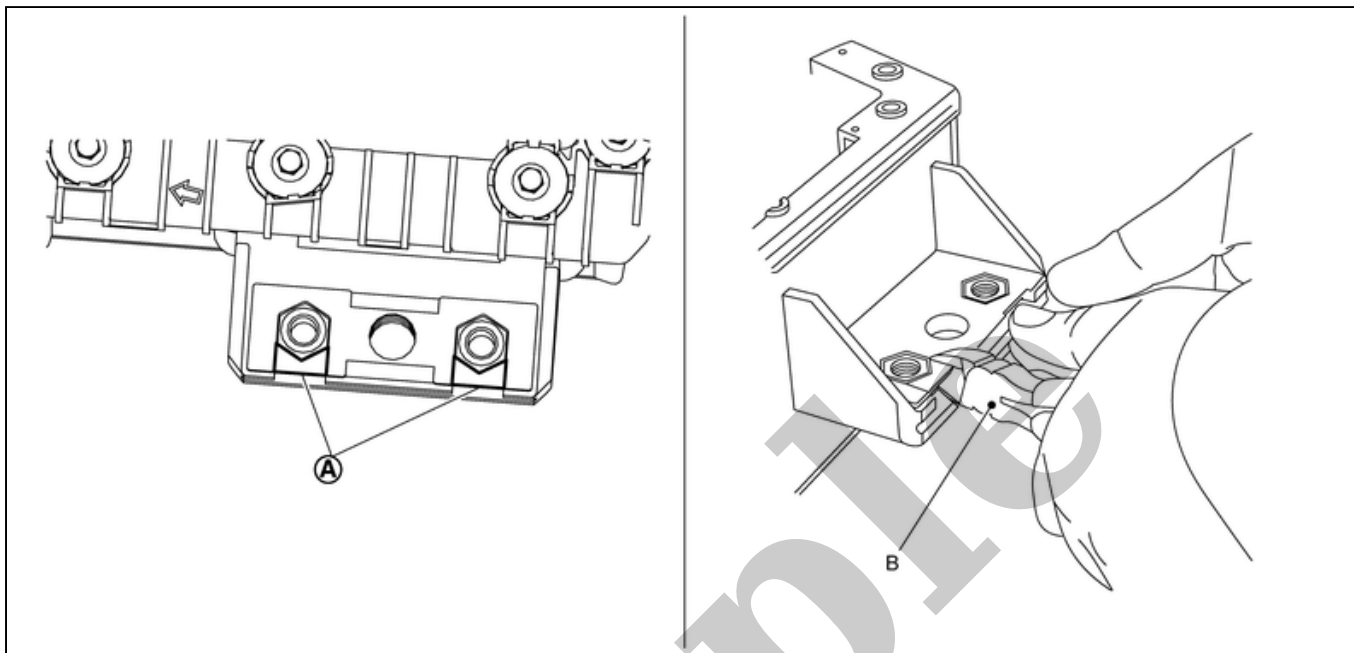

RPR-001999661-75-000346897

- Slide nuts **A** to the arrow direction and remove them from Li-ion battery.

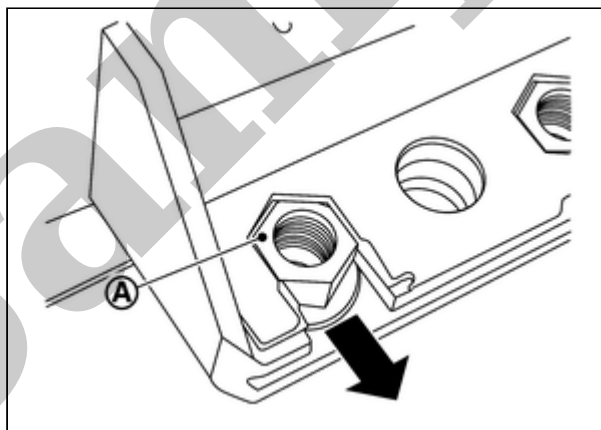

RPR-001999661-76-000346898

WARNING:



To prevent electric shock, wear insulated protective gear.



- Slide new nut **A** to the arrow direction and install it from Li-ion battery.

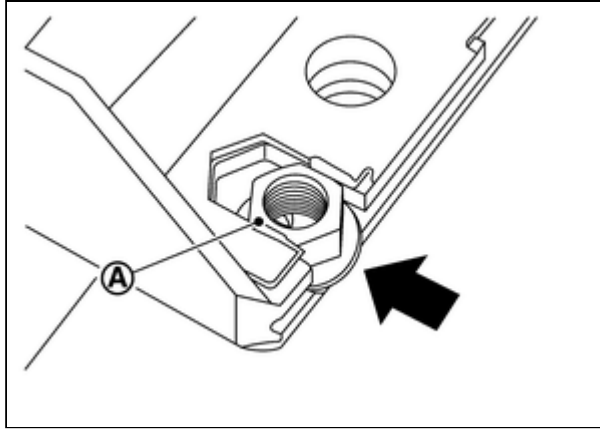

RPR-001999661-77-000346899

CAUTION:

The metal plate cut part is left as it is (No repair required).

WARNING:



To prevent electric shock, wear insulated protective gear.



16 Remove mounting bolt of left member stay (Rear side). Refer to [REAR SUSPENSION MEMBER : Removal & Installation](#).

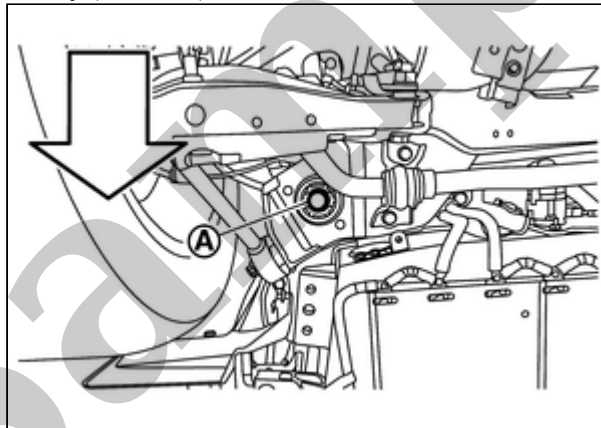

RPR-001999661-78-000346885



: Vehicle front

17 Install left member stay (Rear side). Refer to [REAR SUSPENSION MEMBER : Removal & Installation](#).

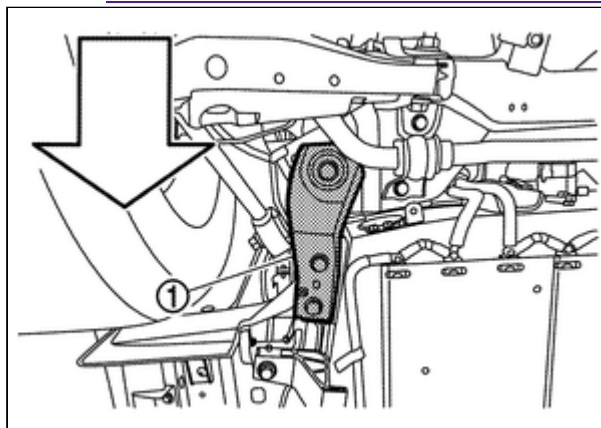

RPR-001999661-79-000346884



: Vehicle front

WARNING:

 To prevent electric shock, wear insulated protective gear.



18 Install high voltage harness connector (A) of quick charge port.

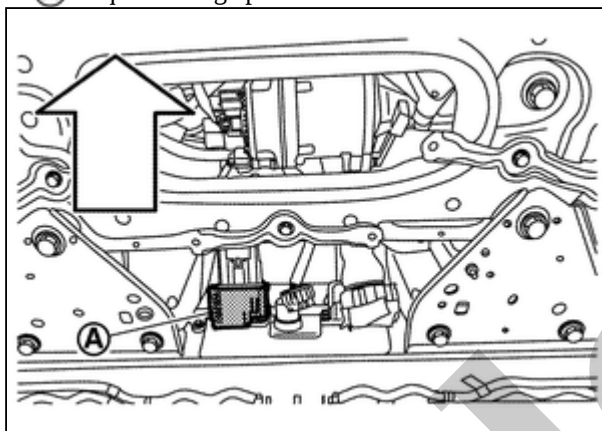

RPR-001999661-86-000346883



: Vehicle front

DANGER:

-  There is the danger of electric shock caused by contact with the terminals. Be sure to wear insulated protective gear.



- Install high voltage harness connector of quick charge port according to the following procedure.

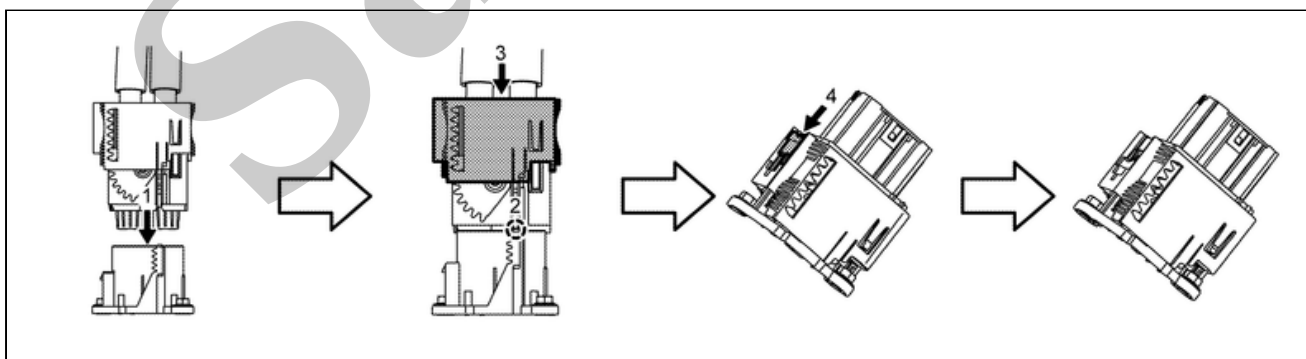

RPR-001999661-87-000346881

CAUTION:

After high voltage harness connector of quick charge port, check the connector for interlock.

19 Install vehicle communication connector of Li-ion battery while turning the connector clockwise.

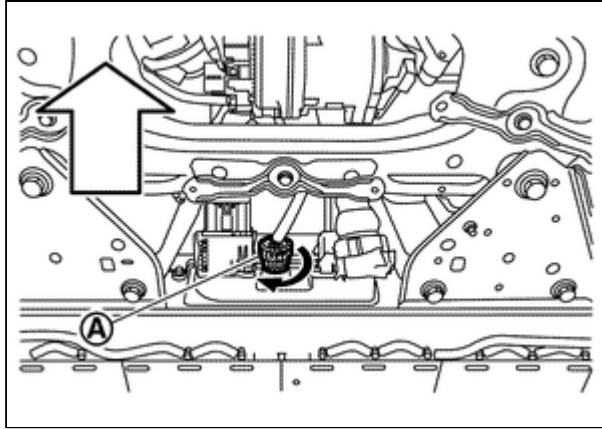

RPR-001999661-88-000346900



: Vehicle front

WARNING:



To prevent electric shock, wear insulated protective gear.



20 Install high voltage harness connector (A) of quick charge port.

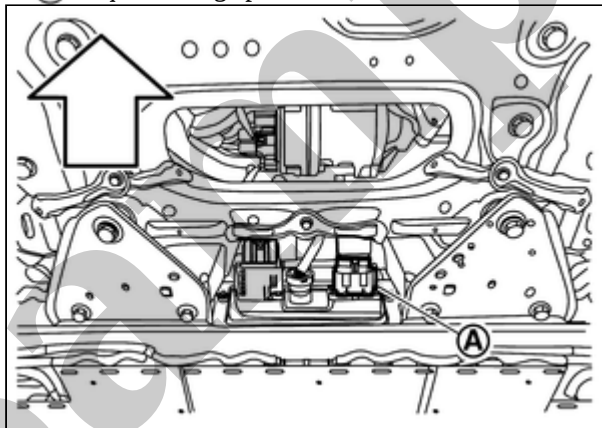

RPR-001999661-89-000346877



: Vehicle front

DANGER:



- There is the danger of electric shock caused by contact with the terminals. Be sure to wear insulated protective gear.



- Install high voltage connector according to the following procedure.

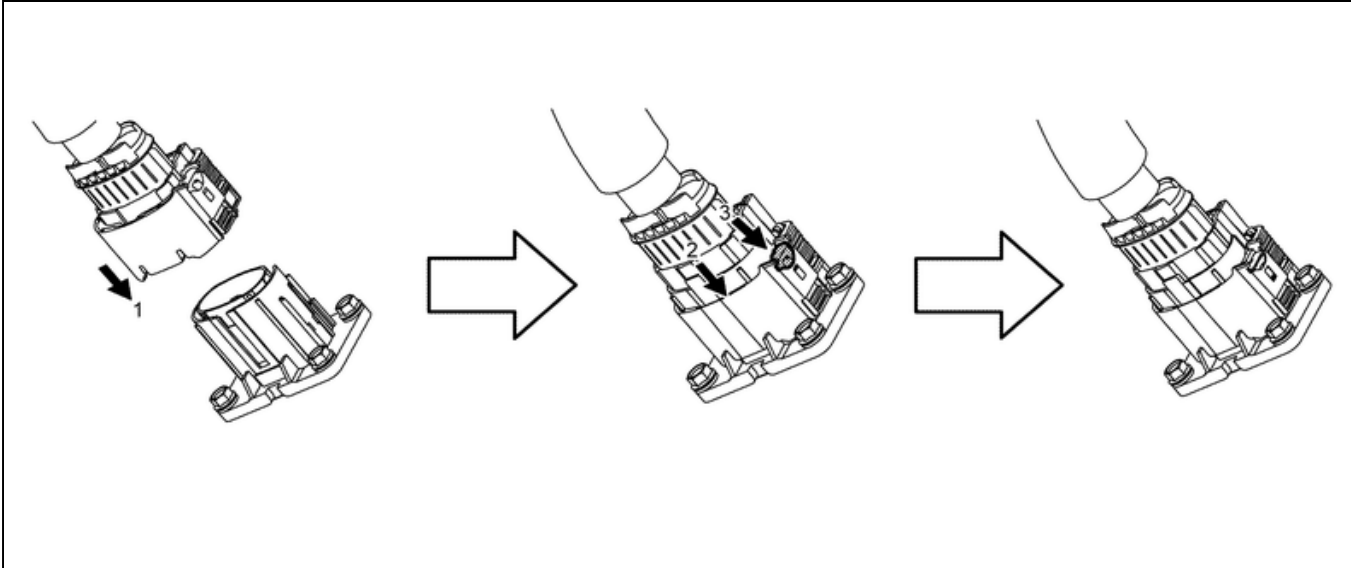

RPR-001999661-90-000346879

21 Install high voltage harness bracket mounting bolt (A) of quick charge port.

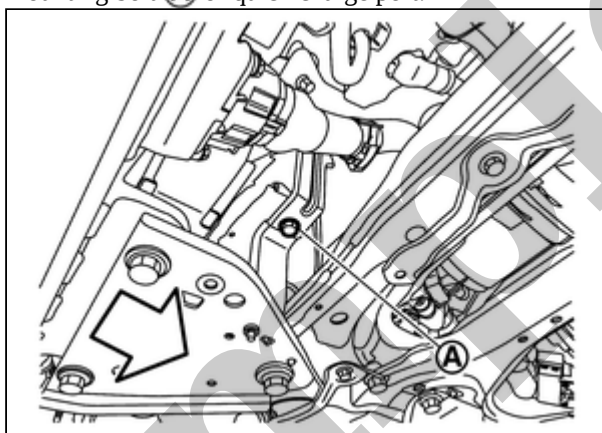

RPR-001999661-91-000346876



22 Install in the reverse order of removal.

Equipotential inspection

After installing battery pack to vehicle, measure resistance between battery pack ground bolt and body ground.

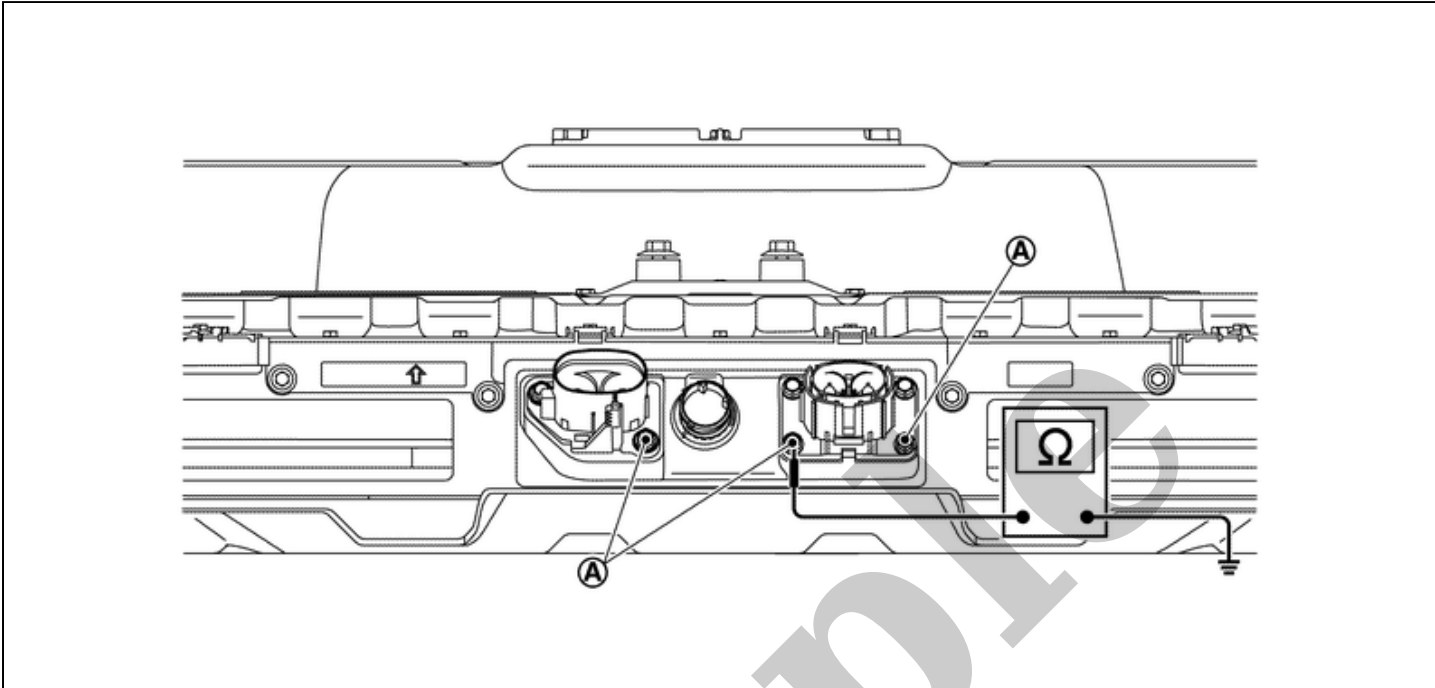

RPR-001999649-01-000373704

WARNING:
 To prevent electric shock, wear insulated protective gear.



Specified value	: Less than 0.1 Ω
-----------------	-------------------

If measured value deviates from the specified value, check ground bolts **A** & **C** for installation and tightening.

Ⓑ

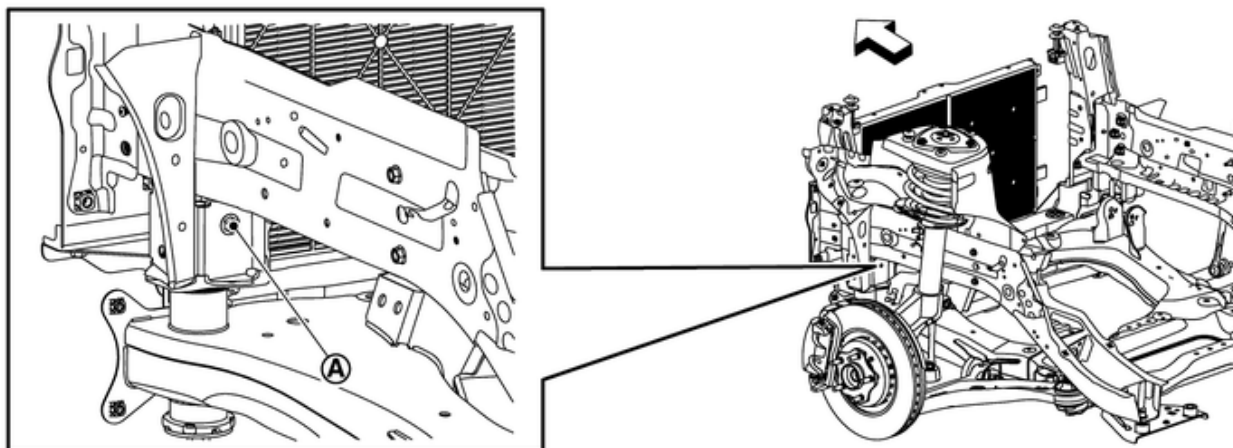

Ⓓ

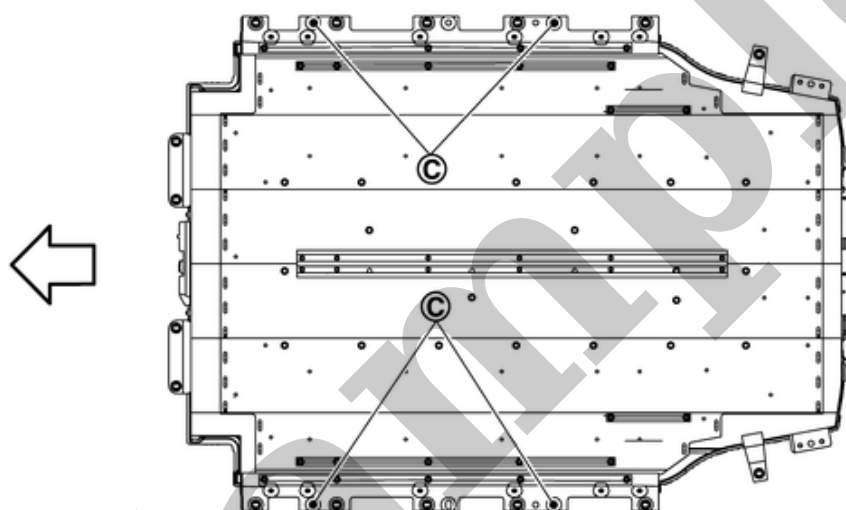

RPR-001999649-02-000373107

Ⓑ	: Left front frame
Ⓓ	: Li-ion battery bottom
←	Vehicle front

SEC. 291•747

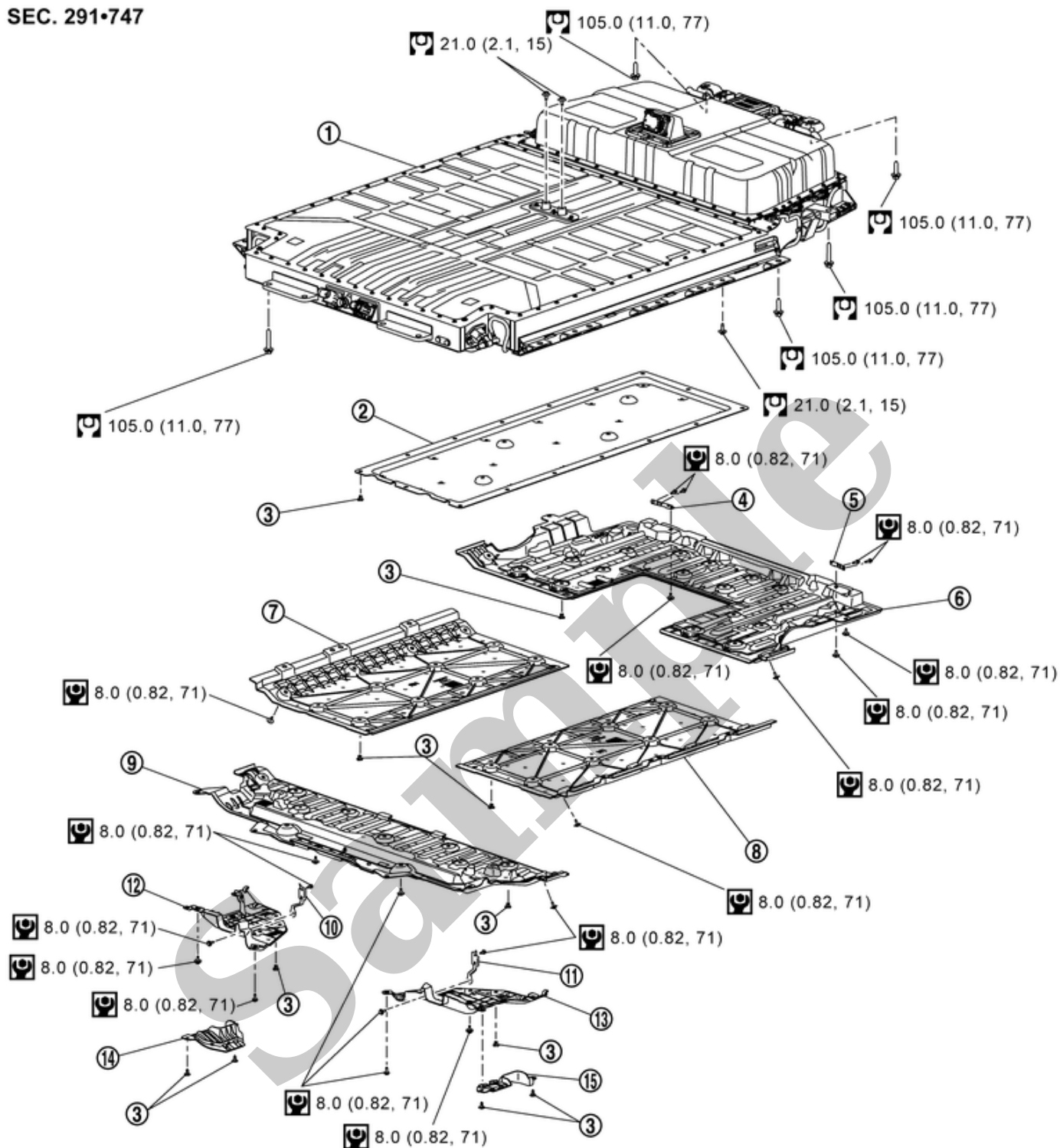

RDE-001999665-01-000393440

①	Li-ion battery	②	Li-ion battery under cover (center)	③	Clip
④	Li-ion battery under cover (rear) bracket right	⑤	Li-ion battery under cover (rear) bracket left	⑥	Li-ion battery under cover (rear)
⑦	Li-ion battery under cover (center right)	⑧	Li-ion battery under cover (center left)	⑨	Li-ion battery under cover (front)
⑩	Li-ion battery under cover (front right) bracket	⑪	Li-ion battery under cover (front left) bracket	⑫	Li-ion battery under cover (front right)
⑬	Li-ion battery under cover (front left)	⑭	Li-ion battery under cover (front right) lid	⑮	Li-ion battery under cover (front left) lid
Ⓐ	: N·m (kg-m, in-lb)				
Ⓑ	: N·m (kg-m, ft-lb)				