

Your Ultimate Source for OEM Repair Manuals

FactoryManuals.net is a great resource for anyone who wants to save money on repairs by doing their own work. The manuals provide detailed instructions and diagrams that make it easy to understand how to fix a vehicle.

2009 CHEVROLET Suburban OEM Service and Repair Workshop Manual

[Go to manual page](#)

Callout	Component Name
1	7th & Reverse Gear Synchronizer Inserts
2	7th & Reverse Shift Fork
3	7th & Reverse Gear Synchronizer Sleeve
4	Reverse Gear Blocking Ring Assembly

Reverse Drive Gear Installation

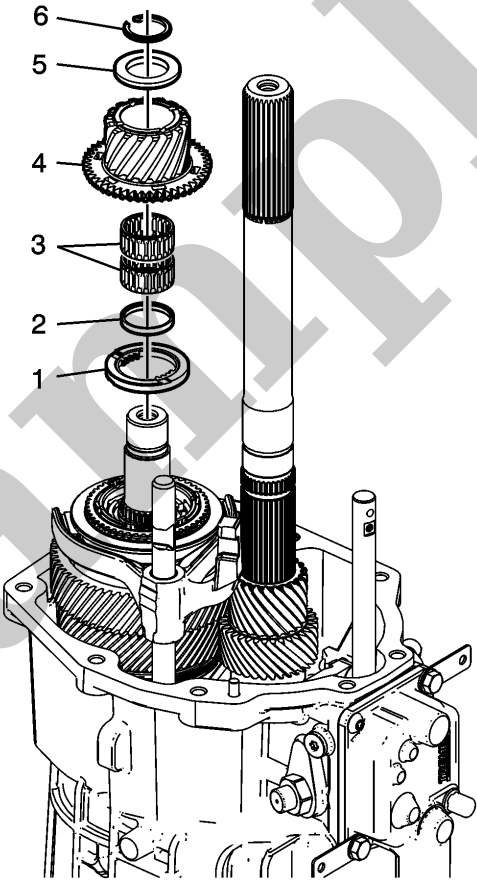

Reverse Drive Gear Installation

Callout	Component Name
1	7th Gear Bearing Spacer
2	Reverse Gear Spacer

Callout	Component Name
	<p>Use the DT-51076 installer and the DT-51076-13 and DT-51076-14 adapters to install the gear.</p> <p>Special Tools</p> <ul style="list-style-type: none"> • DT-51076 Bearing and Gear Installer • DT-51076-10 Installer Adapter Set <p>For equivalent regional tools, refer to Special Tools.</p>
3	Reverse Gear Split Washer
4	Transmission Main Shaft Split Washer
5	<p>Main Shaft Bushing</p> <div data-bbox="233 775 1528 857"> <p>NOTE</p> </div> <div data-bbox="233 857 1528 1090"> <p>Note</p> <p>Replacement bearing will be shipped as an assembly and the inner/race/bushing is installed at this point. The main shaft rear bearing is installed in the extension housing.</p> </div> <p>Procedure</p> <p>Use the DT-51076 installer and the DT-51076-13 and DT-51076-14 adapters to install the bushing.</p> <p>Special Tools</p> <ul style="list-style-type: none"> • DT-51076 Bearing and Gear Installer • DT-51076-10 Installer Adapter Set <p>For equivalent regional tools, refer to Special Tools.</p>
6	Reverse Gear Retaining Ring

Extension Housing Installation

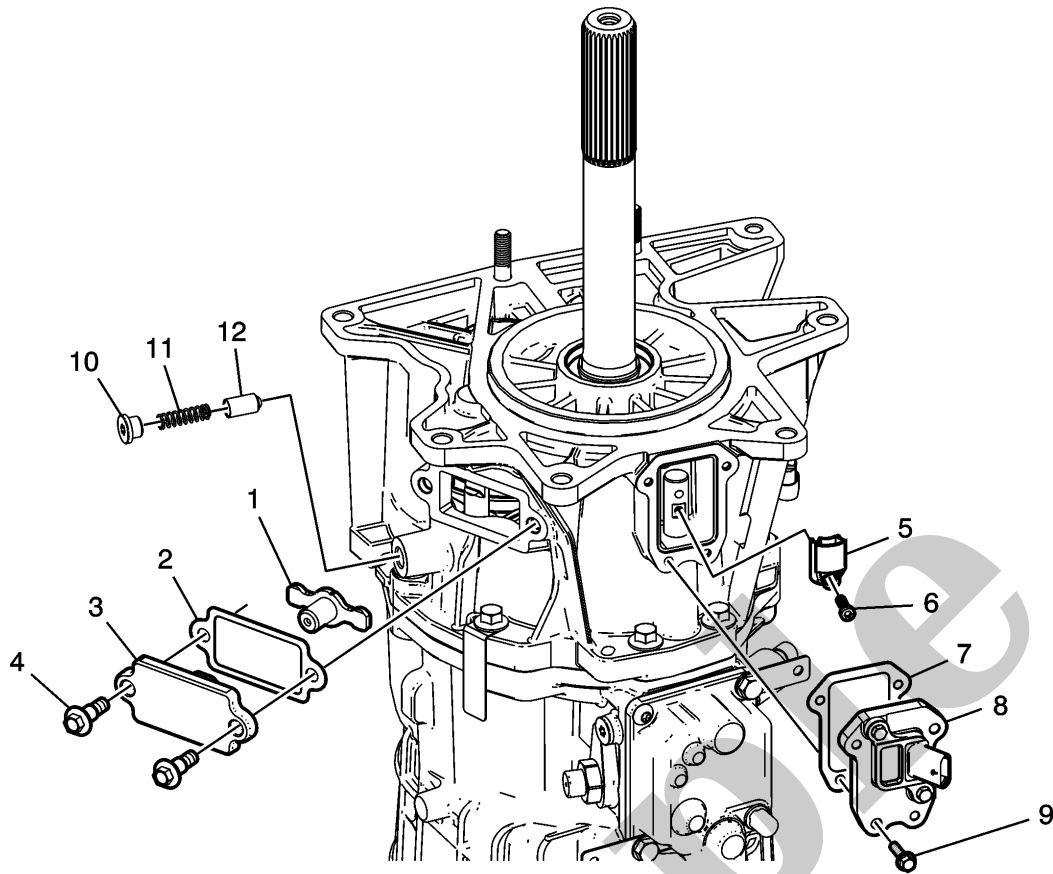

7th/Reverse Inverter Link Cover and Gear Position Sensor Installation

Callout	Component Name
1	Manual Transmission Selector Lever Pivot Pin <div> <div>NOTE</div> <p>Note</p> <p>The part number of the selector lever pivot pin should be assembled pointing toward the shift rail.</p> </div>
2	Manual Transmission Control Lever 7th/Reverse Inverter Link Cover Gasket
3	Manual Transmission Control Lever 7th/Reverse Inverter Link Cover
4	Manual Transmission Control Lever 7th/Reverse Inverter Link Cover Bolt (Qty: 2)

Callout	Component Name
10	Shift Shaft Detent Plug
	Tighten
	27 N·m (20 lb ft)
11	Shift Detent Ball Spring
12	Transmission Detent Ball

Holding Fixture Removal