

Your Ultimate Source for OEM Repair Manuals

FactoryManuals.net is a great resource for anyone who wants to save money on repairs by doing their own work. The manuals provide detailed instructions and diagrams that make it easy to understand how to fix a vehicle.

2009 CHEVROLET Epica OEM Service and Repair Workshop Manual

[Go to manual page](#)

NOTE

Note

Due to the variety of clutch options, there may be components in the mechanical diagnostic tables that are not on a particular vehicle.

Refer to a symptom diagnostic procedure from the following list in order to diagnose the symptom:

- [Clutch Drag Hard Shifting](#)
- [Clutch Slipping](#)
- [Clutch Grabbing](#)
- [Clutch Rattle](#)
- [Clutch Noisy](#)
- [Clutch Pedal Spongy, Low Pedal Effort, Hesitates on Return](#)
- [Clutch Pedal Hard to Push](#)
- [Clutch Frequent Adjustments](#)
- [Clutch Vibration](#)
- [Clutch - No Load](#)

All fasteners listed in this table can be reused after removal.

Application	Specification
	Metric (English)
Clutch Actuator Cylinder Mounting Bolts	12 N·m (106 lb in)
Clutch Pedal Bracket Mounting Nuts	27 N·m (20 lb ft)
Clutch Pedal Nut	50 N·m (37 lb ft)
Cruise Control Release Switch Bracket Retaining Bolts	12 N·m (106 lb in)
Driver Foot Rest Bracket Retaining Bolt	8 N·m (71 lb in)
Driver Foot Rest Bracket Retaining Nut	10 N·m (89 lb in)
Engine Flywheel Inspection Cover Retaining Bolts	25 N·m (18 lb ft)
Negative Battery Cable Bolt	15 N·m (11 lb ft)



YOUR CURRENT VEHICLE

Clutch Actuator Cylinder Replacement

Clutch Actuator Cylinder Replacement

Removal Procedure

1. Remove the driveline support assembly and transaxle from the vehicle. Refer to [Transmission Replacement](#).

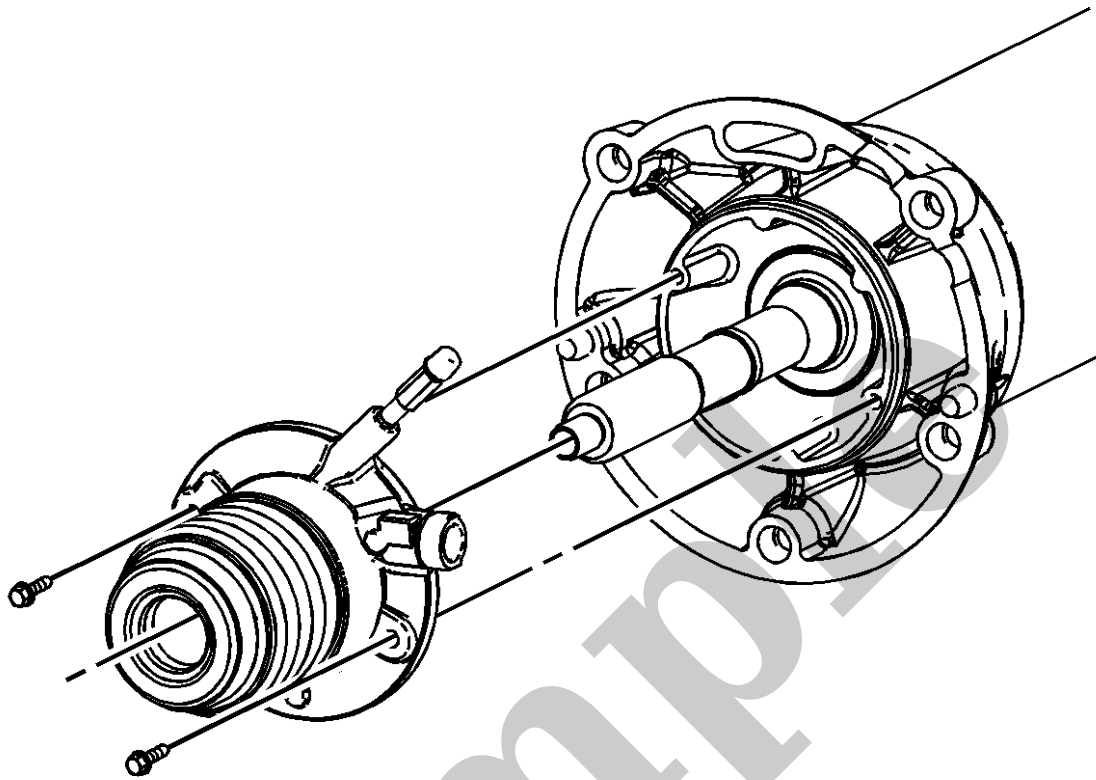

5.
Remove the clutch actuator cylinder mounting bolts.
6. Remove the clutch actuator cylinder from the driveline support assembly.

Installation Procedure

1. CAUTION

Caution

Care must be taken when disassembling the clutch actuator cylinder hose connector from the clutch actuator cylinder. Do not remove, misposition, or damage the internal restrictor valve/Peak Torque Limiter (PTL). Operating a vehicle with a removed, mispositioned, or damaged PTL valve could result in severe driveline damage.