

Your Ultimate Source for OEM Repair Manuals

FactoryManuals.net is a great resource for anyone who wants to save money on repairs by doing their own work. The manuals provide detailed instructions and diagrams that make it easy to understand how to fix a vehicle.

2009 CHEVROLET Celta - 5 doors OEM Service and Repair Workshop Manual

[Go to manual page](#)

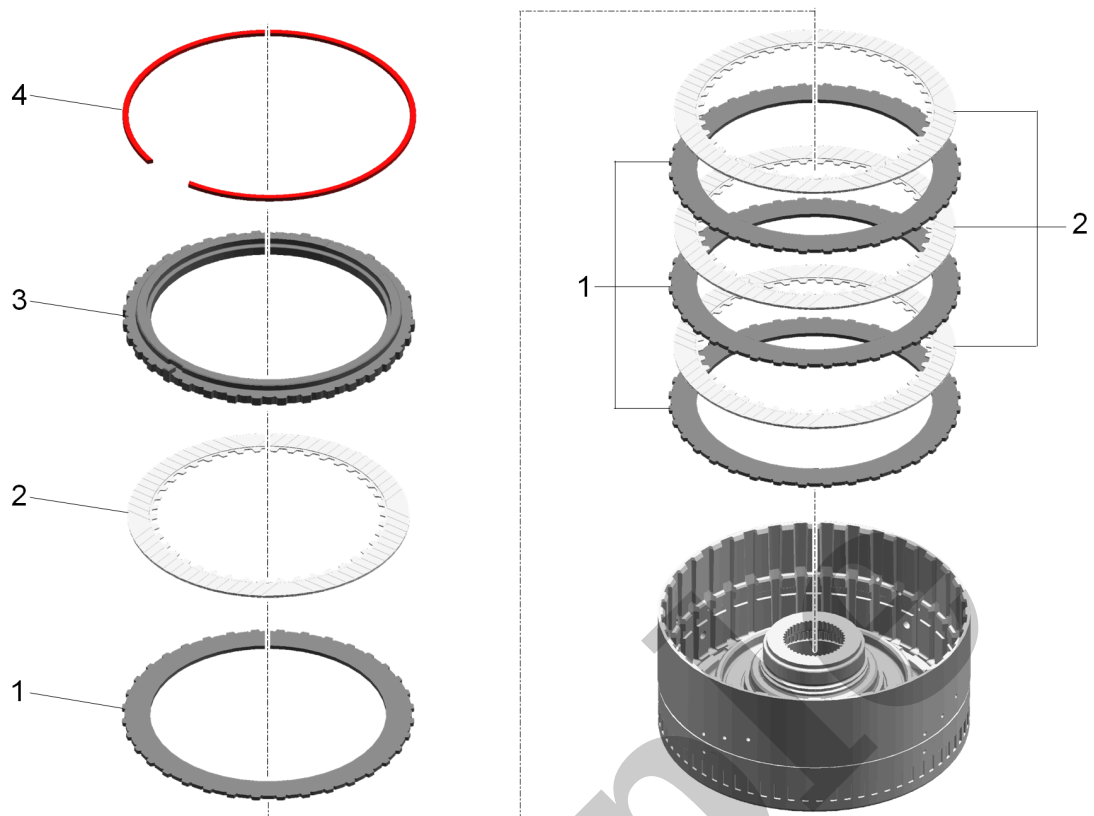

7.

1-3-5-6-7 Clutch Plate(1) »Install – with LT1 (Qty: 4), with LT4 (Qty: 5)

8. 1-3-5-6-7 Clutch Plate-Friction(2) »Install – with LT1 (Qty: 4), with LT4 (Qty: 5)

9. 1-3-5-6-7 Clutch Backing Plate(3) »Install

10. Select the correct retaining ring. [1-3-5-6-7 Clutch Backing Plate Retaining Ring Measurement](#)

11. 1-3-5-6-7 Clutch Backing Plate Retaining Ring(4) »Install

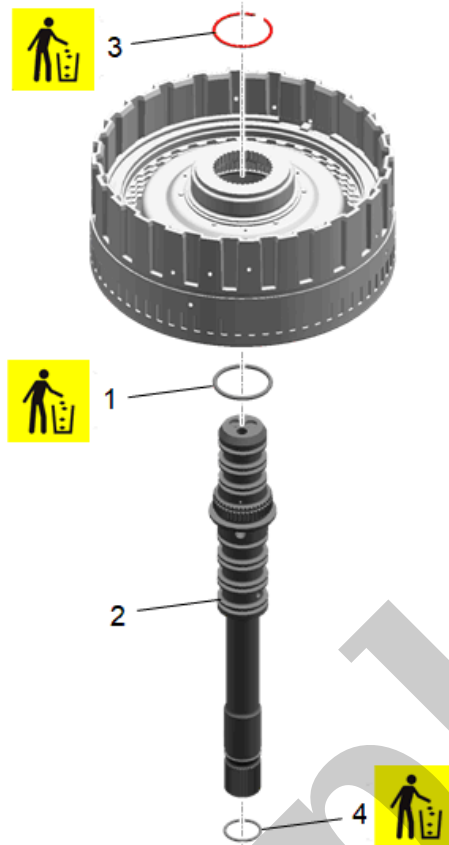

16.

CAUTION

Caution

Refer to [Seal Reuse Caution](#).

Turbine Shaft Seal(1) »Install NEW

17. Turbine Shaft(2) »Install

18. Turbine Shaft Retaining Ring(3) »Install NEW

19. Turbine Shaft Seal(4) »Install NEW

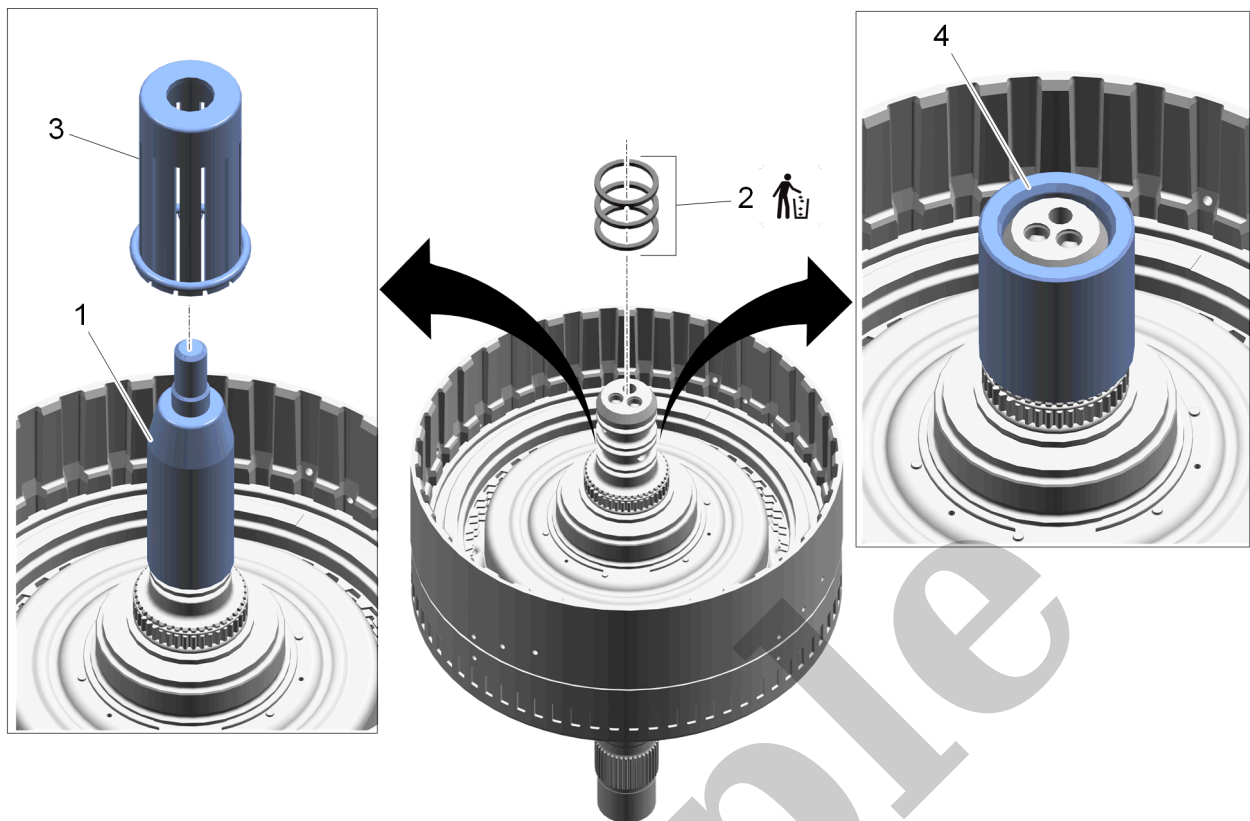

23.

CAUTION

Caution

Do not use old seal rings. Install NEW seal rings. Reusing old seal rings may cause internal transmission leaks and transmission damage.

CAUTION

Caution

Size the fluid seal rings for at least 5 minutes after installation to obtain proper seal ring size. Failure to do so may cause internal transmission leaks and transmission damage.

Adjust the turn screw on **DT-50911-3 seal protector** (1) and install the bottom NEW seal ring first with the **DT-50911-3 seal pusher** (3).

24. Turbine Shaft Fluid Seal Ring(2) »Install NEW[3x]

25. Use the large taper side of **DT-50911-1 seal sizer** (4) for initial seal sizing, then flip the tool over for final sizing.

Callout	Component Name
1	1-3-5-6-7 Clutch Assembly
	<div><div>NOTE</div><div><p>Note</p><p>Verify proper installation of the 1–3–5–6–7 clutch assembly by measuring as indicated (a). An approximate measurement of 6.49 mm (0.256 in) indicates correct installation.</p></div></div>
2	1-3-5-6-7 Clutch Thrust Bearing Washer
3	1-3-5-6-7 Clutch Thrust Bearing