

Your Ultimate Source for OEM Repair Manuals

FactoryManuals.net is a great resource for anyone who wants to save money on repairs by doing their own work. The manuals provide detailed instructions and diagrams that make it easy to understand how to fix a vehicle.

2008 FORD Focus 3 Doors OEM Service and Repair Workshop Manual

[Go to manual page](#)

Low One-Way Clutch Assembly

307-01A Automatic Transmission - 10-Speed Automatic Transmission - 10R80	2022 F-150
Description and Operation	Procedure revision date: 04/24/2019

Low One-Way Clutch Assembly

One-Way Clutch (OWC) Exploded View

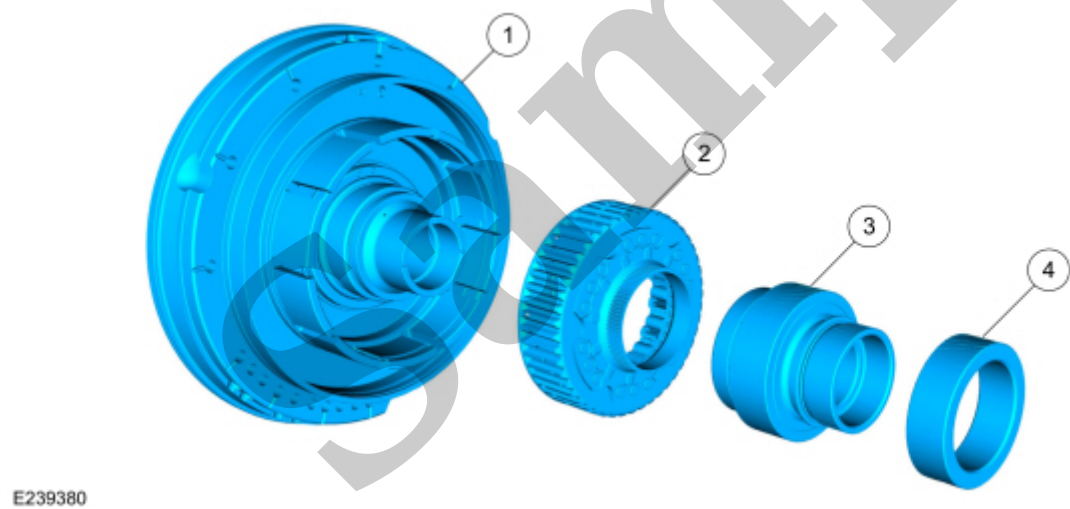

E239380

Item	Description
1	Front support assembly
2	One-Way Clutch (OWC)
3	Sun gear No. 1

Main Control Valve Body

307-01A Automatic Transmission - 10-Speed Automatic Transmission - 10R80	2022 F-150
Description and Operation	Procedure revision date: 03/2/2022

Main Control Valve Body

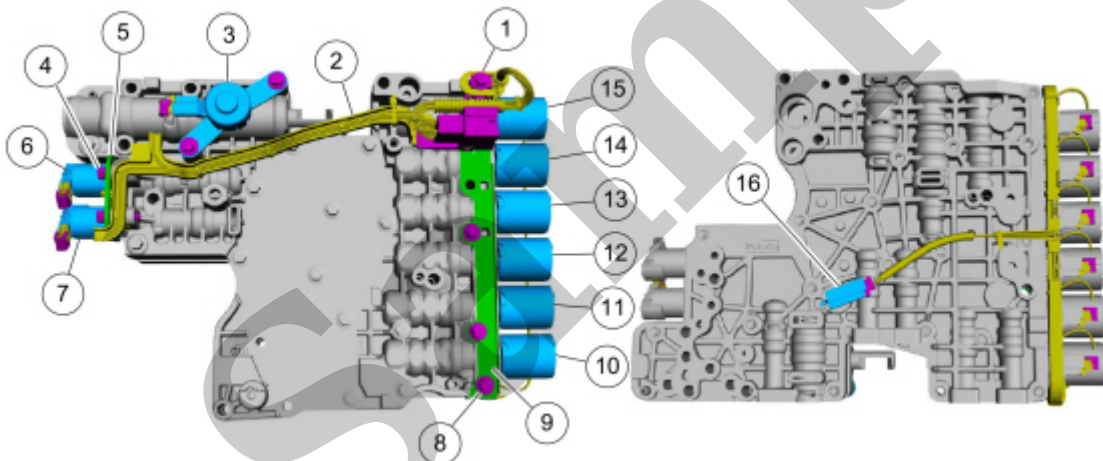

E261612

5	Solenoid retaining plate
6	TCC (torque converter clutch) solenoid
7	LPC (line pressure control) solenoid
8	Shift solenoid retaining plate bolts
9	Shift solenoid retaining plate
10	SSD (shift solenoid D)
11	SSE (shift solenoid E)
12	SSB (shift solenoid B)
13	SSC (shift solenoid C)
14	SSF (shift solenoid F)
15	SSA (shift solenoid A)
16	TFT (transmission fluid temperature)
17	Valve channel plate bolts
18	Valve channel plate
19	Lower-to-upper valve body bolts
20	Lower valve body
21	Upper valve body
22	Valve body dowel pins

Lower Valve Body

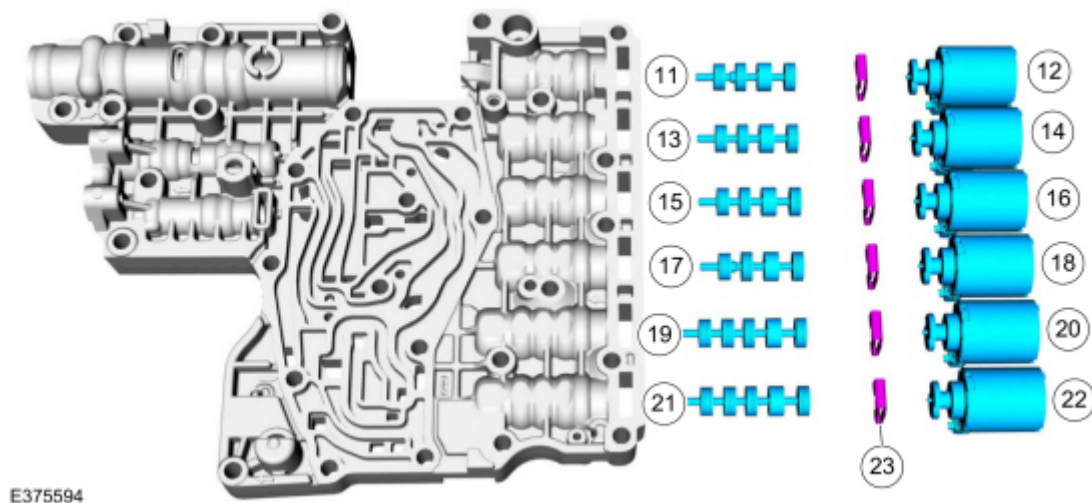

1	Valve body separator plate bolts
2	Valve body separator plate
3	LPC (line pressure control) damper assembly
4	Clutch exhaust check valve
5	Torque converter anti-drainback valve
6	Transmission fluid auxiliary pump check valve
7	Check balls (quantity 5)
8	LPC (line pressure control) anti-backflow valve assembly
9	TCC (torque converter clutch) priority valve assembly
10	Park lock pawl valve
11	A clutch control valve
12	SSA (shift solenoid A)
13	F clutch control valve
14	SSF (shift solenoid F)
15	C clutch control valve

4	B clutch latch valve assembly
5	F clutch latch valve assembly
6	A clutch latch valve assembly
7	Plug and spring assembly
8	TCC (torque converter clutch) regulator valve assembly
9	Main regulator valve assembly

The main control consists of a upper and lower valve body with solenoids that are controlled by a remote mounted TCM (transmission control module) or the PCM (powertrain control module) . The TCM (transmission control module) or PCM (powertrain control module) operates the electrical components to provide refined engagement feel, shift feel, and shift scheduling.

Clutch Control Valves

The A, B, C, and F clutch control valves regulate line pressure for smooth clutch application. The clutch control valve design includes a slightly smaller land at the right end of the valve. The adjacent different diameter lands creates a differential chamber. Fluid under pressure in this chamber applies more force to the larger diameter land than to the smaller diameter land.

- The clutch control valve moves to open or close a passage between line pressure and the clutch control circuit. With the valve at the left of the bore, the passage between line pressure and X clutch control is restricted (closed) and the clutch is released. With the valve at the right of the bore, the passage between line pressure and X clutch control is not restricted (open) and the clutch is applied.
- The clutch control valve is positioned in the bore by balancing two opposing forces. On the left side of the valve is the shift solenoid that pushes the valve to the right, thereby opening the passage and increasing pressure in the clutch control circuit.
- Clutch control pressure in the differential chamber applies more force to the land on the left pushing the valve towards the solenoid, thereby lowering pressure in the clutch control circuit.
- When the shift solenoid is de-energized, the weight of the fluid in the elevated exhaust circuit acts on the clutch control valve to keep it positioned against the solenoid pintle. The passage from line pressure to X clutch control is closed.
- To apply the clutch, the TCM (transmission control module) or PCM (powertrain control module) applies current to the shift solenoid and hydraulic pressure in the X clutch control circuit increases proportionally.



Planetary Assembly

307-01A Automatic Transmission - 10-Speed Automatic Transmission - 10R80	2022 F-150
Description and Operation	Procedure revision date: 04/24/2019

Planetary Assembly

Planetary Gearset Exploded View

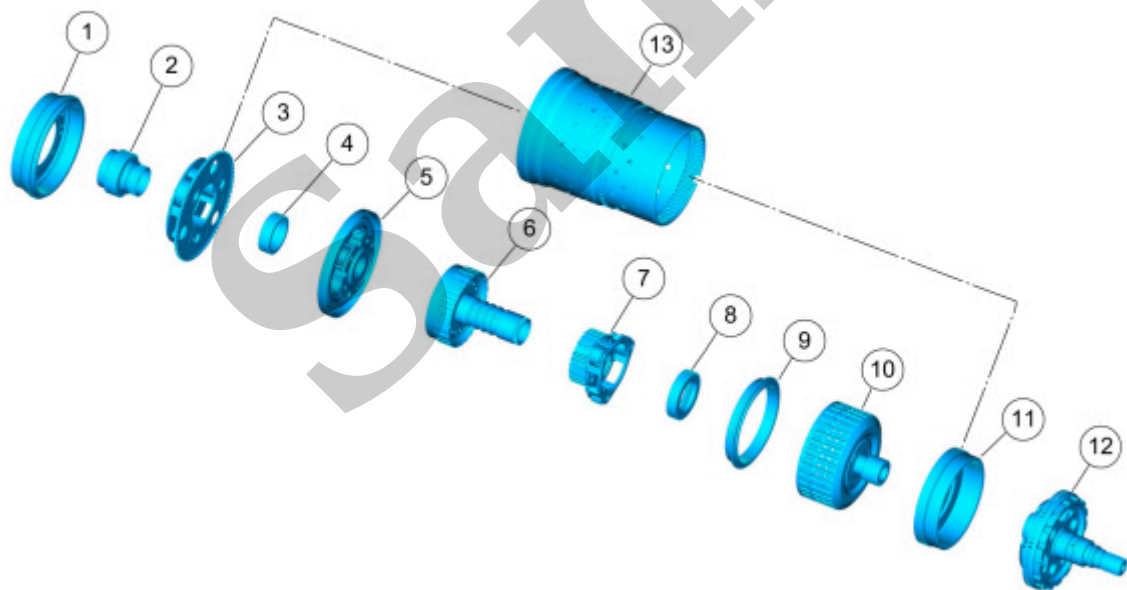

E239537

Item	Description
1	Ring gear No. 1



Pump Assembly

307-01A Automatic Transmission - 10-Speed Automatic Transmission - 10R80	2022 F-150
Description and Operation	Procedure revision date: 08/18/2016

Pump Assembly

Overview

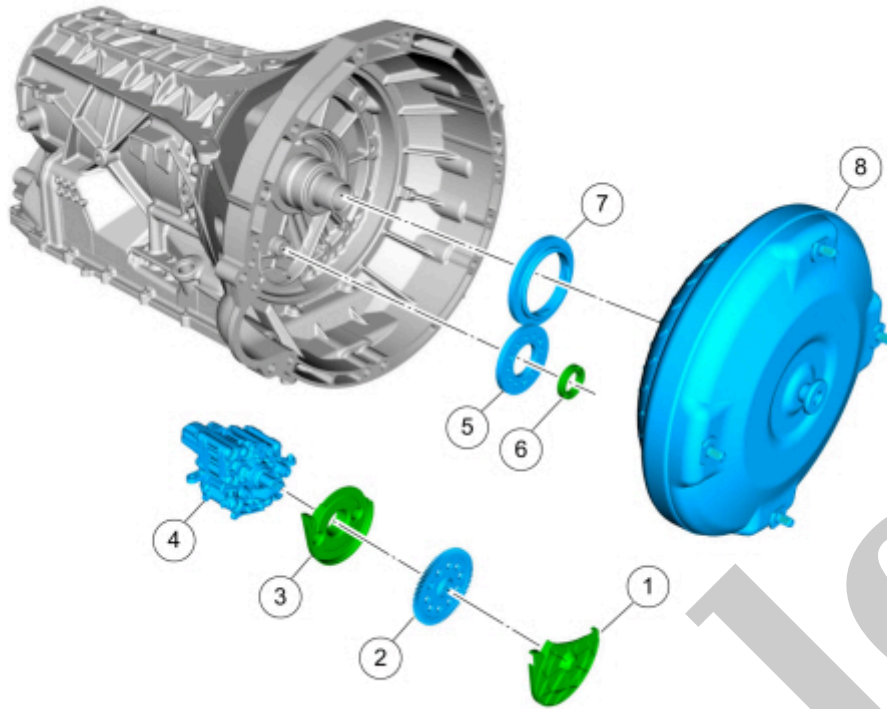

E239579

Item	Description
1	Transmission fluid pump driven gear outer cover
2	Transmission fluid pump driven gear
3	Transmission fluid pump driven gear inner cover
4	Transmission fluid pump
5	Transmission fluid pump idler gear
6	Transmission fluid pump idler gear bearing
7	Transmission fluid pump drive gear
8	Torque converter

