

Your Ultimate Source for OEM Repair Manuals

FactoryManuals.net is a great resource for anyone who wants to save money on repairs by doing their own work. The manuals provide detailed instructions and diagrams that make it easy to understand how to fix a vehicle.

2008 FORD Escape OEM Service and Repair Workshop Manual

[Go to manual page](#)

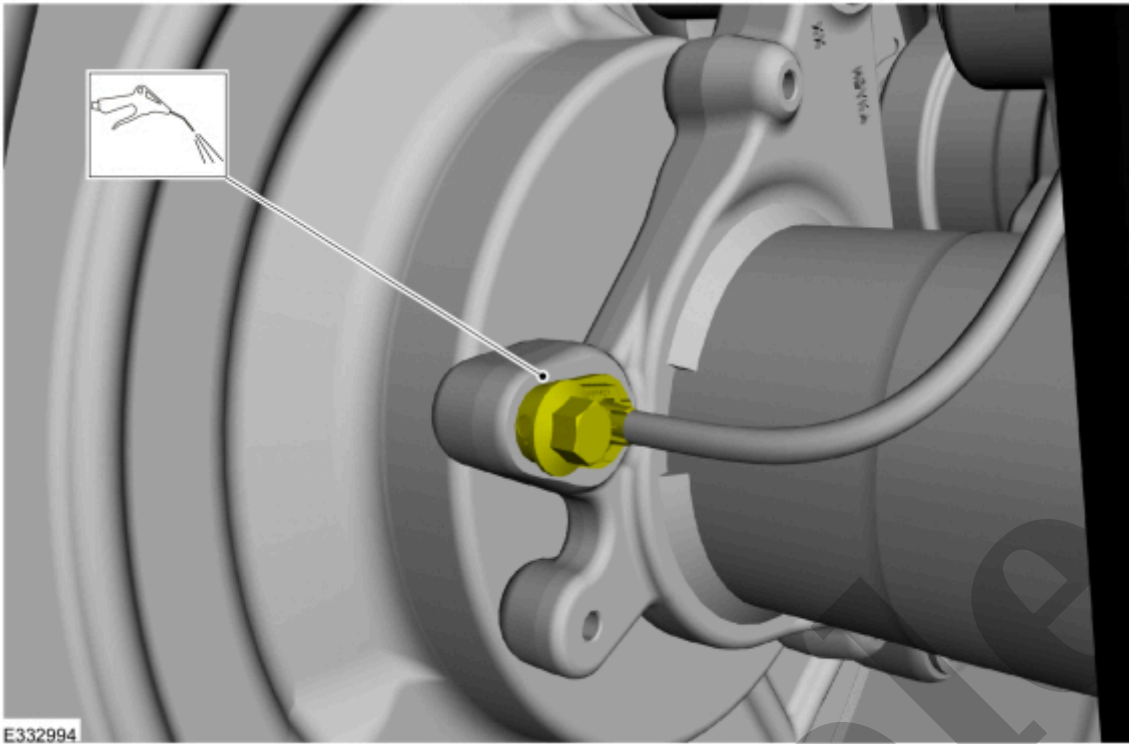

[Click here to learn about symbols, color coding, and icons used in this manual.](#)

3. On both sides.

Remove the wheel speed sensor bolt and position aside the wheel speed sensor.

Torque : 133 lb.in (15 Nm)

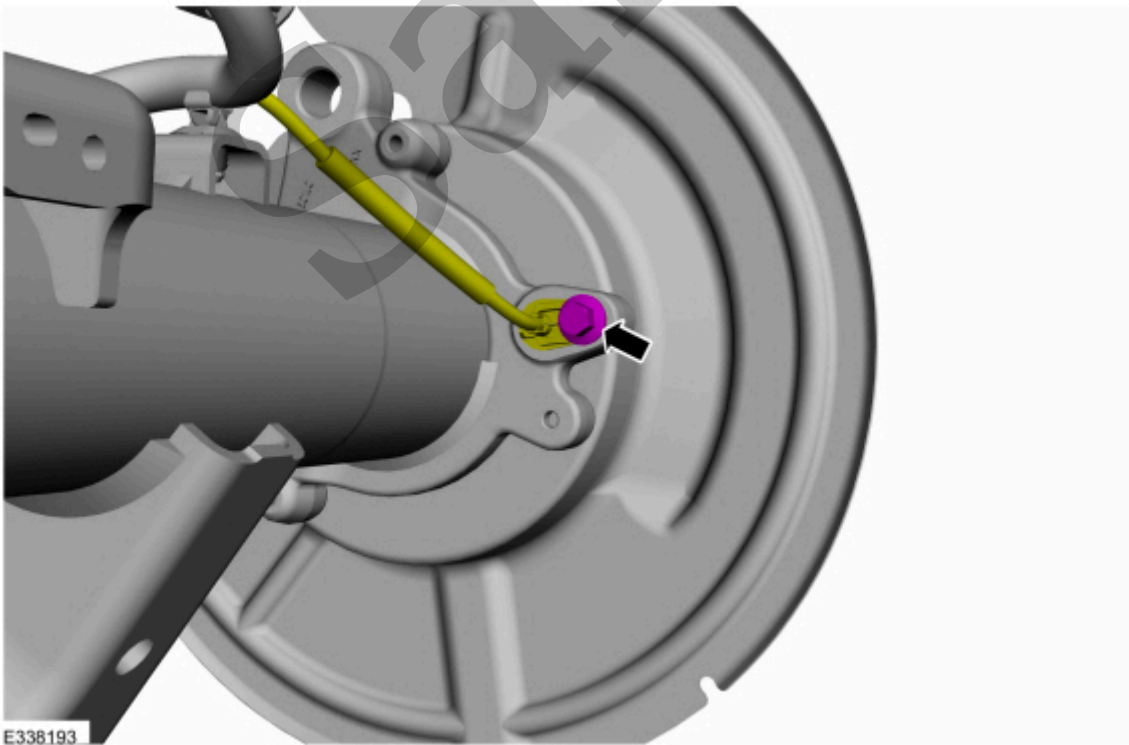

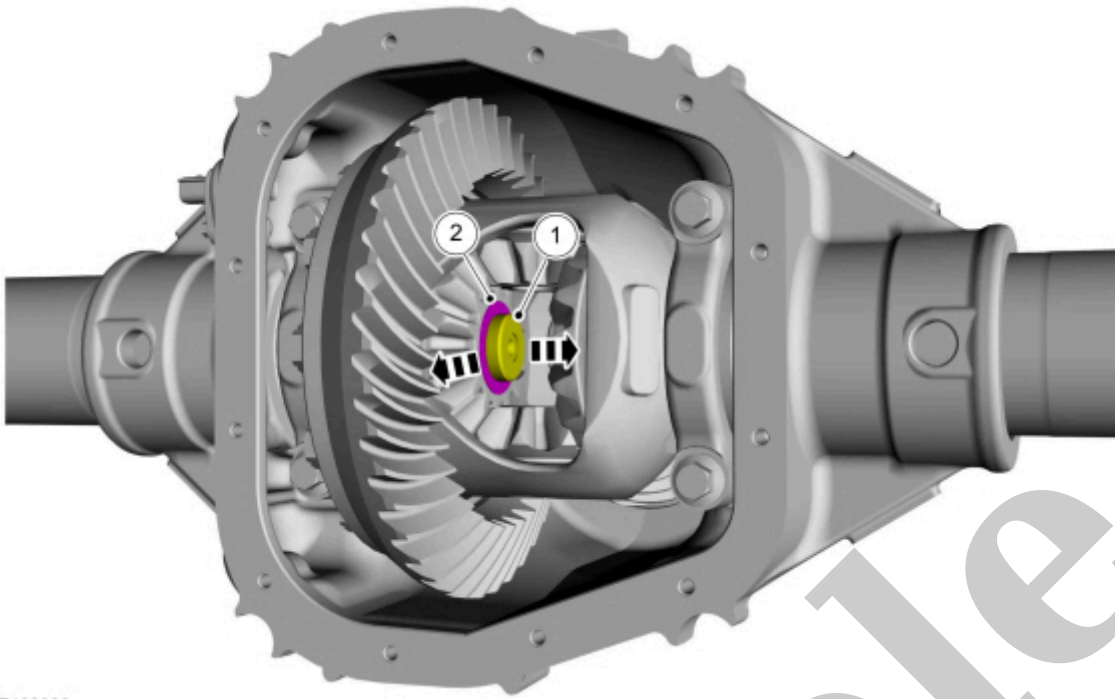

E192933

[Click here to learn about symbols, color coding, and icons used in this manual.](#)

7. Remove the axle shaft.

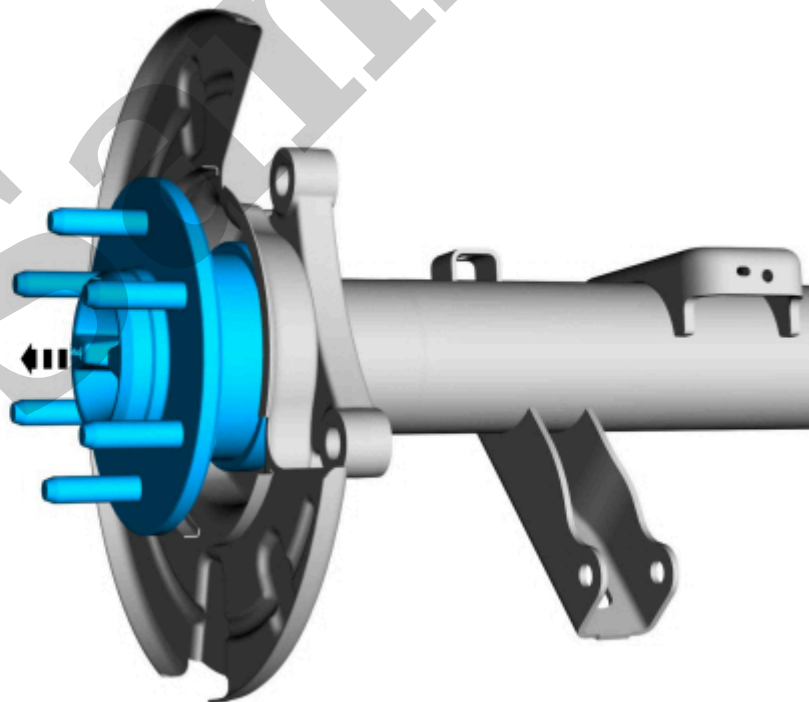

E192934

[Click here to learn about symbols, color coding, and icons used in this manual.](#)

Installation

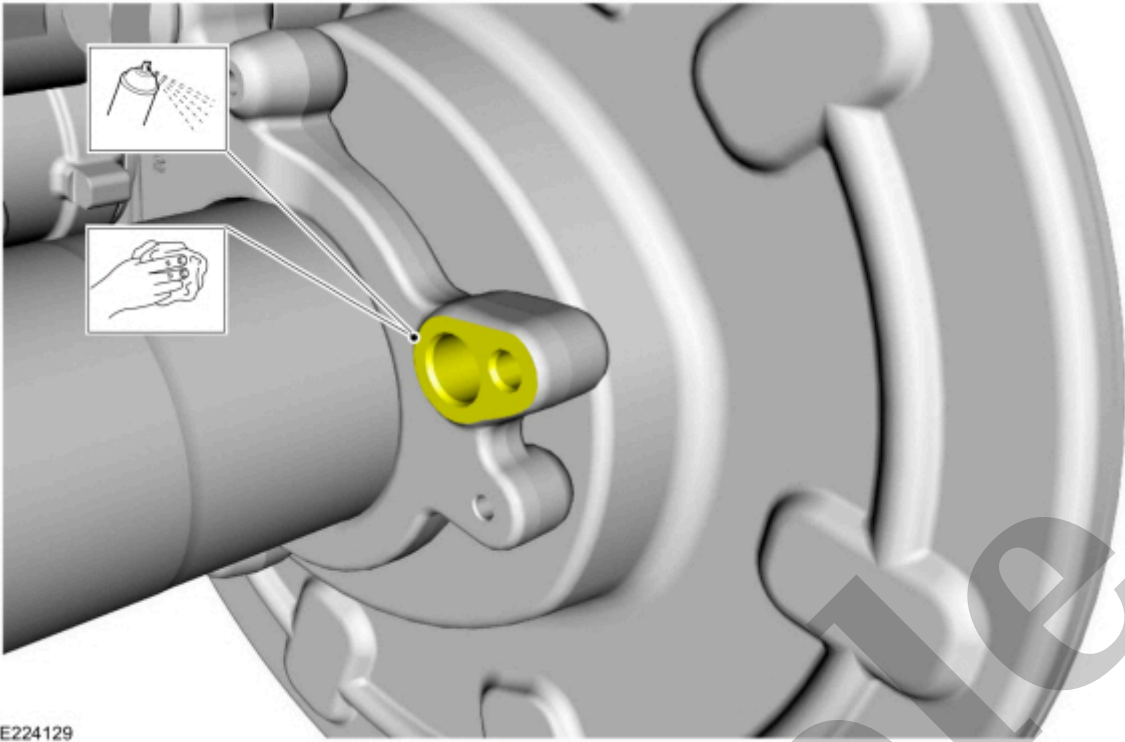

E224129

[Click here to learn about symbols, color coding, and icons used in this manual.](#)

Copyright © Ford Motor Company

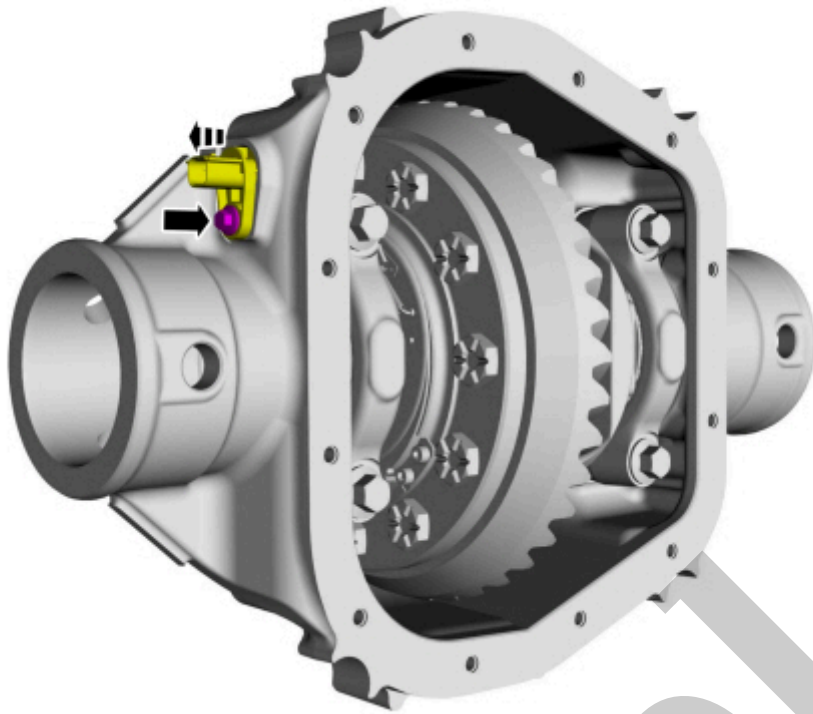

E195462

[Click here to learn about symbols, color coding, and icons used in this manual.](#)

4. Disconnect the ELD (electronic locking differential) coil electrical connector from the ELD (electronic locking differential) connector adapter.

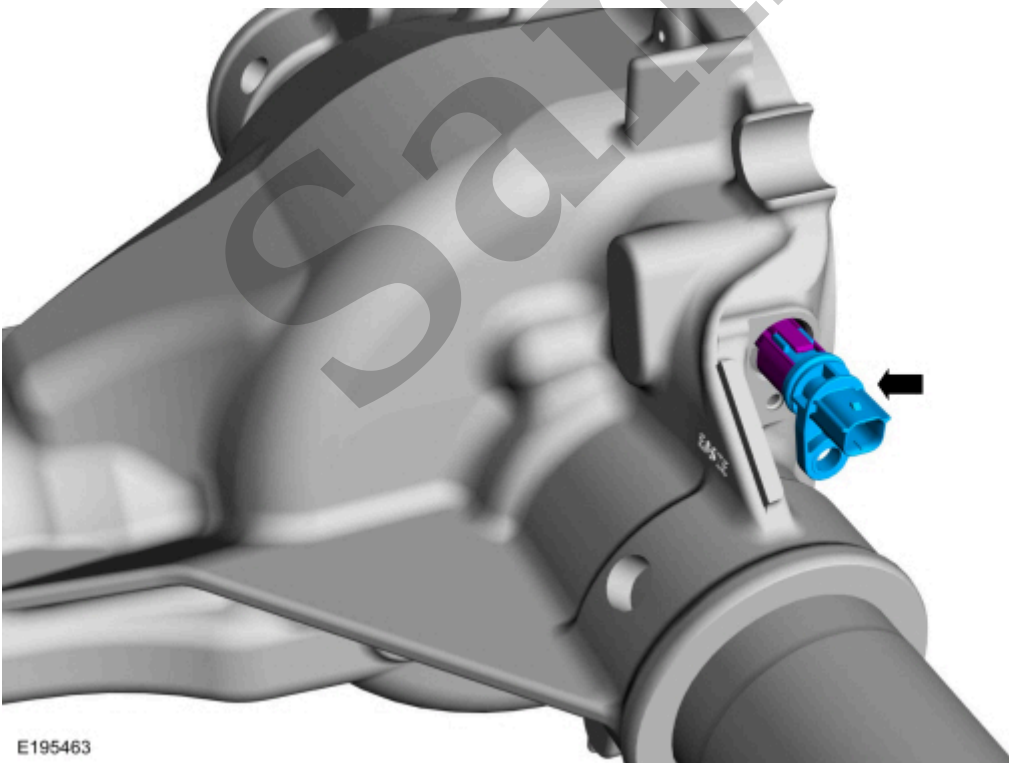

E195463

[Click here to learn about symbols, color coding, and icons used in this manual.](#)

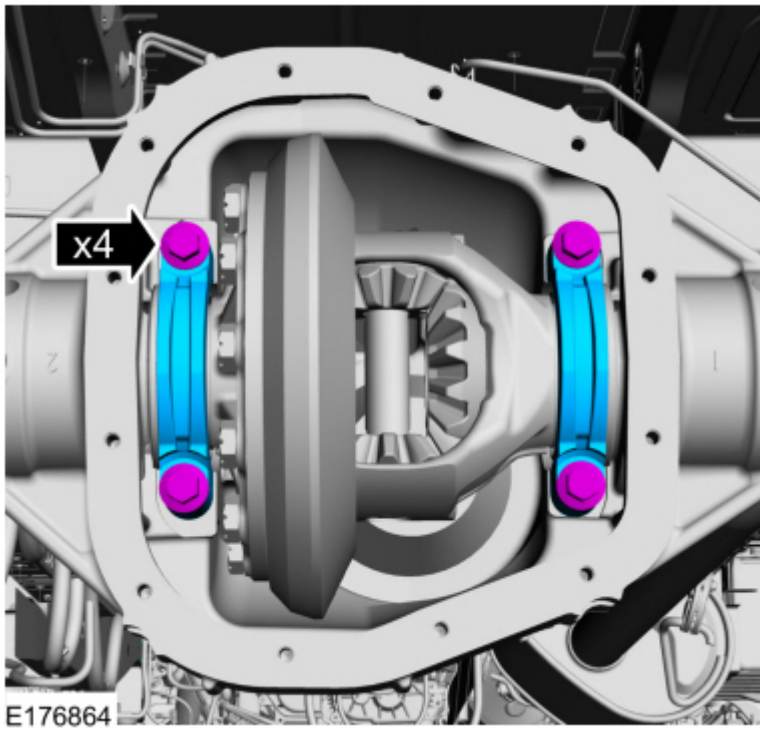

[Click here to learn about symbols, color coding, and icons used in this manual.](#)

7. Remove the differential carrier, differential carrier bearing cups and the differential shims.

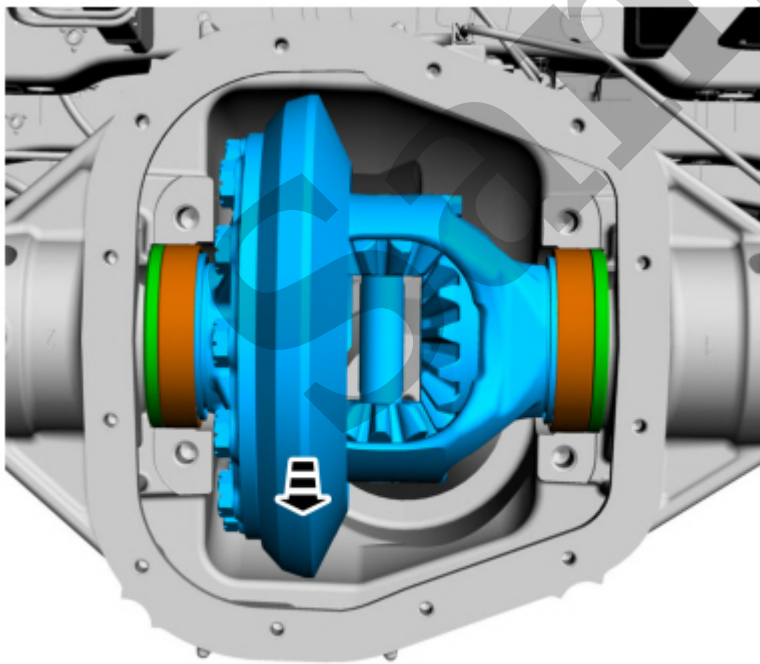

[Click here to learn about symbols, color coding, and icons used in this manual.](#)

Installation

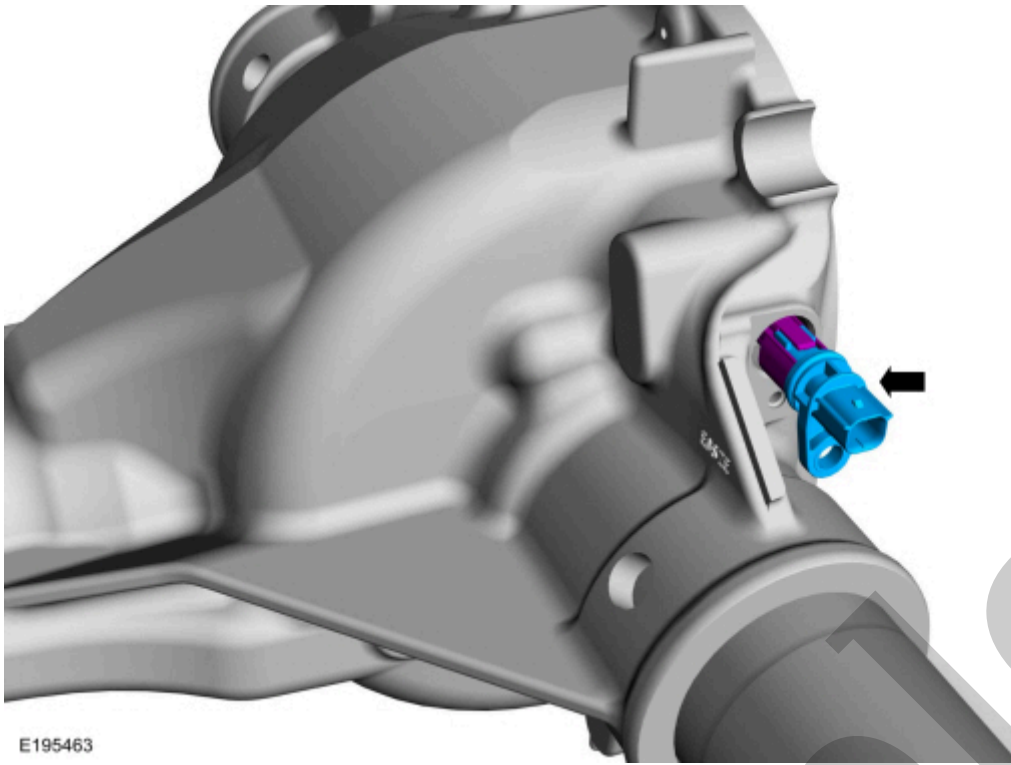

E195463

[Click here to learn about symbols, color coding, and icons used in this manual.](#)

1. Install the ELD (electronic locking differential) connector adaptor into the axle assembly housing.
2. Install the ELD (electronic locking differential) connector adaptor bolt.

Torque : 62 lb.in (7 Nm)

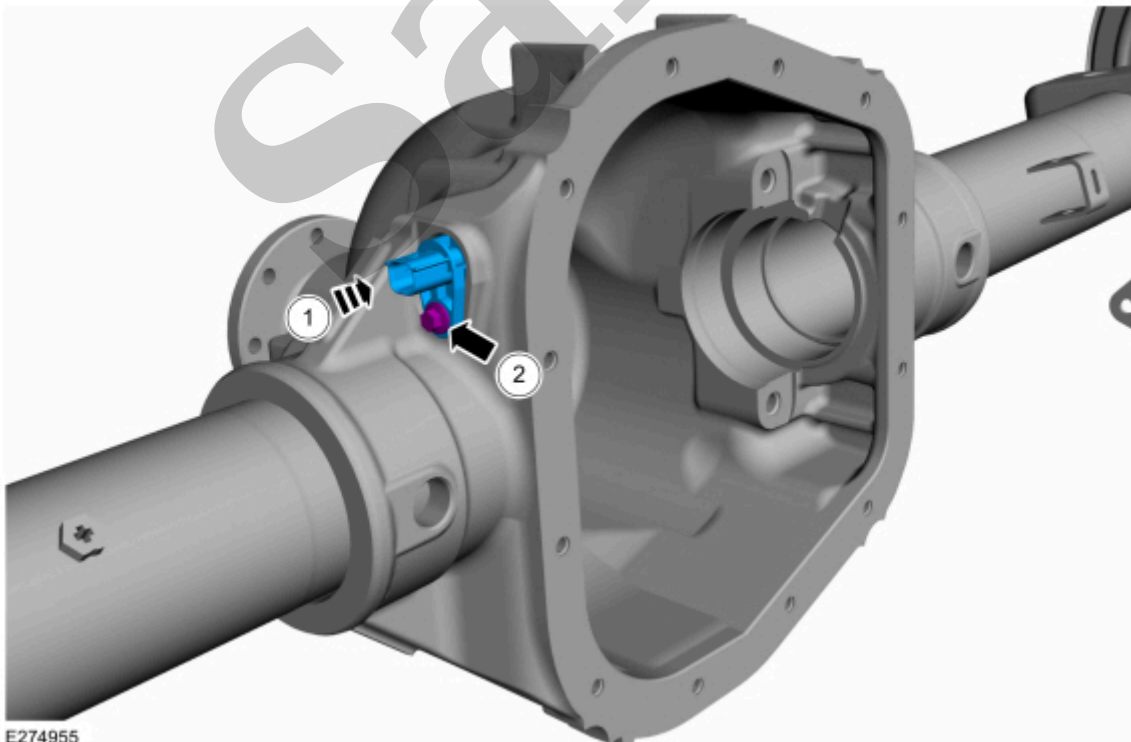

E274955

1. Install the LH (left-hand) selected ring gear back lash shim.

2. **NOTE**

The differential bearing cap bolts should only be finger tight at this time.

Position the differential to the LH (left-hand) side of the differential housing. Install the LH (left-hand) differential bearing cap and the differential bearing cap bolts.

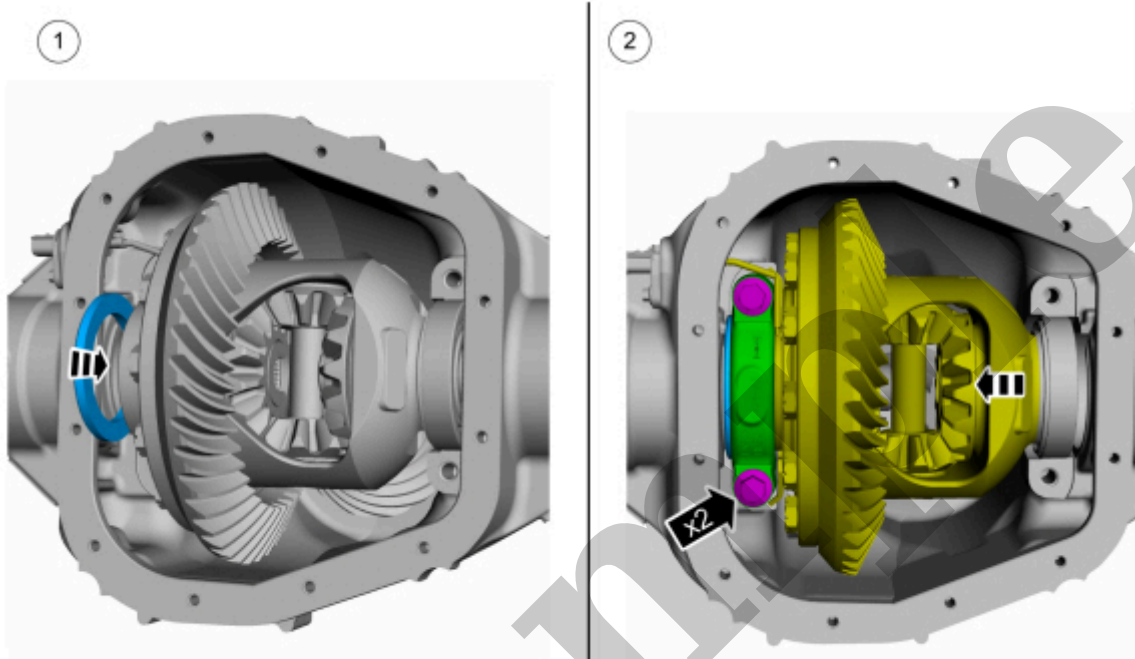

E344379

[Click here to learn about symbols, color coding, and icons used in this manual.](#)

6. Using the special tool and a soft face brass mallet, install the RH (right-hand) selected ring gear back lash shim.

Use Special Service Tool : 205-220 Installer, Differential Shim

Use the General Equipment: Copper Hammer

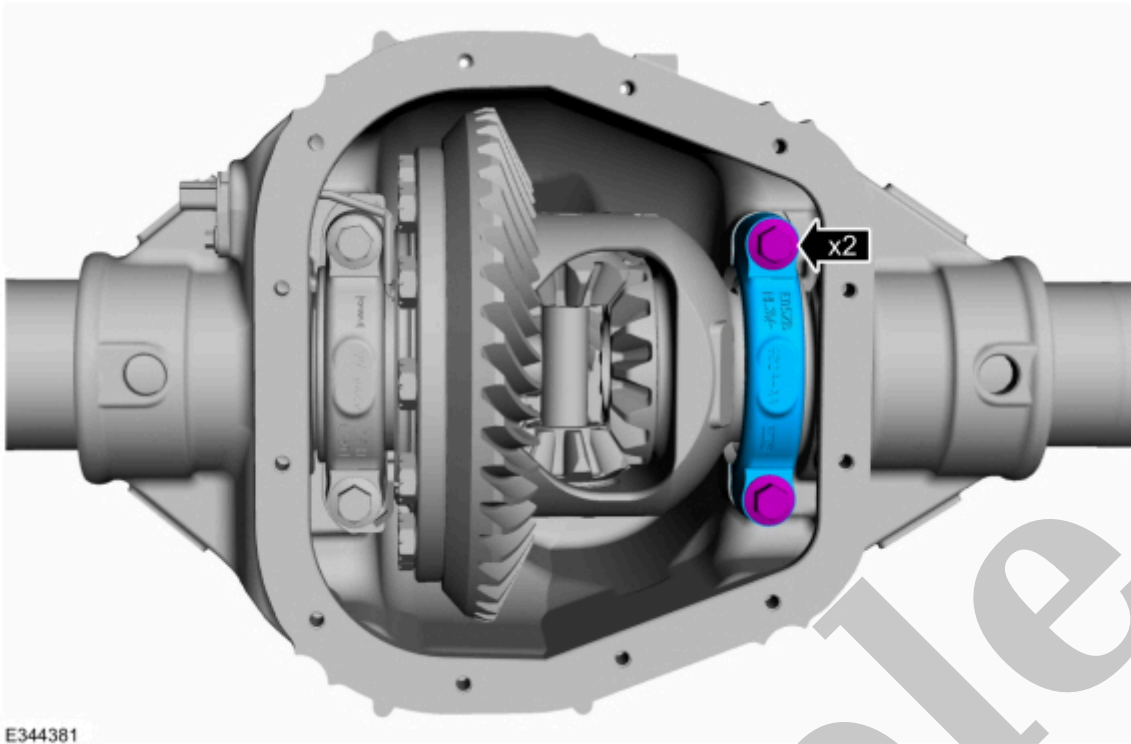

E344381

[Click here to learn about symbols, color coding, and icons used in this manual.](#)

All vehicles

8. Tighten the differential bearing cap bolts.

Torque : 83 lb.ft (112 Nm)

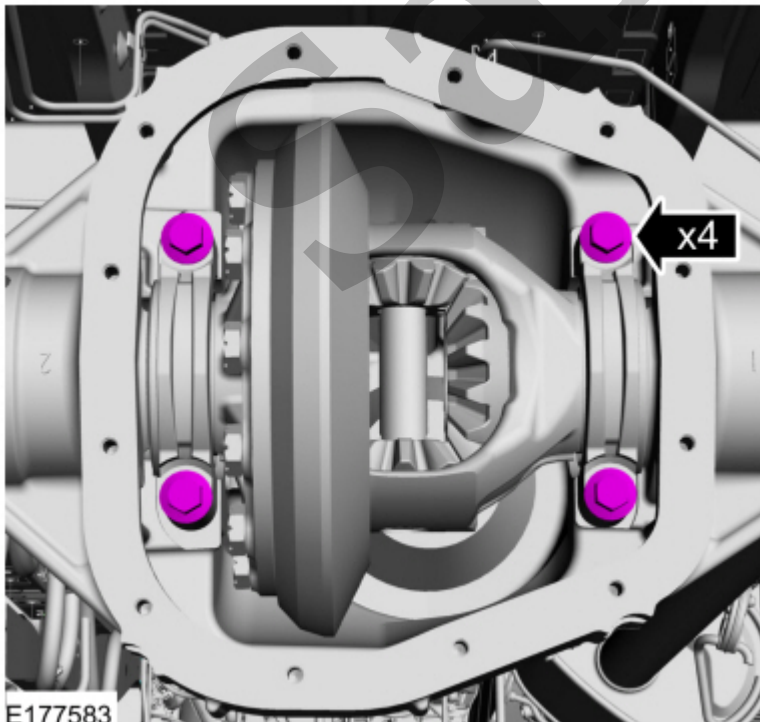

E177583

Differential Housing Cover - Raptor

205-02B Rear Drive Axle/Differential - Vehicles With: Ford 9.75 Inch Ring Gear	2022 F-150
Removal and Installation	Procedure revision date: 08/6/2021

Differential Housing Cover - Raptor

Removal

1. With the vehicle in NEUTRAL, position it on a hoist.
Refer to: [Jacking and Lifting - Overview](#)(100-02 Jacking and Lifting, Description and Operation).
2. Remove the upper bracket bolt and position the upper bracket aside.