

Your Ultimate Source for OEM Repair Manuals

FactoryManuals.net is a great resource for anyone who wants to save money on repairs by doing their own work. The manuals provide detailed instructions and diagrams that make it easy to understand how to fix a vehicle.

2007 MAZDA 3 / Axela Hatchback OEM Service and Repair Workshop Manual

[Go to manual page](#)

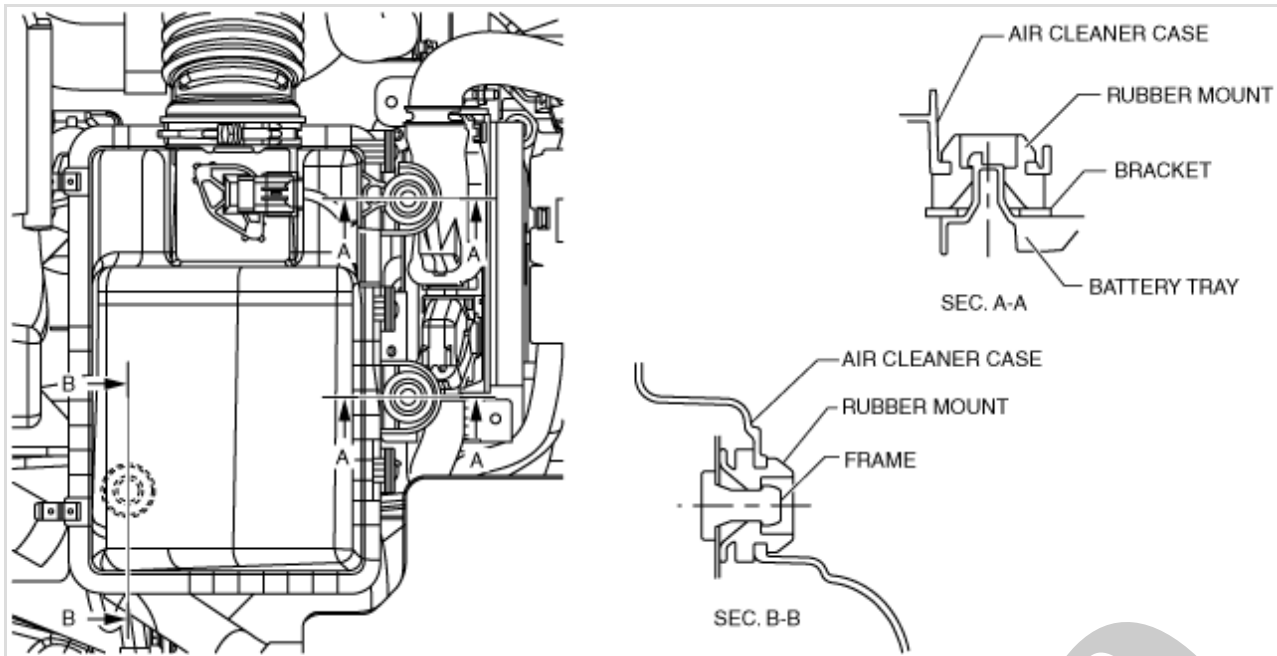

ac5uuw00000367

Fresh-air Duct Installation Note

1. Install the fresh-air duct as shown in the figure.

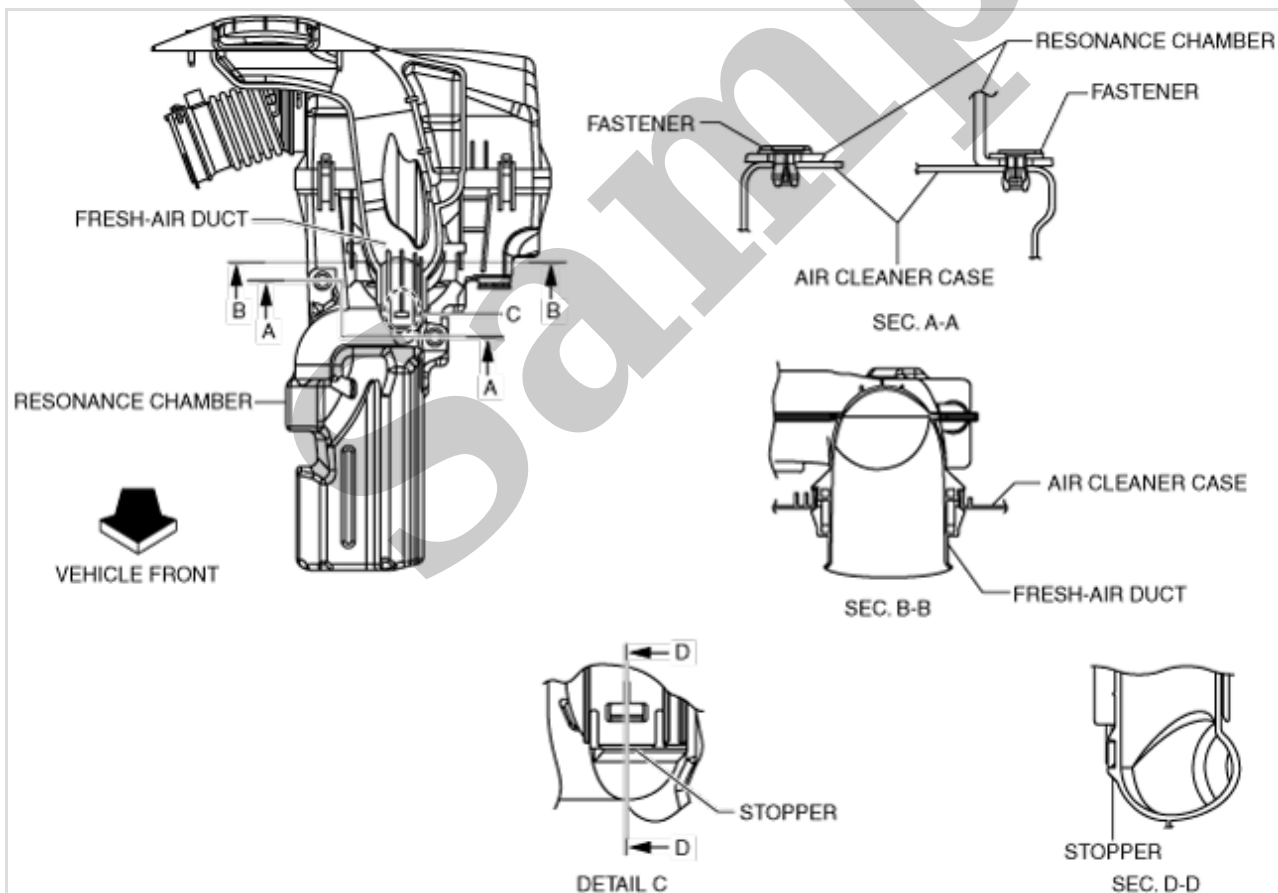

ac5uuw00000368

Air Cleaner Cover Installation Note

1. Install the air cleaner cover as shown in the figure.

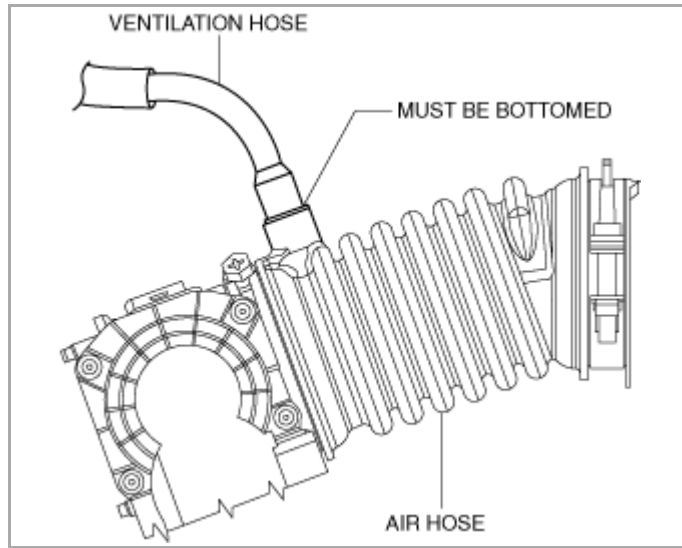

ac5uuw00000371

Sample

6	Air cleaner case (See Air Cleaner Case Installation Note.)
7	Ventilation hose (See Ventilation Hose Installation Note.)
8	Air hose (See Air Hose Installation Note.)
9	Throttle body (See Throttle Body Removal Note.) (See Throttle Body Installation Note.)
10	Vacuum hose (See VACUUM HOSE REMOVAL/INSTALLATION [SKYACTIV-G 2.5 (WITH CYLINDER DEACTIVATION)].)
11	Evaporative hose (See Evaporative Hose Installation Note.)
12	PCV hose
13	MAP sensor/IAT sensor No.2 (See MANIFOLD ABSOLUTE PRESSURE (MAP) SENSOR/INTAKE AIR TEMPERATURE (IAT) SENSOR NO.2 REMOVAL/INSTALLATION [SKYACTIV-G 2.5 (WITH CYLINDER DEACTIVATION)].)
14	Intake manifold (See Intake Manifold Removal Note.) (See Intake Manifold Installation Note.)

Resonance Chamber Removal Note

1.Remove the following parts as a single unit:

- Air cleaner case
- Fresh-air duct
- Resonance chamber

2.Remove the resonance chamber.

Fresh-air Duct Removal Note

1.Pull out the fresh-air duct while pressing the tab shown in the figure.

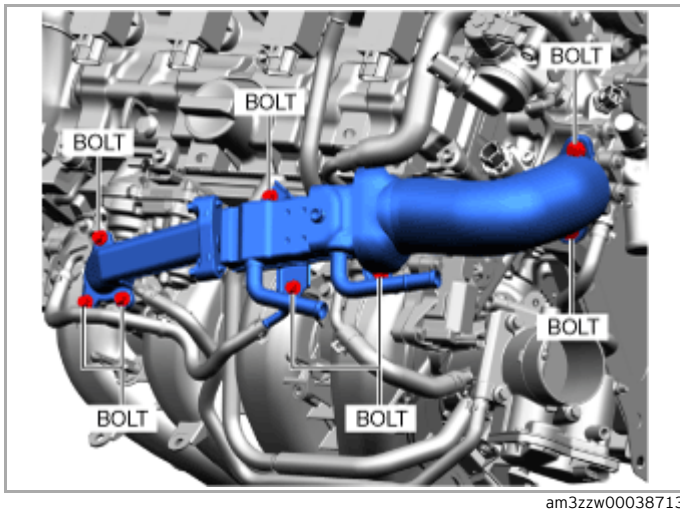

5.Remove the bolt shown in the figure.

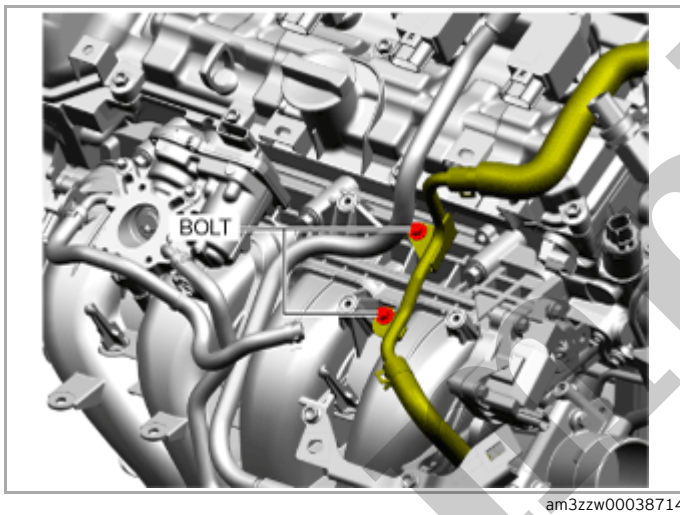

6.Remove the bolts shown in the figure and set the EGR valve aside with the hose kept connected so that it does not interfere with the work. (See [EGR VALVE REMOVAL/INSTALLATION \[SKYACTIV-G \(WITH EGR COOLER\)\]](#).)

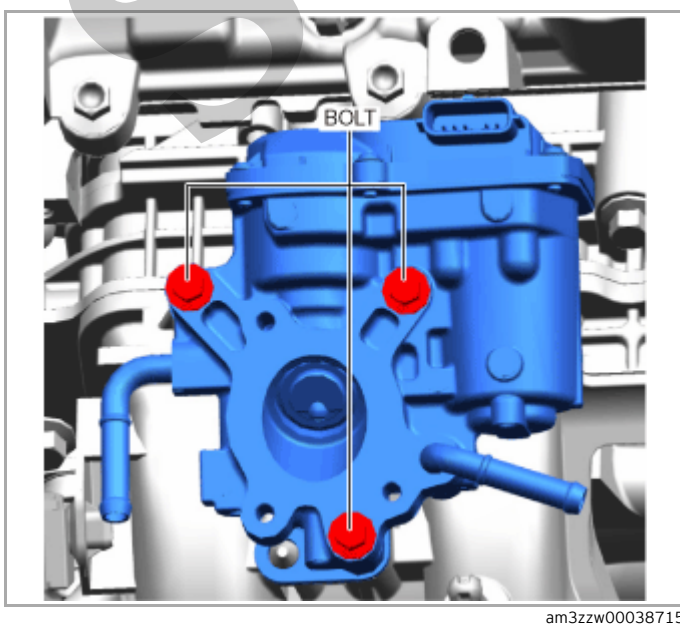

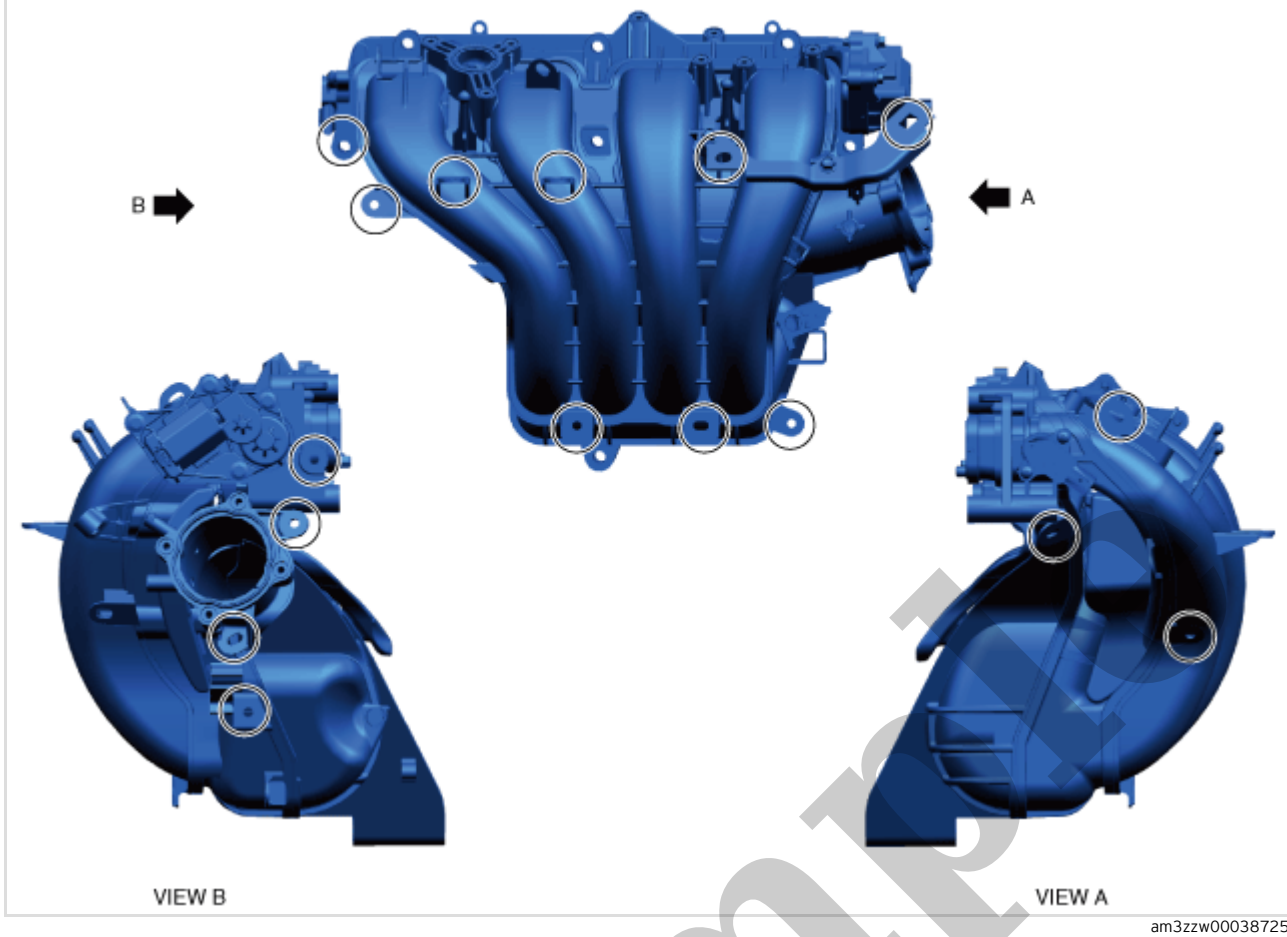

3.Connect the swirl control valve actuator connector shown in the figure.

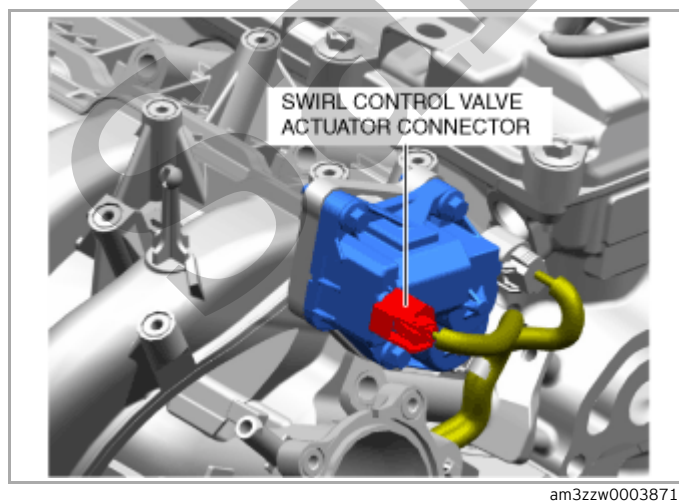

4.Connect the swirl control valve position sensor connector shown in the figure.

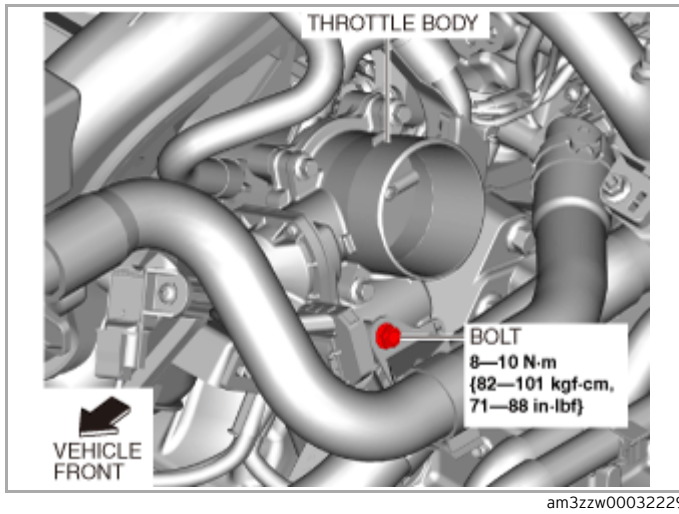

Air Cleaner Case Installation Note

1. Install the air cleaner case as shown in the figure.

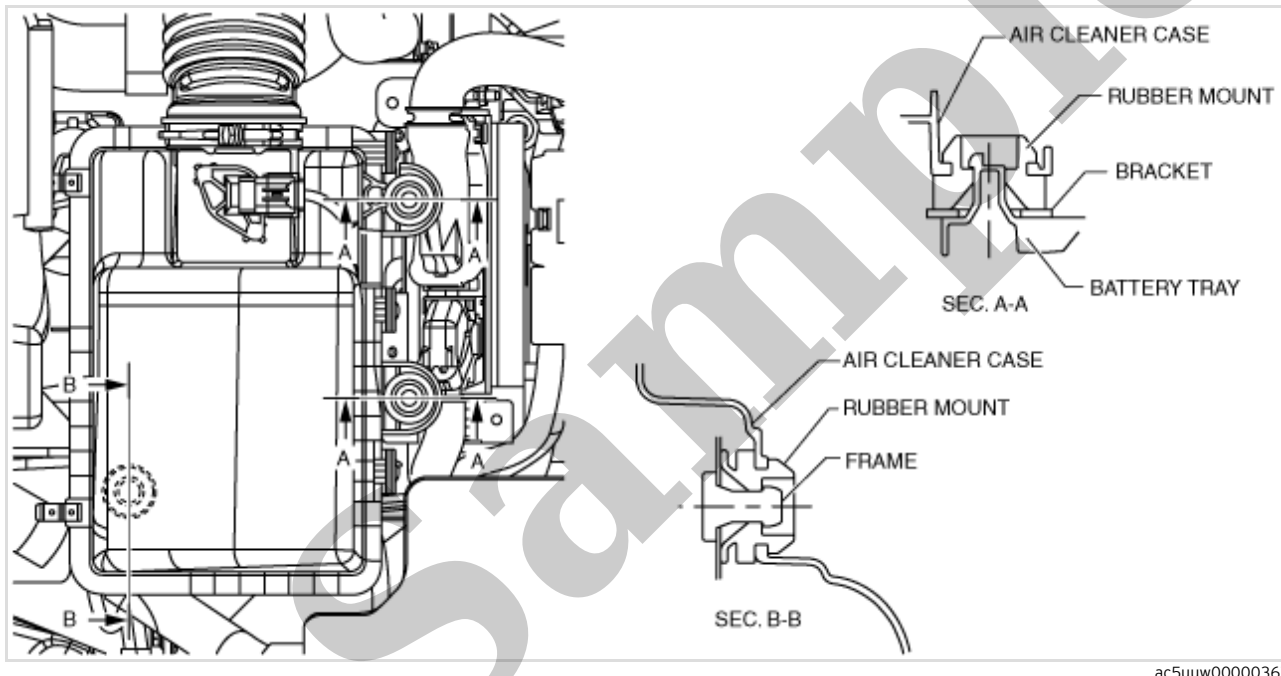

Air Cleaner Cover Installation Note

1. Install the air cleaner cover as shown in the figure.

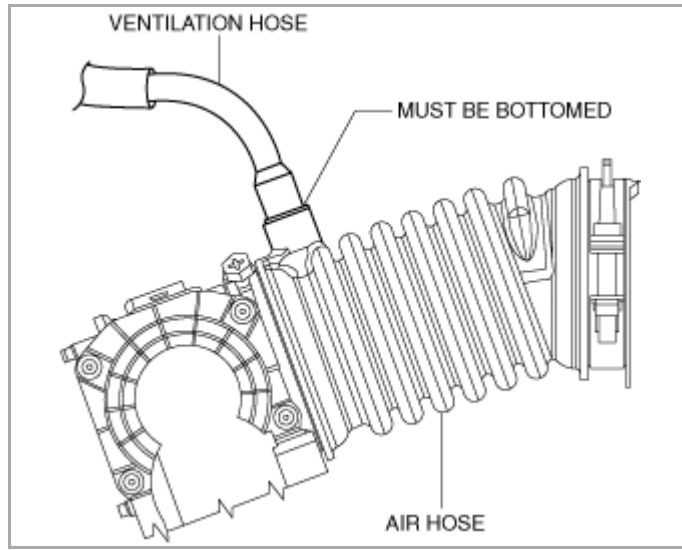

ac5uuw00000371

Sample

INTAKE-AIR SYSTEM VACUUM HOSE ROUTING DIAGRAM [SKYACTIV-G 2.5 (WITHOUT CYLINDER DEACTIVATION)]

SM2897406

id0113s180410

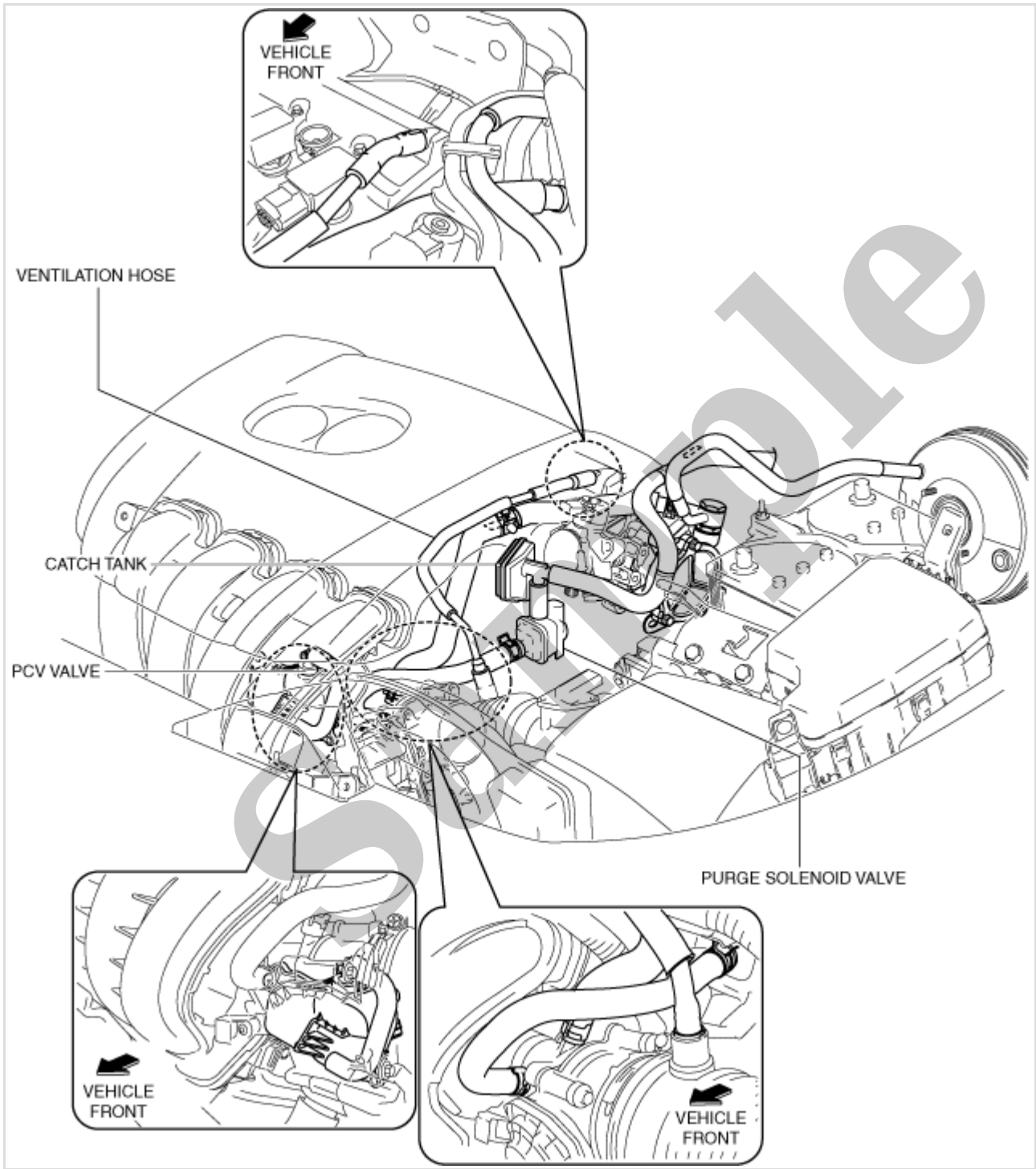

ac5uuw00011178

AIR CLEANER ELEMENT INSPECTION [SKYACTIV-G 2.5 (WITHOUT CYLINDER DEACTIVATION)]

SM2897399

id0113s180080

1.Remove the air cleaner element. (See [AIR CLEANER ELEMENT REMOVAL/INSTALLATION \[SKYACTIV-G 2.5 \(WITHOUT CYLINDER DEACTIVATION\)\]](#).)

2.Inspect the following items:

- Has the replacement interval past?
- Is the air cleaner element soiled, damaged, or bent?
- Are the air cleaner case and the air cleaner element correctly sealed?
- Is the correct air cleaner element installed?

— If there is any abnormality, clean or replace the air cleaner element. (See [AIR CLEANER ELEMENT REMOVAL/INSTALLATION \[SKYACTIV-G 2.5 \(WITHOUT CYLINDER DEACTIVATION\)\]](#).)