

Your Ultimate Source for OEM Repair Manuals

FactoryManuals.net is a great resource for anyone who wants to save money on repairs by doing their own work. The manuals provide detailed instructions and diagrams that make it easy to understand how to fix a vehicle.

2007 MAZDA 2 / Demio OEM Service and Repair Workshop Manual

[Go to manual page](#)

8.Remove the bolts and clips shown in the figure and remove the wiring harness bracket.

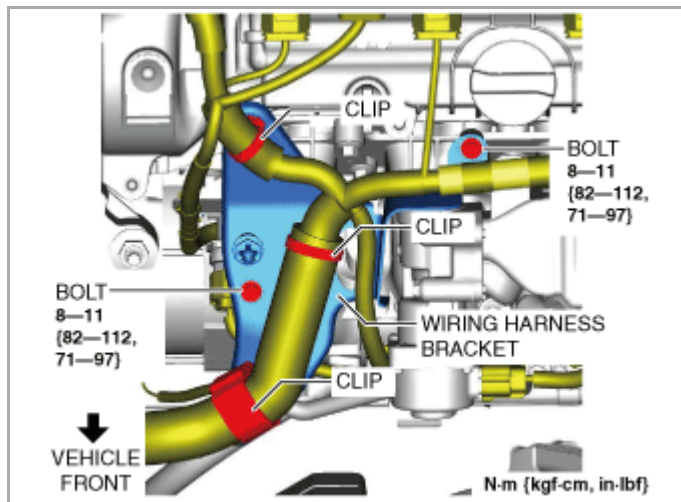

ac9uuw00009512

9.Disconnect the wiring harness clips from the intake manifold.

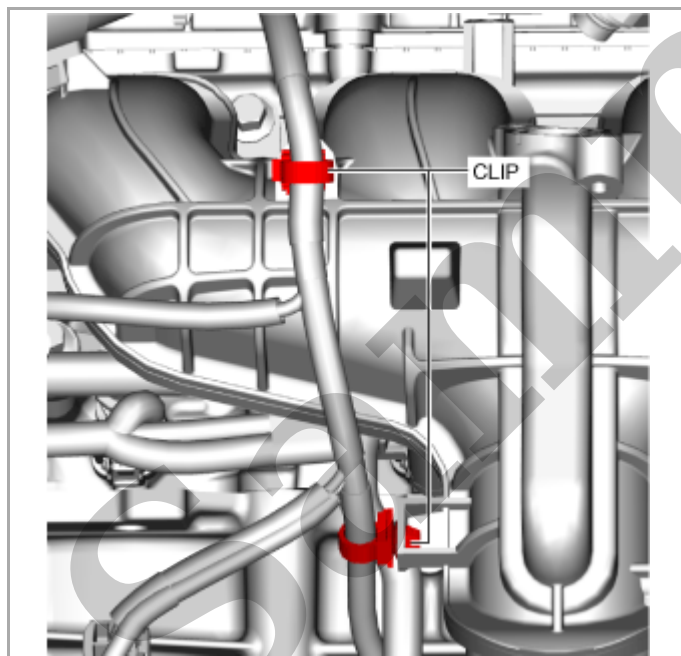

am6xuw00010688

10.Remove the intake manifold.

11.Remove the bracket from the intake manifold.

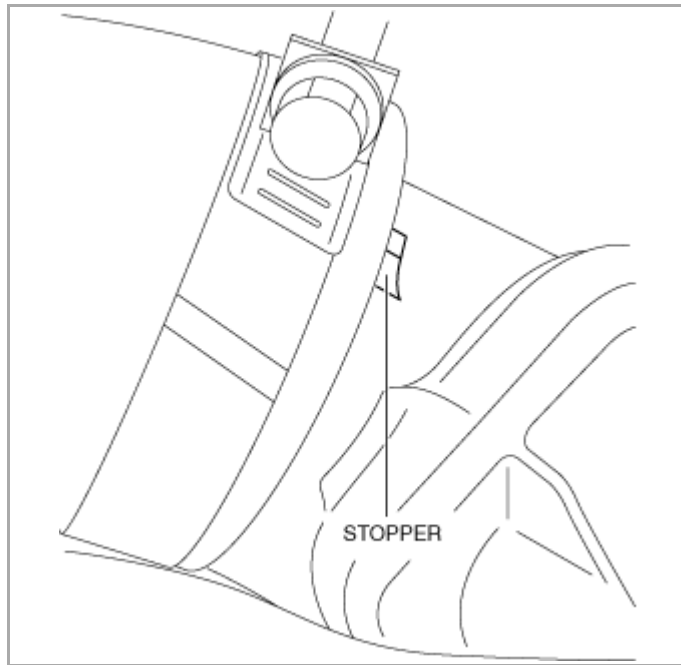

ac5wzw00007966

5.Re-position the temporarily installed hose clamp to the position 5–7 mm {0.20–0.27 in} from the charge air cooler outlet pipe stopper.

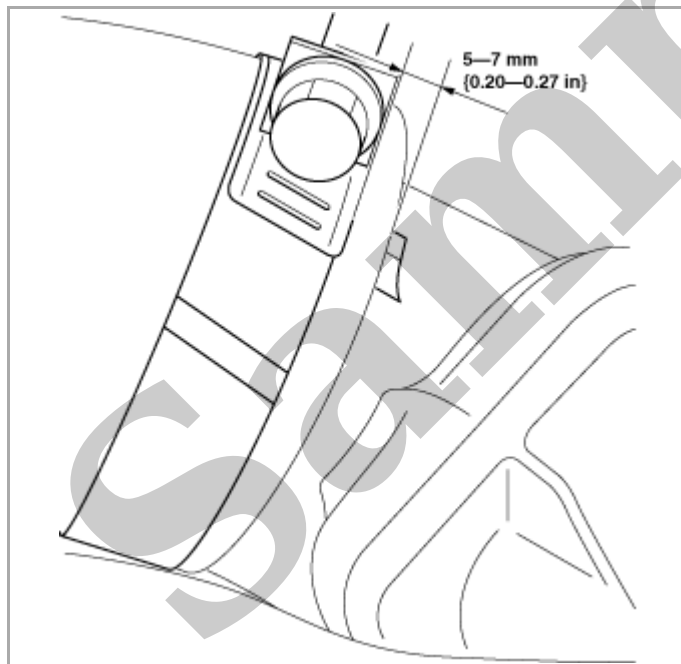

ac5wzw00007967

Caution

- If the hose clamp is not tightened sufficiently, the charge air cooler outlet hose could become disconnected, and if it is tightened excessively, it may damage the charge air cooler outlet hose and charge air cooler outlet pipe. Therefore, assemble the end of the hose clamp so that it rides on the white line.

6.Tighten the hose clamp until the clamp end rides on top of the white line.

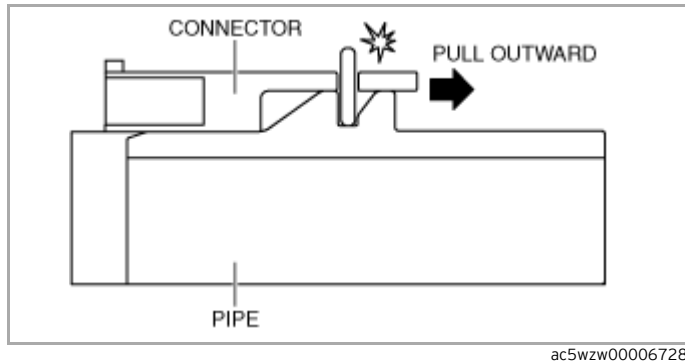

7. Install the front under cover No.2. (See [FRONT UNDER COVER No.2 REMOVAL/INSTALLATION.](#))

8. Install the front under cover No.1. (See [FRONT UNDER COVER No.1 REMOVAL/INSTALLATION.](#))

Air Cleaner Cover Installation Note

1. Install the air cleaner cover as shown in the figure.

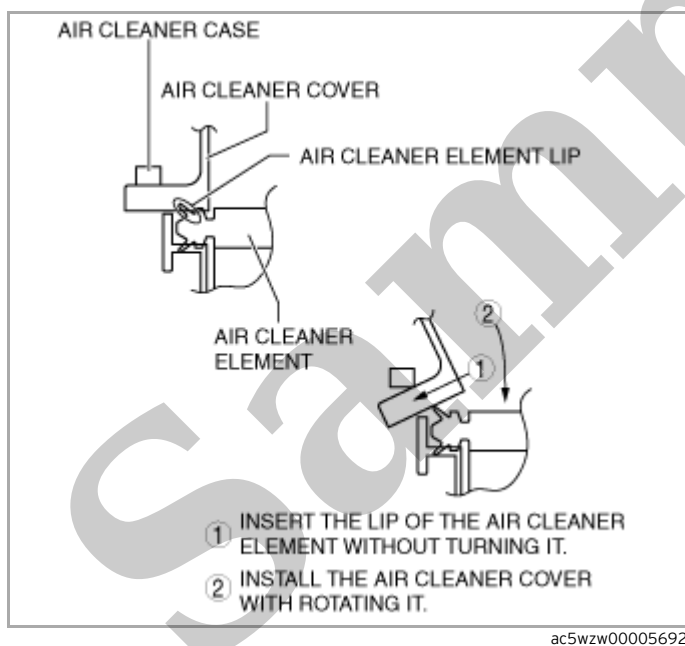

2. Secure the air cleaner cover and the air cleaner case with the clip.

INTAKE-AIR SYSTEM VACUUM HOSE ROUTING DIAGRAM [SKYACTIV-G 2.5T]

SM2897388

id0113q480410

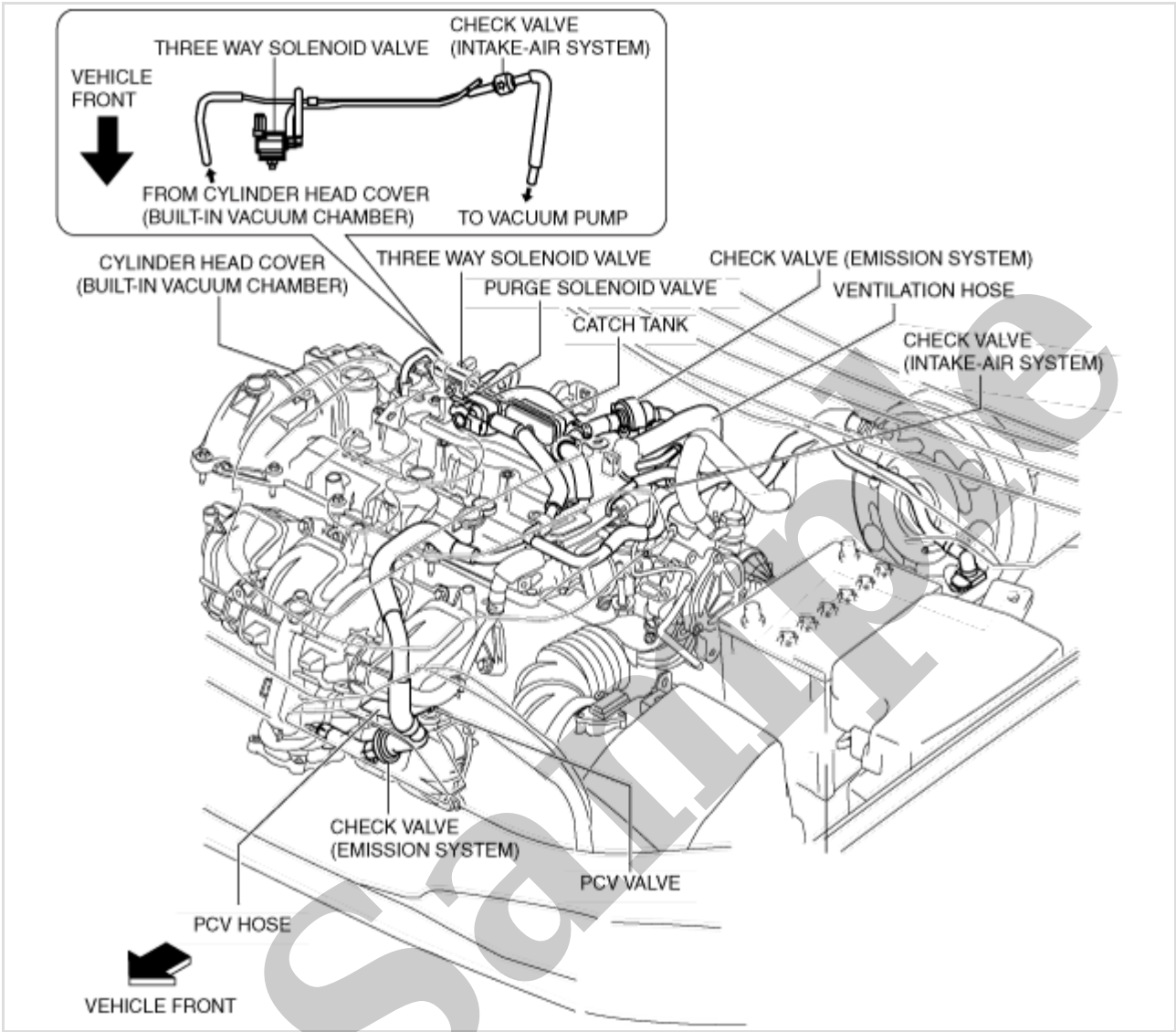

ac9uuw00009727

AIR BYPASS VALVE REMOVAL/INSTALLATION [SKYACTIV-G 2.5T]

SM2897370

id0113q407080

Note

- The air bypass valve cannot be removed.

1.Remove the dynamic pressure turbo. (See [DYNAMIC PRESSURE TURBO REMOVAL/INSTALLATION \[SKYACTIV-G 2.5T\]](#).)

Sample

VACUUM CHAMBER REMOVAL/INSTALLATION [SKYACTIV-G 2.5T]

SM2897372

id0113q426540

Note

- The vacuum chamber cannot be removed as it is built into the cylinder head cover.

1.Remove the cylinder head cover. (See [TIMING CHAIN REMOVAL/INSTALLATION \[SKYACTIV-G 2.5T\]](#).)

Sample

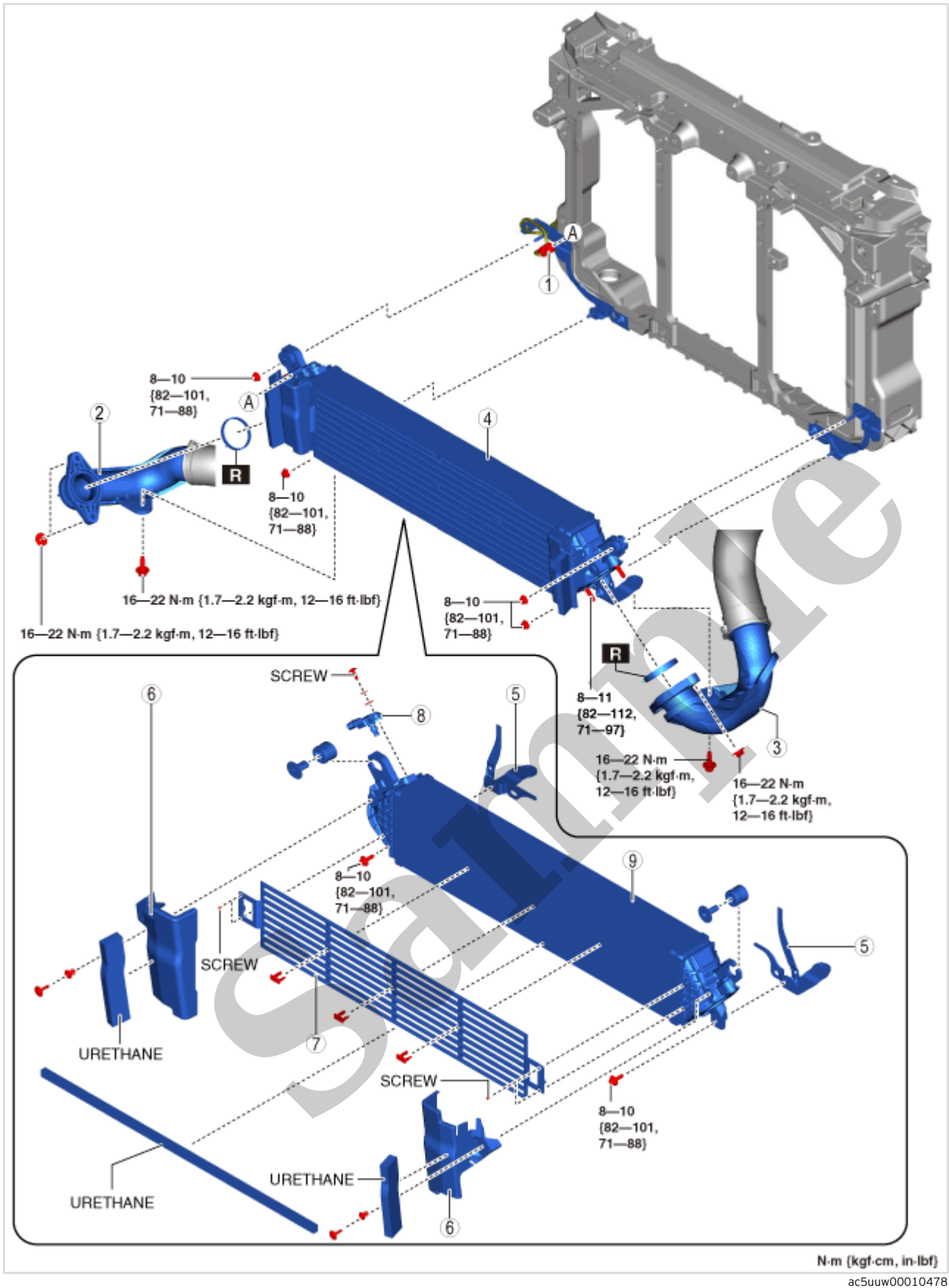

1	Boost pressure sensor/boost air temperature sensor connector
2	Charge air cooler outlet pipe (See Charge Air Cooler Inlet Pipe, Charge Air Cooler Outlet Pipe Installation Note.)
3	Charge air cooler inlet pipe (See Charge Air Cooler Inlet Pipe, Charge Air Cooler Outlet Pipe Installation Note.)
4	Charge air cooler component
5	Bracket
6	Guide plate

DYNAMIC PRESSURE TURBO REMOVAL/INSTALLATION [SKYACTIV-G 2.5T]

SM2897377

id0113q470770

Replacement Part

Washer	Nut	Gasket
Quantity: 2	Quantity: 5	Quantity: 1
Location of use: Water pipe No.1	Location of use: Dynamic pressure turbo	Location of use: Dynamic pressure turbo
Washer	Gasket	Gasket
Quantity: 2	Quantity: 1	Quantity: 1
Location of use: Water pipe No.2	Location of use: Oil pipe No.2	Location of use: Oil pipe No.3
Washer		
Quantity: 4	-	-
Location of use: Oil pipe No.1		

- 1.Drain the engine coolant. (See [ENGINE COOLANT REPLACEMENT \[SKYACTIV-G 2.5T\].](#))
- 2.Disconnect the negative battery terminal. (See [NEGATIVE BATTERY TERMINAL DISCONNECTION/CONNECTION.](#))
- 3.Remove the plug hole plate. (See [PLUG HOLE PLATE REMOVAL/INSTALLATION \[SKYACTIV-G 2.5T\].](#))
- 4.Remove the air cleaner, air hose and fresh air duct as a single unit. (See [INTAKE-AIR SYSTEM REMOVAL/INSTALLATION \[SKYACTIV-G 2.5T\].](#))
- 5.Remove the battery and battery tray. (See [BATTERY REMOVAL/INSTALLATION \[SKYACTIV-G 2.5T\].](#))
- 6.Remove the air inlet pipe. (See [INTAKE-AIR SYSTEM REMOVAL/INSTALLATION \[SKYACTIV-G 2.5T\].](#))
- 7.Set the turbocharger air inlet hose aside. (U.S.A., Canada and Israel) (See [INTAKE-AIR SYSTEM REMOVAL/INSTALLATION \[SKYACTIV-G 2.5T\].](#))
- 8.Remove the turbocharger air inlet hose. (except U.S.A., Canada and Israel) (See [INTAKE-AIR SYSTEM REMOVAL/INSTALLATION \[SKYACTIV-G 2.5T\].](#))
- 9.Remove the turbocharger air outlet pipe installation nuts and set the turbocharger air outlet pipe aside. (See [INTAKE-AIR SYSTEM REMOVAL/INSTALLATION \[SKYACTIV-G 2.5T\].](#))

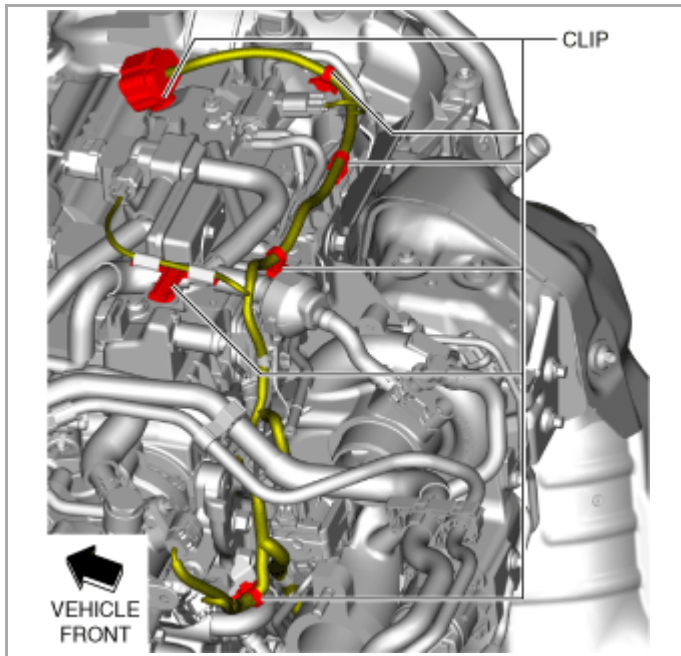

am6xuw00010684

14. Remove the front crossmember component. (See [FRONT CROSSMEMBER REMOVAL/INSTALLATION](#).)

15. Remove the WU-TWC. (See [EXHAUST SYSTEM REMOVAL/INSTALLATION \[SKYACTIV-G 2.5T\]](#).)

16. Remove the oil pipe protector. (See [OIL COOLER REMOVAL/INSTALLATION \[SKYACTIV-G 2.5T\]](#).)

17. Disconnect the vacuum hose (exhaust manifold variable valve actuator side) shown in the figure.

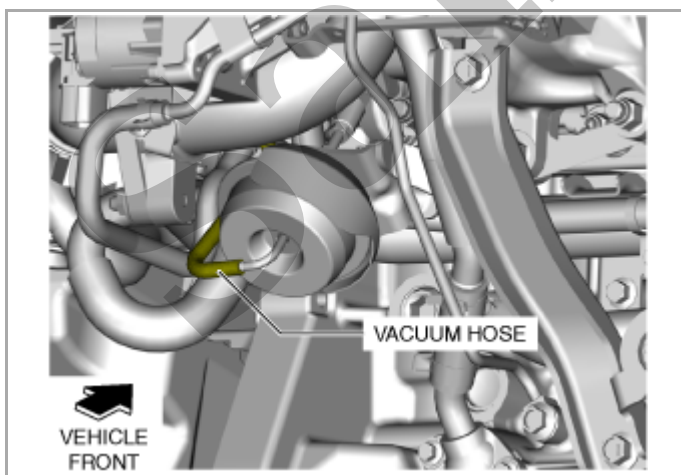

ac9uuw00009692

18. Remove in the order indicated in the table.

19. Install in the reverse order of removal.

20. Refill the engine coolant. (See [ENGINE COOLANT REPLACEMENT \[SKYACTIV-G 2.5T\]](#).)