

Your Ultimate Source for OEM Repair Manuals

FactoryManuals.net is a great resource for anyone who wants to save money on repairs by doing their own work. The manuals provide detailed instructions and diagrams that make it easy to understand how to fix a vehicle.

2007 JEEP Wrangler Unlimited OEM Service and Repair Workshop Manual

[Go to manual page](#)

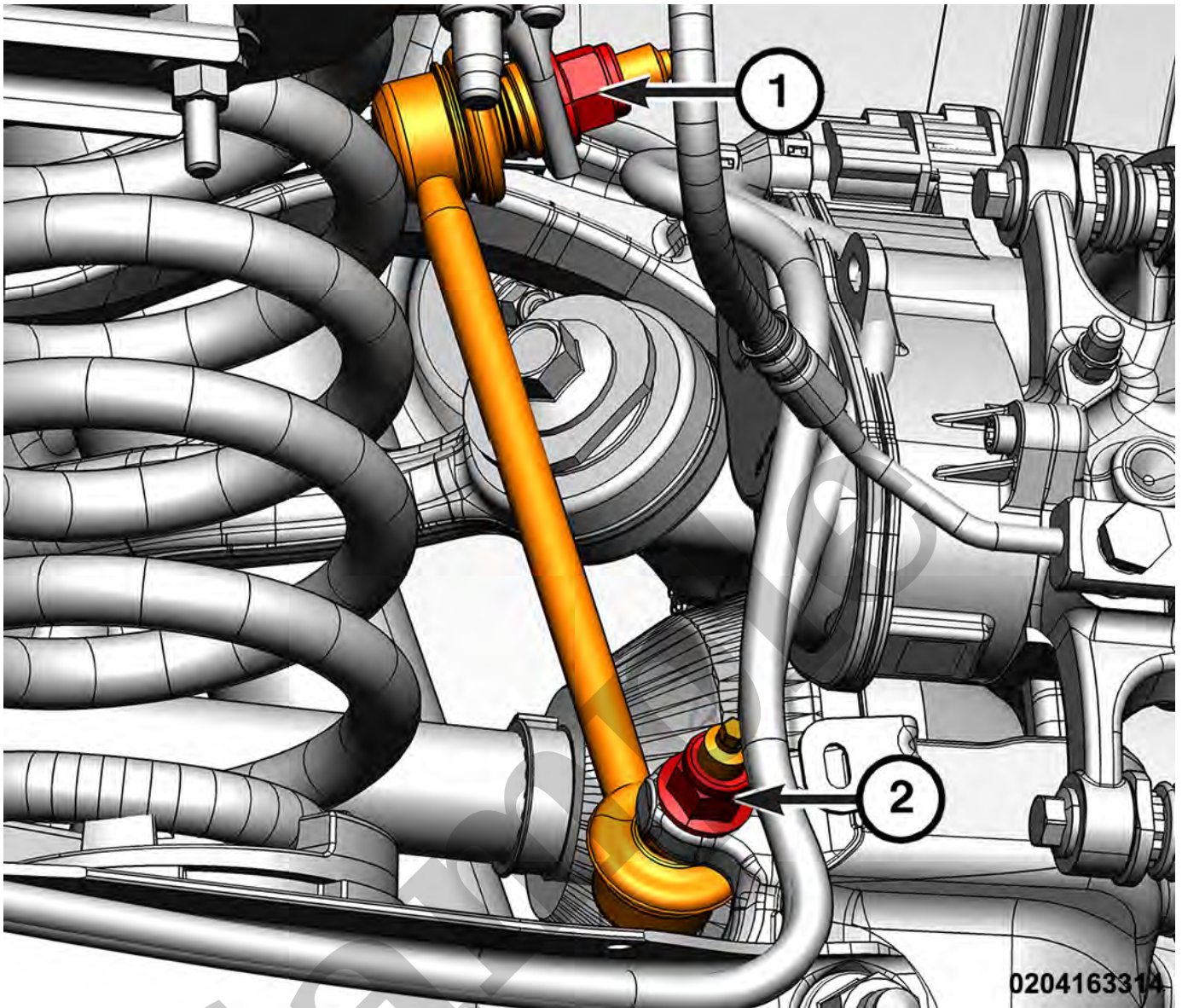

1 - Stabilizer Bar Link Upper Nut

2 - Stabilizer Bar Link Lower Nut

5. Hold the stud, then remove and **DISCARD** the stabilizer bar link upper nut.

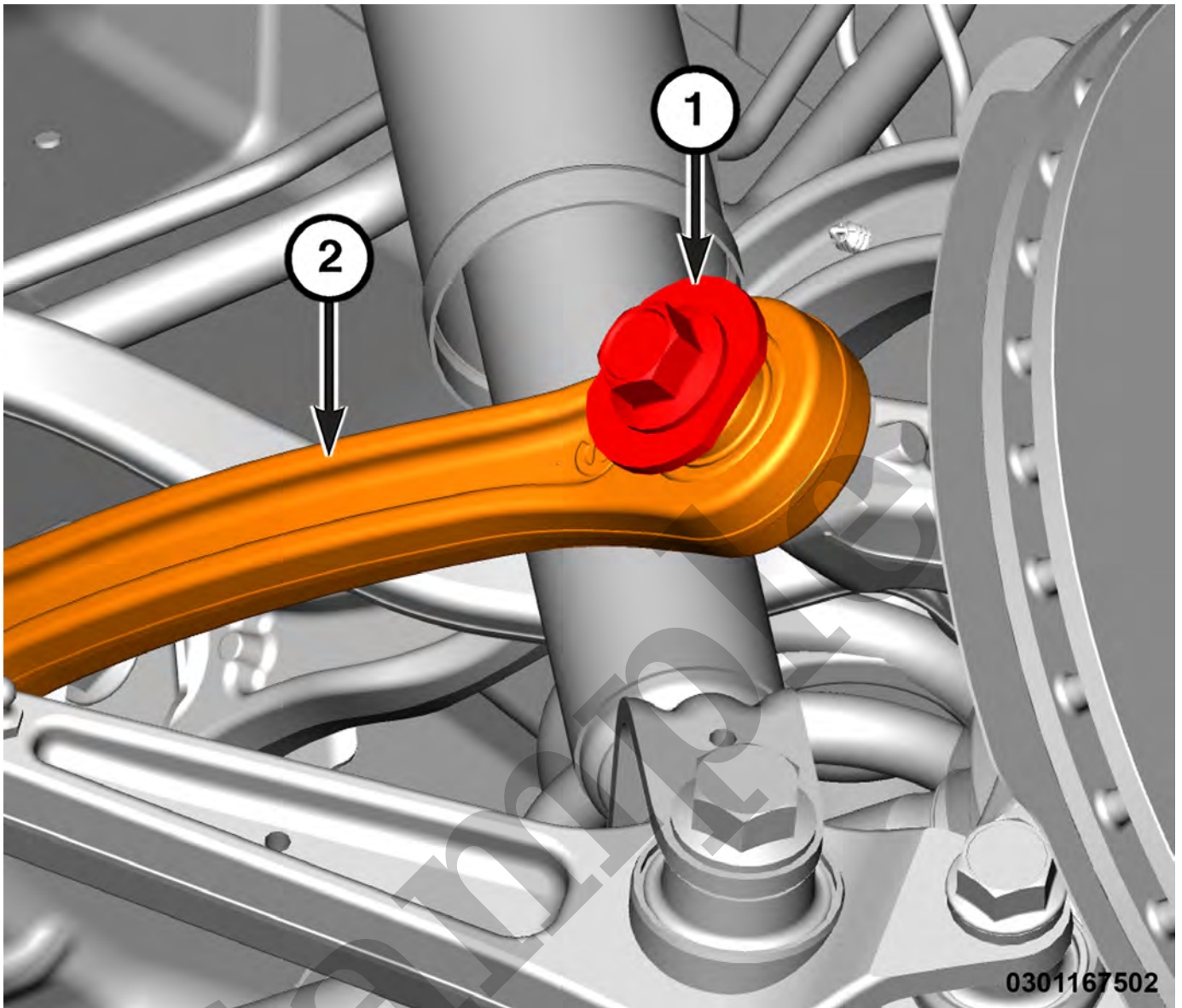

1 - Toe Link Outer Bolt

2 - Toe Link

11. Remove the toe link outer bolt from the knuckle side of the toe link.

- Install a **NEW** hub nut on the outer CV joint shaft.
- After the knuckle is reassembled, use the Push-Pull-Push method to verify that the halfshaft circlip is still engaged.
- If equipped with air suspension, use the scan tool to navigate to the Air Suspension Control Module (ASCM) and perform the following routines:
 - Fill Spring From Reservoir
 - Enable Level Control

NOTE

The air suspension system can be disabled and enabled by using the DSM in the vehicle under Tire Jack Mode, which is the preferred method. If the disable level control routine in the diagnostic scan tool is used, it will only disable the level control (automatic and manual) for that ignition cycle. The air suspension system can also be enabled by driving the vehicle above 8 km/h (5 mph). The air suspension must be disabled prior to lifting the vehicle or performing any work.

- Support the vehicle suspension and place at ride height. Torque all suspension fasteners to proper torque specifications.

TORQUE SPECIFICATIONS - REAR AXLE - 230RIA

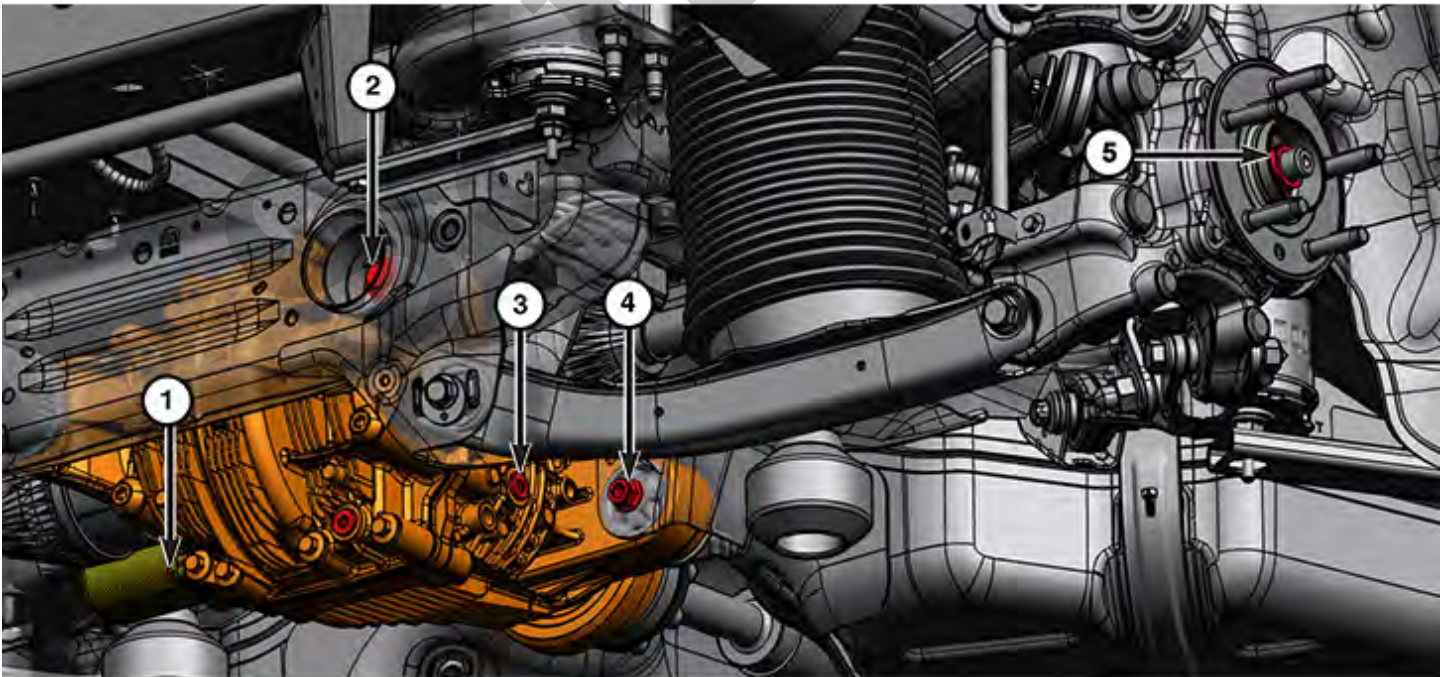

YOUR CURRENT VEHICLE

195FIA - Special Tools

195FIA - SPECIAL TOOLS

Driver Handle, Universal

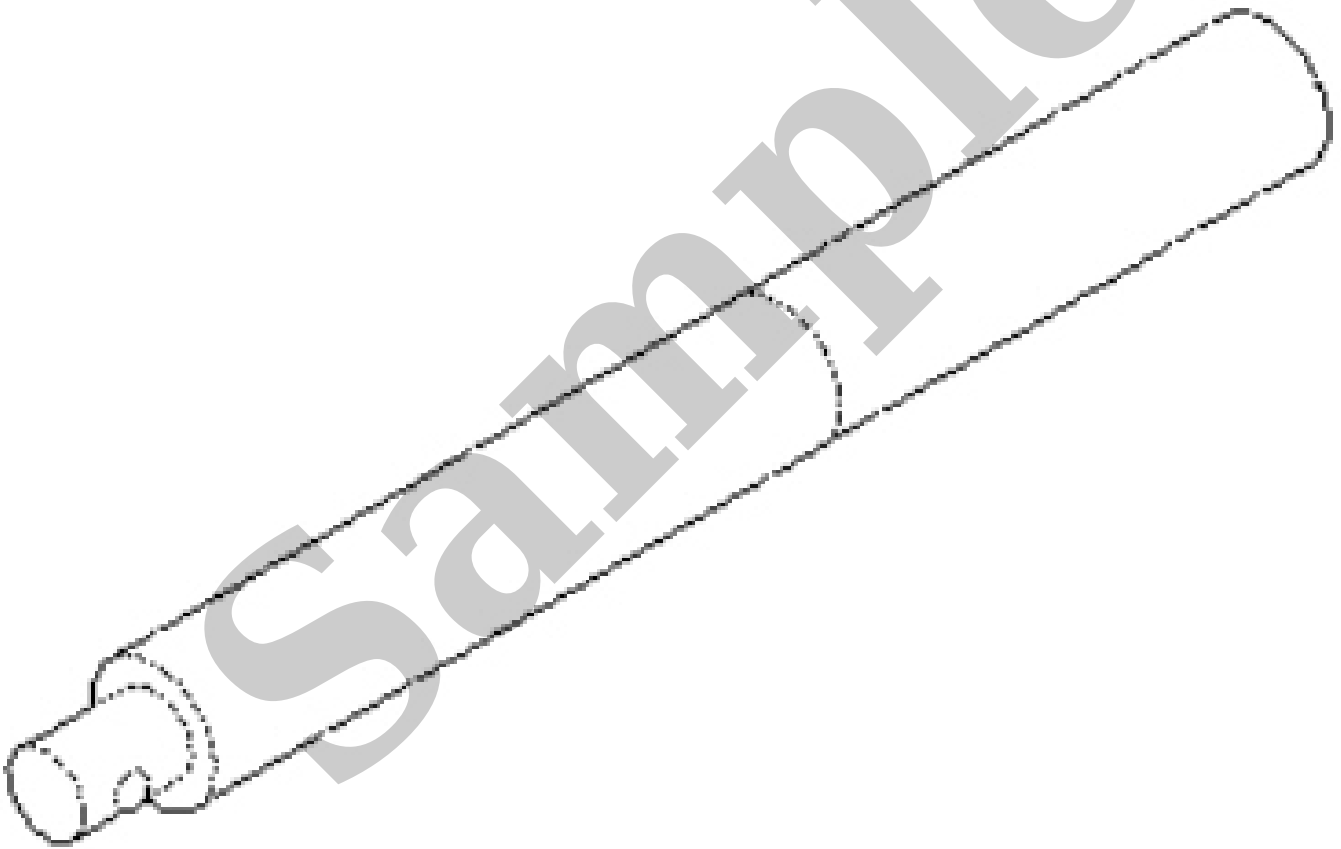

Protector, Half Shaft, Drive

Remover, Seal

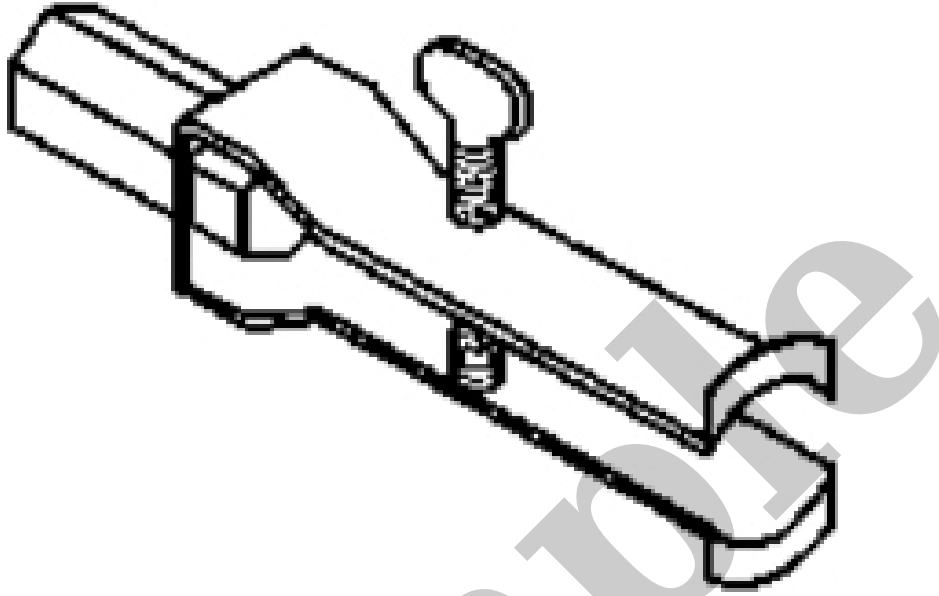

Cup, Receiver

Receiver, Small Bushing Remover

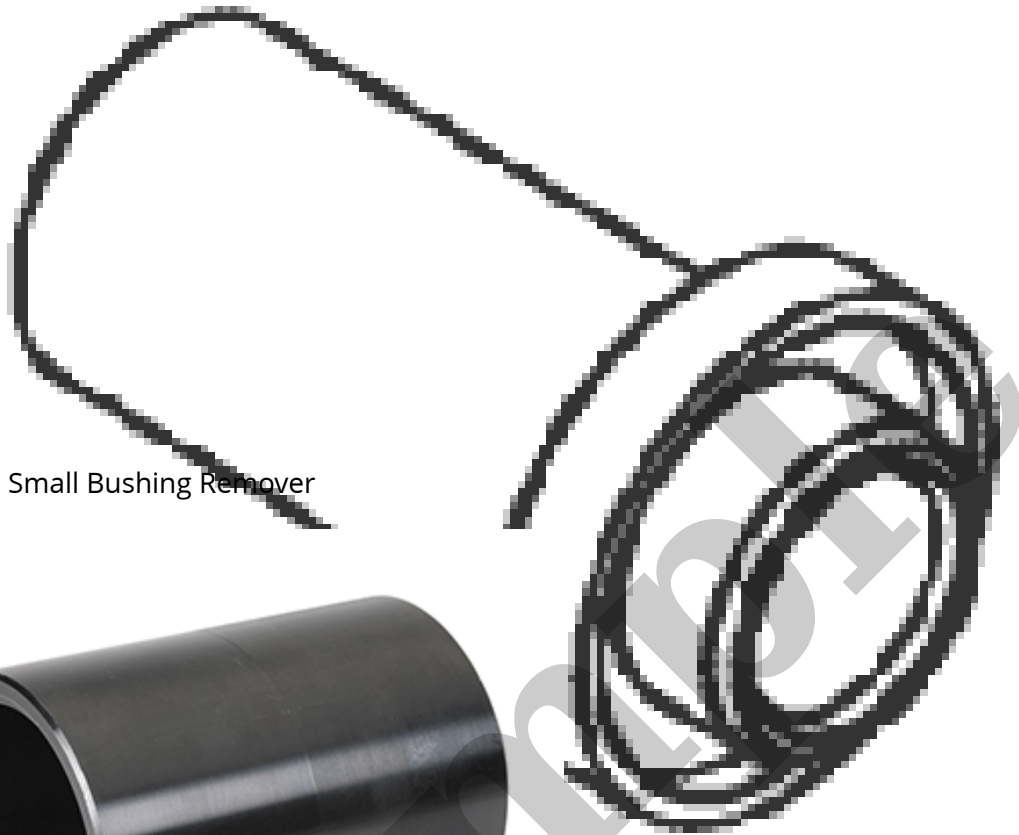

Remover, Small Bushing

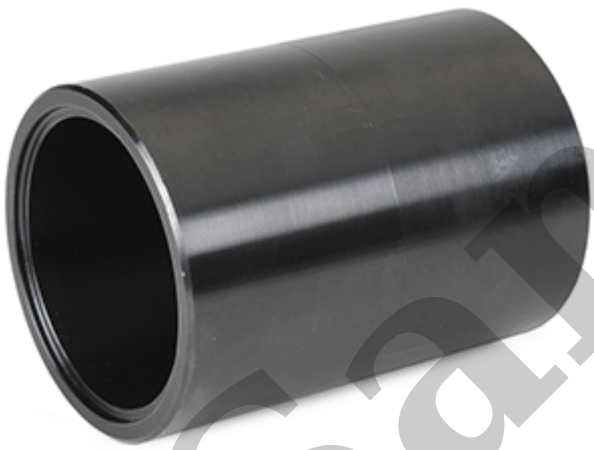

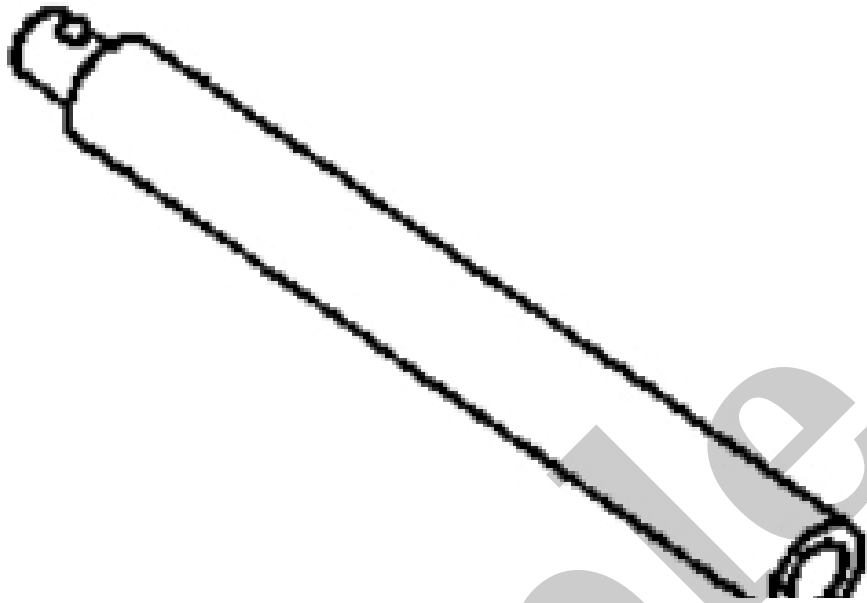

Installer, Bearing

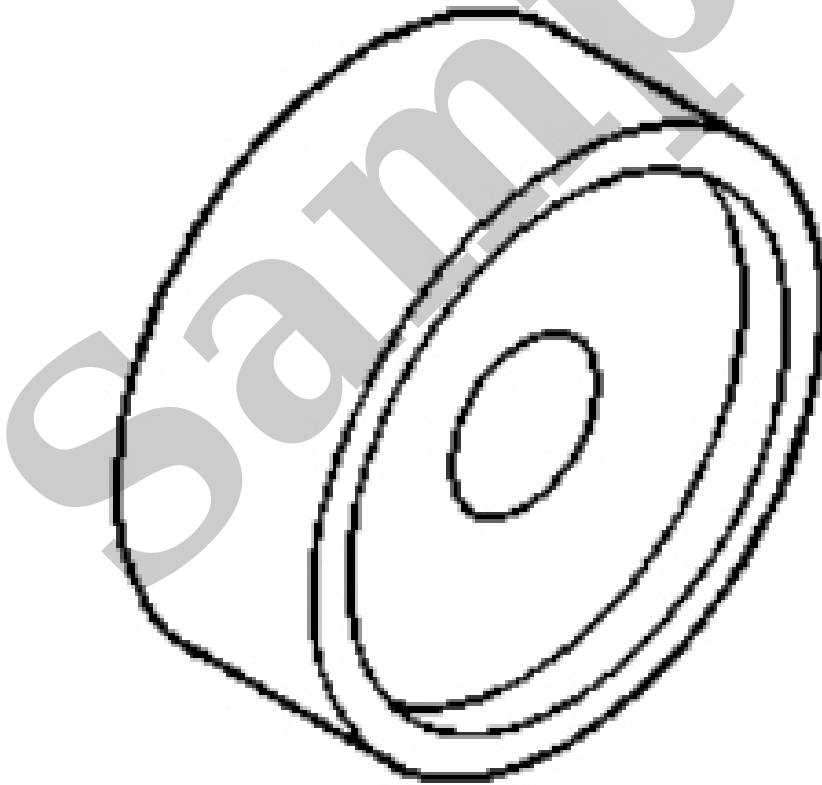

Slide Hammer, Universal

Remover, Seal

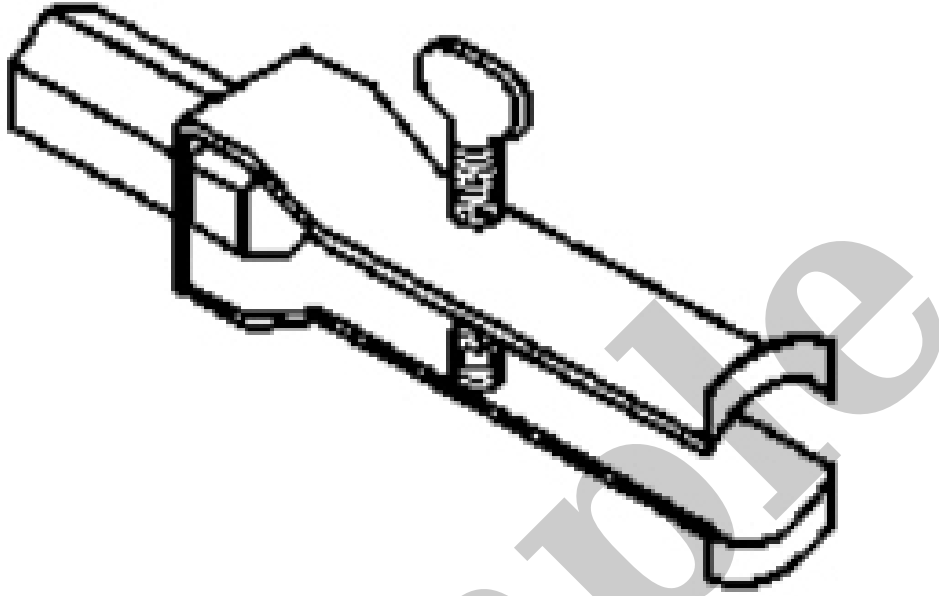

Cup, Receiver

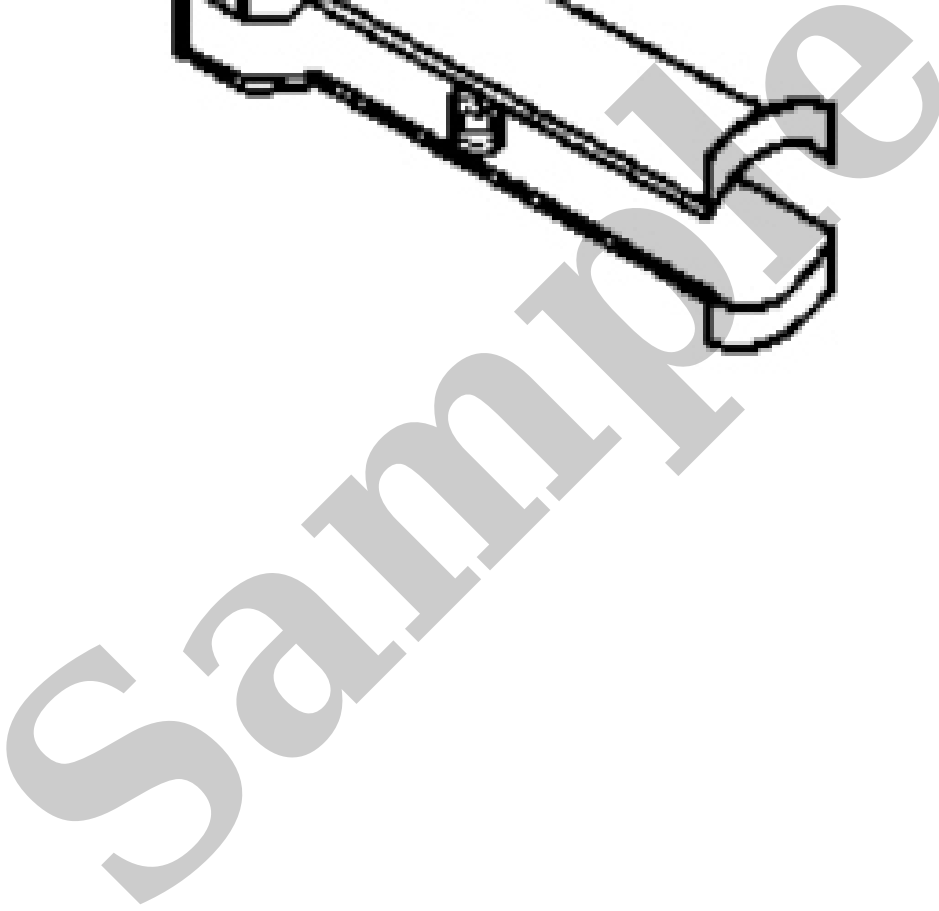

Installer, Seal

