

Your Ultimate Source for OEM Repair Manuals

FactoryManuals.net is a great resource for anyone who wants to save money on repairs by doing their own work. The manuals provide detailed instructions and diagrams that make it easy to understand how to fix a vehicle.

2007 Jeep WRANGLER Service Manual

[Go to manual page](#)

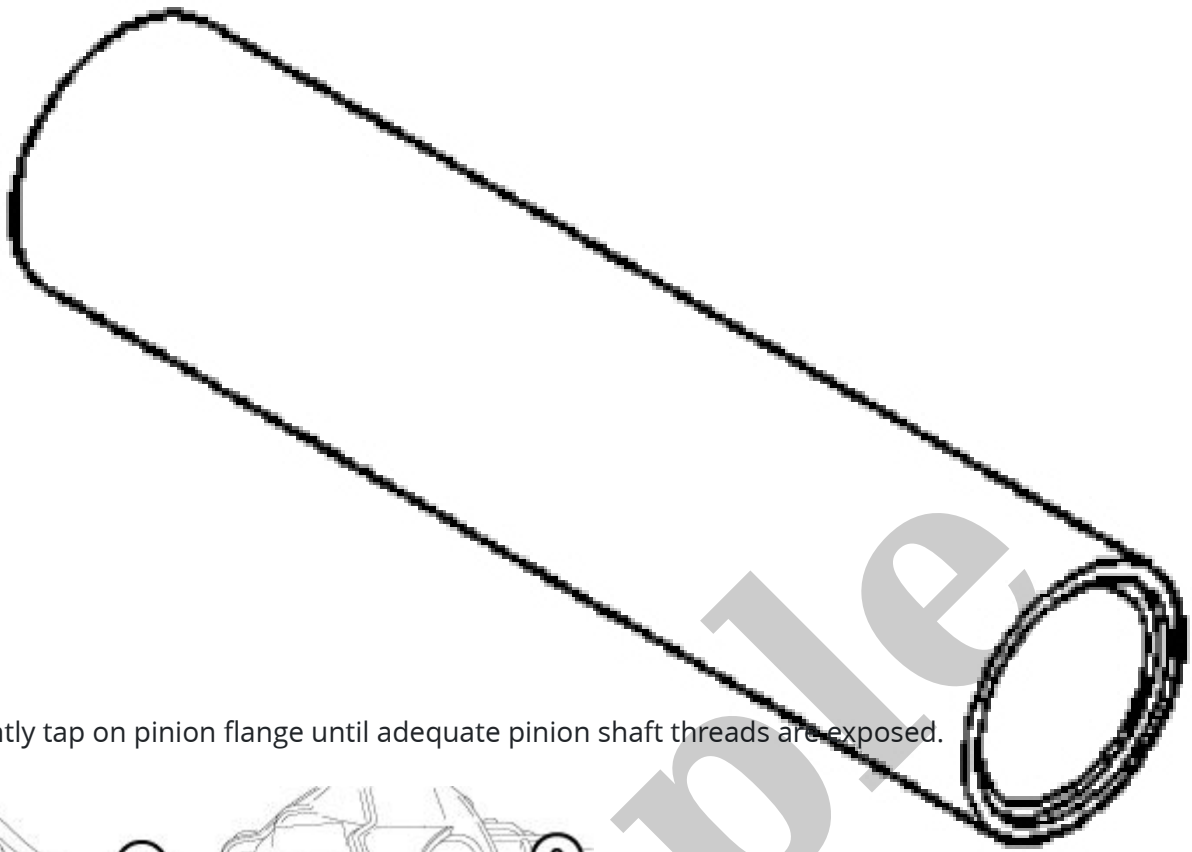

, lightly tap on pinion flange until adequate pinion shaft threads are exposed.

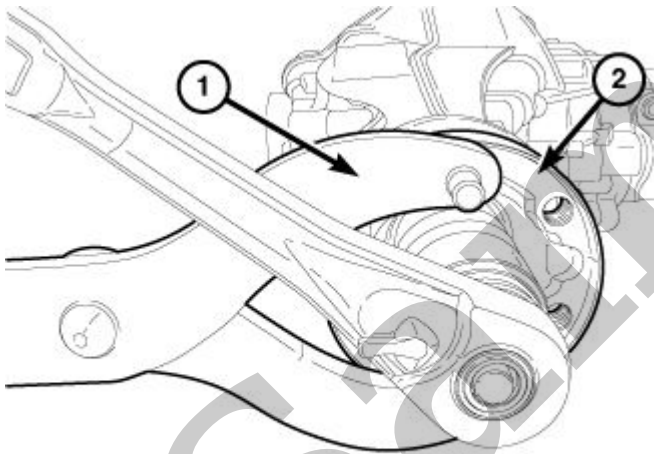

2975841

1 - Flange Wrench

2 - Pinion Flange

- Apply Mopar® Lock and Seal Adhesive Loctite 2701 to the pinion flange nut.
- Apply axle grease to pinion nut washer face prior to installing nut.
- Using Flange Wrench

Holder, Flange

Front Driveshaft

FRONT DRIVESHAFT

REMOVAL

NOTE

The front driveshaft is only serviced as a complete assembly.

1. Raise and support the vehicle ([Refer to Vehicle Quick Reference/Hoisting/Standard Procedure](#)).
2. Remove the transmission belly pan ([Refer to Frame and Bumpers/Under Body Protection/BELLY PAN/Removal and Installation](#)).
3. Support the transfer case.
4. Remove the transmission crossmember ([Refer to Frame and Bumpers/Frame/CROSSMEMBER, Transmission/Removal and Installation](#)).
5. Mark a reference line across the transfer case flange and the front driveshaft flange yoke to maintain proper driveshaft alignment during reassembly.

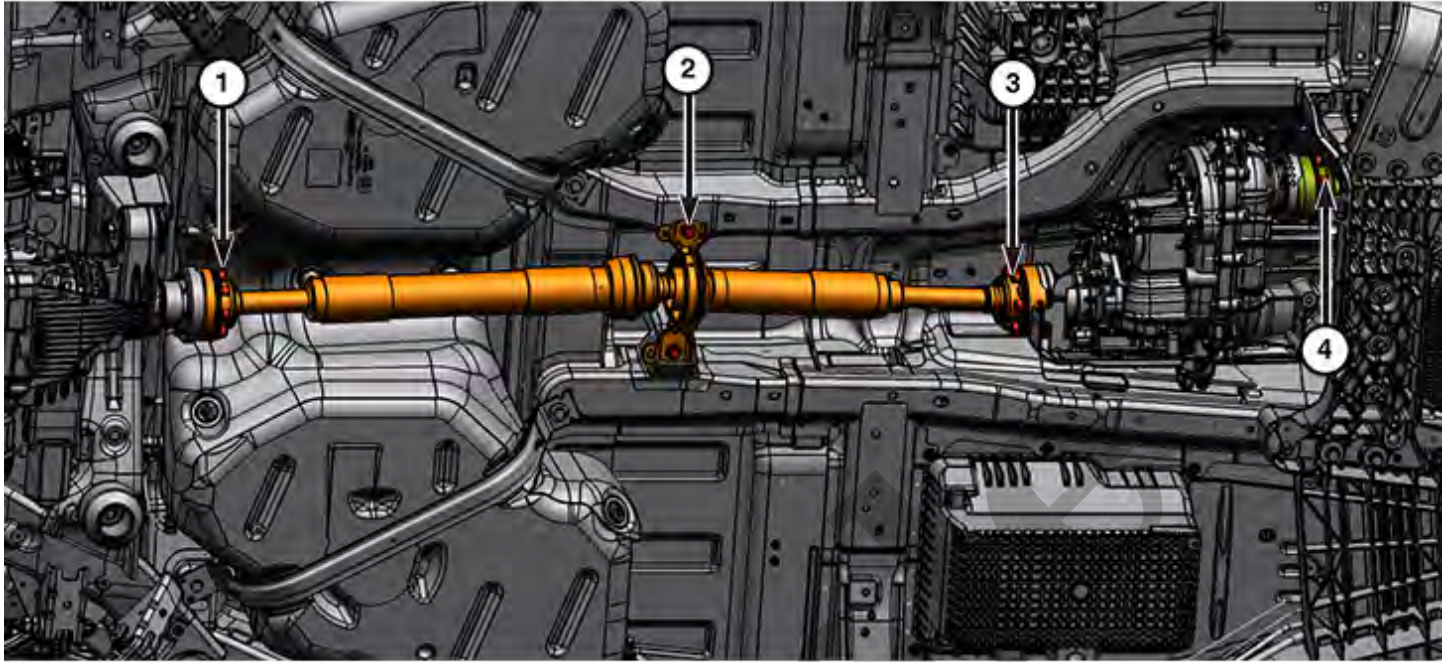

0305191835

CALLOUT	DESCRIPTION	SPECIFICATION	COMMENTS
1	Rear Driveshaft to Rear Pinion Flange Bolts	56 N·m (41 Ft. Lbs.)	If removed, NEW bolts must be installed and tightened to specifications
2	Rear Driveshaft Center Support Bearing Bolts	55 N·m (41 Ft. Lbs.)	If removed, NEW bolts must be installed and tightened to specifications
3	Rear Driveshaft to Transfer Case Flange Bolts	56 N·m (41 Ft. Lbs.)	If removed, NEW bolts must be installed and tightened to specifications
4	Front Driveshaft to Transfer Case Flange Bolts	56 N·m (41 Ft. Lbs.)	If removed, NEW bolts must be installed and tightened to specifications

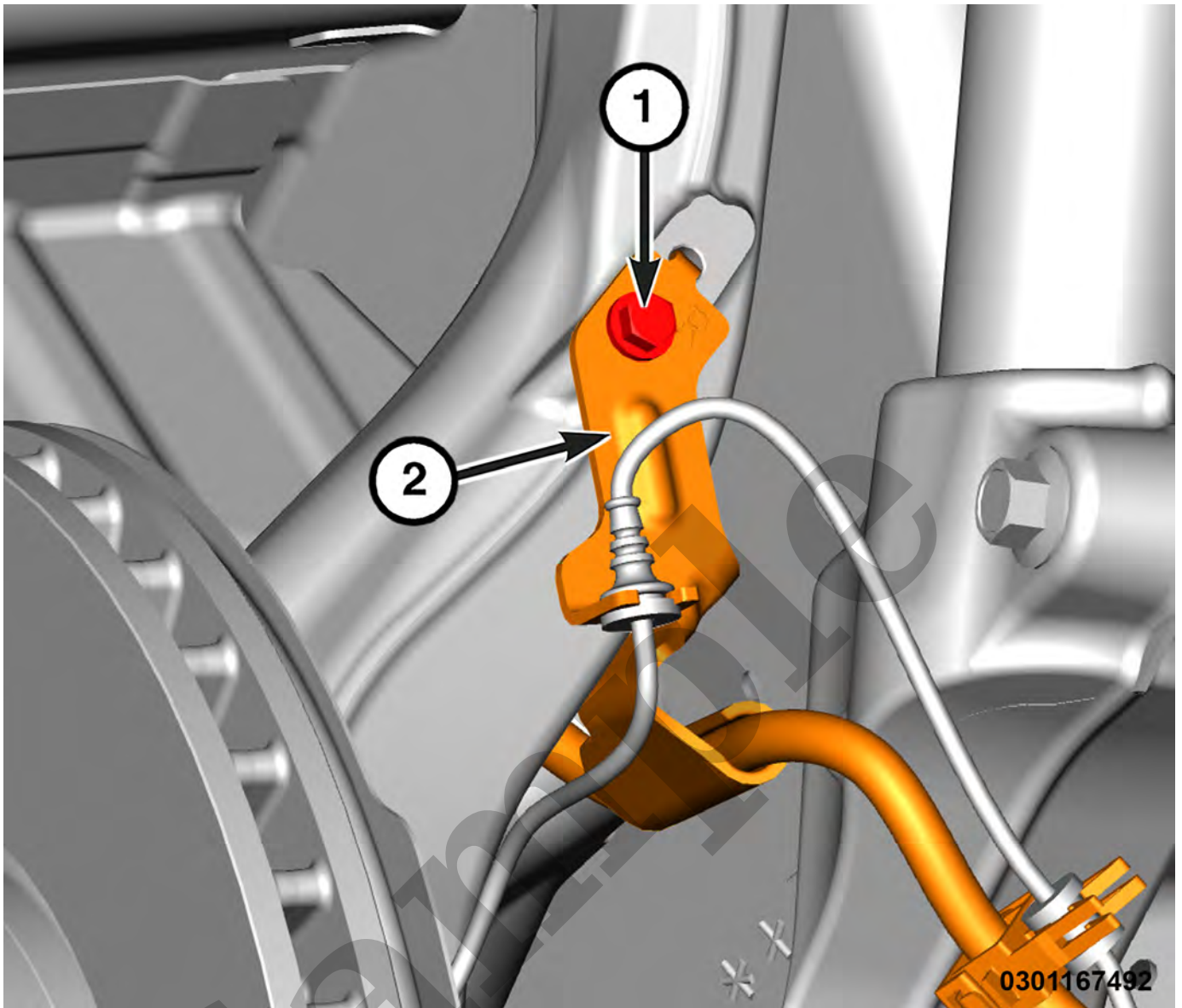

1 - Front Brake Hose Bracket Bolt

2 - Front Brake Hose Bracket

6. Remove the front brake hose bracket bolt and position the front brake hose bracket aside.

CAUTION

DO NOT attempt to rotate the steering knuckle pinch nut. The steering knuckle pinch nut is pressed in the steering knuckle and damage will occur if the nut is rotated.

10. Hold the nut and remove the steering knuckle pinch bolt.
11. Separate the upper ball joint from the steering knuckle.

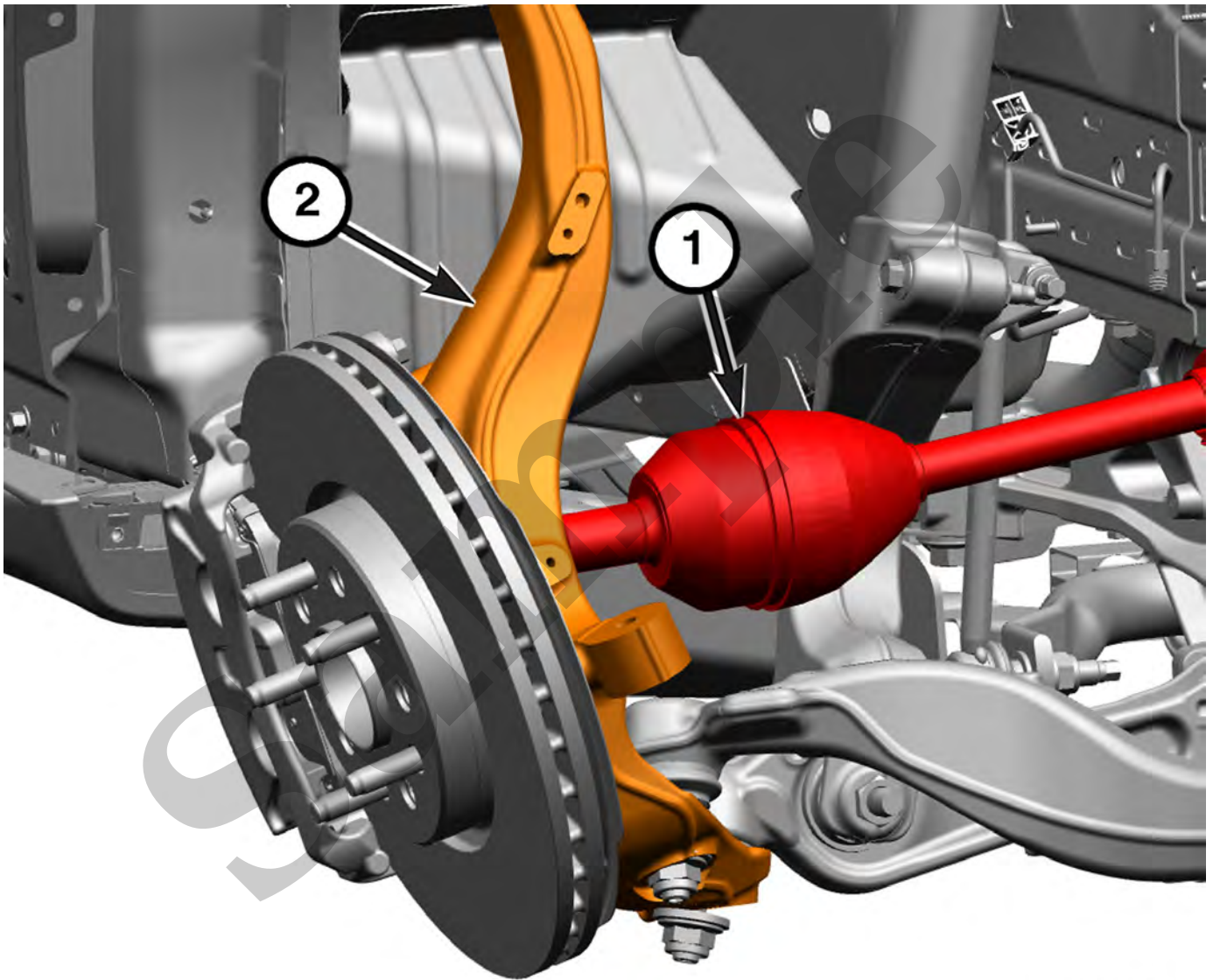

0301167493

1 - Front Halfshaft

2 - Steering Knuckle

CALLOUT	DESCRIPTION	SPECIFICATION	COMMENTS
		2. + 115°	
-	Differential Vent Fitting	15 N·m (11 In. Lbs.)	-

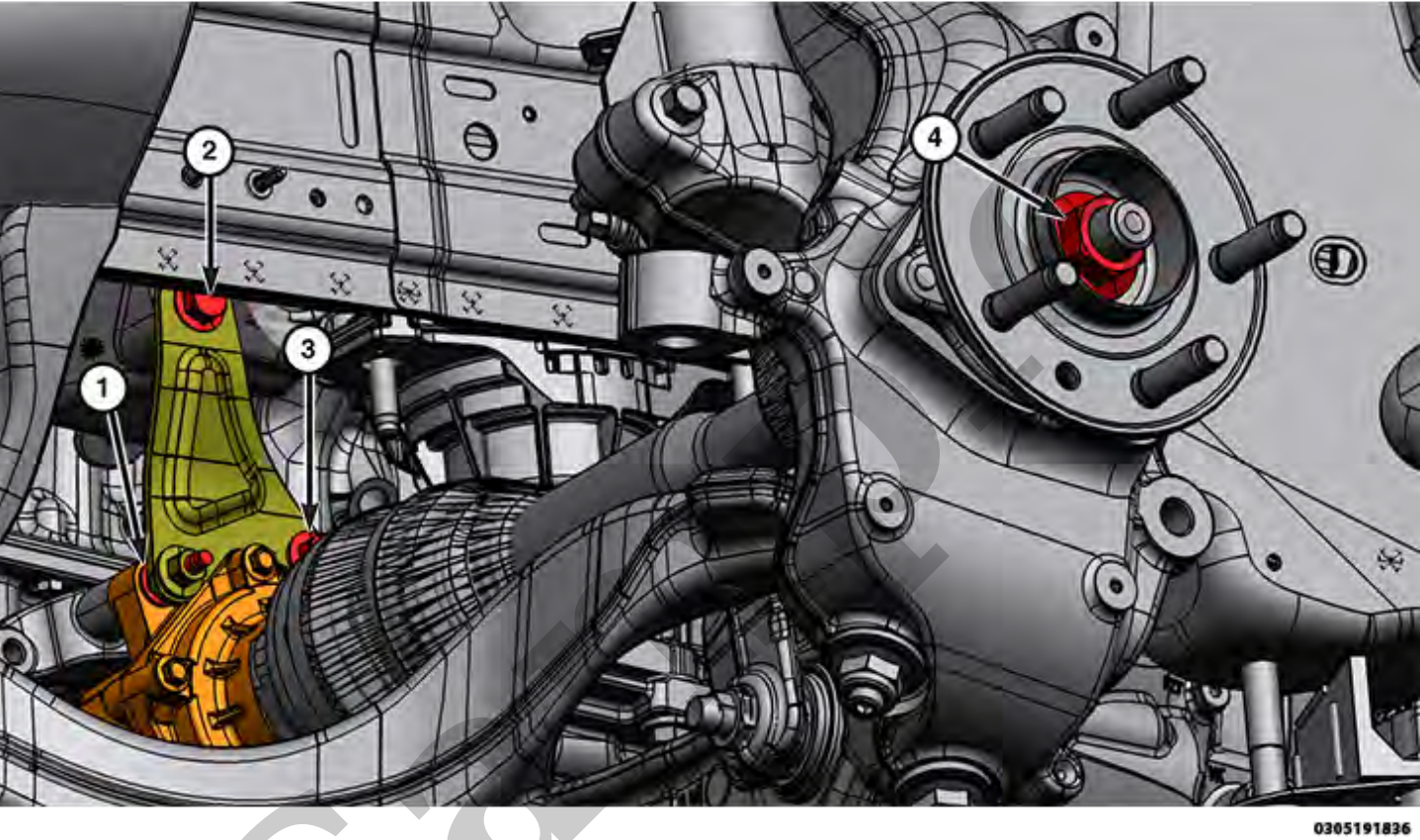

CALLOUT	DESCRIPTION	SPECIFICATION	COMMENTS
1	Front Axle Disconnect (FAD) to Engine Bolt (Double Ended Stud)	55 N·m (41 Ft. Lbs.)	-
2	Front Axle Disconnect (FAD) Bracket Bolt	35 N·m (26 Ft. Lbs.)	-
3	Front Axle Disconnect (FAD) Bracket Nut	30 N·m (22 Ft. Lbs.)	-
4	Halfshaft Hub Nut	310 N·m (229 Ft. Lbs.)	If removed, NEW nut must be installed and tightened to

7	Spring Link Nut (With Cam)	180 N·m (133 Ft. Lbs.)	Fastener must be torqued with the vehicle at normal ride height.
8	Spring Link Bolt (Without Cam)	180 N·m (133 Ft. Lbs.)	Fastener must be torqued with the vehicle at normal ride height.

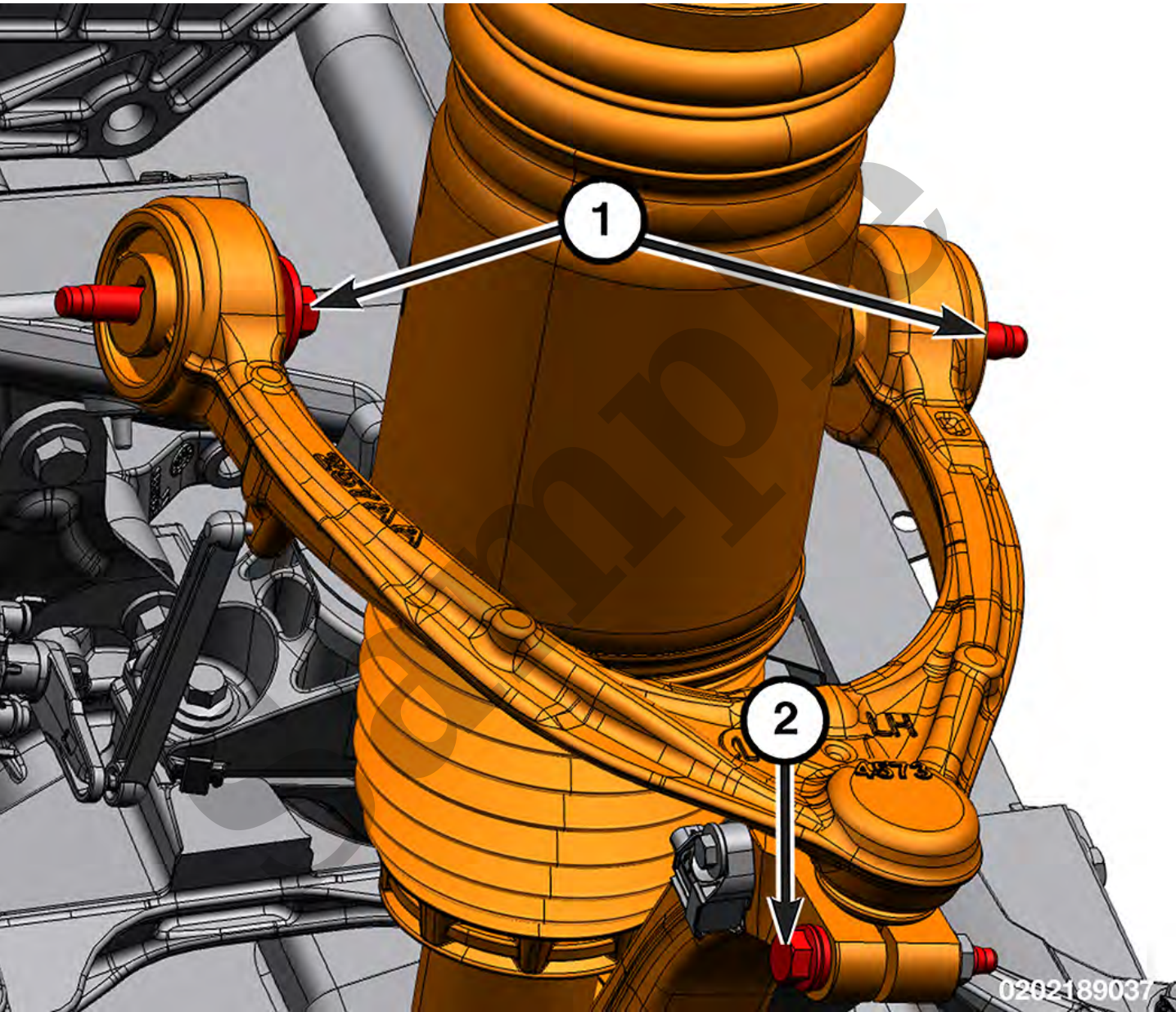

CALLOUT	DESCRIPTION	SPECIFICATION	COMMENT
1	Upper Control Arm Bolts	90 N·m (66 Ft. Lbs.)	Fastener must be torqued with the vehicle at normal ride height.

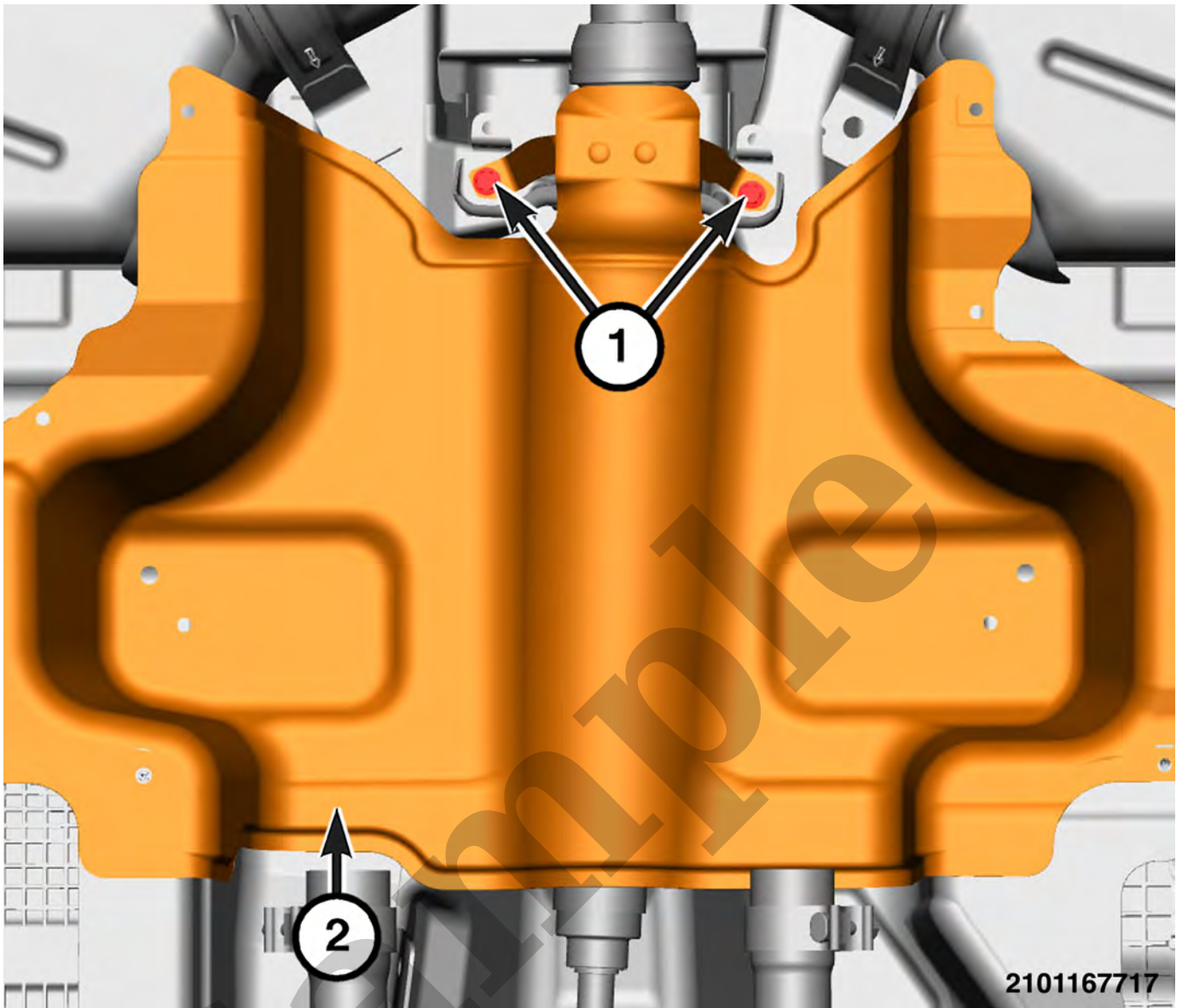

1 - Rear Driveshaft Center Support Bearing Bolts
2 - Exhaust Heat Shield

6. Mark the center support bearing for reassembly alignment. The bearing can rotate 180° when removed and not fit properly during re-installation.
7. Remove and **DISCARD** the rear driveshaft center support bearing bolts and remove the exhaust heat shield.

- During installation of the rear driveshaft, align the marks created on the rear driveshaft with the marks on the output flanges and center support bearing.

NOTE

If a new driveshaft is being installed, align the paint mark on the new driveshaft with the paint mark on the transfer case and axle flanges if they are still visible.

- Install **NEW** center support bearings and driveshaft bolts.
- Install the center bearing in the correct orientation. Failure to do so can create a vibration while driving the vehicle and subsequent damage to the drivetrain components.

TORQUE SPECIFICATIONS - DRIVESHAFTS

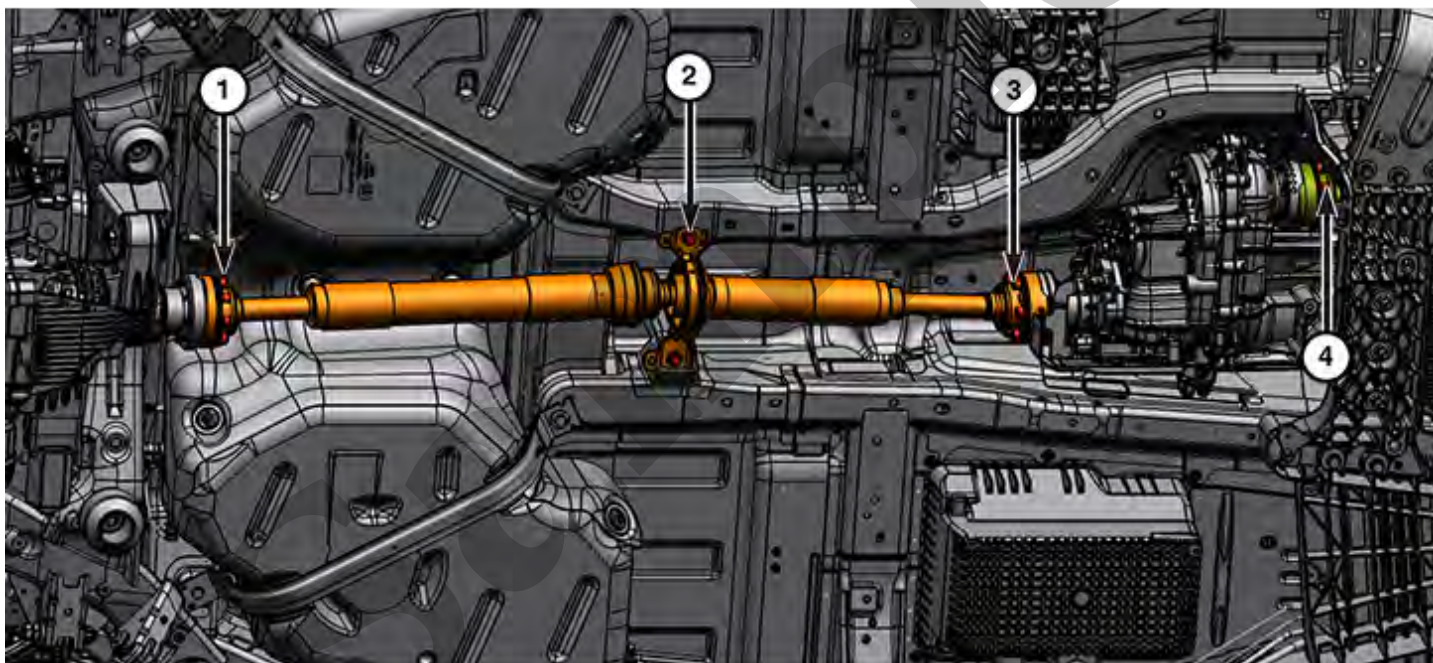

0305191835

CALLOUT	DESCRIPTION	SPECIFICATION	COMMENTS
1	Rear Driveshaft to Rear Pinion Flange Bolts	56 N·m (41 Ft. Lbs.)	If removed, NEW bolts must be installed and tightened to specifications
2	Rear Driveshaft Center Support Bearing Bolts	55 N·m (41 Ft. Lbs.)	If removed, NEW bolts must be installed and tightened to specifications