

Your Ultimate Source for OEM Repair Manuals

FactoryManuals.net is a great resource for anyone who wants to save money on repairs by doing their own work. The manuals provide detailed instructions and diagrams that make it easy to understand how to fix a vehicle.

2007 Jeep LIBERTY Service Manual

[Go to manual page](#)

Follow the removal procedure in reverse for general reassembly of the components on the vehicle. The steps listed below are calling out specific procedures that should be followed during installation.

- Tighten the fasteners securely.

Sample

YOUR CURRENT VEHICLE

Electronic Limited Slip Differential (ELSD) Motor - 230RIA

ELECTRONIC LIMITED SLIP DIFFERENTIAL (ELSD) MOTOR - 230RIA

REMOVAL

1. Raise and support the vehicle ([Refer to Vehicle Quick Reference/Hoisting/Standard Procedure](#)).

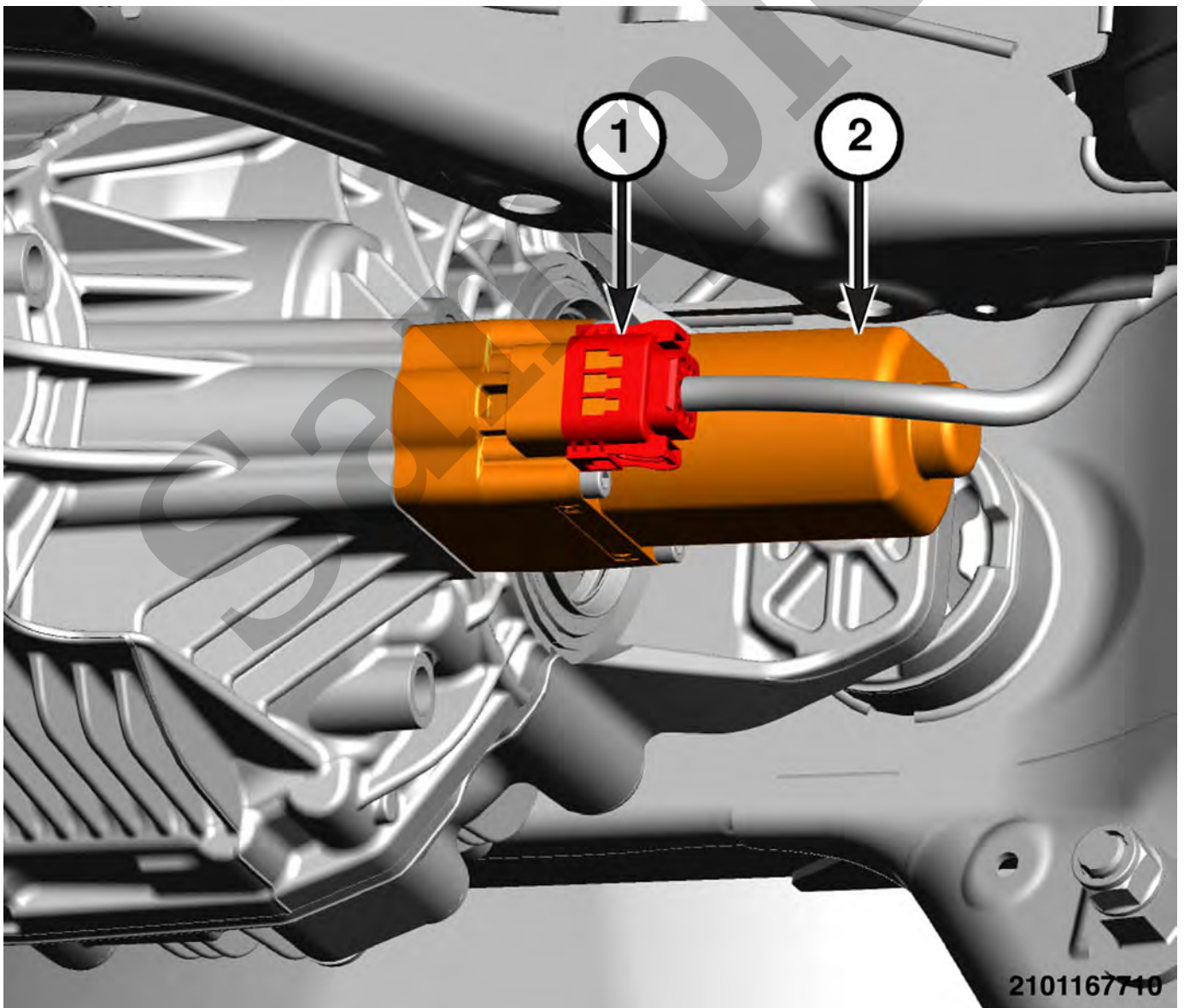

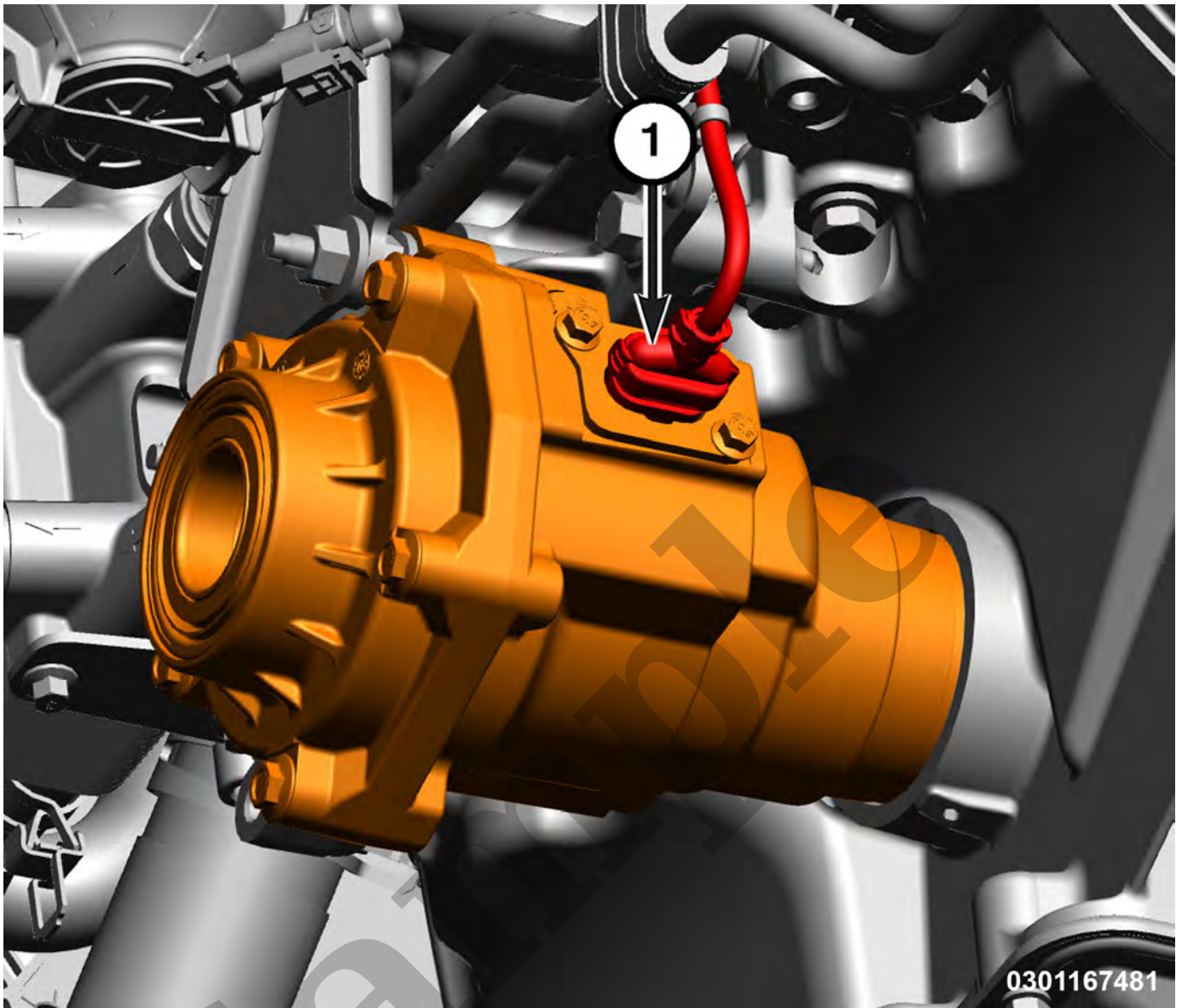

1 - Wire Harness Connector

5. Disconnect the Front Axle Disconnect (FAD) wire harness connector.

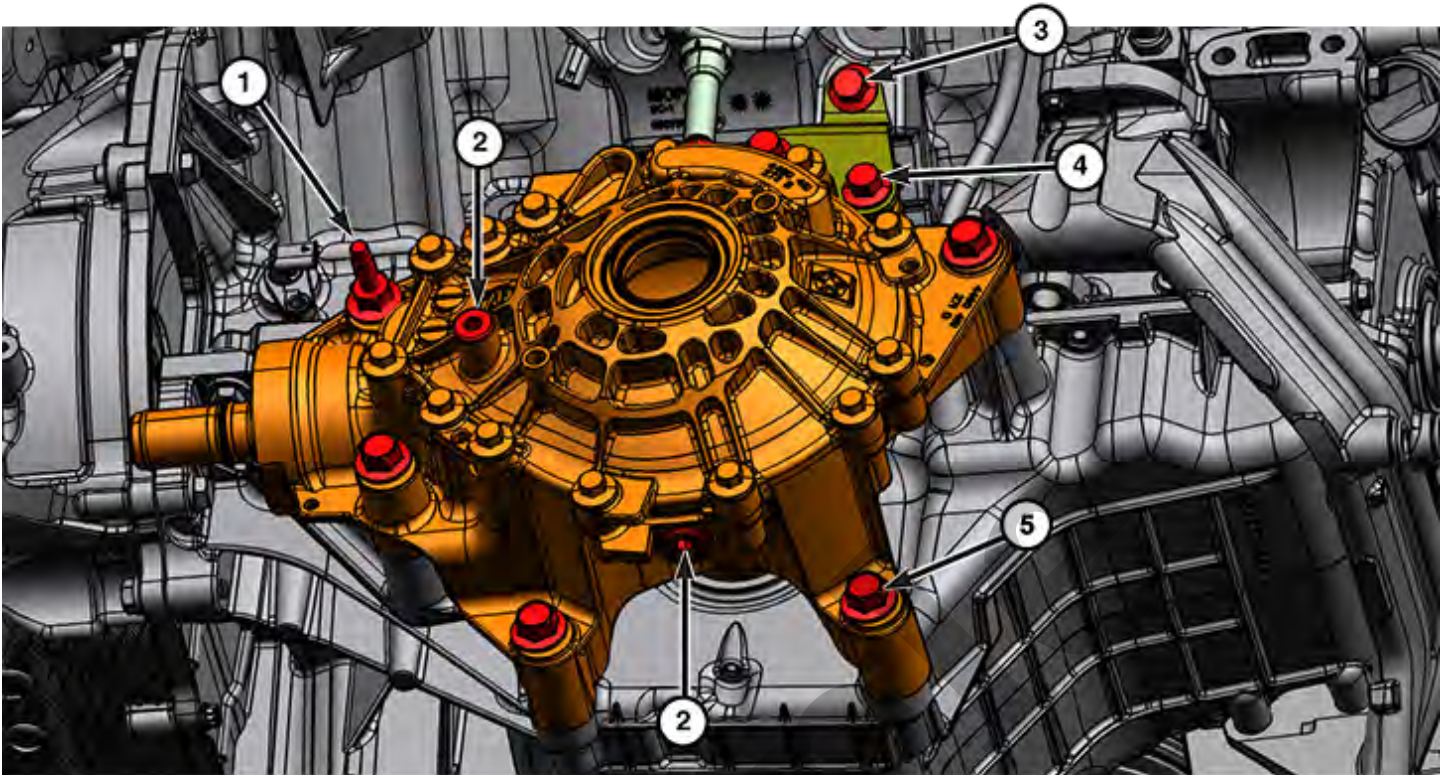

0305191832

CALLOUT	DESCRIPTION	SPECIFICATION	COMMENTS
1	Front Axle to Engine Stud Bolt	Torque Procedure 1. 35 N·m (26 Ft. Lbs.) 2. + 115°	-
2	Drain and Fill Plugs	35 N·m (26 Ft. Lbs.)	-
3	Front Axle Support Bracket Bolts to Engine	55 N·m (41 Ft. Lbs.)	-
4	Front Axle Support Bracket Bolts to PDU	55 N·m (41 Ft. Lbs.)	-
5	Front Axle to Engine Bolts	Torque Procedure 1. 35 N·m (26 Ft. Lbs.) 2. + 115°	-
-	Differential Vent Fitting	15 N·m (11 In. Lbs.)	-

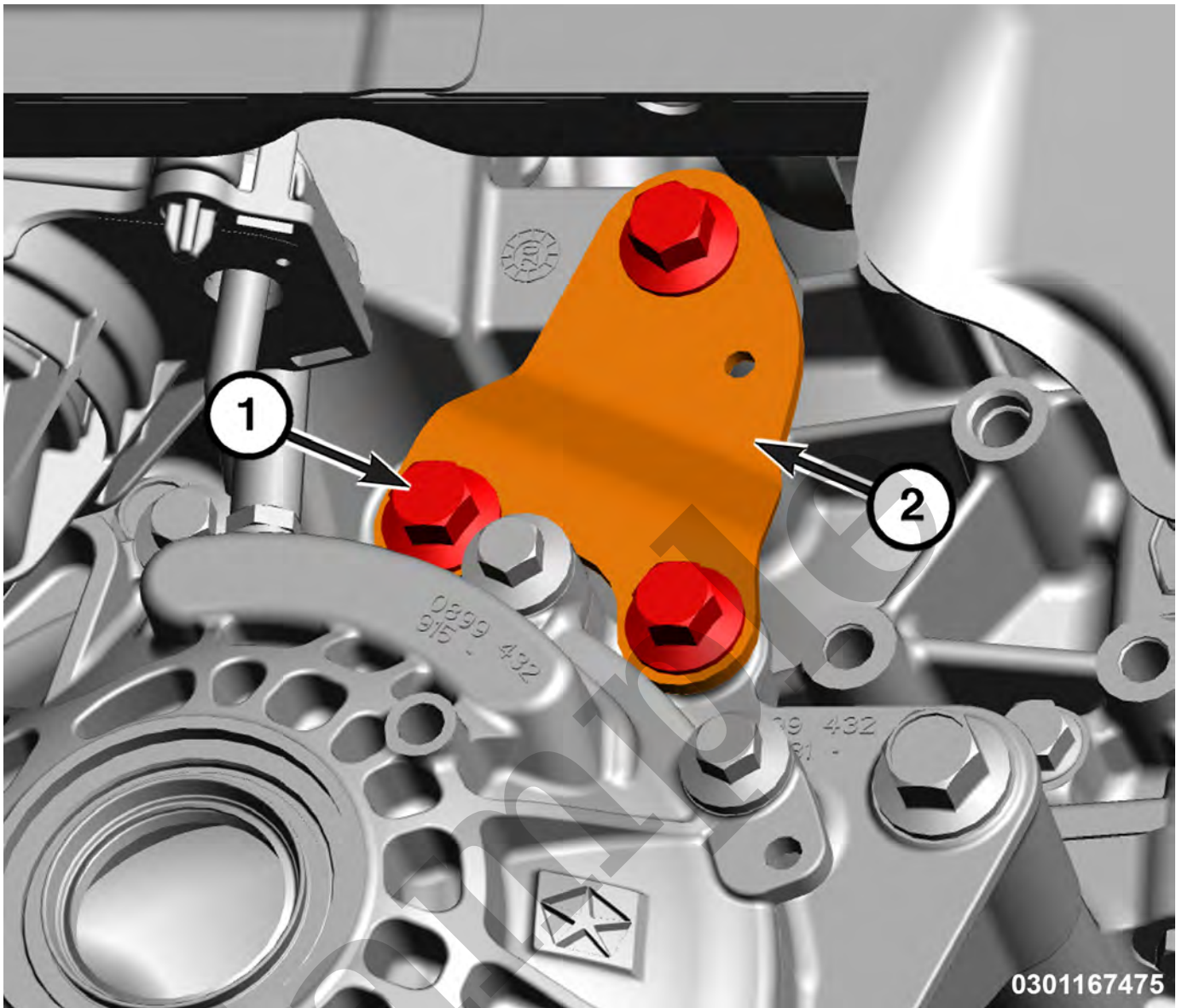

1 - Front Axle Bracket Bolts

2 - Front Axle Bracket

6. Remove the front axle bracket bolts and remove the front axle bracket.

TORQUE SPECIFICATIONS - FRONT AXLE - 195FIA

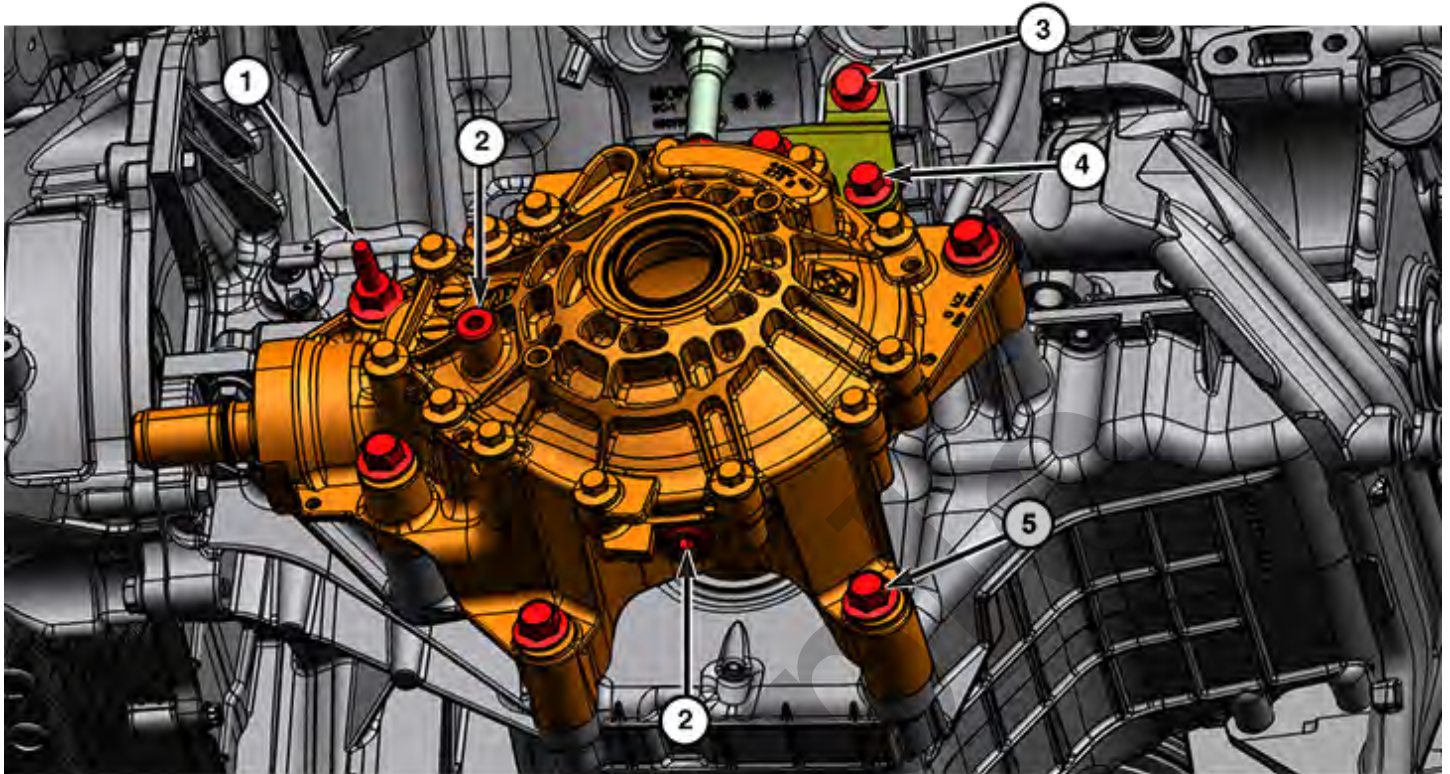

0305191832

CALLOUT	DESCRIPTION	SPECIFICATION	COMMENTS
1	Front Axle to Engine Stud Bolt	Torque Procedure 1. 35 N·m (26 Ft. Lbs.) 2. + 115°	-
2	Drain and Fill Plugs	35 N·m (26 Ft. Lbs.)	-
3	Front Axle Support Bracket Bolts to Engine	55 N·m (41 Ft. Lbs.)	-
4	Front Axle Support Bracket Bolts to PDU	55 N·m (41 Ft. Lbs.)	-
5	Front Axle to Engine Bolts	Torque Procedure 1. 35 N·m (26 Ft. Lbs.) 2. + 115°	-
-	Differential Vent Fitting	15 N·m (11 In. Lbs.)	-

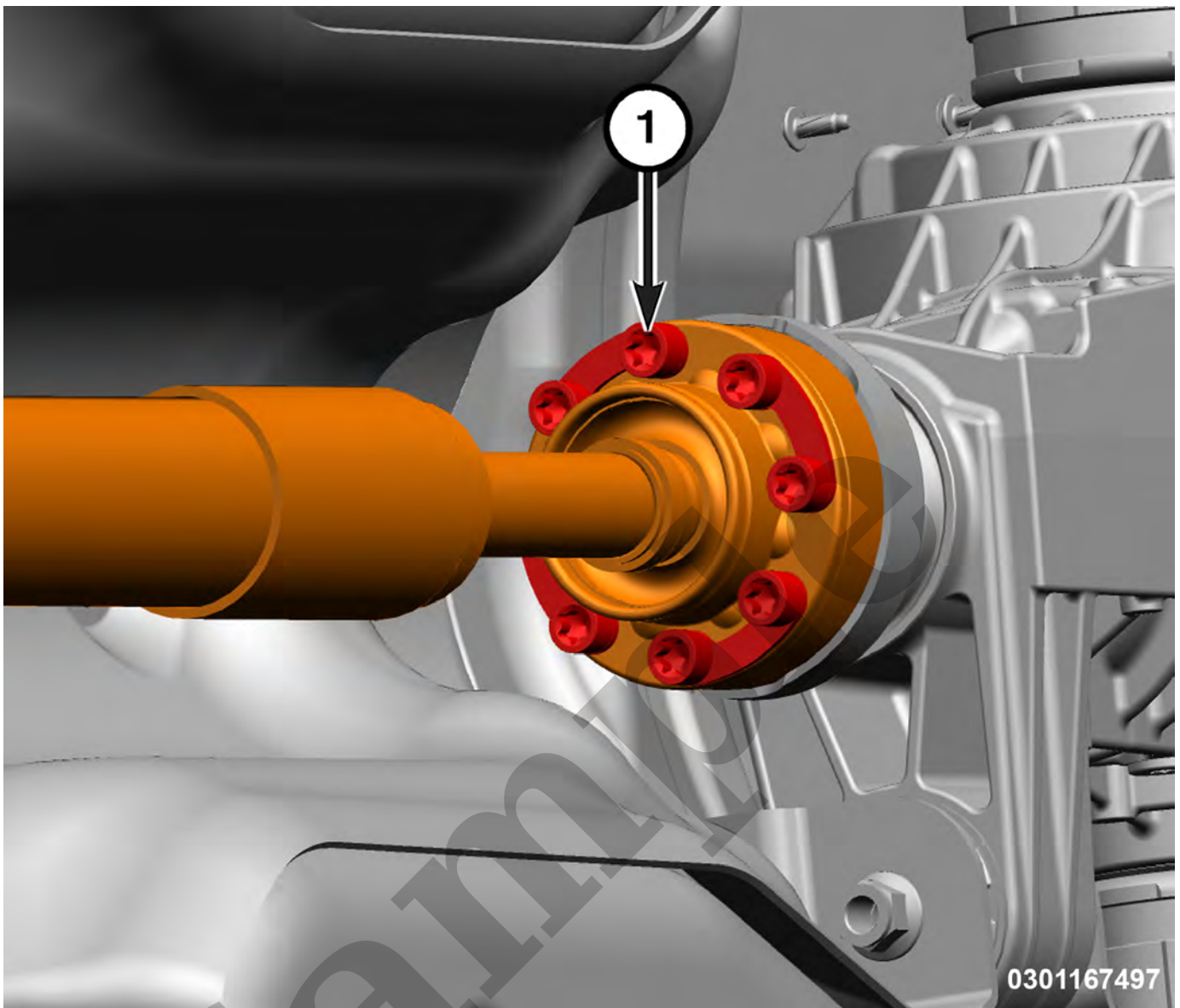

1 - Rear Driveshaft to Rear Pinion Flange Bolts

4. Remove and **DISCARD** the driveshaft to rear pinion flange bolts, secure and position the driveshaft aside.
5. Remove the right rear halfshaft ([Refer to Differential and Driveline/SHAFTS, Axle/Drive/Half/Removal and Installation](#)).

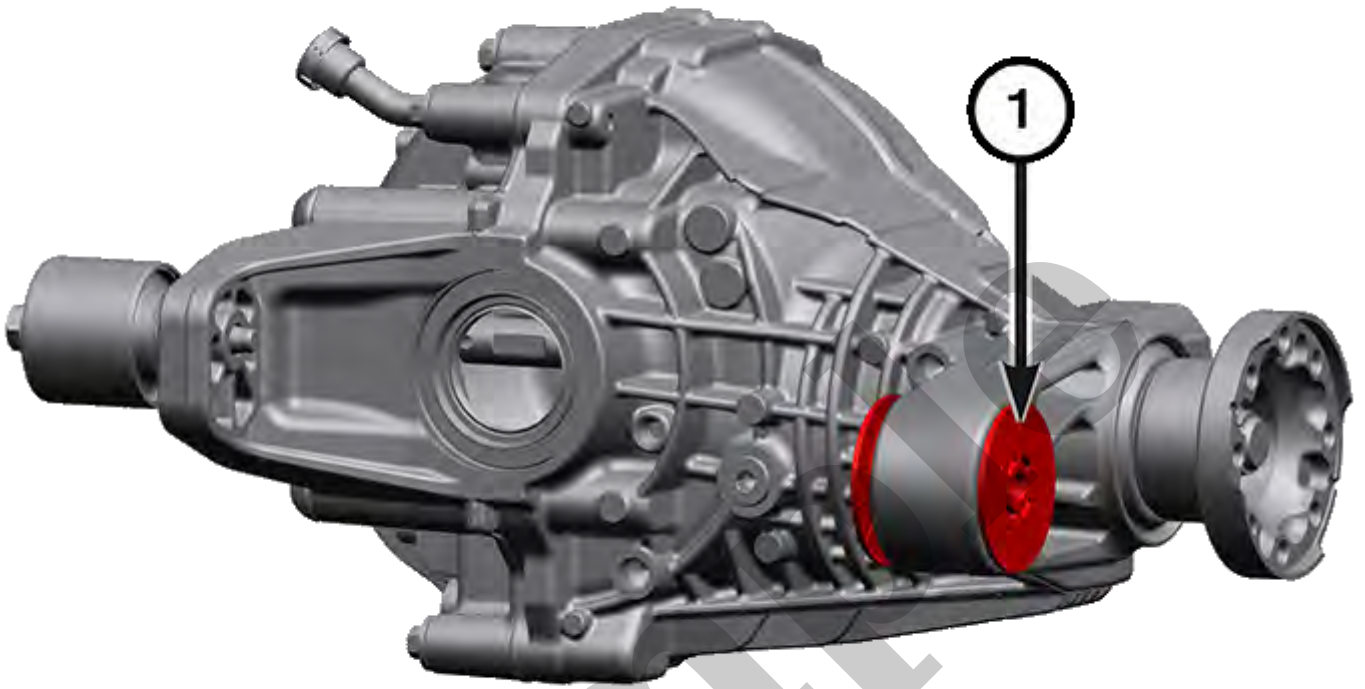

0327156508

1 - Front Bushing

- If installing a replacement axle, install **NEW** front bushing in axle housing using Kit, Forcing Screw-7/16"

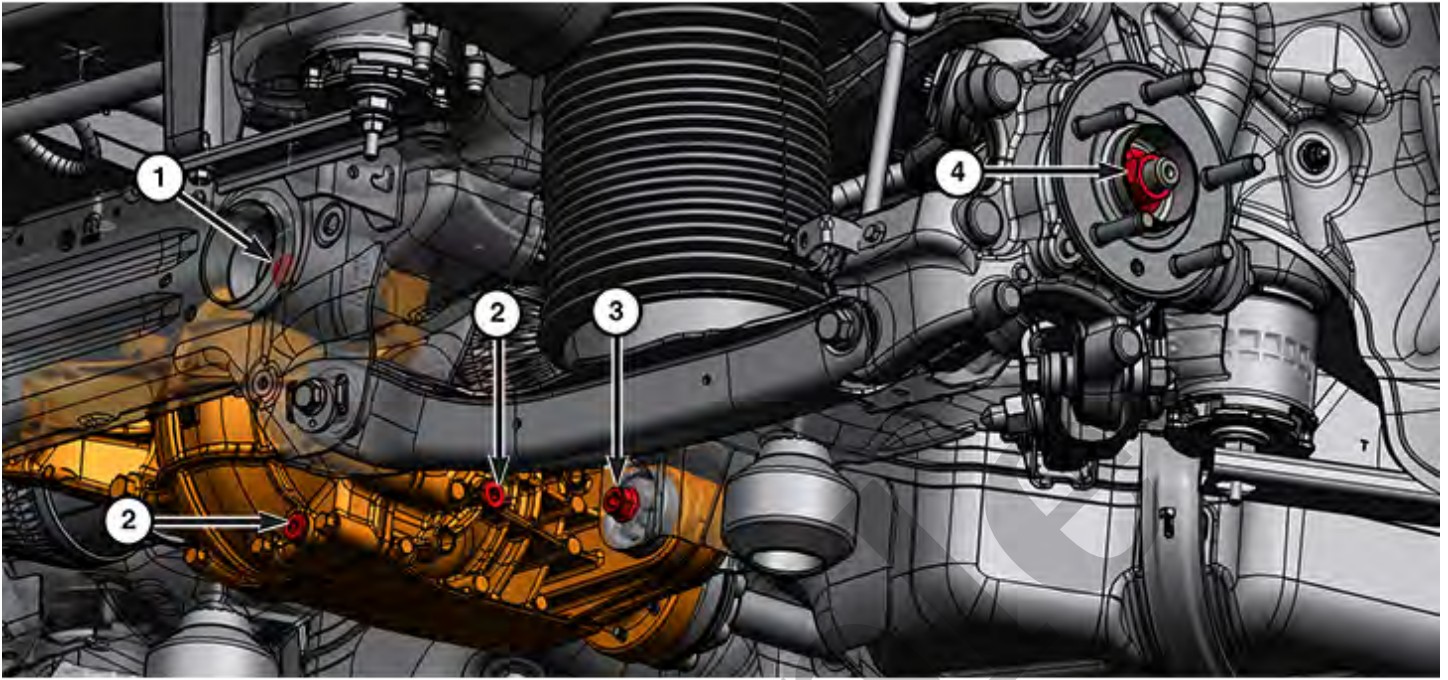

0305191833

CALLOUT	DESCRIPTION	SPECIFICATION	COMMENTS
1	Rear Axle to Crossmember Bolts	115 N·m (85 Ft. Lbs.)	-
2	Drain and Fill Plugs	35 N·m (26 Ft. Lbs.)	-
3	Rear Axle Forward Pinion Mount Bolt and Nut	90 N·m (66 Ft. Lbs.)	-
4	Halfshaft Hub Nut	310 N·m (229 Ft. Lbs.)	Do not reuse these fasteners. If removed, a new fastener must be installed and tightened to specifications

TORQUE SPECIFICATIONS - DRIVESHAFTS