

Your Ultimate Source for OEM Repair Manuals

FactoryManuals.net is a great resource for anyone who wants to save money on repairs by doing their own work. The manuals provide detailed instructions and diagrams that make it easy to understand how to fix a vehicle.

2007 FORD Mustang OEM Service and Repair Workshop Manual

[Go to manual page](#)

Release the clips and remove the upper centerstack bezel.

Use the General Equipment: Interior Trim Remover

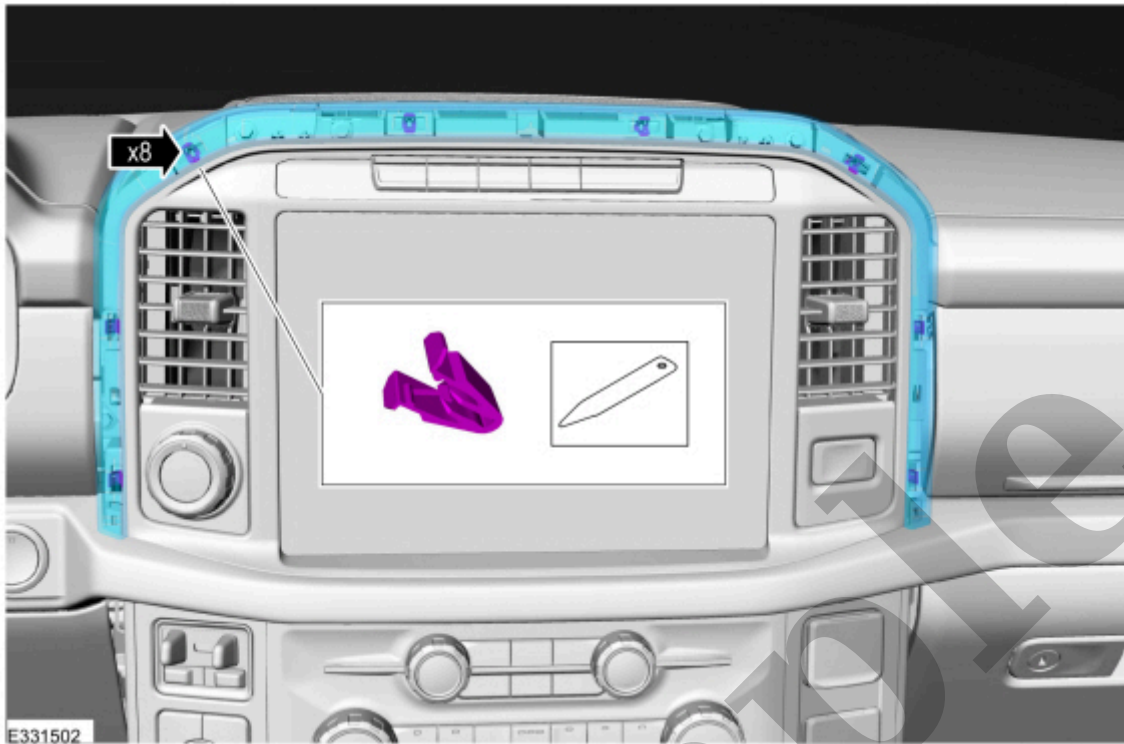

[Click here to learn about symbols, color coding, and icons used in this manual.](#)

Vehicles equipped with an instrument panel center speaker

3. Remove the instrument panel center speaker.

Refer to: [Instrument Panel Center Speaker - Vehicles With: 8 Inch Center Display Screen/12 Inch Center Display Screen](#)(415-00 Information and Entertainment System - General Information, Removal and Installation).

4. Remove the screws, release the clips and remove the instrument panel center speaker mounting plate.

6. Remove the screws, release the clips and remove the upper instrument panel tray.

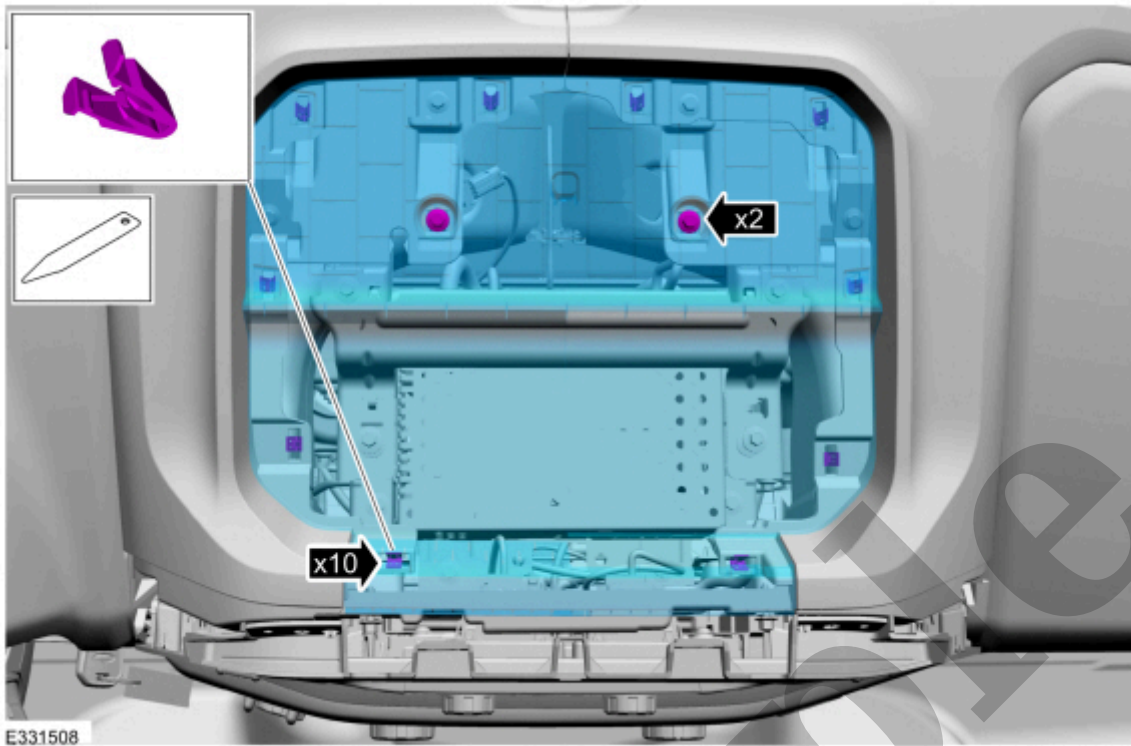

[Click here to learn about symbols, color coding, and icons used in this manual.](#)

All vehicles

7. Remove the bolts and the bracket.

Torque : 55 lb.in (6.2 Nm)

Installation

1. To install, reverse the removal procedure.

2. **NOTE**

This step is only necessary if replacing the component.

Using a diagnostic scan tool, complete the PMI (programmable module installation) process for the ACM (audio front control module) following the on-screen instructions.

Copyright © Ford Motor Company

Sample

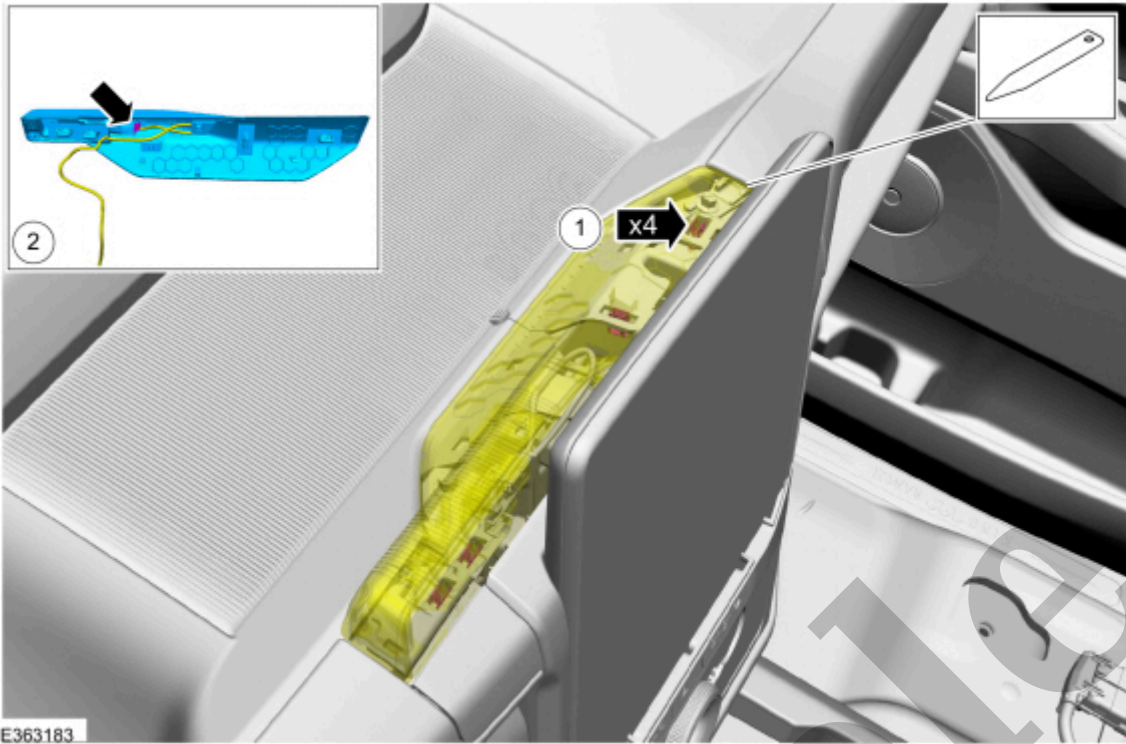

[Click here to learn about symbols, color coding, and icons used in this manual.](#)

2. Remove the bolts.

Torque : 106 lb.in (12 Nm)



[Click here to learn about symbols, color coding, and icons used in this manual.](#)

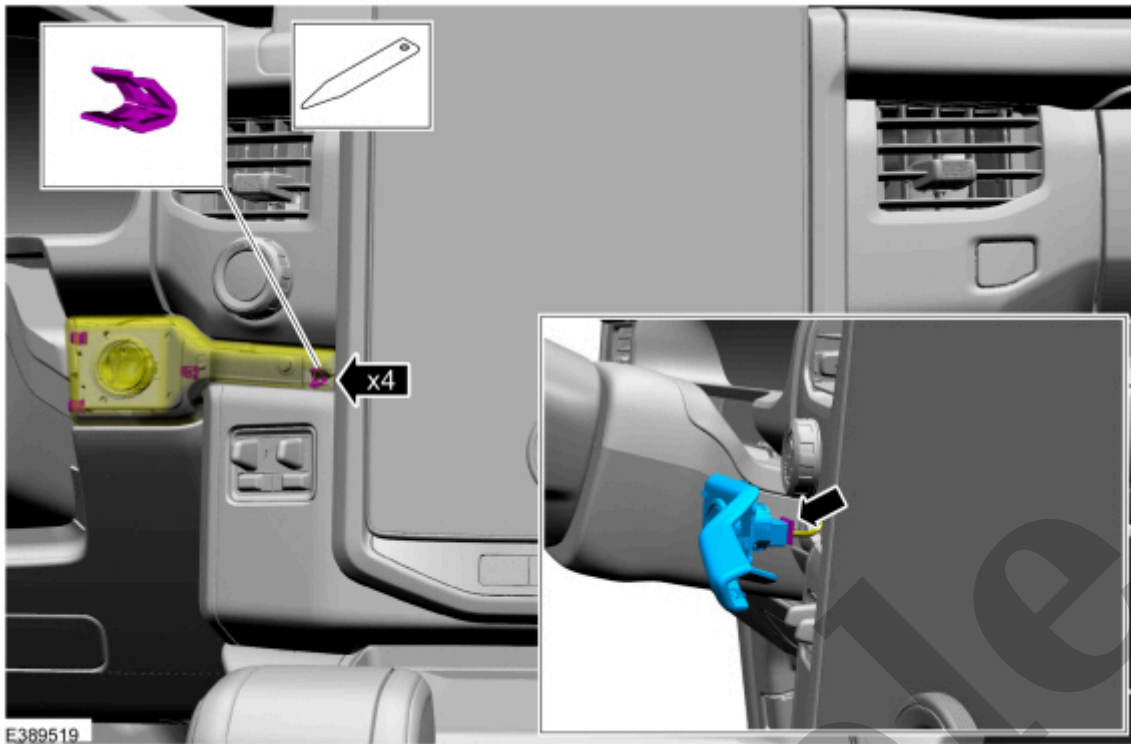

[Click here to learn about symbols, color coding, and icons used in this manual.](#)

5. Remove the screws.

Torque : 22 lb.in (2.5 Nm)



[Click here to learn about symbols, color coding, and icons used in this manual.](#)

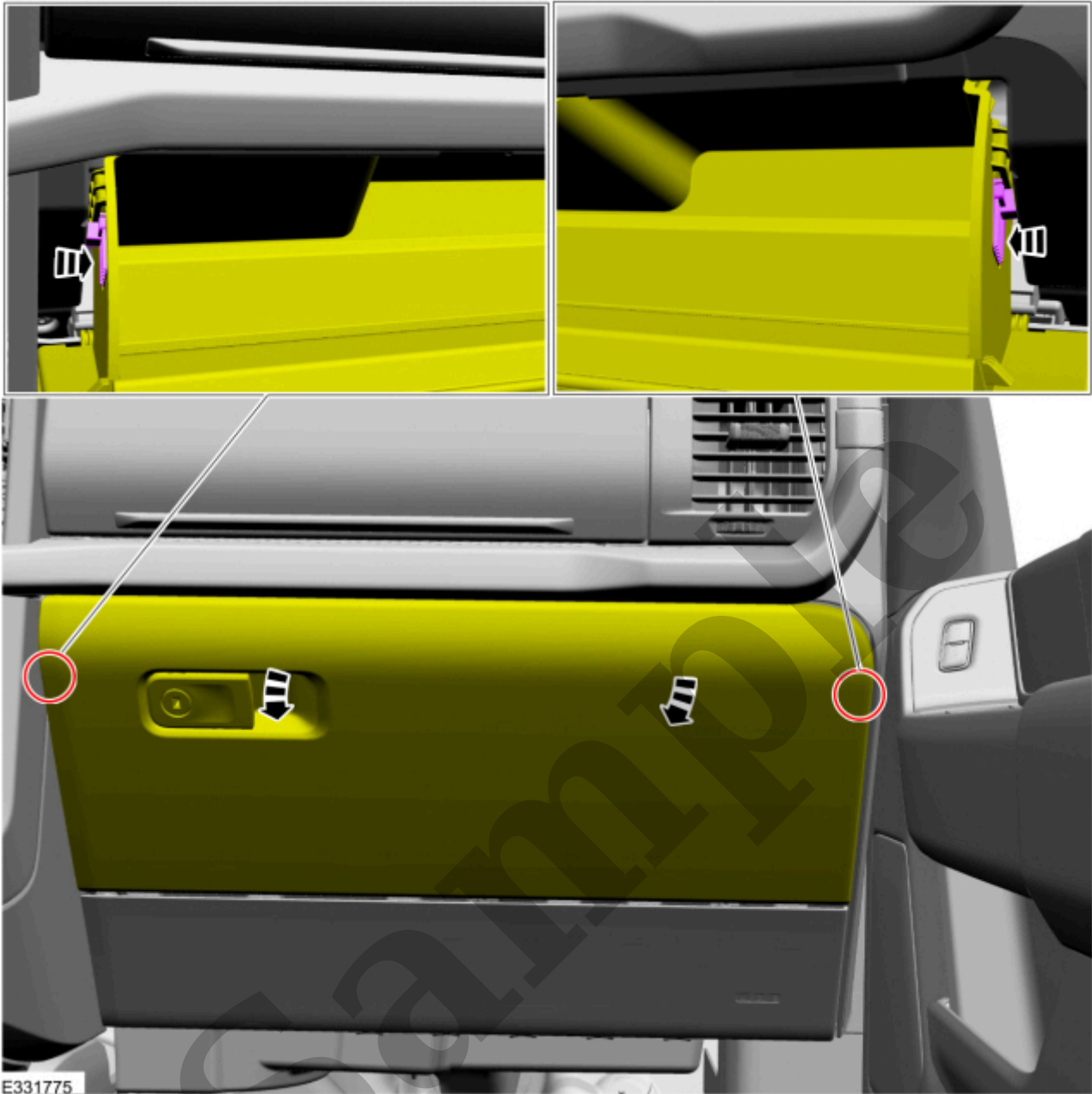

[Click here to learn about symbols, color coding, and icons used in this manual.](#)

8. Disconnect the audio unit antenna cable connector.

1. To install, reverse the removal procedure.

Copyright © Ford Motor Company

Sample

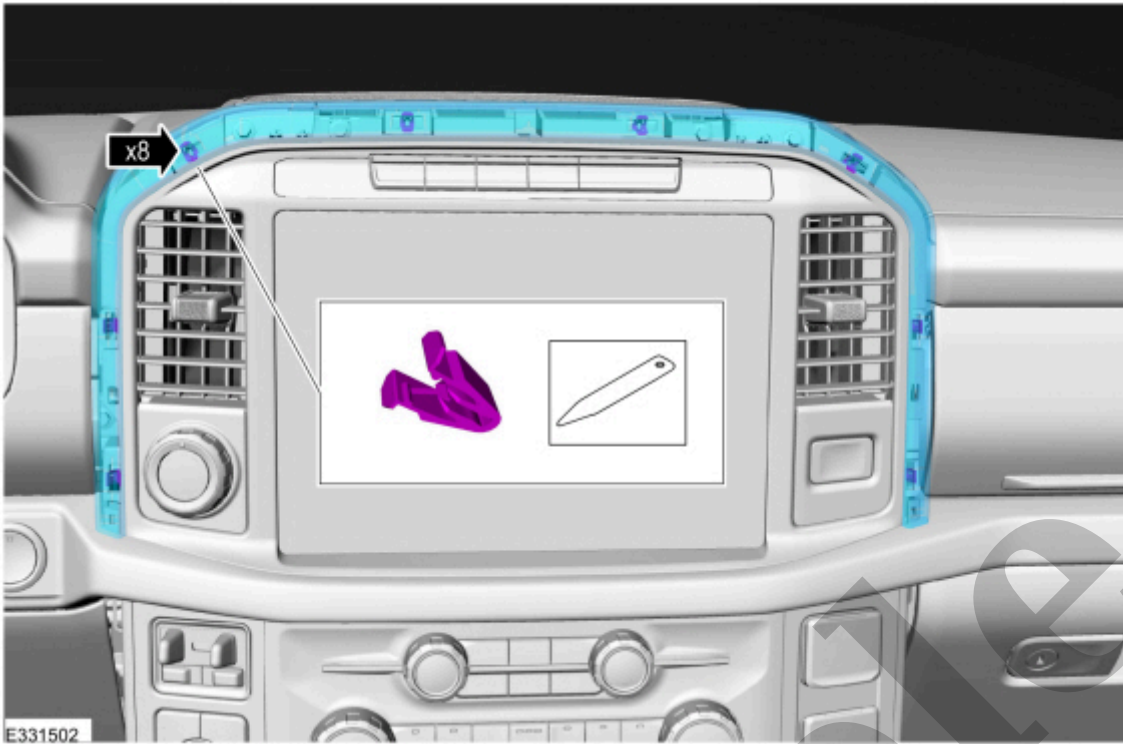

[Click here to learn about symbols, color coding, and icons used in this manual.](#)

2. Release the clips and remove the RH (right-hand) instrument center trim panel.

- On vehicles equipped with push button start disconnect the electrical connector.

Use the General Equipment: Interior Trim Remover

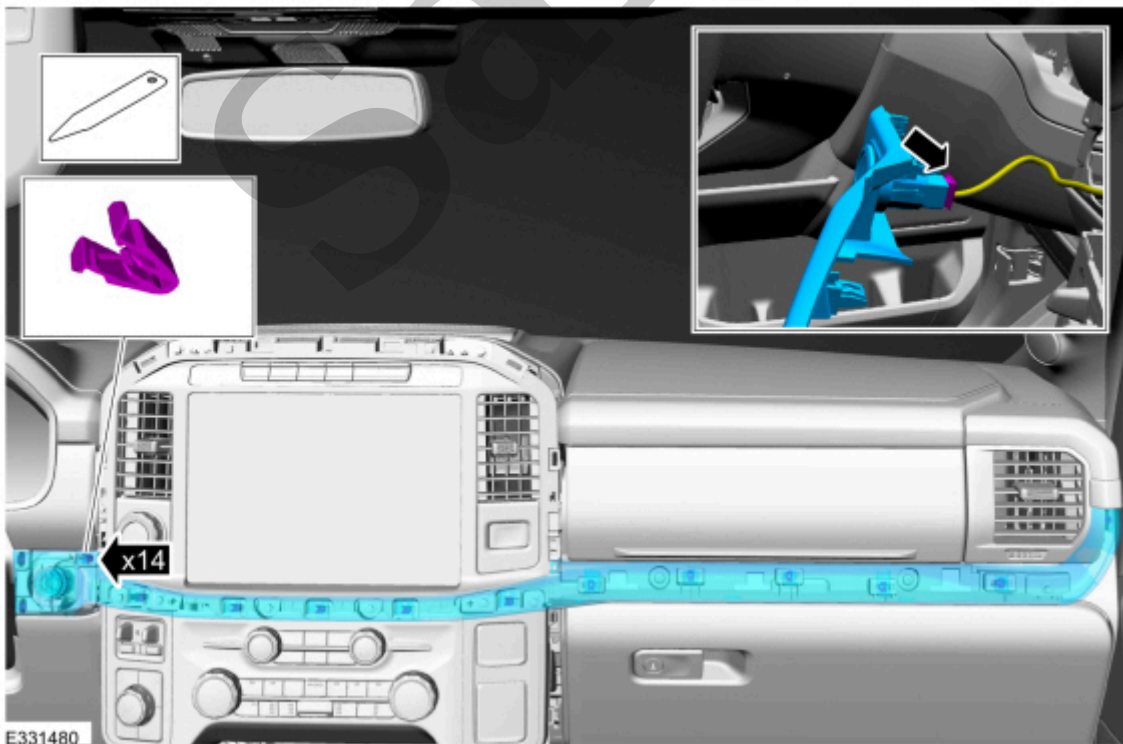

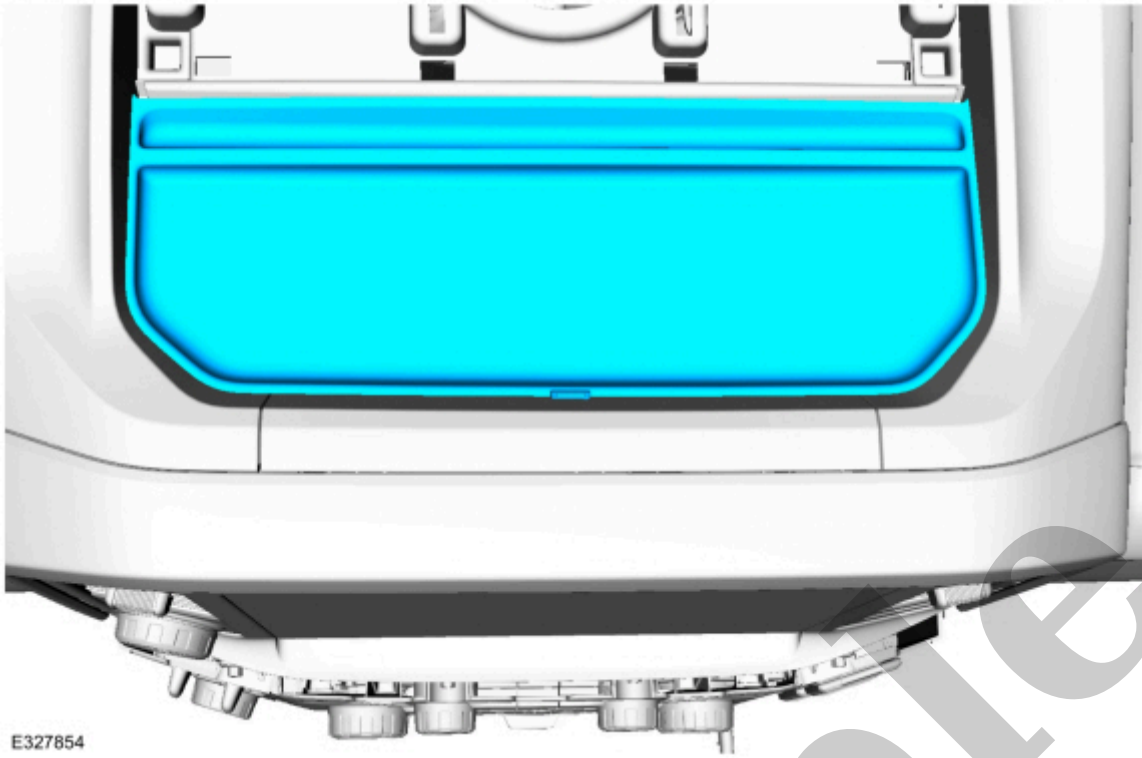

E327854

[Click here to learn about symbols, color coding, and icons used in this manual.](#)

5. Remove the bolts, release the clips and remove the trim panel.

- If equipped.

Disconnect the electrical connector.

Torque : 22 lb.in (2.5 Nm)