

# Your Ultimate Source for OEM Repair Manuals

FactoryManuals.net is a great resource for anyone who wants to save money on repairs by doing their own work. The manuals provide detailed instructions and diagrams that make it easy to understand how to fix a vehicle.

## 2006 MAZDA B Series / Bravo Freestyle Cab OEM Service and Repair Workshop Manual

[Go to manual page](#)

3	Upper mount rubber
4	Radiator (See <a href="#">Radiator Removal Note.</a> )
5	Lower mount rubber

## Upper Mount Rubber Bracket Removal Note

### Caution

- To prevent damage to the upper mount rubber bracket tab, do not apply excessive force.

1.While pressing down the upper mount rubber bracket tab lightly in the direction of the arrow shown in the figure, pull out the upper mount rubber bracket toward the vehicle rear.

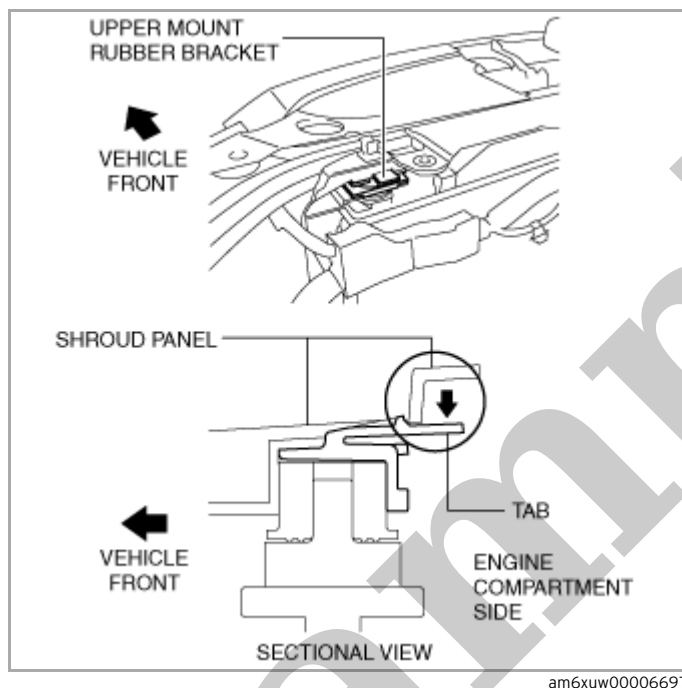

2.Remove the upper mount rubber bracket.

## Radiator Removal Note

1.Remove the wiring harness clips shown in the figure.

# COOLING SYSTEM CAP INSPECTION [SKYACTIV-G 2.5T]

SM2897320

id0112q580150

## Warning

- Never remove the cooling system cap or loosen the radiator drain plug while the engine is running, or when the engine and radiator are hot. Scalding engine coolant and steam may shoot out and cause serious injury. It may also damage the engine and cooling system.
- Turn off the engine and wait until it is cool. Even then, be very careful when removing the cap. Wrap a thick cloth around it and slowly turn it counterclockwise to the first stop. Step back while the pressure escapes.
- When you are sure all the pressure is gone, press down on the cap using the cloth, turn it, and remove it.

1. Clean the cooling system cap and the sealed part.

2. Inspect the cooling system cap for cracks or everted seal.

- If there is any malfunction, replace the cooling system cap.

3. Attach the cooling system cap to the radiator cap tester.

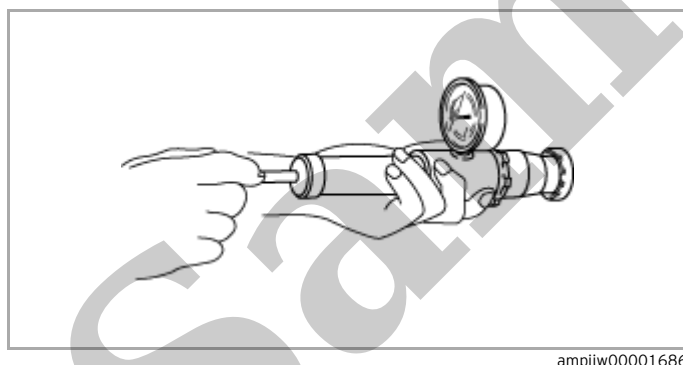

ampjjw00001686

4. Hold the cooling system cap downward and apply pressure gradually. Verify that the pressure is held stable for 10 s.

- If the pressure is not held stable, replace the cooling system cap.

## Cooling system cap valve opening pressure

93.2–122.6 kPa {0.951–1.250 kgf/cm<sup>2</sup>, 13.6–17.7 psi}

7. Disconnect the upper radiator hose shown in the figure.

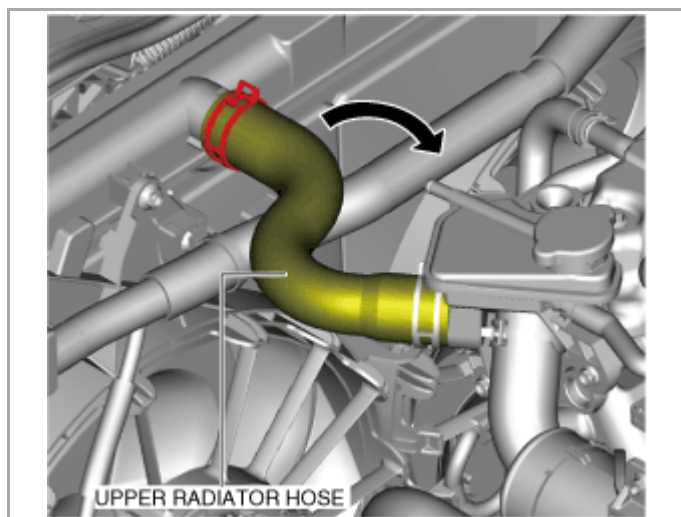

ac5uuw00010854

8. Remove the oil hose clip from the cooling fan component. (If equipped)

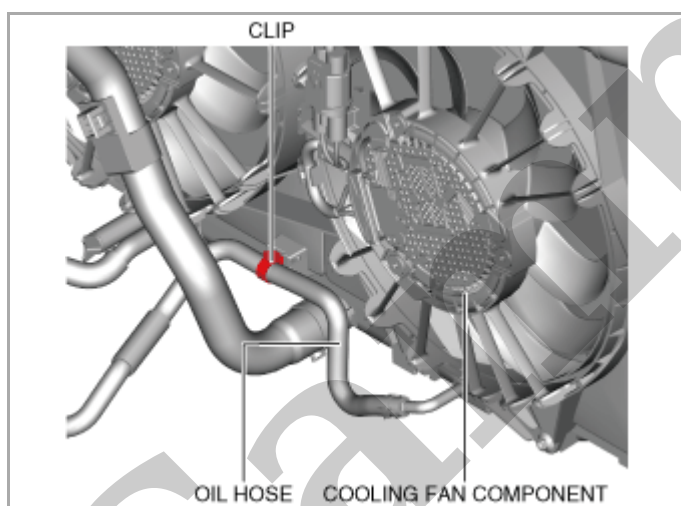

ac5uuw00010544

9. Remove in the order indicated in the table.

10. Install in the reverse order of removal.

11. Refill the engine coolant. (See [ENGINE COOLANT REPLACEMENT \[SKYACTIV-G 2.5T\].](#))

12. Inspect for engine coolant leakage. (See [ENGINE COOLANT LEAKAGE INSPECTION \[SKYACTIV-G 2.5T\].](#))

# THERMOSTAT REMOVAL/INSTALLATION [SKYACTIV-D 2.2]

SM2897332

id0112s680120

## Warning

- Never remove the cooling system cap or loosen the radiator drain plug while the engine is running, or when the engine and radiator are hot. Scalding engine coolant and steam may shoot out and cause serious injury. It may also damage the engine and cooling system.
- Turn off the engine and wait until it is cool. Even then, be very careful when removing the cap. Wrap a thick cloth around it and slowly turn it counterclockwise to the first stop. Step back while the pressure escapes.
- When you are sure all the pressure is gone, press down on the cap using the cloth, turn it, and remove it.

1. Disconnect the negative battery cable. (See [NEGATIVE BATTERY TERMINAL DISCONNECTION/CONNECTION.](#))

2. Remove the engine cover. (See [ENGINE COVER REMOVAL/INSTALLATION \[SKYACTIV-D 2.2\].](#))

3. Remove the front under cover No.2. (See [FRONT UNDER COVER No.2 REMOVAL/INSTALLATION.](#))

4. Drain the engine coolant. (See [ENGINE COOLANT REPLACEMENT \[SKYACTIV-D 2.2\].](#))

5. Disconnect generator terminal B and set the wiring harness aside. (See [GENERATOR REMOVAL/INSTALLATION \[SKYACTIV-D 2.2\].](#))

6. Remove in the order indicated in the table.

7. Install in the reverse order of removal.

8. Refill the engine coolant. (See [ENGINE COOLANT REPLACEMENT \[SKYACTIV-D 2.2\].](#))

9. Inspect for the engine coolant leakage. (See [ENGINE COOLANT LEAKAGE INSPECTION \[SKYACTIV-D 2.2\].](#))

- The tightening order for the two bolts is optional.

#### Tightening torque

9–12 N·m {92–122 kgf·cm, 80–106 in·lbf}

(3) Finally, tighten the bolt shown in the figure to the specified torque.

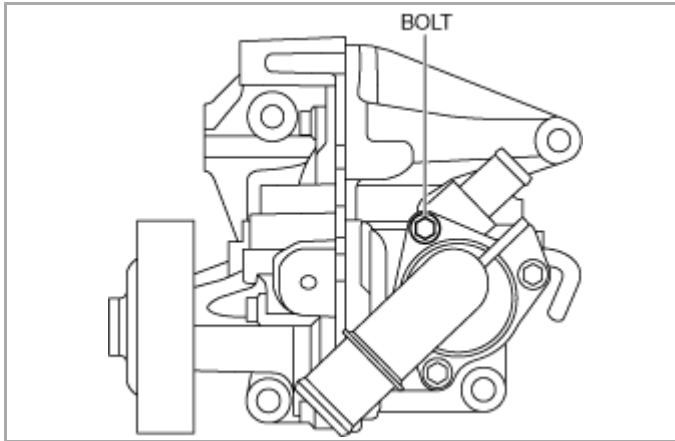

ac5wzw00004881

#### Tightening torque

9–12 N·m {92–122 kgf·cm, 80–106 in·lbf}

13. Inspect for engine coolant leakage. (See [ENGINE COOLANT LEAKAGE INSPECTION \[SKYACTIV-D 2.2\].](#))
14. Inspect the ATF level. (if equipped) (See [AUTOMATIC TRANSAXLE FLUID \(ATF\) INSPECTION \[GW6A-EL, GW6AX-EL\].](#))

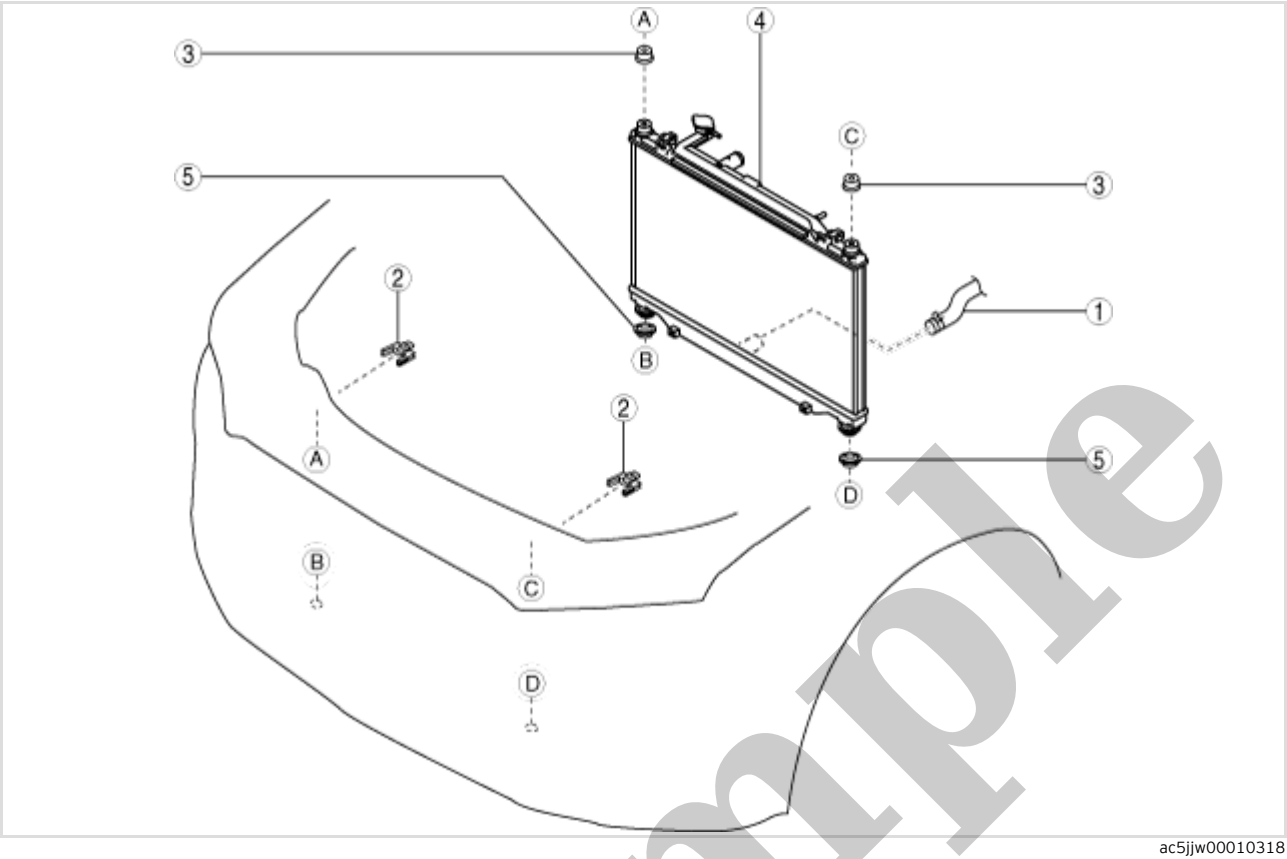

1	Lower radiator hose
2	Upper mount rubber bracket (See <a href="#">Upper Mount Rubber Bracket Removal Note.</a> )
3	Upper mount rubber
4	Radiator (See <a href="#">Radiator Removal Note.</a> )
5	Lower mount rubber

### Upper Mount Rubber Bracket Removal Note

**Caution**

- To prevent damage to the upper mount rubber bracket tab, do not apply excessive force.

1. While pressing down the upper mount rubber bracket tab lightly in the direction of the arrow shown in the figure, pull out the upper mount rubber bracket toward the vehicle rear.

# COOLING SYSTEM CAP INSPECTION [SKYACTIV-D 2.2]

SM2897335

id0112s680150

## Warning

- Never remove the cooling system cap or loosen the radiator drain plug while the engine is running, or when the engine and radiator are hot. Scalding engine coolant and steam may shoot out and cause serious injury. It may also damage the engine and cooling system.
- Turn off the engine and wait until it is cool. Even then, be very careful when removing the cap. Wrap a thick cloth around it and slowly turn it counterclockwise to the first stop. Step back while the pressure escapes.
- When you are sure all the pressure is gone, press down on the cap using the cloth, turn it, and remove it.

1. Clean the cooling system cap and the sealed part.

2. Inspect the cooling system cap for cracks or everted seal.

- If there is any malfunction, replace the cooling system cap.

3. Attach the cooling system cap to the radiator cap tester.

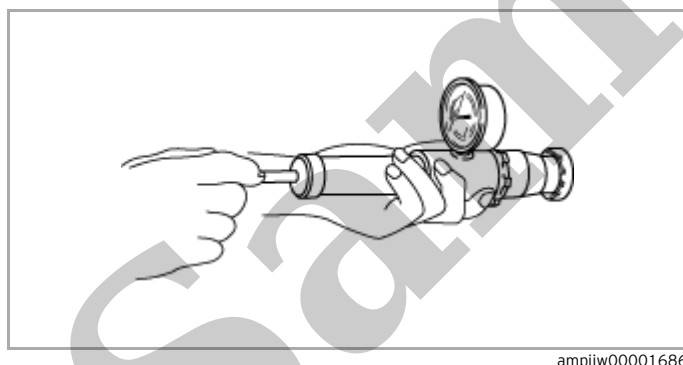

ampjjw00001686

4. Hold the cooling system cap downward and apply pressure gradually. Verify that the pressure is held stable for 10 s.

- If the pressure is not held stable, replace the cooling system cap.

## Cooling system cap valve opening pressure

93.2–122.6 kPa {0.951–1.250 kgf/cm<sup>2</sup>, 13.6–17.7 psi}

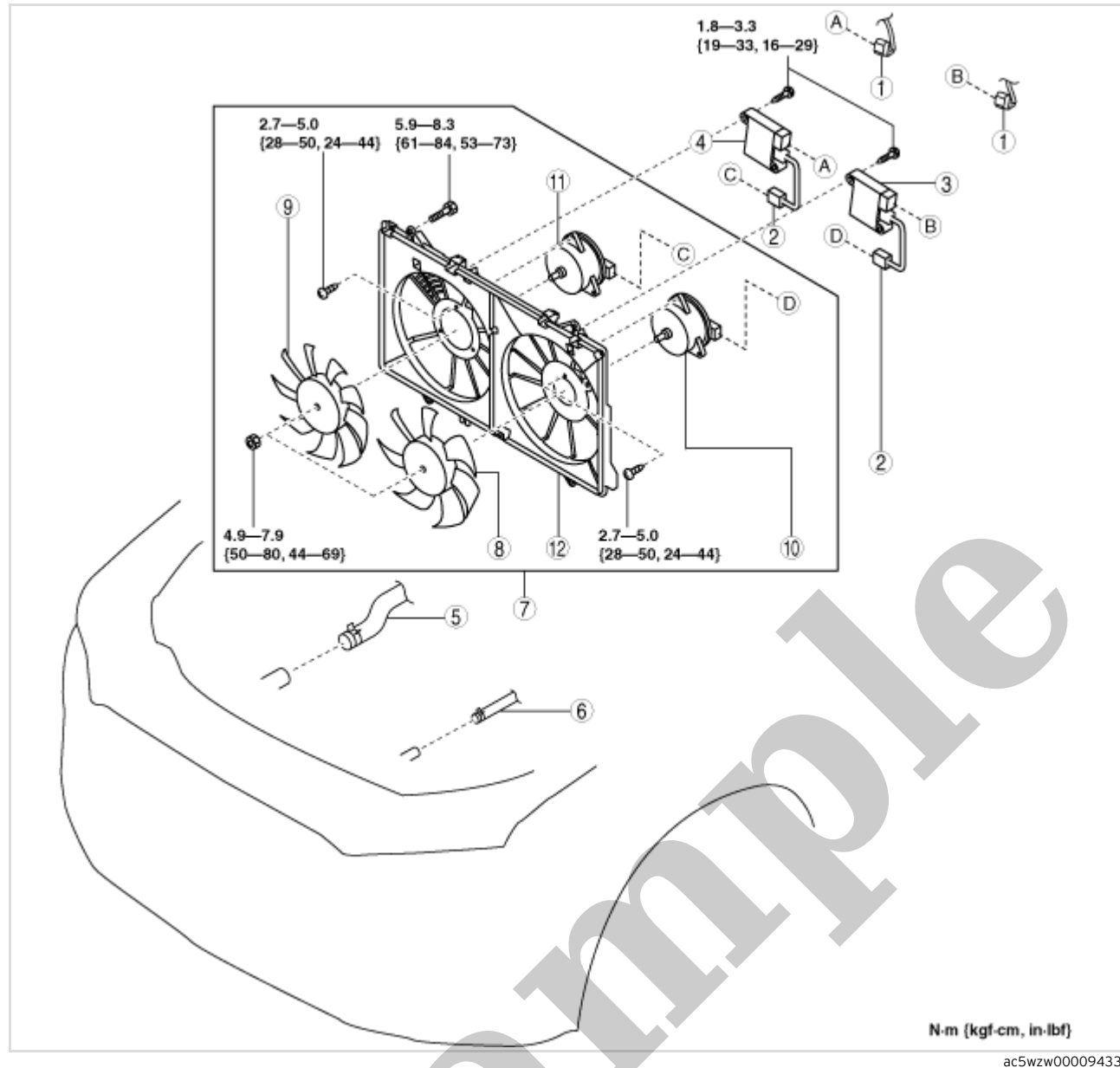

ac5wzw00009433

1	Fan control module connectors
2	Cooling fan motor connector
3	Fan control module No.1
4	Fan control module No.2
5	Upper radiator hose
6	Water hose
7	Cooling fan component (See <a href="#">Cooling Fan Component Removal Note.</a> )
8	Cooling fan No.1
9	Cooling fan No.2
10	Cooling fan motor No.1
11	Cooling fan motor No.2
12	Radiator cowling

## Cooling Fan Component Removal Note

1.Remove the wiring harness clips shown in the figure.

7	Cooling fan motor No.1 (See <a href="#">COOLING FAN MOTOR REMOVAL/INSTALLATION [SKYACTIV-D 2.2].</a> ) (See <a href="#">COOLING FAN MOTOR INSPECTION [SKYACTIV-D 2.2].</a> )
8	Radiator (See <a href="#">ENGINE COOLANT PROTECTION INSPECTION [SKYACTIV-D 2.2].</a> ) (See <a href="#">ENGINE COOLANT REPLACEMENT [SKYACTIV-D 2.2].</a> ) (See <a href="#">ENGINE COOLANT LEAKAGE INSPECTION [SKYACTIV-D 2.2].</a> ) (See <a href="#">RADIATOR REMOVAL/INSTALLATION [SKYACTIV-D 2.2].</a> )
9	Cooling system cap (See <a href="#">COOLING SYSTEM CAP INSPECTION [SKYACTIV-D 2.2].</a> )

Sample