

Your Ultimate Source for OEM Repair Manuals

FactoryManuals.net is a great resource for anyone who wants to save money on repairs by doing their own work. The manuals provide detailed instructions and diagrams that make it easy to understand how to fix a vehicle.

2006 MAZDA 6 MPS OEM Service and Repair Workshop Manual

[Go to manual page](#)

5	Oil strainer (See OIL PUMP REMOVAL/INSTALLATION [SKYACTIV-G 2.5 (WITHOUT CYLINDER DEACTIVATION)] .)
6	Oil pan (See OIL PAN REMOVAL/INSTALLATION [SKYACTIV-G 2.5 (WITHOUT CYLINDER DEACTIVATION)] .)
7	Oil filter (See OIL FILTER REPLACEMENT [SKYACTIV-G 2.5 (WITHOUT CYLINDER DEACTIVATION)] .)
8	Oil cooler (See OIL COOLER REMOVAL/INSTALLATION [SKYACTIV-G 2.5 (WITHOUT CYLINDER DEACTIVATION)] .)

Sample

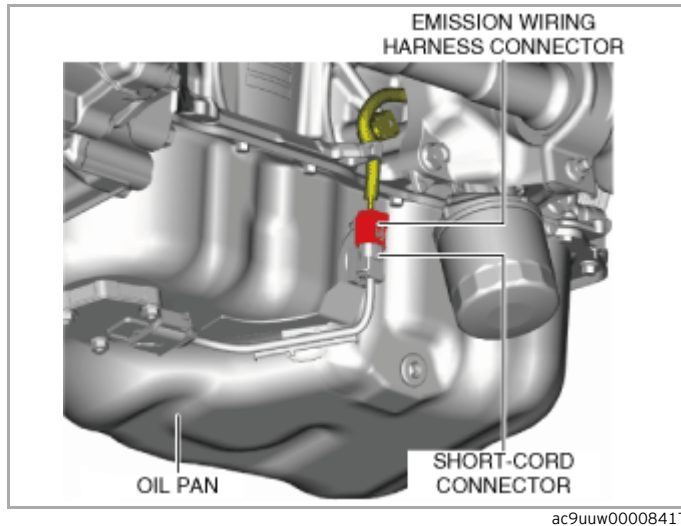

Oil Pan Removal Note

1. Remove the oil pan using a separator tool.

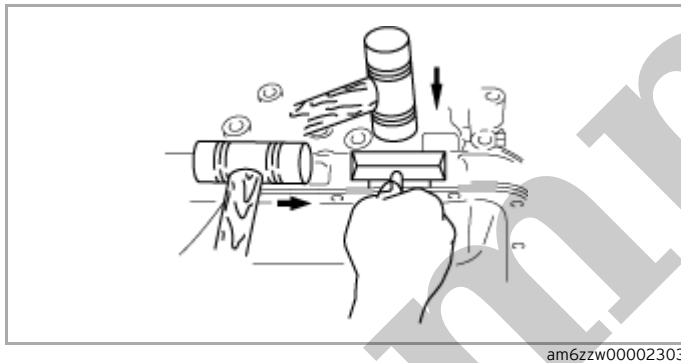

2. When replacing the oil pan, remove the short-cord. (With engine oil level sensor) (See [ENGINE OIL LEVEL SENSOR REMOVAL/INSTALLATION \[SKYACTIV-G 2.5 \(WITHOUT CYLINDER DEACTIVATION\)\]](#).)

Oil Pan Installation Note

1. When replacing the oil pan, install the short-cord and a new engine oil level sensor. (With engine oil level sensor) (See [ENGINE OIL LEVEL SENSOR REMOVAL/INSTALLATION \[SKYACTIV-G 2.5 \(WITHOUT CYLINDER DEACTIVATION\)\]](#).)
2. Completely clean and remove any oil, dirt, sealant or other foreign matter that may be adhering to the cylinder block and oil pan.

Caution

- Using bolts with the old silicone sealant adhering could cause cracks in the cylinder block.

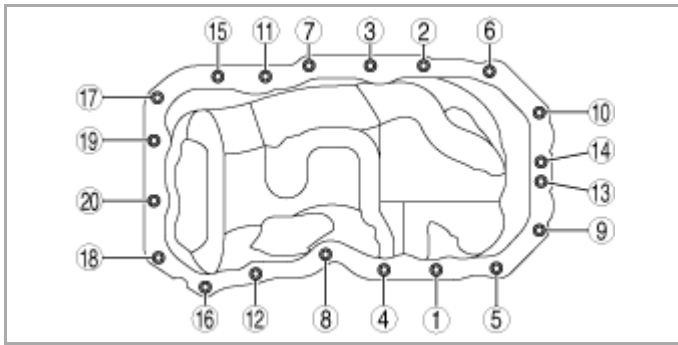

ac5uuw00003464

Tightening torque

8–11 N·m {82–112 kgf·cm, 71–97 in·lbf}

Sample

3.Stop the engine and wait for 5 min or more.

4.Remove the oil filler cap.

5.Remove the service hole cover (installed to front under cover No.2) used to drain the engine oil.

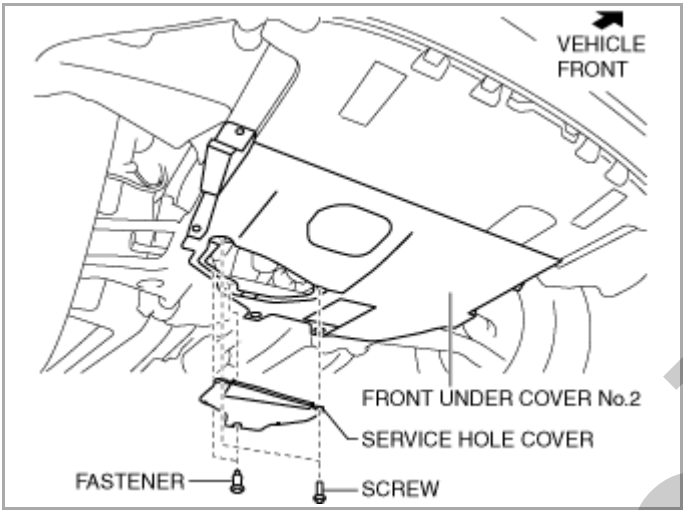

ac5uuw00007328

6.Remove the oil pan drain plug.

7.Drain the engine oil into a container.

8.Wait until the engine oil starts to drip.

9.Install the oil pan drain plug with a new gasket.

Oil pan drain plug tightening torque

30–41 N·m {3.1–4.1 kgf·m, 23–30 ft·lbf}

10.Refill with the following type and amount of engine oil.

Engine oil specification

Item		U.S.A., Canada and Israel	Except U.S.A., Canada and Israel
Engine oil capacity (approx. quantity)	Oil replacement		4.3 L {4.5 US qt, 3.8 Imp qt}
	Oil and oil filter replacement		4.5 L {4.8 US qt, 4.0 Imp qt}
	Total (dry engine, without oil cooler)		5.4 L {5.7 US qt, 4.8 Imp qt}
	Total (dry engine, with oil cooler)		5.5 L {5.8 US qt, 4.8 Imp qt}

- If the oil level is lower than the MIN mark, add engine oil while verifying the engine oil amount using the dipstick. (See **ENGINE OIL REPLACEMENT [SKYACTIV-G 2.5 (WITHOUT CYLINDER DEACTIVATION)]**.)

- If the oil level is above the MAX mark, penetration of fuel into the engine oil can be considered. Replace the engine oil. (See **ENGINE OIL REPLACEMENT [SKYACTIV-G 2.5 (WITHOUT CYLINDER DEACTIVATION)]**.)

6. Insert the dipstick completely until it attaches to the cylinder head cover.

Sample

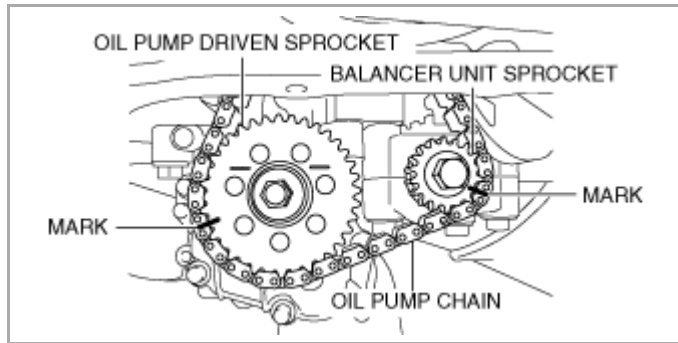

ac5uuw00004794

Note

- The marks will be used as alignment marks when installing the oil pump driven sprocket.

2.While locking the oil pump against rotation as shown in the figure, remove the oil pump driven sprocket installation bolt.

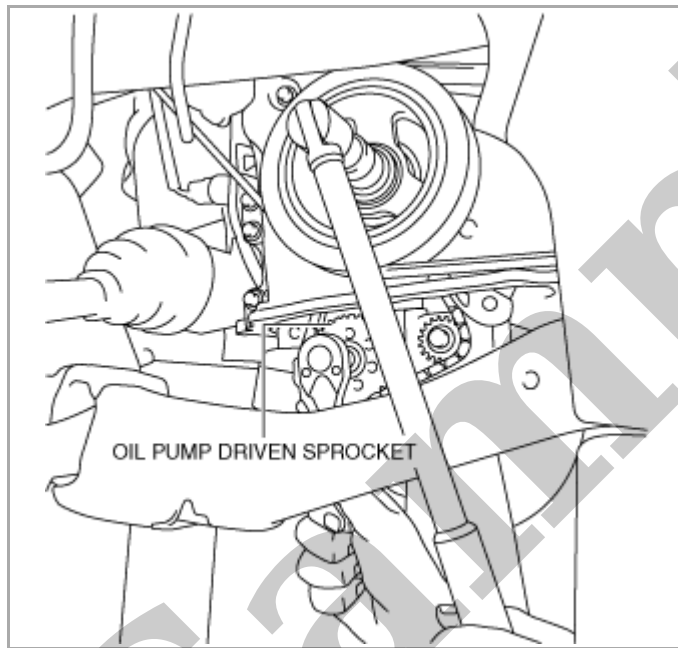

ac5uuw00004795

3.While pressing the oil pump chain in the direction of the arrow shown in the figure, remove the oil pump driven sprocket.

2.While pressing the oil pump chain in the direction of the arrow shown in the figure, install the oil pump driven sprocket.

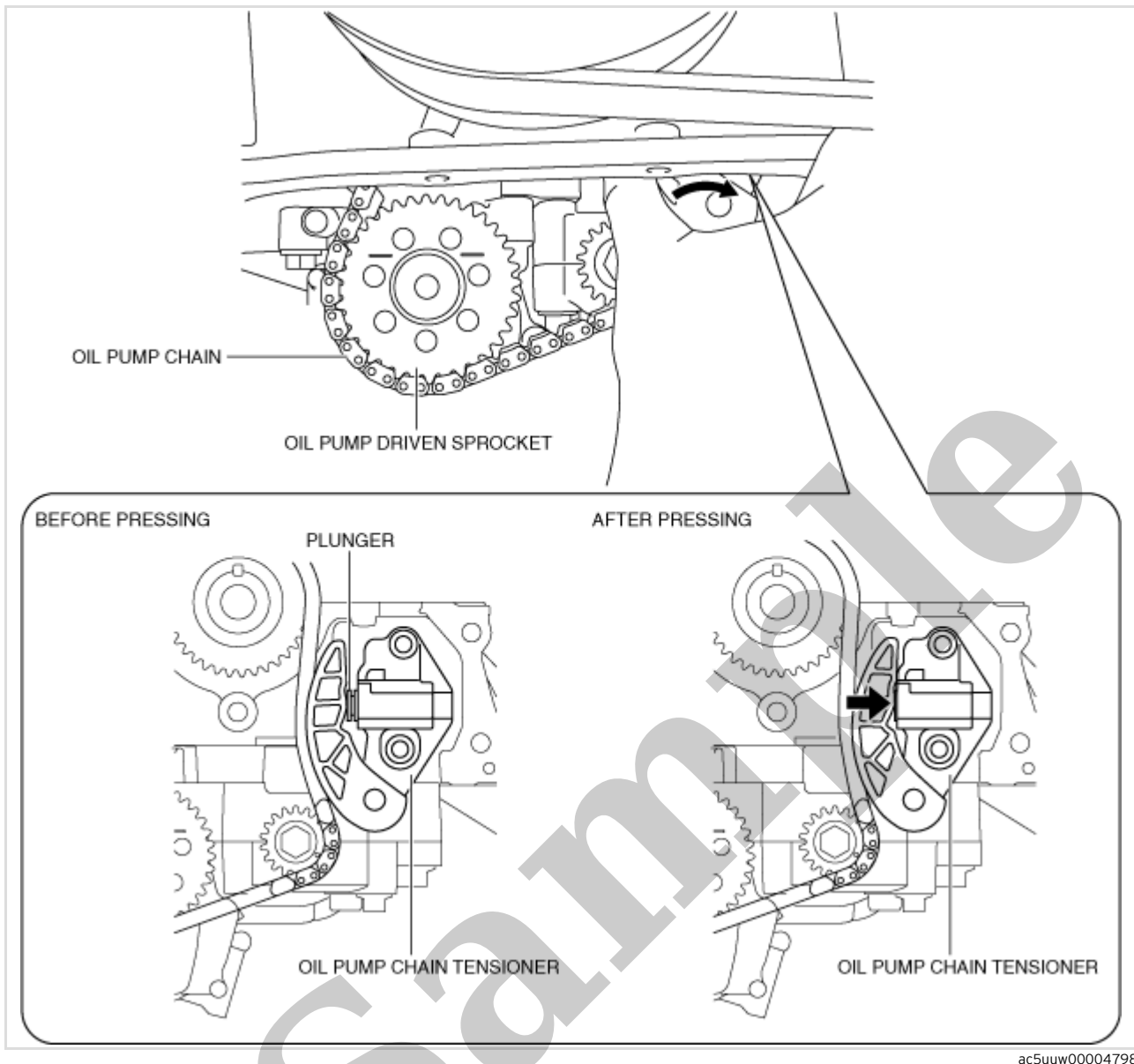

ac5uuw00004798

3.While locking the oil pump against rotation as shown in the figure, tighten the oil pump driven sprocket installation bolt.

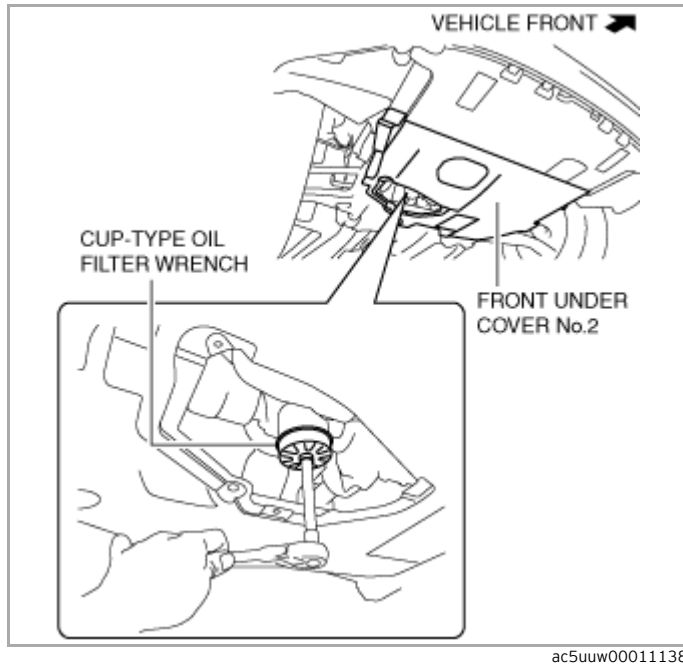

3. Use a clean rag to wipe off the mounting surface.

4. Apply clean engine oil to the O-ring of a new oil filter.

5. Tighten the oil filter according to the instructions on the package or side of the oil filter.

Tightening torque (reference value)

12–16 N·m {123–163 kgf·cm, 107–141 in·lbf}

6. Start the engine and confirm that there is no oil leakage.

- If there is oil leakage, repair or replace the applicable part.

7. Inspect the oil level. (See [ENGINE OIL LEVEL INSPECTION \[SKYACTIV-G 2.5 \(WITHOUT CYLINDER DEACTIVATION\)\]](#).)

8. Install the service hole cover.

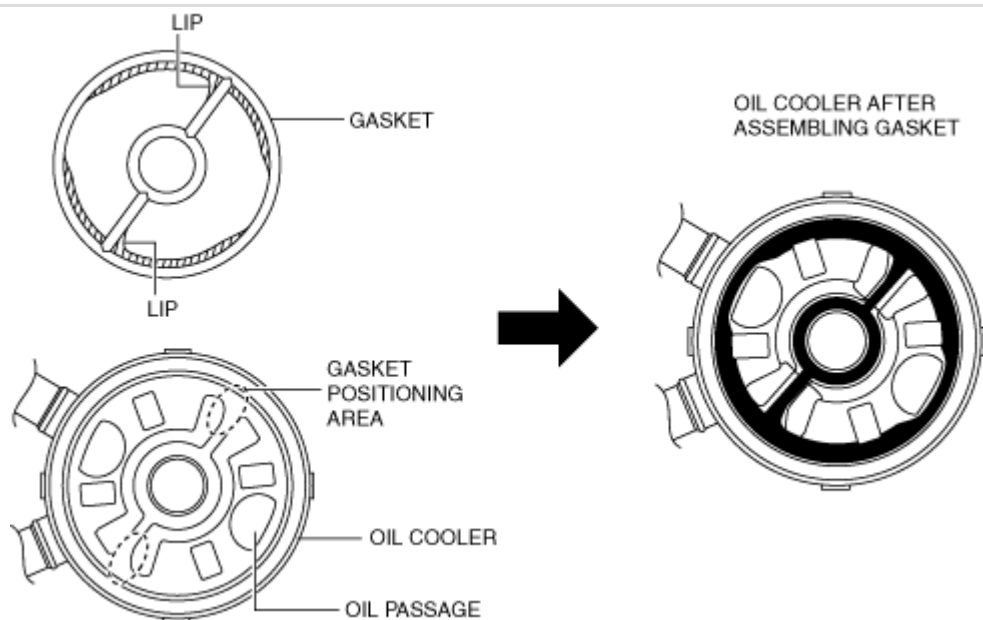

am6zzw00010238

Oil Cooler Installation Note

1. Install the oil cooler with the tab aligned with the notch of the oil filter body.

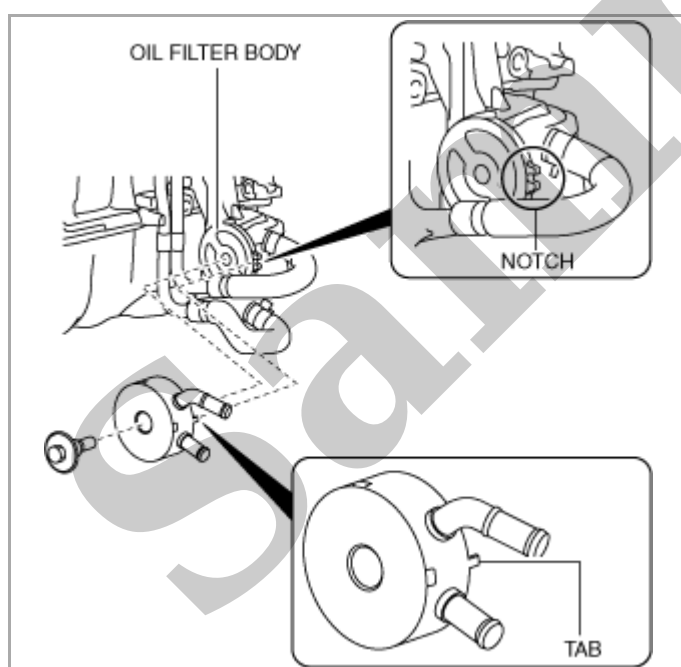

am6zzw00010239