

Your Ultimate Source for OEM Repair Manuals

FactoryManuals.net is a great resource for anyone who wants to save money on repairs by doing their own work. The manuals provide detailed instructions and diagrams that make it easy to understand how to fix a vehicle.

2005 NISSAN Micra 3 Doors OEM Service and Repair Workshop Manual

[Go to manual page](#)

WARNING:

Always observe the following item for preventing accidental activation.

- Before servicing, power switch OFF, disconnect 12V battery negative terminal and wait for 3 minutes or more (discharges electricity held in the additional power supply circuit of the air bag diagnosis sensor unit). Refer to [Precautions for Removing Battery Terminal](#).
- Never use air tools or electric tools for servicing.

REMOVAL

Front Door Satellite Sensor

- 1 Remove front door finisher. Refer to [Removal & Installation](#).
- 2 Remove front door sealing screen. Refer to [Removal & Installation](#).
- 3 Disconnect front door satellite sensor harness connector.
- 4 Disengage front door satellite sensor lock pin (A) according numerical order 1 → 2 indicated arrows as shown in figure, and then remove front door satellite sensor.

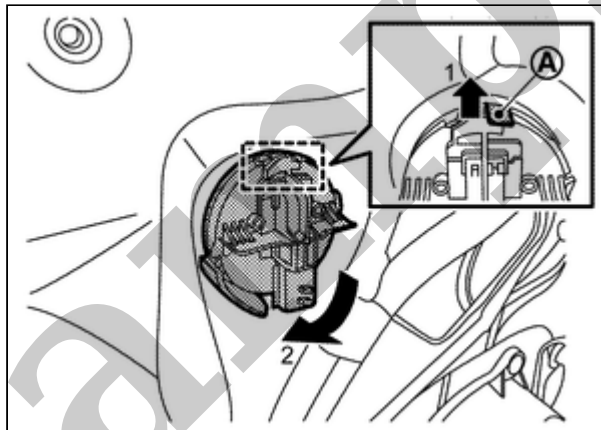

RPR-001930894-03-000373738

C-pillar Satellite Sensor

- 1 Remove luggage side lower finisher. Refer to [Removal & Installation](#).
- 2 Disconnect C-pillar satellite sensor harness connector.
- 3 Remove C-pillar satellite sensor mounting nut, and then remove C-pillar satellite sensor.

CAUTION:

- To prevent damage to the parts, never impact the satellite sensor.



- Replace satellite sensor if it is dropped or sustains an impact.
- Replace satellite sensor of deployed front side air bag module, deployed front center air bag module (with front center air bag module models), deployed rear side air bag module, and deployed curtain air bag module.

INSTALLATION

Note the following items, and then install in the reverse order of removal.

Front Door Satellite Sensor

Note the following items, and then install in the reverse order of removal.

CAUTION:

- Never reuse front door satellite sensor after removal, replace with new one.
- Never damage the harness while installing.
- Always install normally aligning to the cutout hole, because performance of the satellite sensor excessively fluctuates according to the installation position.
- After installation is completed, perform self-diagnosis using CONSULT or air bag warning lamp, if the system is normal and "PAST" of "Self Diagnostic Result" is indicated, always perform "ERASE" of "Self Diagnostic Result" using CONSULT. Refer to [Work Flow](#).
- After the work is completed, check that no system malfunction is detected by air bag warning lamp.

C-pillar Satellite Sensor

Note the following items, and then install in the reverse order of removal.

CAUTION:

- Never reuse C-pillar satellite sensor mounting nut after removal, replace with the new one.
- Never damage the harness while installing.
- Always install normally aligning to the cutout hole, because performance of the satellite sensor excessively fluctuates according to the installation position.
- After installation is completed, perform self-diagnosis using CONSULT or air bag warning lamp, if the system is normal and "PAST" of "Self Diagnostic Result" is indicated, always perform "ERASE" of "Self Diagnostic Result" using CONSULT. Refer to [Work Flow](#).
- After the work is completed, check that no system malfunction is detected by air bag warning lamp.

SEC. 253

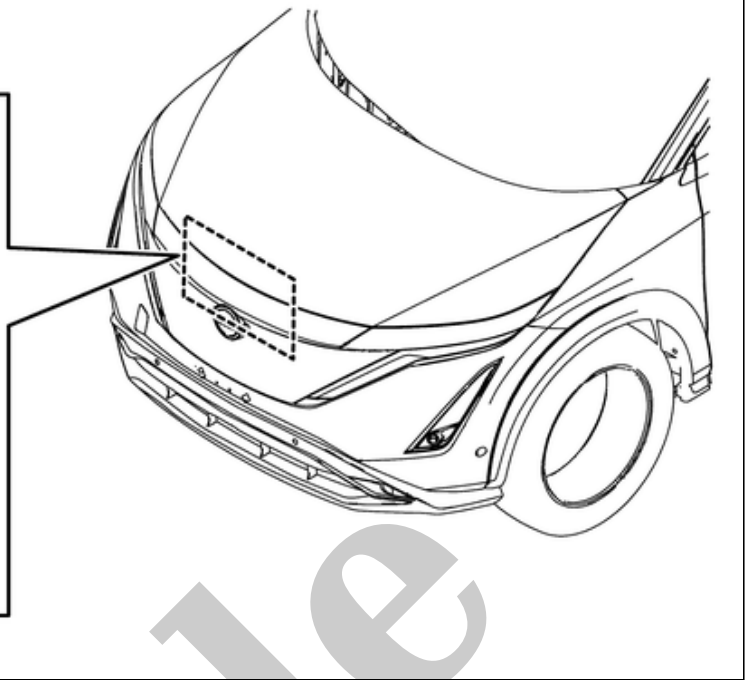
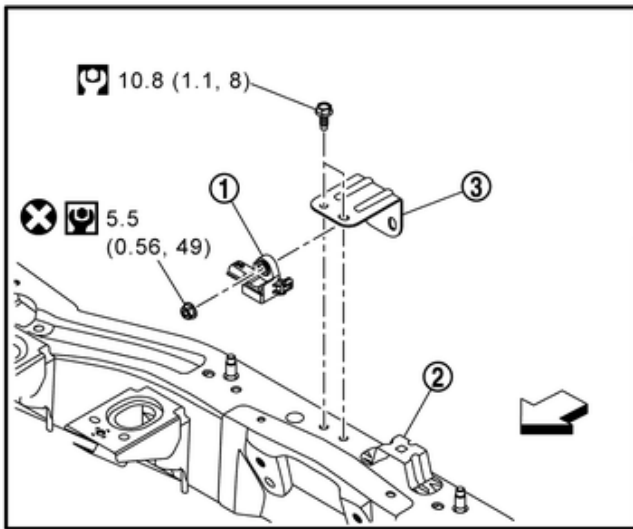

RDE-001930891-01-000384965

①	Crash zone sensor	②	Radiator core support	③	Bracket
←	: Vehicle front				
⊗	: Always replace after every disassembly.				
🔧	: N·m (kg-m, in-lb)				
🔧	: N·m (kg-m, ft-lb)				

WARNING:

Always observe the following item for preventing accidental activation.

- Before servicing, power switch OFF, disconnect 12V battery negative terminal and wait for 3 minutes or more (discharges electricity held in the additional power supply circuit of the air bag diagnosis sensor unit). Refer to [Precautions for Removing Battery Terminal](#).
- Never use air tools or electric tools for servicing.

REMOVAL

- 1 Fully open hood.
- 2 Remove bracket mounting bolts.
- 3 Disconnect crash zone sensor harness connector.
- 4 Remove crash zone sensor mounting nut, and then remove crash zone sensor from bracket.

CAUTION:

- To prevent damage to the parts, never impact the crash zone sensor.



RPR-001930892-01-MHIA0009ZZ

- Replace crash zone sensor if it is dropped or sustains an impact.
- Replace crash zone sensor of deployed driver air bag module, deployed passenger air bag module, deployed driver knee air bag module, deployed passenger knee air bag module, seat belt pre-tensioner and deployed lap pre-tensioner.

INSTALLATION

Note the following items, and then install in the reverse order of removal.

CAUTION:

- Never reuse mounting nut after removal, replace with new nut.
- Always install normally aligning to the cutout hole, because performance of the crash zone sensor excessively fluctuates according to the installation position.
- After installation is completed, perform self-diagnosis using CONSULT or air bag warning lamp, if the system is normal and "PAST" of "Self Diagnostic Result" is indicated, always perform "ERASE" of "Self Diagnostic Result" using CONSULT. Refer to [Work Flow](#).
- After the work is completed, check that no system malfunction is detected by air bag warning lamp.

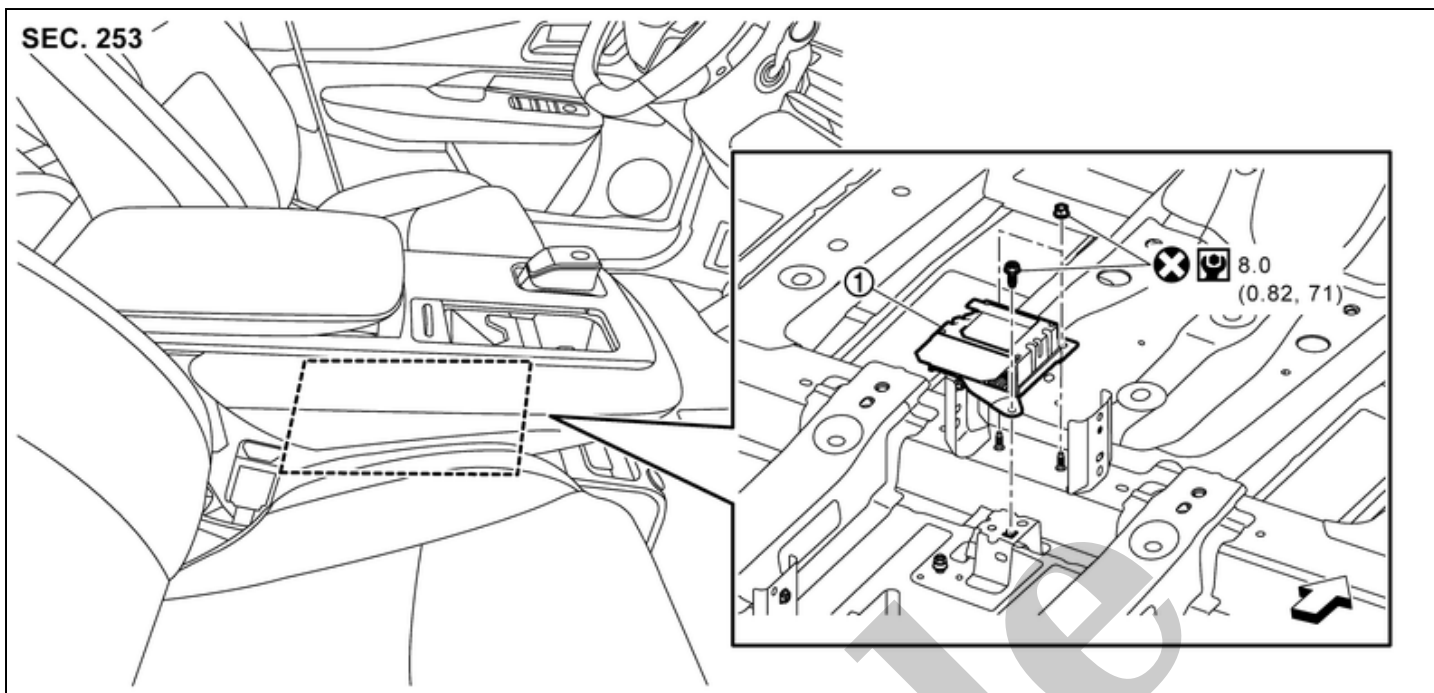

RDE-001930910-01-000373739

①	Diagnosis sensor unit				
↶	: Vehicle front				
⊗	: Always replace after every disassembly.				
⊞	: N·m (kg-m, in-lb)				

WARNING:

Always observe the following items for preventing accidental activation.

- Before servicing, power switch OFF, disconnect 12V battery negative terminal and wait for 3 minutes or more (discharges electricity held in the additional power supply circuit of the air bag diagnosis sensor unit). Refer to [Precautions for Removing Battery Terminal](#).
- Before disconnecting the air bag sensor unit harness connector, be sure to disconnect each harness connector of the air bag modules, seat belt pre-tensioners and lap pre-tensioner to prevent air bag deployment by static electricity and seat belt pre-tensioner operation.
- Never use air tools or electric tools for servicing.
- When replacing the air bag diagnosis sensor unit, always check with the parts department for the latest parts information. Installing an incorrect air bag diagnosis sensor unit may or may not cause the air bag warning lamp to illuminate and may cause incorrect deployment of the supplemental air bags and seat belt pre-tensioners in a collision resulting in serious personal injury or death.

REMOVAL

1 Disconnect connector of all air bag modules, seat belt pre-tensioners and lap pre-tensioner.

- Driver air bag module: Refer to [Removal & Installation](#).
- Passenger air bag module: Refer to [Removal & Installation](#).
- Driver knee air bag module: Refer to [Removal and Installation](#).
- Passenger knee air bag module: Refer to [Removal and Installation](#).
- Front side air bag module: Refer to [Removal & Installation](#).
- Front center air bag module (with front center air bag module models): Refer to [Removal & Installation](#).
- Rear side air bag module: Refer to [Removal and Installation](#).
- Curtain air bag module: Refer to [Removal & Installation](#).
- Pre-tensioner seat belt: Refer to [Removal & Installation](#).
- Lap pre-tensioner: Refer to [Removal & Installation](#).

2 Remove center console assembly. Refer to [Removal & Installation](#).

3 Remove front floor duct. Refer to [Removal & Installation](#).

4 Remove rear ventilator duct. Refer to [Removal & Installation](#).

5 Disconnect diagnosis sensor unit harness connectors.

6 Remove diagnosis sensor unit mounting bolt and nuts, and then remove diagnosis sensor unit.

CAUTION:

- To prevent damage to the diagnosis sensor unit, never impact it



RPR-001930909-01-MHIA0009ZZ

- Replace air bag diagnosis sensor unit if it is dropped or sustains an impact.
- Replace air bag diagnosis sensor unit of deployed driver air bag module, deployed passenger air bag module, deployed front side air bag module, deployed front center air bag module (with front center air bag module models), deployed rear side air bag module, deployed curtain air bag module, deployed seat belt pre-tensioner and deployed lap pre-tensioner.

INSTALLATION

Note the following items, and then install in the reverse order of removal.

CAUTION:

- Never reuse mounting bolt and nuts after removal, replace with new one.
- Never damage the harness while installing.
- Be sure to perform **ADDITIONAL SERVICE WHEN REPLACING AIR BAG DIAGNOSIS UNIT** when replacing air bag diagnosis sensor unit. Or not doing so, air bag diagnosis sensor unit control function does not operate normally. Refer to [Work Procedure](#).
- After installation is completed, perform self-diagnosis using CONSULT or air bag warning lamp, if the system is normal and "PAST" of "Self Diagnostic Result" is indicated, always perform "ERASE" of "Self Diagnostic Result" using CONSULT. Refer to [Work Flow](#).
- After the work is completed, check that no system malfunction is detected by air bag warning lamp.

SEC. 484

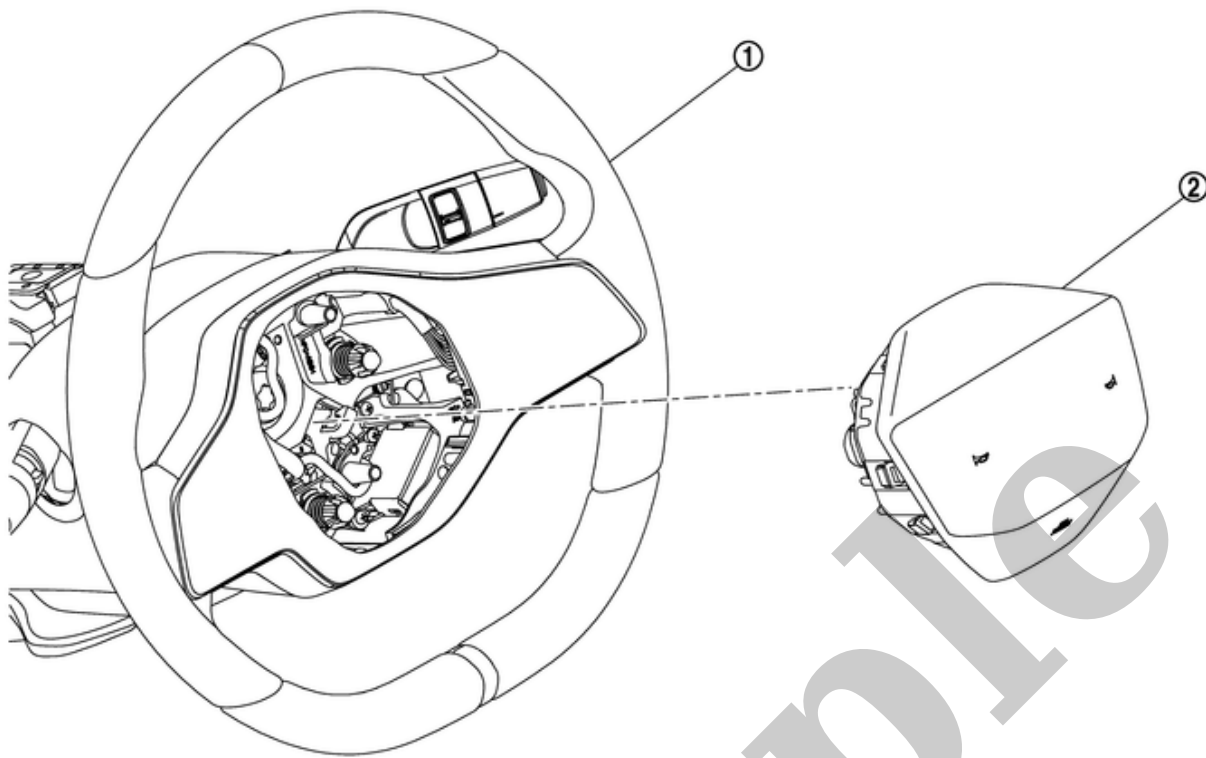

RDE-001930866-01-000354093

①	Steering wheel	②	Driver air bag module		
---	----------------	---	-----------------------	--	--

WARNING:

Always observe the following items for preventing accidental activation.

- Before servicing, power switch OFF, disconnect 12V battery negative terminal and wait for 3 minutes or more (discharges electricity held in the additional power supply circuit of the air bag diagnosis sensor unit). Refer to [Precautions for Removing Battery Terminal](#).
- Always work from the side of air bag module. Never work in front of it.
- Never use the air tools or electric tools for servicing.

CAUTION:

Never damage around parts.

REMOVAL

1 From the holes on left, right and lower of steering wheel, check the position of torsion spring (A) secure the driver air bag module.

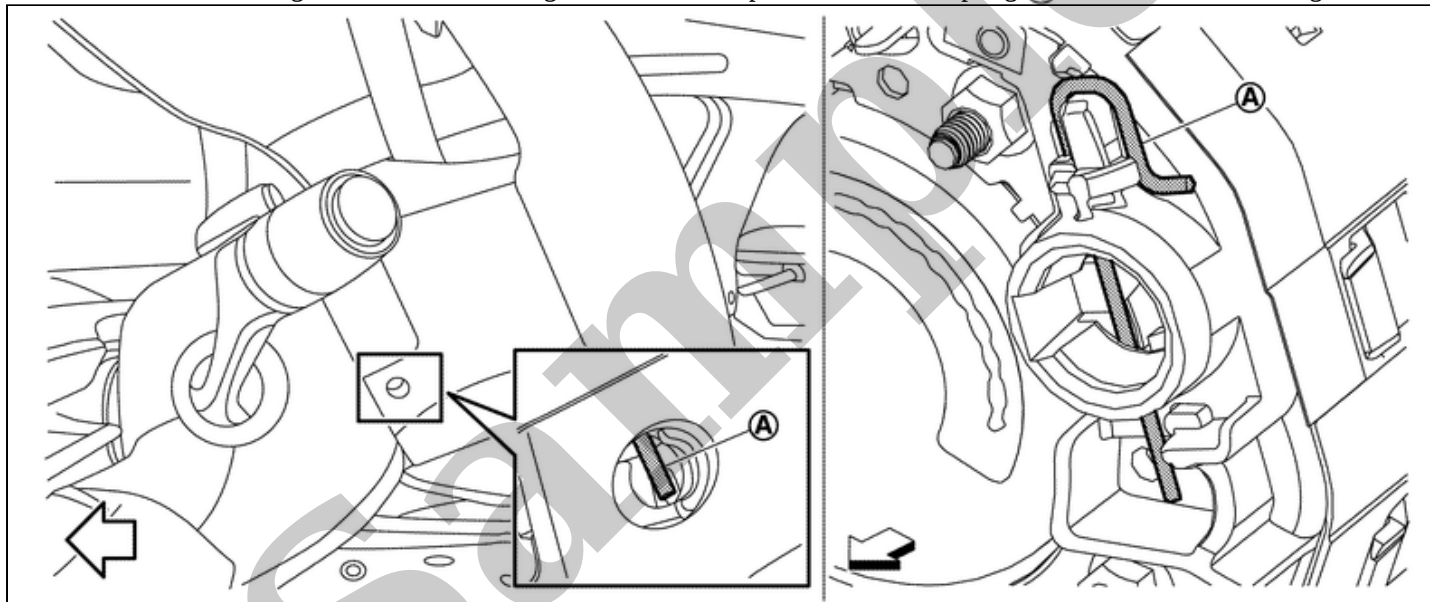

RPR-001930867-01-000390742



: Vehicle front

2 Insert remover tool (A) into a hole of the steering wheel, and then press and disengage torsion spring (B).

