

# Your Ultimate Source for OEM Repair Manuals

FactoryManuals.net is a great resource for anyone who wants to save money on repairs by doing their own work. The manuals provide detailed instructions and diagrams that make it easy to understand how to fix a vehicle.

## 2005 CHEVROLET Colorado Extended Cab OEM Service and Repair Workshop Manual

[Go to manual page](#)

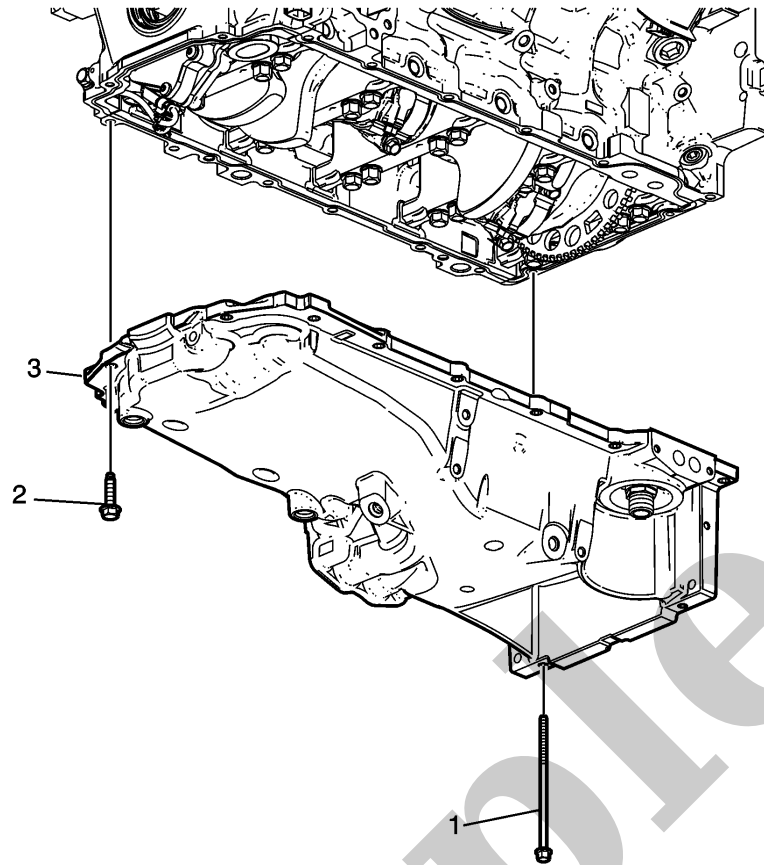

9.

Remove the oil pan bolts (1 and 2).

10. Remove the oil pan (3) from the engine block.

11. For oil pan disassemble, refer to [Oil Pan Disassemble](#).

12. For cleaning and inspection, refer to [Oil Pan Cleaning and Inspection](#).

### Installation Procedure

1. For oil pan assemble, refer to [Oil Pan Assemble](#).

## Tighten

1. Tighten the oil pan mounting bolts (3) M6 to 12 N·m (106 lb in).
2. Tighten the oil pan mounting bolts (2) M8 to 25 N·m (18 lb ft).

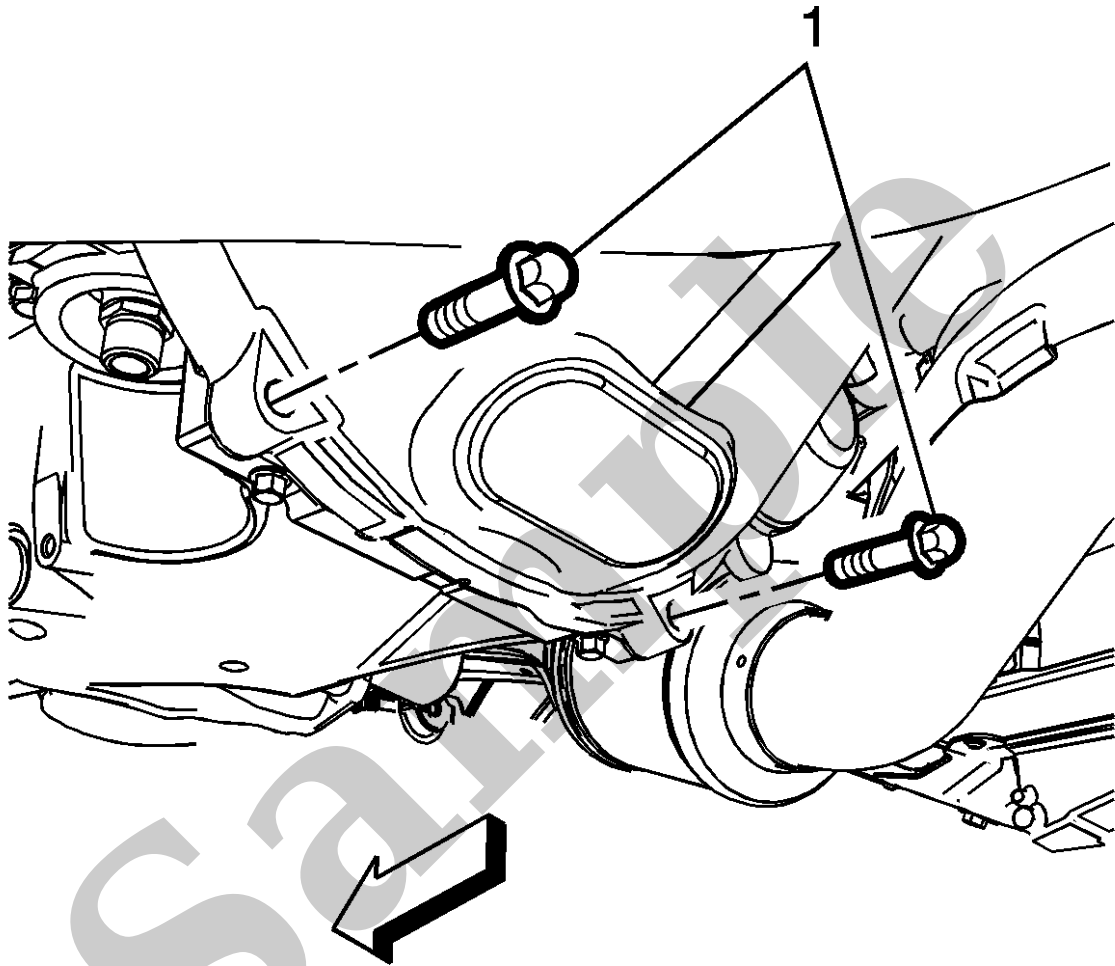

6.

Install the bell housing to oil pan bolts (1). Tighten the bolts to **50 N·m (37 lb ft)** .

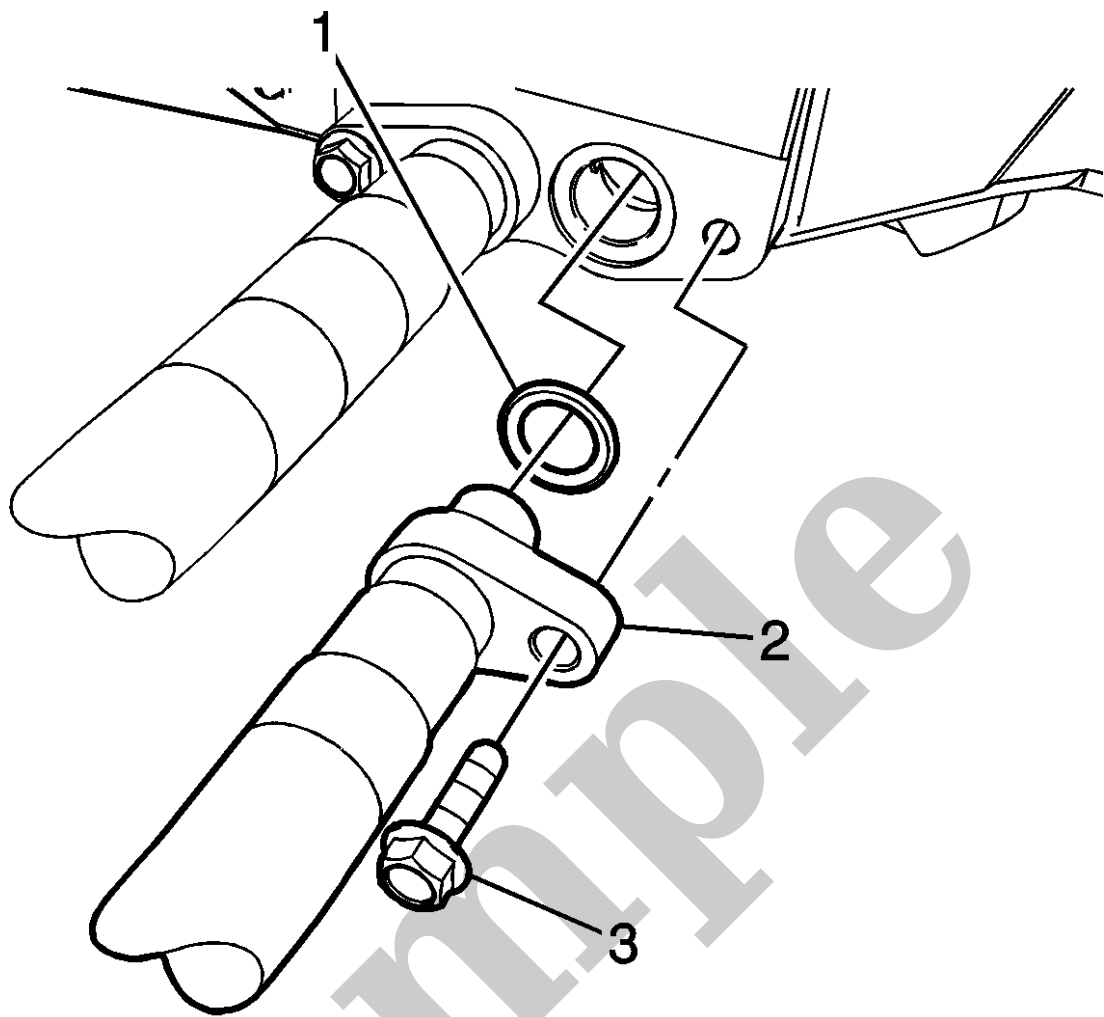

8.

Using a NEW oil seal (1) install the oil tank inlet hose (2) and bolt (3) to the oil pan. Tighten the inlet hose to oil pan bolt to **22 N·m (16 lb ft)**.

9. Install the engine oil cooler adapter. Refer to [Engine Oil Cooler Adapter Replacement](#).

10. Attach the wiring harness to the oil pan as necessary.

YOUR CURRENT VEHICLE

## Oil Pan Replacement

### Oil Pan Replacement (Without Z52)

#### Removal Procedure

1. Remove the oil level indicator tube. Refer to [Oil Level Indicator Tube Replacement](#).

2. **NOTE**

**Note**

It is not necessary to remove the transverse spring or steering gear intermediate shaft from the cradle.

**NOTE**

**Note**

It is not necessary to remove the stabilizer shaft, only to disconnect the links.

Remove the front cradle. Refer to [Front Cradle Replacement](#).

