

Your Ultimate Source for OEM Repair Manuals

FactoryManuals.net is a great resource for anyone who wants to save money on repairs by doing their own work. The manuals provide detailed instructions and diagrams that make it easy to understand how to fix a vehicle.

2005 CHEVROLET Colorado Double Cab OEM Service and Repair Workshop Manual

[Go to manual page](#)

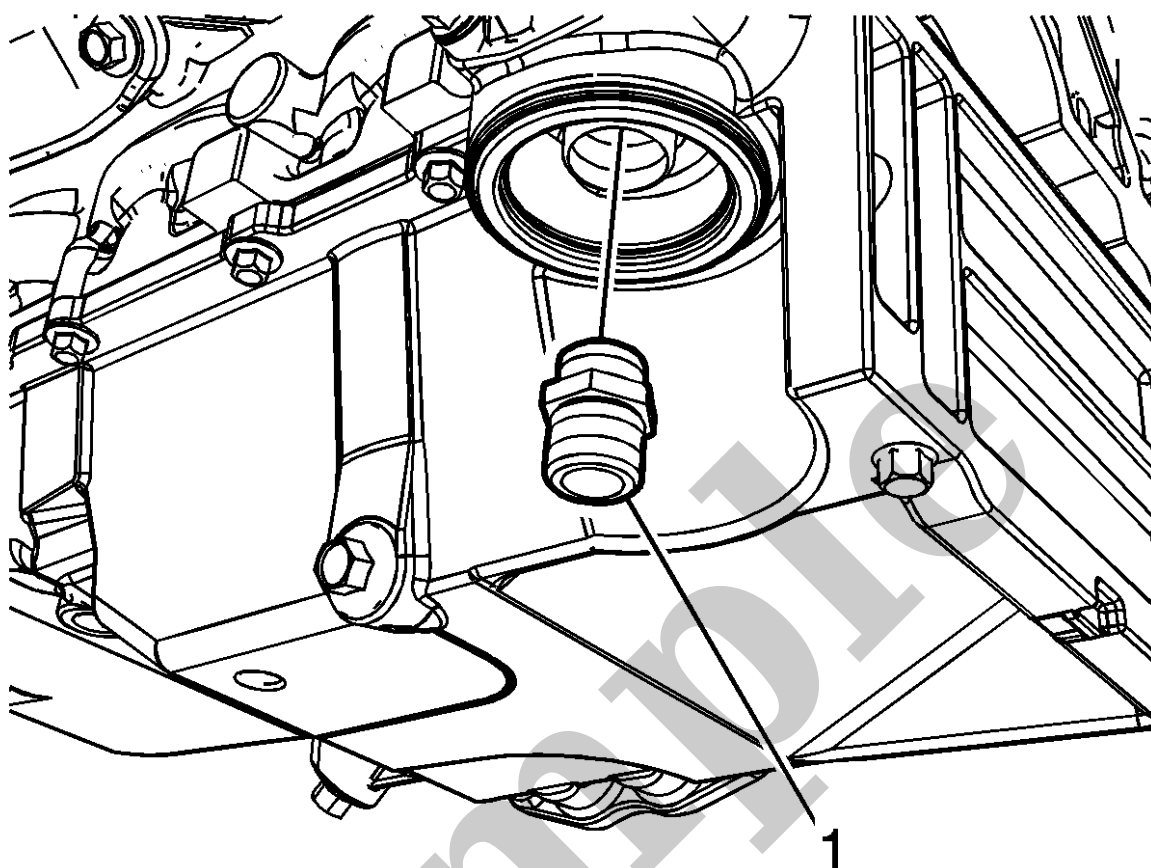

1.

CAUTION

Caution

Refer to [Fastener Caution](#).

Install the oil filter adapter (1).

Tighten

Tighten the oil filter adapter to 55 N·m (40 lb ft).

YOUR CURRENT VEHICLE

Oil Level Indicator Tube Replacement

Oil Level Indicator Tube Replacement

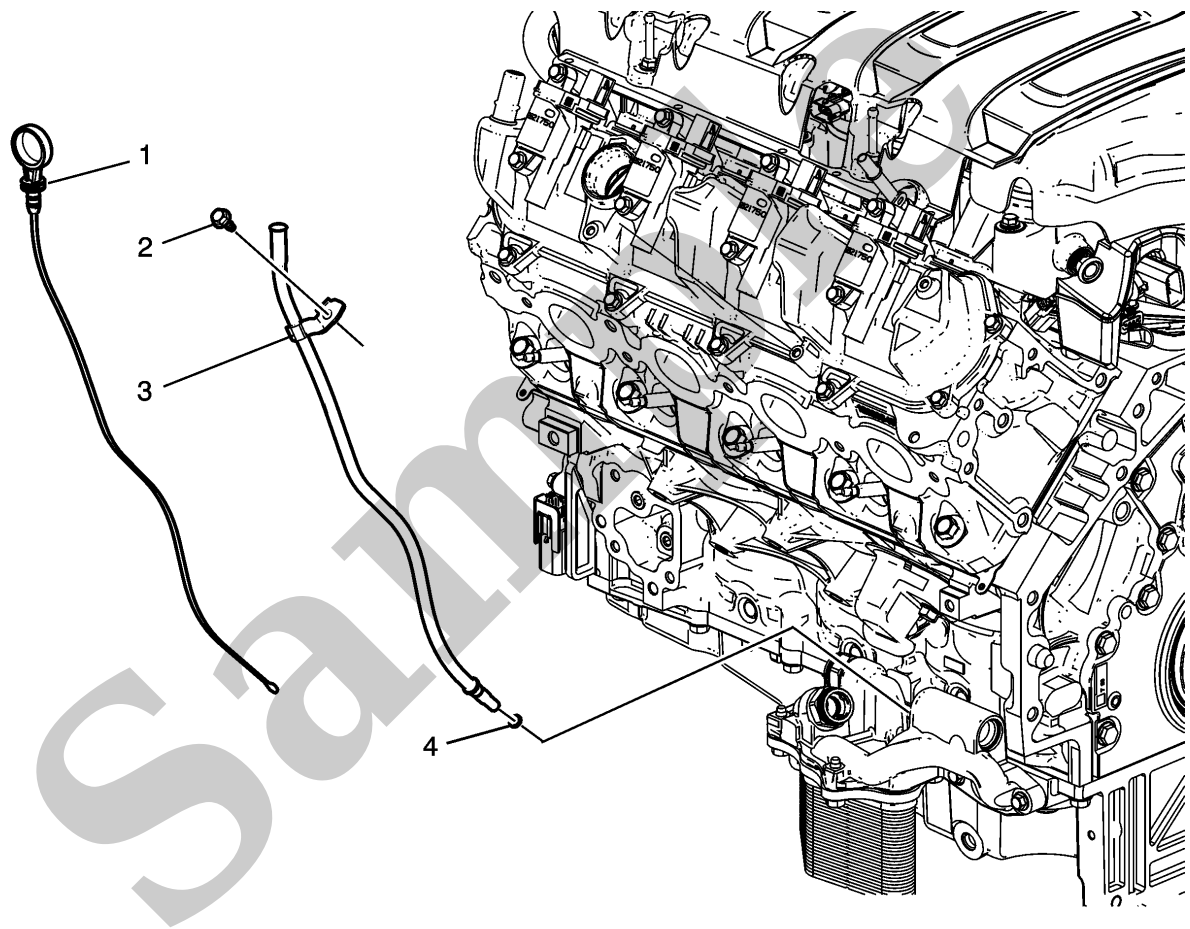

Oil Level Indicator Tube Replacement

Callout	Component Name
Preliminary Procedure Remove the fasteners for the valve rocker arm insulator, then reposition the insulator. Refer to Valve Rocker Arm Cover Insulator Replacement - Left Side .	
1	Oil Level Indicator



YOUR CURRENT VEHICLE

Oil Pan Replacement

Oil Pan Replacement (With Z52)

Removal Procedure

1. **NOTE**

Note

It is not necessary to remove the stabilizer shaft, only to disconnect the links.

NOTE

Note

The front of the oil pan sits inside the crankshaft balancer and the crankshaft balancer needs to be drawn off 5/8 of an inch. It is not necessary to completely remove the crankshaft balancer.

Partially remove the crankshaft balancer. Refer to [Crankshaft Balancer Replacement](#).



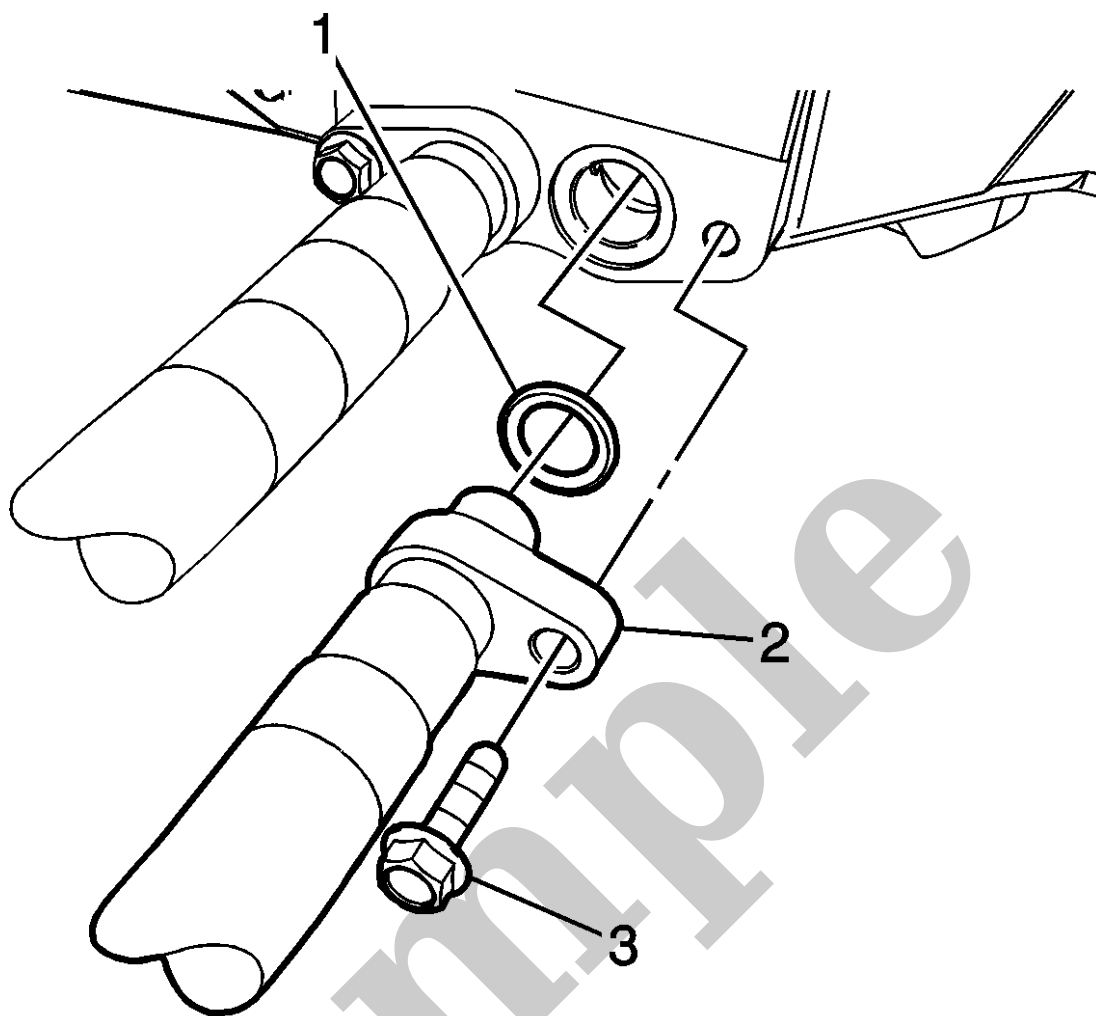

6.

Remove the oil inlet hose to oil pan bolt (3) and disconnect the hose (2) from the oil pan.

Discard the oil seal (1).

7. Remove the oil tank outlet hose to oil pan bolt and disconnect the hose from the oil pan.

Discard the oil seal.