

Your Ultimate Source for OEM Repair Manuals

FactoryManuals.net is a great resource for anyone who wants to save money on repairs by doing their own work. The manuals provide detailed instructions and diagrams that make it easy to understand how to fix a vehicle.

2005 CHEVROLET Blazer 5 doors OEM Service and Repair Workshop Manual

[Go to manual page](#)

1. Tighten the flex plate bolts (1-8) a first pass in sequence to **15 N·m (11 lb ft)** .
2. Tighten the flex plate bolts (1-8) a second pass in sequence to **30 N·m (22 lb ft)** .
3. Tighten the flex plate bolts (1-8) a final pass in sequence an additional **45 degrees** using **EN-45059 angle meter** .

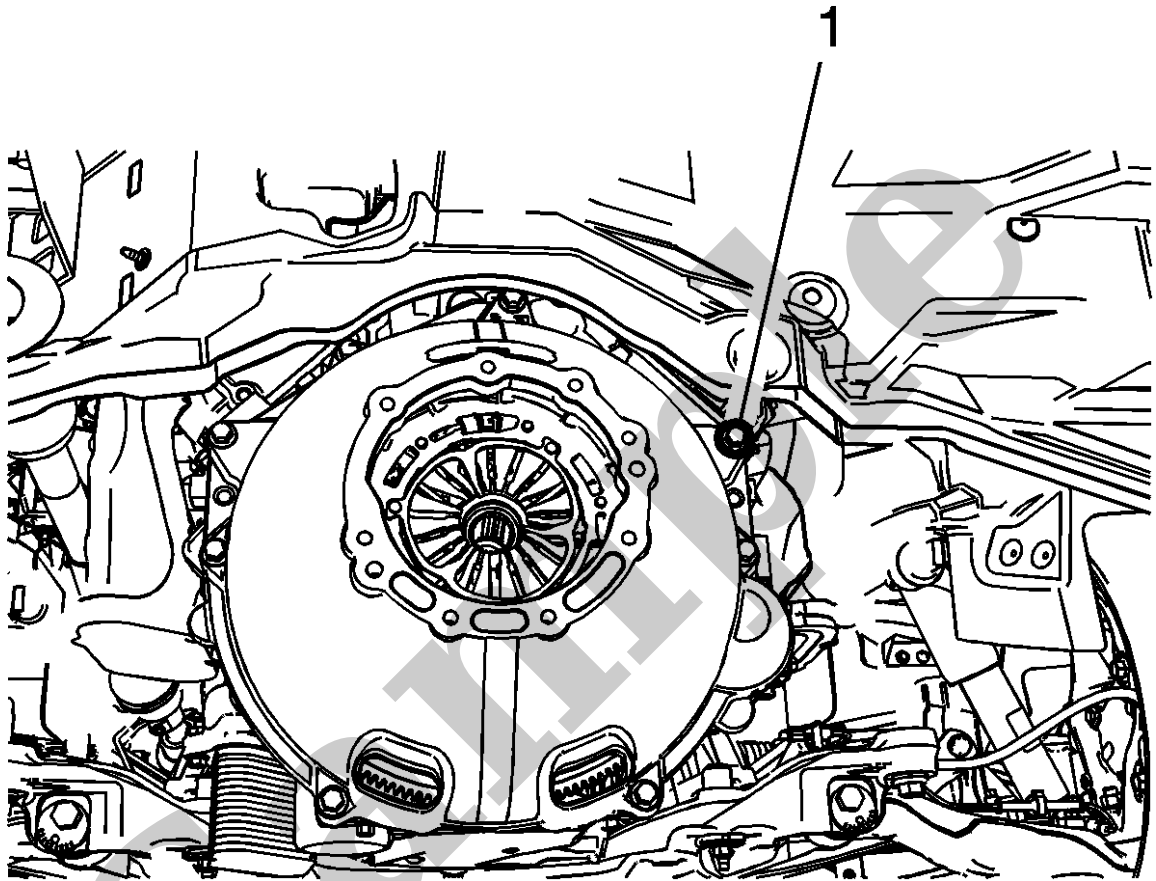

3. Install the eight bell housing bolts (1) and tighten to **50 N·m (37 lb ft)** .
4. reposition the engine harness channel and install the two bolts. Tighten bolts to 10 N·m (89 lb in).
5. Install the automatic transmission. Refer to [Transmission Replacement](#).

Callout	Component Name
Drive Belt Replacement - Accessory	
1	<div>Camshaft Position Actuator Fasteners (Qty: 3)</div> <div>CAUTION</div> <div>Caution Refer to Fastener Caution.</div> <div>Tighten</div> <div>10 N·m (89 lb in)</div>
2	<div>Camshaft Position Actuator Magnet</div> <div>Procedure Unplug the camshaft position actuator magnet electrical connector.</div>
3	<div>Camshaft Position Actuator Magnet Gasket</div> <div>NOTE</div> <div>Note Replace with NEW gasket</div>

Callout	Component Name
Supercharger Belt Idler Pulley Replacement	
1	<div>Camshaft Position Actuator Fasteners (Qty: 3)</div> <div>CAUTION</div> <div>Caution Refer to Fastener Caution.</div> <div>Tighten</div> <div>10 N·m (89 lb in)</div>
2	<div>Camshaft Position Actuator Magnet</div> <div>Procedure Unplug the camshaft position actuator magnet electrical connector.</div>
3	<div>Camshaft Position Actuator Magnet Gasket</div> <div>NOTE</div> <div>Note Replace with NEW gasket</div>

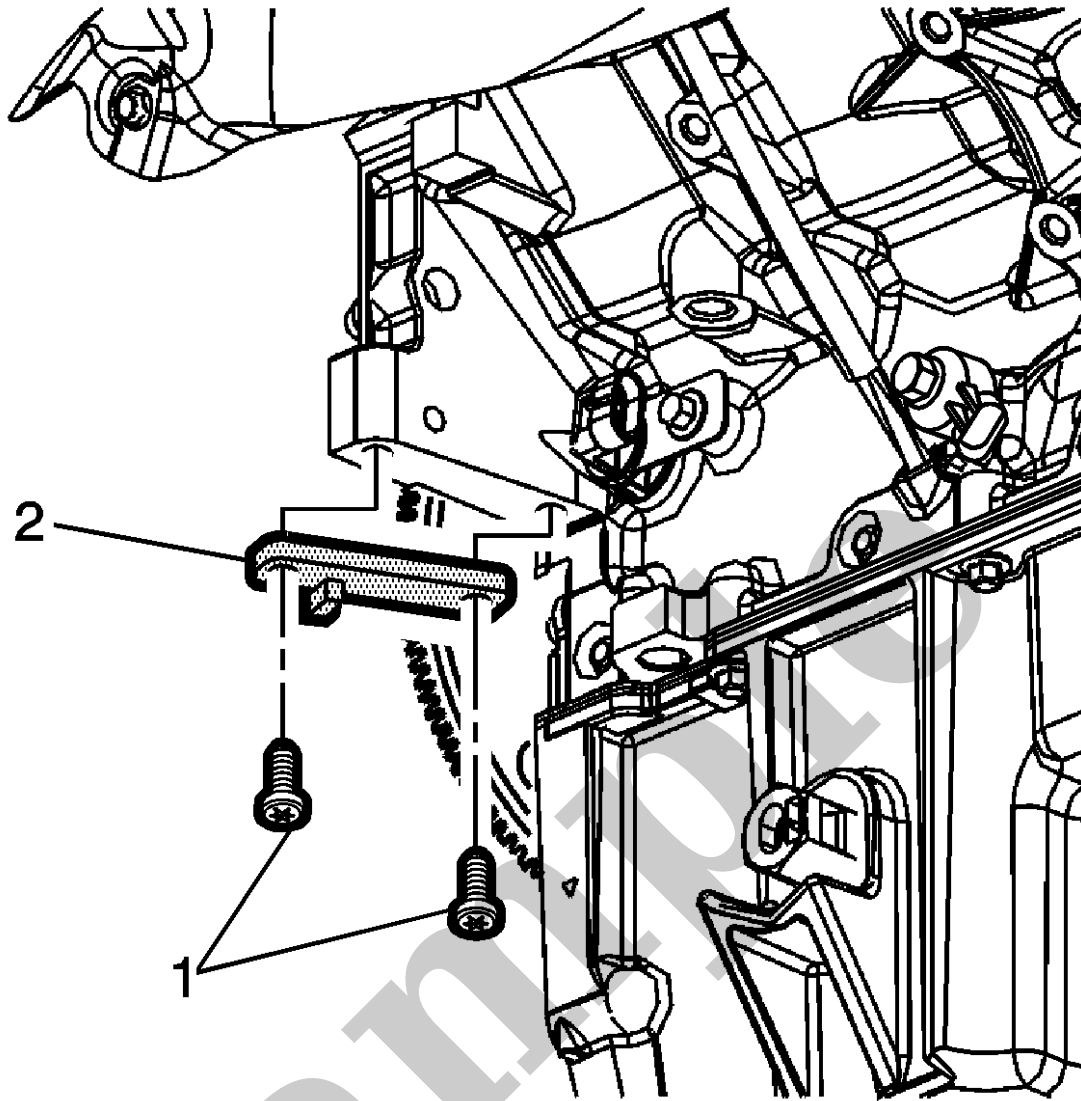

2.

CAUTION

Caution

Refer to [Fastener Caution](#).

NOTE

Note

Ensure that the teeth of the **EN-42386-A flywheel holding tool** mesh with the teeth of the engine flywheel.

Install the **EN-42386-A flywheel holding tool** (2) and bolts. Use one M10–1.5 x 120 mm and one M10–1.5 x 45 mm bolt for proper tool installation. Tighten the **EN-42386-A flywheel holding tool** bolts (1) to