

Your Ultimate Source for OEM Repair Manuals

FactoryManuals.net is a great resource for anyone who wants to save money on repairs by doing their own work. The manuals provide detailed instructions and diagrams that make it easy to understand how to fix a vehicle.

2003 NISSAN Micra 3 Doors OEM Service and Repair Workshop Manual

[Go to manual page](#)

DESIGN/PURPOSE

Notifies the driver when the vehicle is moved or may start moving while automatic brake hold function is being applied.

Design	Warning message	Description
—	Press brake pedal to prevent rolling	When the vehicle moves or possibly moves while automatic brake hold function activates.
	Caution Steep slope	When the automatic brake hold function activates on the steep slope.
	Steep Slope Apply foot brake	When the brake pedal is not depressed while the automatic brake hold function activates on the steep slope for 3 minutes approximately.
	Press brake to operate switch	<ul style="list-style-type: none"> When the automatic brake hold switch is pushed without depressing brake pedal while the automatic brake hold function activates. When Automatic brake hold function cannot be released even if the accelerator pedal is depressed on steep slope.

SYNCHRONIZATION WITH WARNING CHIME

Warning message	—
Press brake pedal to prevent rolling	Applicable
Caution Steep slope	NO
Steep Slope Apply foot brake	NO
Press brake to operate switch	NO

SYNCHRONIZATION WITH MASTER WARNING LAMP

Warning message	—
Press brake pedal to	Applicable

Warning message	—
prevent rolling	
Caution Steep slope	NO
Steep Slope	
Apply foot brake	NO
Press brake to operate switch	NO

Refer to [Master Warning Lamp](#).

SYSTEM DIAGRAM

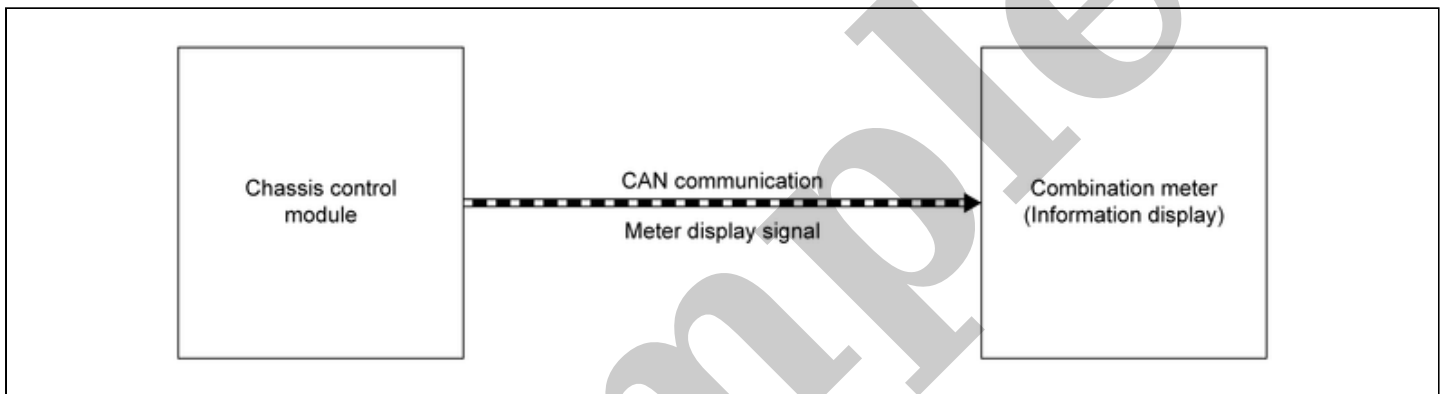

SIEMD-7262766-01-SFIA4258GB

WARNING MESSAGE DISPLAY CONDITION

When all of the following conditions are satisfied.

- Automatic brake hold function applied
- Vehicle is moved; vehicle may start moving; or a malfunction is detected in automatic brake hold function (chassis control module). Refer to [DTC Index](#).

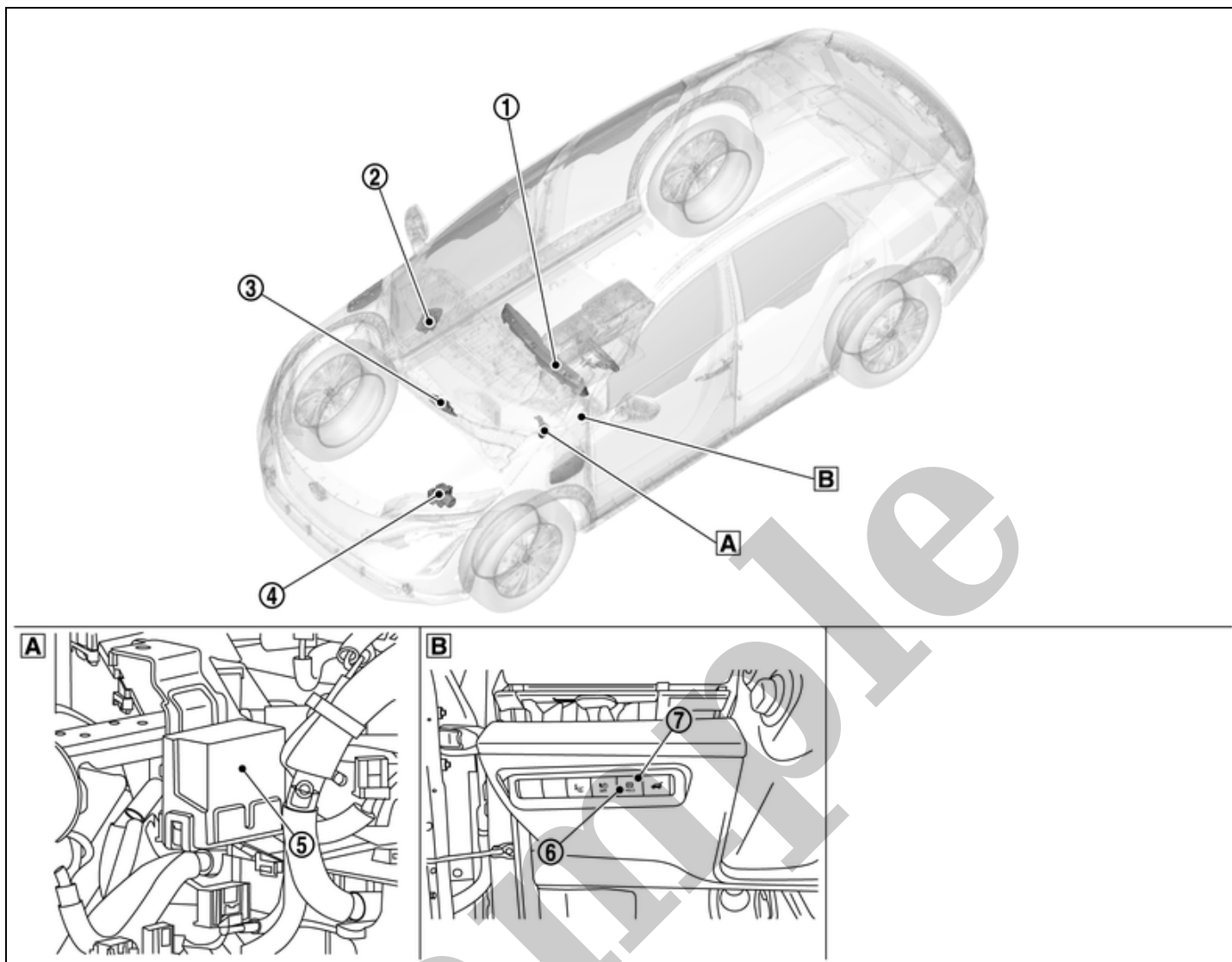

SIEMD-7262699-01-000383620

A	Back of instrument lower panel (LH side)	B	Instrument lower panel	
----------	--	----------	------------------------	--

<p>① Combination meter</p> <p>Refer to Component Parts Location for detailed installation location.</p>	<p>② BCM</p> <p>Refer to Component Parts Location for detailed installation location.</p>	<p>③ VCM</p> <p>Refer to Component Parts Location for detailed installation location.</p>
<p>④ ABS actuator and electric unit (control unit)</p> <p>Refer to Component Parts Location for detailed installation location.</p>	<p>⑤ Chassis control module</p>	<p>⑥ Automatic brake hold switch indicator</p>
<p>⑦ Automatic brake hold switch</p>		

FUNCTIONS WITHIN THE SYSTEM

Chassis control module controls automatic brake hold function and e-Step function according to the signals from each sensor, each switch and each control unit.

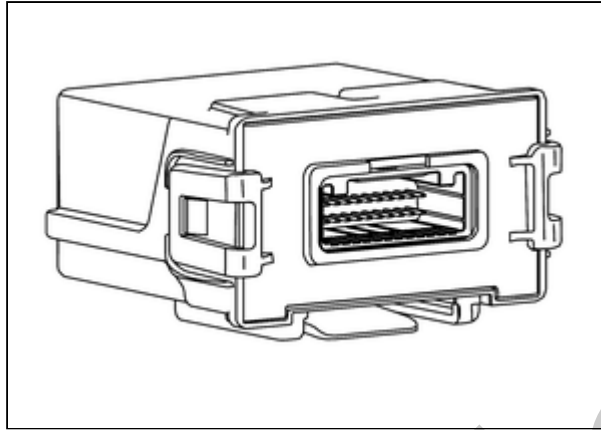

SIEMD-7307157-01-000363064

INDIVIDUAL FUNCTIONS WITHIN THE SYSTEM

- Receives the signals required to activate the automatic brake hold function and e-Pedal Step function from each control unit.
- Transmits the signals required to activate the automatic brake hold function and e-Pedal Step function to each control unit.

PARTS LOCATION

Refer to [Component Parts Location](#).

FUNCTIONS WITHIN THE SYSTEM

By operating automatic brake hold switch, turn ON/OFF automatic brake hold function.



NOTE:

Automatic brake hold function retains the last state until the driver changes the option even if the power switch OFF.

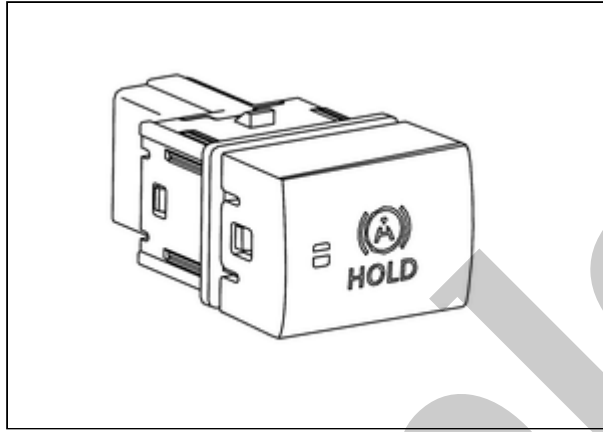

SIEMD-7262711-02-000363065

INDIVIDUAL FUNCTIONS WITHIN THE SYSTEM

- Turns ON/OFF automatic brake hold switch, and turns ON/OFF automatic brake hold function by chassis control module.
- According to the control of chassis control module, automatic brake hold switch indicator turns ON/OFF.

INDIVIDUAL OPERATION

- A normal open type is used for automatic brake hold switch.

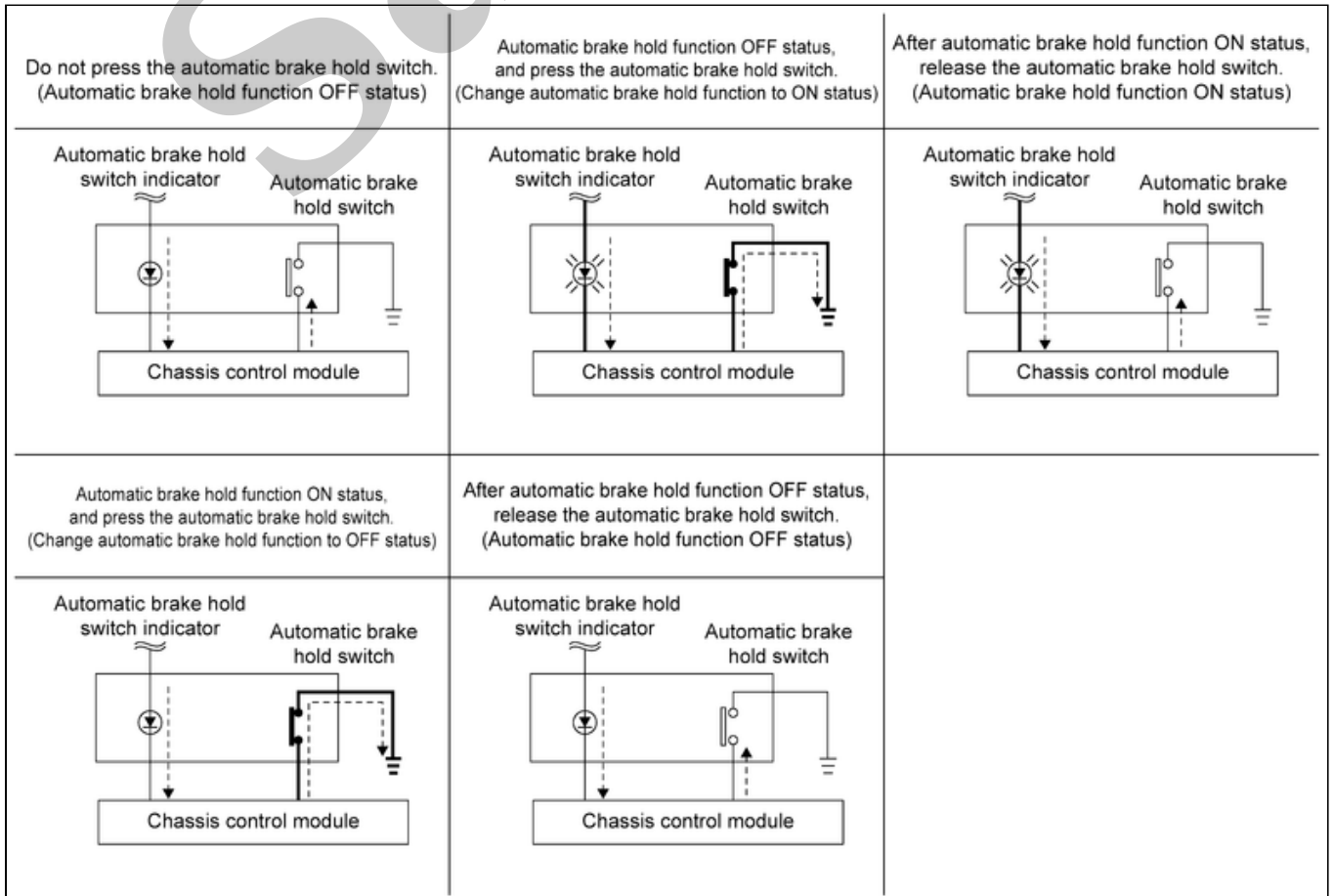

- If automatic brake hold switch is pressed when automatic brake hold function is OFF, automatic brake hold function turns ON. In addition, automatic brake hold switch indicator illuminates.

**NOTE:**

Automatic brake hold function retains the last state until the driver changes the option even if the power switch OFF.

- If automatic brake hold switch is pressed when automatic brake hold function is ON, automatic brake hold function turns OFF. In addition, automatic brake hold switch indicator turns OFF. [If automatic brake hold indicator lamp (white or green) is ON, it turns OFF.]

**NOTE:**

To turn OFF automatic brake hold function while the brakes are held by automatic brake hold function, press automatic brake hold switch while depressing brake pedal.

PARTS LOCATION

Refer to [Component Parts Location](#).

Sample

Diagnosis Description

SIEMD-7307749

Chassis control module: Refer to [Diagnosis Description](#).

Sample

REMOVAL

CAUTION:

When replacing chassis control module, configuration of chassis control module is required. Refer to [Work Procedure](#).

1 Remove the instrument panel. Refer to [Work Procedure](#).

2 Disconnect chassis control module harness connector.

3 Remove the chassis control module.

CAUTION:

Never drop the chassis control module.

INSTALLATION

Note the following, install in the reverse order of removal.

- When replacing the chassis control module, be sure to perform the configuration of chassis control module. Refer to [Work Procedure](#).

REMOVAL

1. Remove instrument lower panel. Refer to [Removal & Installation](#).
2. Remove switch bracket mounting screw **A** and remove automatic brake hold switch bracket **1** from instrument lower panel.

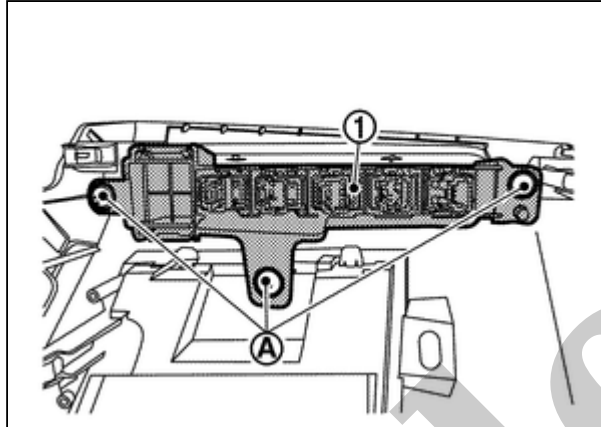

RPR-001952905-01-000350748

3. Remove automatic brake hold switch from switch bracket.

INSTALLATION

Install in the reverse order of removal.