

# Your Ultimate Source for OEM Repair Manuals

FactoryManuals.net is a great resource for anyone who wants to save money on repairs by doing their own work. The manuals provide detailed instructions and diagrams that make it easy to understand how to fix a vehicle.

## 2003 CHEVROLET S-10 Crew Cab OEM Service and Repair Workshop Manual

[Go to manual page](#)

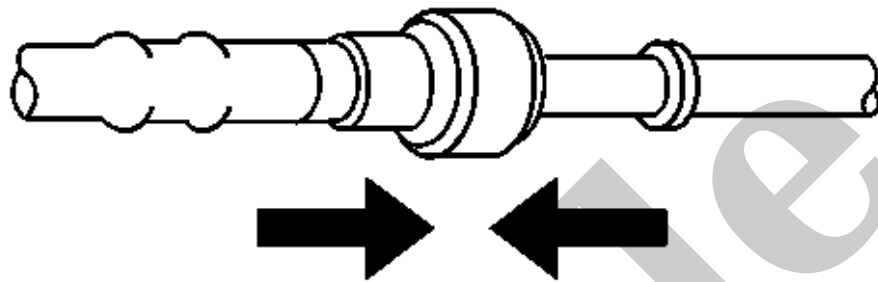

2.

Push both sides of the fitting together in order to cause the retaining tabs to snap into place.

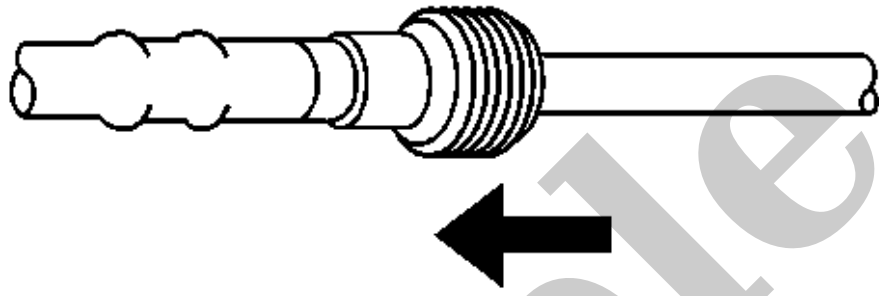

4.

Reposition the dust cover over the quick connect fitting.

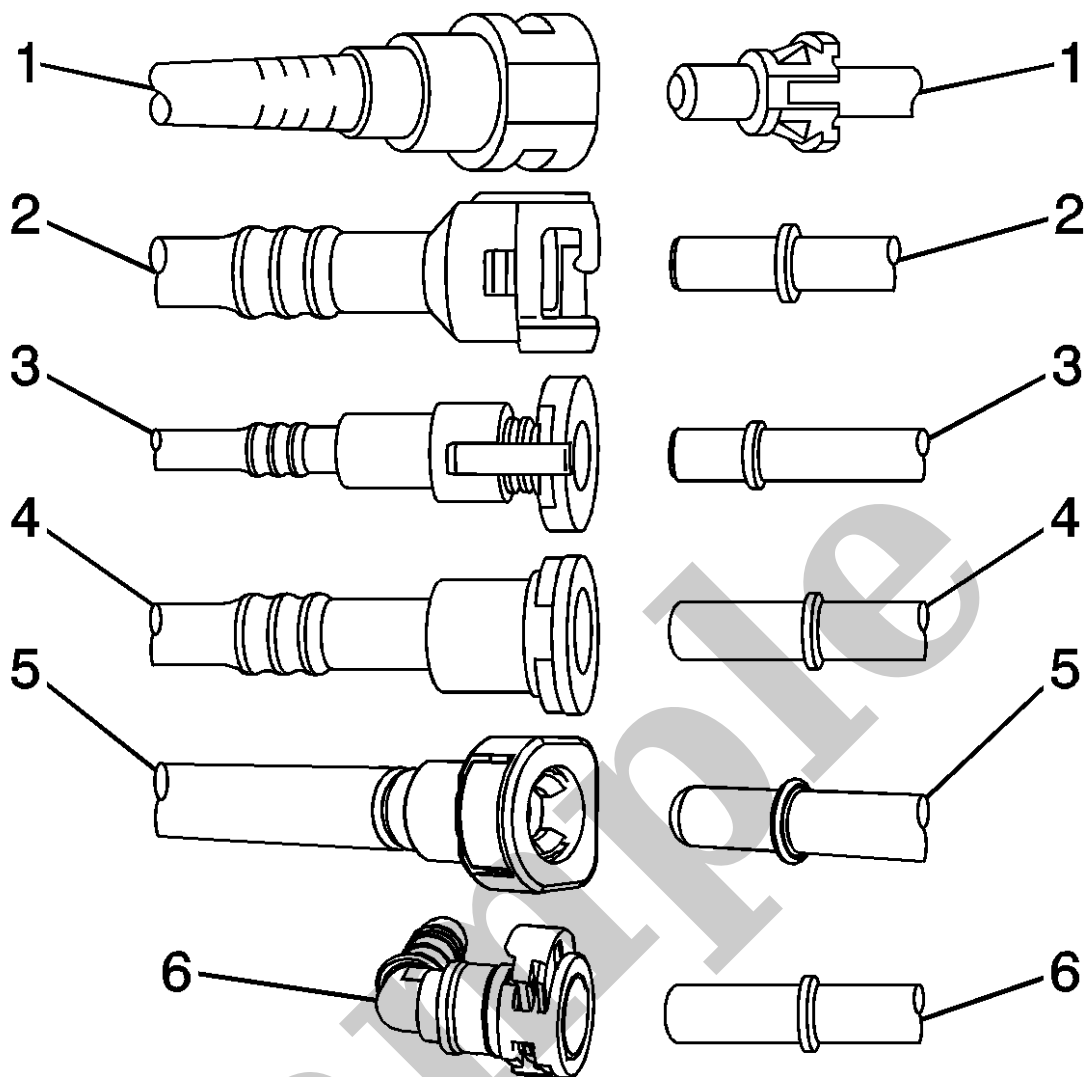

1.

## NOTE

### Note

There are several types of Plastic Collar Fuel and Evaporative Emission Quick Connect Fittings used on this vehicle.

- Bartholomew (1)
- Q Release (2)
- Squeeze to Release (3)
- Sliding Retainer (4)
- Push Down TI (5)



Refer to [Fuel and Evaporative Emission Hose/Pipe Connection Cleaning Caution](#).

Using compressed air, blow any dirt or debris from around the connection.

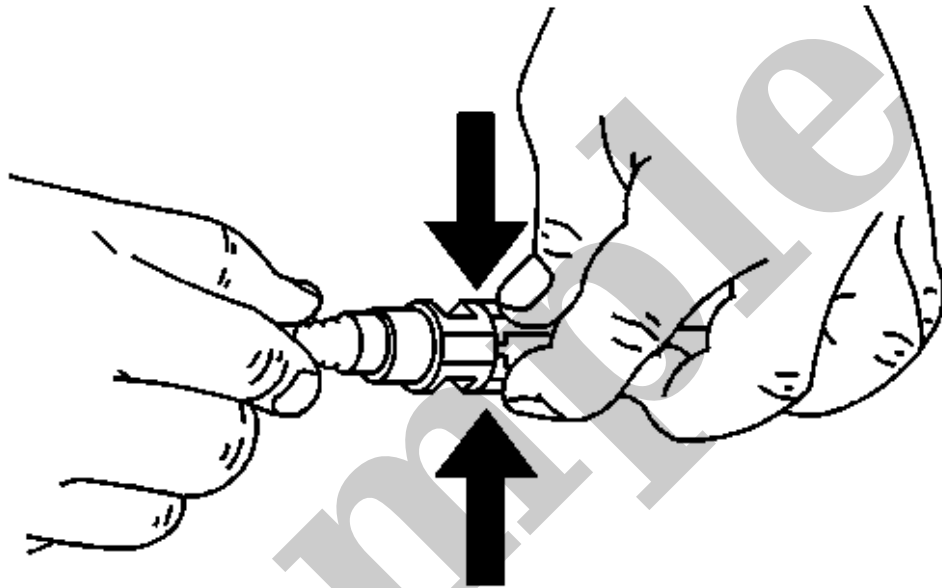

3.

This step applies to Bartholomew style connector ONLY. Squeeze the plastic quick connect fitting release tabs.