

# Your Ultimate Source for OEM Repair Manuals

FactoryManuals.net is a great resource for anyone who wants to save money on repairs by doing their own work. The manuals provide detailed instructions and diagrams that make it easy to understand how to fix a vehicle.

## **2003 CHEVROLET Matiz / Spark (M150) OEM Service and Repair Workshop Manual**

[Go to manual page](#)

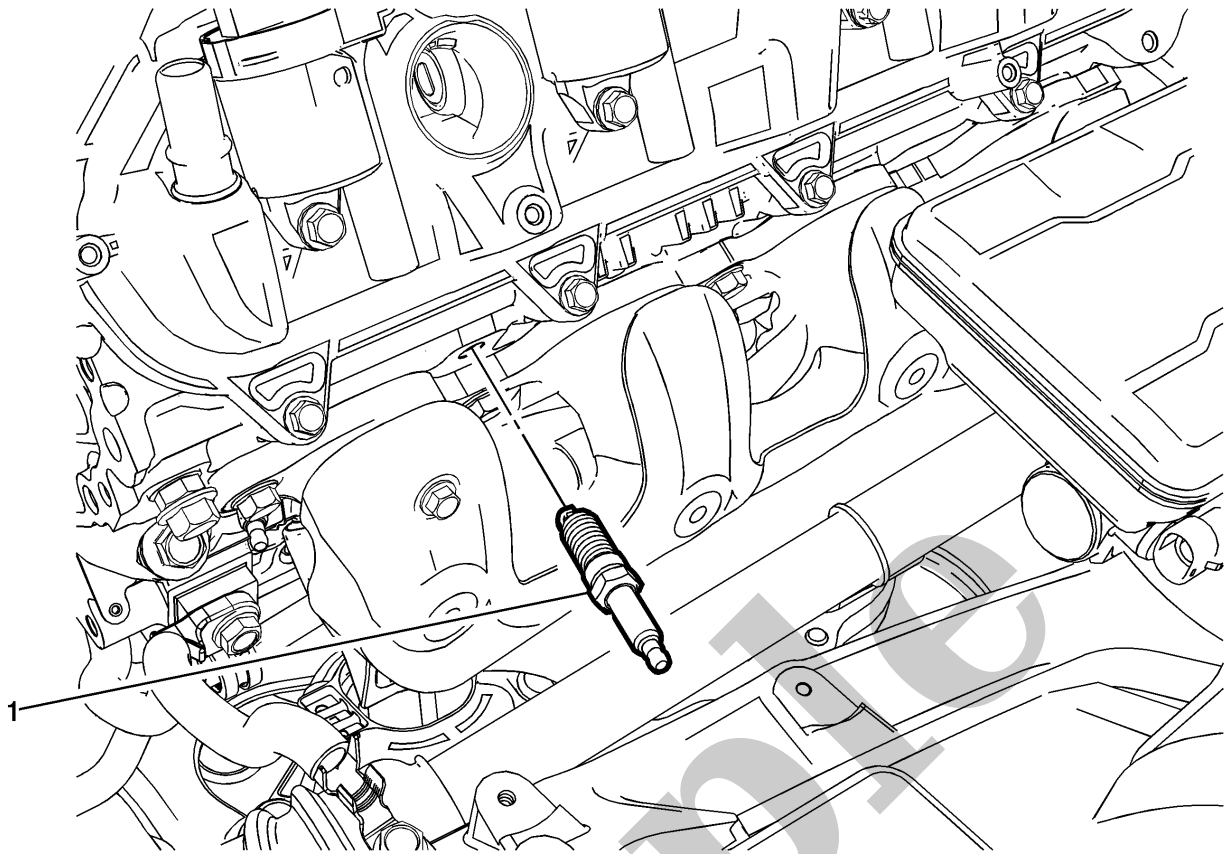

6.

Remove the spark plugs (1) one at a time and place each plug in a tray marked with the corresponding cylinder numbers.

#### Installation Procedure

YOUR CURRENT VEHICLE

# Heated Oxygen Sensor Replacement - Bank 1 Sensor 1

Heated Oxygen Sensor Replacement - Bank 1 Sensor 1

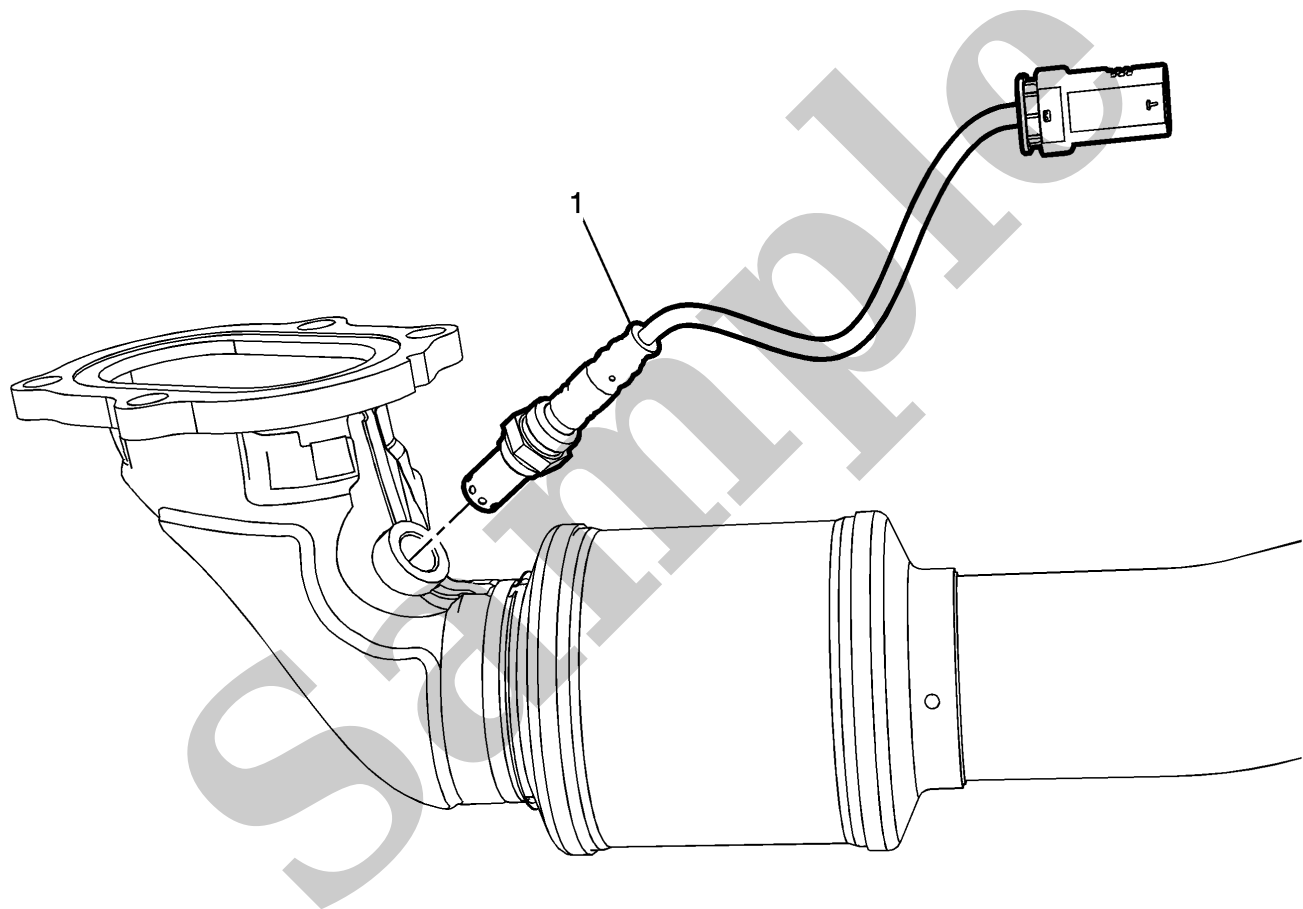

## Heated Oxygen Sensor Replacement - Bank 1 Sensor 1

Callout	Component Name
WARNING	
Warning	

Callout	Component Name
	<p data-bbox="268 197 1398 275">3. If replacing, perform the HO2S heater resistance learned values reset. <a href="#">HO2S Heater Resistance Learned Values Reset</a></p> <div data-bbox="233 297 1528 383"><b>NOTE</b></div> <p data-bbox="252 416 322 448"><b>Note</b></p> <ul data-bbox="284 472 1501 999" style="list-style-type: none"><li>• The heated oxygen sensor in-line connector and louvered end <b>MUST</b> be kept clear of all grease, dirt, and other contaminants. Do <b>NOT</b> use cleaning solvents of any type. Do <b>NOT</b> drop or roughly handle the sensor.</li><li>• The heated oxygen sensor <b>MAY</b> be difficult to remove when the engine temperature is less than 48°C (120°F).</li><li>• A special anti-seize compound is used on the heated oxygen sensor threads. The compound consists of liquid graphite and glass beads. The graphite will burn away, but the glass beads will remain, making the sensor easier to remove. New or service sensors will have the compound already applied to the threads. IF a sensor is removed and is to be reinstalled, the threads <b>MUST</b> have an anti-seize compound applied before installation. <a href="#">Adhesives, Fluids, Lubricants, and Sealers</a></li></ul> <p data-bbox="233 1037 339 1068"><b>Tighten</b></p> <p data-bbox="233 1081 440 1113">42 N·m (31 lb ft)</p>

Callout	Component Name
	<p>In order to avoid being burned, do not service the exhaust system while it is still hot. Service the system when it is cool.</p>
<b>WARNING</b>	
<p><b>Warning</b></p> <p>Avoid contact with HOT components. Wear safety glasses and protective gloves to avoid personal injury.</p>	
<p><b>Preliminary Procedure</b></p> <p>Catalytic Converter Replacement - Left Side</p>	
1	<p>Heated Oxygen Sensor</p> <div> <p><b>CAUTION</b></p> <p><b>Caution</b></p> <p>Refer to <a href="#">Component Fastener Tightening Caution</a>.</p> </div> <div> <p><b>CAUTION</b></p> <p><b>Caution</b></p> <p>Refer to <a href="#">Heated Oxygen and Oxygen Sensor Caution</a>.</p> </div> <div> <p><b>CAUTION</b></p> <p><b>Caution</b></p> <p>Refer to <a href="#">Heated Oxygen Sensor Resistance Learn Reset Caution</a>.</p> </div> <div> <p><b>CAUTION</b></p> <p><b>Caution</b></p> <p>The use of excessive force may damage the threads in the exhaust manifold/pipe.</p> </div> <p><b>Procedure</b></p> <ol style="list-style-type: none"> <li>1. Disconnect the heated oxygen sensor electrical connector.</li> <li>2. If reinstalling the old sensor, coat the threads with anti-seize compound. <a href="#">Adhesives, Fluids, Lubricants, and Sealers</a></li> </ol>