

Your Ultimate Source for OEM Repair Manuals

FactoryManuals.net is a great resource for anyone who wants to save money on repairs by doing their own work. The manuals provide detailed instructions and diagrams that make it easy to understand how to fix a vehicle.

2001 FORD Fiesta 3 Doors OEM Service and Repair Workshop Manual

[Go to manual page](#)

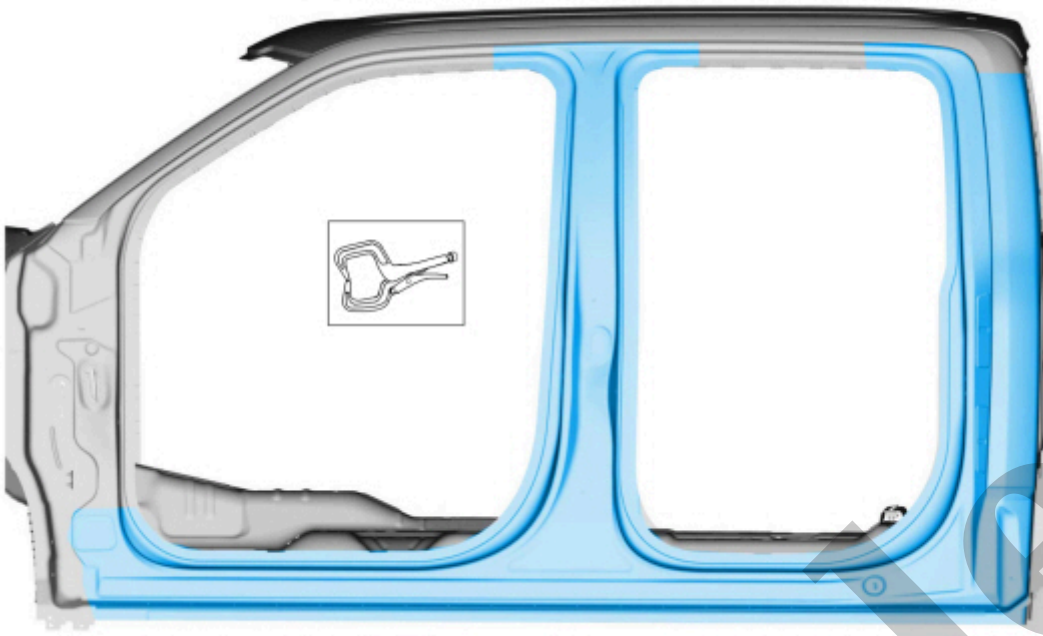

E333131

[Click here to learn about symbols, color coding, and icons used in this manual.](#)

40. Complete joining of body side section to backing plates.

Refer to: [Joining Techniques](#)(501-25 Body Repairs - General Information, General Procedures).

41. Seam weld all sectioning joints using a MIG (metal inert gas) welder set up for aluminum repair.

Use the General Equipment: MIG/MAG Welding Equipment

3	W717186-S900	EN	DP11-200/H	SA-0400/SA-0402	-	W790377-S900	-
4	W708717-S900	AW	DP11-200/H	SA-0400/SA-0402	-	W790377-S900	-
5	W710246-S900	BN	DP10-200/H	SA-0400/SA-0402	-	W790377-S900	-
6	W708717-S900	AW	DG10-220/H	SA-0400/SA-0402	-	W790377-S900	-
7	W717186-S900	EN	DG11-220/H	SA-0400/SA-0402	-	W790377-S900	-

Refer to: [Joining Techniques](#)(501-25 Body Repairs - General Information, General Procedures).

Use the General Equipment: Self-Piercing Rivet (SPR) Remover/Installer

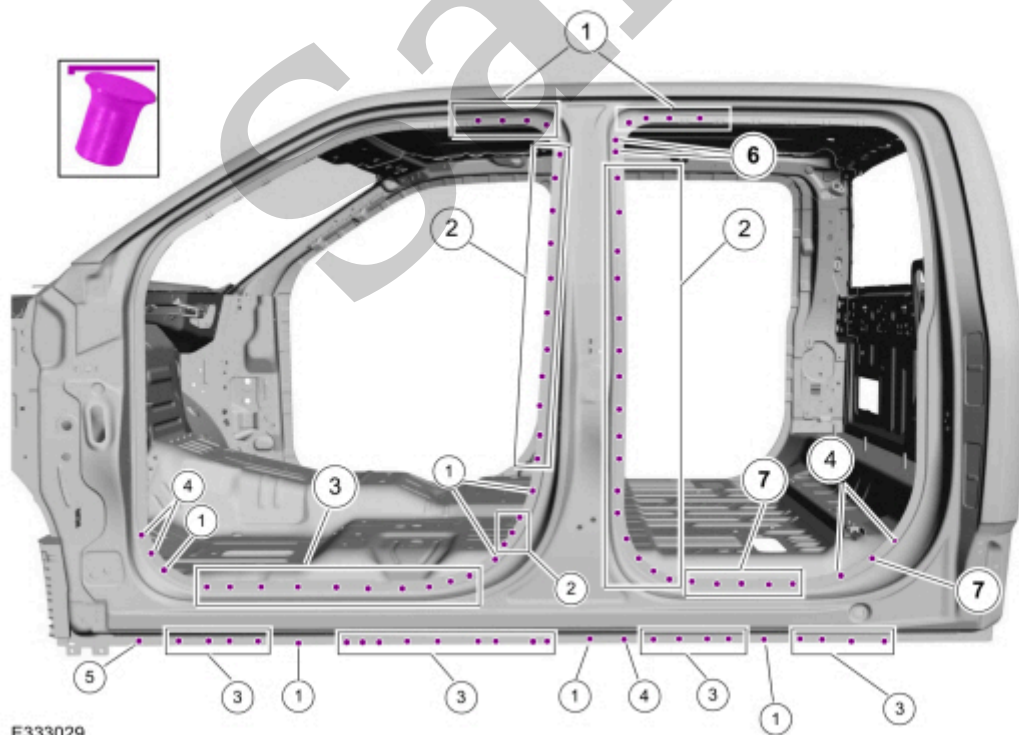

E333029

Use the General Equipment: Blind Rivet Gun

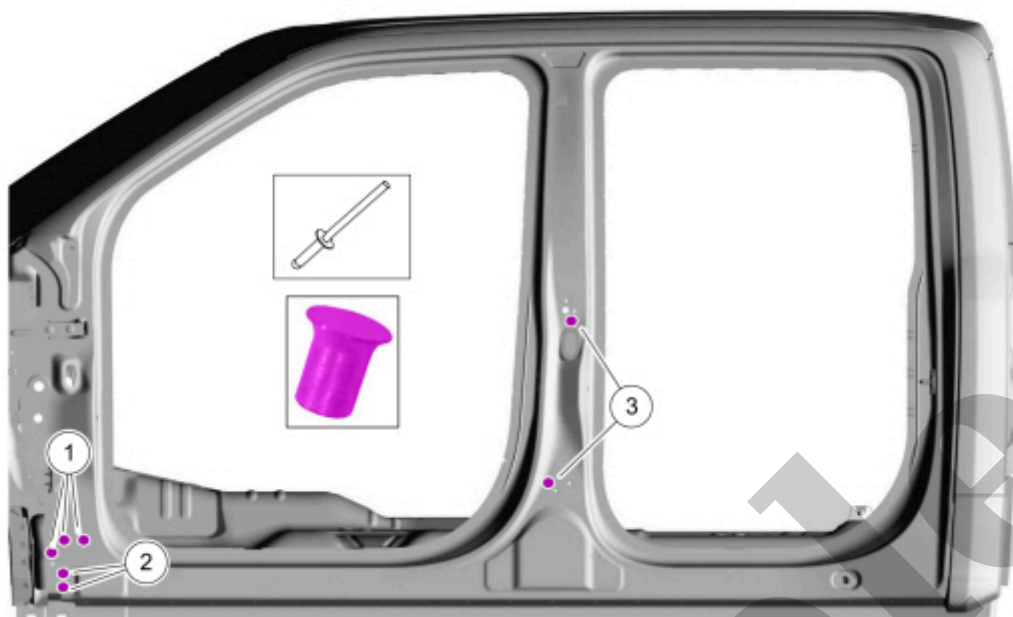

E257692

[Click here to learn about symbols, color coding, and icons used in this manual.](#)

45. Drill for fasteners.

Use the General Equipment: 6.5 mm Drill Bit

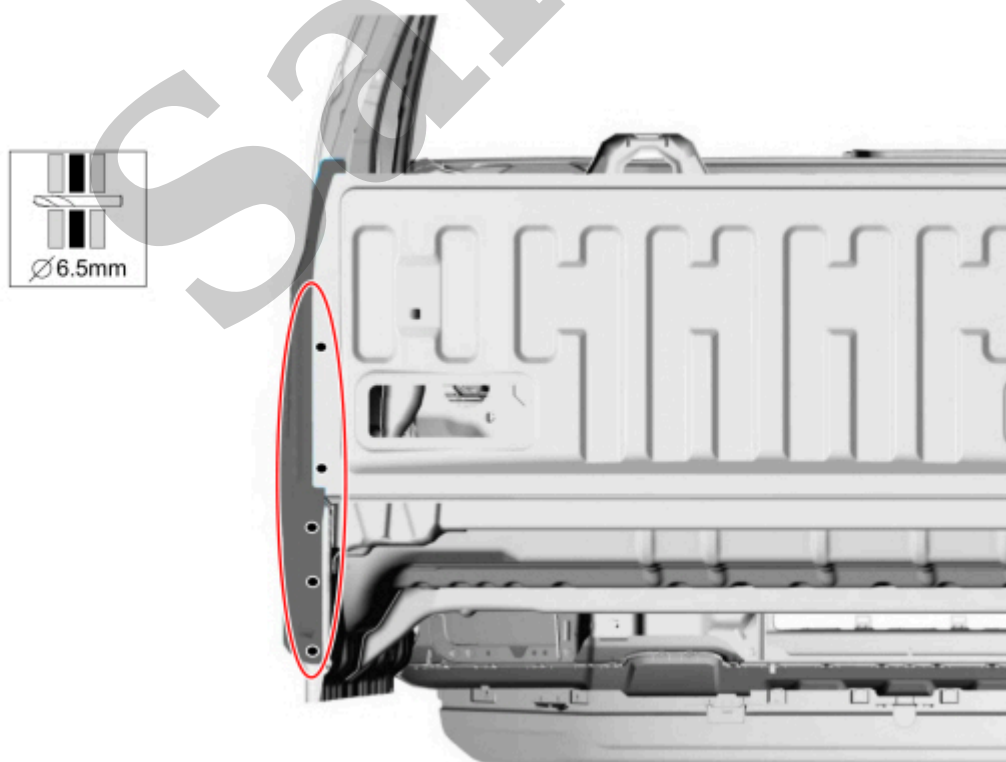

E257296

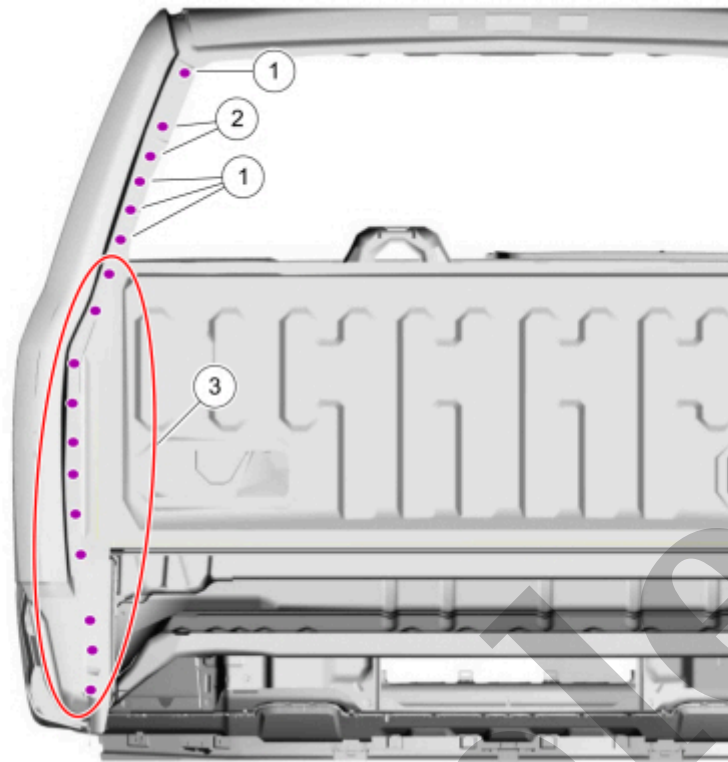

E199485

[Click here to learn about symbols, color coding, and icons used in this manual.](#)

47. Apply additional NVH (noise, vibration and harshness) foam to baffles to assure complete sealing.

Material : Flexible Foam Repair / 3M™ 08463, LORD Fusor® 121

48. Metal finish using typical aluminum repair techniques and a fiber-based body filler.

Refer to: [Special Repair Considerations for Aluminum Repairs](#)(501-25 Body Repairs - General Information, Description and Operation).

49. Prime the rear window glass opening channel using a Ford approved epoxy based primer.



[Click here to learn about symbols, color coding, and icons used in this manual.](#)

51. **Seam Sealing:**

All seams must be sealed to production level.

Material : Seam Sealer / TA-2-B, 3M™ 08308, LORD Fusor® 803DTM

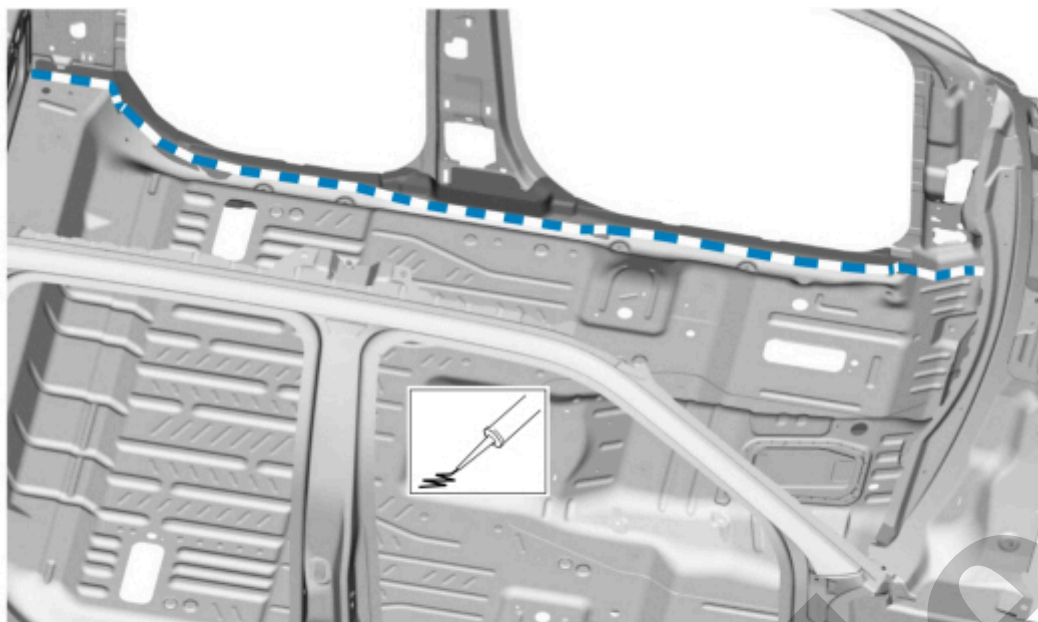

E199985

[Click here to learn about symbols, color coding, and icons used in this manual.](#)

53. Refinish using a Ford approved paint system and typical refinishing techniques.

54. Unmask the rear window glass opening channel.

- Door strikers.

Torque : 18 lb.ft (25 Nm)

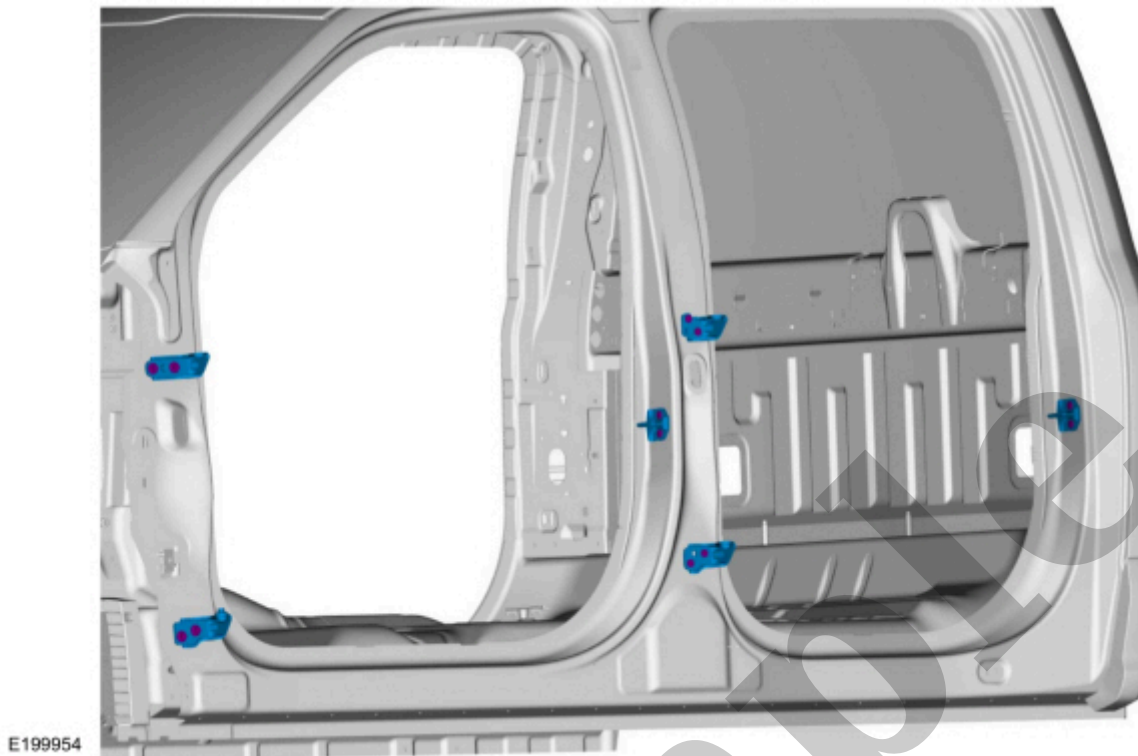

[Click here to learn about symbols, color coding, and icons used in this manual.](#)

58. Install the roof and body side trim.

Refer to: [Bodyside Moulding](#)(501-08 Exterior Trim and Ornamentation, Removal and Installation).

Refer to: [Roof Moulding](#)(501-08 Exterior Trim and Ornamentation, Removal and Installation).

59. Install the front and rear doors.

Refer to: [Front Door - Regular Cab/SuperCrew](#)(501-03 Body Closures, Removal and Installation).

Refer to: [Rear Door - SuperCrew](#)(501-03 Body Closures, Removal and Installation).

60. Install the front fender.

Refer to: [Fender](#)(501-02 Front End Body Panels, Removal and Installation).

61. Align the front and rear doors.

Refer to: [Front Door Alignment - Regular Cab/SuperCrew](#)(501-03 Body Closures, General Procedures).

Refer to: [Rear Door Alignment - SuperCrew](#)(501-03 Body Closures, General Procedures).

62. Repower the SRS (supplemental restraint system) .



Rocker Panel Inner Reinforcement - Regular Cab

<i>501-29 Side Panel Sheet Metal Repairs</i>	<i>2022 F-150</i>
<i>Removal and Installation</i>	<i>Procedure revision date: 10/23/2020</i>

Rocker Panel Inner Reinforcement - Regular Cab

Removal

WARNING

Electric vehicles damaged by a crash may have compromised high voltage safety systems and present a potential high voltage electrical shock hazard. Exercise caution and wear appropriate Personal Protective Equipment (PPE) safety gear, including high voltage safety gloves and boots. Remove all metallic jewelry, including watches and rings. Isolate the HV system as directed by the Ford Emergency Response Guide for the vehicle. Failure to follow these instructions may result in serious personal injury or death.

NOTICE

Battery electric vehicle (BEV), hybrid electric vehicle (HEV) and plug-in hybrid electric vehicle (PHEV) contain a high-voltage battery. Before cutting or welding near the high-voltage battery it must be removed to avoid damage.

1. WARNING

Before beginning any service procedure in this manual, refer to health and safety warnings in section 100-00 General Information. Failure to follow this instruction may result in serious personal injury.

Refer to: [Health and Safety Precautions](#)(100-00 General Information, Description and Operation).

5. Remove the A-pillar reinforcement.

Refer to: [A-Pillar Outer Panel Section and Reinforcement](#)(501-29 Side Panel Sheet Metal Repairs, Removal and Installation).

6. Remove the rear window glass.

Refer to: [Fixed Glass](#)(501-11 Glass, Frames and Mechanisms, General Procedures).

7. Remove the roof ditch sealer.

Use the General Equipment: Hot Air Gun

Use the General Equipment: Scraper for Straight Edges

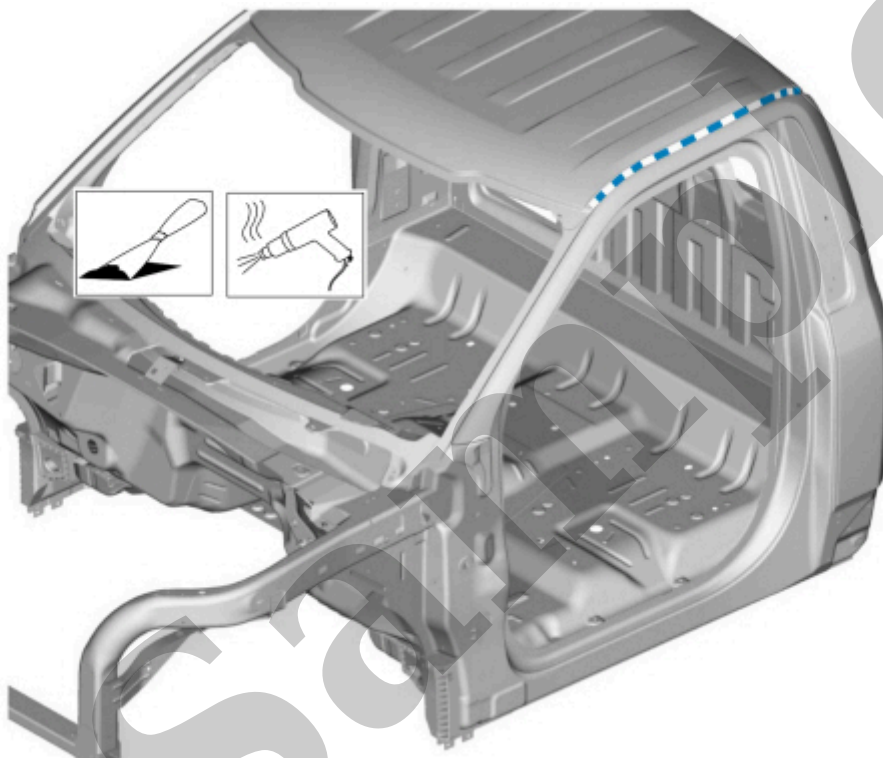

[Click here to learn about symbols, color coding, and icons used in this manual.](#)

8. Carefully cut the
outer panel only

Use the General Equipment: Air Body Saw

Use the General Equipment: Spherical Cutter