

Your Ultimate Source for OEM Repair Manuals

FactoryManuals.net is a great resource for anyone who wants to save money on repairs by doing their own work. The manuals provide detailed instructions and diagrams that make it easy to understand how to fix a vehicle.

2000 CHEVROLET Celta - 3 doors OEM Service and Repair Workshop Manual

[Go to manual page](#)

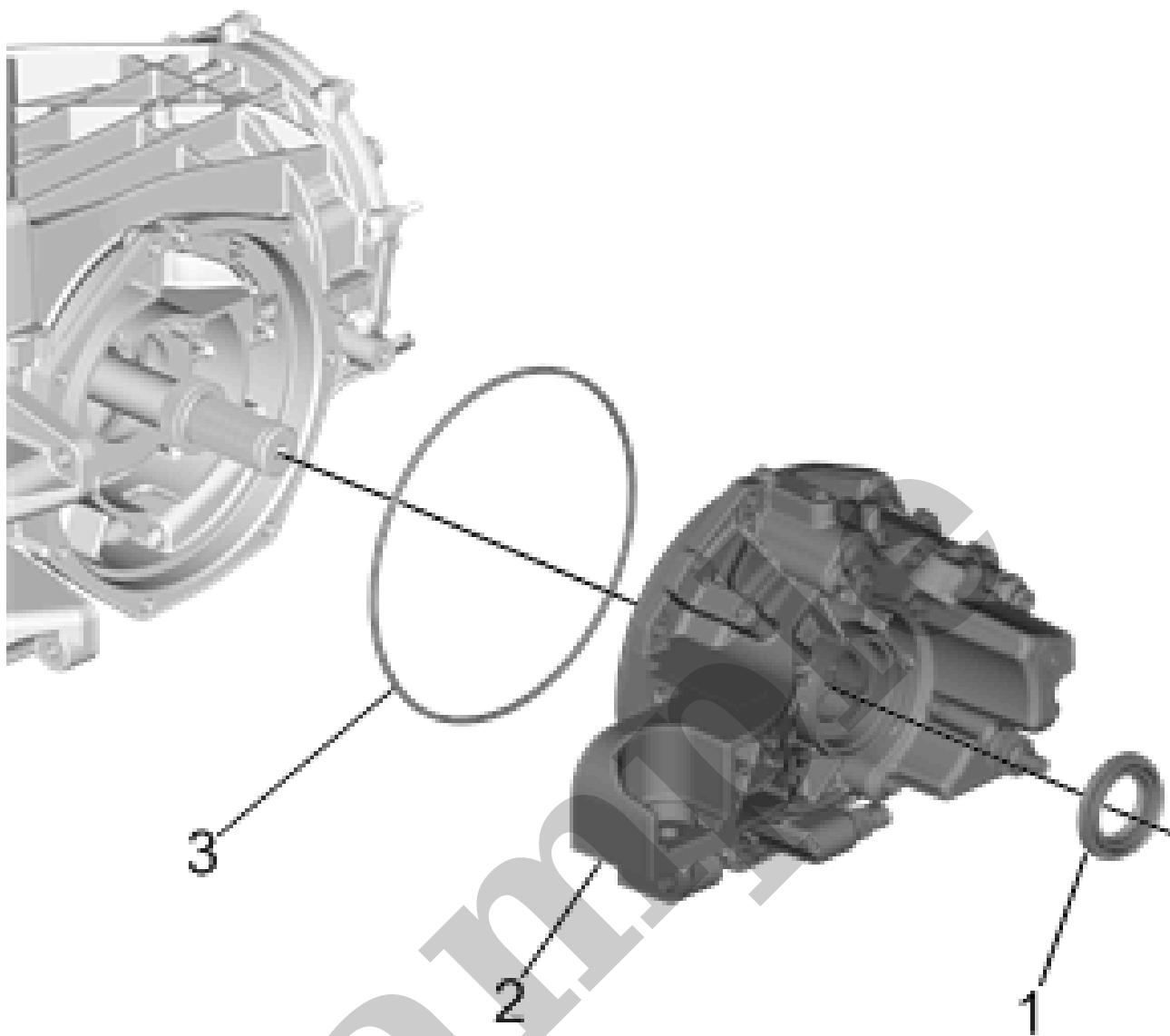

12.

Remove the differential cover (2) from the differential.

13. Remove and discard the rear axle shaft seal (1). Refer to [Rear Axle Shaft Seal Replacement](#).

14. Remove and discard the D-ring (3).

Installation Procedure

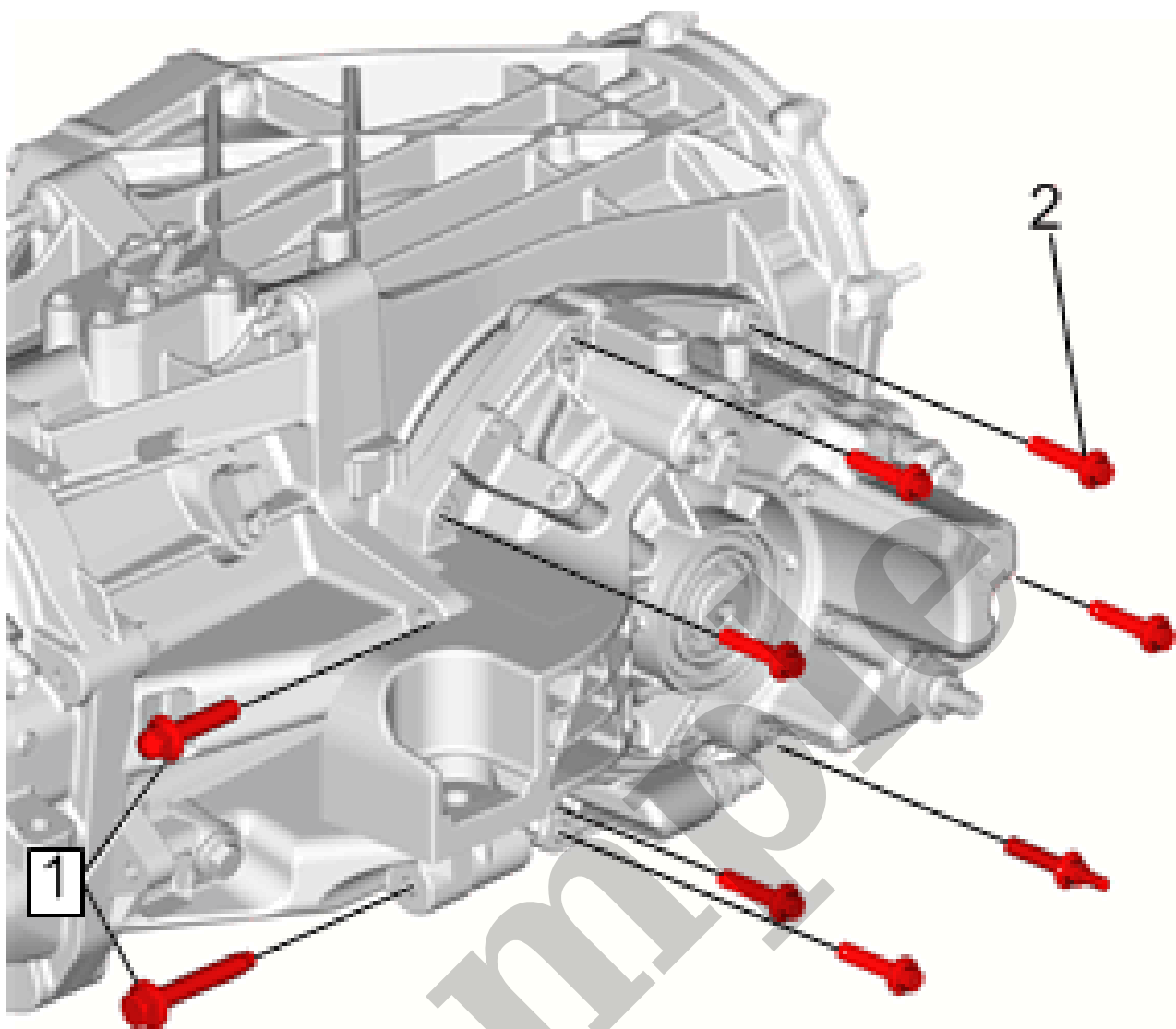

4.

CAUTION

Caution

Refer to [Fastener Caution](#).

Install the differential cover bolts (2). Tighten to **28 N·m (21 lb ft)**.

5. Install the bolts (1) attaching the cover to the transmission. Tighten to **28 N·m (21 lb ft)**

YOUR CURRENT VEHICLE

Differential Carrier Cover and Seal Replacement - Left Side

Differential Carrier Cover and Seal Replacement - Left Side (mLSD)

Removal Procedure

1. Raise and suitably support the vehicle. Refer to [Lifting and Jacking the Vehicle](#).
2. Remove the LH rear tire and wheel assembly. Refer to [Tire and Wheel Removal and Installation](#).
3. Remove the LH wheel drive shaft. Refer to [Rear Wheel Drive Shaft Replacement](#).
4. Remove the LH muffler assembly. Refer to [Exhaust Muffler Replacement - Left Side](#).
5. Drain the fluid from the differential. Refer to [Differential Oil Replacement](#).
6. Support the differential assembly.
7. Remove the LH transmission/axle mount. Refer to [Transmission Mount Replacement](#) or [Transmission Mount Replacement](#).
8. Clean any dirt or debris from around the differential cover (left).



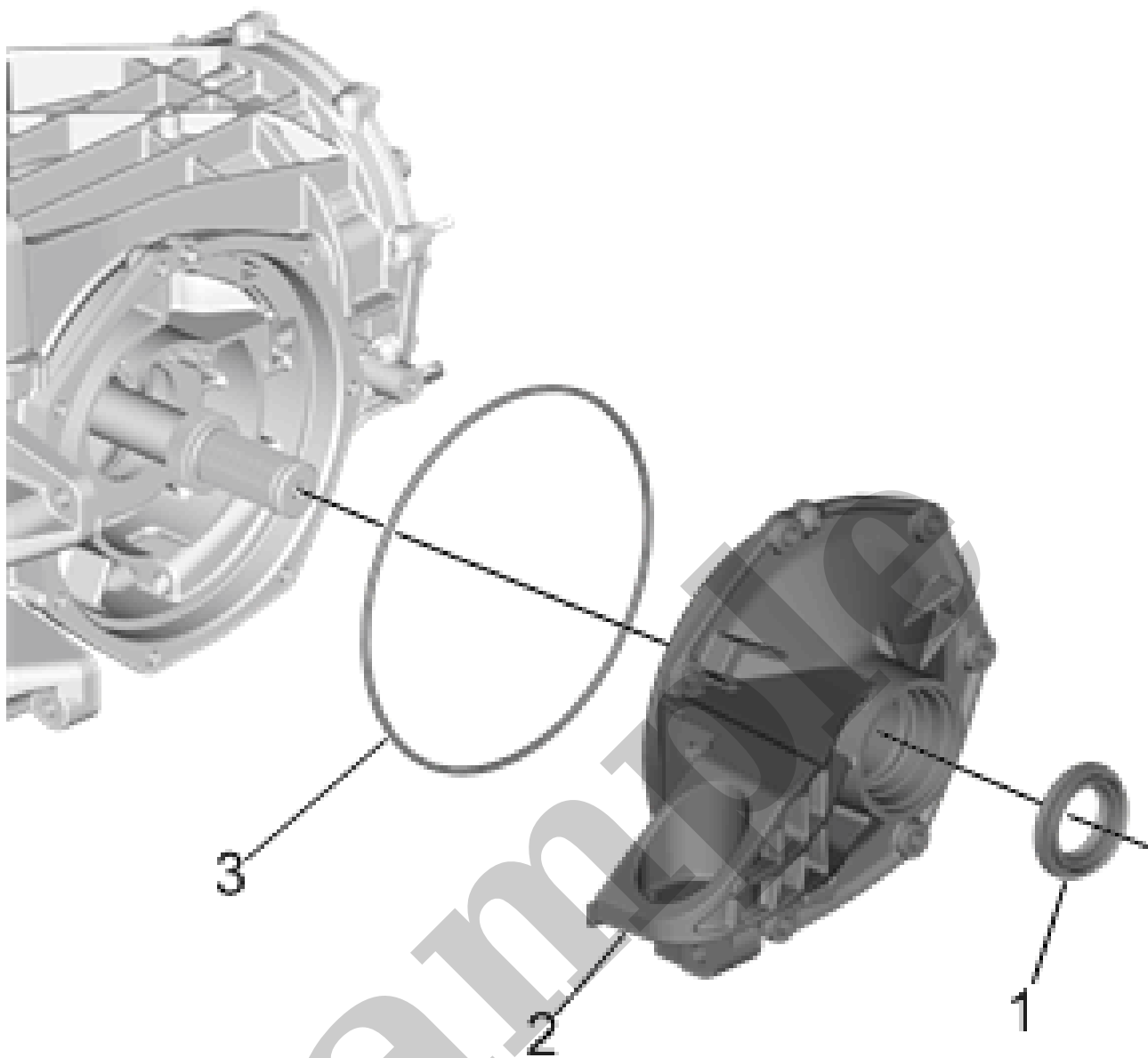

11.
Remove the differential cover (2) from the differential.
12. Remove and discard the rear axle shaft seal (1). Refer to [Rear Axle Shaft Seal Replacement](#).
13. Remove and discard the D-ring (3).

Installation Procedure