

Your Ultimate Source for OEM Repair Manuals

FactoryManuals.net is a great resource for anyone who wants to save money on repairs by doing their own work. The manuals provide detailed instructions and diagrams that make it easy to understand how to fix a vehicle.

1999 VOLVO V40 OEM Service and Repair Workshop Manual

[Go to manual page](#)

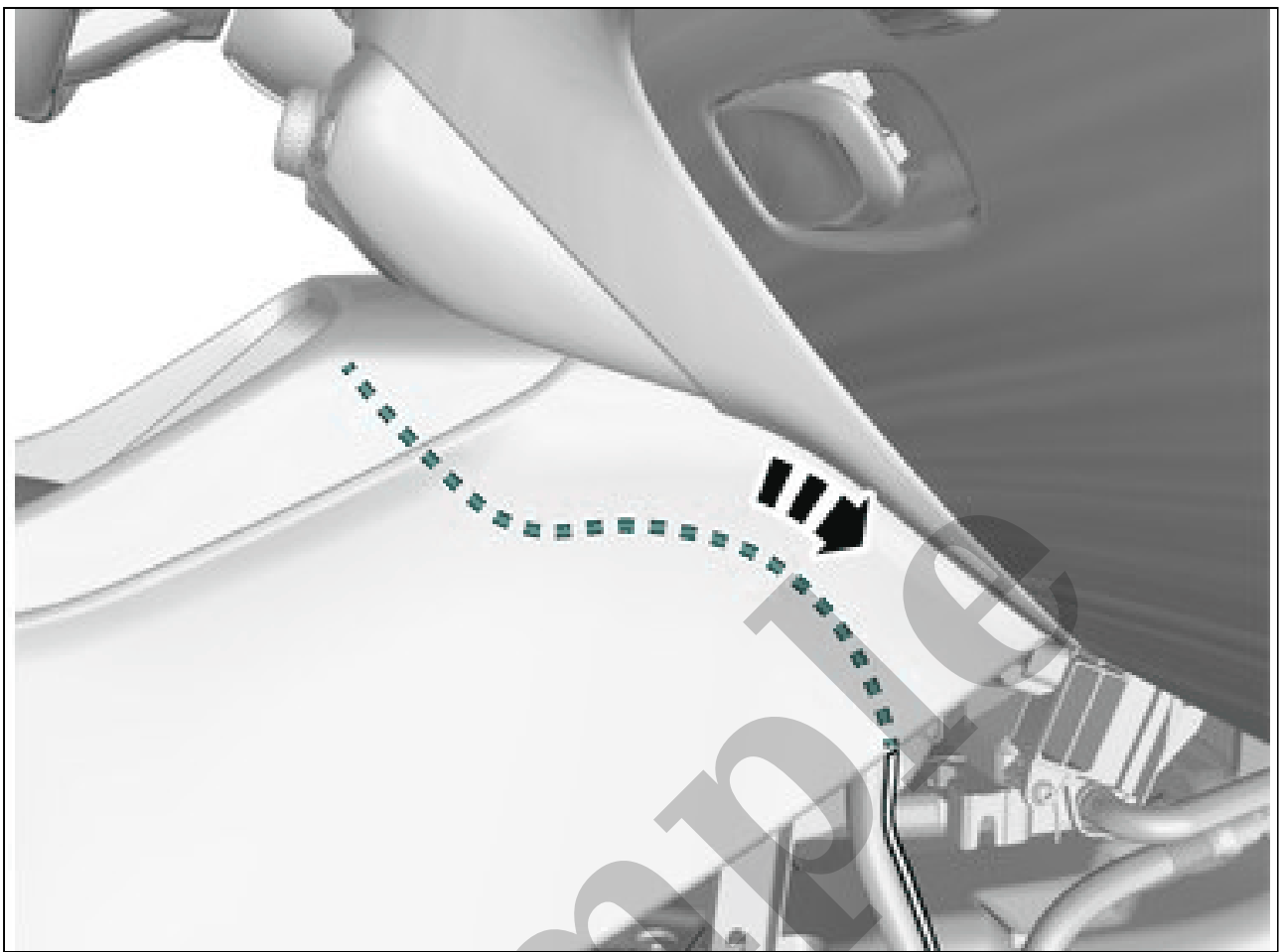

Courtesy of VOLVO CARS CORPORATION

Position/route the cable as illustrated.

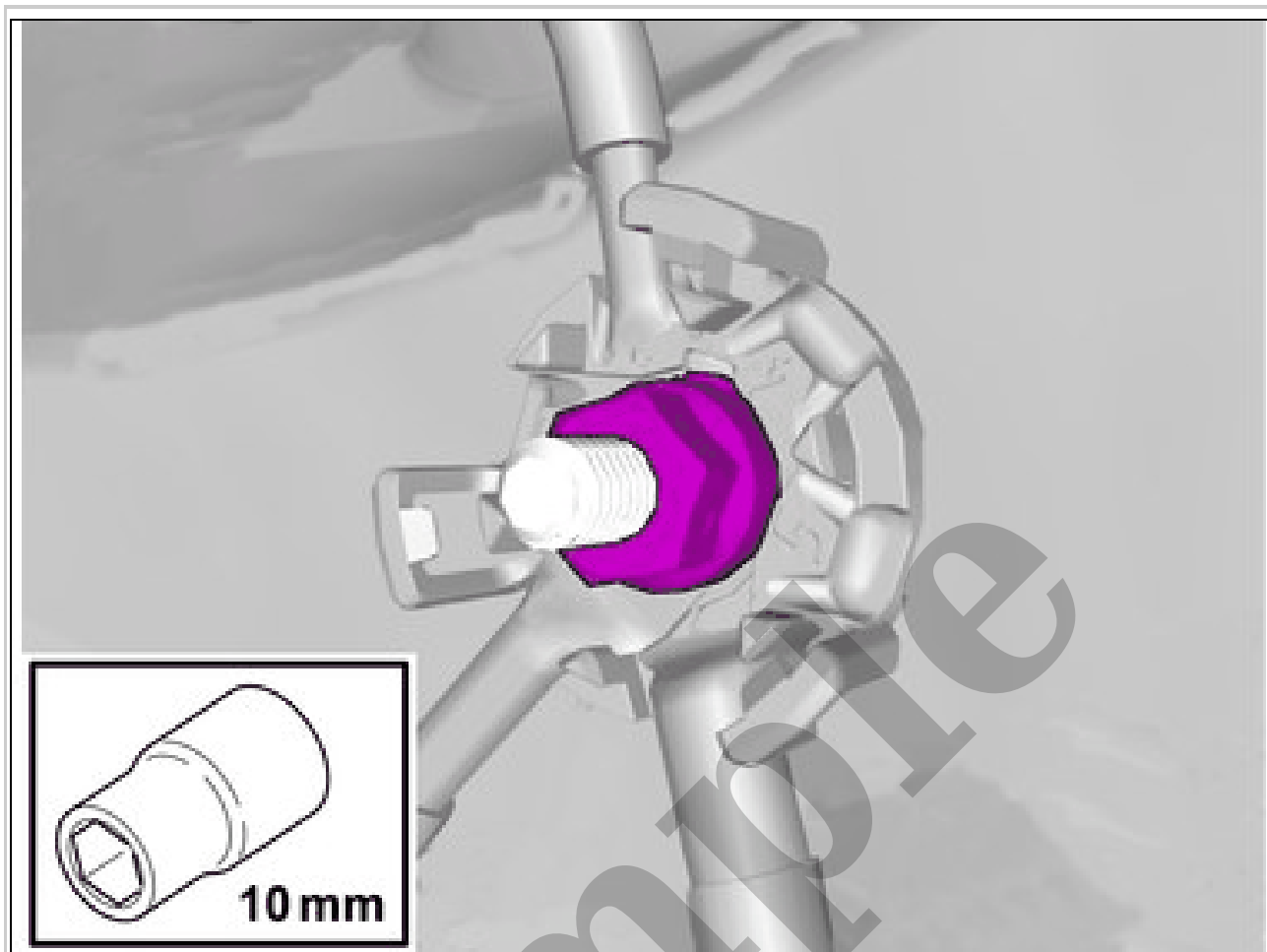

Courtesy of VOLVO CARS CORPORATION

Remove the nut.
The item is to be reused.

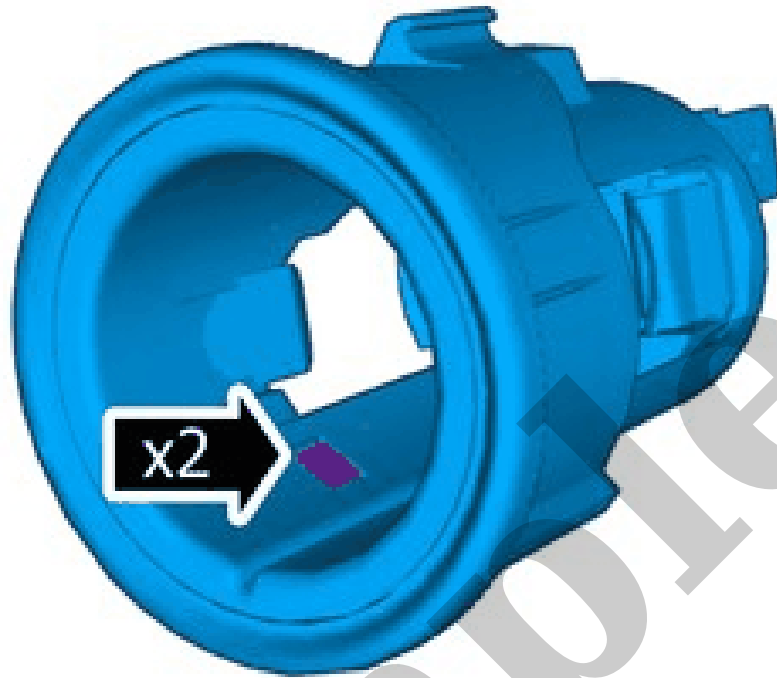

Courtesy of VOLVO CARS CORPORATION

Check that the component has locked in its position.

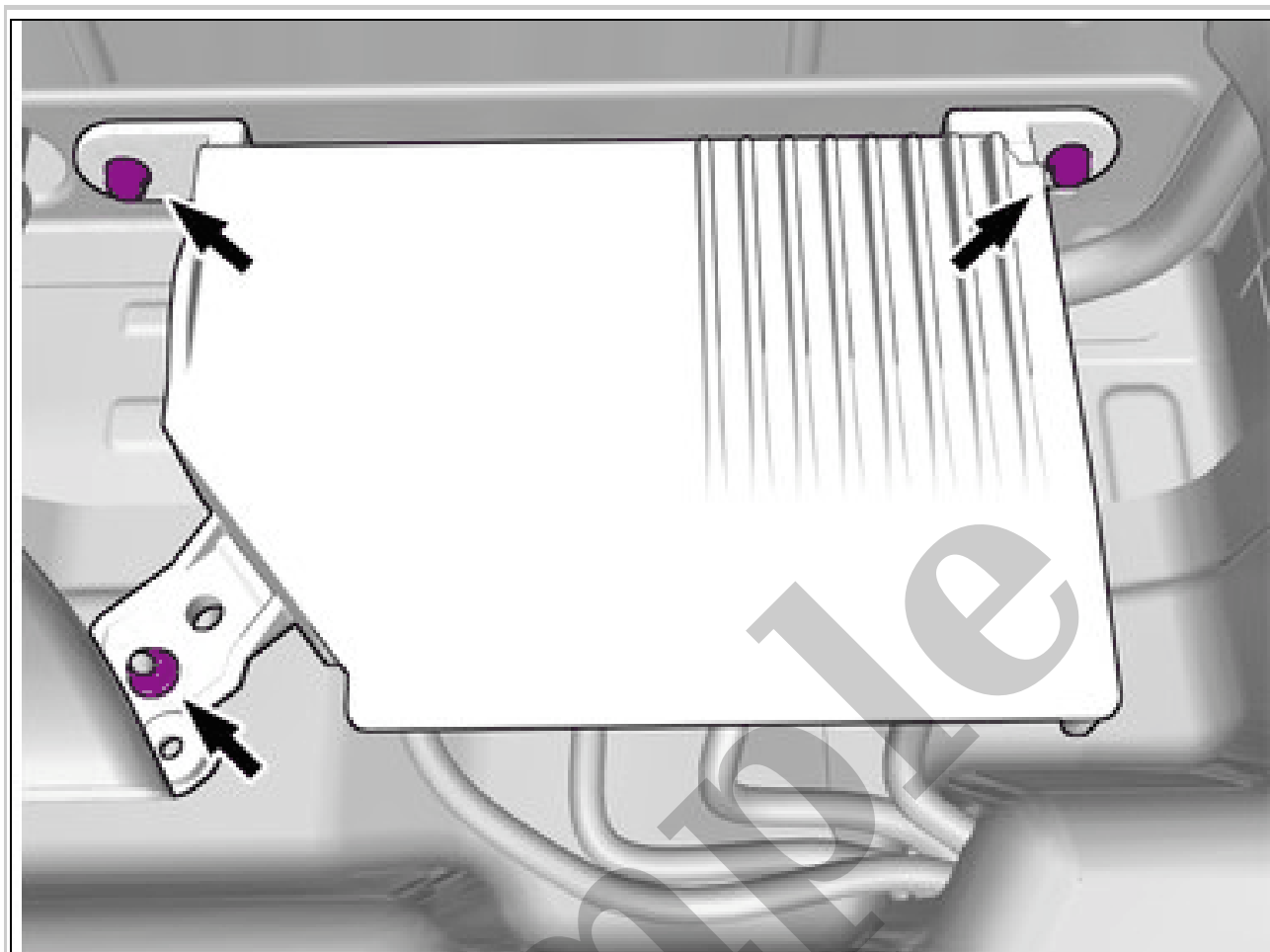

Courtesy of VOLVO CARS CORPORATION

Remove the screws.

Torque: M6, 10Nm

Set the vehicle to Inactive mode, described in user mode. Refer to: USAGE MODE

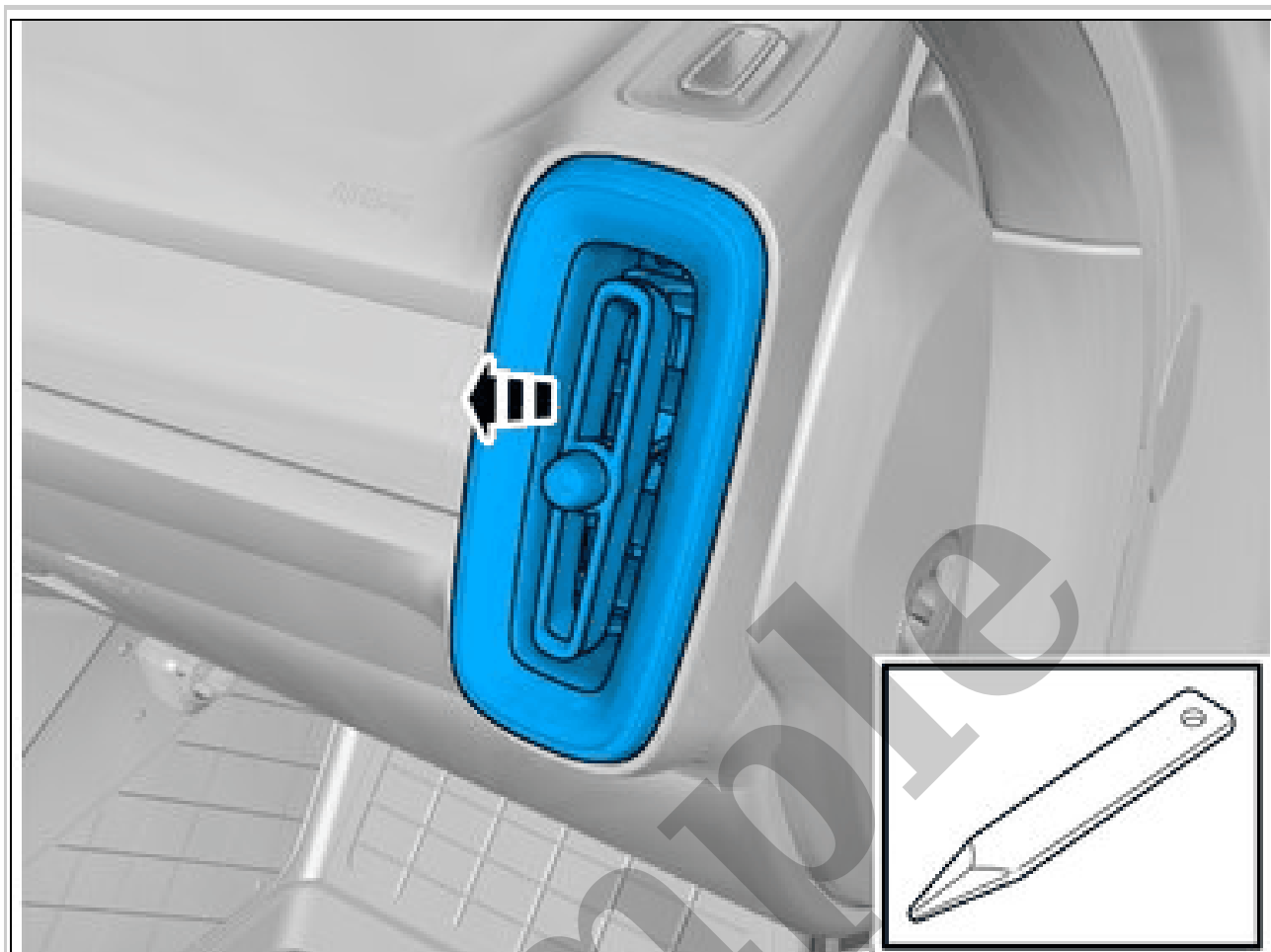

Courtesy of VOLVO CARS CORPORATION

Remove the marked part.

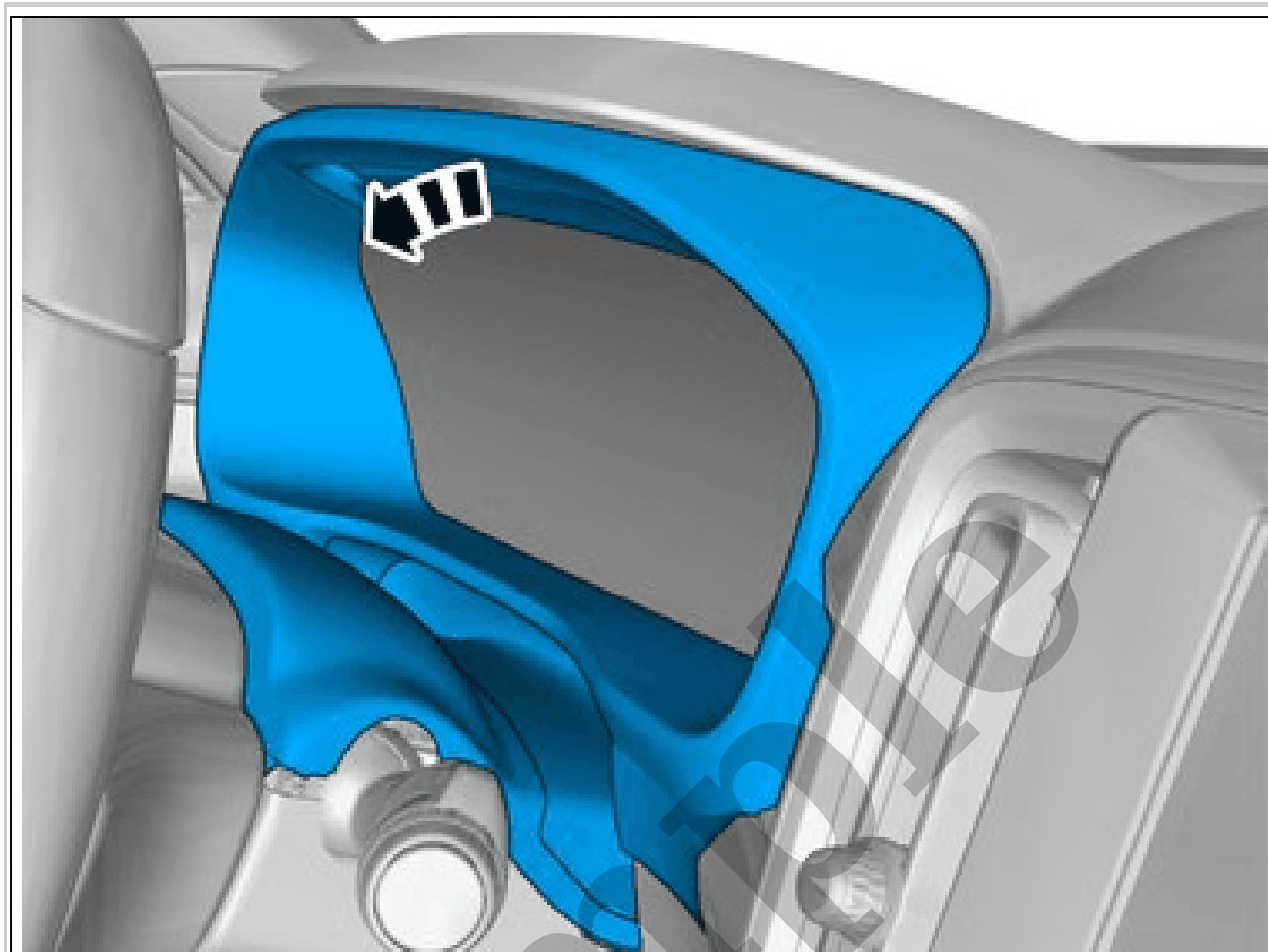

Courtesy of VOLVO CARS CORPORATION

CAUTION: *Observe caution when carrying out this step.*

Remove the marked part.

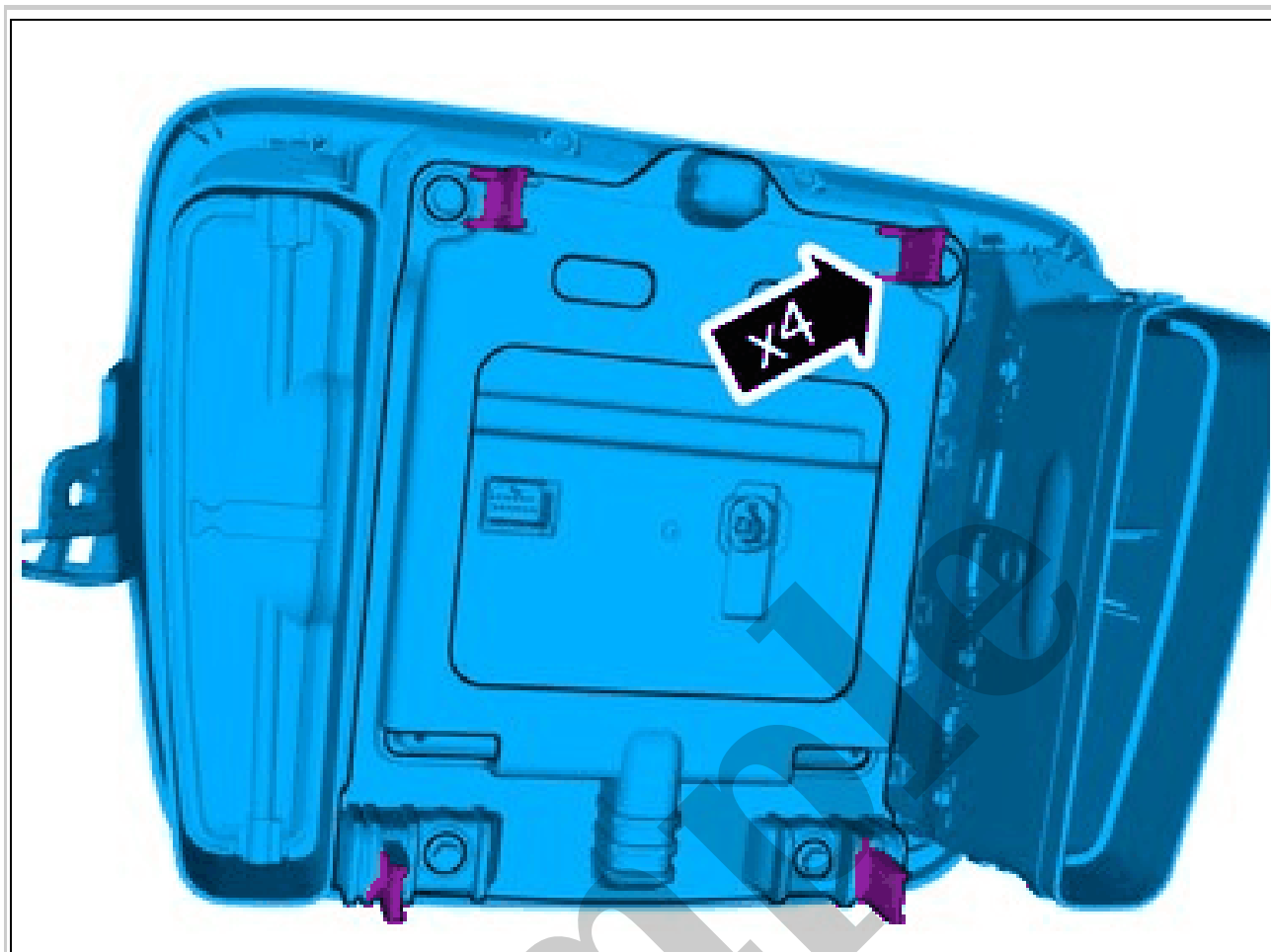

Courtesy of VOLVO CARS CORPORATION

The graphic shows the back of the component.

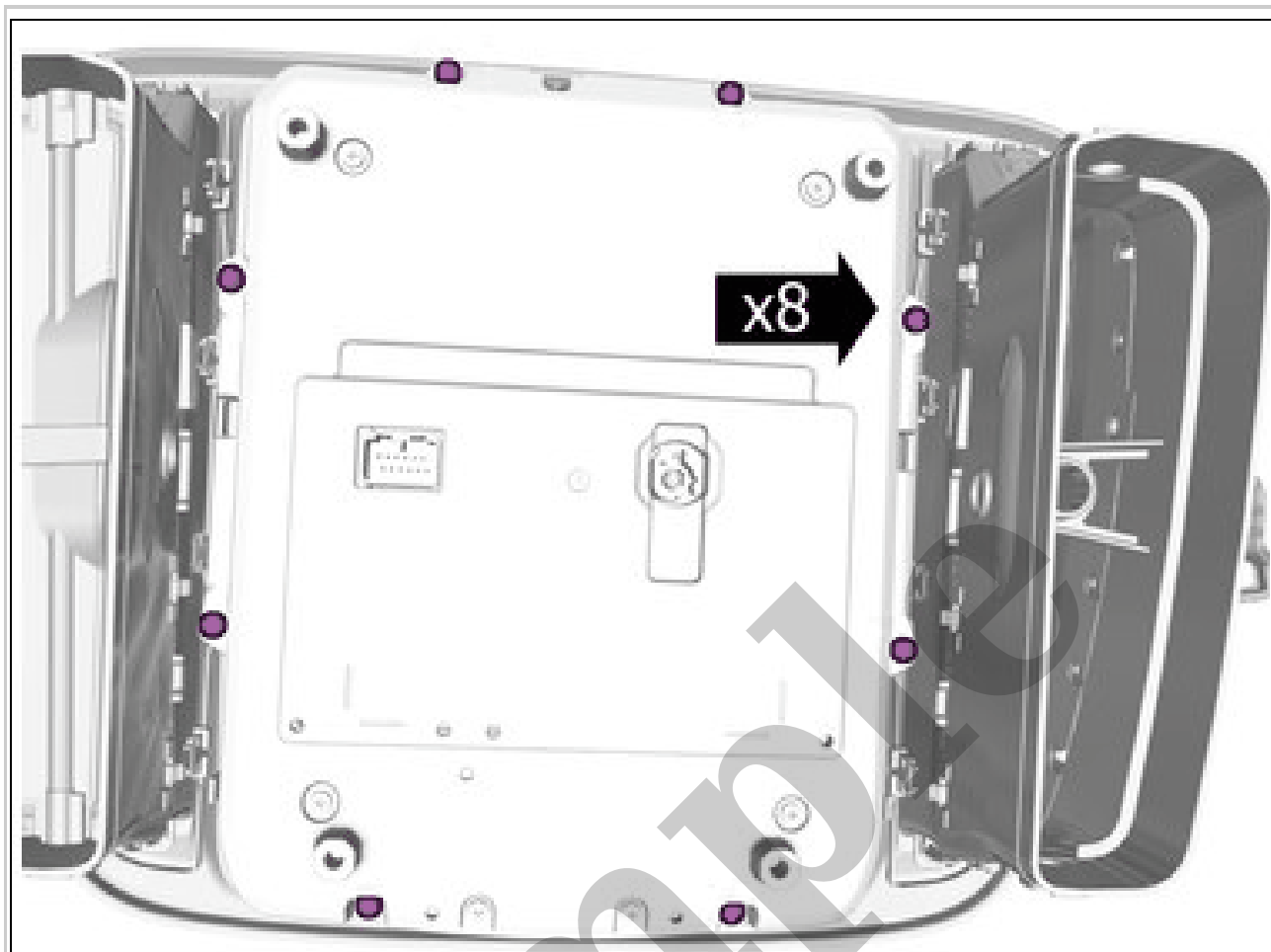

Courtesy of VOLVO CARS CORPORATION

Remove the screws.

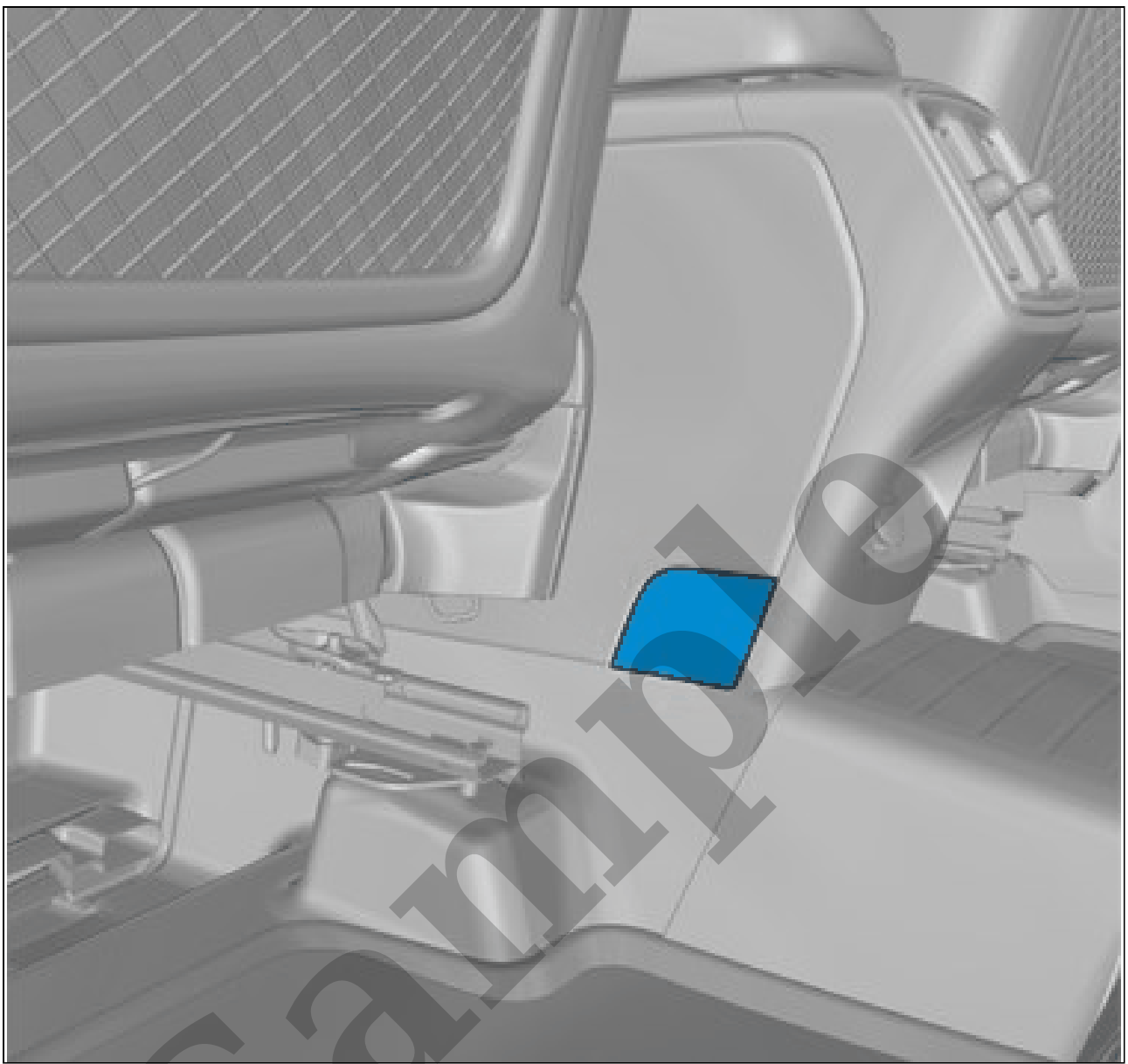

Courtesy of VOLVO CARS CORPORATION

Remove the marked part.
On both sides.
Use: Interior trim remover