

Your Ultimate Source for OEM Repair Manuals

FactoryManuals.net is a great resource for anyone who wants to save money on repairs by doing their own work. The manuals provide detailed instructions and diagrams that make it easy to understand how to fix a vehicle.

1998 FORD Escort 5 Doors OEM Service and Repair Workshop Manual

[Go to manual page](#)



E243701

[Click here to learn about symbols, color coding, and icons used in this manual.](#)

261. 1. Inspect the transmission fluid pump idler gear for damage.
2. Make sure the transmission fluid pump idler gear bearing spins freely and has no excessive end play.

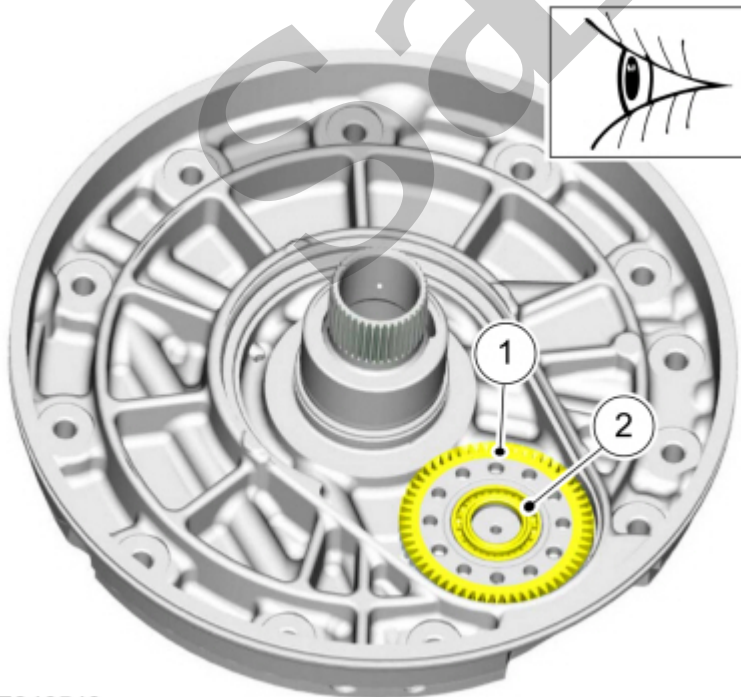

E246543

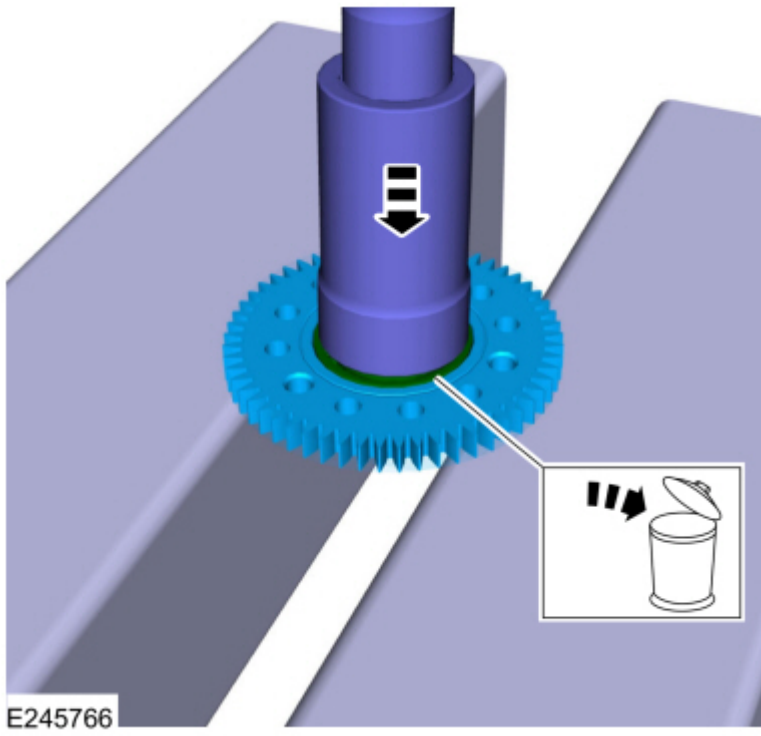

[Click here to learn about symbols, color coding, and icons used in this manual.](#)

264. Remove and discard the stator support seal.

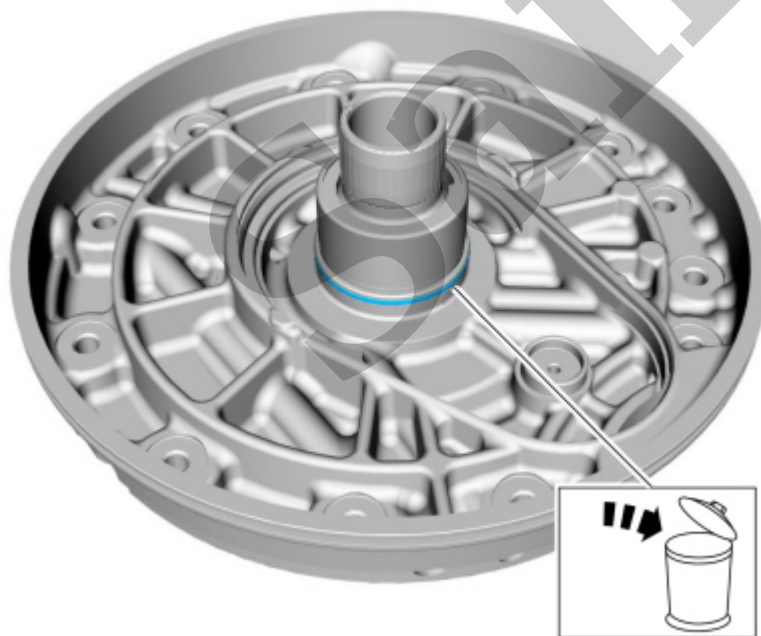

[Click here to learn about symbols, color coding, and icons used in this manual.](#)

265. Clean and inspect the components for damage or excessive wear, replace as necessary.

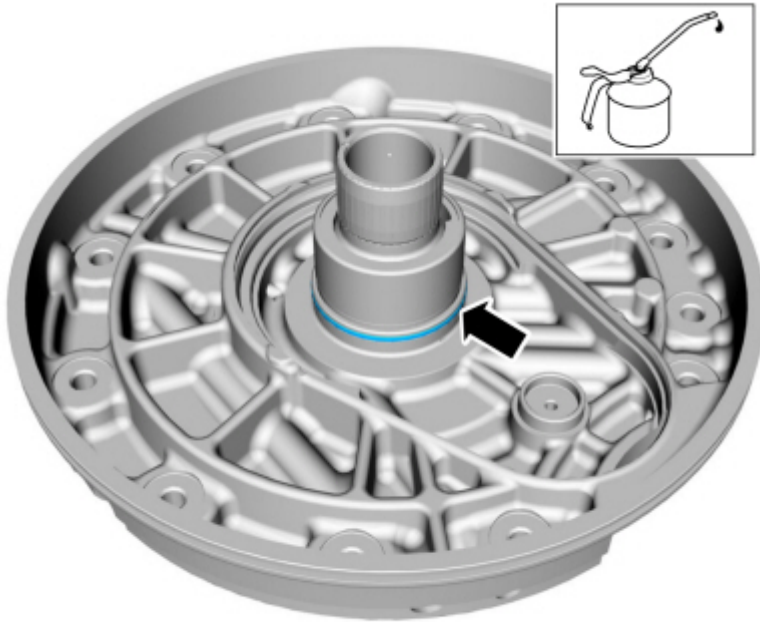

E243873

[Click here to learn about symbols, color coding, and icons used in this manual.](#)

267. If removed, using the special tool and a press, install the new transmission fluid pump idler gear bearing.

Use Special Service Tool : 307-736 Installer, Pump Drive Gear Bearing

Use the General Equipment: Hydraulic Press

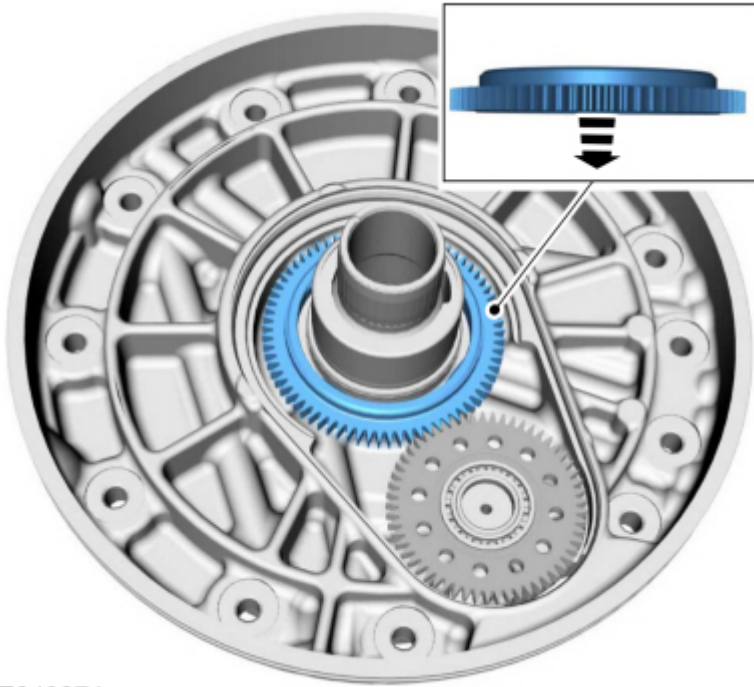

E243874

[Click here to learn about symbols, color coding, and icons used in this manual.](#)

270. Install the front support cover by pressing down evenly by hand.



E243875

[Click here to learn about symbols, color coding, and icons used in this manual.](#)

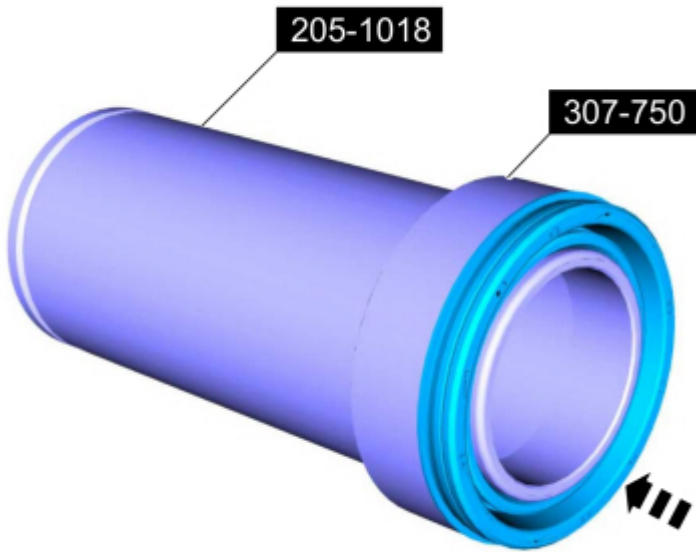

E256311

[Click here to learn about symbols, color coding, and icons used in this manual.](#)

273. Using the special tools, install the new torque converter hub seal.

Use Special Service Tool : 307-750 Installer, Converter Seal , 205-1018 Installation Tube

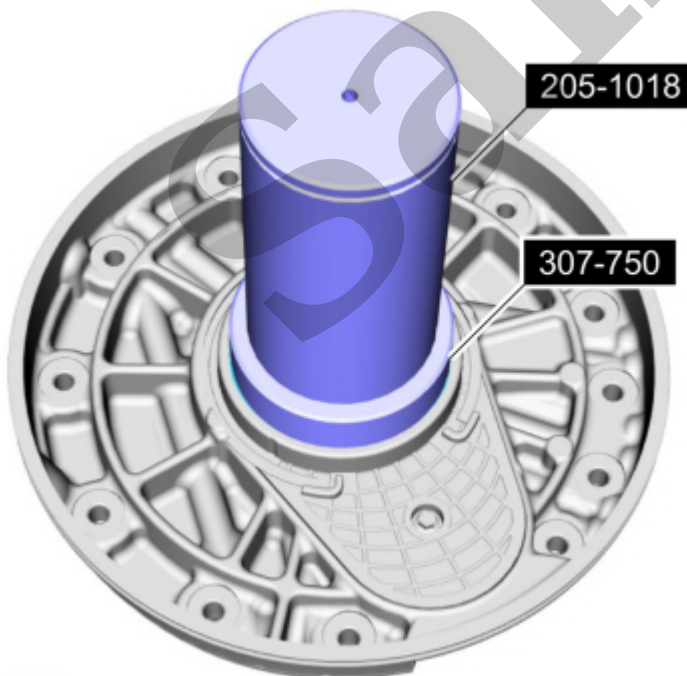

E256312

[Click here to learn about symbols, color coding, and icons used in this manual.](#)

276. Install the new A clutch piston outer seal and the new A clutch piston inner seal. Lubricate the A clutch piston seals with petroleum jelly.

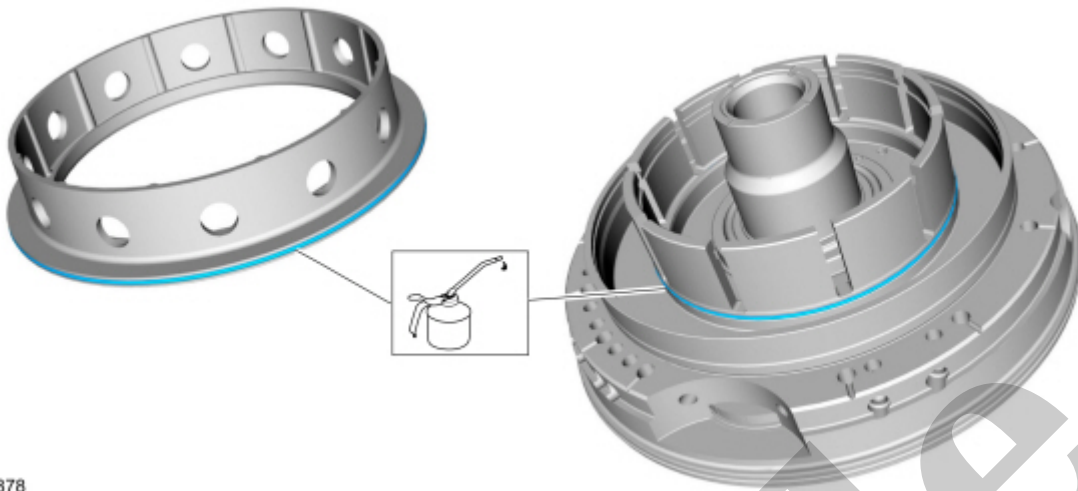

E243878

[Click here to learn about symbols, color coding, and icons used in this manual.](#)

277. Install the A clutch piston by pushing down on the piston until an audible click is heard.

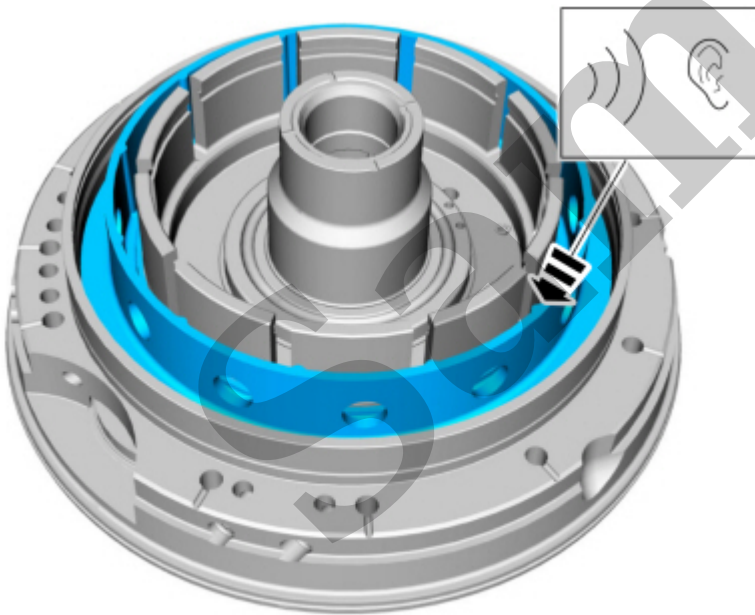

E243879

[Click here to learn about symbols, color coding, and icons used in this manual.](#)

278. Install the A clutch piston return spring with the retaining tabs facing upward.

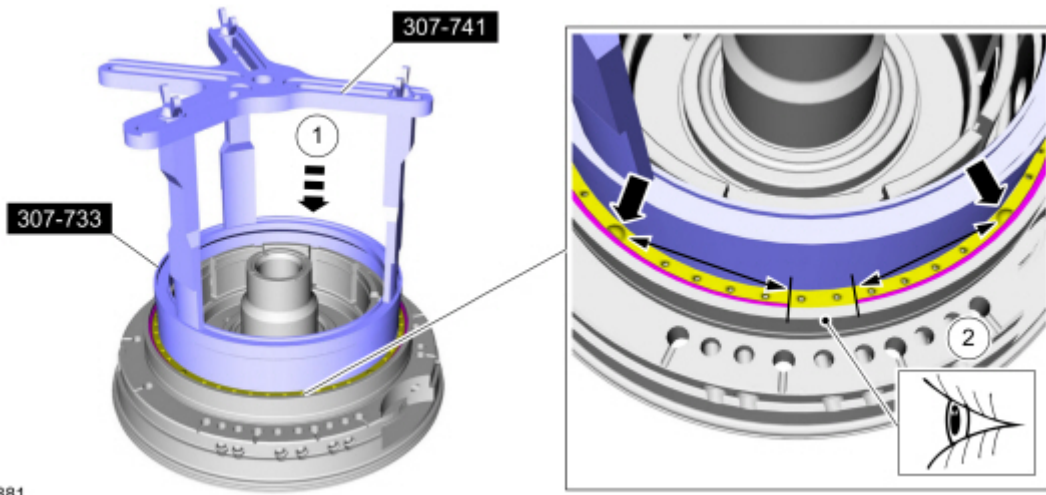

E243881

[Click here to learn about symbols, color coding, and icons used in this manual.](#)

280. 1. Lubricate the B clutch piston seals with petroleum jelly.
2. Install the new B clutch piston.

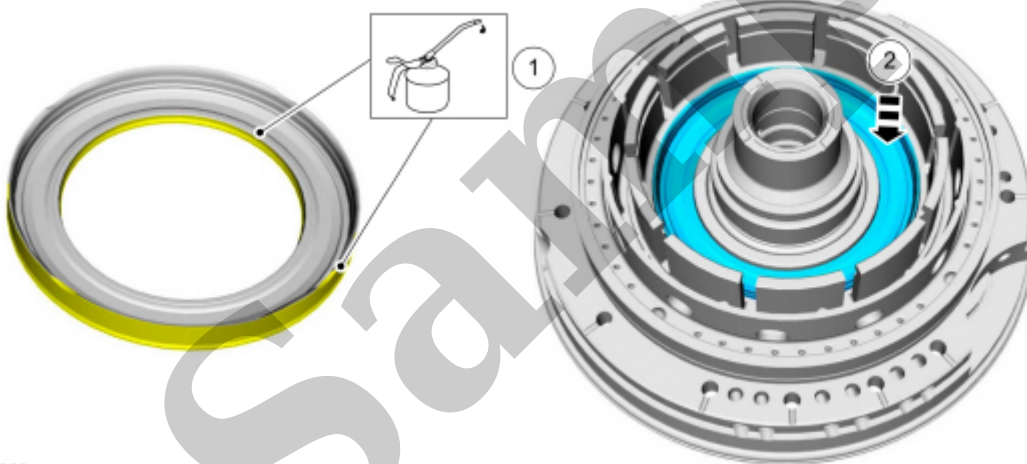

E243882

[Click here to learn about symbols, color coding, and icons used in this manual.](#)

281. Install the B clutch apply plate.

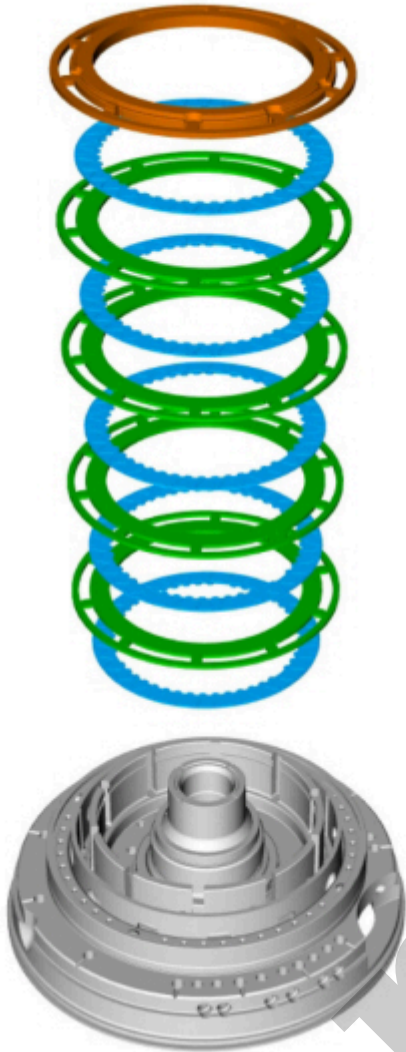

E243895

[Click here to learn about symbols, color coding, and icons used in this manual.](#)

283. Install the B clutch snap ring with the grooved side down.

1. B clutch snap ring grooved side

clutch clearance measurements and compare the measurement to the clutch clearance chart in specifications to determine the correct size snap ring. Install the correct B clutch snap ring.

Refer to: [Specifications](#)(307-01A Automatic Transmission - 10-Speed Automatic Transmission – 10R80, Specifications).

Use Special Service Tool : 100-002 (TOOL-4201-C) Holding Fixture with Dial Indicator Gauge

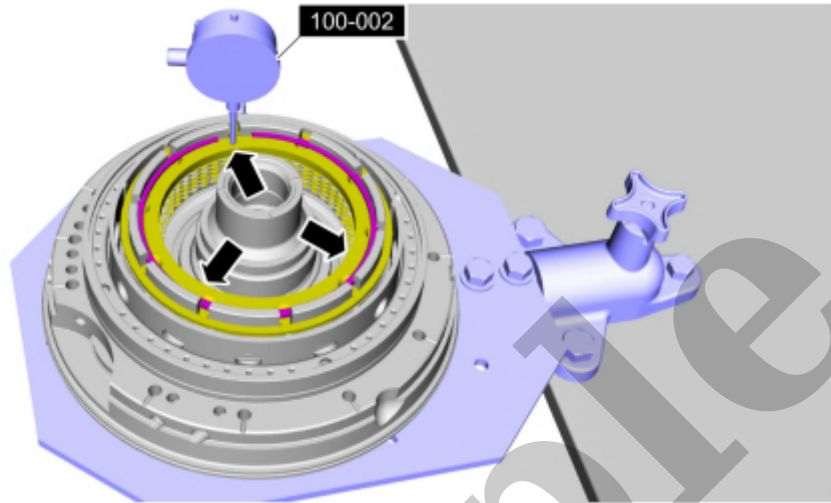

E243896

[Click here to learn about symbols, color coding, and icons used in this manual.](#)

286. Remove the B clutch snap ring.

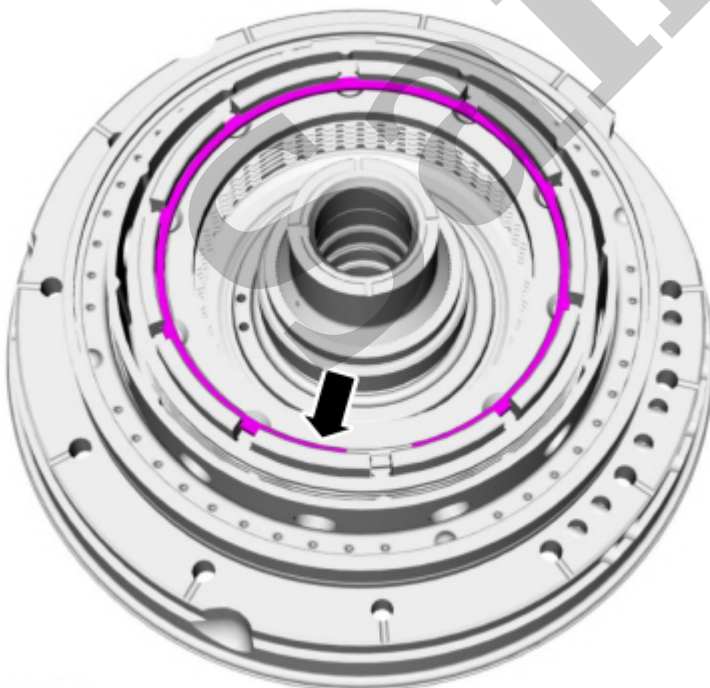

E243974

[Click here to learn about symbols, color coding, and icons used in this manual.](#)