

Your Ultimate Source for OEM Repair Manuals

FactoryManuals.net is a great resource for anyone who wants to save money on repairs by doing their own work. The manuals provide detailed instructions and diagrams that make it easy to understand how to fix a vehicle.

1998 CHEVROLET Express OEM Service and Repair Workshop Manual

[Go to manual page](#)

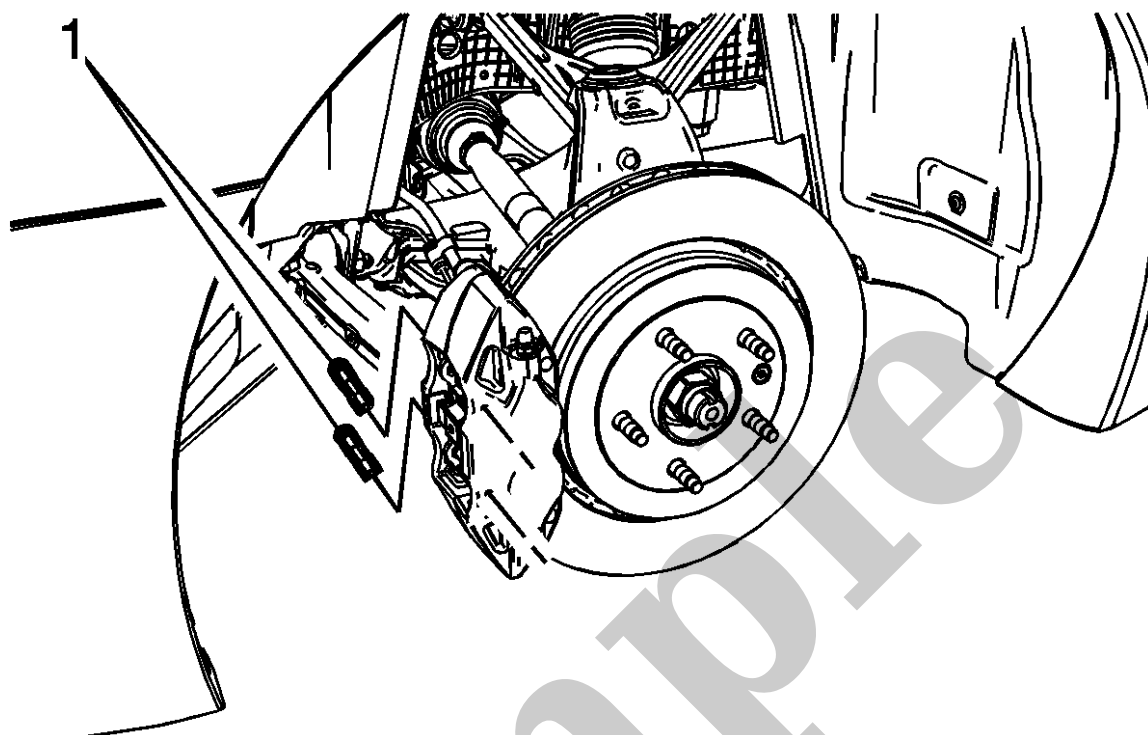

6.

Carefully drive out the brake caliper pins (1) from the brake caliper.

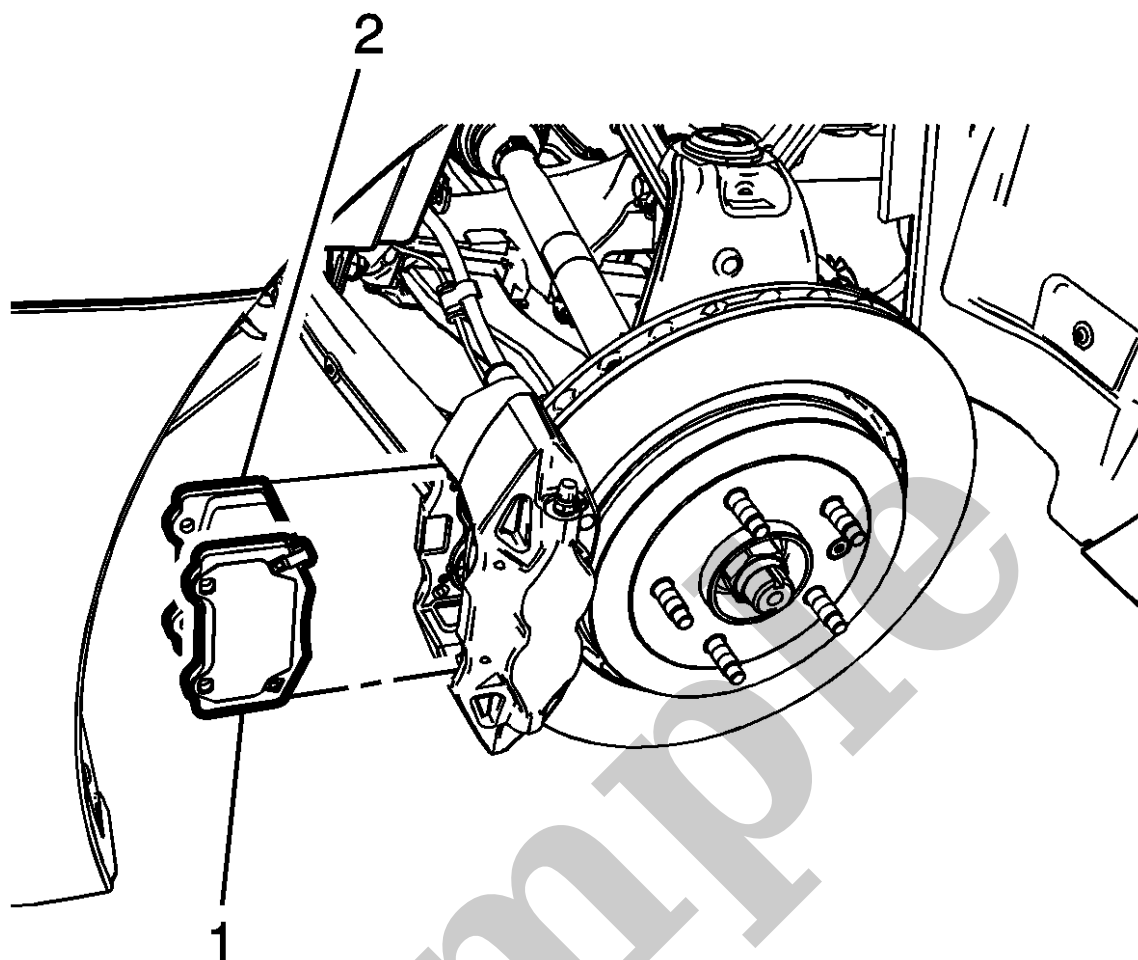

9.

Remove the outer brake pad (1), noting the location of the brake pad wear sensor.

10. Remove the inner brake pad (2).

Installation Procedure

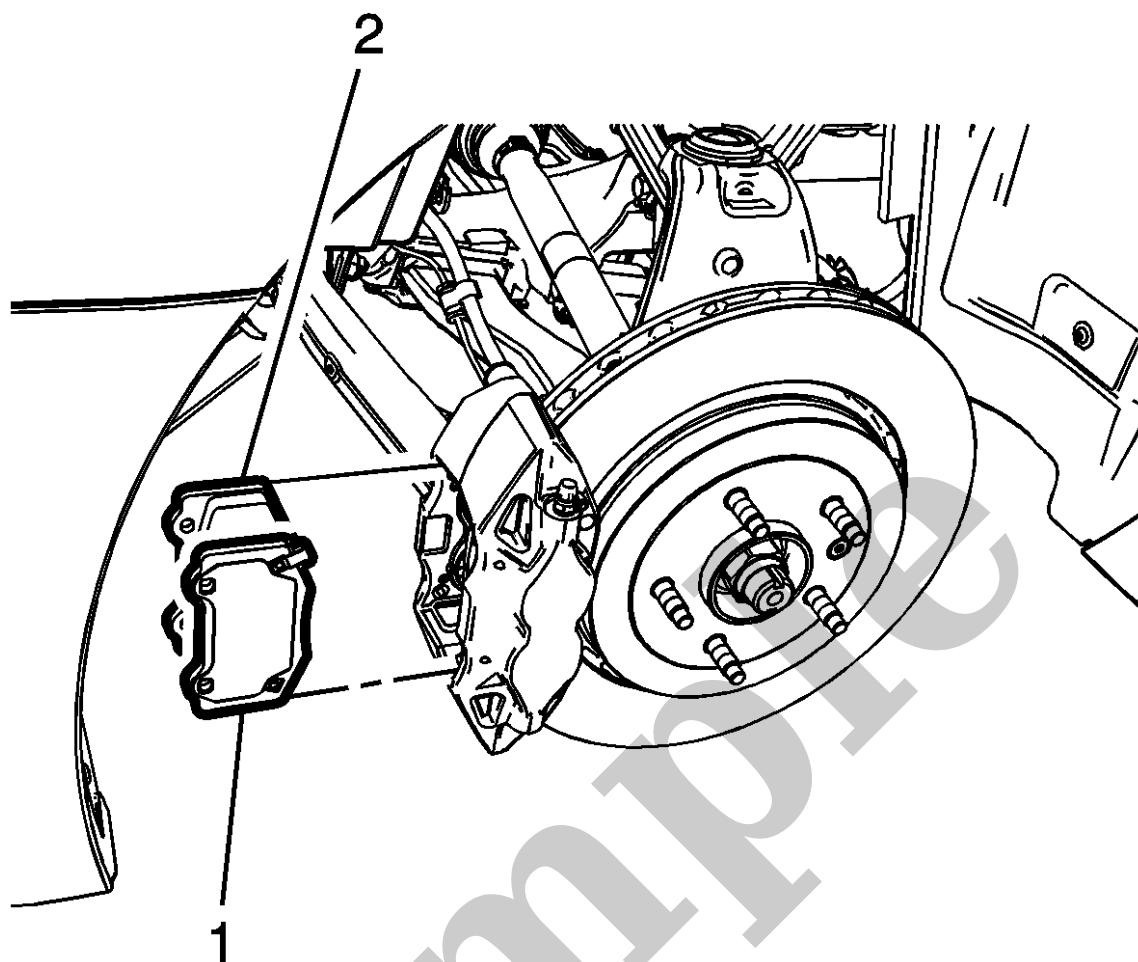

3.

Install the outer brake pad (1), noting the location of the brake pad wear sensor.

4. Install the inner brake pad (2).

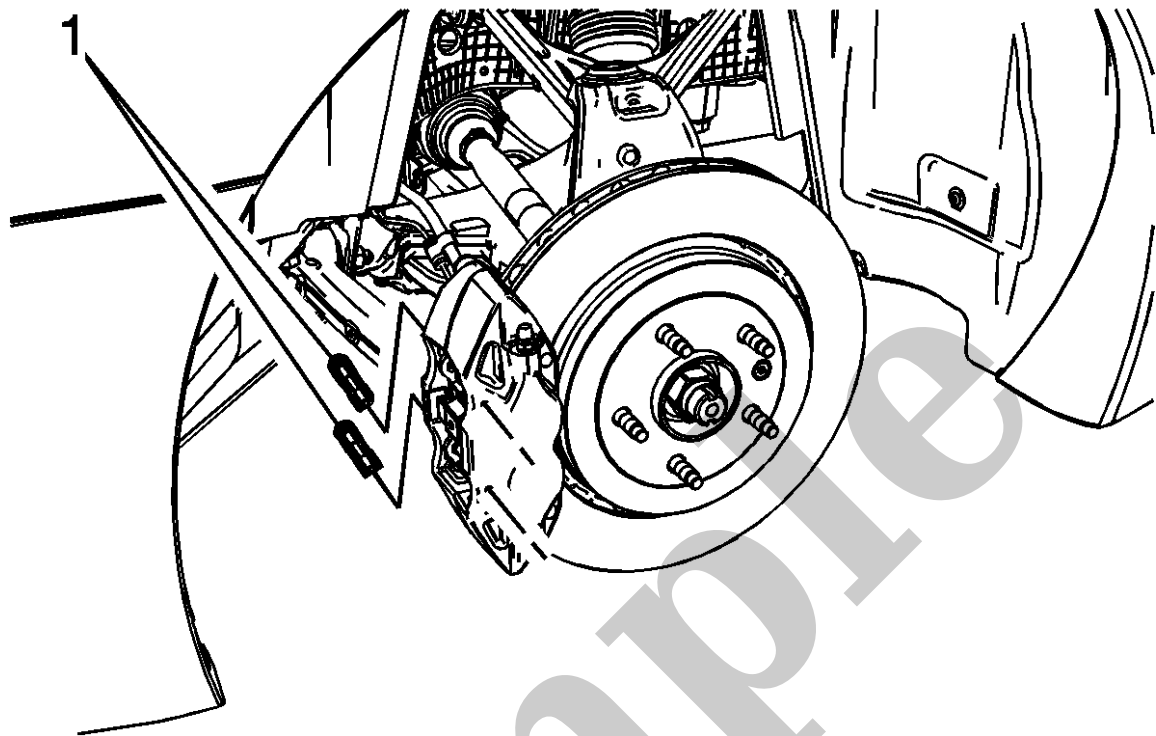

6.
Carefully drive the brake caliper pins (1) into the brake caliper.
7. Ensure the brake caliper pins are fully seated in the brake caliper.
8. Install the tire and wheel assembly. Refer to [Tire and Wheel Removal and Installation](#).
9. With the engine OFF, gradually apply the brake pedal to approximately 2/3 of its travel distance.
10. Slowly release the brake pedal.
11. Wait 15 seconds, then repeat steps 9 and 10 until a firm brake pedal apply is obtained. This will properly seat the brake caliper pistons and brake pads.
12. Fill the brake master cylinder reservoir to the proper level. Refer to [Brake Master Cylinder Reservoir Filling](#).
13. Burnish the brake pads and rotors. Refer to [Brake Pad and Rotor Burnishing](#).