

Your Ultimate Source for OEM Repair Manuals

FactoryManuals.net is a great resource for anyone who wants to save money on repairs by doing their own work. The manuals provide detailed instructions and diagrams that make it easy to understand how to fix a vehicle.

1997 VOLVO 960 Estate OEM Service and Repair Workshop Manual

[Go to manual page](#)

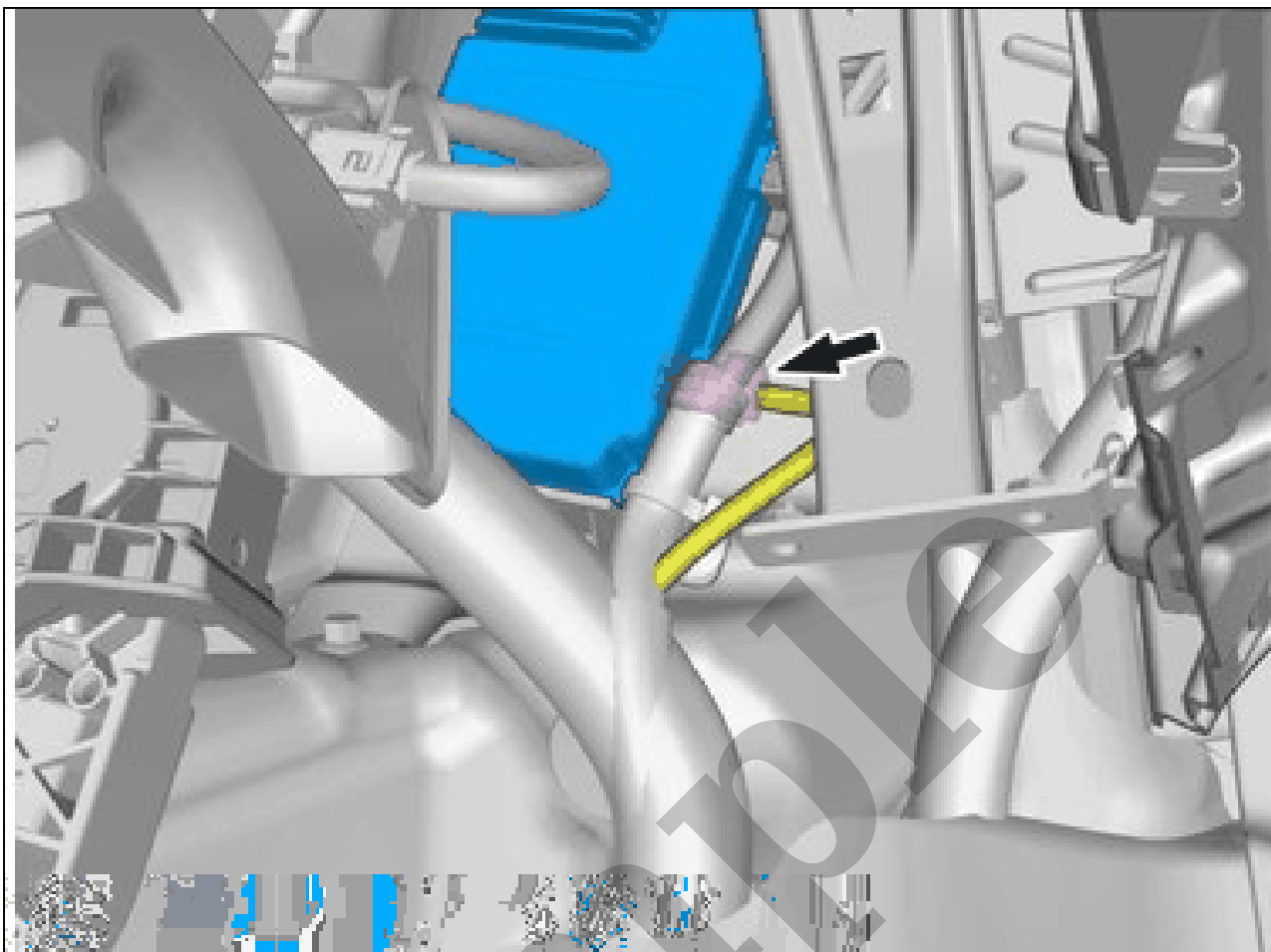

Courtesy of VOLVO CARS CORPORATION

View from below
Disconnect the connector.
VEHICLES EARLY VERSION

OBD FIREWALL MODULE > OBD FIREWALL MODULE (OFM) [2018-2020] > REMOVAL

Remove front seat. Refer to: FRONT SEAT

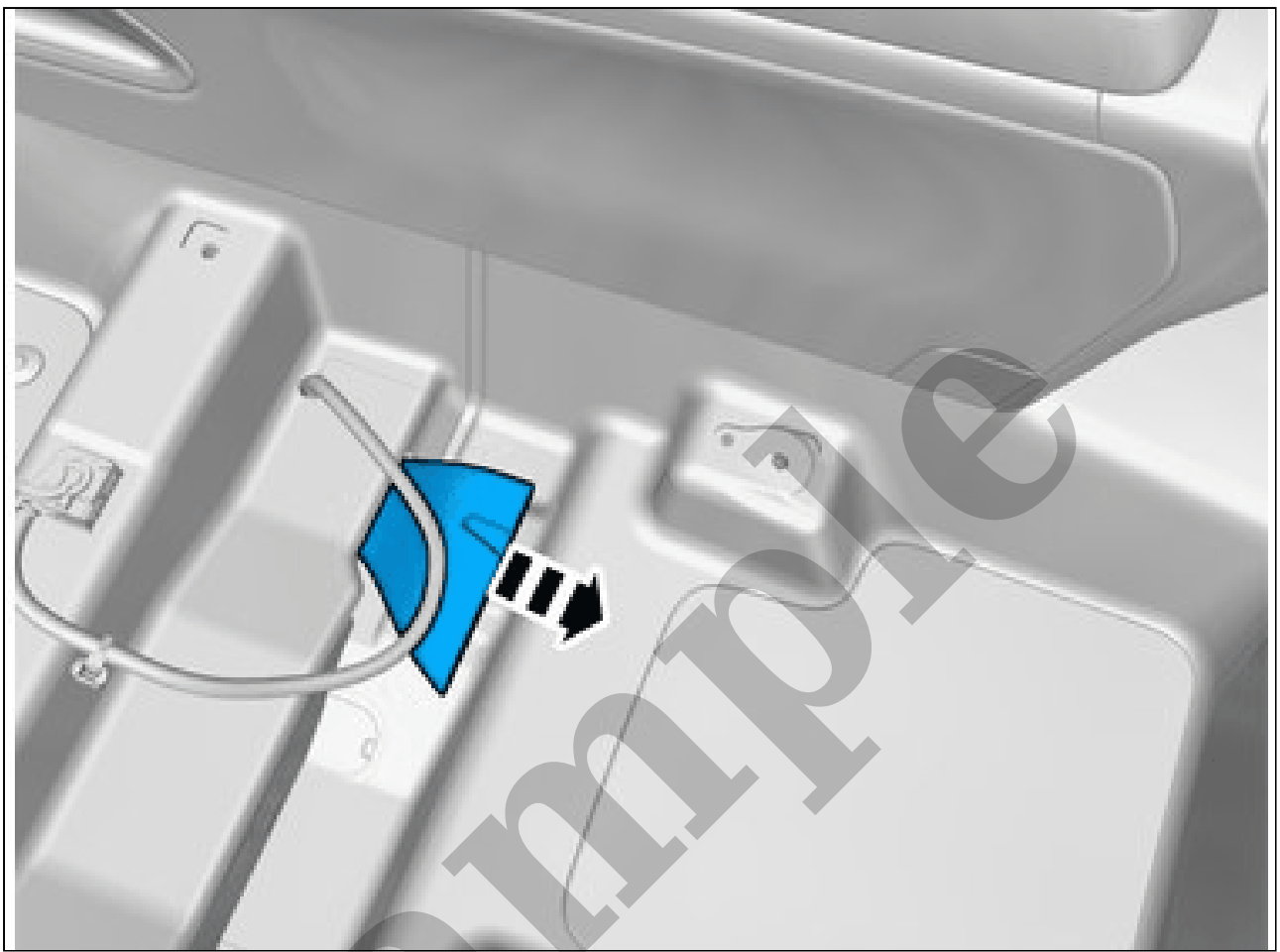

Courtesy of VOLVO CARS CORPORATION

Remove the marked part.

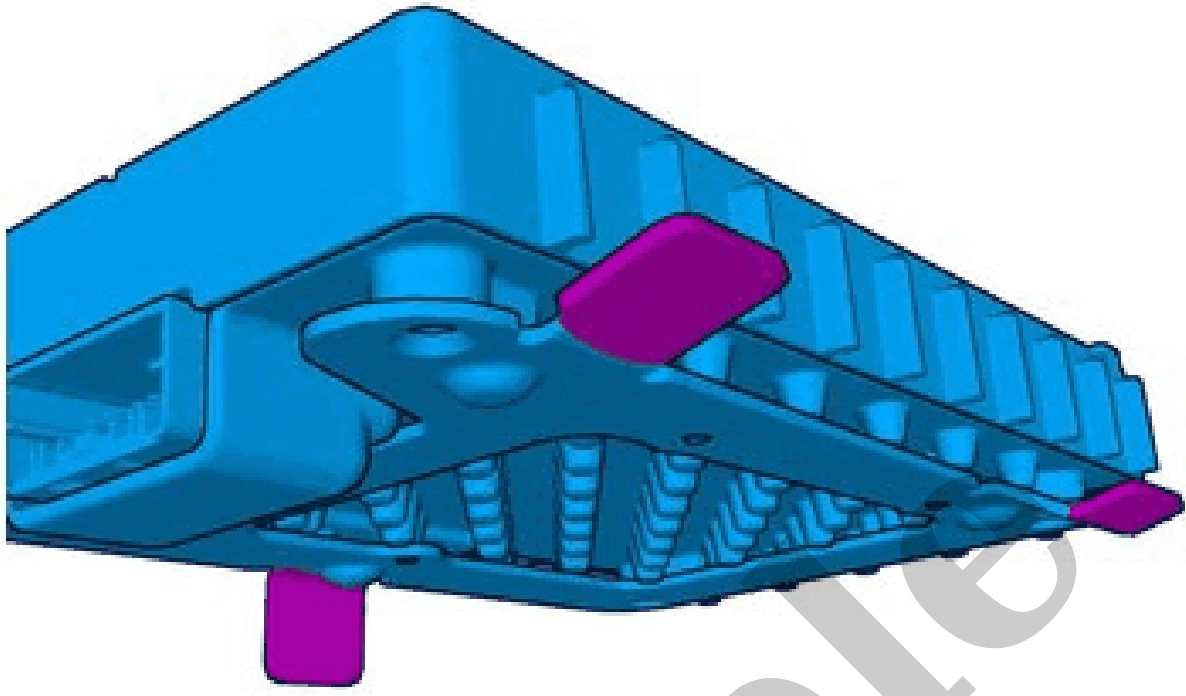

Courtesy of VOLVO CARS CORPORATION

Sample

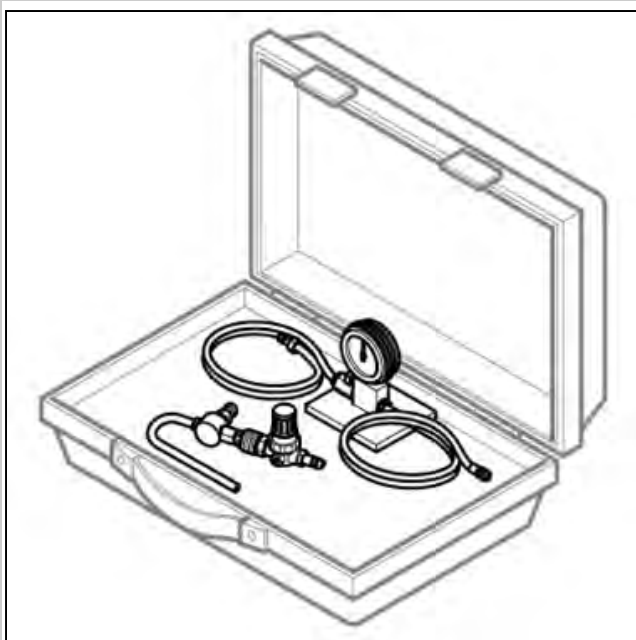

999 7618 Vacuum tool
Tool number: 999 7618
Tool description: Vacuum tool
Tool boards: 30

Courtesy of VOLVO CARS CORPORATION

Materials	
Designation	Part number
Butyl tape	1161782

CHECK

Remove the headlamp. Refer to: HEADLAMPS

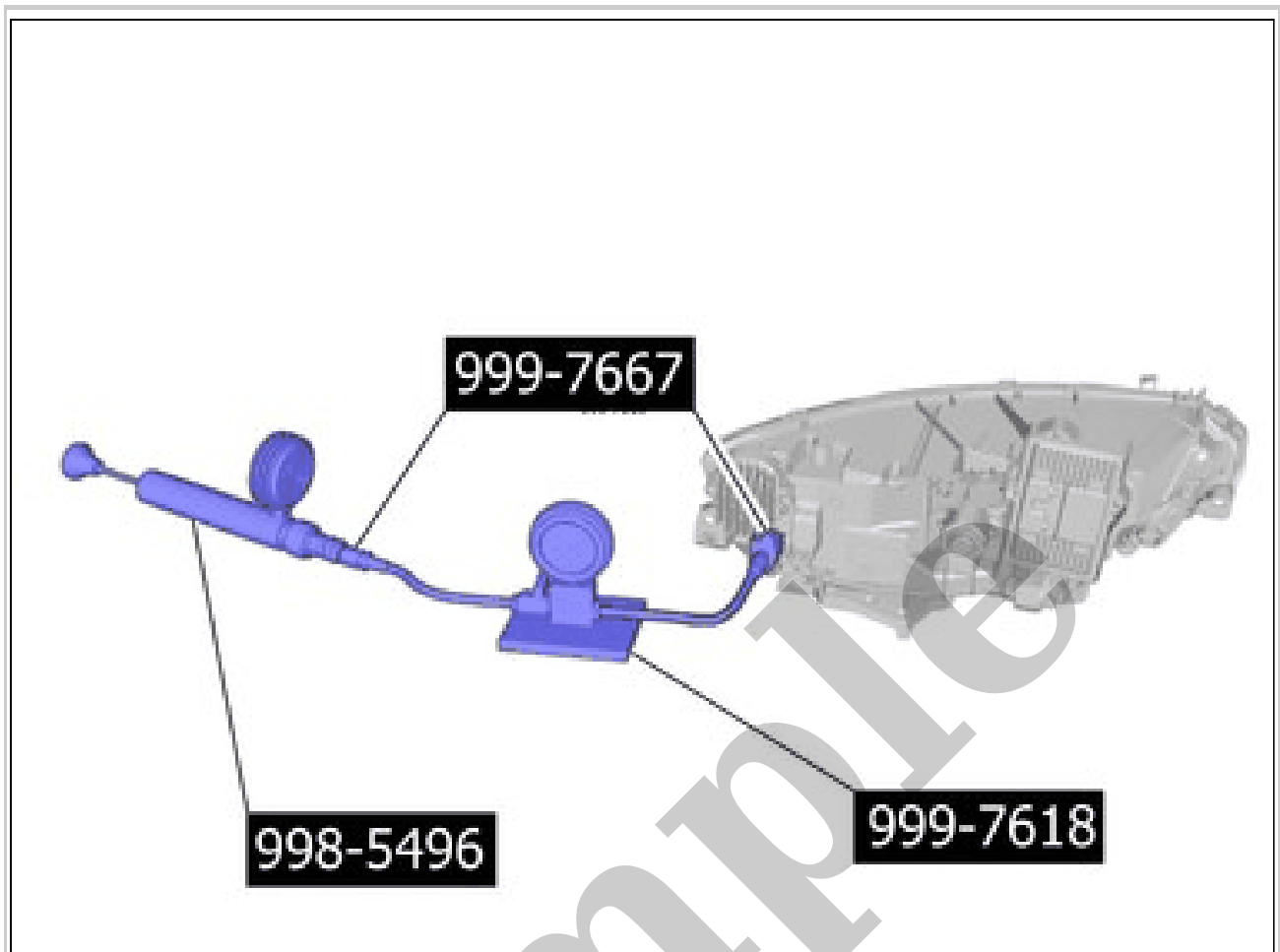

Courtesy of VOLVO CARS CORPORATION

Adjust the pressure to maximum 40 mbar.

Close the valve and wait for 30 seconds. If the pressure does not drop below 20 mbar, the headlamp is considered to have no leaks.

Special Tool: 998 5496 ENGINE COOLANT SYSTEM - PRESSURE TESTER Special Tool: 999 7667 Test equipment Special Tool: 999 7618 Vacuum tool

HEADLAMPS, ADJUSTING > HEADLAMPS, ADJUSTING [2022, E400V5 | 2021-2022, E400V6]

NOTE: For information on Volvo color coded illustrations, refer to: IMAGES .

ADJUSTMENT

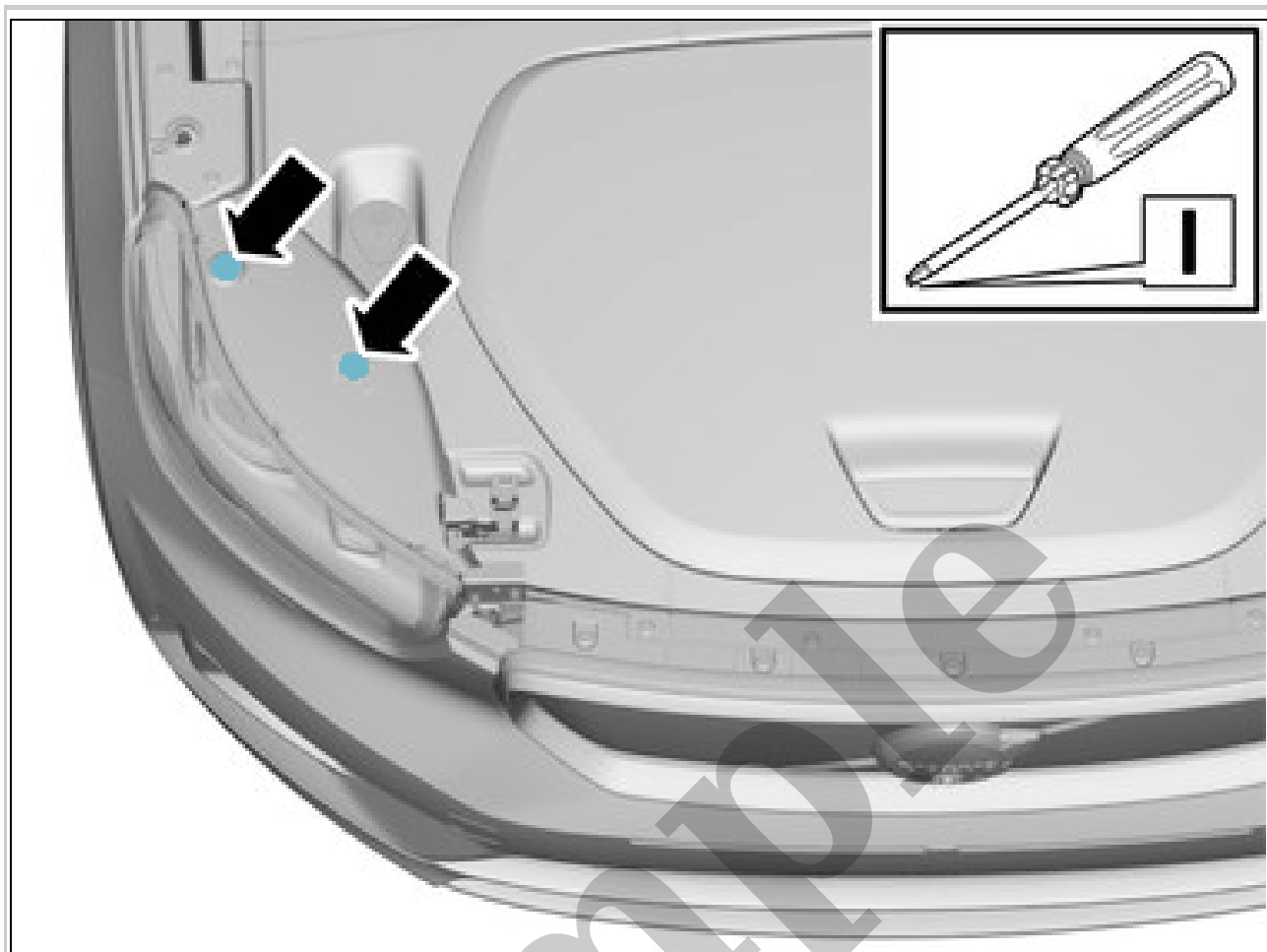

Courtesy of VOLVO CARS CORPORATION

Remove the marked parts.
On both sides.

Use: Electrician's screwdriver

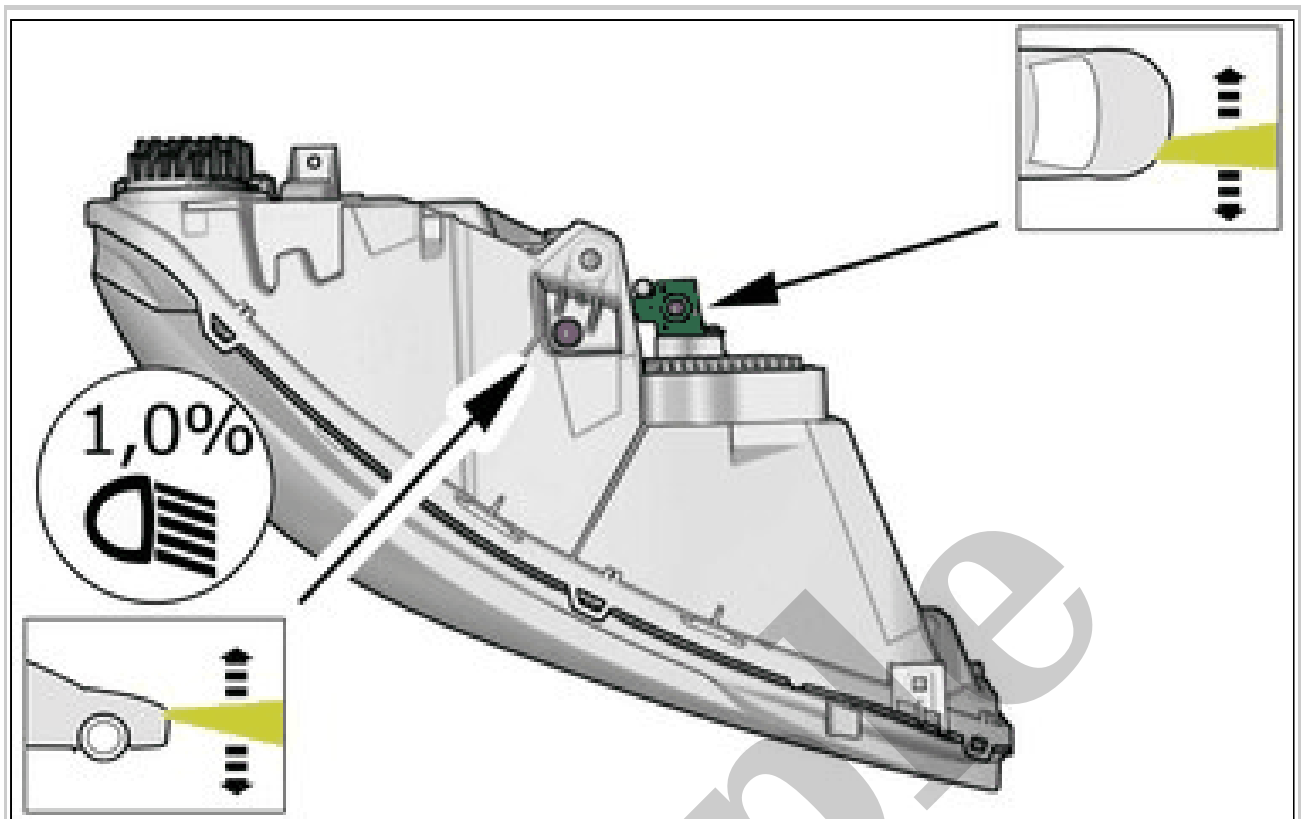

Courtesy of VOLVO CARS CORPORATION

Follow the instructions regarding light pattern. Refer to: BEAM

readable parameters.

DOOR PANEL ILLUMINATION > DOOR PANEL ILLUMINATION (10/324 - 10/327) [2018-2022] > CONNECTION AND COMMUNICATION

The door panel illumination is connected differently depending on if the vehicle is left hand drive or right hand drive.

Left hand drive

- The door panel illumination, front left, is directly connected to the Driver Door Module (DDM)
- The door panel illumination, front right, is directly connected to the Passenger Door Module (PDM)
- The door panel illumination, rear left, is directly connected to the rear door module RDM, left. The rear door module RDM, left, communicates with the Driver Door Module (DDM) over LIN
- The door panel illumination, rear right, is directly connected to the rear door module RDM, right. The rear door module RDM, right, communicates with the Passenger Door Module (PDM) over LIN

Right hand drive

- The door panel illumination, front left, is directly connected to the Passenger Door Module (PDM)
- The door panel illumination, front right, is directly connected to the Driver Door Module (DDM)
- The door panel illumination, rear left, is directly connected to the rear door module RDM, left. The rear door module RDM, left, communicates with the Passenger Door Module (PDM) over LIN
- The door panel illumination, rear right, is directly connected to the rear door module RDM, right. The rear door module RDM, right, communicates with the Driver Door Module (DDM) over LIN

DOOR POCKET ILLUMINATION > DOOR POCKET ILLUMINATION (10/309 - 10/312) [2018-2022] > DESCRIPTION

The pocket in the door panel is illuminated by the door pocket illumination.

DOOR POCKET ILLUMINATION > DOOR POCKET ILLUMINATION (10/309 - 10/312) [2018-2022] > DIAGNOSTIC INFORMATION

The door pocket illumination does not have a built-in diagnostic system. The Driver Door Module (DDM) or the Passenger Door Module (PDM) monitors the door pocket illumination, sets DTCs and stores readable parameters.

DOOR POCKET ILLUMINATION > DOOR POCKET ILLUMINATION (10/309 - 10/312) [2018-2022] > CONNECTION AND COMMUNICATION

The door pocket illumination is connected differently depending on if the vehicle is left hand drive or right hand drive.

Left hand drive

- The door pocket illumination, front left, is directly connected to the Driver Door Module (DDM)
- The door pocket illumination, front right, is directly connected to the Passenger Door Module (PDM)
- The door pocket illumination, rear left, is directly connected to the rear door module RDM, left. The rear door module RDM, left, communicates with the Driver Door Module (DDM) over LIN

The Headlamp Control Module Left (HCML) / Headlamp Control Module Right (HCMR) receives information from the Central Electronic Module (CEM) and actuates its light sources and motors according to this information. The HCML/HCMR communicates with the CEM over Body CAN exposed.

HIGH MOUNTED BRAKE LIGHT > HIGH MOUNTED BRAKE LIGHT (10/19) [2018-2022] > DESCRIPTION

The high mounted brake light, is activated together with the rear brake lights during braking. The lamp consists of a number of LEDs.

HIGH MOUNTED BRAKE LIGHT > HIGH MOUNTED BRAKE LIGHT (10/19) [2018-2022] > DIAGNOSTIC INFORMATION

The high mounted brake light does not have a built-in diagnostic system. The Central Electronic Module (CEM) monitors the lights and sets DTCs and readable parameters.

HIGH MOUNTED BRAKE LIGHT > HIGH MOUNTED BRAKE LIGHT (10/19) [2018-2022] > CONNECTION AND COMMUNICATION

The high mounted brake light is directly connected to the Central Electronic Module (CEM) and the Trailer Module (TRM).

ILLUMINATION, CRYSTAL CUPHOLDER > ILLUMINATION, CRYSTAL CUPHOLDER (10/345) [2018-2022] > DESCRIPTION



Courtesy of VOLVO CARS CORPORATION

The illumination, crystal cupholder, illuminates the crystal cupholder for the champagne glasses.