

Your Ultimate Source for OEM Repair Manuals

FactoryManuals.net is a great resource for anyone who wants to save money on repairs by doing their own work. The manuals provide detailed instructions and diagrams that make it easy to understand how to fix a vehicle.

1996 VOLVO 850 Estate R OEM Service and Repair Workshop Manual

[Go to manual page](#)

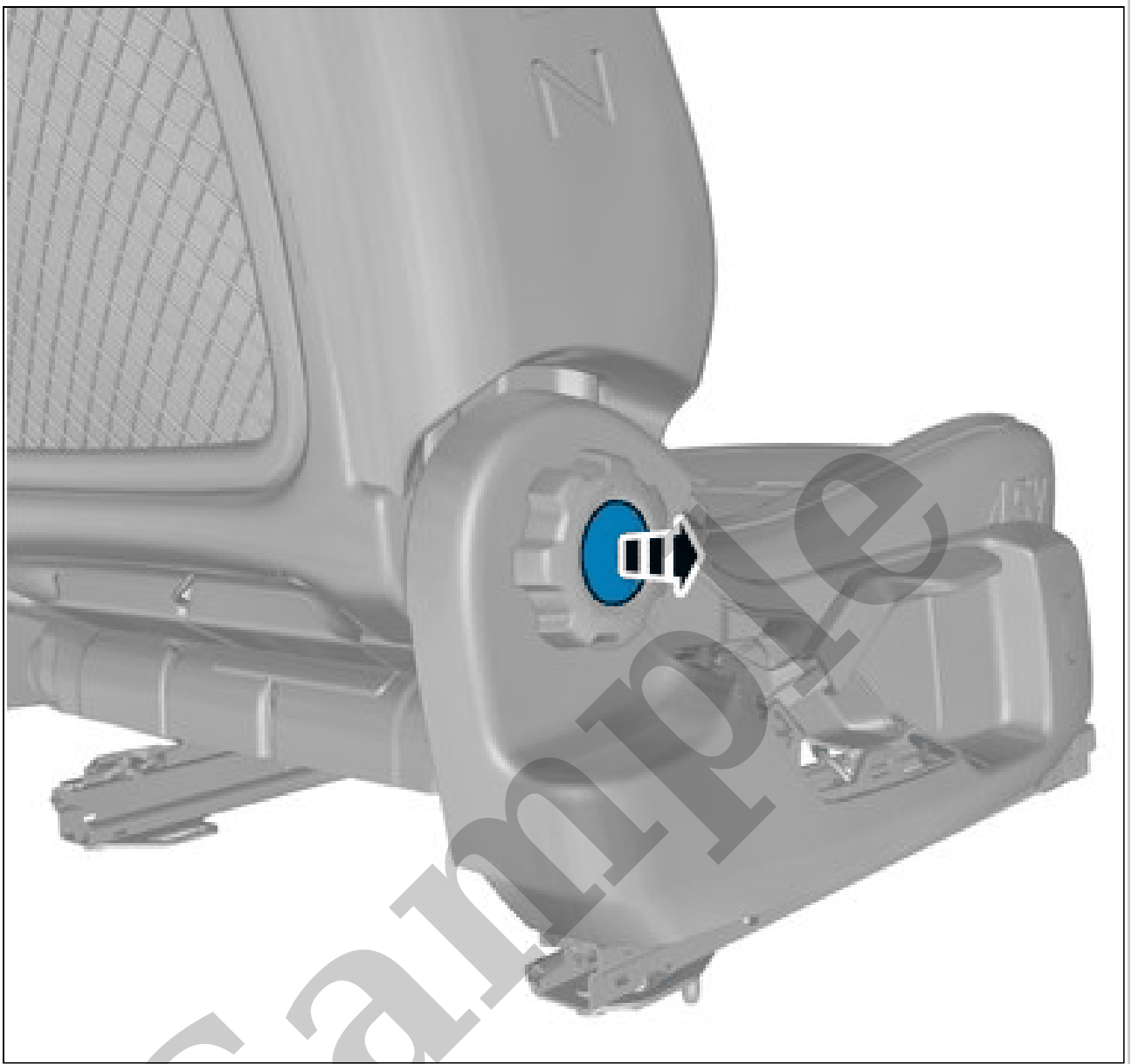

Courtesy of VOLVO CARS CORPORATION

Remove the marked part.

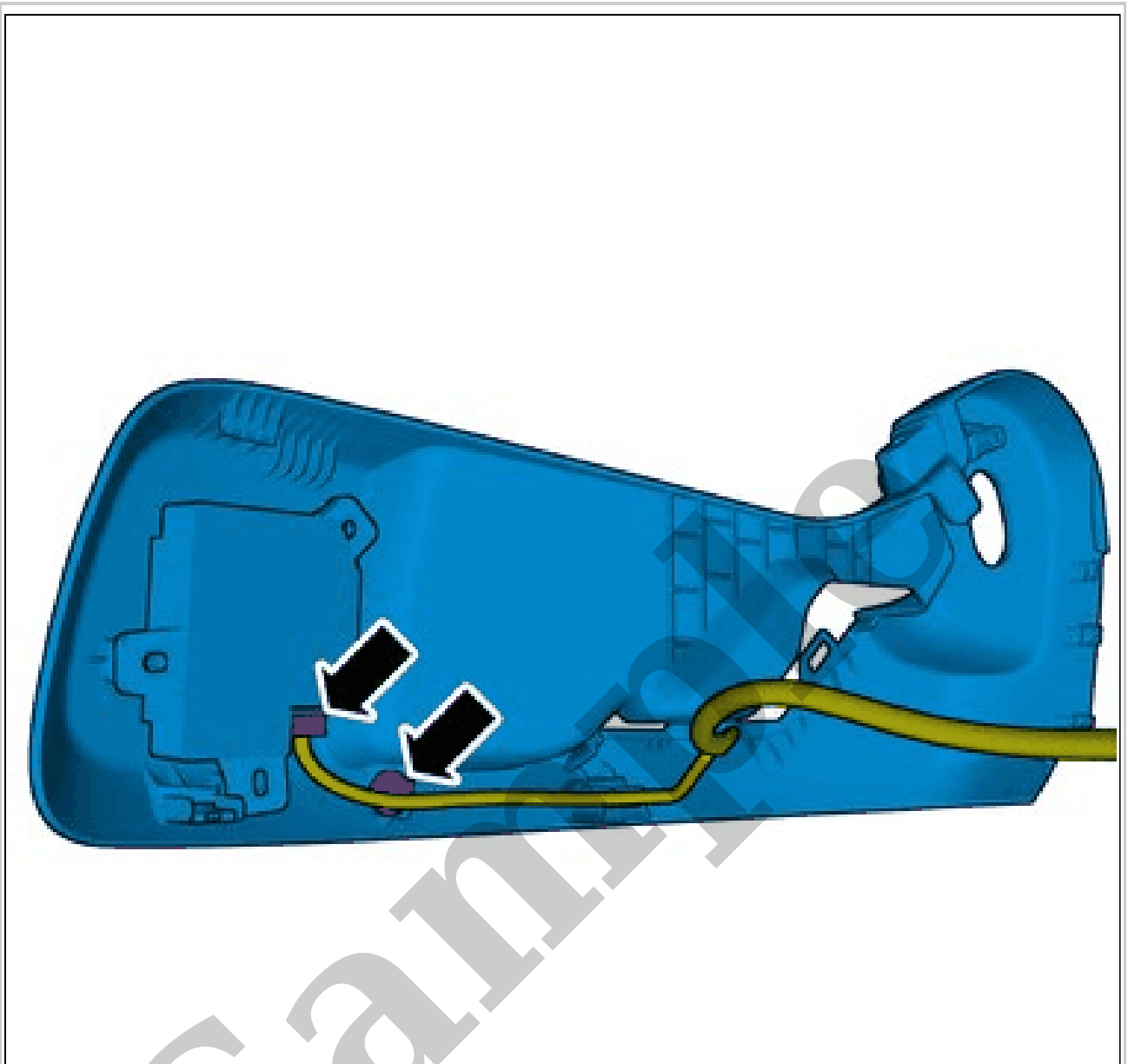

Courtesy of VOLVO CARS CORPORATION

Loosen the clip.
Disconnect the connector.
Remove the marked part.
ALL VEHICLES

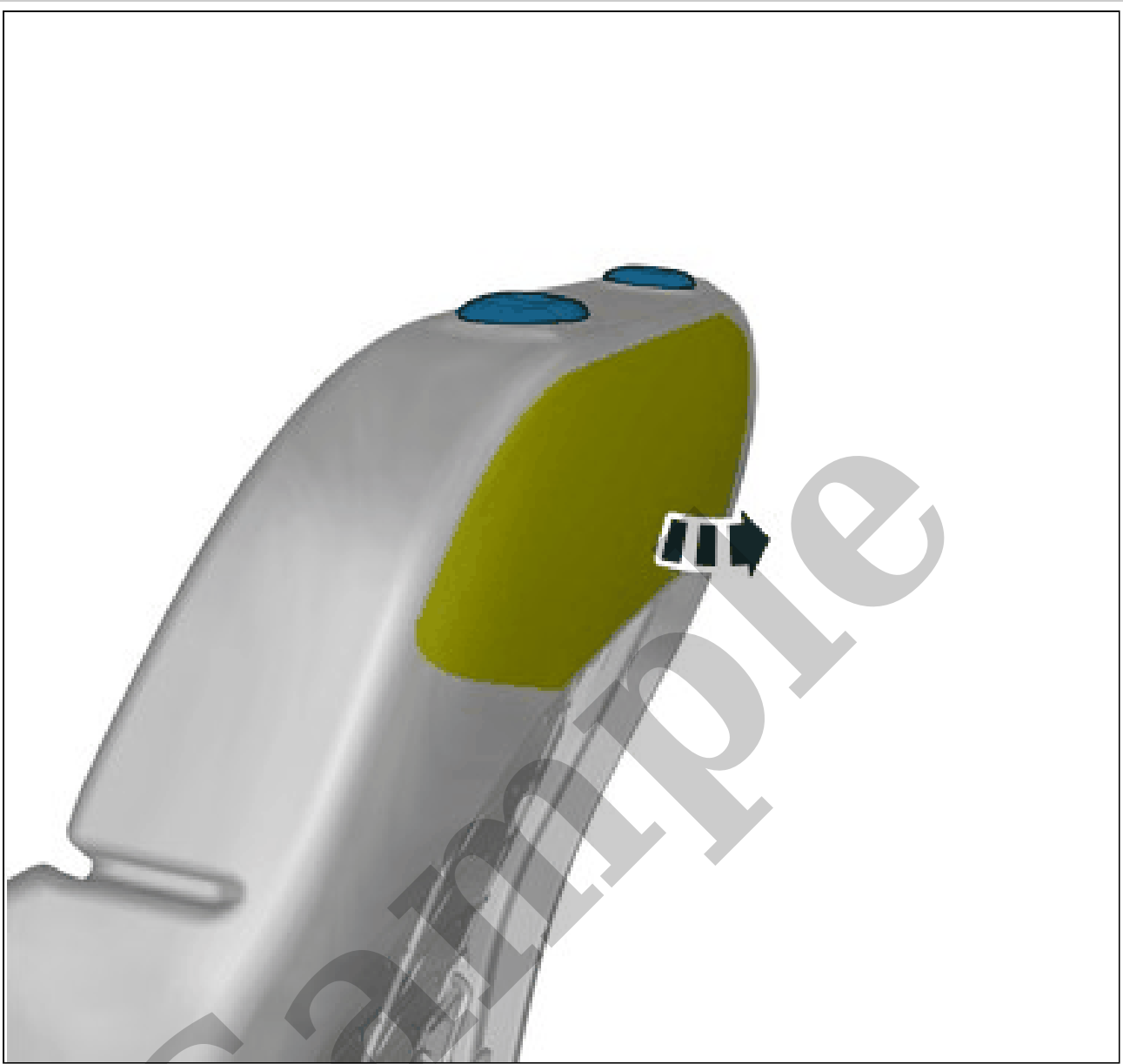

Courtesy of VOLVO CARS CORPORATION

Fold marked part aside.

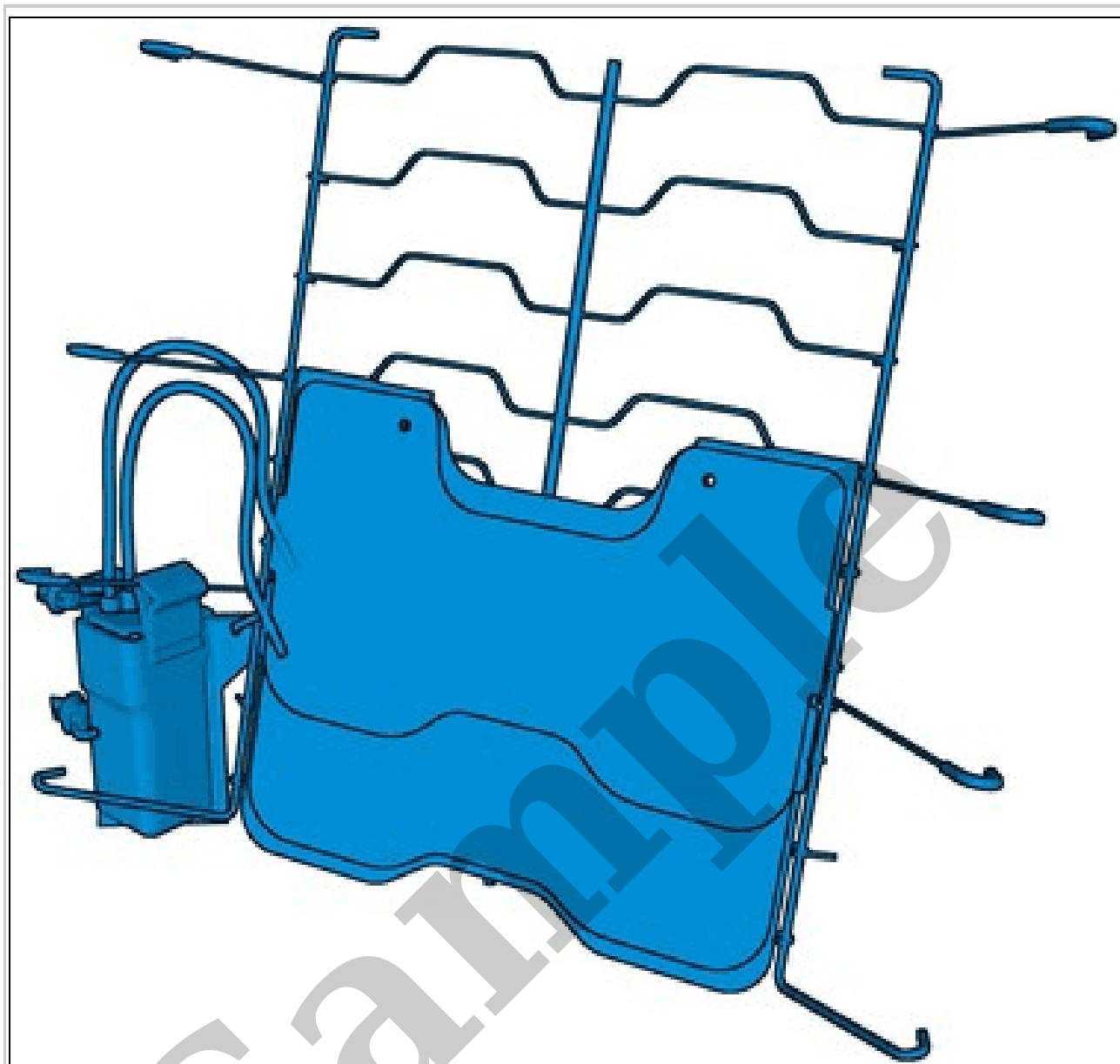

Courtesy of VOLVO CARS CORPORATION

NOTE: *Orientation view*

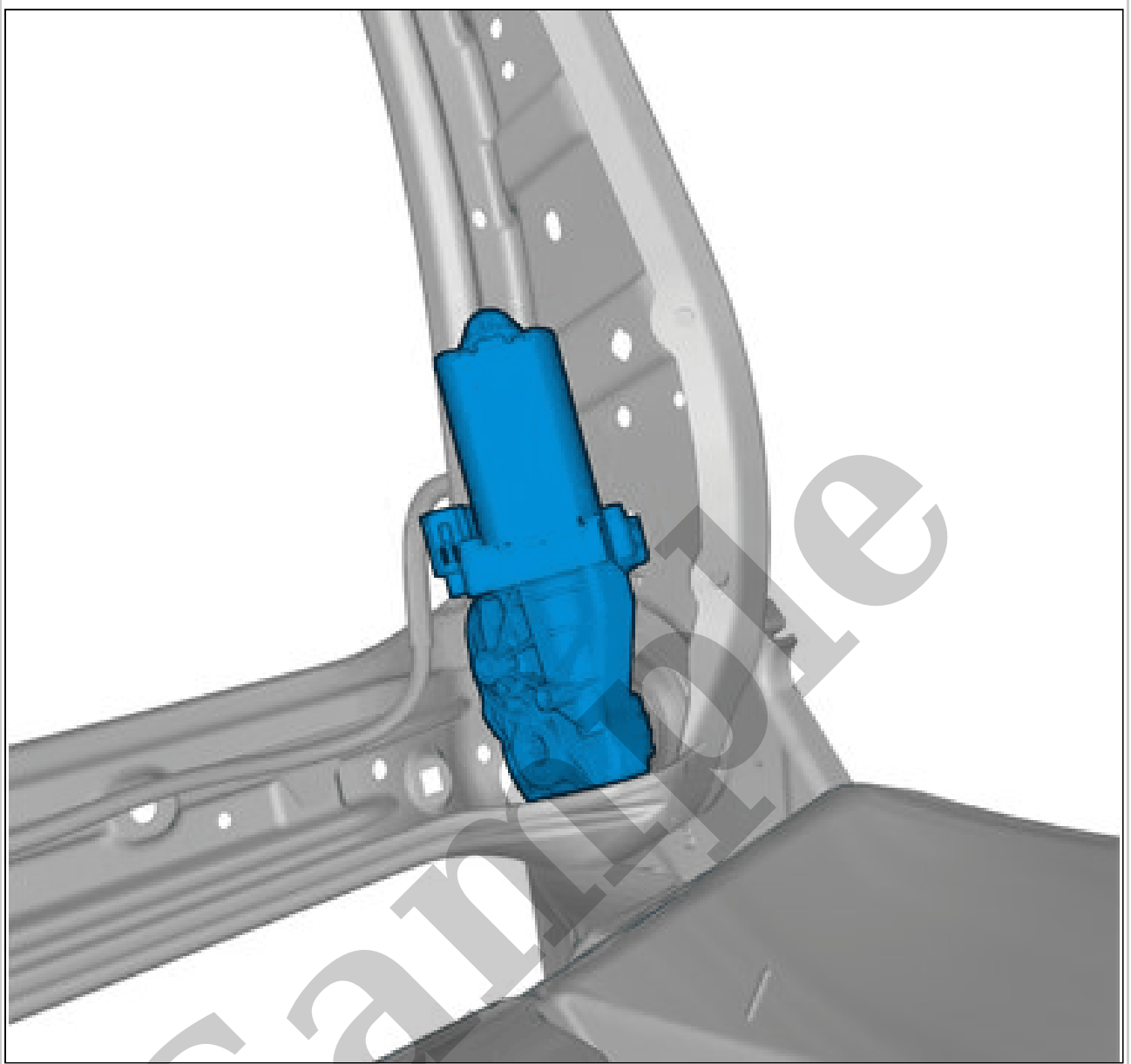

Courtesy of VOLVO CARS CORPORATION

Remove the marked part.

ALL VEHICLES

Disconnect connector ignition cable. Refer to: IGNITER WIRE CONNECTOR

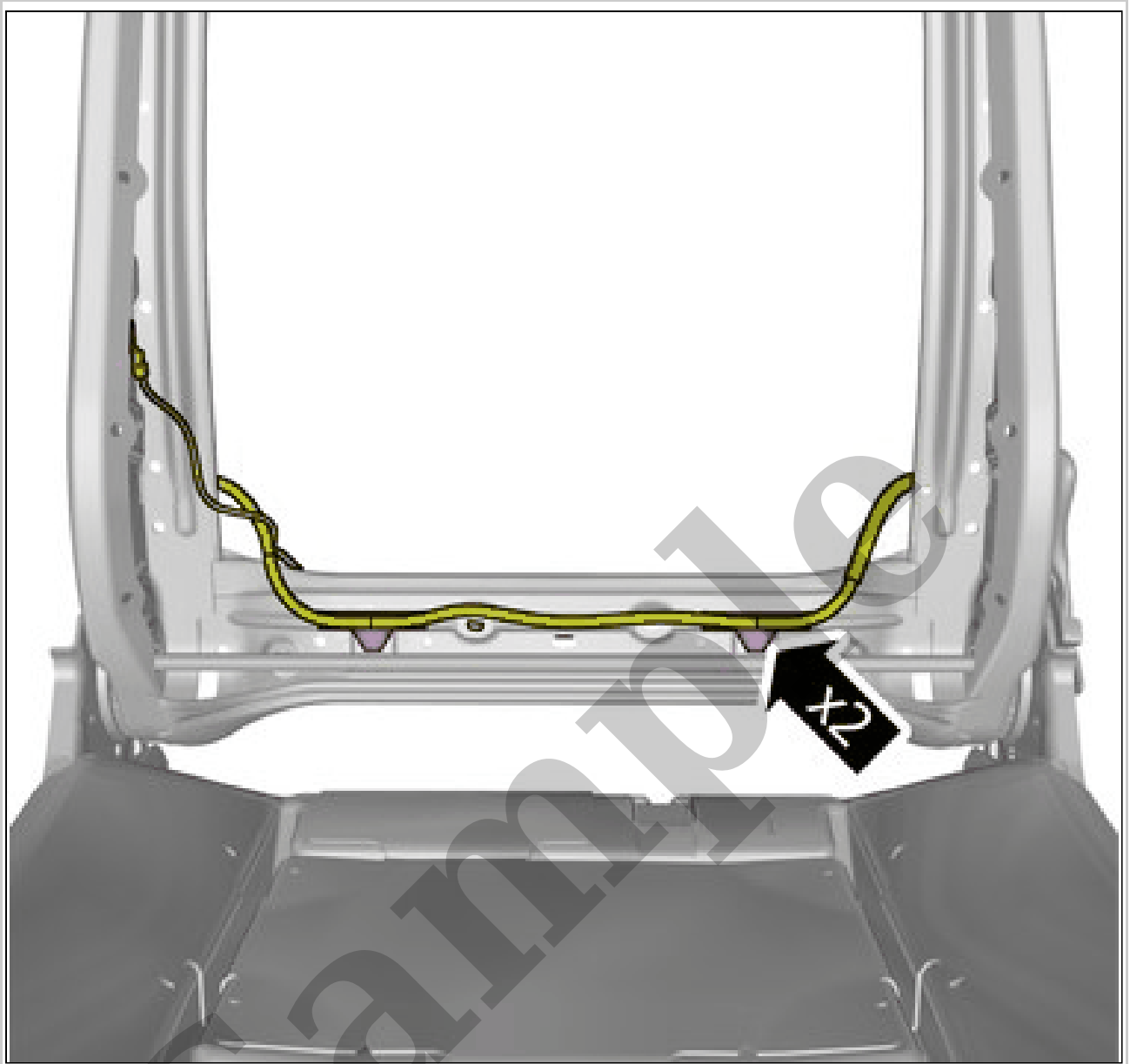

Courtesy of VOLVO CARS CORPORATION

Remove the cable harness clips.

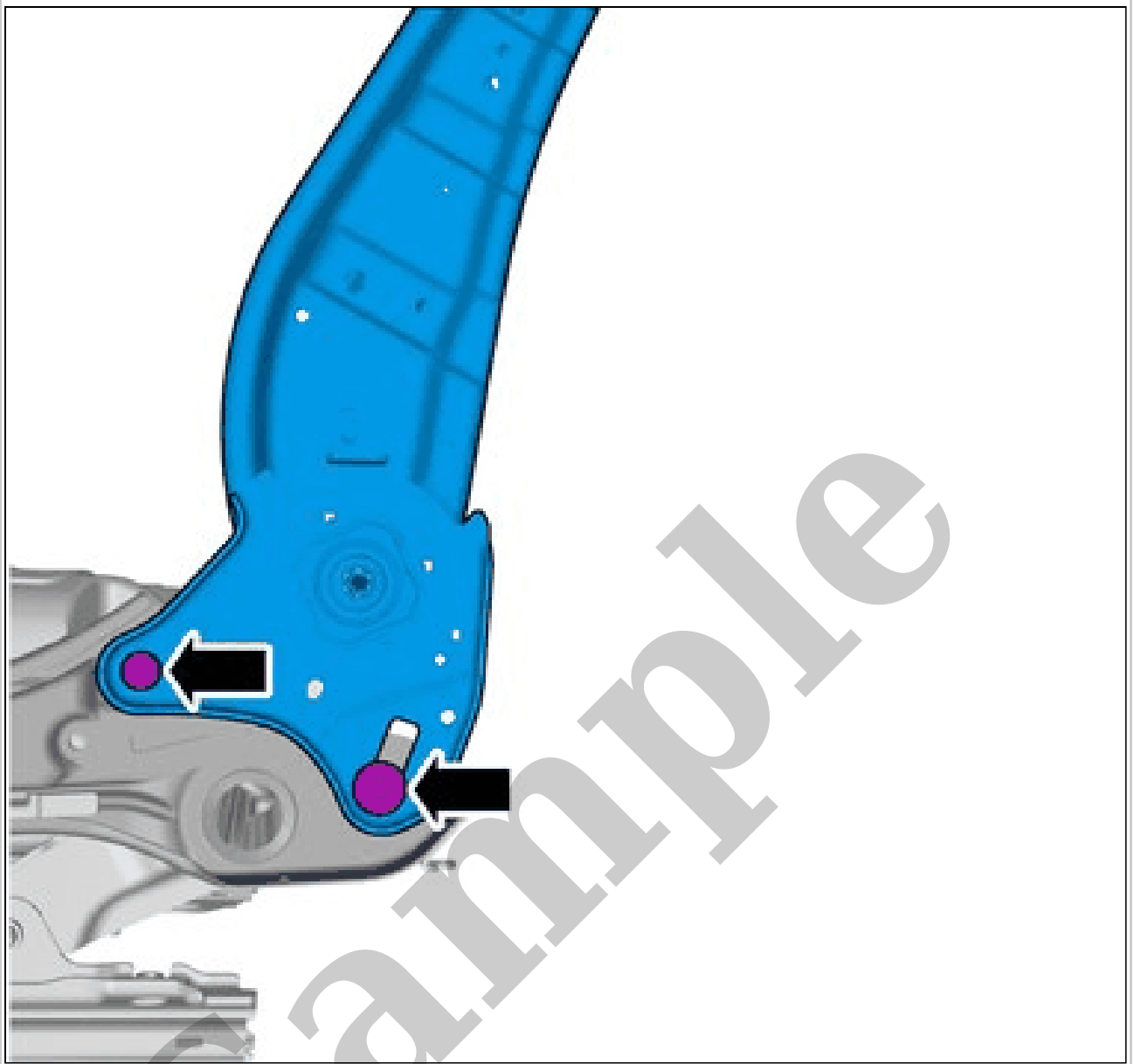

Courtesy of VOLVO CARS CORPORATION

Tighten the bolts.

Torque: Backrest frame to seat frame, 42Nm

To install, reverse the removal procedure.

DRIVER'S AIRBAG > DRIVER'S AIRBAG [2018-2022] > REMOVAL

Follow instructions about safety information pyrotechnical system. Refer to: SAFETY INFORMATION PYROTECHNICAL SYSTEMS

See information regarding the handling of non-deployed pyrotechnical parts. Refer to: HANDLING NON-DEPLOYED PYROTECHNICAL PART

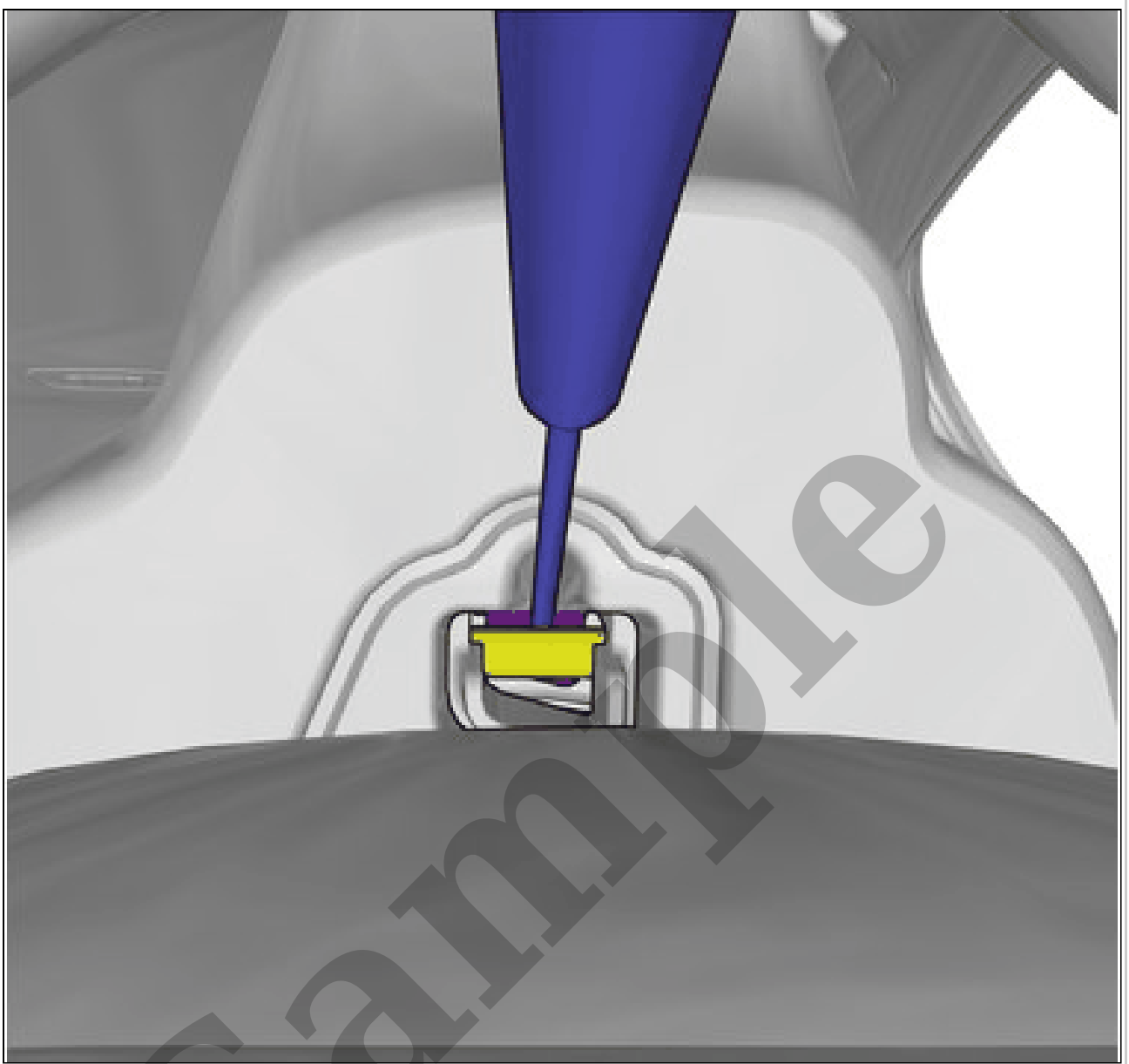

Courtesy of VOLVO CARS CORPORATION

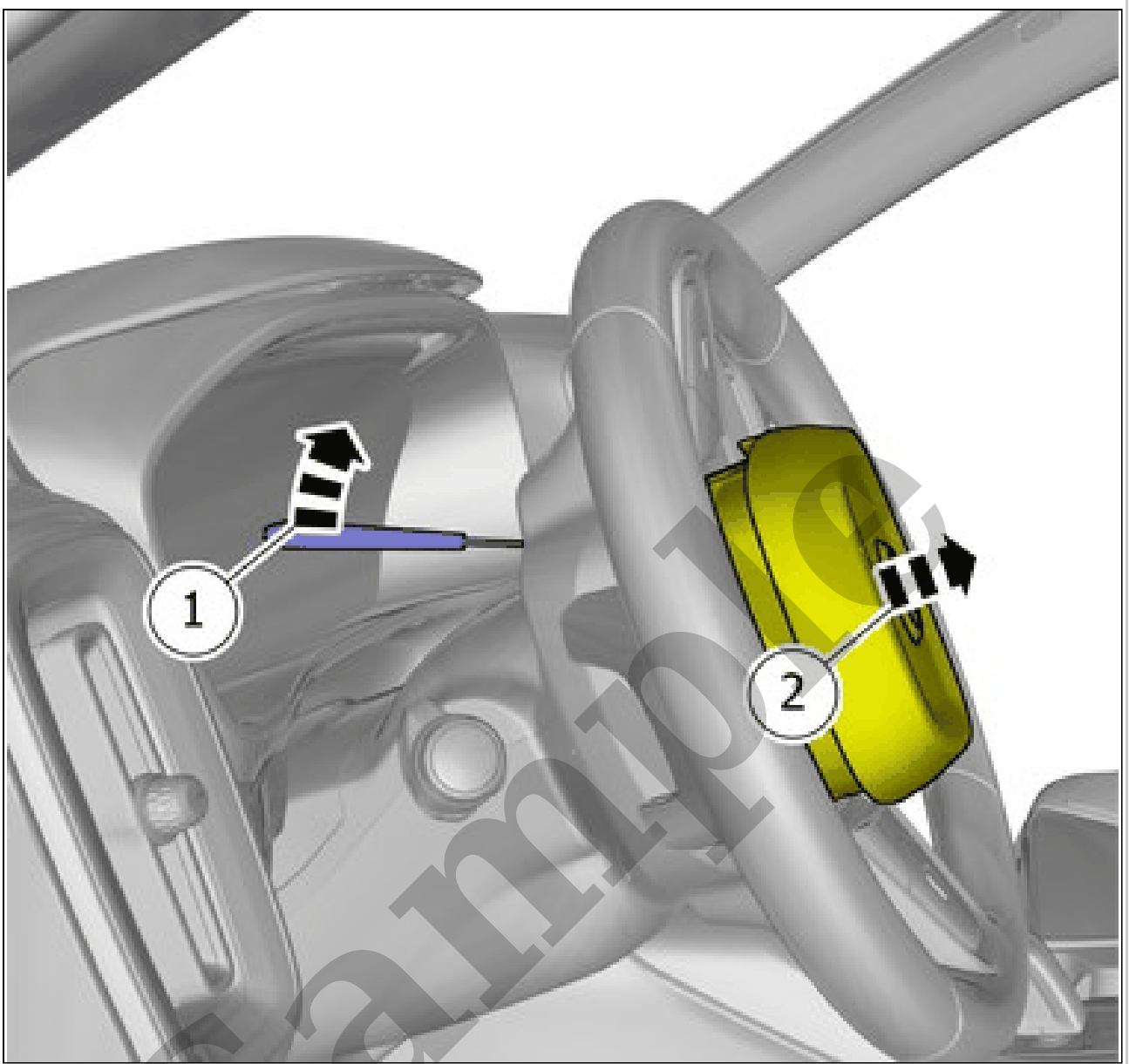

Courtesy of VOLVO CARS CORPORATION

1. Release the catch.
2. Loosen the marked detail.